

McClure Engineering Associates, Inc.
 Macomb, Illinois 61455
 114 East Jackson Street
 (309) 833-4594 FAX (309) 837-4909
 Design firm License #184-000816 Copyright 2008 by McClure Engineering Associates, Inc.

PLOTTING SCALE: 1" = 30'
 DRAWN BY: TAB
 CHECKED BY: JAR
 DATE: OCTOBER 2008

NO.	REVISIONS	DATE

**WARD STREET IMPROVEMENTS
 PAVEMENT MARKING PLAN - STA. 300+03 TO 315+00**
 CITY OF MACOMB
 SOUTH WARD ST.
 FILE NAME: W:\DRAWINGS\MACOMB\WARDS1\WARD-ST-2007 FIELD BOOK No: 2237 JOB NUMBER: 03-26-08286

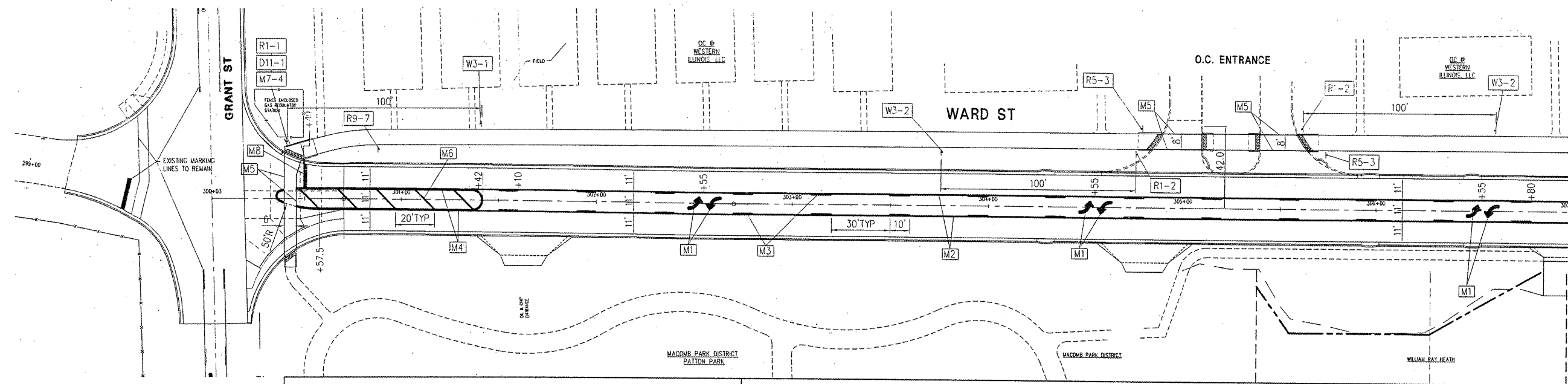

- SHARED USE PATH SIGNING**
- | | |
|--|-------------------------------------|
| R1-1 STOP SIGN-18"x18" | W3-1 STOP AHEAD-18"x18" |
| R1-2 YIELD SIGN-18"x18"x18" | W3-2 YIELD AHEAD-18"x18" |
| R5-3 NO MOTOR VEHICLES-24"x24" | W11-1 BICYCLE WARNING-24"x24" |
| R5-6 NO BICYCLES-24"x24" | W16-1 SHARE THE ROAD-18"x24" |
| R9-7 SHARED USE PATH RESTRICTION-12"x18" | D11-1 BIKE ROUTE-24"x18" |
| | M7-4 ROUTE SIGN SUPPLEMENTAL 12"x9" |

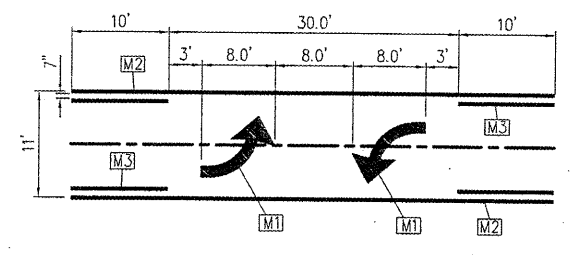

- PAVEMENT MARKING LEGEND**
- M1 POLYUREA PAVEMENT MARKING, LETTERS AND SYMBOLS, SPECIAL - LEFT/RIGHT TURN ARROWS(WHITE)
 - M2 POLYUREA PAVEMENT MARKING, TYPE 1-LINE, 4" (YELLOW)
 - M3 POLYUREA PAVEMENT MARKING, TYPE 1-LINE, 4" (YELLOW-SKIP/DASH)
 - M4 POLYUREA PAVEMENT MARKING, TYPE 1-LINE, 4" (DOUBLE YELLOW)
 - M5 POLYUREA PAVEMENT MARKING, TYPE 1-LINE, 6" (WHITE)
 - M6 POLYUREA PAVEMENT MARKING, TYPE 1-LINE, 12" (YELLOW)
 - M7 POLYUREA PAVEMENT MARKING, TYPE 1-LINE, 12" (WHITE)
 - M8 POLYUREA PAVEMENT MARKING, TYPE 1-LINE, 24" (WHITE)
 - M9 POLYUREA PAVEMENT MARKING, TYPE 1-LINE, 8" (WHITE)

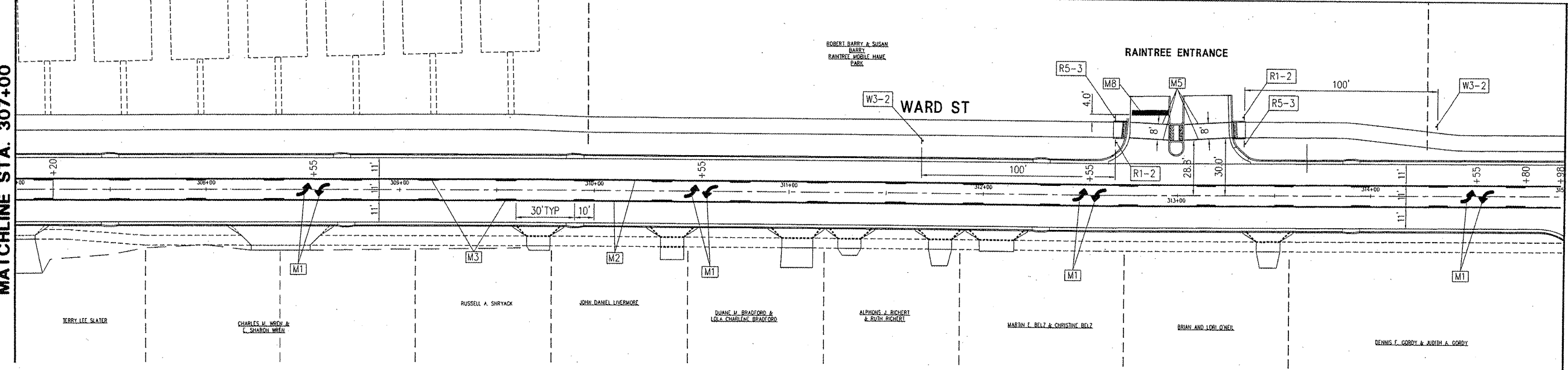

MATCHLINE STA. 307+00

MATCHLINE STA. 315+00