

STAGE 4

CONSTRUCTION

1. CONSTRUCT TEMPORARY SIDEWALK AT RESIDENCE AT THE NORTHEAST CORNER OF WARD STREET AND BARSIE BOULEVARD AS INDICATED.
2. REMOVE EXISTING PAVEMENT AND OTHER ITEMS.
3. CONSTRUCT CROSSROAD AND LATERAL STORM SEWER.
4. PERFORM EARTHWORK.
5. FINAL UTILITY ADJUSTMENTS SHALL BE PERFORMED.
6. CONSTRUCT CURB AND GUTTER, PAVEMENT AND SIDE STREET TIE-INS.
7. DRIVEWAY APRONS, SIDEWALK, AND OTHER ITEMS WITHIN THE LIMITS OF STAGE 4 CAN BE COMPLETED NOW OR IN LATER STAGES.
8. REMOVE TEMPORARY ACCESS ITEMS AFTER OPENING WARD STREET BACK UP TO TRAFFIC.

STAGE 4

TRAFFIC

- A. CONSTRUCT IMPROVEMENTS FROM STA. 313+00 TO STA. 323+80 WHILE CLOSING THIS PORTION OF SOUTH WARD STREET TO ALL TRAFFIC. WARD STREET SHALL BE CLOSED TO THRU TRAFFIC FROM STA. 300+50 TO STA. 313+00 AND FROM STA. 323+80 TO STA. 326+75. TWO-LANE, 2-WAY TRAFFIC SHALL BE MAINTAINED OUTSIDE OF THESE LIMITS.
- B. A TEMPORARY PCC SIDEWALK SHALL BE CONSTRUCTED AS DETAILED AT THE NORTHEAST CORNER OF BARSIE BOULEVARD, PRIOR TO CLOSING THIS PORTION OF WARD STREET. THE "NO PARKING" SIGN ON BARSIE BOULEVARD, NEAR WARD STREET SHALL BE RELOCATED FURTHER TO THE EAST, ALLOWING THESE RESIDENTS TO PARK ON BARSIE ADJACENT TO THEIR PROPERTY DURING THIS STAGE OF CONSTRUCTION.
- C. McDONOUGH STREET, CHASE STREET, AND BARSIE BOULEVARD SHALL ALL BE CLOSED ADJACENT TO WARD STREET AS SHOWN. ACCESS SHALL BE MAINTAINED FOR THE CHURCH OF CHRIST OFF OF CHASE STREET, AND FOR THE CONGREGATION OF JEHOVAH'S WITNESSES OFF OF BARSIE BOULEVARD.
- D. IMPROVEMENTS FOR THE CHASE STREET ENTRANCE TO THE CHURCH OF CHRIST SHALL BE CONSTRUCTED PRIOR TO CLOSING THIS PORTION OF WARD STREET. THESE DRIVEWAY IMPROVEMENTS SHALL BE CONSTRUCTED SIMULTANEOUSLY WITH EITHER STAGE 2 OR STAGE 3 WORK. THE ACCESS TO THE CHURCH OFF OF WARD STREET SHALL REMAIN OPEN UNTIL THESE IMPROVEMENTS ARE COMPLETED AND THE CHASE STREET ENTRANCE IS AVAILABLE TO TRAFFIC.
- E. IMPLEMENT SPECIAL SIGN TABLE IN SPECIAL PROVISIONS.

STAGE 4
 STA 313+00± TO STA 323+80

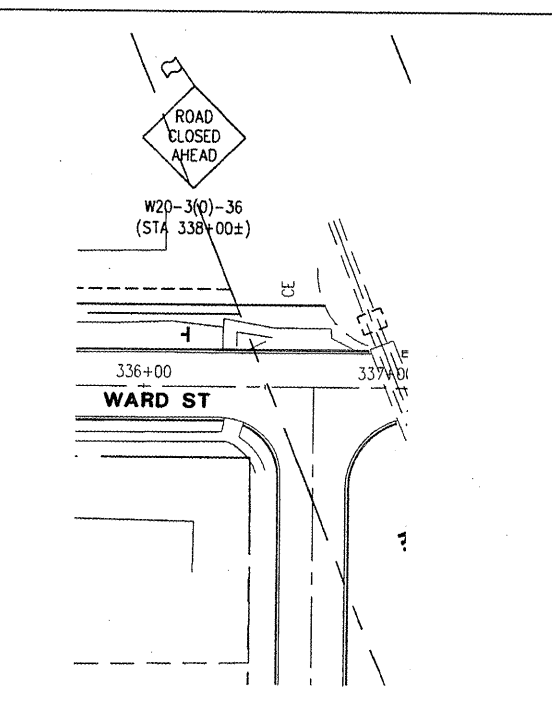
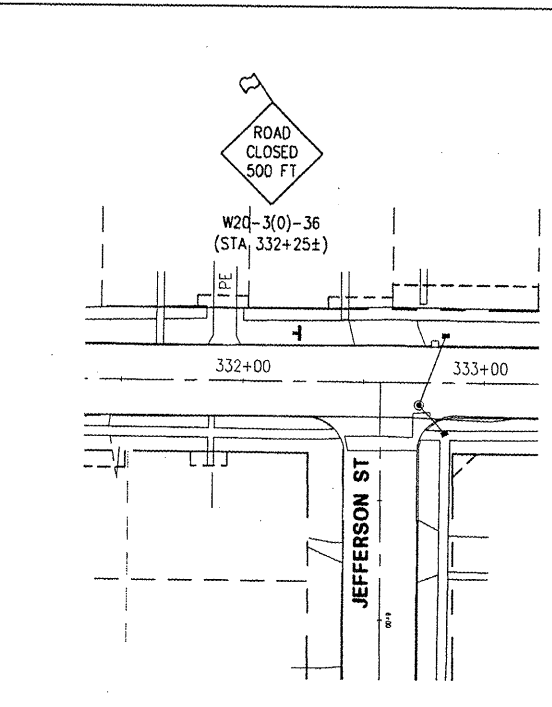
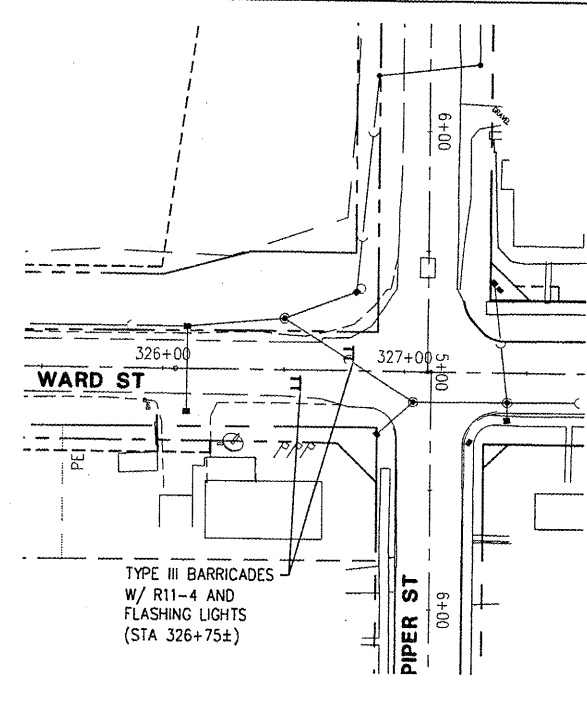
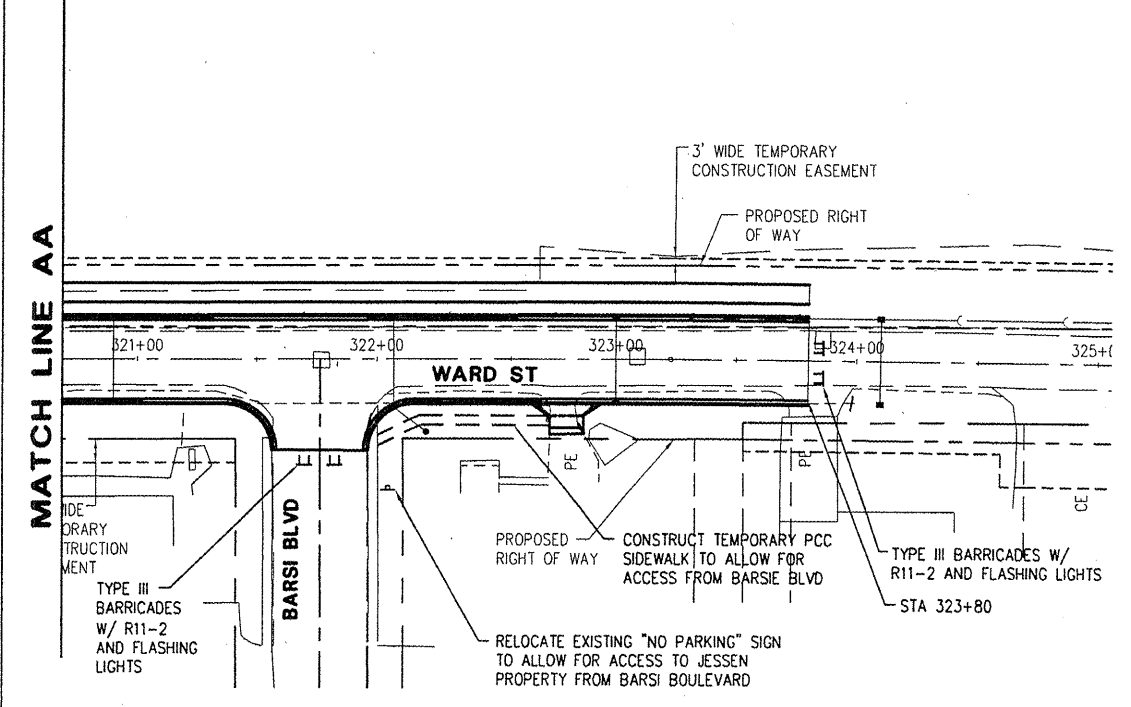

Plotting Scale: 1" = 40'

DRAWN BY:	JAR
CHECKED BY:	JAR
DATE:	OCTOBER 2008

NO.	REVISIONS	ITEM	DATE