

McClure
 Engineering Associates, Inc.
 114 East Jackson Street
 Macomb, Illinois 61455
 13091 833.4594
 Design Firm License #184-000816 Copyright 2008 by McClure Engineering Associates, Inc.

LEGEND

- ① PCC DRIVEWAY PAVEMENT, 6"
- ② PCC DRIVEWAY PAVEMENT, 7"
- ③ AGGREGATE SURFACE COURSE, TYPE A, 6"
- ④ PCC SIDEWALK, 4"
- ④A PCC SIDEWALK 5"
- ⑤ COMB. CONC. CURB & GUTTER, TYPE B6.18
- ⑧ AGGREGATE SURFACE COURSE, TYPE A, 8"
- ⑨ POROUS GRANULAR EMBANKMENT
- ⑩ GEOTECHNICAL FABRIC FOR GROUND STABILIZATION
- Ⓡ1 DRIVEWAY PAVEMENT REMOVAL
- Ⓡ2 PAVEMENT REMOVAL
- Ⓡ3 BRICK SIDEWALK REMOVAL
- Ⓡ4 CONCRETE SIDEWALK REMOVAL
- Ⓡ5 CURB AND GUTTER REMOVAL
- Ⓡ13 REMOVAL OF UNSUITABLE MATERIAL

320+18

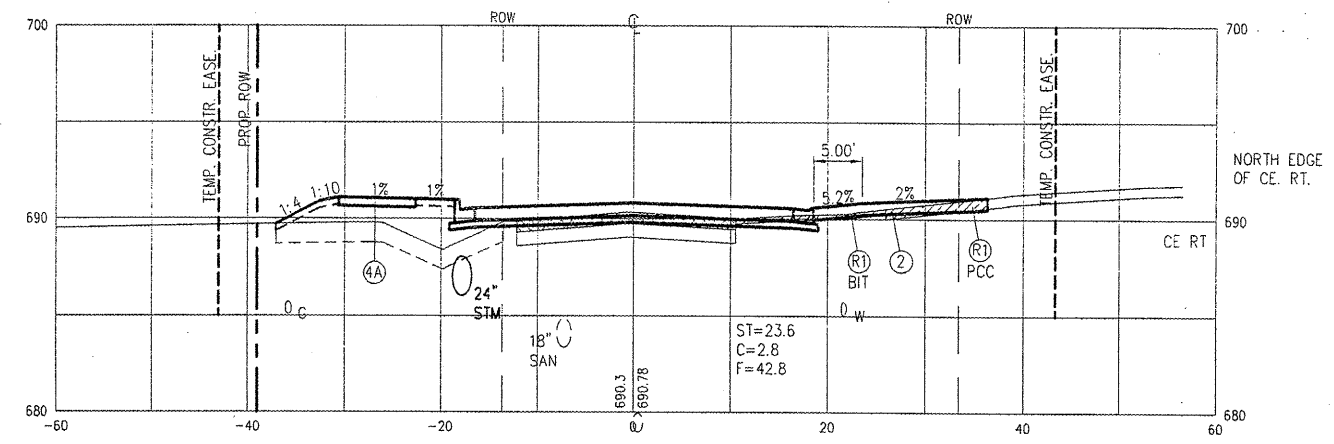

320+03

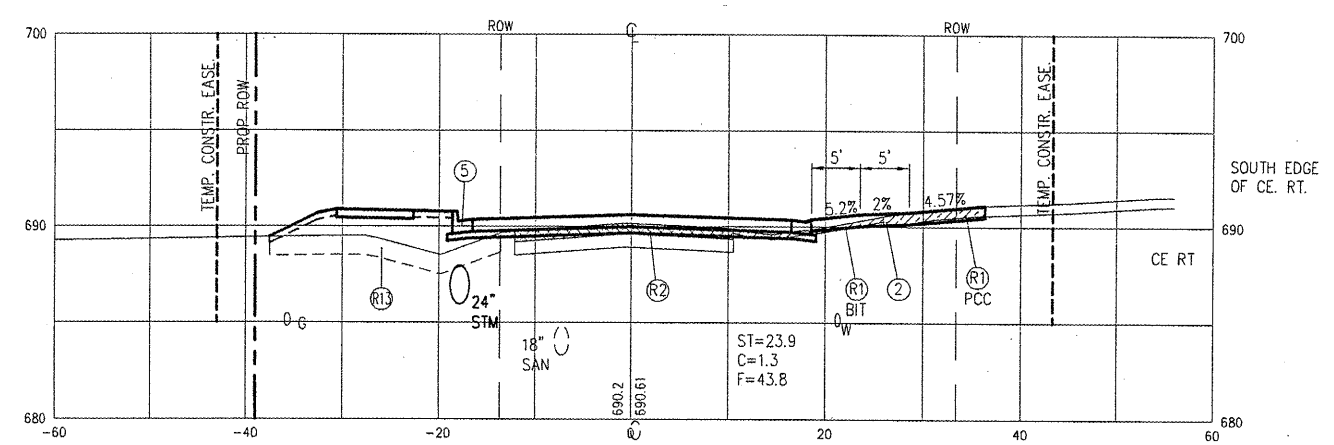

320+50

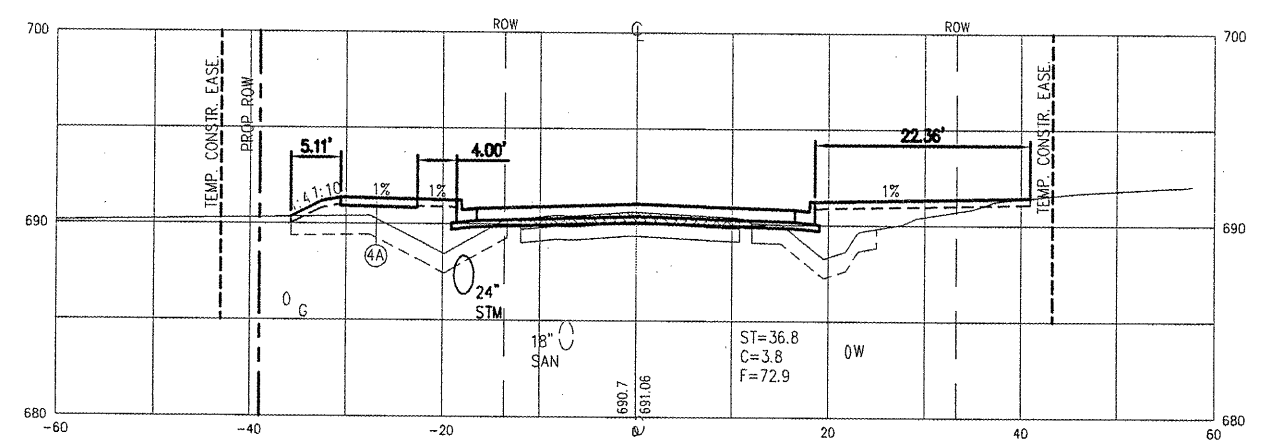

319+50

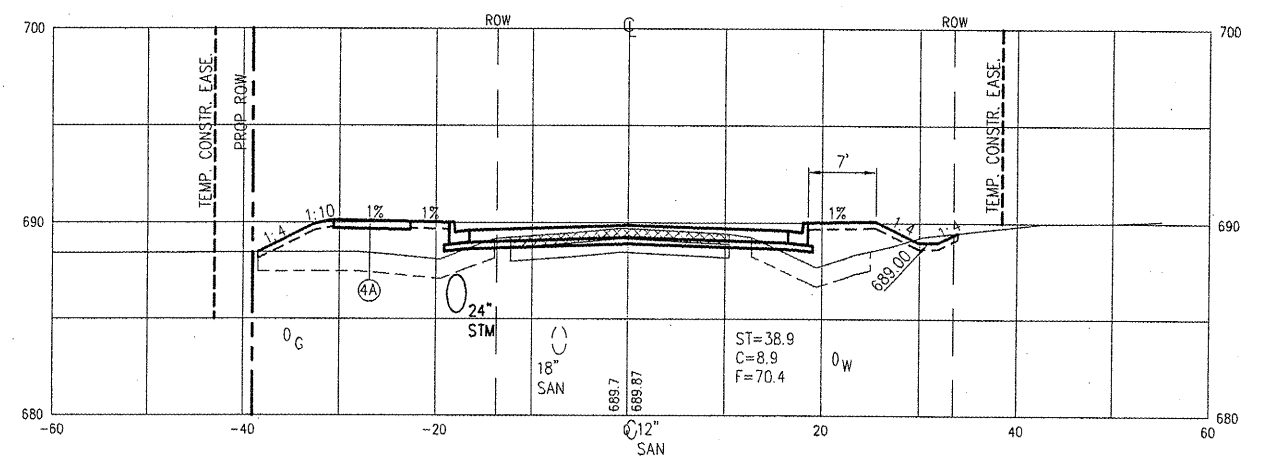

320+34

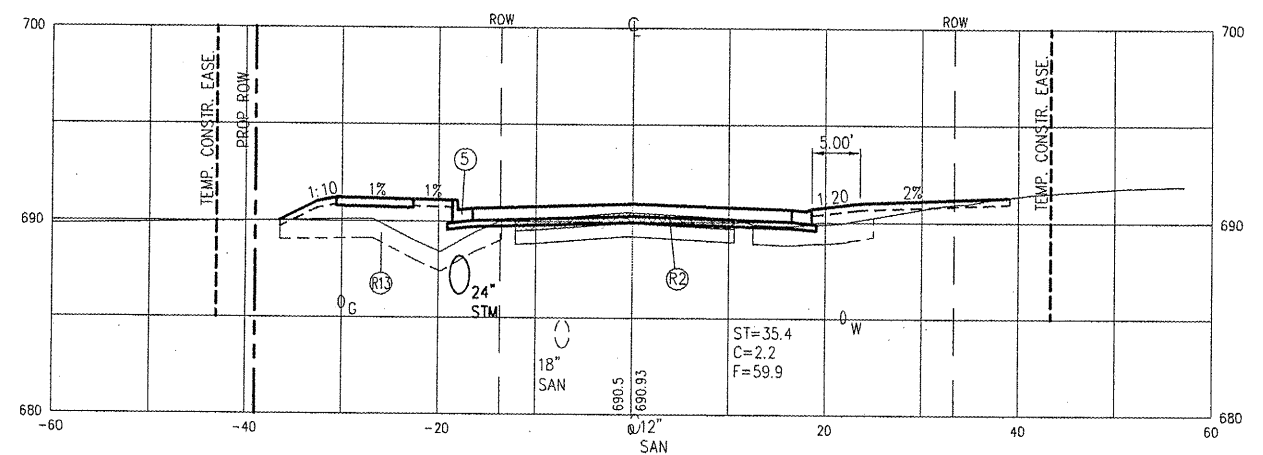

PLOTTING SCALE: 1" = 10'
 DRAWN BY: TAB
 CHECKED BY: JAR
 DATE: OCTOBER 2008

NO.	REVISIONS	DATE

WARD STREET IMPROVEMENTS
CROSS SECTIONS - STA. 319+50 TO 320+50
 CITY OF MACOMB
 SOUTH WARD ST., MACOMB, ILLINOIS
 FILE NAME: [MACOMB\WARDST\WARD-ST-2007-K-SEC FIELD BOOK No. 2257 JOB NUMBER: 03-28-08099

