

ELEVATION
 (Showing outside face of East Railing)
 (West Rail spacing similar but rotated 180°)
 See sheet 21 for Railing Details.

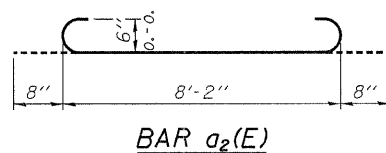

BAR a₂(E)

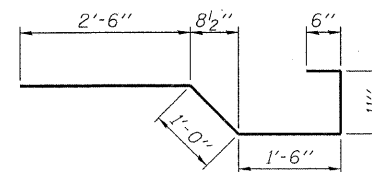

BAR x(E)

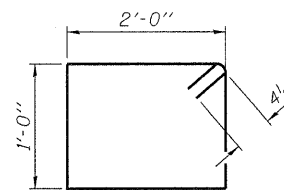

BAR s(E)

**SUPERSTRUCTURE
 BILL OF MATERIAL**

BAR	NO.	SIZE	LENGTH	SHAPE
a(E)	1,524	#5	27'-8"	—
a ₁ (E)	1,892	#6	6'-0"	—
a ₂ (E)	18	#6	9'-6"	U
a ₃ (E)	2	#6	31'-0"	—
a ₄ (E)	8	#6	31'-0"	—
b(E)	464	#5	28'-9"	—
b ₁ (E)	408	#5	27'-2"	—
b ₂ (E)	84	#6	21'-2"	—
b ₃ (E)	84	#6	24'-6"	—
b ₄ (E)	84	#6	23'-5"	—
s(E)	948	#4	6'-9"	□
x(E)	30	#5	6'-5"	L
Concrete Superstructure			Cu. Yd.	377.8
Reinforcement Bars, Epoxy Coated			Pound	100,430

See sheet 19 for additional Superstructure Details.

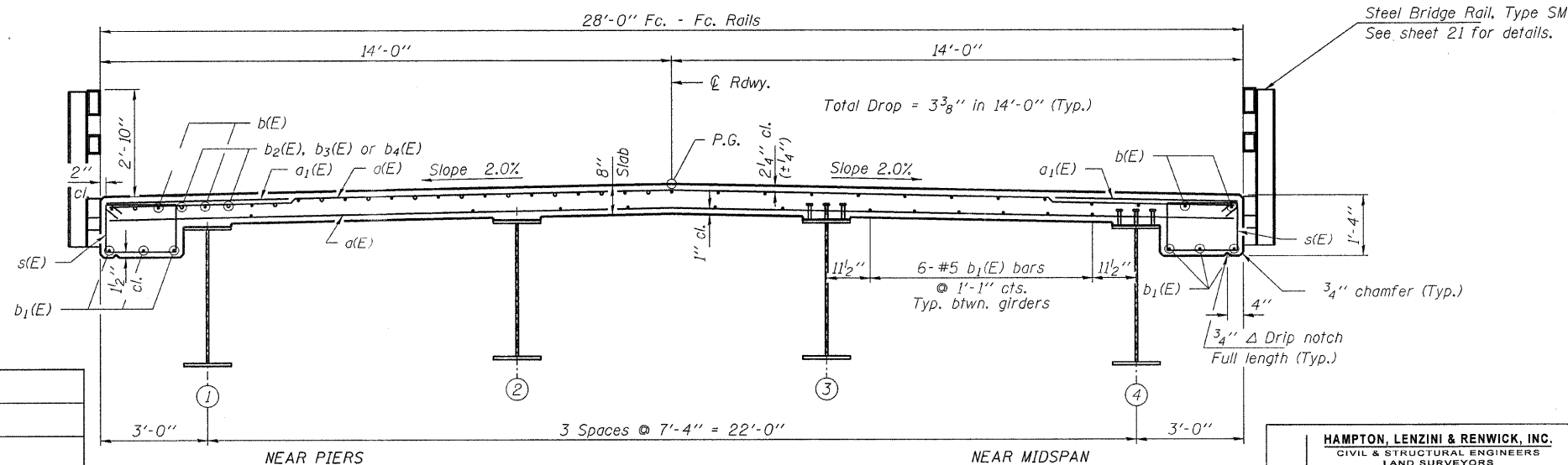

CROSS SECTION
 (Looking North)

DESIGNED - M.D.C.
CHECKED - S.M.S.
DRAWN - D.A.B.
CHECKED - M.G.B.

HAMPTON, LENZINI & RENWICK, INC.
 CIVIL & STRUCTURAL ENGINEERS
 LAND SURVEYORS
HLR
 3085 STEVENSON DRIVE, SUITE 201
 SPRINGFIELD, ILLINOIS 62703
 (217) 548-3400
 PROJECT NUMBER: 12-75-0001-1 DATE: 12/22/08

T.R.	SECTION	COUNTY	TOTAL SHEETS	SHEET NO.
154	03-06130-00-BR	PIATT	57	20
SANGAMON ROAD DISTRICT		CONTRACT NO. 91385		
FED. ROAD DIST. NO.		ILLINOIS FED. AID PROJECT		