

ROUTE NO.	SECTION	CITY	TOTAL SHEETS	SHEET NO.
STEVENS CREEK BIKEWAY	99-P4000-00-BP	DECATUR PARK DIST	145	8
FED. ROAD DIST. NO.	ILLINOIS		PROJECT TE-00D7(27)	

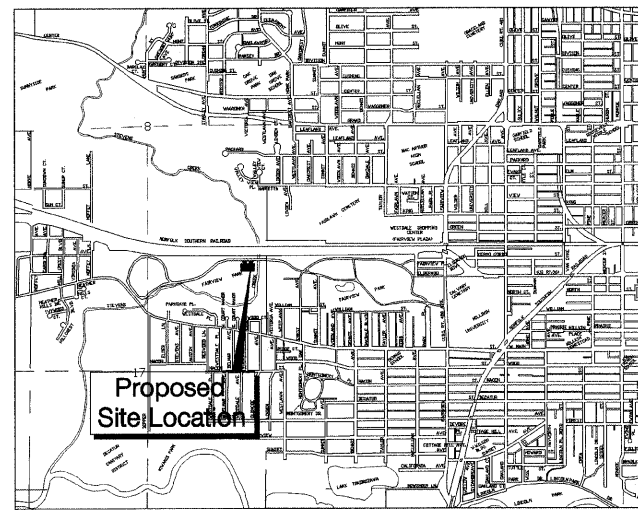

LOCATION MAP
1" = 2000'

LEGAL DESCRIPTION

That part of the East half (E.1/2) of the Northeast Quarter (N.E.1/4) of Section 17, Township 16 North, Range 2 East of the 3rd P.M. lying North of the North line of the following described tracts: Robinwood Subdivision as per plat recorded in Book 1405 on page 77 of the records in the Recorder's Office of Macon County, Illinois; AND Manor Place Addition as per plat recorded in Book 335 on page 638 in said Recorder's Office; AND Edgewood Addition as per plat recorded in Book 536 on page 28 in said Recorder's Office; AND ALSO Victoria Court as per plat recorded in Book 982 on page 92 in said Recorder's Office.



PROPERTY SITE
1" = 400'

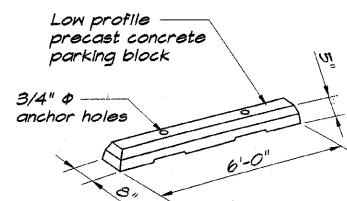
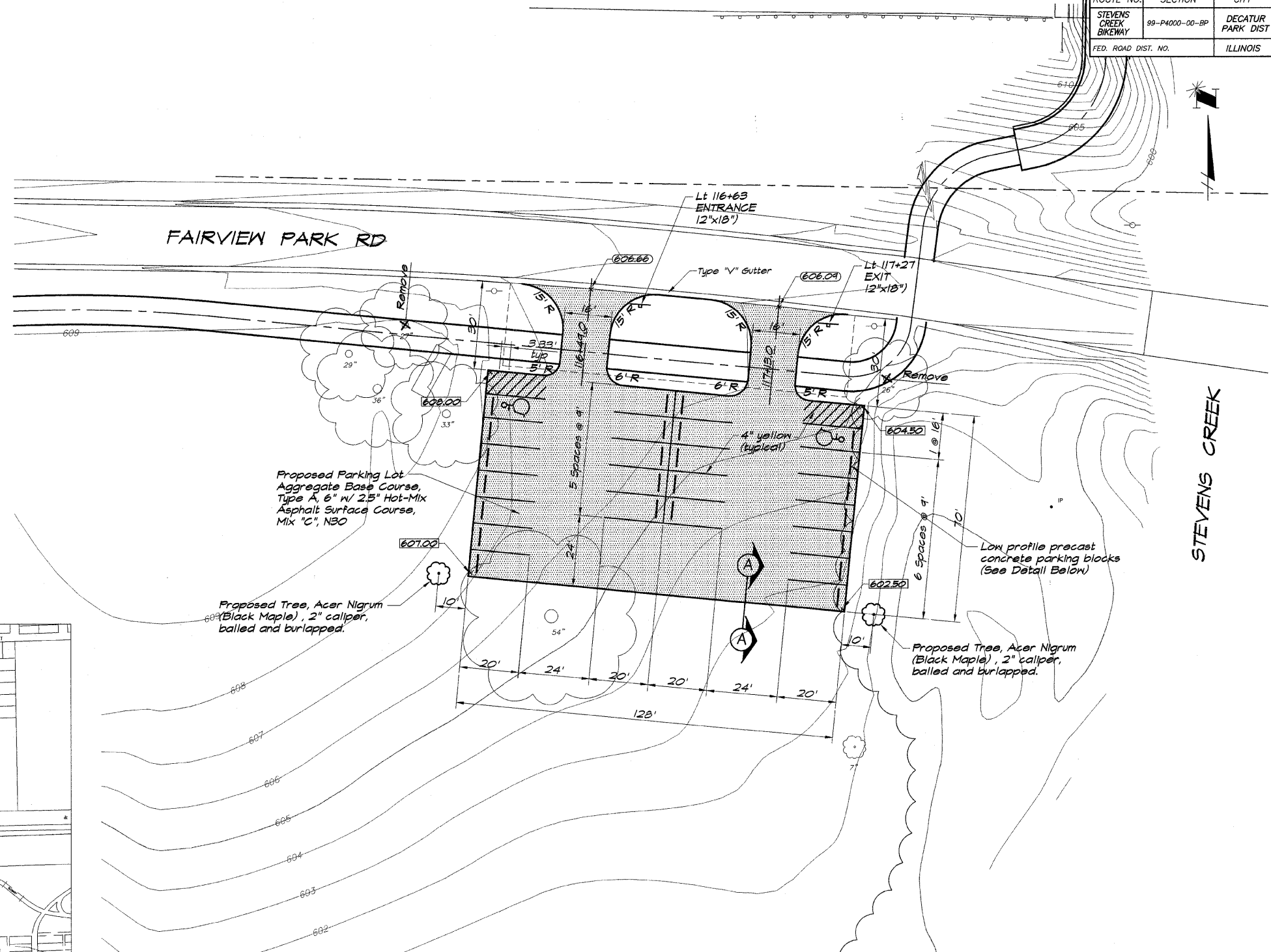

PARKING BLOCK

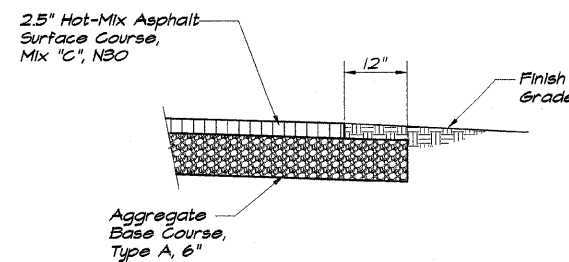

SECTION A

NOTES

- Construction and materials shall conform to IDOT "Standard Specifications for Road and Bridge Construction", January 2007.
- Accessible Parking Signs shall conform with the U.S. Department of Transportation standard RT-8 accompanied with "9200 Fine" Sign.
- Parking lot shall be 2.5" Hot-Mix Asphalt Surface Course, Mix "C", N30 with Aggregate Base Course, Type A, 6".
- Grade site to drain as shown.
- The erosion control specified in the Storm Water Pollution Prevention Plan (SWPPP) shall be in accordance with applicable IDOT Standards.
- The proposed parking lot has 11 spaces. The Zoning Ordinance requires 1.5 points per space. 11x1.5= 16.5. Therefore 17 landscaping points are required. The parking lot has less than 50 spaces, so the landscaping can be located within 10' of the perimeter of the parking lot. One Black Maple trees with point value of 18 is proposed to be planted next to the parking lot as shown. 1x18= 18.
- Landscaping shall meet the requirements of Section XXVIII of the City of Decatur's Zoning Ordinance.

BAINBRIDGE & ASSOCIATES, INC.
Consulting Engineers
GEB
MULANSKI
170 SOUTH TAYLORVILLE ROAD
DECATUR ILLINOIS 62526
Phone: 248-1228

REVISIONS	NO.	BY	DATE

DECATUR PARK DISTRICT
STEVENS CREEK BIKEWAY - PHASE I
FAIRVIEW PARK PARKING LOT
000 FAIRVIEW PARK ROAD