

ROUTE NO.	SECTION	CITY	TOTAL SHEETS	SHEET NO.
STEVENS CREEK BIKEWAY	48-P4000-00-BP	DECATUR PARK DIST	145	62
FED. ROAD DIST. NO.	ILLINOIS	PROJECT	TE-0007(27)	

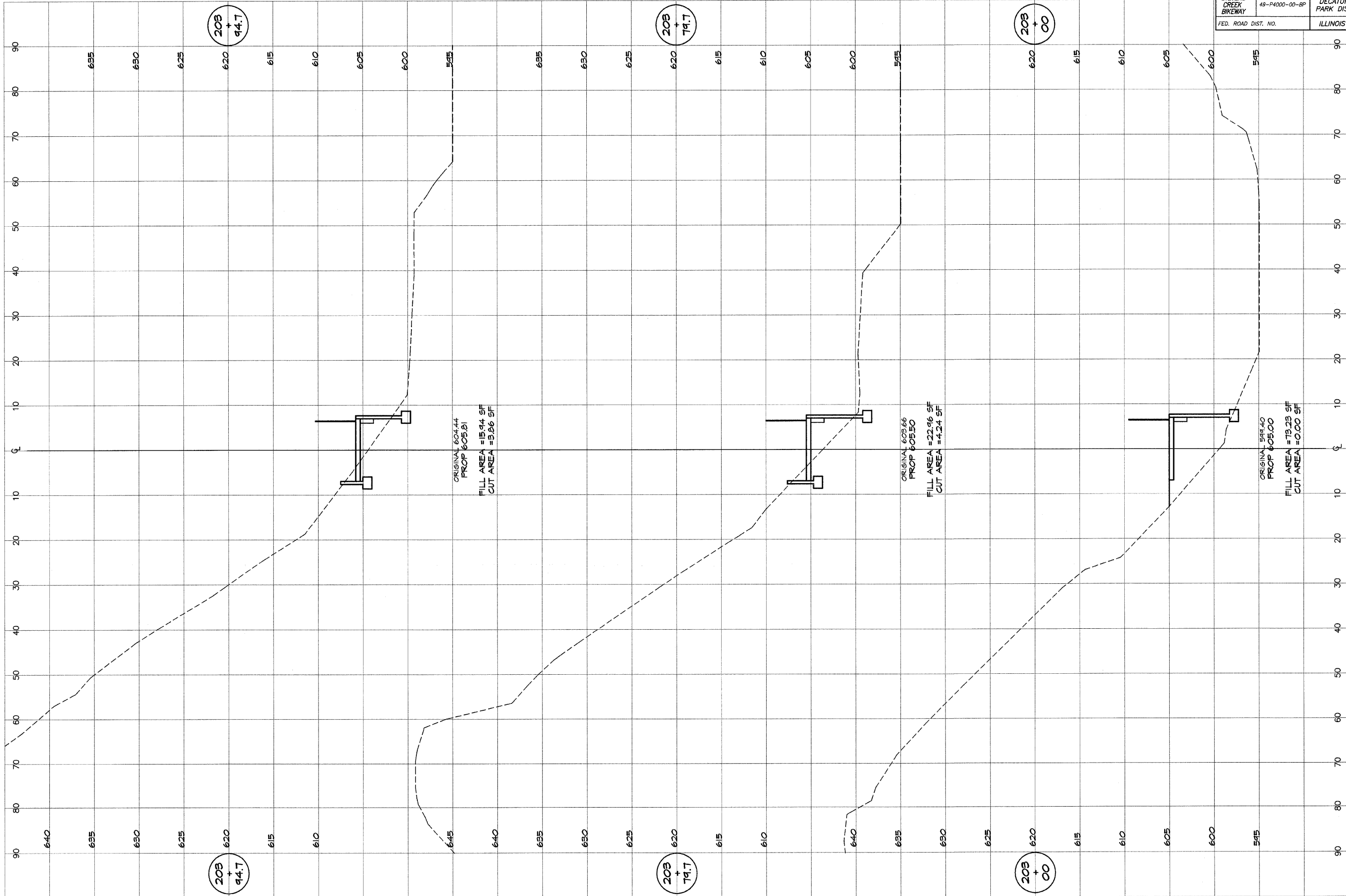

BAINBRIDGE & ASSOCIATES, INC.
GEB
 Consulting Engineers
 100 WEST TAYLOR TOWER PLAZA
 DECATUR, ILLINOIS
 60155
 License No. 184-001856

DESIGNED		SCALE		REVISIONS	
DATE	BY	DATE	NO.	NO.	DATE
1/10/04	P. Millis	as noted			
		Jan 2004			
		Job No.			
		48P0494			
		Field Book			
		XXX			

DECATUR PARK DISTRICT
STEVENS CREEK BIKEWAY - PHASE I
CROSS SECTIONS
FAIRVIEW TO CENTER