

ROUTE NO.	SECTION	CITY	TOTAL SHEETS	SHEET NO.
STEVENS CREEK BIKEWAY	99-P4000-00-BP	DECATUR PARK DIST	145	116
FED. ROAD DIST. NO.	ILLINOIS		PROJECT TE-0007(27)	

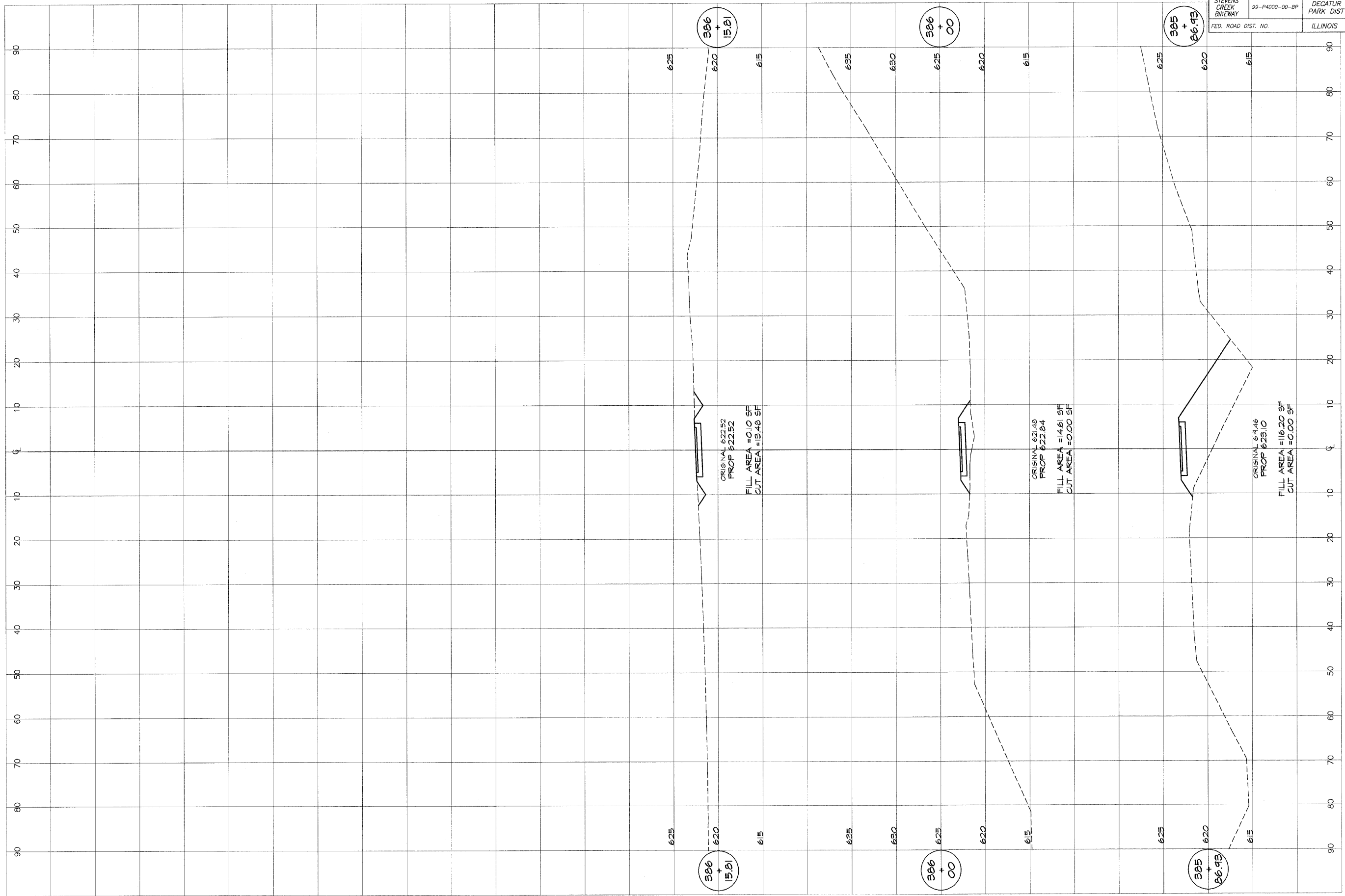

**BAINBRIDGE & ASSOCIATES, INC.**  
*Consulting Engineers*  
**GEORGE MILANSKI**  
 P.E. CIVIL ENGINEER ILLINOIS  
 1800 LEXINGTON  
 DECATUR, ILLINOIS 62521

DESIGNED	SCALE	REVISIONS
MHP	as noted	NO. BY DATE
P mls	Jan 2004	
FIELD BOOK	JOB NO. 99097	
XXX		

**DECATUR PARK DISTRICT**  
 STEVENS CREEK BIKEWAY - PHASE I  
 CROSS SECTIONS  
 SUMMIT AVENUE ACCESS