

ROUTE NO.	SECTION	CITY	TOTAL SHEETS	SHEET NO.
STEVENS CREEK BIKEWAY	49-P4000-00-BP	DECATUR PARK DIST	145	144
FED. ROAD DIST. NO.		ILLINOIS	PROJECT	TE-0007(27)

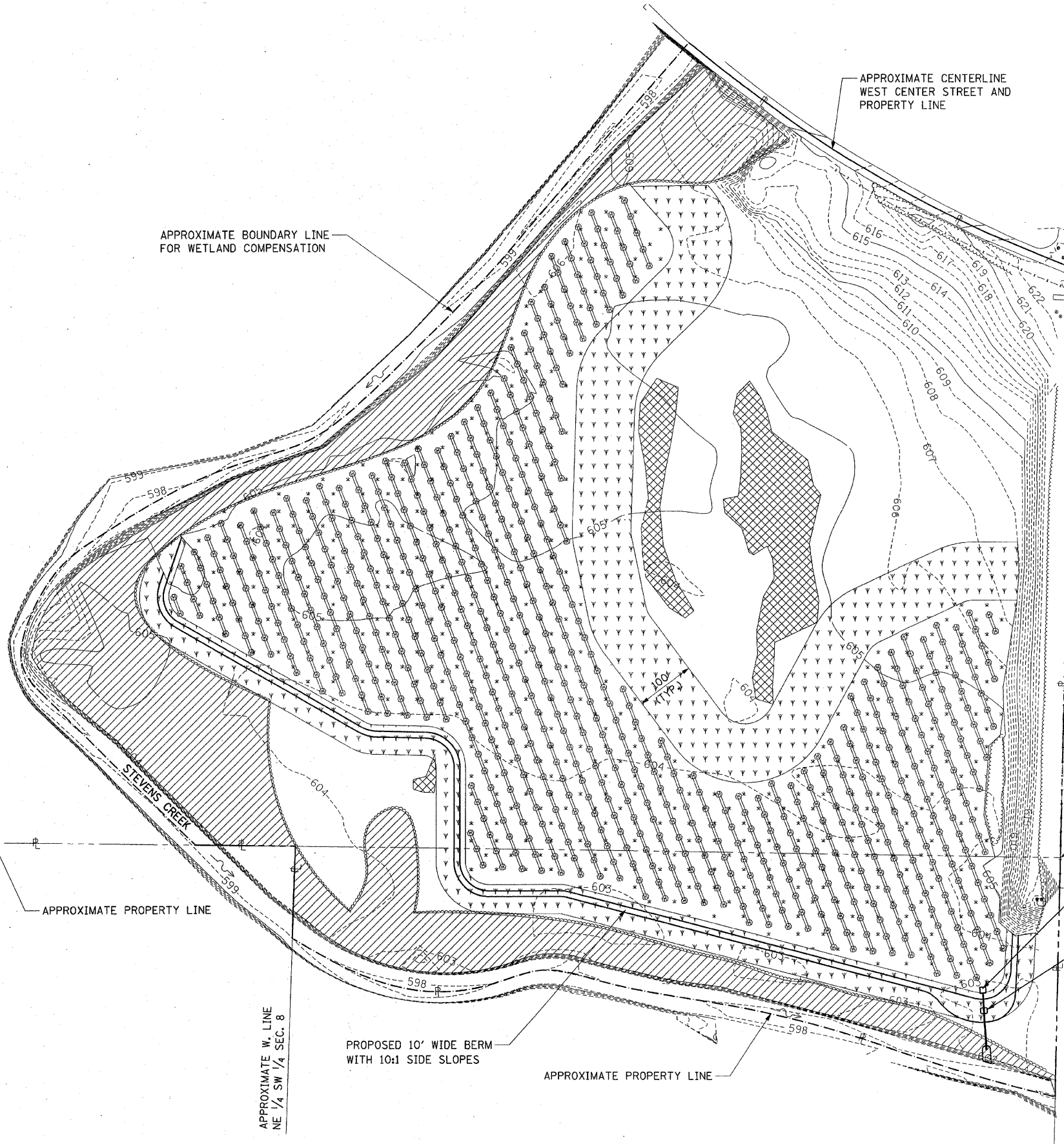

LEGEND

- 605 — EXISTING MAJOR CONTOUR
- - - 604 - - - EXISTING MINOR CONTOUR
- ZONE A UPLAND BUFFER AND BERM (6.23 acres) UPLAND HERBACEOUS AREA SEEDED WITH NATIVE GRASSLAND MIX.
- ZONE B FORESTED WETLAND (16.24 acres) PLANT THIS ZONE WITH EQUAL NUMBER OF PECAN (CARYA ILLINOENSIS), GREEN ASH (FRAXINUS PENNSYLVANICA LANCEOLATA), SHELLBARK HICKORY (CARYA LACINIOSA), SWAMP WHITE OAK (QUERCUS BICOLOR) AND PIN OAK (QUERCUS PALUSTRIS) ON 30-FOOT CENTERS USING ROOT PRODUCTION METHOD (RPM) TREES. RPM TREES ARE SOLD EXCLUSIVELY BY THE FORREST KEELING NURSERY IN ELSBERRY, MISSOURI. PHONE NUMBER (800) 356-2401. (147 EACH)
- ZONE C EXISTING WETLAND (1.41 acres) WATERS OF THE UNITED STATES. THIS ZONE SHALL NOT BE GRADED OR DISTURBED AS THIS AREA WILL REMAIN AS EMERGENT WETLAND.
- ZONE D EMERGENT WETLAND (16.24 acres) THIS AREA BETWEEN THE ROWS OF TREES (ZONE B) WILL BE ALLOWED TO NATURALLY REVEGETATE WITH EMERGENT WETLAND SPECIES.
- ZONE E FORESTED BUFFER (6.43 acres) EXISTING RIPARIAN FOREST AREA WILL BE PROTECTED FROM DISTURBANCE.
- ZONE F UNDISTURBED AREA (13.60 acres) NO CONSTRUCTION WITHIN THIS ZONE, EXCEPT OF TEMPORARY FENCE.

PROFESSIONAL ENGINEER
MICHAEL T. MATZEB
049-058471
STATE OF ILLINOIS
Michael T. MatzEB
DATE: Feb. 11, 2005
LIC. EXP. DATE: 11/30/2007

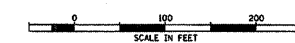

02/11/2005
R02L0085032063.ctb\sheet\wef_d001.dgn
LAYOUT
DRAWN
REVIEWED
RT 11/02/04
RT 11/02/04
RMS 11/02/04



WETLAND PLANTING PLAN

WETLAND COMPENSATION SITE
STEVENS CREEK BIKEWAY
MACON COUNTY, ILLINOIS

HANSON NO. 03S2063

FIGURE NO. 6.4