

NOTE:
 IN ADDITION TO CONTROL AS SHOWN ON SHEET 2, VERTICAL CONTROL SHALL BE VERIFIED UTILIZING A MINIMUM OF 2 EXISTING CULVERT INVERTS. EXISTING INVERTS ARE TO CULVERT INVERT, NOT SILT ELEVATION. STATIONING PROVIDED FOR REFERENCE ONLY. STATIONING DOES NOT NECESSARILY FOLLOW CENTERLINE ROADWAY.

| ROUTE NO. | SECTION | COUNTY | TOTAL SHEETS | SHEET NO. |
|---------------------|----------------|----------|--------------|-----------|
| FAS 712 (CH 24) | 05-00110-00-DR | FAYETTE | 34 | 16 |
| FEDERAL AID PROJECT | | ILLINOIS | PROJECT | |

CONTRACT NO. 95577

SE 1/4, SEC 12, T8N, R1E, 3RD P.M.

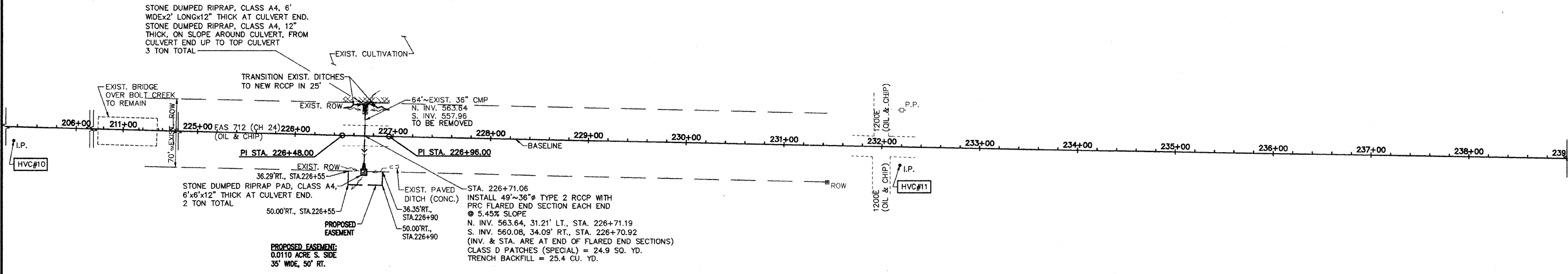

ROGER C. & PATSY K. MARTIN

NE 1/4, SEC 13, T8N, R1E, 3RD P.M.

PI STA. 226+48.00 PI STA. 226+96.00
 N 902489.34 N 902488.45
 E 787081.57 E 787129.56
 I = 00°23'06" L I = 00°02'02" L

SCALES:
 1" = 50' HOR
 1" = 5' VER

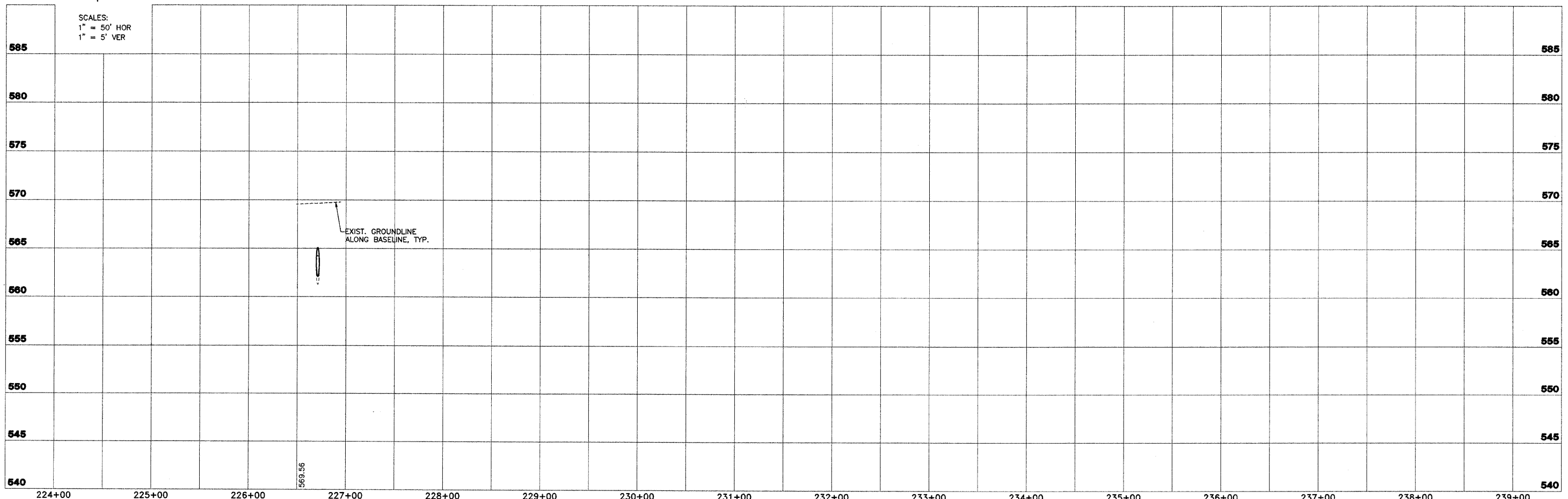

AECOM
 2524 South Broadway
 Skokie, Illinois 60077
 847.442.2000
 www.aecom.com
 Copyright © 2008
 U. S. Dept. of Transportation
 No. 184003708

FAS 712 (C.H. 24)
SECTION 05-00110-00-DR
FAYETTE COUNTY, ILLINOIS

PLAN AND PROFILE
STA. 224+00 TO STA. 239+00

| | | | |
|--------|-----|----------|-----------|
| SURVEY | JAS | CHECKED | DATE |
| DESIGN | MRQ | APPROVED | 03/25/09 |
| DRAWN | BLT | REVISOR | |
| | | JOB NO. | 200801393 |

I:\PROJECTS\050801\050801_001\050801_001_1-16.dwg