

HIGHWAY BRIDGE REPLACEMENT & REHABILITATION PROGRAM

DETAIL PLANS FOR

PROPOSED BRIDGE

T.R. 137 (SAND RIDGE ROAD) OVER LOST CREEK
 SECTION 03-10115-00-BR
 CLINTON COUNTY - MERIDIAN ROAD DISTRICT
 PROJECT: ARBROS-027-(038)
 JOB NO: C-98-341-09

ROUTE NO.	SECTION	COUNTY	TOTAL SHEETS	SHEET NO.
T.R. 137 SAND RIDGE ROAD	03-10115-00-BR	CLINTON	15	1

FEDERAL AID PROJECT BROS-027-(038)
 CONTRACT NO. 97374

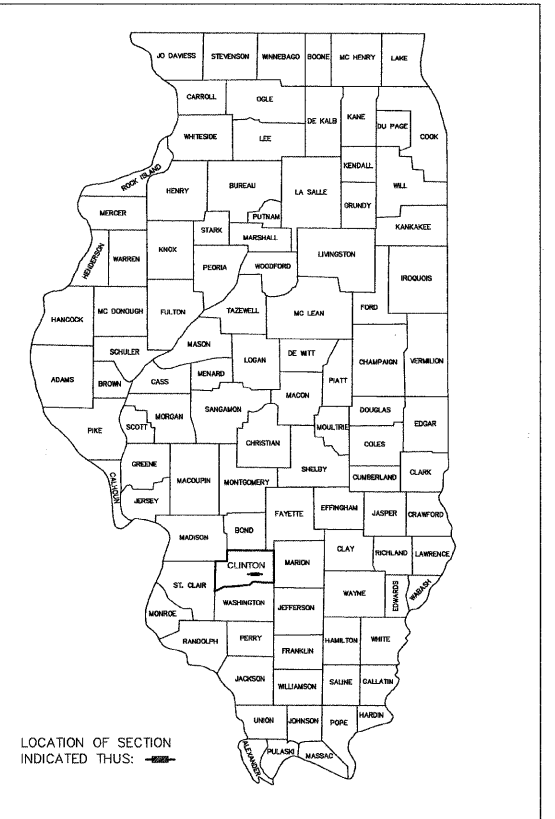

INDEX OF SHEETS

1. COVER SHEET
2. SUMMARY OF QUANTITIES AND TYPICAL CROSS SECTIONS
3. PLAN AND PROFILE OF EXISTING AND PROPOSED ROADWAY
4. GENERAL PLAN AND ELEVATION
5. P.P.C. DECK BEAM SUPERSTRUCTURE
6. 21"x48" P.P.C. DECK BEAM SPANS 1 & 3
7. 21"x48" P.P.C. DECK BEAM SPAN 2
8. 21"x48" P.P.C. DECK BEAM DETAILS
9. PILE BENT ABUTMENT
10. PILE BENT PIER
11. STEEL RAILING, TYPE S-1
12. HP PILE DETAILS
13. SOIL BORING LOGS
- 14-15. CROSS SECTIONS EXISTING AND PROPOSED ROADWAY

HIGHWAY STANDARDS

28000I-04
 51500I-03
 70190I-01
 BLR 21-7

DESIGN CLASSIFICATION

LOCAL ROAD
 CURRENT A.D.T. = 150
 DESIGN SPEED = 30 MPH
 DESIGN A.D.T. = 150 (2009)

PROJECT LOCATION

PROPOSED STRUCTURE NO. 014-4055 @ STATION 19+95.
 TRIPLE SPAN PRECAST PRESTRESSED CONCRETE DECK BEAMS, (21" DEPTH) ON SPILL THRU PILE BENT ABUTMENTS AND PILE BENT PIERS MEASURING 131'- 10 5/8" BACK TO BACK OF ABUTMENTS WITH 28'-0" CLEAR ROADWAY WIDTH.

BEGIN CONSTRUCTION STA. 17+00
 END CONSTRUCTION STA. 22+85

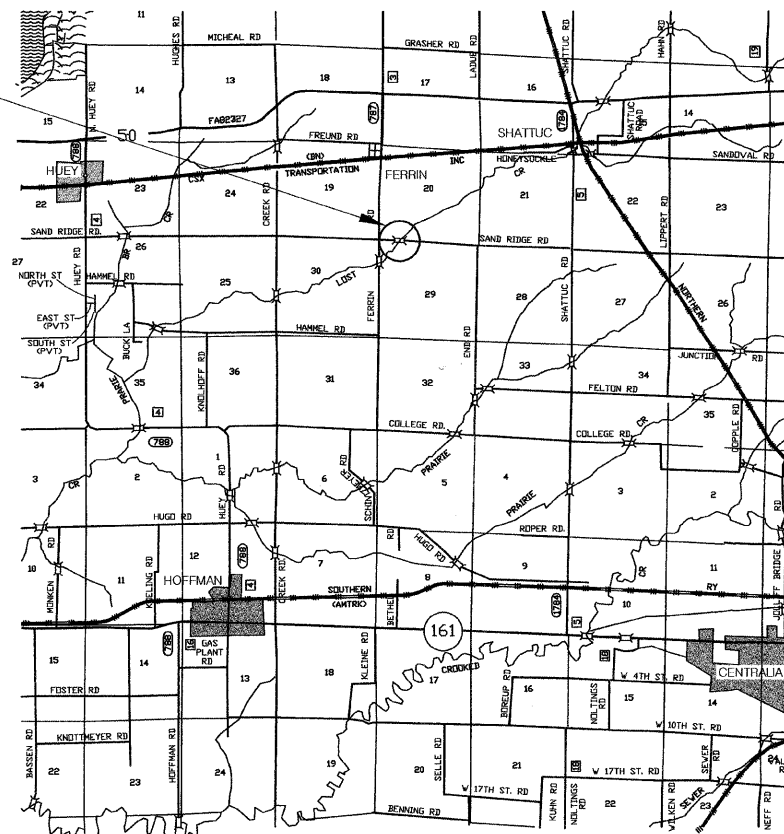

LOCATION MAP

NET LENGTH OF PROJECT = 585 FEET OR 0.11 MILES

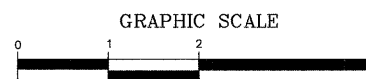

1 INCH = 1 MILE

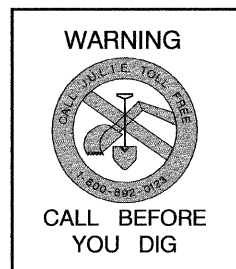

UTILITIES:

CALL J.U.L.I.E. BEFORE YOU DIG
 800-892-0123

ELECTRIC:

AMEREN IP
 2610 BROADWAY
 MT. VERNON, IL. 62864
 PHONE: 1-800-755-5000

TELEPHONE:

FRONTIER COMMUNICATIONS
 801 W. JACKSON ST.
 ALTAMONT, IL. 62411
 PHONE: (618)483-6205

WATER:

HOFFMAN RURAL WATER
 924 CODY RD.
 CENTRALIA, IL. 62801
 PHONE: (618)532-8569

FIBER OPTIC CABLE

AT&T
 210 N. LOCUST ST.
 CENTRALIA, IL. 62801
 PHONE: (618)533-3418



Daniel L. Behrens DATE *3-12-09*
 COUNTY ENGINEER
 ILLINOIS P.E. # 62-050860 EXPIRES 11/30/2009

ILLINOIS DEPARTMENT OF TRANSPORTATION	
APPROVED	<i>March 12, 2009</i> <i>Daniel L. Behrens</i> CLINTON COUNTY, COUNTY ENGINEER
APPROVED	<i>March 12, 2009</i> <i>Robert K. Kennell</i> MERIDIAN ROAD DISTRICT HIGHWAY COMMISSIONER
PASSED	<i>3/18, 2009</i> <i>[Signature]</i> DISTRICT 8 ENGINEER OF LOCAL ROADS & STREETS
RELEASING FOR BID BASED ON LIMITED REVIEW	<i>3/18, 2009</i> <i>Wendy C. Lewis</i> DEPUTY DIRECTOR OF HIGHWAYS, REGION 5 ENGINEER