

ROUTE NO.	SECTION	COUNTY	TOTAL SHEETS	SHEET
T.R. 137 SAND RIDGE ROAD	03-10115-00-BR	CLINTON	15	15
CONTRACT NO. 97374				

PLAN
 SURVEYED _____
 PLOTTED _____
 ALIGNMENT CHECKED _____
 RT. OF WAY CHECKED _____
 NO. _____ BY _____

PROFILE
 SURVEYED _____
 PLOTTED _____
 GRADES CHECKED _____
 IN _____
 STRUCTURE NOTATIONS CHKO
 NO. _____ BY _____

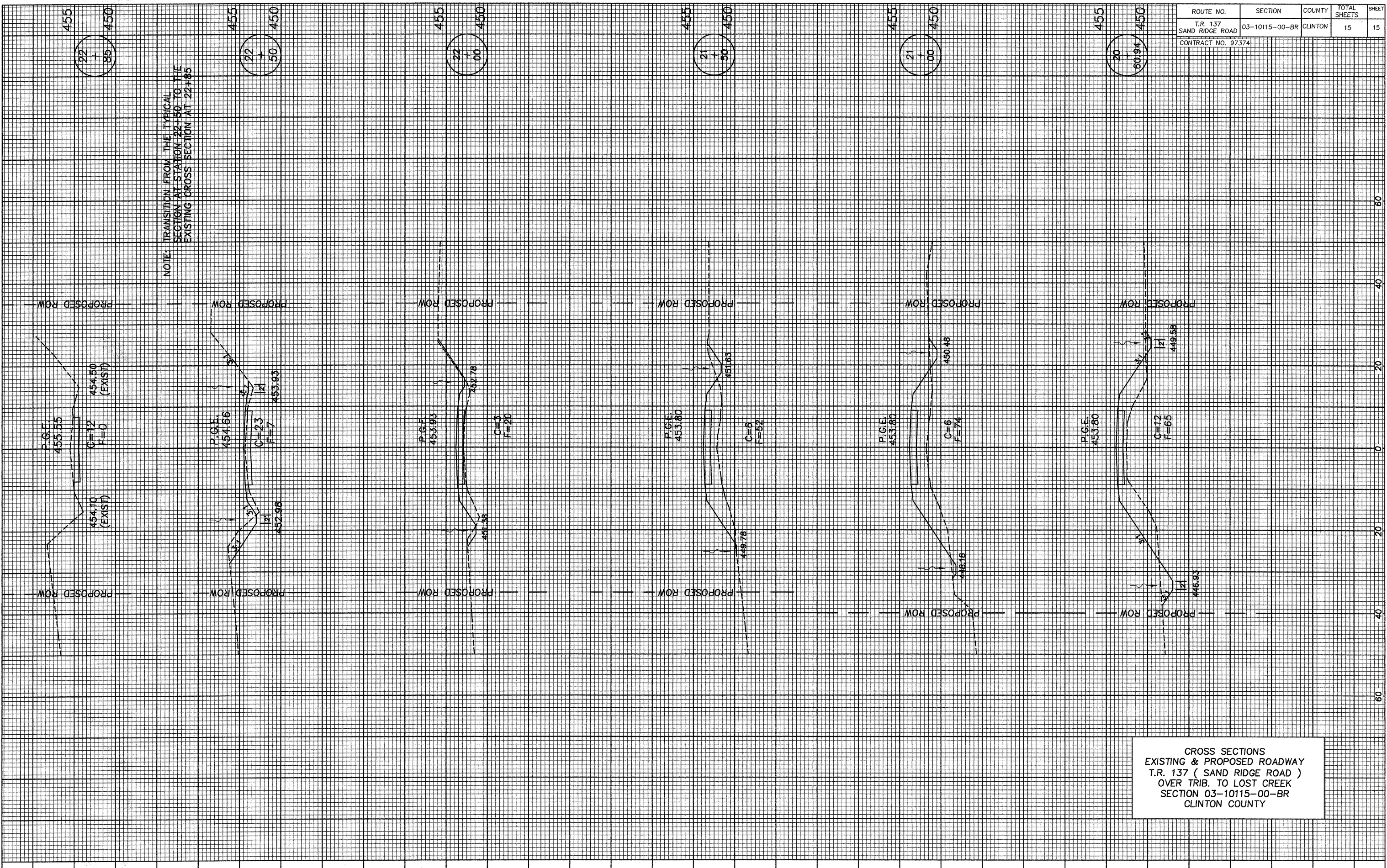

NOTE: TRANSITION FROM THE TYPICAL SECTION AT STATION 22+50 TO THE EXISTING CROSS SECTION AT 22+85

CROSS SECTIONS
 EXISTING & PROPOSED ROADWAY
 T.R. 137 (SAND RIDGE ROAD)
 OVER TRIB. TO LOST CREEK
 SECTION 03-10115-00-BR
 CLINTON COUNTY