

ROUTE	SECTION	COUNTY	TOTAL SHEETS	SHEET NO.
TR 80	00-01198-00-BR	MASSAC	13	8
PROJECT NO. BROS-127(19)			CONTRACT NO. 99354	

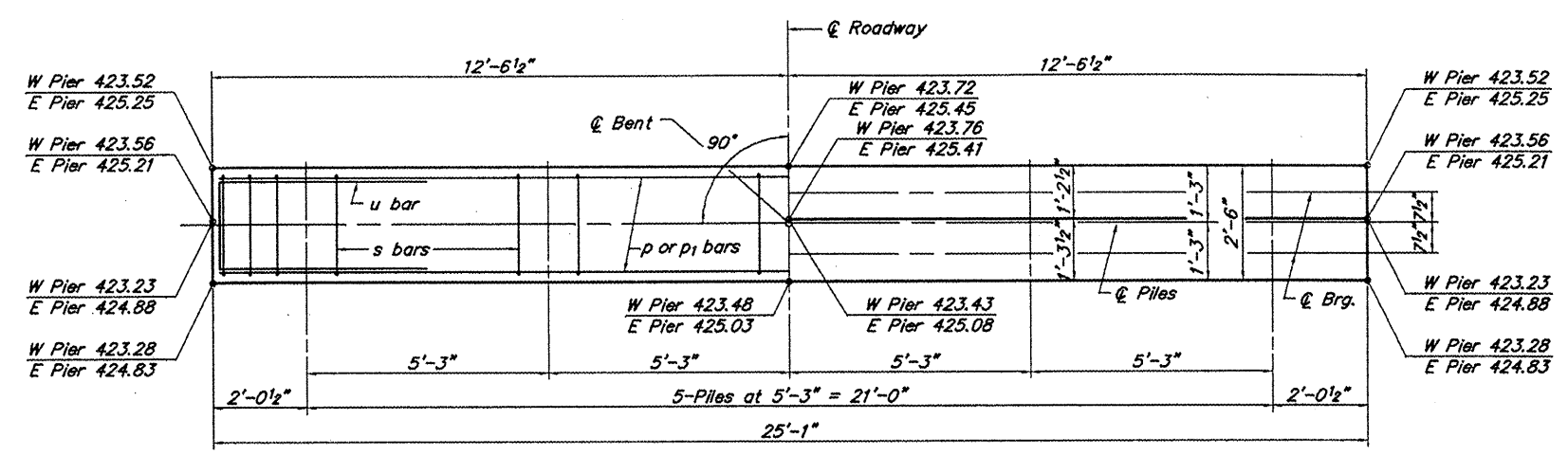

PLAN

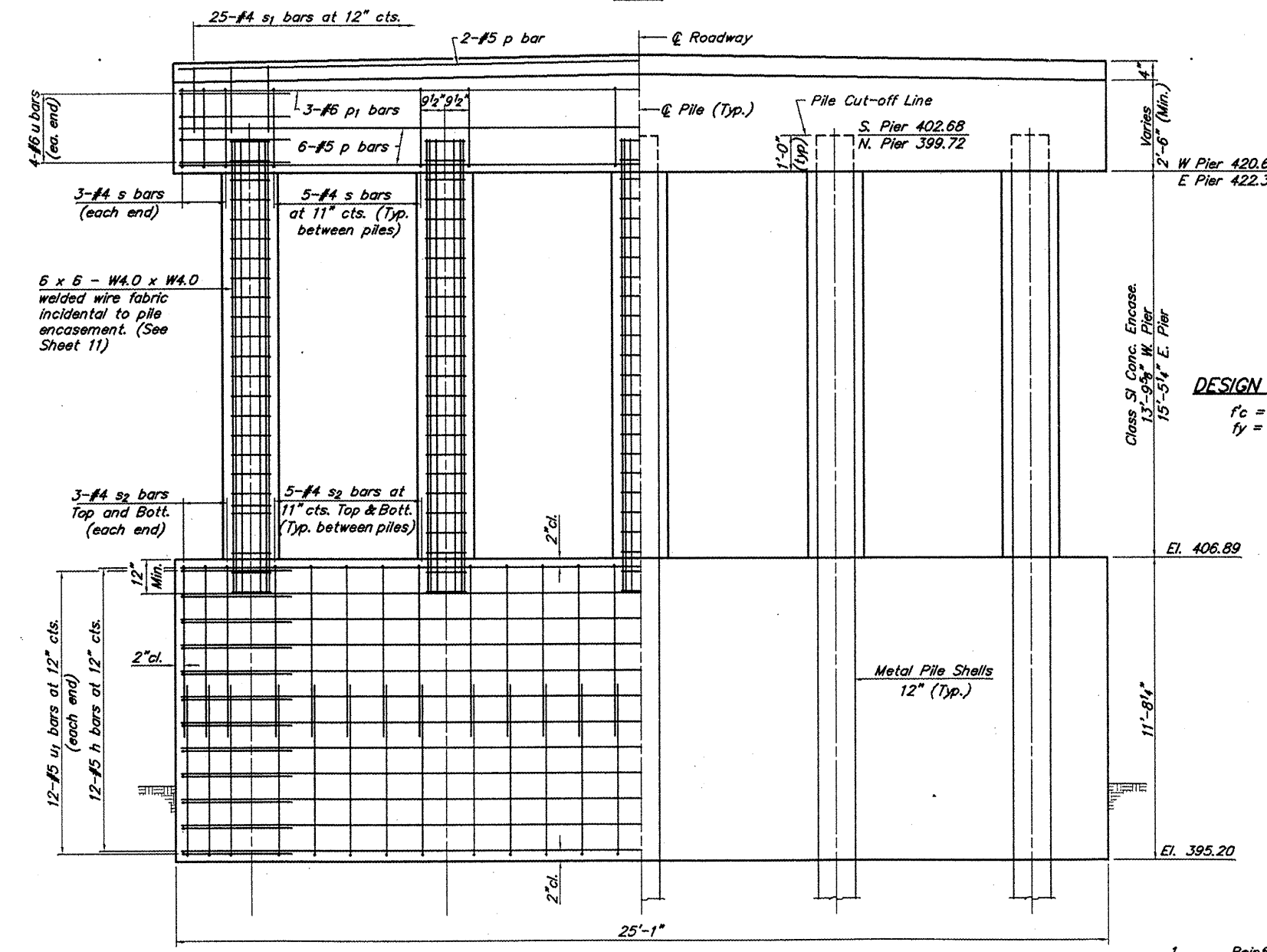

ELEVATION

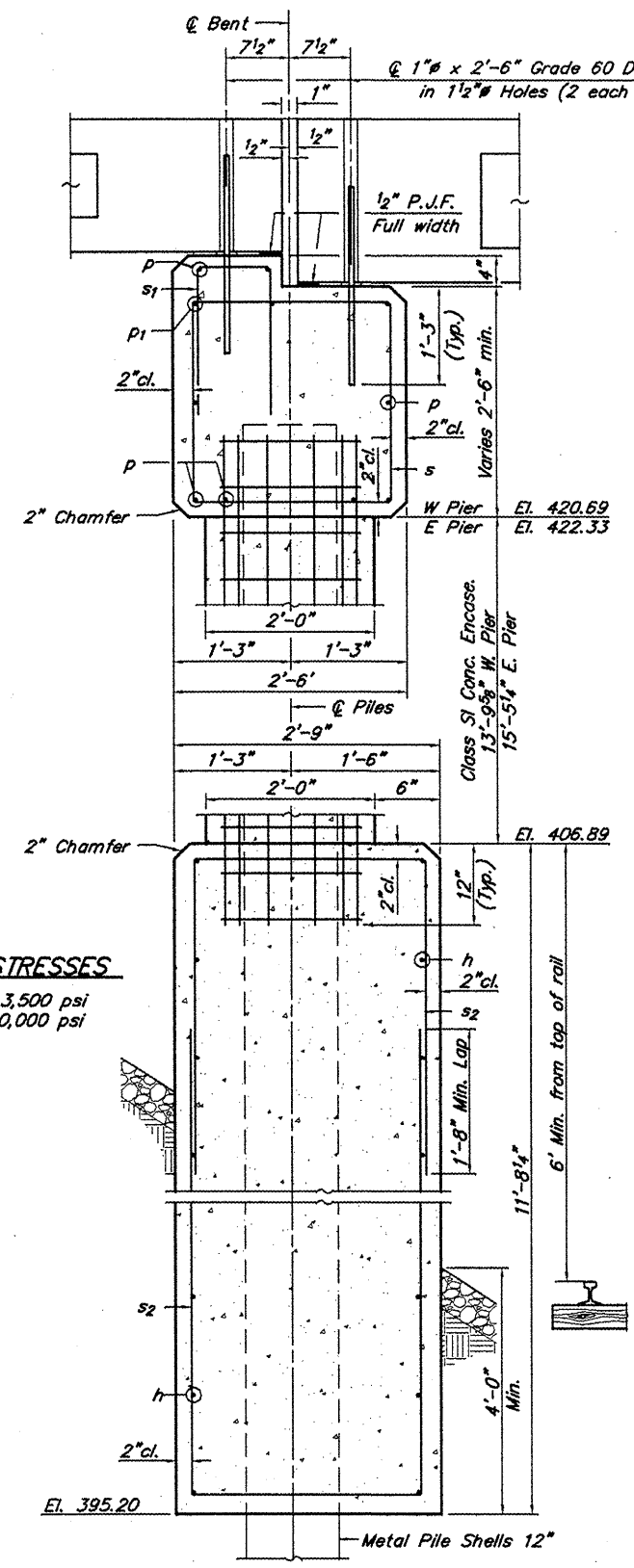

SECTION THRU ABUT.  
(At Right Angles)

**DESIGN STRESSES**  
 $f_c = 3,500 \text{ psi}$   
 $f_y = 60,000 \text{ psi}$

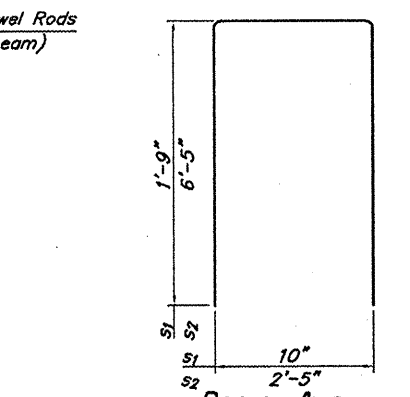

Bar s1 & s2

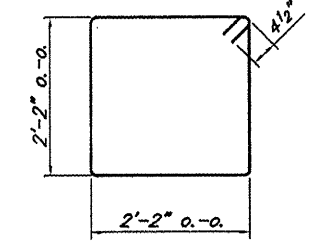

Bar s

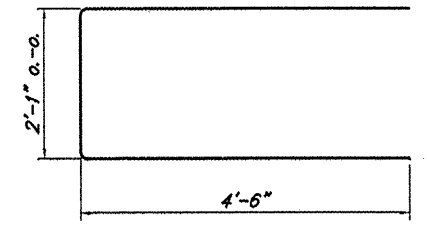

Bar u & u1

**BILL OF MATERIALS FOR ONE PIER**

Bar	No.	Size	Length	Shape
h	24	#5	24'-9"	—
p	8	#5	24'-9"	—
p1	3	#6	24'-9"	—
s	26	#4	9'-5"	□
s1	25	#4	4'-4"	□
s2	52	#5	15'-3"	□
u	8	#6	11'-1"	—
u1	24	#5	11'-1"	—
Concrete Structures			34.7	Cu. Yds.
Reinforcement Bars			2412	Lbs.

**CLASS SI CONCRETE ENCASEMENT**

West Pier	East Pier	Total
6.0	6.7	12.7
		Cu. Yds.

PIERS  
 CN/IC RAILROAD  
 SECTION 00-01198-00-BR  
 MASSAC COUNTY

- NOTES**
- Reinforcement bars shall conform to A.A.S.H.T.O. M-31, M-42 or M-53, Grade 60.
  - Nominal 1 1/4" joint at @ Pier shall be filled with non-shrink grout to top.