

STATE OF ILLINOIS
DEPARTMENT OF TRANSPORTATION
DIVISION OF HIGHWAYS

F.A. ROUTE NO.	SECTION	COUNTY	TOTAL SHEETS	SHEET NO.
6950	14-00089-00-RS	KANE	11	1

ILLINOIS PROJECT
CONTRACT NO. : 61B68

INDEX OF SHEETS

NO.	TITLE
1	COVER SHEET
2	GENERAL NOTES & SUMMARY OF QUANTITIES
3	TYPICAL SECTIONS
4-6	PLAN SHEETS
7-11	DISTRICT ONE STANDARD DETAILS

HIGHWAY STANDARD

NO.	DESCRIPTION
000001-06	STANDARD SYMBOLS, ABBREVIATIONS AND PATTERNS
424001-08	PERPENDICULAR CURB RAMPS FOR SIDEWALKS
424016-02	MID-BLOCK CURB RAMPS FOR SIDEWALKS
442201-03	CLASS C AND D PATCHES
606001-06	CONCRETE CURB TYPE B AND COMINATION CONCRETE CURB AND GUTTER
701006-05	OFF-RD OPERATIONS, 2L, 2W, 15' TO 24' FROM PAVEMENT EDGE
701301-04	LANE CLOSURE, 2L, 2W, SHORT TIME OPERATIONS
701311-03	LANE CLOSURE, 2L, 2W, MOVING OPERATIONS DAY ONLY
701701-09	URBAN LANE CLOSURE, MULTILANE INTERSECTION
701501-06	URBAN LANE CLOSURE, 2L, 2W, UNDIVIDED
701502-06	URBAN LANE CLOSURE, 2L, 2W, WITH BIDIRECTIONAL LEFT TURN LANE
701801-05	SIDEWALK CORNER OR SIDEWALK CLOSURE
701901-04	TRAFFIC CONTROL DEVICES
780001-05	TYPICAL PAVEMENT MARKINGS

TRAFFIC DATA:

SLEEPY HOLLOW ROAD
ADT (YEAR) = 4,952 (2013)
SPEED LIMIT = 35 MPH
CLASSIFICATION = MINOR COLLECTOR

MILLER ROAD
ADT (YEAR) = 2810 (2010)
SPEED LIMIT = 35 MPH
CLASSIFICATION = MINOR COLLECTOR

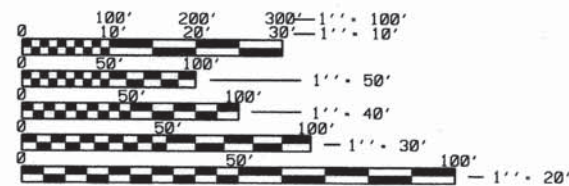

FULL SIZE PLANS HAVE BEEN PREPARED USING STANDARD ENGINEERING SCALES. REDUCED SIZED PLANS WILL NOT CONFORM TO STANDARD SCALES. IN MAKING MEASUREMENTS ON REDUCED PLANS, THE ABOVE SCALES MAY BE USED.

J.U.L.I.E. JOINT UTILITY LOCATION INFORMATION FOR EXCAVATION 1-800-892-0123 OR 811	
COUNTY:	KANE
TOWNSHIP:	DUNDEE
VILLAGE:	CARPENTERSVILLE
SECTION:	N/W QUARTER SECTION 16, & S/E QUARTER SECTION 8

PROJECT ENGINEER: E. J. S.
PROJECT MANAGER: E. J. S.

CONTRACT NO. : 61B68

PLANS FOR PROPOSED
FEDERAL AID HIGHWAY

FAU6950 (SLEEPY HOLLOW ROAD) &
FAU 1279 (MILLER ROAD)
VILLAGE LIMITS TO GRANDVIEW DRIVE &
SHENANDOAH DRIVE TO VILLAGE LIMITS
RESURFACING
SECTION NO.: 14-00089-00-RS
PROJECT NO: M-4003(442)
VILLAGE OF CARPENTERSVILLE
KANE COUNTY
C-91-163-15

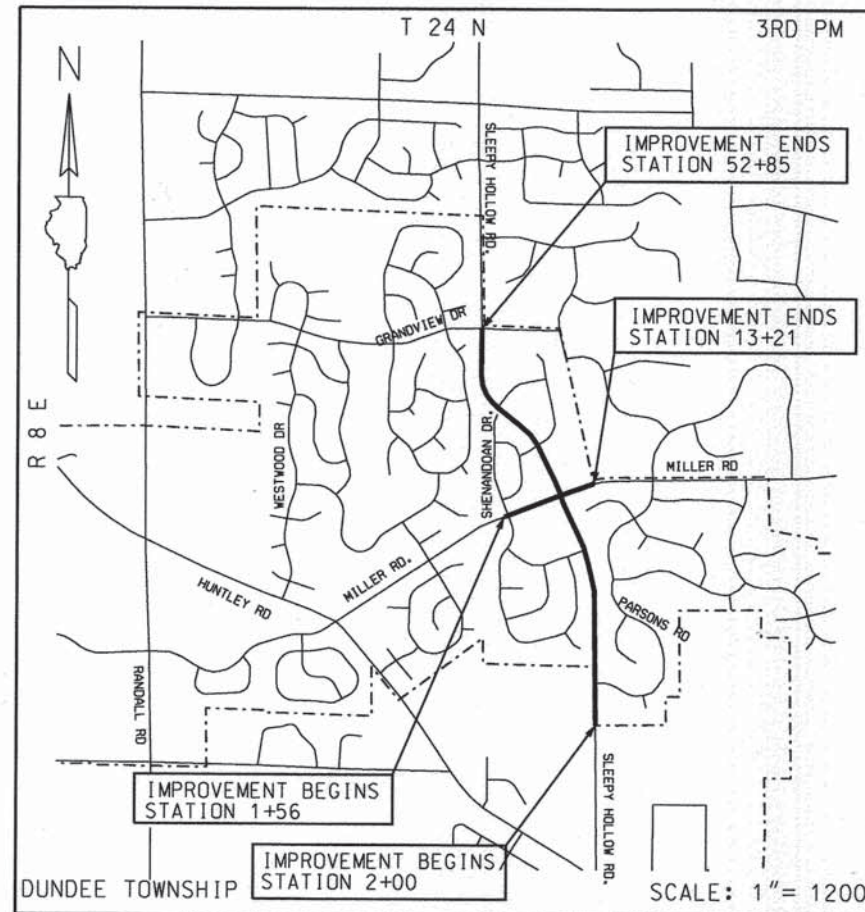

GROSS LENGTH OF IMPROVEMENT = 6,262 FEET OR 1.19 MILES
NET LENGTH OF IMPROVEMENT = 6,262 FEET OR 1.19 MILES

PLANS PREPARED BY:

THE VILLAGE OF CARPENTERSVILLE
ENGINEERING DIVISION
1200 L.W. BESINGER DRIVE
CARPENTERSVILLE, ILLINOIS 60110
224-293-1637

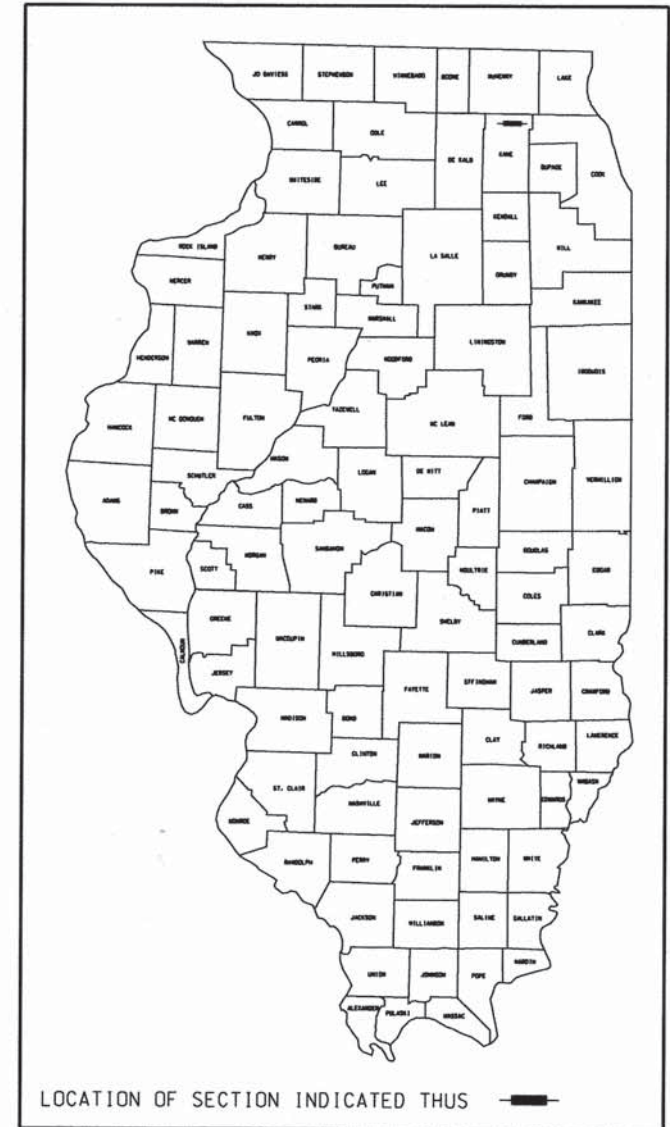

STATE OF ILLINOIS
DEPARTMENT OF TRANSPORTATION
DIVISION OF HIGHWAYS

APPROVED 3-25-2015
Ed Ritter
VILLAGE OF CARPENTERSVILLE
ED RITTER, VILLAGE PRESIDENT

PASSED APRIL 1, 2015
Christopher Holt
CHRISTOPHER HOLT
DISTRICT 1 ENGINEER OF LOCAL ROADS & STREETS

RELEASED FOR BID
BASED ON LIMITED REVIEW APRIL 1, 2015
John Kathan
DEPUTY DIRECTOR OF HIGHWAYS, REGION 1 ENGINEER

PROFESSIONAL ENGINEER'S SIGN & SEAL

Kevin R. Gray, PE
EXPIRES: NOVEMBER 30, 2015

PRINTED BY THE AUTHORITY
OF THE STATE OF ILLINOIS

FEDERAL AID PROGRAM : FAWAD AQUEEL, PE 847-705-4021 SCHAUMBURG, IL.

GENERAL NOTES

ALL CONSTRUCTION SHALL BE DONE IN ACCORDANCE WITH THE "STANDARD SPECIFICATIONS FOR ROAD AND BRIDGE CONSTRUCTION", ADOPTED JANUARY 1, 2012; THE "SUPPLEMENTAL SPECIFICATIONS AND RECURRING SPECIAL PROVISIONS", ADOPTED JANUARY 1, 2015; THE LATEST EDITION OF THE "ILLINOIS MANUAL ON UNIFORM TRAFFIC CONTROL DEVICES FOR STREETS AND HIGHWAYS" (IMUTCD); "THE STANDARD SPECIFICATIONS FOR WATER AND SEWER MAIN CONSTRUCTION IN ILLINOIS" JULY 2009 6TH EDITION; THE "DETAILS" IN THE PLANS. LATEST EDITION OF THE MANUAL OF TEST PROCEDURE OF MATERIALS; THE AMERICAN WITH DISABILITIES ACT OF 1990 ACCESSIBILITY GUIDELINES; THE "DRAFT" REHABILITATION ACT OF 1973 (SECTION 504) THE PUBLIC RIGHTS-OF-WAY ACCESSIBILITY GUIDELINES AND THE "SPECIAL PROVISIONS" INCLUDED IN THE CONTRACT DOCUMENTS.

THE CONTRACTOR SHALL BE RESPONSIBLE FOR CONTACTING THE OWNERS OF ALL EXISTING FACILITIES SO THAT THE UTILITIES AND THEIR APPURTENANCES MAY BE LOCATED AND ADJUSTED OR MOVED IF NECESSARY. PRIOR TO THE START OF CONSTRUCTION OPERATIONS, THE CONTRACTOR SHALL COOPERATE WITH ALL UTILITY OWNERS AS PROVIDED FOR IN THE STANDARD SPECIFICATIONS.

THE LOCATIONS OF EXISTING DRAINAGE STRUCTURES, STORM AND SANITARY SEWERS, WATER SERVICE LINES AND OTHER UTILITY LINES ARE APPROXIMATE, AND THE ENGINEER DOES NOT GUARANTEE THEIR ACCURACY. THEIR EXACT HORIZONTAL AND VERTICAL LOCATIONS ARE TO BE DETERMINED IN THE FIELD BY THE CONTRACTOR AT HIS OWN EXPENSE.

THE CONTRACTOR SHALL BE RESPONSIBLE FOR THE PROTECTION OF ALL UNDERGROUND OR SURFACE UTILITIES EVEN THOUGH THEY MAY NOT BE SHOWN ON THE PLANS. ANY UTILITY THAT IS DAMAGED DURING CONSTRUCTION SHALL BE REPAIRED OR REPLACED TO THE SATISFACTION OF THE ENGINEER. THIS WORK SHALL BE AT THE CONTRACTOR'S EXPENSE.

COORDINATION OF ALL WORK INVOLVED IN THE CONSTRUCTION AREA WILL BE DISCUSSED AT THE PRECONSTRUCTION CONFERENCE. BEFORE STARTING ANY EXCAVATION, THE CONTRACTOR SHALL CALL "JULIE" AT 811 OR 800-892-1123 FOR FIELD LOCATIONS OF BURIED ELECTRIC, TELEPHONE, GAS AND CABLE TELEVISION FACILITIES. (96 HOURS NOTIFICATION IS REQUIRED.)

THE ENGINEER SHALL PROTECT AND CAREFULLY PRESERVE ALL SECTION OR SUBSECTION MONUMENTS, PROPERTY PINS, REFERENCE MARKERS.

ALL RADII FOR PROPOSED CURB AND GUTTER ARE TO THE BACK OF CURB UNLESS OTHERWISE NOTED AND SHALL BE AS INDICATED ON THE PLANS. NO ELEVATIONS ARE SHOWN ON THE PROPOSED PLANS. CONTRACTOR SHALL MAINTAIN GRADE BETWEEN EXISTING POINTS.

THE ENGINEER WILL PROVIDE HORIZONTAL CONTROL AND CONSTRUCTION LAYOUT FOR THIS WORK. THIS WILL CONSIST OF MARKING ALL PAVEMENT REMOVAL, CURB AND GUTTER REMOVAL, SIDEWALK REMOVAL, PANEL PLACEMENT AND PAVEMENT MARKINGS.

WHENEVER DURING CONSTRUCTION OPERATIONS ANY LOOSE MATERIAL IS DEPOSITED IN THE FLOW LINE OF DRAINAGE STRUCTURES SUCH THAT THE NATURAL FLOW OF WATER IS OBSTRUCTED, IT SHALL BE REMOVED AT THE CLOSE OF EACH WORKING DAY. AT THE CONCLUSION OF CONSTRUCTION OPERATIONS, ALL UTILITY STRUCTURES SHALL BE FREE FROM DIRT AND DEBRIS. THE WORK SPECIFIED ABOVE WILL NOT BE PAID FOR SEPARATELY BUT SHALL BE INCLUDED IN THE COST THE CONTRACT.

ANY EXISTING WATER MAINS OR SANITARY OR STORM SEWERS DAMAGED BY THE CONTRACTOR DURING CONSTRUCTION SHALL BE REPAIRED BY THE CONTRACTOR AT NO COST.

THE CONTRACTOR SHALL NOT OPEN OR SHUT ANY WATER VALVES OR FIRE HYDRANTS WITHOUT PRIOR AUTHORIZATION FROM THE VILLAGE OF CARPENTERSVILLE ENGINEERING DEPARTMENT OR WATER DIVISION. UNAUTHORIZED USE SHALL SUBJECT THE OFFENDER TO ARREST AND PROSECUTION.

THE CONTRACTOR SHALL PROVIDE ACCESS TO ADJUTING PROPERTY AT ALL TIMES DURING THE CONSTRUCTION OF THIS PROJECT, EXCEPT FOR PERIODS OF SHORT DURATION. THE COST TO PROVIDE ACCESS SHALL BE INCLUDED IN THE COST OF THE CONTRACT.

IT SHALL BE THE CONTRACTOR'S RESPONSIBILITY TO VERIFY ALL EXISTING DIMENSIONS AND CONDITIONS IN THE FIELD PRIOR TO ORDERING MATERIALS AND BEGINNING CONSTRUCTION.

ALL SAW CUTTING SHALL BE INCLUDED IN COST OF REMOVAL ITEMS AND SHALL BE PERFORMED PRIOR TO BEGINNING REMOVAL. ANY ITEMS OF WORK REMOVED PRIOR TO SAW CUTTING WILL NOT BE MEASURED FOR PAYMENT.

THE THICKNESSES OF HOT-MIX ASPHALT MIXTURES, SHOWN IN THE PLANS, ARE NOMINAL. DEVIATIONS MAY OCCUR DUE TO IRREGULARITIES IN THE SURFACES OR BASIS ON WHICH THEY ARE TO BE PLACED. PLAN THICKNESSES SHOULD BE CONSIDERED THE MINIMUM THICKNESS PERMITTED.

DETECTABLE WARNINGS MEETING ADA REQUIREMENTS SHALL BE INSTALLED AT ALL INTERSECTING STREETS AND COMMERCIAL DRIVEWAYS AS DIRECTED BY THE ENGINEER. *SEE IDOT STANDARD 424001-07 INCLUDED IN THE SPECIFICATIONS*. CONTRACTOR SHALL VERIFY THAT ALL SLOPES MEET ADA REQUIREMENTS PRIOR TO INSTALLING SIDEWALK DETECTABLE WARNINGS AND ADJACENT CURB AND GUTTER PAVEMENT GRADES.

PROPOSED CONCRETE CURB AND GUTTER SHALL BE TRANSITIONED TO EXISTING CURB AND GUTTER OVER A LENGTH OF 6 FEET. THIS WORK SHALL BE PAID FOR AT THE CONTRACT UNIT PRICE PER FOOT FOR COMBINATION CONCRETE CURB AND GUTTER REMOVAL AND REPLACEMENT.

ALL CONCRETE AND LANDSCAPE RESTORATION WORK MUST BE COMPLETE BEFORE THE HMA SURFACE COURSE IS PLACED.

SUMMARY OF QUANTITIES

CODE NO.	ITEM	UNIT	TOTAL QUANT.
			0005
40600275	BITUMINOUS MATERIAL (PRIME COAT)	POUND	10065
40600400	MIXTURE FOR CRACK, JOINTS, AND FLANGWAYS	TON	25
40600982	HOT MIX ASPHALT SURFACE REMOVAL - BUTT JOINT	50 YD	780
40603335	HOT MIX ASPHALT SURFACE COURSE, MIX D, N50	TON	2790
42400200	PORTLAND CEMENT CONCRETE SIDEWALK 5 INCH	50 FT	1700
42400800	DETECTABLE WARNINGS	50 FT	360
44000157	HOT MIX ASPHALT SURFACE REMOVAL, 2"	50 YD	24395
44000500	COMBINATION CURB AND GUTTER REMOVAL	FOOT	950
44000600	SIDEWALK REMOVAL	50 FT	1700
44201713	CLASS D PATCHES, TYPE I, 6 INCH	50 YD	475
44201717	CLASS D PATCHES, TYPE II, 6 INCH	50 YD	475
44201721	CLASS D PATCHES, TYPE III, 6 INCH	50 YD	625
44201723	CLASS D PATCHES, TYPE IV, 6 INCH	50 YD	725
44300100	AREA REFLECTIVE CRACK CONTROL TREATMENT	50 YD	24395
60603800	COMBINATION CURB AND GUTTER, TYPE B-6.12	FOOT	950
60255500	MANHOLES TO BE ADJUSTED	EACH	14
67100100	MOBILIZATION	L SUM	1
78000100	THERMOPLASTIC PAVEMENT MARKING - LETTERS AND SYMBOLS	50 FT	850
78000200	THERMOPLASTIC PAVEMENT MARKING - LINE 4"	FOOT	33100
78000400	THERMOPLASTIC PAVEMENT MARKING - LINE 6"	FOOT	8200
78000600	THERMOPLASTIC PAVEMENT MARKING - LINE 12"	FOOT	3300
78000650	THERMOPLASTIC PAVEMENT MARKING - LINE 24"	FOOT	450
70102620	TRAFFIC CONTROL AND PROTECTION, STANDARD 701501	L SUM	1
70102622	TRAFFIC CONTROL AND PROTECTION, STANDARD 701502	L SUM	1
70102635	TRAFFIC CONTROL AND PROTECTION, STANDARD 701701	L SUM	1
70102640	TRAFFIC CONTROL AND PROTECTION, STANDARD 701801	L SUM	1

△
△
△
△
△

△ = DENOTES SPECIALTY ITEMS

	USER NAME = E.J.S.	DESIGNED - E.J.S.	REVISED - PER IDOT 2/25/2015	STATE OF ILLINOIS DEPARTMENT OF TRANSPORTATION	GENERAL NOTES AND SUMMARY OF QUANTITIES	F.A.U. RTE. 6950	SECTION 14-00089-00-RS	COUNTY KANE	TOTAL SHEETS 11	SHEET NO. 2		
	PLOT SCALE =	CHECKED - E.V.H.	REVISED -			SCALE: NONE	SHEET 2 OF 11 SHEETS	STA. _____ TO STA. _____	CONTRACT NO. 61868			
	PLOT DATE =	DATE - 12/10/2014	REVISED -			ILLINOIS FED. AD PROJECT						

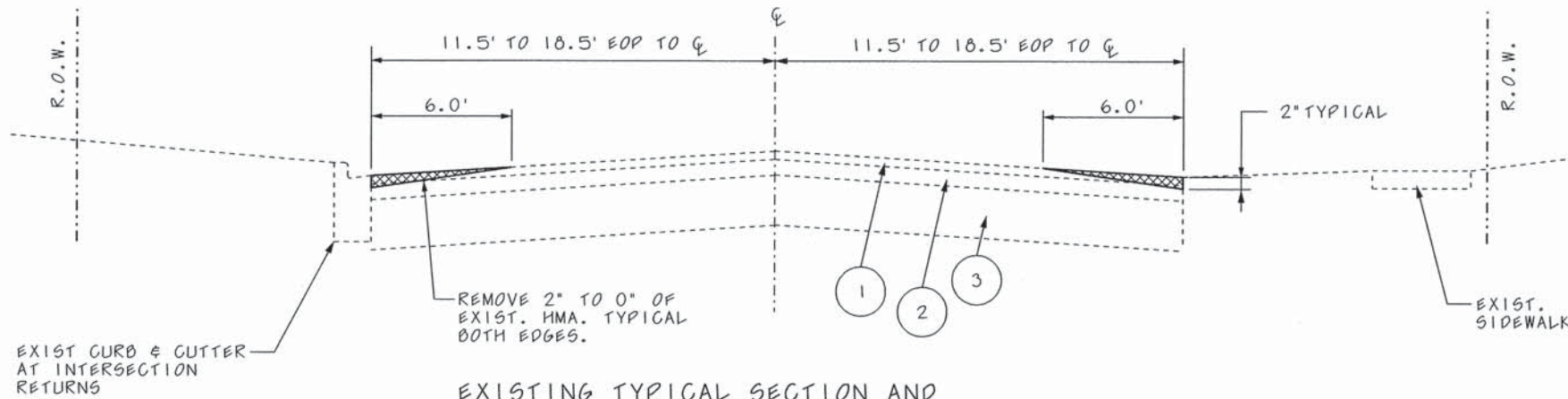

EXISTING TYPICAL SECTION AND HMA SURFACE REMOVAL, 2 INCH (SPECIAL)

STA. 2+00 TO 52+85, SLEEPY HOLLOW ROAD
 STA. 1+56 TO 13+21, MILLER ROAD NOT TO SCALE

- 1 HOT MIX ASPHALT SURFACE COURSE, 1-1/2 INCH
- 2 HOT MIX ASPHALT BINDER COURSE, 2-1/2 INCH
- 3 GRANULAR BASE COURSE, 8 INCH

PAVEMENT CORE

NO PAVEMENT CORES WERE TAKEN
 EXISTING TYPICAL SECTION DEPTHS WERE OBTAINED FROM ARCHIVED AS-BUILT FIELD DATA
 ACTUAL FIELD CONDITIONS MAY VARY.

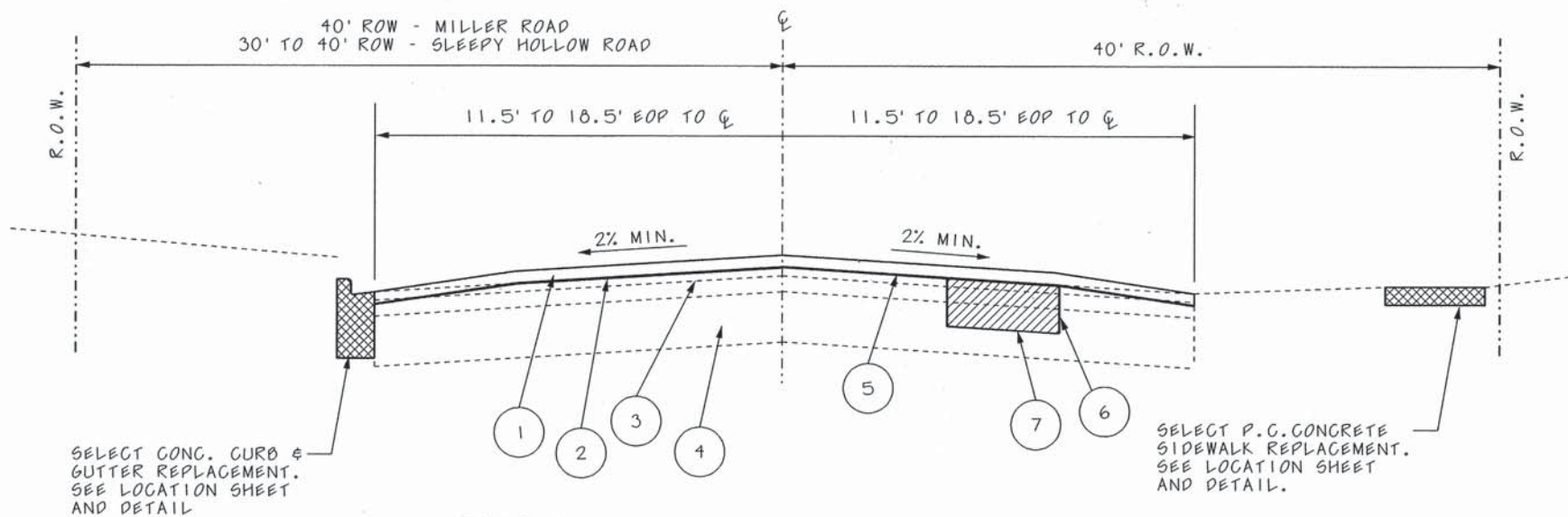

PROPOSED TYPICAL CROSS SECTION

STA. 2+00 TO 52+85, SLEEPY HOLLOW ROAD
 STA. 1+56 TO 13+21, MILLER ROAD NOT TO SCALE

- 1 HOT MIX ASPHALT SURFACE COURSE, MIX "D" N50, 2.0"
- 2 BITUMINOUS MATERIAL (PRIME COAT)
- 3 EXISTING HMA
- 4 EXISTING GRANULAR BASE COURSE
- 5 AREA REFLECTIVE CRACK CONTROL TREATMENT (SLEEPY HOLLOW ROAD ONLY)
- 6 SAW CUT FULL THICKNESS, PAID FOR UNDER CLASS D PATCHING, 6"
- 7 ASPHALT AND AGGREGATE REMOVAL AND REPLACEMENT WITH HOT MIX ASPHALT BINDER COURSE, N50. PAID FOR UNDER CLASS D PATCHING, 6"

HOT MIX ASPHALT MIXTURE REQUIREMENTS

ITEM DESCRIPTION	MIXTURE TYPE	AIR VOIDS
PAVEMENT RESURFACING	HOT MIX ASPHALT SURFACE COURSE, MIX "D", N50, 1L-19.0, N50	4% @ 50 GYR.
HMA PAVEMENT DRIVEWAY		
CLASS D PATCHING	CLASS D PATCHES (HMA BINDER 1L-19MM)	4% @ 70 GYR.

THE UNIT WEIGHT USED TO CALCULATE ALL HMA MIXTURE QUANTITIES IS 112 LBS / SOYD / INCH.

THE "AC TYPE" FOR POLYMERIZED HMA MIXES SHALL BE "SBS / SBR PG 76-22" AND FOR NON-POLYMERIZED HMA THE "AC TYPE" SHALL BE "PG 64-22" UNLESS MODIFIED BY DISTRICT ONE SPECIAL PROVISIONS.

FOR HMA FULL DEPTH "AC TYPE" SEE SPECIAL PROVISIONS.
 FOR USE OF RECYCLED MATERIAL SEE SPECIAL PROVISIONS.



USER NAME = E.J.S.	DESIGNED = E.J.S.	REVISED = PER IDOT 2/25/2015
	DRAWN = E.J.S.	REVISED =
PLOT SCALE =	CHECKED = E.V.H.	REVISED =
PLOT DATE =	DATE = 12/10/2014	REVISED =

STATE OF ILLINOIS
 DEPARTMENT OF TRANSPORTATION

TYPICAL SECTIONS

F.A.U. RTE. 6950	SECTION 14-00089-00-RS	COUNTY KANE	TOTAL SHEETS 11	SHEET NO. 3
SCALE: NONE			SHEET 3 OF 11 SHEETS	
STA. _____ TO STA. _____			ILLINOIS FED. AID PROJECT	
CONTRACT NO. 61B68				

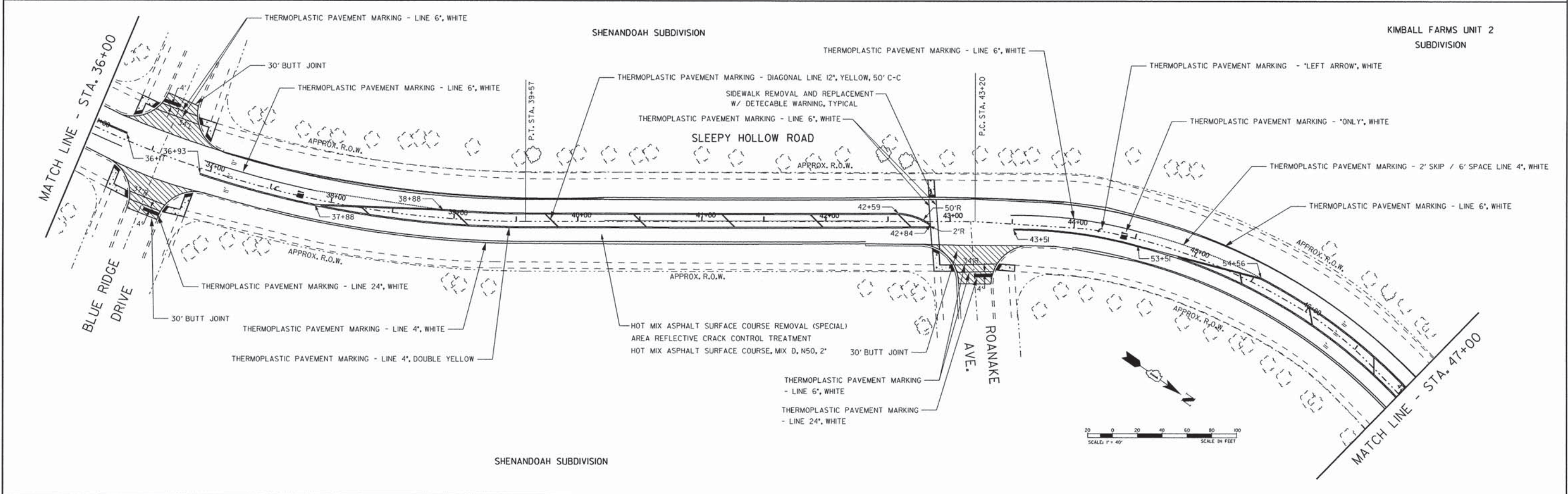
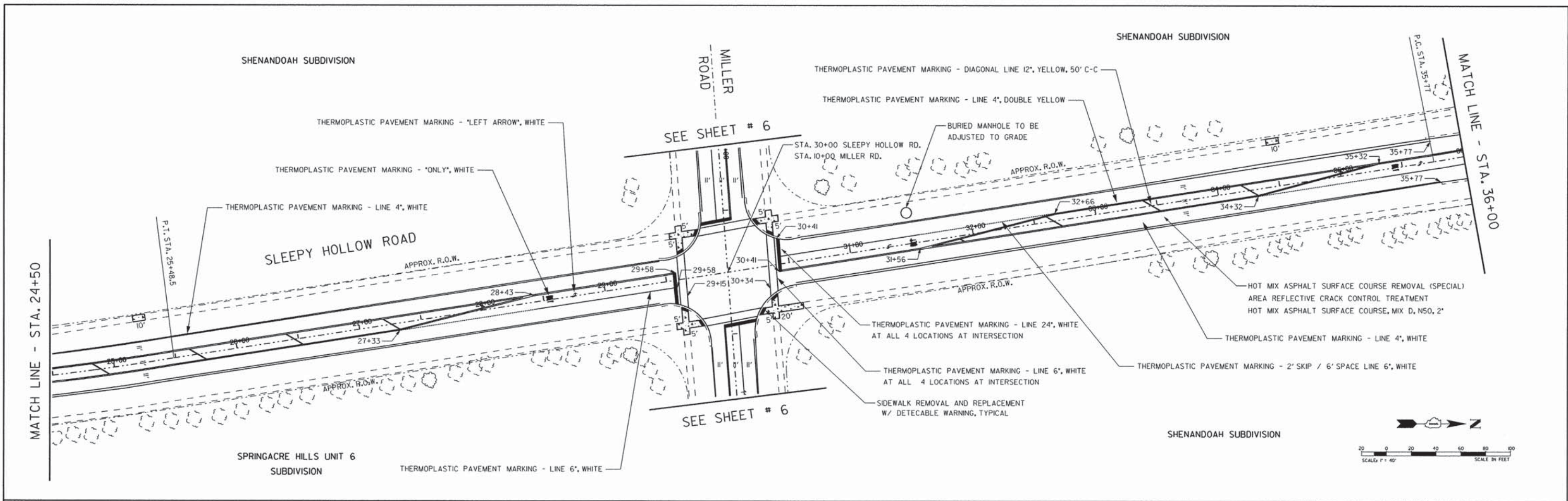

	USER NAME = E.J.S.	DESIGNED - E.J.S.	REVISED -PER IDOT - 2/26/15	STATE OF ILLINOIS DEPARTMENT OF TRANSPORTATION	PLAN SHEET	F.A.U. RTE. 6950	SECTION 14-00089-00-RS	COUNTY KANE	TOTAL SHEETS II	SHEET NO. 5			
	PLOT SCALE = 1" / 40'	CHECKED - E.V.H.	REVISED -			SCALE: 1" = 40'	SHEET 5 OF 11 SHEETS	STA. 24+50 TO STA. 47+00	CONTRACT NO. 61B68				
	PLOT DATE = #DATE#	DATE - 12/10/2014	REVISED -			ILLINOIS FED. AID PROJECT							

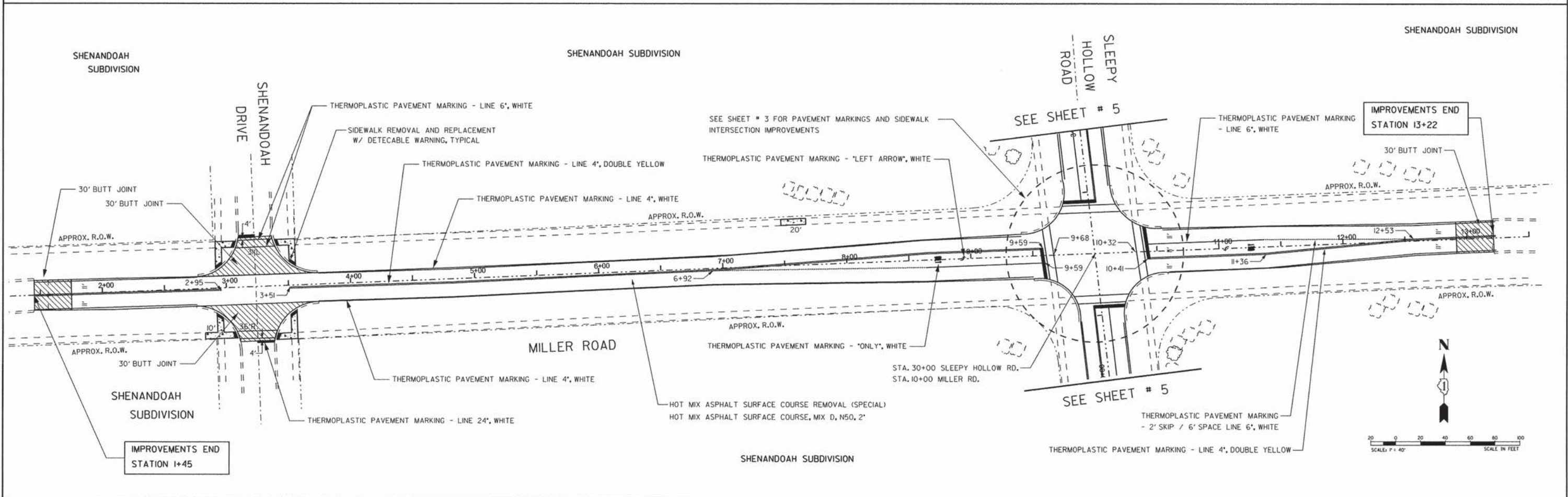
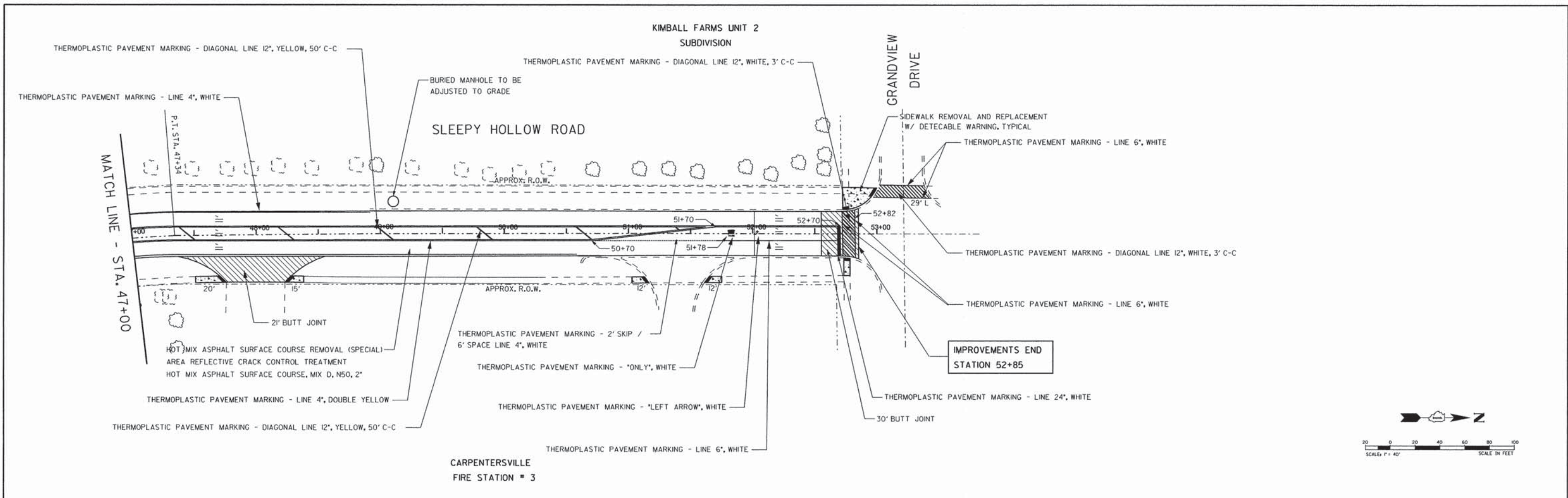

	USER NAME = E.J.S.	DESIGNED = E.J.S.	REVISED - PER IDOT - 2/26/15	STATE OF ILLINOIS DEPARTMENT OF TRANSPORTATION	PLAN SHEET	F.A.U. RTE. 695a	SECTION 14-00089-00-RS	COUNTY KANE	TOTAL SHEETS II	SHEET NO. 6			
	PLOT SCALE = 1" / 40'	DRAWN = E.J.S.	REVISED - PER IDOT - 4/7/15			SCALE: P = 40'	SHEET 6 OF 11 SHEETS	STA. 47+00 TO STA. 13+22	CONTRACT NO. 61B68				
	PLOT DATE = #DATE#	CHECKED = E.V.H.	REVISED -			ILLINOIS FED. AID PROJECT							
	DATE = 12/10/2014	DATE =	REVISED -										

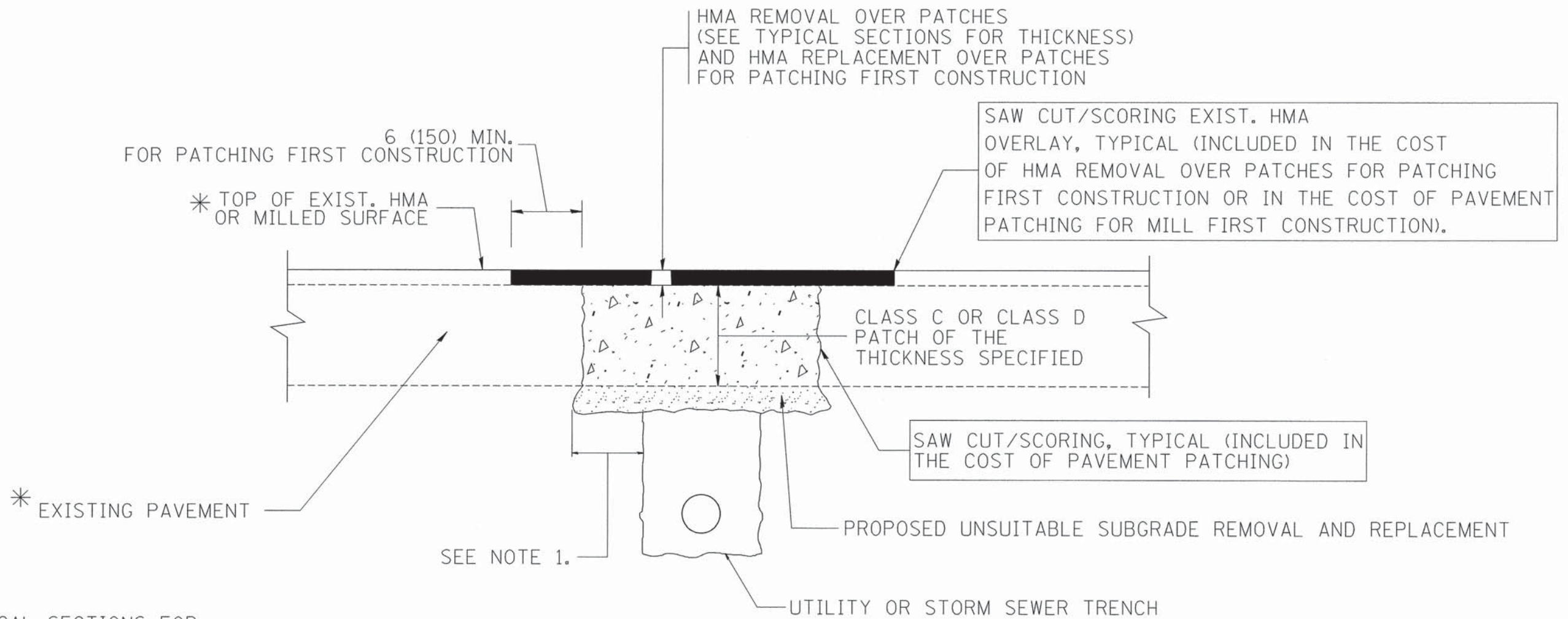

* SEE TYPICAL SECTIONS FOR THICKNESS AND MATERIALS

NOTES:

1. THE WIDTH OF THE FULL DEPTH PATCH OVER A TRENCH SHALL BE 12 (300) WIDER ON EACH SIDE OF THE TRENCH.
2. FOR METHOD OF MEASUREMENT AND BASIS OF PAYMENT, SEE RECURRING SPECIAL PROVISION "PATCHING WITH HOT-MIX ASPHALT OVERLAY REMOVAL".

SEQUENCE OF CONSTRUCTION (PATCHING FIRST)

1. REMOVE THE EXISTING HMA MATERIAL OVER THE AREA TO BE PATCHED.
2. REMOVE AND REPLACE WITH CLASS C OR D PATCH.
3. REPLACE HMA MATERIAL OVER THE AREA TO BE PATCHED.

SEQUENCE OF CONSTRUCTION (MILLING FIRST)

1. MILL HMA FIRST IF THERE IS AT LEAST 4 1/2 INCHES OR MORE OF HMA MATERIAL ON TOP OF THE EXISTING PAVEMENT OR IF THE PAVEMENT IS FULL DEPTH HMA. A MINIMUM OF 2 INCHES OF HMA MATERIAL SHALL BE IN PLACE AFTER MILLING.
2. REMOVE AND REPLACE WITH FULL DEPTH CLASS D PATCHES TO TOP OF MILLED SURFACE.

ALL DIMENSIONS ARE IN INCHES (MILLIMETERS) UNLESS OTHERWISE SHOWN.

	USER NAME = bauerdl	DESIGNED - R. SHAH	REVISED - A. ABBAS 04-27-98	STATE OF ILLINOIS DEPARTMENT OF TRANSPORTATION	PAVEMENT PATCHING FOR HMA SURFACED PAVEMENT	F.A.U. RTE. 6950	SECTION 14-00089-00-RS	COUNTY KANE	TOTAL SHEETS 11	SHEET NO. 7
	PLOT SCALE = 50,000 ' / IN.	CHECKED -	REVISED - R. BORO 01-01-07			BD400-04 (BD-22)	CONTRACT NO. 61B68			
	PLOT DATE = 10/27/2008	DATE - 10-25-94	REVISED - K. ENG 10-27-08			FED. ROAD DIST. NO. 1	ILLINOIS FED. AID PROJECT			

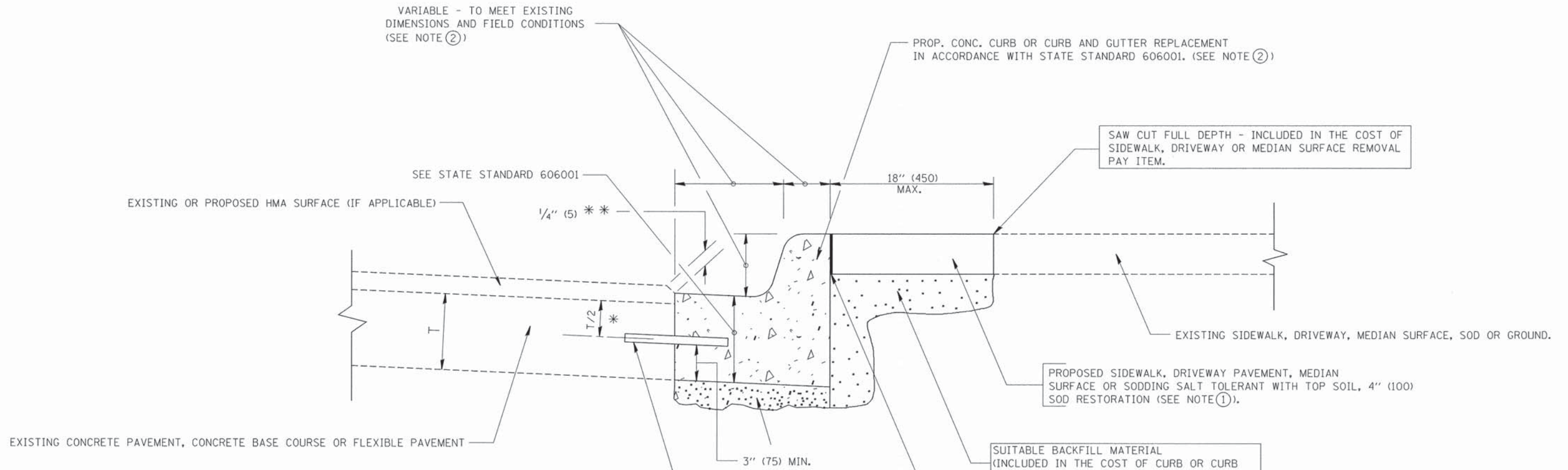

- * 3" (75) MINIMUM FROM TOP AND BOTTOM OF THE CONCRETE PAVEMENT OR BASE COURSE.
 - ** IF THE FINAL SURFACE OF THE PAVEMENT IS CONCRETE, THE GUTTER IS TO BE FLUSH WITH THE PAVEMENT.
- NOTE: ① SIDEWALK, DRIVEWAY PAVEMENT OR MEDIAN SURFACE SHALL BE SIMILAR TO THE MATERIAL BEING REMOVED AND WILL BE PAID FOR SEPARATELY.
- SODDING, SALT TOLERANT AND TOP SOIL, FURNISH AND PLACE 4" WILL BE PAID FOR SEPARATELY,
- ② FERTILIZER FOR THE PLACEMENT OF THE SOD IS NOT REQUIRED
- ③ CURB OR CURB AND GUTTER REPLACEMENT SHALL MATCH THE SHAPE OF THE EXISTING CURB OR CURB AND GUTTER UNLESS OTHERWISE SPECIFIED.
- ④ FOR CURB OR CURB AND GUTTER REMOVAL AND REPLACEMENT ADJACENT TO FLEXIBLE PAVEMENT DELETE EPOXY COATED TIE BARS.
- ⑤ LONGITUDINAL BARS, IF ENCOUNTERED IN THE EXISTING CURB OR CURB AND GUTTER, ARE NOT TO BE REPLACED. CUTTING AND REMOVING LONGITUDINAL BARS SHALL BE INCLUDED IN THE COST OF CURB OR CURB AND GUTTER REMOVAL AND REPLACEMENT.
- ⑥ THE COST OF HMA SURFACE REMOVAL IN THE EXISTING GUTTER FLAG SHALL BE INCLUDED IN THE COST OF THE CURB AND GUTTER REMOVAL AND REPLACEMENT.
- ⑦ THE REMOVAL AND REPLACEMENT OF THE EXISTING CURB OR CURB AND GUTTER SHALL BE DONE IN ACCORDANCE WITH THE APPLICABLE PORTIONS OF SECTION 440 AND 606 OF THE STANDARD SPECIFICATIONS.
- ⑧ THE LOCATIONS OF REMOVAL AND REPLACEMENT OF EXISTING CURB OR CURB AND GUTTER SHALL BE DETERMINED BY THE RESIDENT ENGINEER AT THE TIME OF CONSTRUCTION.

PROPOSED 3/4" (20) PREFORMED EXPANSION JOINT AT CONCRETE SIDEWALKS, DRIVEWAYS, AND MEDIANS. (INCLUDED IN THE COST OF CURB OR CURB AND GUTTER REMOVAL AND REPLACEMENT.)

UNSUITABLE SUB-BASE MATERIAL TO BE REMOVED, IF DIRECTED BY THE ENGINEER, SHALL BE REPLACED WITH EITHER SUB-BASE GRANULAR MATERIAL, TYPE B OR ADDITIONAL THICKNESS OF CONCRETE.

REMOVAL AND REPLACEMENT 4" (100) OR LESS IS INCLUDED IN THE COST OF CURB OR CURB AND GUTTER REMOVAL AND REPLACEMENT.

REMOVAL AND REPLACEMENT IN EXCESS OF 4" (100) WILL BE PAID FOR IN ACCORDANCE WITH ARTICLE 109.04 OF THE STANDARD SPECIFICATIONS.

PROPOSED #6 (20) EPOXY COATED TIE BARS 24" (600) LONG AT 24" (600) CENTERS WILL NOT BE PAID FOR SEPARATELY. DELETE EPOXY COATED TIE BARS IF EXISTING TIE BARS ARE USABLE AS DETERMINED BY THE ENGINEER. (SEE NOTE ③).

BASIS OF PAYMENT:
 THIS WORK WILL BE PAID FOR AT THE CONTRACT UNIT PRICE PER FOOT (METER) FOR "CURB REMOVAL AND REPLACEMENT" OR "COMBINATION CONCRETE CURB AND GUTTER REMOVAL AND REPLACEMENT".

CURB OR CURB AND GUTTER REMOVAL AND REPLACEMENT

ALL DIMENSIONS ARE IN INCHES (MILLIMETERS) UNLESS OTHERWISE SHOWN.

	USER NAME = drivakosgn	DESIGNED - A. HOUSEH	REVISED - R. SHAH 10-03-96	STATE OF ILLINOIS DEPARTMENT OF TRANSPORTATION	CURB OR CURB AND GUTTER REMOVAL AND REPLACEMENT	F.A.U. RTE. 6950	SECTION 14-00089-00-RS	COUNTY KANE	TOTAL SHEETS 11	SHEET NO. 8		
	PLOT SCALE = 50.000' / IN.	CHECKED -	REVISED - M. GOMEZ 01-22-01			SCALE: NONE	SHEET NO. 8 OF 11 SHEETS	STA. TO STA.	BD600-06 (BD-24)		CONTRACT NO. 61868	
	PLOT DATE = 12/15/2009	DATE - 03-11-94	REVISED - R. BORO 12-15-09			FED. ROAD DIST. NO. 1 ILLINOIS FED. AID PROJECT						

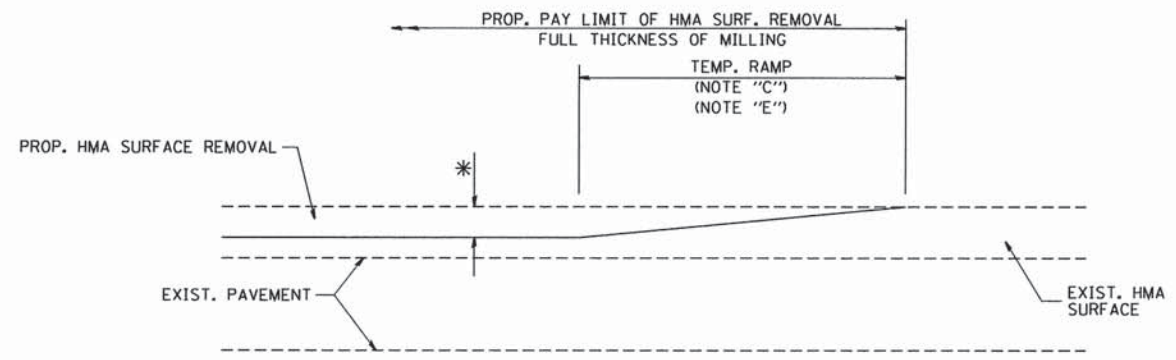

MILLED TEMPORARY RAMP
(FOR BUTT JOINT AND HMA TAPER SEE DETAIL BELOW)

OPTION 1

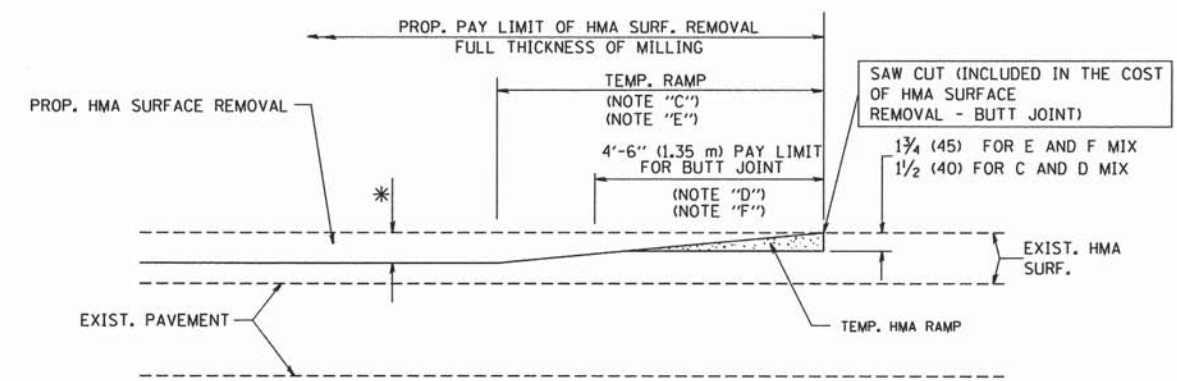

HMA CONSTRUCTED TEMPORARY RAMP
(FOR BUTT JOINT AND HMA TAPER SEE DETAIL BELOW)

OPTION 2

TYPICAL TEMPORARY RAMP

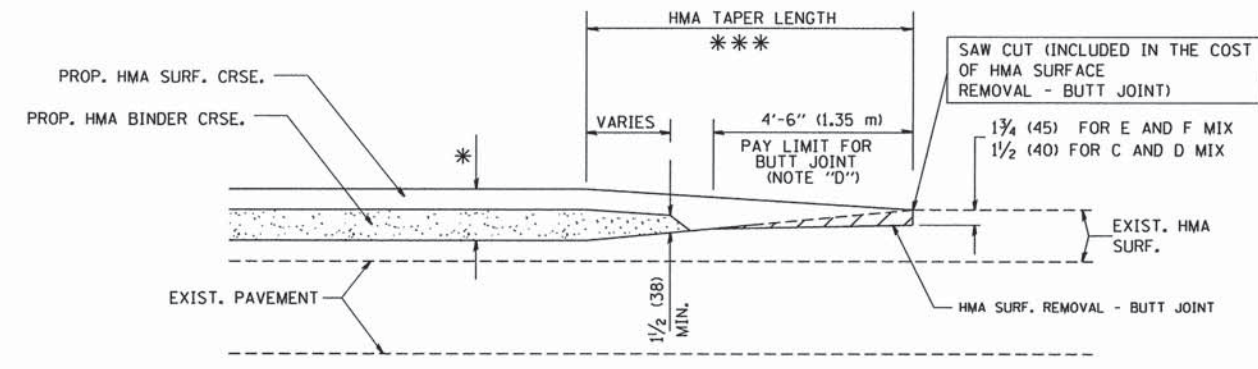

BUTT JOINT AND HMA TAPER

TYPICAL BUTT JOINT AND HMA TAPER
FOR MILLING AND RESURFACING

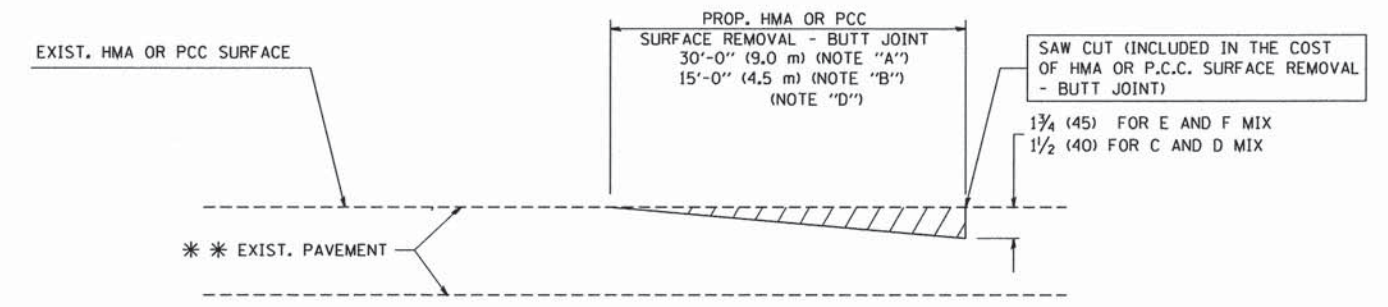

BUTT JOINT DETAIL

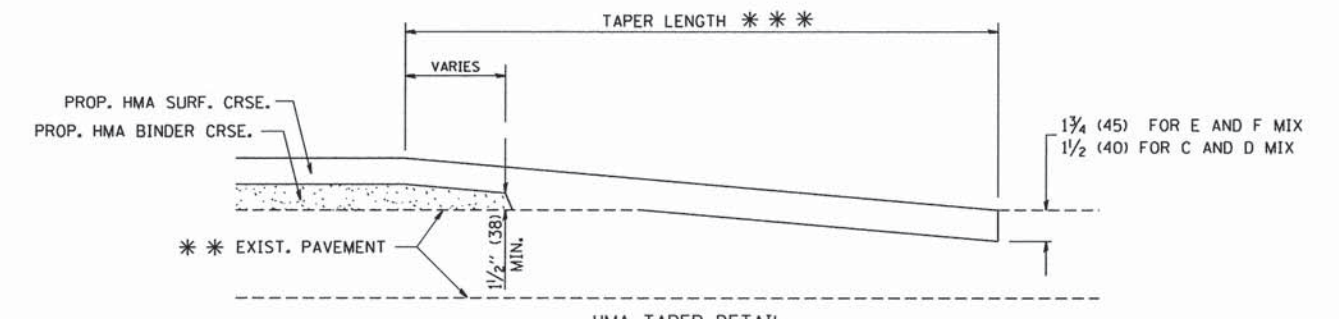

HMA TAPER DETAIL

TYPICAL BUTT JOINT AND HMA TAPER
FOR RESURFACING ONLY

*** PC CONCRETE, HMA OR HMA RESURFACED PAVEMENT.

NOTES

- A: MAINLINE ROADWAYS AND MAJOR SIDE ROADS.
 - B: MINOR SIDE ROADS.
 - C: THE TEMP. RAMP SHALL BE CONSTRUCTED IMMEDIATELY UPON REMOVAL OF THE EXISTING HMA SURFACE.
 - D: THE BUTT JOINT SHALL BE CONSTRUCTED IMMEDIATELY PRIOR TO PLACING THE PROPOSED HMA COURSES.
 - E: TAPER THE TEMP. RAMP AT A RATE OF 3'-0" (900 mm) PER 1 INCH (25 mm) OF MILLING THICKNESS.
 - F: INSTALLATION AND REMOVAL OF THE 4'-6" (1.35 m) TEMP. RAMP IS INCLUDED IN COST OF HMA SURFACE REMOVAL - BUTT JOINT
 - G: SEE ARTICLE 406.08 AND 406.14 OF THE STANDARD SPECIFICATIONS FOR "HMA AND/OR PCC SURFACE REMOVAL, BUTT JOINT".
- * SEE TYPICAL SECTIONS FOR MILLING THICKNESS.
- *** 20'-0" (6.1 m) PER 1 (25) RESURFACING (NOTE "A")
10'-0" (3.0 m) PER 1 (25) RESURFACING (NOTE "B")

BASIS OF PAYMENT:

THE BUTT JOINT WILL BE PAID FOR AT THE CONTRACT UNIT PRICE PER SQUARE YARD (SQUARE METER) FOR "HOT-MIX ASPHALT SURFACE REMOVAL - BUTT JOINT" OR FOR "PORTLAND CEMENT CONCRETE SURFACE REMOVAL - BUTT JOINT".

ALL DIMENSIONS ARE IN INCHES (MILLIMETERS) UNLESS OTHERWISE SHOWN.



USER NAME = gaglianob	DESIGNED - M. DE YONG	REVISED - R. SHAH 10-25-94
	DRAWN -	REVISED - A. ABBAS 03-21-97
PLOT SCALE = 50,0000' / IN.	CHECKED -	REVISED - M. GOMEZ 04-06-01
PLOT DATE = 1/4/2008	DATE - 06-13-90	REVISED - R. BORO 01-01-07

STATE OF ILLINOIS
DEPARTMENT OF TRANSPORTATION

BUTT JOINT AND HMA TAPER DETAILS	
SCALE: NONE	SHEET NO. 9 OF 11 SHEETS
STA.	TO STA.

F.A.J. RTE.	SECTION	COUNTY	TOTAL SHEETS	SHEET NO.
6950	14-00089-00-RS	KANE	11	9
BD400-05 BD32		CONTRACT NO. 61B68		
FED. ROAD DIST. NO. 1 ILLINOIS FED. AID PROJECT				

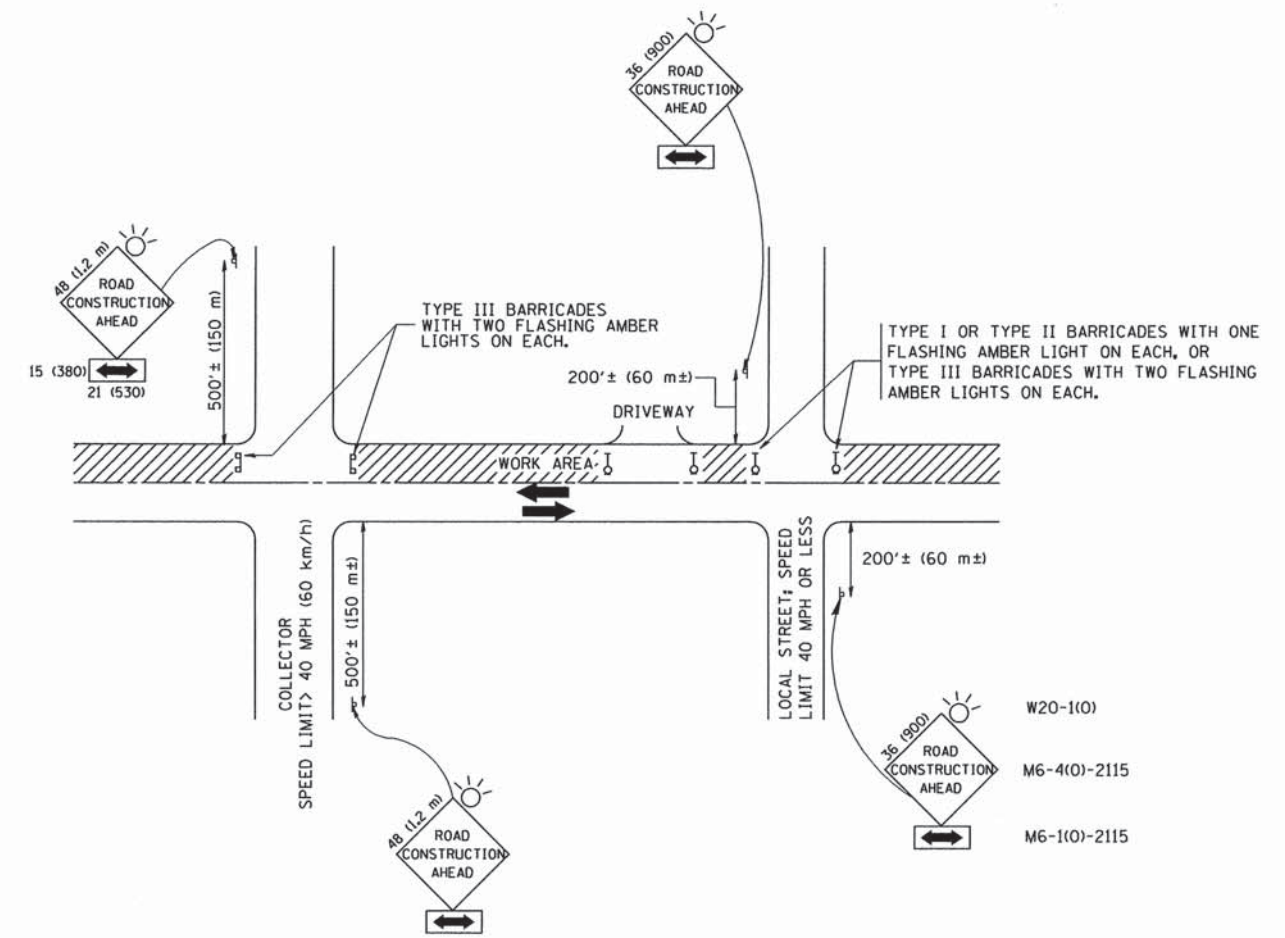

TRAFFIC CONTROL AND PROTECTION FOR SIDE ROADS, INTERSECTIONS, AND DRIVEWAYS

NOTES:

A. FOR NO LANE RESTRICTION ON THE SIDE ROAD OR DRIVEWAYS

1. SIDE ROAD WITH A SPEED LIMIT OF 40 MPH (60 km/h) OR LESS AS SHOWN ON THE DRAWING AND AS DIRECTED BY THE ENGINEER:
 - a) ONE ROAD CONSTRUCTION AHEAD SIGN 36 x 36 (900x900) WITH A FLASHER AND FLAG MOUNTED ON IT APPROXIMATELY 200' (60 m) IN ADVANCE OF THE MAIN ROUTE.
 - b) THE CLOSED PORTION OF THE MAIN ROUTE SHALL BE PROTECTED BY BLOCKING WITH TYPE I, TYPE II OR TYPE III BARRICADES, 1/3 OF THE CROSS SECTION OF THE CLOSED PORTION.
2. SIDE ROAD WITH A SPEED LIMIT GREATER THAN 40 MPH (60 km/h) AS SHOWN ON THE DRAWING AND AS DIRECTED BY THE ENGINEER:
 - a) ONE ROAD CONSTRUCTION AHEAD SIGN 48 x 48 (1.2 m x 1.2 m) WITH A FLASHER MOUNTED ON IT APPROXIMATELY 500' (150 m) IN ADVANCE OF THE MAIN ROUTE.
 - b) THE CLOSED PORTION OF THE MAIN ROUTE SHALL BE PROTECTED BY BLOCKING WITH TYPE III BARRICADES, 1/2 OF THE CROSS SECTION OF THE CLOSED PORTION.
3. WHEN THE SIDE ROAD LIES BETWEEN THE BEGINNING OF THE MAINLINE SIGNING AND THE WORK ZONE, A SINGLE HEADED ARROW (M6-1) SHALL BE USED IN LIEU OF THE DOUBLE HEADED ARROW (M6-4).

B. FOR A LANE CLOSURE ON A SIDE ROAD OR DRIVEWAY:

USE APPLICABLE PORTIONS OF THE TYPICAL APPLICATION OF TRAFFIC CONTROL DEVICES (STD. 701501, STD. 701606 OR THE APPROPRIATE STANDARD). THE SPACING OF SIGNS AND BARRICADES SHALL BE ADJUSTED FOR FIELD CONDITIONS AS DIRECTED BY THE ENGINEER. THE DIRECTIONAL ARROW SHALL BE COVERED OR REMOVED WHEN NO LONGER CONSISTENT WITH THE SIDE ROAD LANE CLOSURE.

C. ADVANCE WARNING SIGNS ARE TO BE OMITTED ON DRIVEWAY UNLESS OTHERWISE NOTED.

D. THE TRAFFIC CONTROL AND PROTECTION FOR SIDE ROADS, INTERSECTIONS, AND DRIVEWAYS SHALL BE INCIDENTAL TO THE COST OF SPECIFIED TRAFFIC CONTROL STANDARDS OR ITEMS.

All dimensions are in millimeters (inches) unless otherwise shown.



USER NAME = gaglianobt	DESIGNED - LHA	REVISED - J. OBERLE 10-18-95
	DRAWN -	REVISED - A. HOUSEH 03-06-96
PLOT SCALE = 50,000' / IN.	CHECKED -	REVISED - A. HOUSEH 10-15-96
PLOT DATE = 1/4/2008	DATE - 06-89	REVISED - T. RAMMACHER 01-06-00

STATE OF ILLINOIS
DEPARTMENT OF TRANSPORTATION

TRAFFIC CONTROL AND PROTECTION FOR
SIDE ROADS, INTERSECTIONS, AND DRIVEWAYS

SCALE: NONE SHEET NO. 10 OF 11 SHEETS STA. TO STA.

F.A. RTE.	SECTION	COUNTY	TOTAL SHEETS	SHEET NO.
6950	14-00089-00-RS	KANE	11	10
TC-10			CONTRACT NO. 61B68	
FED. ROAD DIST. NO. 1 ILLINOIS FED. AID PROJECT				

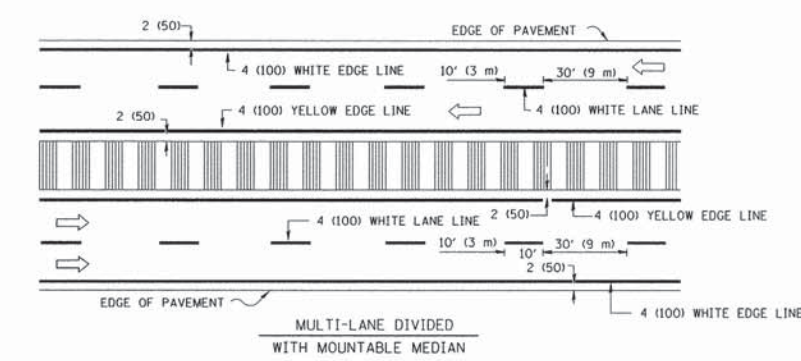
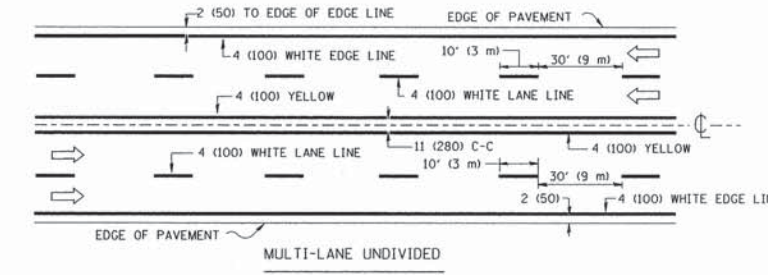
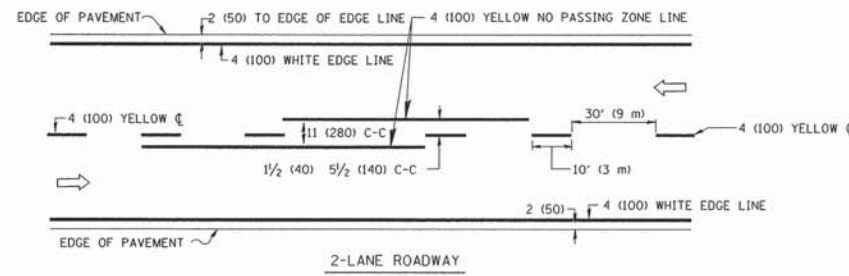

NOTE: MEDIANS WITH BARRIER CURB DO NOT REQUIRE AN EDGE LINE

TYPICAL LANE AND EDGE LINE MARKING

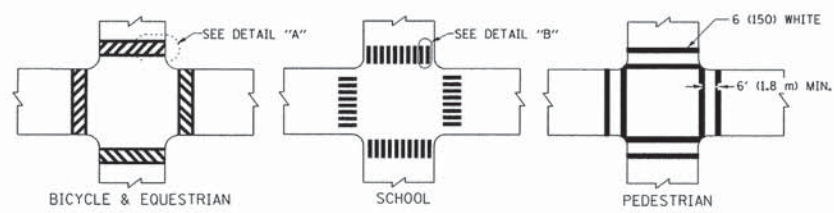

TYPICAL CROSSWALK MARKING

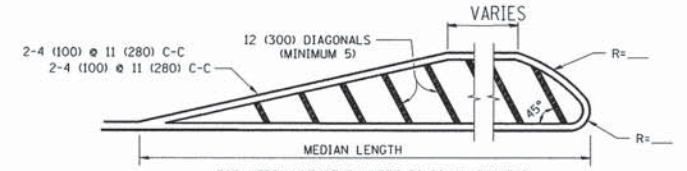
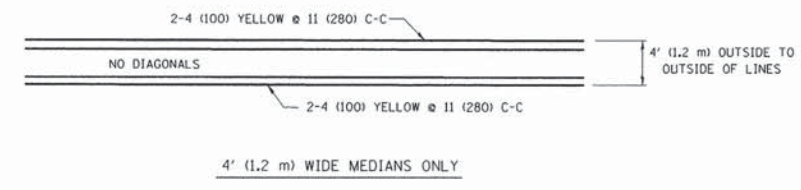

FOR MEDIAN LENGTHS WHERE DIAGONAL SPACING CANNOT BE ATTAINED, USE 5 (FIVE) EQUALLY SPACED DIAGONAL LINES.
 DIAGONAL LINE SPACING: 50' (15 m) C-C (LESS THAN 30MPH (50 km/h))
 75' (25 m) C-C 30MPH (50 km/h) TO 45MPH (70 km/h)
 150' (45 m) C-C (MORE THAN 45MPH (70 km/h))

MEDIANS OVER 4' (1.2 m) WIDE

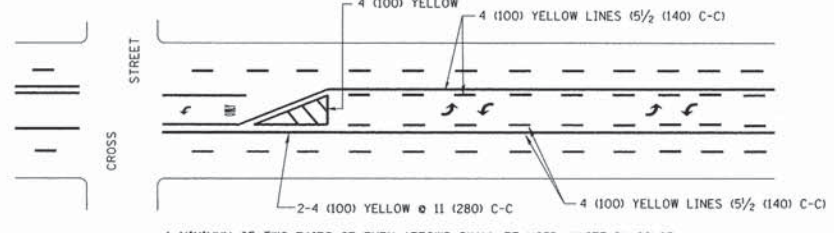

A MINIMUM OF TWO PAIRS OF TURN ARROWS SHALL BE USED, WHITE IN COLOR. ADDITIONAL PAIRS SHALL BE PLACED AT 200' (60 m) TO 300' (90 m) INTERVALS.

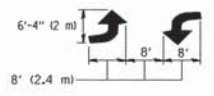

MEDIAN WITH TWO-WAY LEFT TURN LANE

TYPICAL PAINTED MEDIAN MARKING

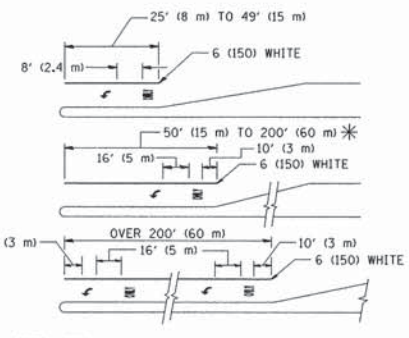

FULL SIZE LETTERS 8' (2.4 m) AND ARROWS SHALL BE USED.
 AREA = 15.6 SQ. FT. (1.5 m²) ONLY AREA = 20.8 SQ. FT. (1.9 m²)
 * TURN LANES IN EXCESS OF 400' (120 m) IN LENGTH MAY HAVE AN ADDITIONAL SET OF ARROW - "ONLY" INSTALLED MIDWAY BETWEEN THE OTHER TWO SETS OF ARROW - "ONLY".

TYPICAL LEFT (OR RIGHT) TURN LANE

TYPICAL TURN LANE MARKING

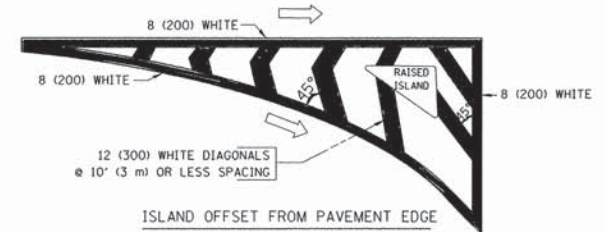

ISLAND OFFSET FROM PAVEMENT EDGE

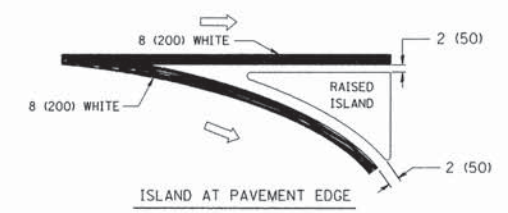

ISLAND AT PAVEMENT EDGE

TYPICAL ISLAND MARKING

TYPE OF MARKING	WIDTH OF LINE	PATTERN	COLOR	SPACING / REMARKS
CENTERLINE ON 2 LANE PAVEMENT	4 (100)	SKIP-DASH	YELLOW	10' (3 m) LINE WITH 30' (9 m) SPACE
CENTERLINE ON MULTI-LANE UNDIVIDED PAVEMENT	2 @ 4 (100)	SOLID	YELLOW	11 (280) C-C
NO PASSING ZONE LINES: FOR ONE DIRECTION FOR BOTH DIRECTIONS	4 (100) 2 @ 4 (100)	SOLID SOLID	YELLOW YELLOW	5 1/2 (140) C-C FROM SKIP-DASH CENTERLINE 11 (280) C-C OMIT SKIP-DASH CENTERLINE BETWEEN
LANE LINES	4 (100) 5 (125) ON FREEWAYS	SKIP-DASH SKIP-DASH	WHITE WHITE	10' (3 m) LINE WITH 30' (9 m) SPACE
DOTTED LINES (EXTENSIONS OF CENTER, LANE OR TURN LANE MARKINGS)	SAME AS LINE BEING EXTENDED	SKIP-DASH	SAME AS LINE BEING EXTENDED	2' (600) LINE WITH 6' (1.8 m) SPACE
EDGE LINES	4 (100)	SOLID	YELLOW-LEFT WHITE-RIGHT	OUTLINE MOUNTABLE MEDIANS IN YELLOW. EDGE LINES ARE NOT USED NEXT TO BARRIER CURB
TURN LANE MARKINGS	6 (150) LINE; FULL SIZE LETTERS & SYMBOLS (8' (2.4m))	SOLID	WHITE	SEE TYPICAL TURN LANE MARKING DETAIL
TWO WAY LEFT TURN MARKING	2 @ 4 (100) EACH DIRECTION 8' (2.4m) LEFT ARROW	SKIP-DASH AND SOLID IN PAIRS	YELLOW WHITE	10' (3 m) LINE WITH 30' (9 m) SPACE FOR SKIP-DASH; 5 1/2 (140) C-C BETWEEN SOLID LINE AND SKIP-DASH LINE SEE TYPICAL TWO-WAY LEFT TURN MARKING DETAIL
CROSSWALK LINES (PEDESTRIAN) A. DIAGONALS (BIKE & EQUESTRIAN) B. LONGITUDINAL BARS (SCHOOL)	2 @ 6 (150) 12 (300) @ 45° 12 (300) @ 90°	SOLID SOLID SOLID	WHITE WHITE WHITE	NOT LESS THAN 6' (1.8 m) APART 2' (600) APART 2' (600) APART SEE TYPICAL CROSSWALK MARKING DETAILS.
STOP LINES	24 (600)	SOLID	WHITE	PLACE 4' (1.2 m) IN ADVANCE OF AND PARALLEL TO CROSSWALK, IF PRESENT. OTHERWISE, PLACE AT DESIRED STOPPING POINT. PARALLEL TO CROSSROAD CENTERLINE, WHERE POSSIBLE
PAINTED MEDIANS	2 @ 4 (100) WITH 12 (300) DIAGONALS @ 45° NO DIAGONALS USED FOR 4' (1.2 m) WIDE MEDIANS	SOLID	YELLOW: TWO WAY TRAFFIC WHITE: ONE WAY TRAFFIC	11 (280) C-C FOR THE DOUBLE LINE SEE TYPICAL PAINTED MEDIAN MARKING.
GORE MARKING AND CHANNELIZING LINES	8 (200) WITH 12 (300) DIAGONALS @ 45°	SOLID	WHITE	DIAGONALS: 15' (4.5 m) C-C (LESS THAN 30MPH (50 km/h)) 20' (6 m) C-C 30MPH (50 km/h) TO 45MPH (70 km/h) 30' (9 m) C-C (OVER 45MPH (70 km/h))
RAILROAD CROSSING	24 (600) TRANSVERSE LINES; "RR" IS 6' (1.8 m) LETTERS; 16 (400) LINE FOR "X"	SOLID	WHITE	SEE STATE STANDARD 780001 AREA OF: "R"=3.6 SQ. FT. (0.33 m²) EACH "X"=54.0 SQ. FT. (5.0 m²)
SHOULDER DIAGONALS	12 (300) @ 45°	SOLID	WHITE - RIGHT YELLOW - LEFT	50' (15 m) C-C (LESS THAN 30MPH (50 km/h)) 75' (25 m) C-C (30 MPH (50 km/h) TO 45MPH (70 km/h)) 150' (45 m) C-C (OVER 45MPH (70 km/h))

FOR FURTHER DETAILS ON PAVEMENT MARKING REFER TO STANDARD SPECIFICATIONS FOR ROAD AND BRIDGE CONSTRUCTION AND STATE STANDARD 780001.

All dimensions are in inches (millimeters) unless otherwise shown.



USER NAME = drvakasn	DESIGNED - EVERS	REVISED - T. RAMMACHER 10-27-94
	DRAWN -	REVISED - C. JUICIUS 09-09-09
PLOT SCALE = 50.000' / IN.	CHECKED -	REVISED -
PLOT DATE = 9/9/2009	DATE - 03-19-90	REVISED -

STATE OF ILLINOIS
DEPARTMENT OF TRANSPORTATION

DISTRICT ONE	
TYPICAL PAVEMENT MARKINGS	
SCALE: NONE	SHEET NO. 11 OF 11 SHEETS
STA.	TO STA.

F.A. 11	SECTION	COUNTY	TOTAL SHEETS	SHEET NO.
6750	14-00089-00-RS	KANE	11	11
TC-13		CONTRACT NO. 61B68		
FED. ROAD DIST. NO. 1 ILLINOIS FED. AID PROJECT				