

FOR INDEX OF SHEETS SEE SHEET NO. 2

TRAFFIC DATA
 LOCAL STREETS 2014 ADT = 300
 POSTED SPEED LIMIT: 20 MPH
 DESIGN SPEED LIMIT: 30 MPH

DESIGN DESIGNATION = LOCAL STREET

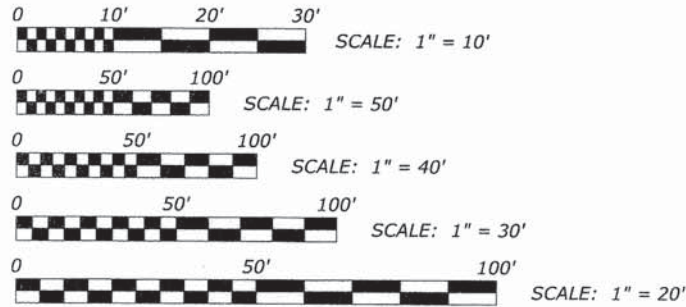

FULL SIZE PLANS HAVE BEEN PREPARED USING STANDARD ENGINEERING SCALES. REDUCED SIZED PLANS WILL NOT CONFORM TO STANDARD SCALES. IN MAKING MEASUREMENTS ON REDUCED PLANS, THE ABOVE SCALES MAY BE USED.

**STATE OF ILLINOIS
 DEPARTMENT OF TRANSPORTATION
 DIVISION OF HIGHWAYS
 PLANS FOR PROPOSED
 FEDERAL AID HIGHWAY
 VARIOUS ROUTES (VARIOUS LIMITS)
 CURB AND GUTTER & SIDEWALK
 SECTION 14-00127-00-SW
 PROJECT SRTS-4009(321)
 VILLAGE OF BROOKFIELD
 COOK COUNTY
 C-91-220-15**

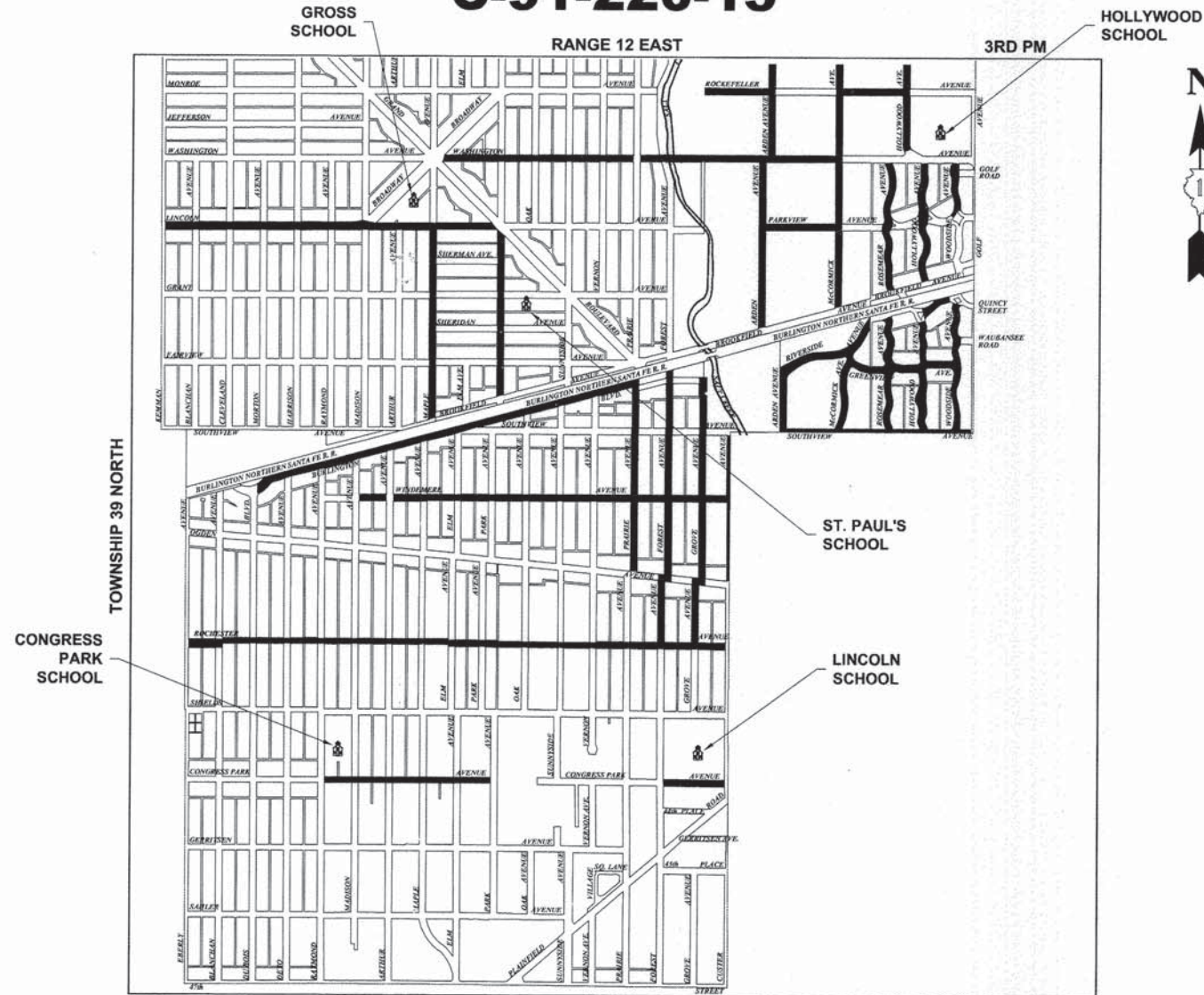

N.T.S.
PROVISO AND LYONS TOWNSHIPS
 - AREA OF IMPROVEMENT
 GROSS LENGTH OF IMPROVEMENT = 5,578 FT = 1.056 MI
 NET LENGTH OF IMPROVEMENT = 5,578 FT = 1.056 MI

ROUTE NO.	SECTION	COUNTY	TOTAL SHEETS	SHEET NO.
-	14-00127-00-SW	COOK	16	1
ILLINOIS PROJECT SRTS-4009(321)				
SECTION 14-00127-00-SW				
CONTRACT NO. 61B47				



**STATE OF ILLINOIS
 ILLINOIS DEPARTMENT OF TRANSPORTATION
 DIVISION OF HIGHWAYS**

APPROVED February 26 2015
 [Signature]
 VILLAGE OF BROOKFIELD, PRESIDENT

PASSED APRIL 10 2015
 [Signature]
 DISTRICT 1 ENGINEER OF LOCAL ROADS & STREETS

RELEASING FOR BID
 BASED ON LIMITED
 REVIEW Apr. 10 2015
 [Signature]
 DEPUTY DIRECTOR OF HIGHWAYS,
 REGION 1 ENGINEER

PRINTED BY THE AUTHORITY OF THE STATE OF ILLINOIS



SIGNED: William O. Peterhans
 DATE: 2-26-15 LICENSE EXPIRES: 11/30/15

HANCOCK ENGINEERING
 100+ Years of Excellence

- Civil Engineers
- Municipal Consultants
- Established 1911

9933 Roosevelt Road
 Westchester, IL 60154-2780
 Phone: 708-865-0300
 www.ehancock.com

E.H.E. NO. 125-14-28002

Drawing file: W:\Projects...by_Village\Brookfield\12514280 - Safe Routes to School\01_COV\FB.dwg Feb 11, 2015 - 1:11pm

FEDERAL AID PROGRAM ENGINEER: FAWAD AQUEEL, PE
 SCHAUMBURG, ILLINOIS PHONE: (847)705-4021

CONSULTANT: EDWIN HANCOCK ENGINEERING COMPANY
 9933 ROOSEVELT ROAD PHONE: (708)865-0300
 WESTCHESTER, ILLINOIS 60154

Call Before You Dig

JULIE
 ILLINOIS ONE-CALL SYSTEM

1-800-892-0123 OR 811

CONTRACT NO. 61B47

INDEX OF SHEETS

SHEET NO.	DESCRIPTION
1	TITLE SHEET, LOCATION MAP
2	INDEX OF SHEETS, LEGEND, HIGHWAY STANDARDS
3	GENERAL NOTES
4	SUMMARY OF QUANTITIES
5-6	TYPICAL SECTIONS
7-9	CONGRESS PARK AVENUE SIDEWALK IMPROVEMENTS
10	LOCATIONS OF INTERMITTENT SIDEWALK REPLACEMENT
11	DETAILS
12	CURB OR CURB AND GUTTER REMOVAL AND REPLACEMENT (BD-24)
13	TRAFFIC CONTROL AND PROTECTION FOR SIDE ROADS, INTERSECTIONS, AND DRIVEWAYS (TC-10)
14-16	STATION CROSS SECTIONS

LEGEND OF SYMBOLS

(TO BE USED IN CONJUNCTION WITH I.D.O.T. STANDARD 000001-06)

EXISTING	PROPOSED	DESCRIPTION	EXISTING	PROPOSED	DESCRIPTION
		FENCE			CURB AND GUTTER
		POWER POLE			EXISTING CURB AND GUTTER TO BE REMOVED
		GAS VALVE			EXISTING CONCRETE AREA TO BE REMOVED
		STREET LIGHT			HOT-MIX ASPHALT DRIVEWAY REMOVAL
		WATER MAIN BUFFALO BOX			SIDEWALK REMOVAL, DRIVEWAY REMOVAL
		WATER MAIN VALVE BOX			PCC SIDEWALK, PCC DRIVEWAY
		SPRINKLER			DIRECTION OF FLOW
		WATER MAIN VALVE VAULT			DRAINAGE SUMMIT
		STORM SEWER MANHOLE			GROUND ELEVATIONS
		STORM CATCH BASIN			
		STORM INLET			
		FIRE HYDRANT			
		BUSH			
		TREE			

I.D.O.T. STANDARD DRAWINGS

STANDARD NO.	TITLE OR DESCRIPTION
000001-06	STANDARD SYMBOLS, ABBREVIATIONS AND PATTERNS
280001-07	TEMPORARY EROSION CONTROL SYSTEMS
424001-08	PERPENDICULAR CURB RAMPS FOR SIDEWALKS
701006-05	OFF-ROAD OPERATIONS, 2L, 2W, 15' TO 24" FROM PAVEMENT EDGE
701301-04	LANE CLOSURE, 2L, 2W, SHORT TIME OPERATIONS
701501-06	URBAN LANE CLOSURE, 2L, 2W, UNDIVIDED
701801-05	SIDEWALK, CORNER OR CROSSWALK CLOSURE
701901-04	TRAFFIC CONTROL DEVICES

Drawing file: W:\Projects_by_village\Brookfield\12514280 - Safe Routes to School\02_index.dwg Feb 11, 2015 - 1:12pm

HANCOCK ENGINEERING
 ♦ Civil Engineers
 ♦ Municipal Consultants
 ♦ Established 1911

9933 Roosevelt Road
 Westchester, Illinois 60154-2798
 Phone: 708/965-0300
 Fax: 708/965-1212

DESIGNED - BPS	REVISED -
DRAWN - DMM	REVISED -
CHECKED - ---	REVISED -
DATE - 02/11/15	REVISED -

STATE OF ILLINOIS
DEPARTMENT OF TRANSPORTATION

INDEX OF SHEETS, LEGEND OF SYMBOLS, HIGHWAY STANDARDS			
SCALE: NONE	SHEET NO. 1 OF 1 SHEETS	STA.	TO STA.

F.A.U. RTE.	SECTION	COUNTY	TOTAL SHEETS	SHEET NO.
---	14-00127-00-SW	COOK	16	2
FIELD BOOK NO.:		CONTRACT NO. 61B47		
FED. ROAD DIST. NO. 1		ILLINOIS FED. AID PROJECT		

ACCESS

THE CONTRACTOR WILL BE REQUIRED TO MAINTAIN INGRESS AND EGRESS FOR EMERGENCY VEHICLES AT ALL TIMES DURING THE CONSTRUCTION PERIOD. DURING CONSTRUCTION, GARBAGE TRUCKS MUST BE PERMITTED ACCESS TO THE WORK ZONE IN ORDER TO PICK UP RESIDENTIAL AND COMMERCIAL GARBAGE FOR THOSE PROPERTIES FRONTING THE WORK ZONE. IF GARBAGE TRUCK ACCESS IS NOT PROVIDED, THE CONTRACTOR WILL BE REQUIRED TO MOVE TRASH CONTAINERS TO AN ACCESSIBLE LOCATION WHICH WILL BE INCLUDED IN THE COST OF MOBILIZATION.

FORMS FOR CONCRETE SIDEWALKS, DRIVEWAYS, PAVEMENT, AND GUTTER FLAGS

A 2" X 6" BOARD WILL BE USED AS A FORM FOR ALL SIDEWALKS TO BE INSTALLED FIVE INCHES (5") IN THICKNESS. A 2" X 8" BOARD WILL BE USED AS A FORM FOR ALL DRIVEWAYS TO BE INSTALLED SEVEN INCHES (7") IN THICKNESS. A 2" X 12" BOARD WILL BE USED AS THE FORM FOR THE FACE OF THE GUTTER FLAGS TO BE INSTALLED TEN INCHES (10") IN THICKNESS. ALL FORMS MUST BE OF A MINIMUM HEIGHT OF THE PROPOSED THICKNESS OF THE RESPECTIVE CONCRETE ITEMS TO BE INSTALLED. METAL FORMS WILL BE ALLOWED FOR REMOVAL AND REPLACEMENT OPERATIONS ONLY ON THIS PROJECT.

MAINTENANCE OF SEWER FLOWS

THE CONTRACTOR SHALL CONDUCT HIS OPERATIONS SO AS TO MAINTAIN AT ALL TIMES FLOWS THROUGH EXISTING STORM AND COMBINED SEWER SYSTEMS DRAINAGE STRUCTURES. HE SHALL ALSO PROVIDE AND MAINTAIN AN EFFICIENT PUMPING PLANT IF NECESSARY AND A TEMPORARY OUTLET AND BE PREPARED AT ALL TIMES TO DISPOSE OF THE WATER COLLECTED IN A SAFE MANNER WITHOUT DAMAGE OF ANY KIND TO ADJACENT PROPERTIES. THE ENDS OF EXISTING DRAINAGE LINES WHICH ARE NOT TO BE INCORPORATED INTO THE PROJECT ARE TO BE SEALED AS SPECIFIED IN THE SPECIAL PROVISIONS. THE COST OF ALL THE PREVIOUSLY MENTIONED WORK SHALL BE INCLUDED IN THE PAY ITEMS. ALL ACCUMULATION OF MATERIAL IN THE STRUCTURE DUE TO CONSTRUCTION OPERATIONS AS WELL AS MATERIAL EXISTING BEFORE CONSTRUCTION, SHALL BE REMOVED BY THE CONTRACTOR AT HIS EXPENSE.

STANDARDS

ANY REFERENCE TO STANDARDS THROUGHOUT THE PLANS OR SPECIAL PROVISIONS SHALL BE INTERPRETED TO BE THE LATEST STANDARD OF THE ILLINOIS DEPARTMENT OF TRANSPORTATION AS SHOWN ON THE INDEX OF SHEETS IN THE PLANS. ALL CONSTRUCTION SHALL BE DONE IN ACCORDANCE WITH THE STANDARD SPECIFICATIONS FOR ROAD AND BRIDGE CONSTRUCTION ADOPTED JANUARY 1, 2012, THE "SUPPLEMENTAL SPECIFICATIONS AND RECURRING SPECIAL PROVISIONS" ADOPTED JANUARY 1, 2015, THE LATEST EDITION OF THE "ILLINOIS MANUAL ON UNIFORM TRAFFIC CONTROL DEVICES FOR STREETS AND HIGHWAYS," "THE STANDARD SPECIFICATIONS FOR WATER AND SEWER MAIN CONSTRUCTION IN ILLINOIS" JULY 2014 7TH EDITION, AND THE "DETAILS" IN THE PLANS AND THE "SPECIAL PROVISIONS" INCLUDED IN THE CONTRACT DOCUMENTS.

EXISTING STRUCTURE MODIFICATIONS

ALL KNOWN EXISTING STRUCTURES IN THE PAVEMENT OR ADJACENT AREAS WHICH ARE INVOLVED IN THE CONSTRUCTION HAVE BEEN SHOWN ON THE PLANS AND NOTED AS TO BE REMOVED, FILLED, RECONSTRUCTED, OR ADJUSTED BY THE CONTRACTOR EXCEPT THOSE OF AMERITECH, COMED, AND THE NICOR GAS COMPANY, WHICH ARE TO BE ADJUSTED BY THE APPROPRIATE UTILITY FORCE. WHERE EXISTING STRUCTURES ARE TO BE REMOVED OR FILLED, OR THE EXISTING CASTING REPLACED, THE CASTINGS REMOVED FROM THE STRUCTURE ARE TO REMAIN THE PROPERTY OF THE VILLAGE AND BE SALVAGED. THE CONTRACTOR IS TO DELIVER FRAMES AND LIDS TO THE VILLAGE'S PUBLIC WORKS YARD.

MAINTENANCE OF EXISTING DRAINAGE STRUCTURES

WHEN DURING THE CONSTRUCTION OPERATIONS, ANY LOOSE MATERIAL IS DEPOSITED IN THE FLOW LINE OF ANY GUTTERS OR DRAINAGE STRUCTURE SO THAT THE NATURAL FLOW OF WATER IS OBSTRUCTED, IT SHALL BE REMOVED AT THE CLOSE OF EACH WORKING DAY. AT THE CONCLUSION OF THE CONSTRUCTION OPERATIONS, ALL DRAINAGE FACILITIES SHALL BE CLEAN AND FREE OF ALL OBSTRUCTIONS. THE COST OF THIS WORK SHALL BE INCLUDED IN THE CONTRACT PAY ITEMS.

SAW CUTTING

THE CONTRACTOR SHALL SAW CUT ASPHALT PAVEMENT, CONCRETE PAVEMENT, SIDEWALKS, CURBS, AND DRIVEWAYS, AS INDICATED ON THE PLANS OR AS DIRECTED BY THE ENGINEER, TO SEPARATE THE EXISTING PAVEMENT TO BE REMOVED BY MEANS OF AN APPROVED CONCRETE SAW TO A DEPTH AS DIRECTED BY THE ENGINEER. SUITABLE GUIDELINES OR DEVICES SHALL BE USED TO ASSURE CUTTING A NEAT, STRAIGHT LINE AS SHOWN ON THE PLANS. CARE SHALL BE TAKEN BY THE CONTRACTOR SO AS NOT TO DAMAGE THE REMAINING PAVEMENT DIRECTLY ADJACENT TO THE PAVEMENT TO BE REMOVED. ANY DAMAGE TO THE EXISTING PAVEMENT RESULTING FROM PAVEMENT REMOVAL OPERATIONS SHALL BE REPAIRED AT THE CONTRACTOR'S EXPENSE. THE PRICE OF SAW CUTTING, AS NOTED ABOVE, SHALL BE INCLUDED IN THE PARTICULAR PAY ITEMS.

UNCONTAMINATED SOIL CERTIFICATION

SECTION 22.51 OF THE ENVIRONMENTAL PROTECTION ACT REQUIRES THAT UNCONTAMINATED SOIL, INCLUDING UNCONTAMINATED SOIL MIXED WITH OTHER CLEAN CONSTRUCTION OR DEMOLITION DEBRIS (CCDD) MATERIALS ACCEPTED AT A CCDD LANDFILL FACILITY, MUST BE CERTIFIED TO BE UNCONTAMINATED. DEPENDING ON THE LOCATION OF THE SOIL REMOVAL, THE CERTIFICATION MAY HAVE TO BE MADE BY A LICENSED PROFESSIONAL ENGINEER.

ANY COSTS FOR THE TESTING OF THE UNCONTAMINATED MATERIAL AND HAVING A LICENSED PROFESSIONAL ENGINEER COMPLETE THE REQUIRED PAPERWORK TO CERTIFY THAT THE MATERIAL IS UNCONTAMINATED AND CAN BE PROPERLY DISPOSED AT A CCDD FACILITY SHALL BE INCLUDED IN THE COST OF MOBILIZATION.

IF THE CONTRACTOR CHOOSES TO DISPOSE OF THE EXCAVATED MATERIAL AT MORE THAN ONE CCDD FACILITY, THEN ANY ADDITIONAL COSTS SHALL ALSO BE BORNE BY THE CONTRACTOR. SHOULD ANY CONTAMINATED MATERIAL BE DISCOVERED ON THE PROJECT, THE ADDITIONAL COSTS FOR TESTING AND PROPER DISPOSAL OF THE CONTAMINATED MATERIAL SHALL EITHER BE PAID BY THE VILLAGE UNDER SEPARATE CONTRACT OR AS PART OF THIS CONTRACT AS ADDITIONAL WORK AT A PRICE TO BE AGREED UPON OR ON A TIME AND MATERIAL BASIS.

Drawing file: w:\Projects_by_Village\Brookfield\12514280 - Safe Routes to School\03_GeneralNotes.dwg Feb 13, 2015 - 8:30am



◆ Civil Engineers
◆ Municipal Consultants
◆ Established 1911

9933 Roosevelt Road
Westchester, Illinois 60154-2788
Phone: 708/865-0100
Fax: 708/865-1212

DESIGNED -	BPS	REVISED -	
DRAWN -	DMM	REVISED -	
CHECKED -	---	REVISED -	
DATE -	02/11/15	REVISED -	

**STATE OF ILLINOIS
DEPARTMENT OF TRANSPORTATION**

GENERAL NOTES

SCALE: NONE SHEET NO. 1 OF 1 SHEETS STA. TO STA.

F.A.U. RTE.	SECTION	COUNTY	TOTAL SHEETS	SHEET NO.
---	14-00127-00-SW	COOK	16	3
FIELD BOOK NO.:		CONTRACT NO. 61847		
FED. ROAD DIST. NO. 1		ILLINOIS FED. AID PROJECT		

SUMMARY OF QUANTITIES

SP	SI	CODE NO.	ITEM	UNIT	TOTAL QUANTITY	CONS. TYPE CODE 021 80% FEDERAL 20% LOCAL
		20200100	EARTH EXCAVATION	CU YD	135	135
		21101610	TOPSOIL FURNISH AND PLACE, 3"	SQ YD	550	550
	X	25000100	SEEDING, CLASS 1	SQ YD	100	100
	X	25200100	SODDING	SQ YD	450	450
		42001300	PROTECTIVE COAT	SQ YD	925	925
		42300300	PORTLAND CEMENT CONCRETE DRIVEWAY PAVEMENT, 7 INCH	SQ YD	120	120
		42400200	PORTLAND CEMENT CONCRETE SIDEWALK, 5 INCH	SQ FT	21,475	21,475
X		42400800	DETECTABLE WARNINGS	SQ FT	160	160
X		44000200	DRIVEWAY PAVEMENT REMOVAL	SQ YD	150	150
X		44000600	SIDEWALK REMOVAL	SQ FT	21,550	21,550
		67100100	MOBILIZATION	L SUM	1	1
		70102620	TRAFFIC CONTROL AND PROTECTION, STANDARD 701501	L SUM	1	1
		70102640	TRAFFIC CONTROL AND PROTECTION, STANDARD 701801	L SUM	1	1
X		X4240430	PORTLAND CEMENT CONCRETE SIDEWALK, 5 INCH, SPECIAL	SQ FT	6,790	6,790
		Z0004562	COMBINATION CONCRETE CURB AND GUTTER REMOVAL AND REPLACEMENT	FOOT	100	100

SI - DENOTES SPECIALTY ITEM

SP - DENOTES SPECIAL PROVISION HAS BEEN PROVIDED

Drawing file: W:\Projects\by_Village\Brookfield\12514280 - Safe Routes to School\04_300.dwg Feb 16, 2015 - 11:12am



♦ Civil Engineers
 ♦ Municipal Consultants
 ♦ Established 1911
 9933 Roosevelt Road
 Westchester, Illinois 60154-2780
 Phone: 708.965-0390
 Fax: 708.965-1212

DESIGNED - BPS	REVISED -
DRAWN - DMM	REVISED -
CHECKED - ---	REVISED -
DATE - 02/11/15	REVISED -

STATE OF ILLINOIS
DEPARTMENT OF TRANSPORTATION

SUMMARY OF QUANTITIES

SCALE: NONE SHEET NO. 1 OF 1 SHEETS STA. TO STA.

F.A.U. RTE.	SECTION	COUNTY	TOTAL SHEETS	SHEET NO.
--	14-00127-00-SW	COOK	16	4
FIELD BOOK NO.:		CONTRACT NO. 61B47		
FED. ROAD DIST. NO. 1		ILLINOIS FED. AID PROJECT		

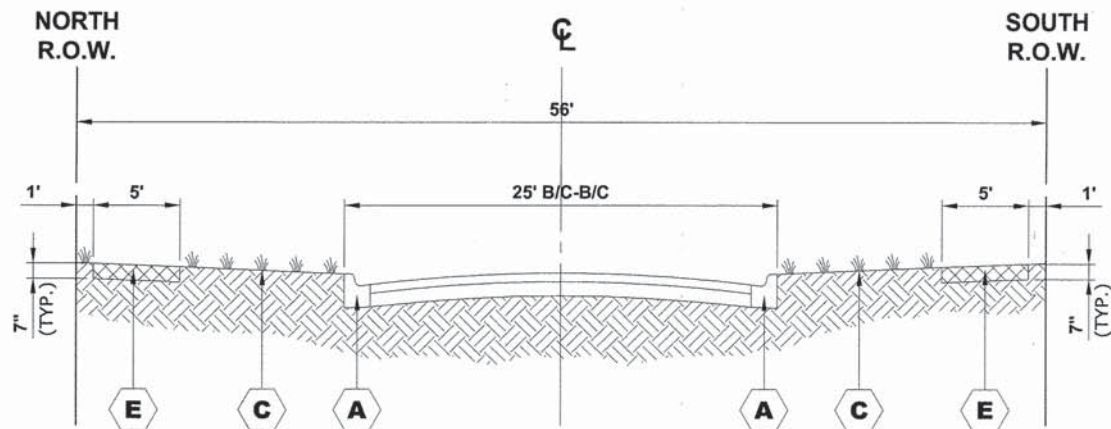

EXISTING TYPICAL SECTION
CONGRESS PARK AVENUE
STA. 1+64 TO STA. 9+66

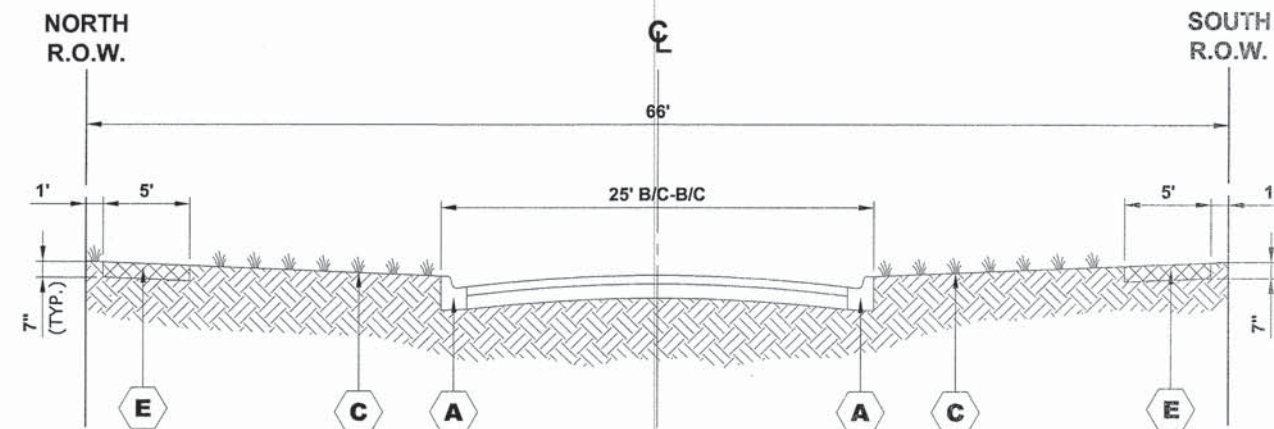

EXISTING TYPICAL SECTION
CONGRESS PARK AVENUE
STA. 33+46 TO STA. 37+65

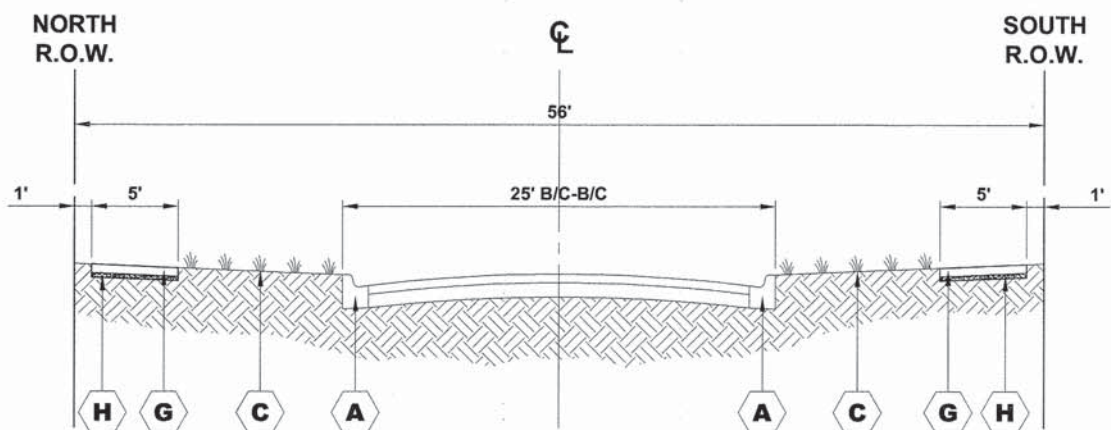

PROPOSED TYPICAL SECTION
CONGRESS PARKWAY
STA. 1+64 TO STA. 9+66

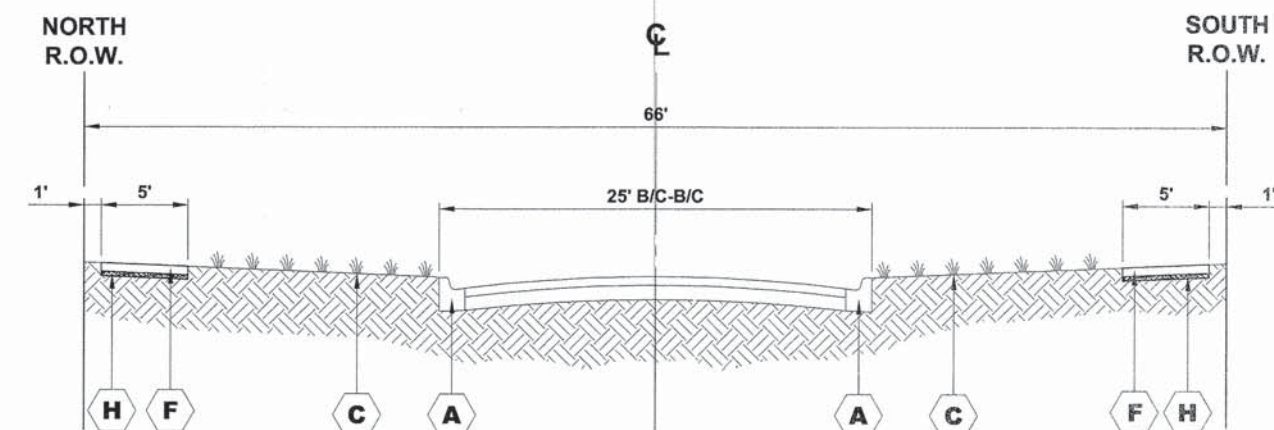

PROPOSED TYPICAL SECTION
CONGRESS PARK AVENUE
STA. 33+46 TO STA. 37+65

LEGEND OF SYMBOLS

SYMBOL	DESCRIPTION
	EXISTING COMBINATION CONCRETE CURB AND GUTTER, TYPE B-6.12
	EXISTING PORTLAND CEMENT CONCRETE SIDEWALK
	EXISTING LANDSCAPED PARKWAY
	INTERMITTENT SIDEWALK REMOVAL

SYMBOL	DESCRIPTION
	EARTH EXCAVATION
	INTERMITTENT REPLACEMENT PORTLAND CEMENT CONCRETE SIDEWALK, 5"
	PORTLAND CEMENT CONCRETE SIDEWALK, 5 INCH, SPECIAL
	SUB-BASE GRANULAR MATERIAL, TYPE B, 2" (INCLUDED IN THE COST OF PCC SIDEWALK, 5" or PCC SIDEWALK, 5", SPECIAL)

Drawing file: W:\Projects_by_Millage\Brookfield\12014280 - Safe Routes to School\05_Typ_Sec.dwg Feb 11, 2015 - 2:09pm



◆ Civil Engineers
 ◆ Municipal Consultants
 ◆ Established 1911

9933 Renneville Road
 Westchester, Illinois 60154-2789
 Phone: 708/965-0350
 Fax: 708/965-1212

DESIGNED -	BPS	REVISED -	
DRAWN -	DMM	REVISED -	
CHECKED -	---	REVISED -	
DATE -	02/11/15	REVISED -	

STATE OF ILLINOIS
 DEPARTMENT OF TRANSPORTATION

TYPICAL SECTIONS

SCALE: NONE SHEET NO. 1 OF 2 SHEETS STA. - TO STA. -

F.A.U. RTE.	SECTION	COUNTY	TOTAL SHEETS	SHEET NO.
---	14-00127-00-SW	COOK	10	5
FIELD BOOK NO.:		CONTRACT NO. 61B47		
FED. ROAD DIST. NO. 1		ILLINOIS FED. AID PROJECT		

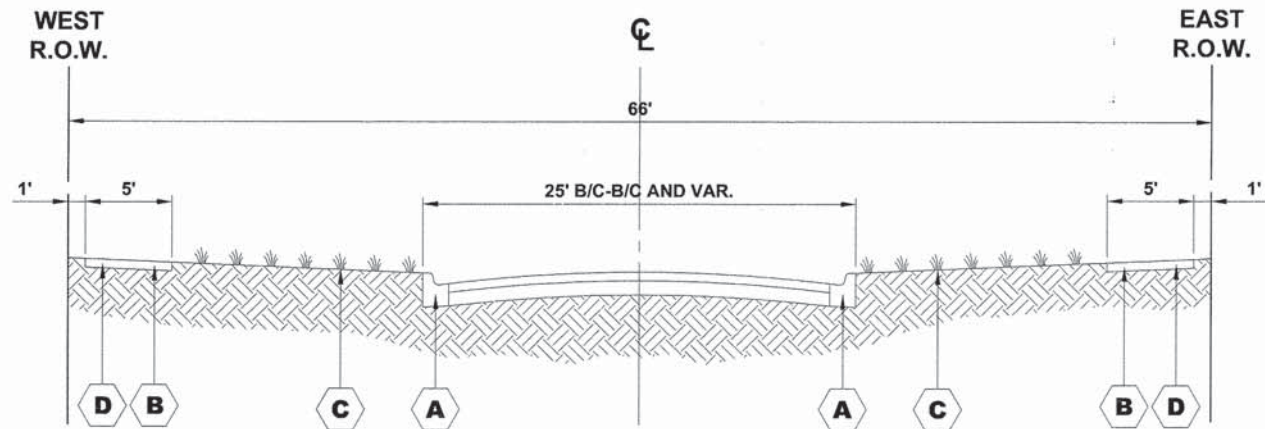

**EXISTING TYPICAL SECTION
VARIOUS STREETS**

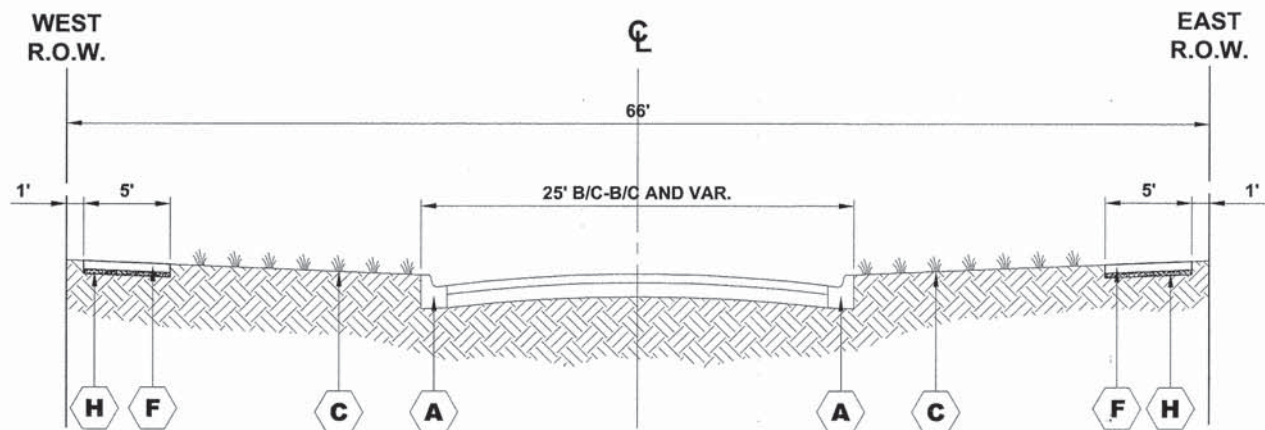

**PROPOSED TYPICAL SECTION
VARIOUS STREETS**

LEGEND OF SYMBOLS

SYMBOL	DESCRIPTION
A	EXISTING COMBINATION CONCRETE CURB AND GUTTER, TYPE B-6.12
B	EXISTING PORTLAND CEMENT CONCRETE SIDEWALK
C	EXISTING LANDSCAPED PARKWAY
D	INTERMITTENT SIDEWALK REMOVAL
E	EARTH EXCAVATION
F	INTERMITTENT REPLACEMENT PORTLAND CEMENT CONCRETE SIDEWALK, 5"
G	PORTLAND CEMENT CONCRETE SIDEWALK, 5 INCH, SPECIAL
H	SUB-BASE GRANULAR MATERIAL, TYPE B, 2" (INCLUDED IN THE COST OF PCC SIDEWALK, 5" or PCC SIDEWALK, 5", SPECIAL)

EARTHWORK SUMMARY

LOCATION	EARTH EXCAVATION 20200100	EARTH EXCAVATION ADJUSTED SHRINKAGE (25%)	EMBANKMENT	EARTHWORK BALANCE WASTE (+) OR SHORTAGE (-)
SECTION	CU YD	CU YD	CU YD	CU YD
CONGRESS PARK AVE.	135	101.25	0	101.25
TOTAL	135	101.25	0	101.25

Drawing file: W:\Projects_by_Mage\Brookfield\12514280 - Safe Routes to School\05_Typ_Sec.dwg Feb 11, 2015 - 2:09pm

HANCOCK ENGINEERING ♦ Civil Engineers
 ♦ Municipal Consultants
 ♦ Established 1911

9933 Roosevelt Road
 Waukegan, Illinois 60154-2780
 Phone: 708/965-0100
 Fax: 708/965-1212

DESIGNED - BPS	REVISED -
DRAWN - DMM	REVISED -
CHECKED - ---	REVISED -
DATE - 02/11/15	REVISED -

**STATE OF ILLINOIS
DEPARTMENT OF TRANSPORTATION**

TYPICAL SECTIONS

SCALE: NONE SHEET NO. 2 OF 2 SHEETS STA. - TO STA. -

F.A.U. RTE.	SECTION	COUNTY	TOTAL SHEETS	SHEET NO.
---	14-00127-00-SW	COOK	16	6
FIELD BOOK NO.:		CONTRACT NO. 61B47		
FED. ROAD DIST. NO. 1		ILLINOIS FED. AID PROJECT		

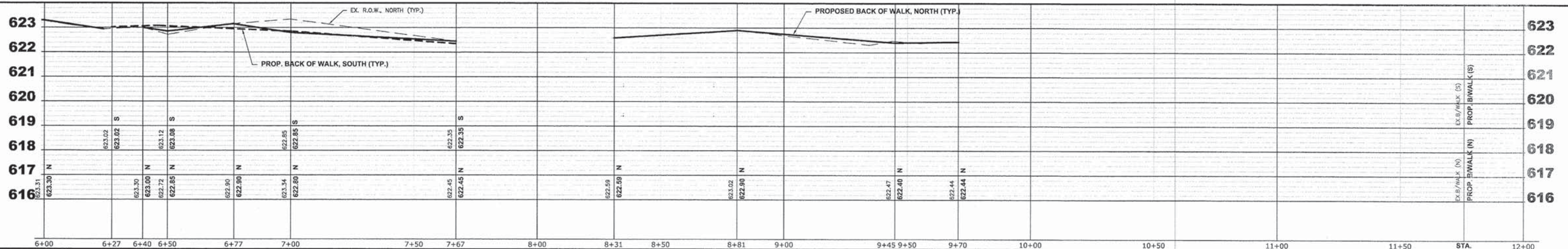
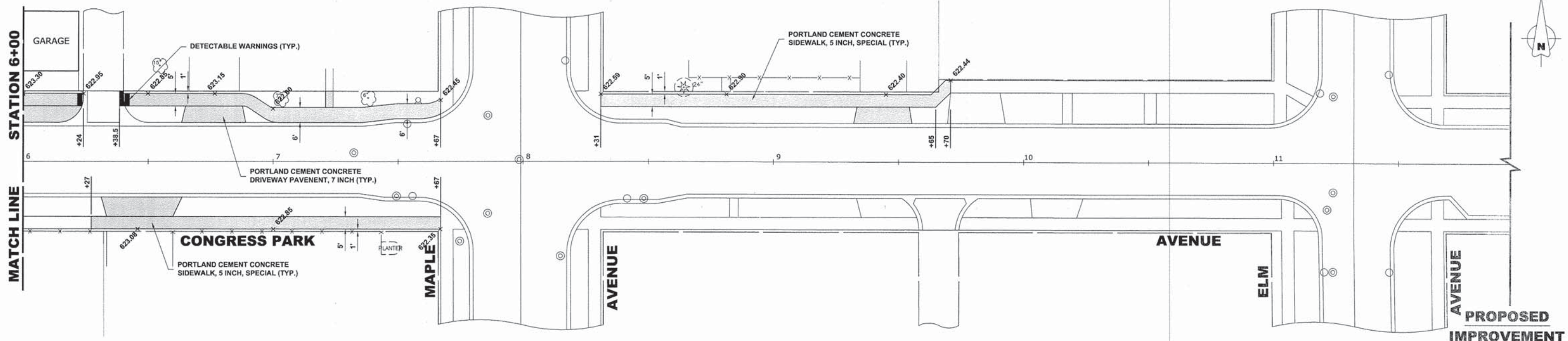
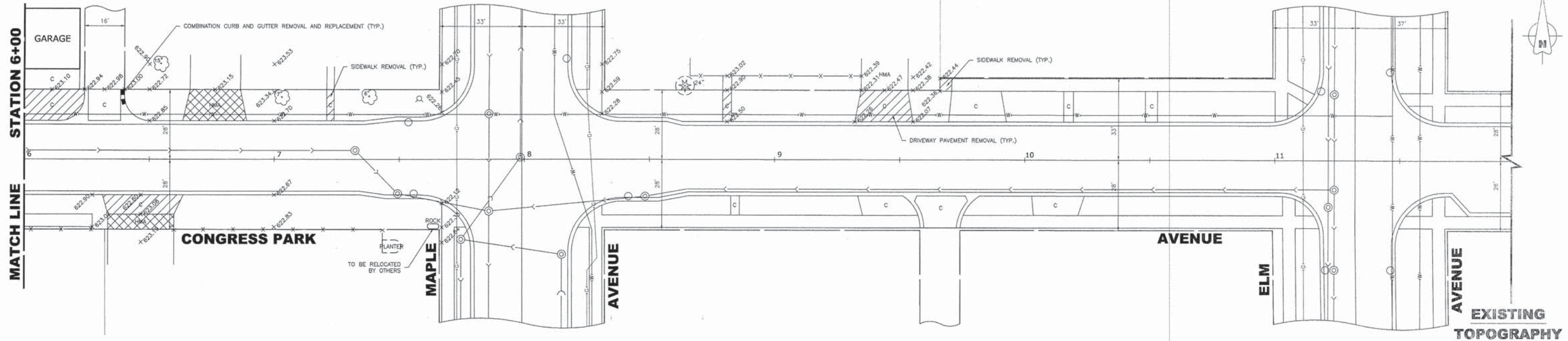

Drawing file: W:\Projects_by_Village\Brookfield\12514280 - Safe Routes to School\Site\05_Safe Routes.dwg Feb 17, 2015 - 9:56am

HANCOCK ENGINEERING
 Civil Engineers
 Municipal Consultants
 Established 1911

9933 Roosevelt Road
 Westchester, Illinois 60154-2790
 Phone: 708/665-0200
 Fax: 708/665-1212

DESIGNED - BPS	REVISED -
DRAWN - DMM	REVISED -
CHECKED -	REVISED -
DATE - 02/11/15	REVISED -

**STATE OF ILLINOIS
 DEPARTMENT OF TRANSPORTATION**

**CONGRESS PARKWAY
 SIDEWALK IMPROVEMENTS**

SCALE: H:1"=20'; V:1"=2' SHEET NO. 2 OF 3 SHEETS STA. 6+00 TO STA. 11+50

F.A.U. RTE.	SECTION	COUNTY	TOTAL SHEETS	SHEET NO.
---	14-00127-00-SW	COOK	16	8
FIELD BOOK NO.:	CONTRACT NO. 61B47			
FED. ROAD DIST. NO. 1	ILLINOIS FED. AID PROJECT			

Drawing file: W:\Projects\by_Millage\Brookfield\12114280 - Safe Routes to School\Site\01_Safe Routes.dwg Feb 17, 2015 - 9:38am

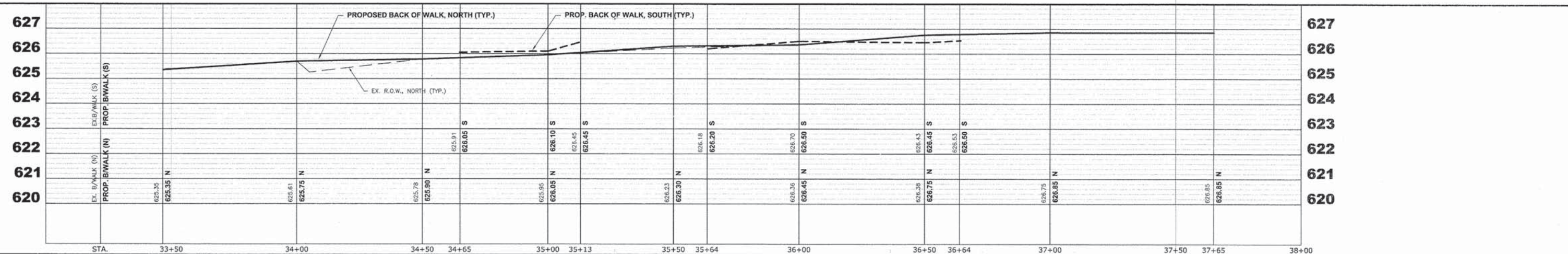
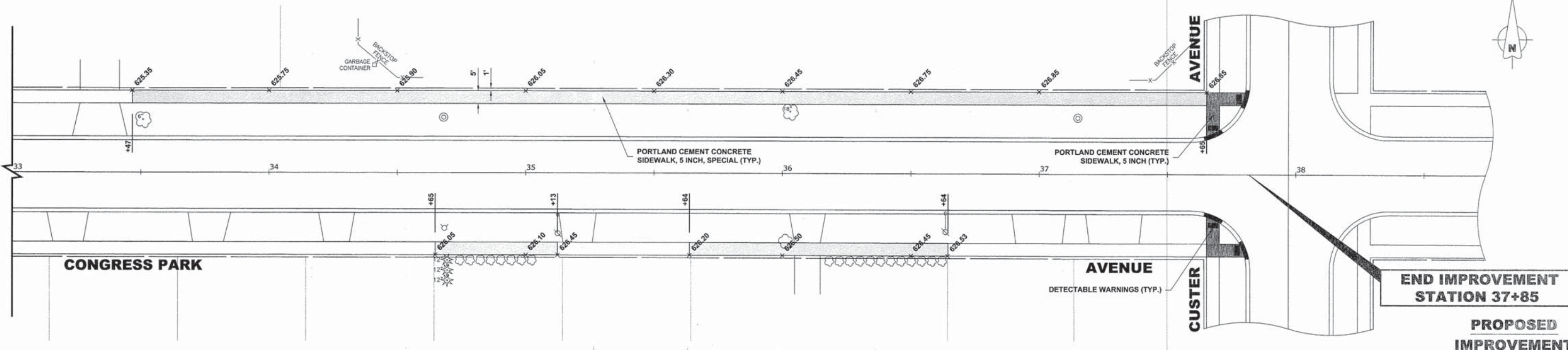
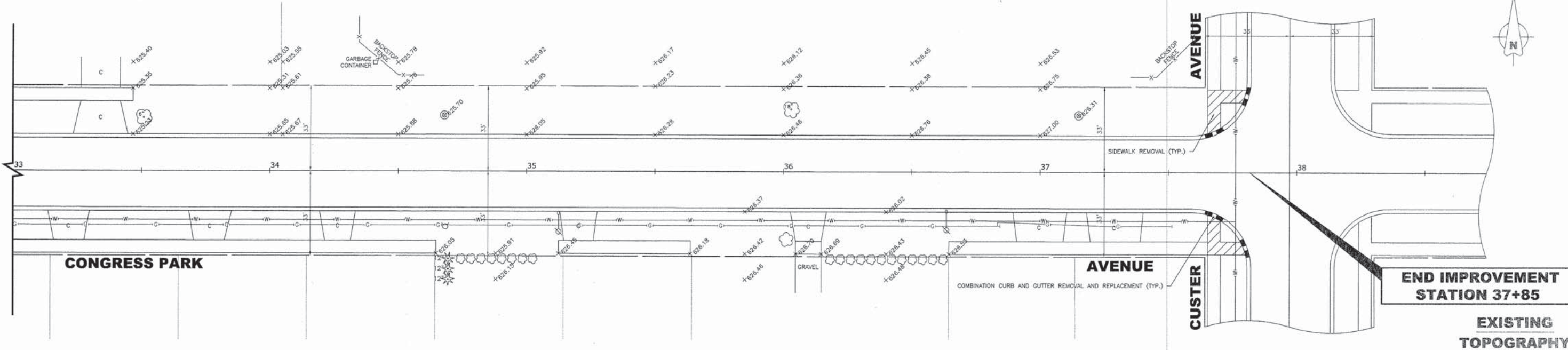

HANCOCK ENGINEERING

- ◆ Civil Engineers
- ◆ Municipal Consultants
- ◆ Established 1911

9933 Roosevelt Road
Westchester, Illinois 60154-2780
Phone: 708/665-0300
Fax: 708/665-1212

DESIGNED - BPS	REVISED -
DRAWN - DMM	REVISED -
CHECKED -	REVISED -
DATE - 02/11/15	REVISED -

**STATE OF ILLINOIS
DEPARTMENT OF TRANSPORTATION**

**CONGRESS PARKWAY
SIDEWALK IMPROVEMENTS**

SCALE: H:1"=20'; V:1"=2'

SHEET NO. 3 OF 3 SHEETS STA. 33+00 TO STA. 38+00

F.A.U. RTE.	SECTION	COUNTY	TOTAL SHEETS	SHEET NO.
---	14-00127-00-SW	COOK	16	9
FIELD BOOK NO.:		CONTRACT NO. 61B47		
FED. ROAD DIST. NO. 1		ILLINOIS FED. AID PROJECT		

Drawing file: W:\Projects_by_Village\Brookfield\1251280 - Side Routes to School\06_Intermittent Walk.dwg Feb 11, 2015 - 11:46pm

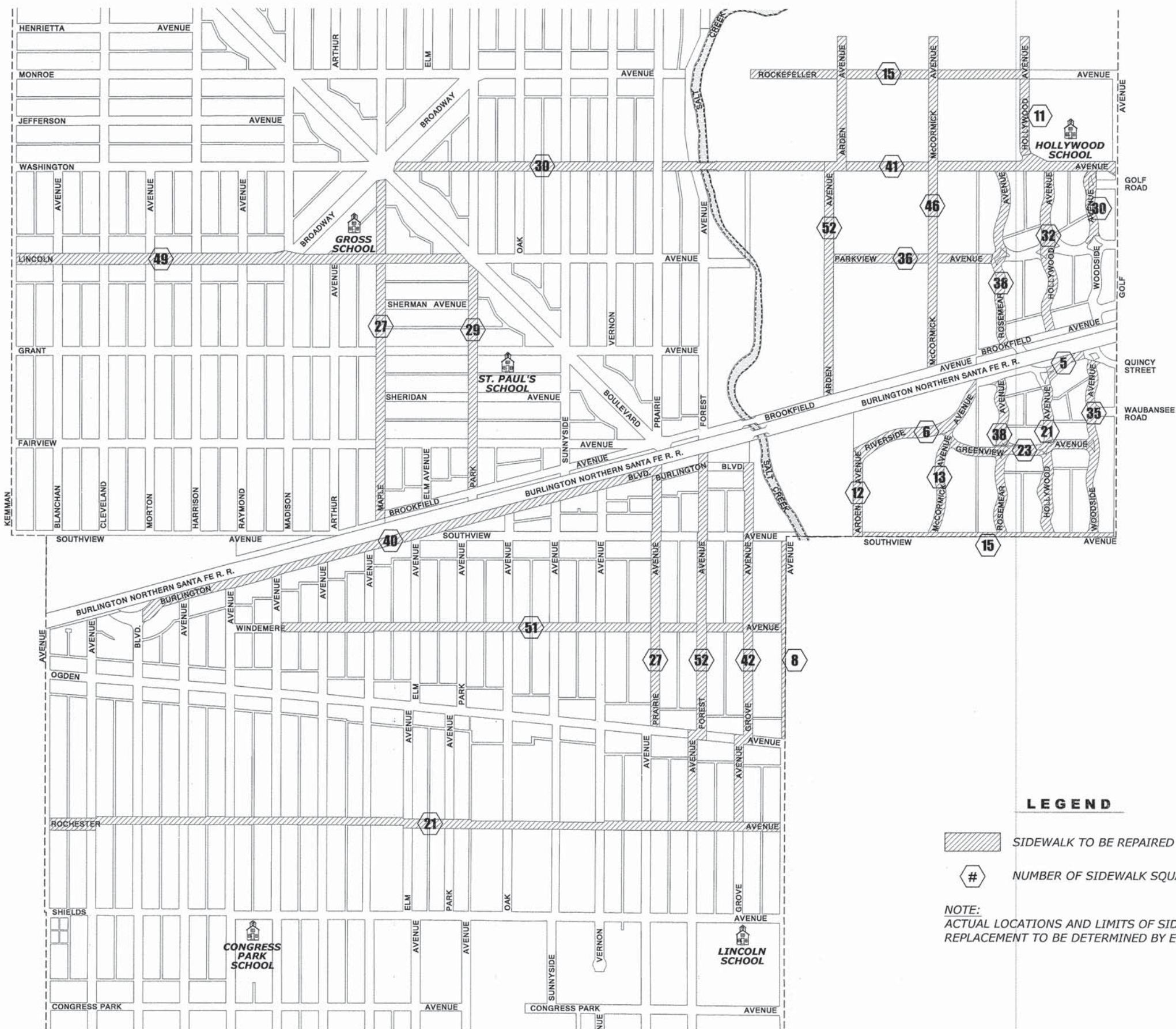

LEGEND

- SIDEWALK TO BE REPAIRED
- NUMBER OF SIDEWALK SQUARES

NOTE:
ACTUAL LOCATIONS AND LIMITS OF SIDEWALK REPLACEMENT TO BE DETERMINED BY ENGINEER.



♦ Civil Engineers
 ♦ Municipal Consultants
 ♦ Established 1911
 9933 Roosevelt Road
 Waukegan, Illinois 60154-2780
 Phone: 708/865-8200
 Fax: 708/865-2222

DESIGNED -	BPS	REVISED -
DRAWN -	DMM	REVISED -
CHECKED -	---	REVISED -
DATE -	02/11/15	REVISED -

**STATE OF ILLINOIS
DEPARTMENT OF TRANSPORTATION**

**LOCATIONS OF INTERMITTENT
SIDEWALK REPLACEMENT**

SCALE: 1" = 400' SHEET NO. 1 OF 1 SHEETS STA. TO STA.

F.A.U. RTE.	SECTION	COUNTY	TOTAL SHEETS	SHEET NO.
---	14-00127-00-SW	COOK	16	10
FIELD BOOK NO.:		CONTRACT NO. 61B47		
FED. ROAD DIST. NO. 1		ILLINOIS FED. AID PROJECT		

GENERAL NOTES

DEPRESSED CURBS - THE TOP OF CURBS SHALL BE DEPRESSED WHERE THE CURB AND GUTTER IS CONSTRUCTED AT HANDICAP ACCESSIBLE SIDEWALK RAMP AT ALLEY RETURNS AND STREET INTERSECTIONS, AND FOR PRIVATE AND COMMERCIAL DRIVES AND AS DIRECTED BY THE ENGINEER

DRAINAGE OPENINGS - AT ALL LOCATIONS WHERE CASTINGS ARE TO BE INCORPORATED IN THE CURB AND GUTTER, A 3/4" EXPANSION JOINT SHALL BE INSTALLED IN THE CURB AND GUTTER A DISTANCE OF 5 FT. FROM EACH SIDE OF THE CASTING. 2-NO. 4 RE-BARS, 9' IN LENGTH, SHALL BE INCORPORATED IN THE CONTINUOUS PORTION OF CONCRETE CURB BEHIND THE CASTING.

DETECTABLE WARNINGS - DETECTABLE WARNINGS SHALL BE INSTALLED AT HANDICAP ACCESSIBLE SIDEWALK RAMP, AT ALLEY RETURNS, AND STREET INTERSECTIONS. THESE SHALL BE CONSTRUCTED IN ACCORDANCE WITH THE APPLICABLE IDOT STANDARDS.

DEPRESSED CURB HEIGHT - THE HEIGHT OF THE DEPRESSED CURB SHALL BE 1-1/2" AT DRIVEWAYS. SEE IDOT STANDARD 424001-08 FOR HEIGHT AT SIDEWALK RAMP.

BITUMINOUS EXPANSION JOINTS - THREE QUARTER INCH (3/4") BITUMINOUS PREMOLDED INORGANIC FIBER EXPANSION JOINTS SHALL BE INSTALLED WHERE NEW SIDEWALK OR CURB AND GUTTER OR DRIVEWAY PAVEMENT ABUTS AN EXISTING CONCRETE WALK, DRIVE, OR CURB WHICH IS TO REMAIN IN PLACE, AND AT NOT LESS THAN NINETY FOOT (90') INTERVALS AT LOCATIONS WHERE CURB REPLACEMENT IS IN EXCESS OF NINETY FEET (90'); AT RADIUS POINTS, AT BOTH SIDES OF FRAMES AND GRATES WHICH FALL IN THE CURB; AND AS DIRECTED BY THE ENGINEER.

ALL EXPANSION JOINTS LOCATED IN THE CURB AND GUTTER SHALL HAVE TWO (2) THREE QUARTER INCH (3/4") DIAMETER, SMOOTH, ROUND, EPOXY COATED DOWEL BARS, EIGHTEEN INCHES (18") IN LENGTH, WITH GREASED PLASTIC END CAPS INSERTED TO ALLOW THE CURB AND GUTTER TO EXPAND AND CONTRACT LATERALLY. CONTRACTION JOINTS SHALL BE TOOLED INTO THE CURB AND GUTTER AT INTERVALS NOT TO EXCEED FIFTEEN FEET (15'). THESE CONTRACTION JOINTS SHALL BE SAW CUT TO A DEPTH OF TWO INCHES (2") WITHIN TWENTY-FOUR (24) HOURS OF CONCRETE PLACEMENT. THE COST OF THE ABOVE WORK SHALL BE INCLUDED IN THE RESPECTIVE ITEMS FOR CONCRETE INSTALLATION.

THE COSTS FOR REMOVAL OF ANY ASPHALT OVERLAY THAT EXTENDS INTO THE GUTTER PORTION OF THE CURB AND GUTTER WILL BE INCLUDED IN THE PRICE FOR COMBINATION CURB AND GUTTER REMOVAL.

THE EDWIN HANCOCK ENGINEERING COMPANY AND THE VILLAGE PUBLIC WORKS DEPARTMENT SHALL BE NOTIFIED AT LEAST TWO (2) WORKING DAYS PRIOR TO ANY CONSTRUCTION ACTIVITY.

CONTACT INFORMATION IS AS FOLLOWS:
 EDWIN HANCOCK ENGINEERING COMPANY: 708-865-0300
 VILLAGE OF BROOKFIELD PUBLIC WORKS: 708-485-2540

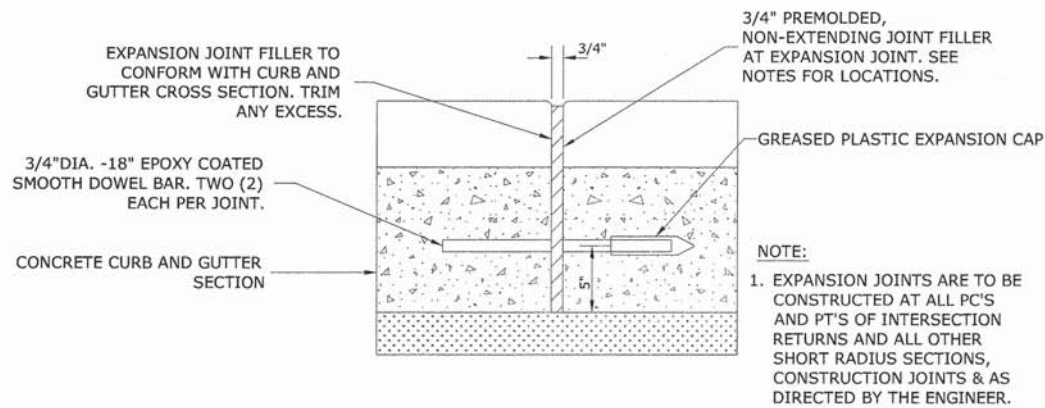

TYPICAL CURB AND GUTTER EXPANSION JOINT

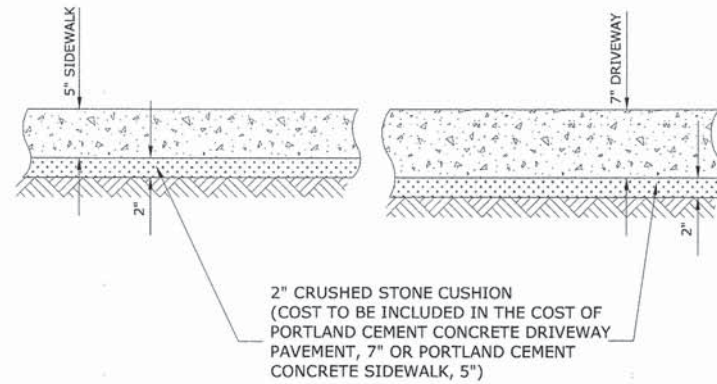

TYPICAL P.C.C. SIDEWALK, DRIVEWAY

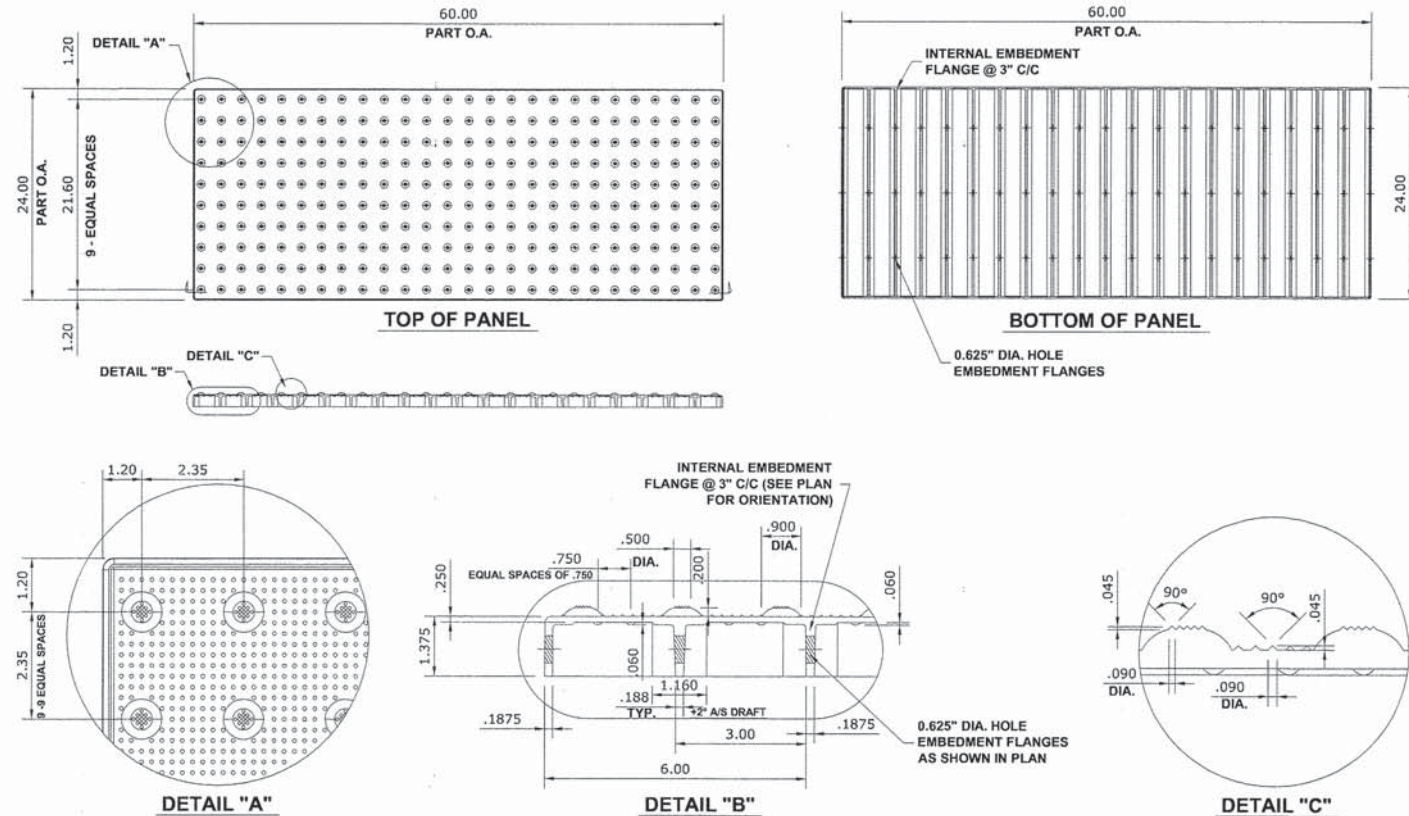

CAST-IN-PLACE COMPOSITE PAVER TILE FOR DETECTABLE WARNING

Drawing File: W:\Projects_by_Village\Brookfield\12514280 - Safe Routes to School\07_Roadway-Details.dwg Feb 11, 2015 - 1:14pm



♦ Civil Engineers
 ♦ Municipal Consultants
 ♦ Established 1911
 9933 Roosevelt Road
 Westchester, Illinois 60154-2790
 Phone: 708-865-0300
 Fax: 708-865-1212

DESIGNED -	BPS	REVISED -
DRAWN -	DMM	REVISED -
CHECKED -	---	REVISED -
DATE -	02/11/15	REVISED -

**STATE OF ILLINOIS
DEPARTMENT OF TRANSPORTATION**

ROADWAY DETAILS

SCALE: NONE SHEET NO. 1 OF 1 SHEETS STA. TO STA.

F.A.U. RTE.	SECTION	COUNTY	TOTAL SHEETS	SHEET NO.
---	14-00127-00-SW	COOK	16	11
FIELD BOOK NO.:		CONTRACT NO. 61B47		
FED. ROAD DIST. NO. 1		ILLINOIS FED. AID PROJECT		

FILE PROJECT NO. 19544-28002

VARIABLE - TO MEET EXISTING DIMENSIONS AND FIELD CONDITIONS (SEE NOTE ②)

PROP. CONC. CURB OR CURB AND GUTTER REPLACEMENT IN ACCORDANCE WITH STATE STANDARD 606001. (SEE NOTE ②)

SAW CUT FULL DEPTH - INCLUDED IN THE COST OF SIDEWALK, DRIVEWAY OR MEDIAN SURFACE REMOVAL PAY ITEM.

SEE STATE STANDARD 606001
EXISTING OR PROPOSED HMA SURFACE (IF APPLICABLE)
1/4" (5)***

18" (450) MAX.

EXISTING SIDEWALK, DRIVEWAY, MEDIAN SURFACE, SOD OR GROUND.

PROPOSED SIDEWALK, DRIVEWAY PAVEMENT, MEDIAN SURFACE OR SODDING SALT TOLERANT WITH TOP SOIL, 4" (100) SOD RESTORATION (SEE NOTE ①).

SUITABLE BACKFILL MATERIAL (INCLUDED IN THE COST OF CURB OR CURB AND GUTTER REMOVAL AND REPLACEMENT)

PROPOSED 3/4" (20) PREFORMED EXPANSION JOINT AT CONCRETE SIDEWALKS, DRIVEWAYS, AND MEDIANS. (INCLUDED IN THE COST OF CURB OR CURB AND GUTTER REMOVAL AND REPLACEMENT.)

UNSUITABLE SUB-BASE MATERIAL TO BE REMOVED, IF DIRECTED BY THE ENGINEER, SHALL BE REPLACED WITH EITHER SUB-BASE GRANULAR MATERIAL, TYPE B OR ADDITIONAL THICKNESS OF CONCRETE.

REMOVAL AND REPLACEMENT 4" (100) OR LESS IS INCLUDED IN THE COST OF CURB OR CURB AND GUTTER REMOVAL AND REPLACEMENT.

REMOVAL AND REPLACEMENT IN EXCESS OF 4" (100) WILL BE PAID FOR IN ACCORDANCE WITH ARTICLE 109.04 OF THE STANDARD SPECIFICATIONS.

PROPOSED #6 (20) EPOXY COATED TIE BARS 24" (600) LONG AT 24" (600) CENTERS WILL NOT BE PAID FOR SEPARATELY. DELETE EPOXY COATED TIE BARS IF EXISTING TIE BARS ARE USUABLE AS DETERMINED BY THE ENGINEER. (SEE NOTE ③).

BASIS OF PAYMENT:
THIS WORK WILL BE PAID FOR AT THE CONTRACT UNIT PRICE PER FOOT (METER) FOR "CURB REMOVAL AND REPLACEMENT" OR "COMBINATION CONCRETE CURB AND GUTTER REMOVAL AND REPLACEMENT".

EXISTING CONCRETE PAVEMENT, CONCRETE BASE COURSE OR FLEXIBLE PAVEMENT

3" (75) MIN.

* 3" (75) MINIMUM FROM TOP AND BOTTOM OF THE CONCRETE PAVEMENT OR BASE COURSE.

** IF THE FINAL SURFACE OF THE PAVEMENT IS CONCRETE, THE GUTTER IS TO BE FLUSH WITH THE PAVEMENT.

NOTE: ① SIDEWALK, DRIVEWAY PAVEMENT OR MEDIAN SURFACE SHALL BE SIMILAR TO THE MATERIAL BEING REMOVED AND WILL BE PAID FOR SEPARATELY.

SODDING, SALT TOLERANT AND TOP SOIL, FURNISH AND PLACE 4" WILL BE PAID FOR SEPARATELY,

② FERTILIZER FOR THE PLACEMENT OF THE SOD IS NOT REQUIRED

③ CURB OR CURB AND GUTTER REPLACEMENT SHALL MATCH THE SHAPE OF THE EXISTING CURB OR CURB AND GUTTER UNLESS OTHERWISE SPECIFIED.

④ FOR CURB OR CURB AND GUTTER REMOVAL AND REPLACEMENT ADJACENT TO FLEXIBLE PAVEMENT DELETE EPOXY COATED TIE BARS.

⑤ LONGITUDINAL BARS, IF ENCOUNTERED IN THE EXISTING CURB OR CURB AND GUTTER, ARE NOT TO BE REPLACED. CUTTING AND REMOVING LONGITUDINAL BARS SHALL BE INCLUDED IN THE COST OF CURB OR CURB AND GUTTER REMOVAL AND REPLACEMENT.

⑥ THE COST OF HMA SURFACE REMOVAL IN THE EXISTING GUTTER FLAG SHALL BE INCLUDED IN THE COST OF THE CURB AND GUTTER REMOVAL AND REPLACEMENT.

⑦ THE REMOVAL AND REPLACEMENT OF THE EXISTING CURB OR CURB AND GUTTER SHALL BE DONE IN ACCORDANCE WITH THE APPLICABLE PORTIONS OF SECTION 440 AND 606

⑧ THE LOCATIONS OF REMOVAL AND REPLACEMENT OF EXISTING CURB OR CURB AND GUTTER SHALL BE DETERMINED BY THE RESIDENT ENGINEER AT THE TIME OF CONSTRUCTION.

CURB OR CURB AND GUTTER REMOVAL AND REPLACEMENT

ALL DIMENSIONS ARE IN INCHES (MILLIMETERS) UNLESS OTHERWISE SHOWN

Drawing file: W:\Projects_by_Village\Brookfield\12514280 - Safe Routes to School\08_IDOT_Standard_Details.dwg Feb 11, 2015 - 1:14pm

USER NAME =	DESIGNED - A. HOUSEH	REVISED - R. SHAH 10-03-96
PLOT SCALE =	DRAWN -	REVISED - A. ABBAS 03-21-97
PLOT DATE =	CHECKED -	REVISED - M. GOMEZ 01-22-01
	DATE - 03-11-94	REVISED - R. BORO 12-15-09

STATE OF ILLINOIS
DEPARTMENT OF TRANSPORTATION

CURB OR CURB AND GUTTER
REMOVAL AND REPLACEMENT

F.A.U. RTE.	SECTION	COUNTY	TOTAL SHEETS	SHEET NO.
--	14-00127-00-SW	COOK	16	12
BD600-06 (BD-24)			CONTRACT NO. 61847	
FED. ROAD DIST. NO. 1 ILLINOIS FED. AID PROJECT				

SCALE: NONE SHEET NO. 1 OF 1 SHEETS STA. TO STA.

Drawing file: W:\Projects_by_Village\Brookfield\12514280 - Safe Routes to School\08_08_00_Standard_Details.dwg Feb 11, 2015 - 11:4pm

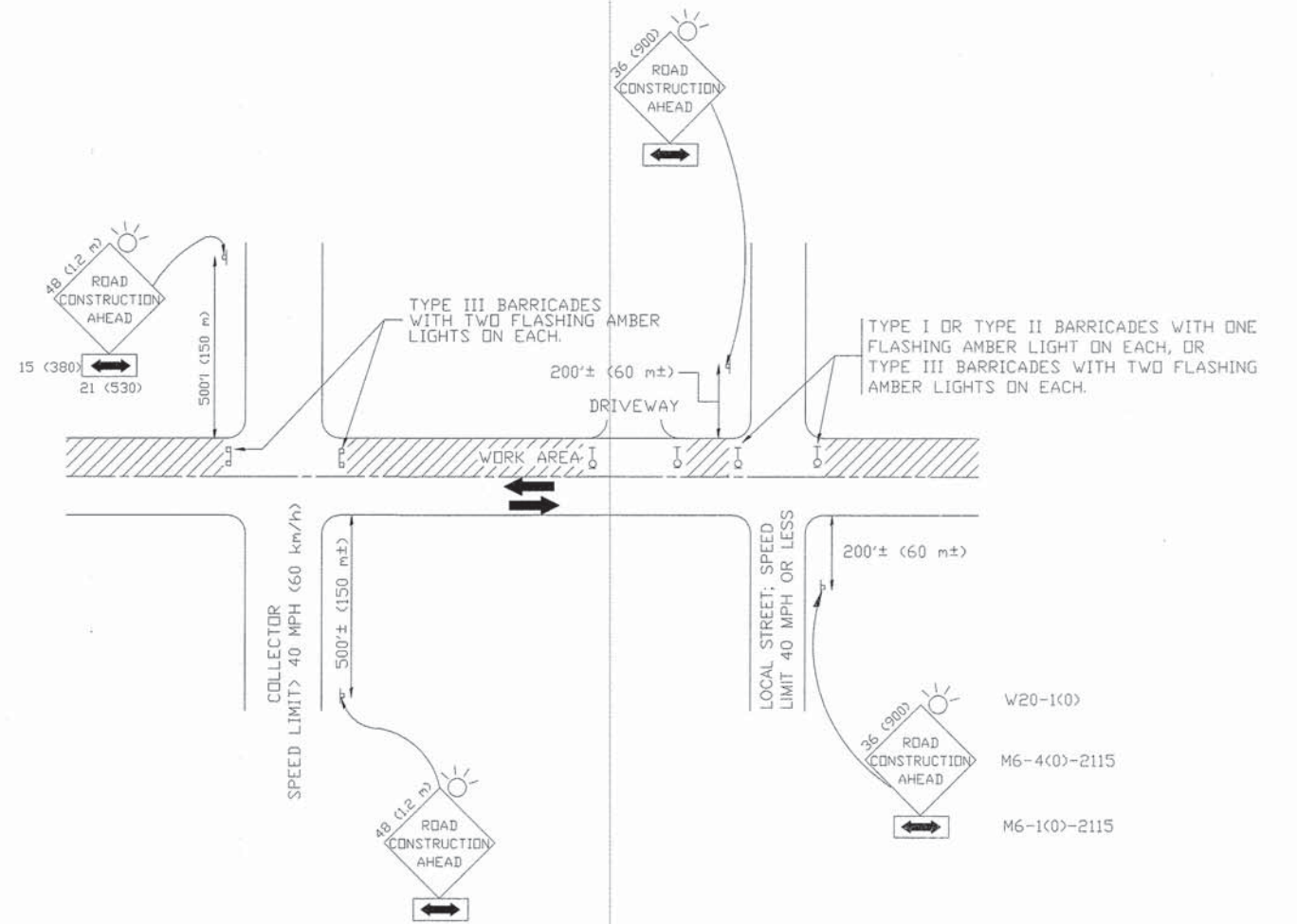

TRAFFIC CONTROL AND PROTECTION FOR SIDE ROADS, INTERSECTIONS, AND DRIVEWAYS

NOTES:

A. FOR NO LANE RESTRICTION ON THE SIDE ROAD OR DRIVEWAYS

1. SIDE ROAD WITH A SPEED LIMIT OF 40 MPH (60 km/h) OR LESS AS SHOWN ON THE DRAWING AND AS DIRECTED BY THE ENGINEER:
 - a) ONE ROAD CONSTRUCTION AHEAD SIGN 36 x 36 (900x900) WITH A FLASHER AND FLAG MOUNTED ON IT APPROXIMATELY 200' (60 m) IN ADVANCE OF THE MAIN ROUTE.
 - b) THE CLOSED PORTION OF THE MAIN ROUTE SHALL BE PROTECTED BY BLOCKING WITH TYPE I, TYPE II OR TYPE III BARRICADES, 1/3 OF THE CROSS SECTION OF THE CLOSED PORTION.
2. SIDE ROAD WITH A SPEED LIMIT GREATER THAN 40 MPH (60 km/h) AS SHOWN ON THE DRAWING AND AS DIRECTED BY THE ENGINEER:
 - a) ONE ROAD CONSTRUCTION AHEAD SIGN 48 x 48 (1.2 m x 1.2 m) WITH A FLASHER MOUNTED ON IT APPROXIMATELY 500' (150 m) IN ADVANCE OF THE MAIN ROUTE.
 - b) THE CLOSED PORTION OF THE MAIN ROUTE SHALL BE PROTECTED BY BLOCKING WITH TYPE III BARRICADES, 1/2 OF THE CROSS SECTION OF THE CLOSED PORTION.
3. WHEN THE SIDE ROAD LIES BETWEEN THE BEGINNING OF THE MAINLINE SIGNING AND THE WORK ZONE, A SINGLE HEADED ARROW (M6-1) SHALL BE USED IN LIEU OF THE DOUBLE HEADED ARROW (M6-4).

B. FOR A LANE CLOSURE ON A SIDE ROAD OR DRIVEWAY:

- USE APPLICABLE PORTIONS OF THE TYPICAL APPLICATION OF TRAFFIC CONTROL DEVICES (STD. 701501, STD. 701606 OR THE APPROPRIATE STANDARD). THE SPACING OF SIGNS AND BARRICADES SHALL BE ADJUSTED FOR FIELD CONDITIONS AS DIRECTED BY THE ENGINEER. THE DIRECTIONAL ARROW SHALL BE COVERED OR REMOVED WHEN NO LONGER CONSISTENT WITH THE SIDE ROAD LANE CLOSURE.
- C. ADVANCE WARNING SIGNS ARE TO BE OMITTED ON DRIVEWAY UNLESS OTHERWISE NOTED.
 - D. THE TRAFFIC CONTROL AND PROTECTION FOR SIDE ROADS, INTERSECTIONS, AND DRIVEWAYS SHALL BE INCIDENTAL TO THE COST OF SPECIFIED TRAFFIC CONTROL STANDARDS OR ITEMS.

All dimensions are in millimeters (inches) unless otherwise shown.

USER NAME =	DESIGNED - LHA	REVISED - J. OBERLE 10-18-95
PLOT SCALE =	DRAWN -	REVISED - A. HOUSEH 03-06-96
PLOT DATE =	CHECKED -	REVISED - A. HOUSEH 10-15-96
	DATE - 06-89	REVISED - T. RAMMACHER 01-06-00

**STATE OF ILLINOIS
DEPARTMENT OF TRANSPORTATION**

**TRAFFIC CONTROL AND PROTECTION FOR
SIDE ROADS, INTERSECTIONS, AND DRIVEWAYS**

SCALE: NONE SHEET NO. 1 OF 1 SHEETS STA. TO STA.

F.A.U. RTE.	SECTION	COUNTY	TOTAL SHEETS	SHEET NO.
--	14-00127-00-SW	COOK	16	13
TC-10			CONTRACT NO. 61B47	
FED. ROAD DIST. NO. 1 (ILLINOIS) FED. AID PROJECT				

EURE PROJECT NO. 154-14-9800

Drawing file: W:\Projects_by_Village\Brookfield\12514260 - Safe Routes to School\10_Xsect.dwg Feb 11, 2015 - 1:15pm

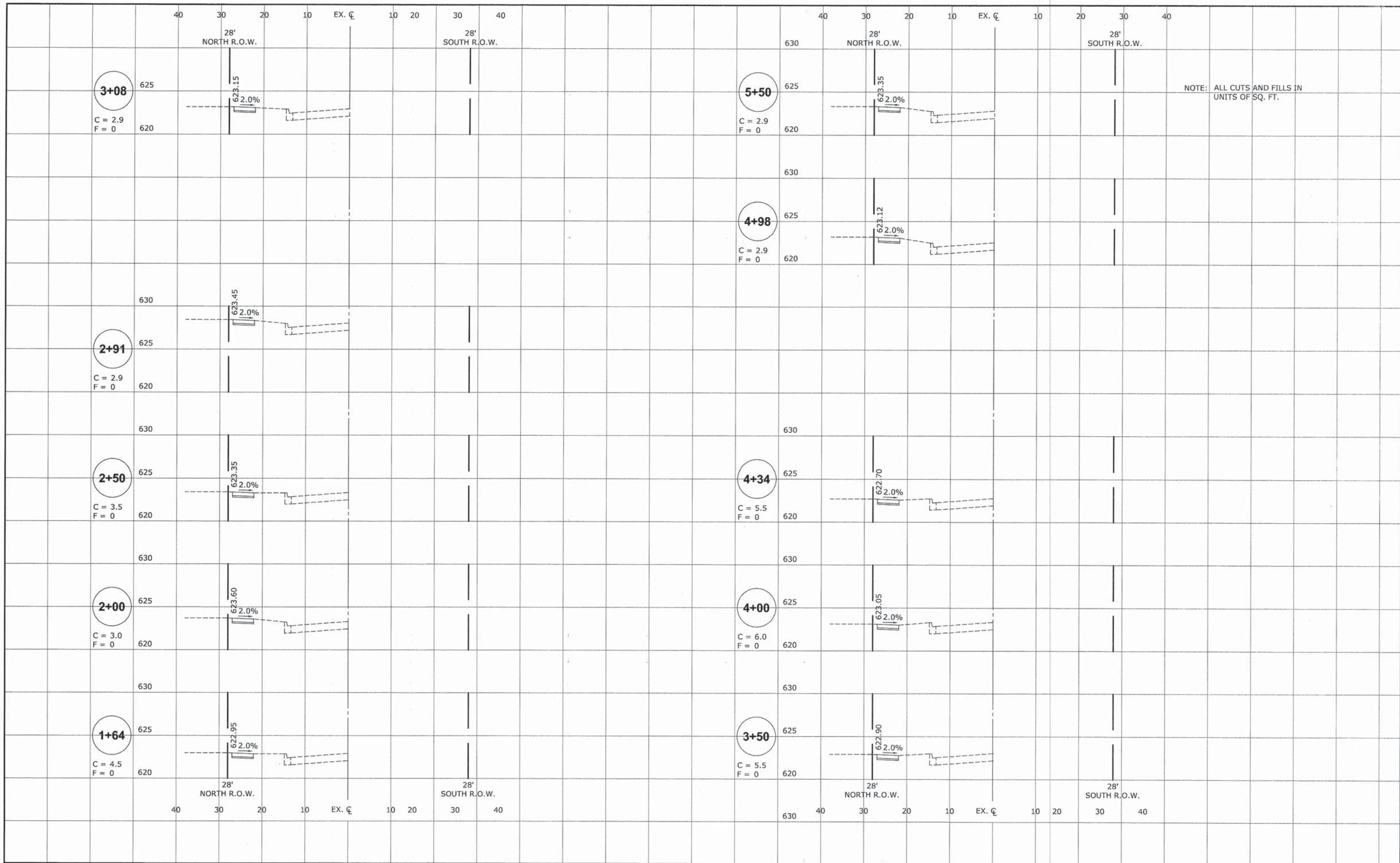

NOTE: ALL CUTS AND FILLS IN UNITS OF SQ. FT.

HANCOCK ENGINEERING
 Civil Engineers
 Municipal Consultants
 Established 1911

9933 Roosevelt Road
 Waukegan, Illinois 60156-2789
 Phone: 708/965-0300
 Fax: 708/965-1212

DESIGNED -	BPS	REVISED -	
DRAWN -	DMM	REVISED -	
CHECKED -	---	REVISED -	
DATE -	02/11/15	REVISED -	

**STATE OF ILLINOIS
 DEPARTMENT OF TRANSPORTATION**

**STATION CROSS SECTIONS
 CONGRESS PARKWAY**

SCALE: 1"=10'H 1"=5'V SHEET NO. 1 OF 3 SHEETS STA. 1+64 TO STA. 5+50

F.A.U. RTE.	SECTION	COUNTY	TOTAL SHEETS	SHEET NO.
---	14-00127-00-SW	COOK	16	14
FIELD BOOK NO.:		CONTRACT NO. 61B47		
FED. ROAD DIST. NO. 1		ILLINOIS FED. AID PROJECT		

Drawing file: W:\Projects_by_Village\Brookfield\12514280 - Safe Routes to School\10_Asects.dwg Feb 11, 2015 - 11:15pm

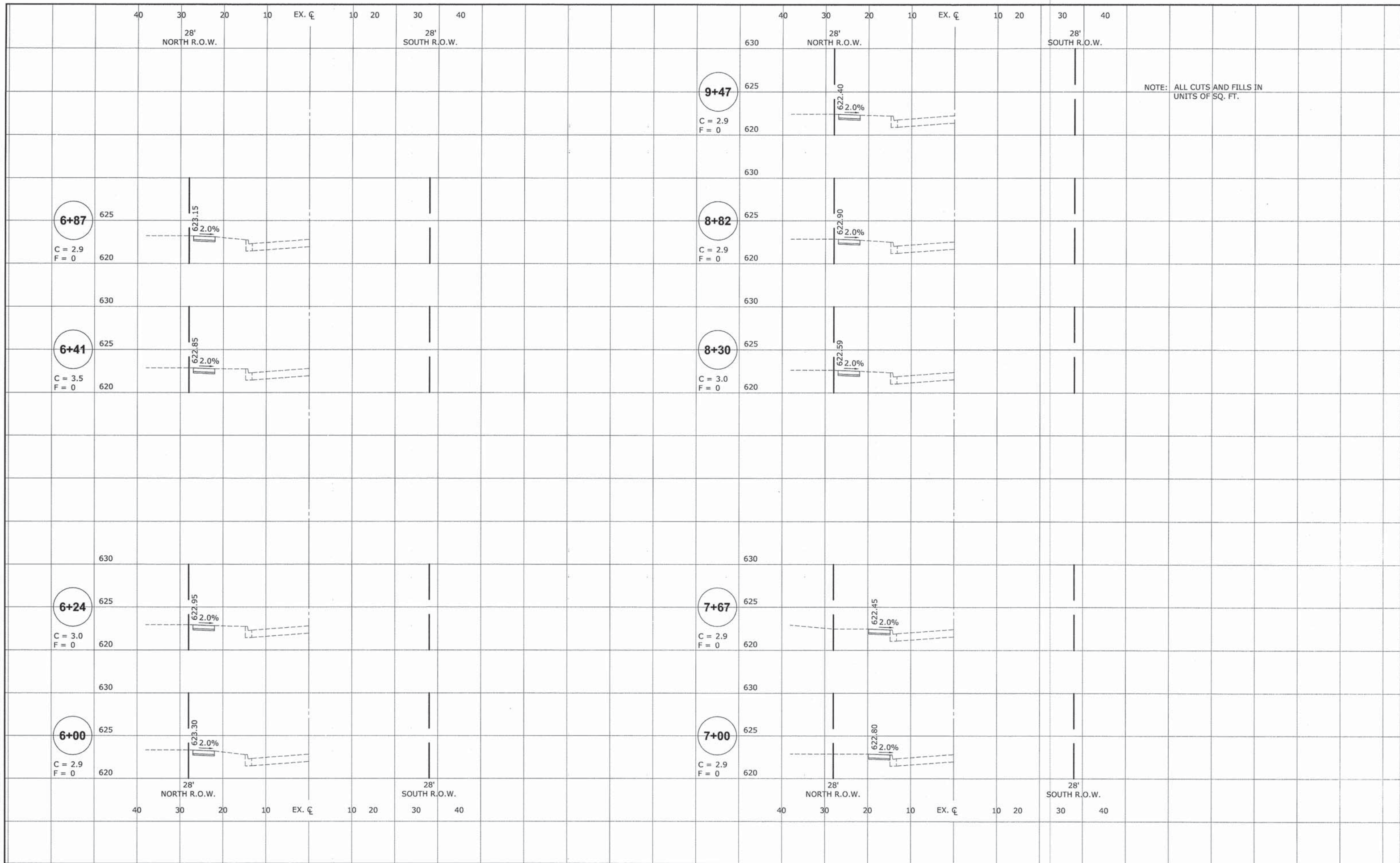

NOTE: ALL CUTS AND FILLS IN UNITS OF SQ. FT.

HANCOCK ENGINEERING

- Civil Engineers
- Municipal Consultants
- Established 1911

9933 Roosevelt Road
Westchester, Illinois 60154-2780
Phone: 708.965-0300
Fax: 708.965-1212

DESIGNED -	BPS	REVISED -	
DRAWN -	DMM	REVISED -	
CHECKED -	---	REVISED -	
DATE -	02/11/15	REVISED -	

**STATE OF ILLINOIS
DEPARTMENT OF TRANSPORTATION**

**STATION CROSS SECTIONS
CONGRESS PARKWAY**

SCALE: 1"=10'H 1"=5'V SHEET NO. 2 OF 3 SHEETS STA. 6+00 TO STA. 9+47

F.A.U. RTE.	SECTION	COUNTY	TOTAL SHEETS	SHEET NO.
---	14-00127-00-SW	COOK	16	15
FIELD BOOK NO.:		CONTRACT NO. 61B47		
FED. ROAD DIST. NO. 1		ILLINOIS FED. AID PROJECT		

Drawing file: W:\Projects_by_Village\Broadfield\12514280 - Safe Routes to School\10_Xsects.dwg Feb 11, 2015 - 11:59am

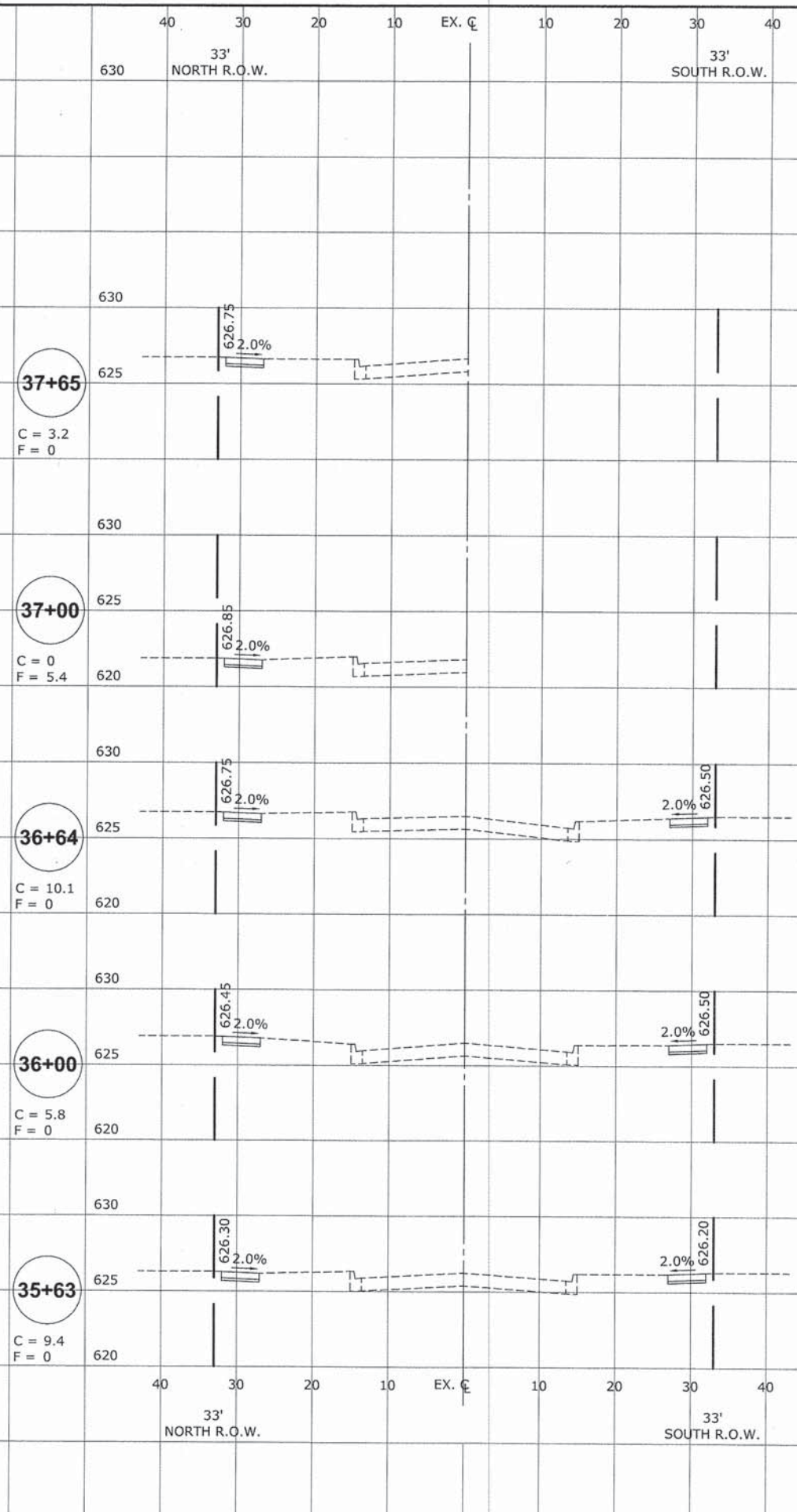
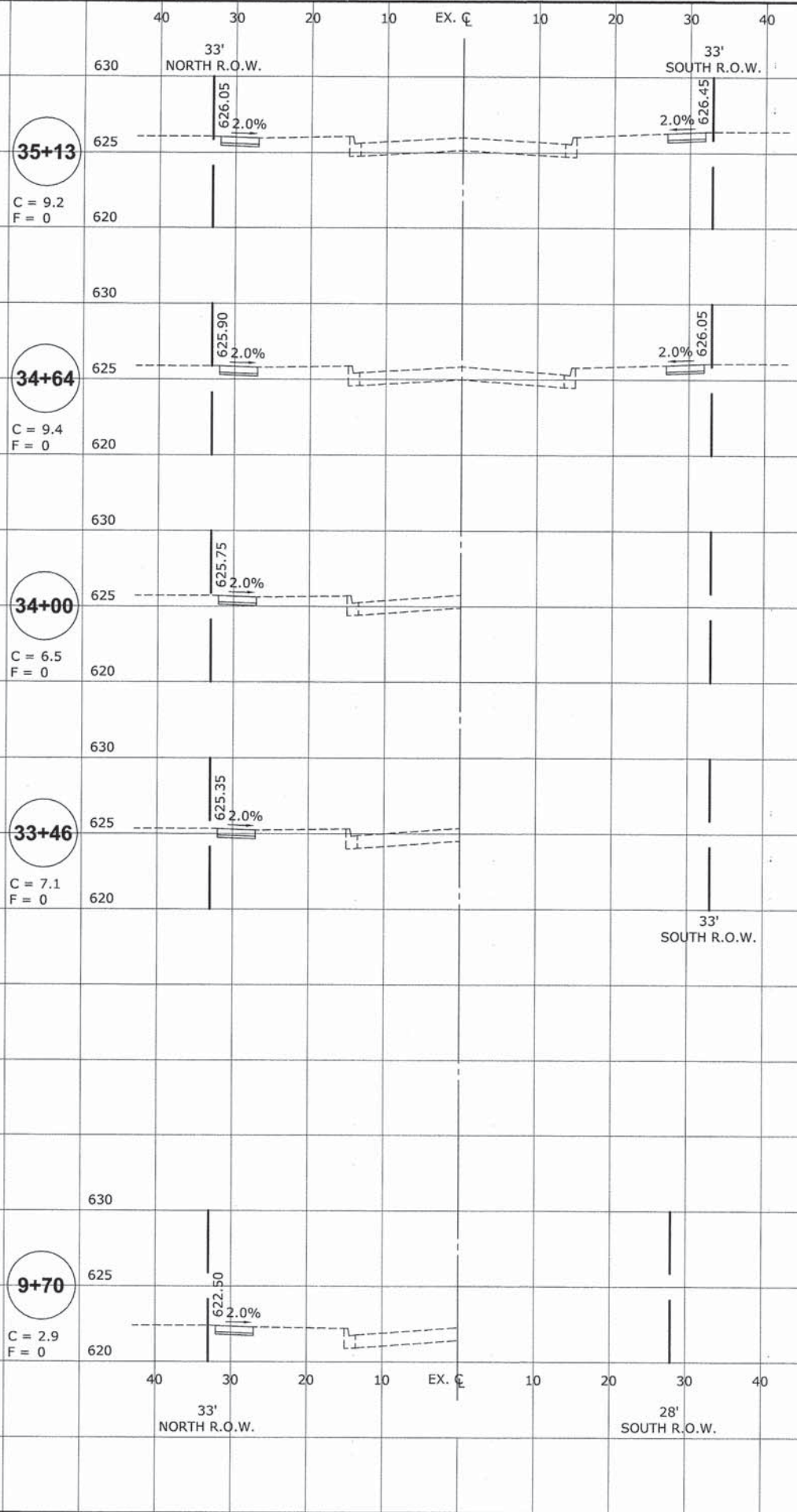

NOTE: ALL CUTS AND FILLS IN UNITS OF SQ. FT.

HANCOCK ENGINEERING
 Civil Engineers
 Municipal Consultants
 Established 1911

9333 Roosevelt Road
 Westchester, Illinois 60154-2780
 Phone: 708/965-0300
 Fax: 708/965-1212

DESIGNED - BPS	REVISED -
DRAWN - DMM	REVISED -
CHECKED -	REVISED -
DATE - 02/11/15	REVISED -

**STATE OF ILLINOIS
DEPARTMENT OF TRANSPORTATION**

**STATION CROSS SECTIONS
CONGRESS PARKWAY**

SCALE: 1"=10'H 1"=5' V SHEET NO. 3 OF 3 SHEETS STA. - TO STA. -

F.A.U. RTE.	SECTION	COUNTY	TOTAL SHEETS	SHEET NO.
---	14-00127-00-SW	COOK	16	16
FIELD BOOK NO.:		CONTRACT NO. 61B47		
FED. ROAD DIST. NO. 1		ILLINOIS FED. AID PROJECT		