

CO. HWY#	SECTION	COUNTY	TOTAL SHEETS	SHEET NO.
14	15-00027-06-RS	McLEAN	12	1

CONTRACT NO. 91585

INDEX OF SHEETS

- 1 Cover Sheet
- 2 Summary Of Quantities
- 3 Existing Cross Sections
- 4-5 Proposed Cross Sections
- 6 Intersection Details
- 7 Typical Details
- 8-12 Plan View Sheets

STATE OF ILLINOIS
DEPARTMENT OF TRANSPORTATION
PROPOSED PLANS

F.A.S. ROUTE 484
15-00027-06-RS
RESURFACE
McLEAN COUNTY
TOWANDA EAST (C.H. 14)
JOB: C-95-055-19
PROJECT# 08L5 (901)
FUNDING: STR, MATCH, MFT, HSIP



LOCATION OF SECTION INDICATED THUS: — —

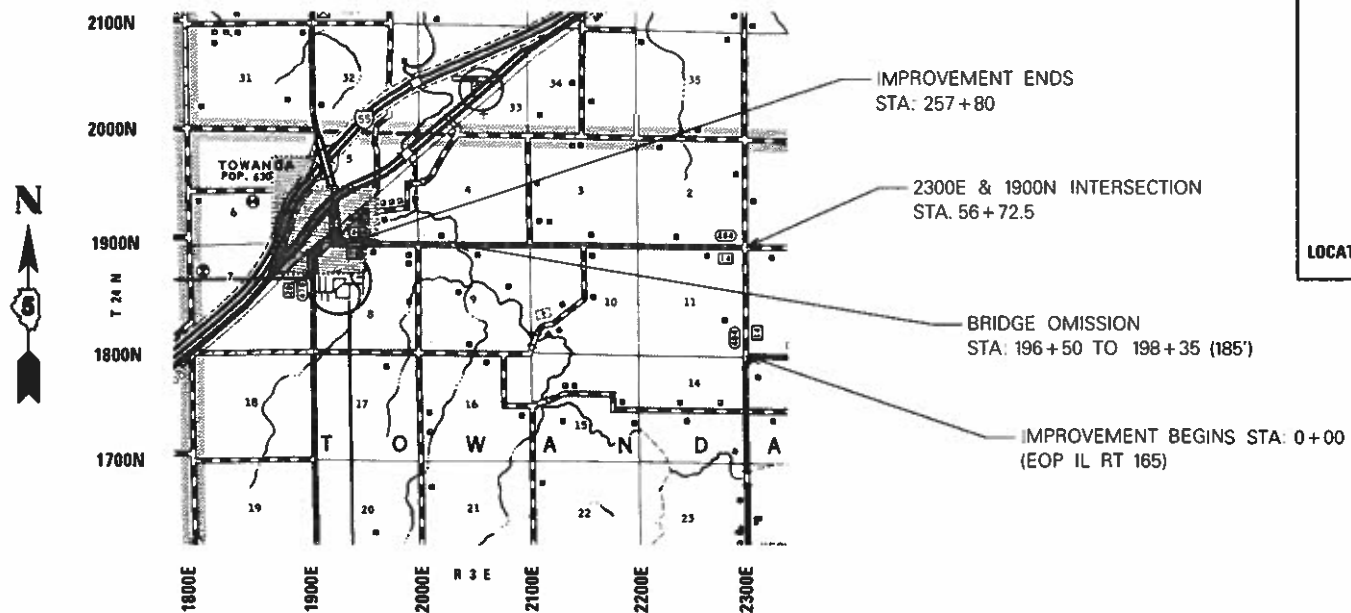

PRINTED BY THE AUTHORITY
OF THE STATE OF ILLINOIS

STATE OF ILLINOIS
DEPARTMENT OF TRANSPORTATION

APPROVED FEBRUARY 25 20 20
Jerry Stokes
COUNTY ENGINEER

PASSED MARCH 4 20 20
[Signature]
DISTRICT FIVE ENGINEER OF
LOCAL ROADS & STREETS

Releasing For Bid Based on Limited Review March 3 20 20
[Signature]
REGION THREE ENGINEER

STATE OF ILLINOIS
DEPARTMENT OF TRANSPORTATION



- NOTE: THE TOTAL LENGTH OF THE PROPOSED PROJECT IS 25,780 FEET (4.88 MILES) WITH A NET LENGTH OF 25,595 FEET (4.85 MILES)
- NOTE: THESE PLANS MEET THE MINIMUM REQUIREMENTS FOR A 3R IMPROVEMENT.
- NOTE: CURRENT ADT: 750
FUNCTIONAL CLASSIFICATION: MAJOR COLLECTOR

THESE PLANS ARE NOT TO SCALE

J.U.L.I.E.
JOINT UTILITY LOCATION INFORMATION FOR EXCAVATION
1-800-892-0123

CONTRACT NO. 91585

SUMMARY OF QUANTITIES

0005 0021

ITEM NUMBER	ITEM	UNIT	TOTAL QUANTITY	STR /LOCAL	HSIP
20200500	EARTH EXCAVATION (WIDENING)	CU YD	1,312	-	1,312
35600650	HOT-MIX ASPHALT BASE COURSE WIDENING, 4"	SQ YD	11,924	-	11,924
40600290	BITUMINOUS MATERIALS (TACK COAT)	POUND	46,700	38,651	8,049
40600990	TEMPORARY RAMPS	SQ YD	225	225	-
40602965	HOT-MIX ASPHALT BINDER COURSE, IL-9.5FG, N50	TON	7,350	6,181	1,169
40604050	HOT-MIX ASPHALT SURFACE COURSE, IL-9.5, MIX "C", N50	TON	6,250	5,248	1,002
40800029	BITUMINOUS MATERIALS (TACK COAT)	POUND	1,000	1,000	-
40800050	INCIDENTAL HOT-MIX ASPHALT SURFACING	TON	430	430	-
44000155	HOT-MIX ASPHALT SURFACE REMOVAL, 1 1/2"	SQ YD	62,414	62,414	-
48102100	AGGREGATE WEDGE SHOULDER, TYPE B	TON	2,000	2,000	-
64200108	SHOULDER RUMBLE STRIPS, 8 INCH	FOOT	35,142	-	35,142
67100100	MOBILIZATION	L. SUM	1	1	-
Δ 78001110	PAINT PAVEMENT MARKING - LINE 4"	FOOT	51,388	51,388	-
Δ 78100100	RAISED REFLECTIVE PAVEMENT MARKERS	EACH	328	328	-
X4401198	HOT-MIX ASPHALT SURFACE REMOVAL, VARIABLE DEPTH	SQ YD	240	240	-
X7010216	TRAFFIC CONTROL AND PROTECTION (SPECIAL)	L. SUM	1	1	-
Z0033700	LONGITUDINAL JOINT SEALANT	FOOT	25,060	25,060	-

Δ SPECIALTY ITEMS

STATE STANDARD DETAILS

- 000001-07 STANDARD SYMBOLS, ABBREVIATIONS AND PATTERNS
- 001006 DECIMAL OF AN INCH AND FOOT
- 642006 SHOULDER RUMBLE STRIPS 8IN.
- 701001-02 OFF-RD OPERATIONS, 2L, 2W MORE THAN 15' AWAY
- 701006-05 OFF-RD OPERATIONS, 2L, 2W, 15' TO 24" FROM PAVEMENT EDGE
- 701011-04 OFF-RD MOVING OPERATIONS, 2L, 2W, DAY ONLY
- 701201-05 LANE CLOSURE, 2L, 2W DAY ONLY, FOR SPEEDS > 45 MPH
- 701301-04 LANE CLOSURE, 2L, 2W SHORT TIME OPERATIONS
- 701306-04 LANE CLOSURE, 2L, 2W, SLOW MOVING OPERATIONS DAY ONLY, FOR SPEEDS > 45 MPH
- 701326-04 LANE CLOSURE, 2L, 2W, PAVEMENT WIDENING, FOR SPEEDS > 45 MPH
- 701901-08 TRAFFIC CONTROL DEVICES
- B.L.R. 18-6 TRAFFIC CONTROL DEVICES-DAY LABOR MAINTENANCE

PAVING SCHEDULE		
2" BINDER	1-3/4" BINDER	3' WIDENING
0+50 - 56+00 (20')	57+50 - 195+04 (28')	56+00, LT - 237+63, LT
	199+77 - 237+63 (28')	57+00, RT - 237+63, RT
	237+63 - 257+33 (22')	

	Binder	Base Cse.	Incidental	Surface
PG Grade	PG 64-22	PG 64-22	PG 64-22	PG 64-22
Design Air	4.0% @	4.0% @	4.0% @	4.0% @
Voids	N50	N50	N50	N50
Mixture Composition	IL-9.5 FG	IL-19	IL 9.5	IL 9.5
Friction				
Aggregate	N/A	N/A	Mixture C	Mixture C
Mixture Weight	112	112	112	112
Quality Management Program	QC/QA	QC/QA	QC/QA	QC/QA
Method	Correlation	Nuclear Comparison	-	Correlation

** For the allowable RAP/FRAP percentages, see BDE 80306 Reclaimed Asphalt Pavement and Reclaimed Asphalt Shingles.

EXISTING TYPICAL CROSS SECTION

SEC 15-00027-06-RS
 TOWANDA EAST (C.H. 14)
 STA. 0+00 TO STA. 56+72.5
 (NOT TO SCALE)

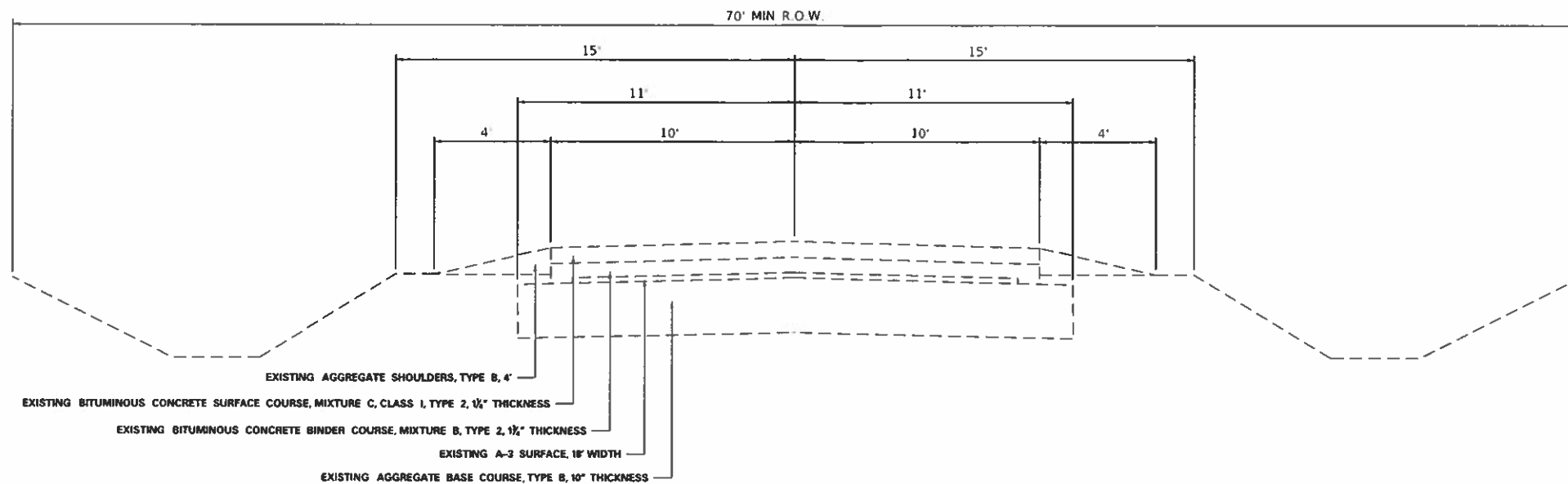

EXISTING TYPICAL CROSS SECTION

SEC 15-00027-06-RS
 TOWANDA EAST (C.H. 14)
 STA. 56+72.5 TO STA. 257+80
 (NOT TO SCALE)

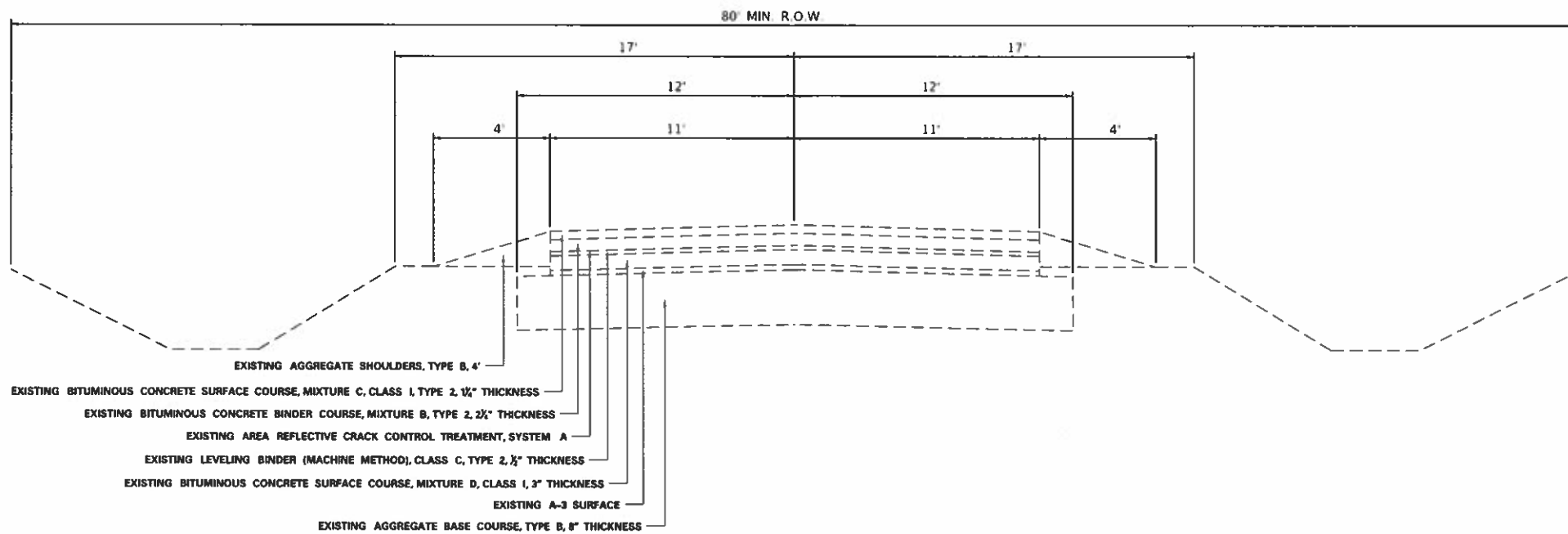

MODIFIED: DeQua
 FILE NAME: X:\Growth\Bids\CH 14\15-00027-06-RS - Towanda East - 2020\Drawings\Ch14Plan_Sheets\15-00027-06-RS_Cross_Sections.dgn

USER NAME	colin trantz	DESIGNED	-	REVISED	-
PLOT SCALE	1/20,000' = 1" = 100'	DRAWN	-	REVISED	-
PLOT DATE	3/24/2020	CHECKED	-	REVISED	-
		DATE	-	REVISED	-

**STATE OF ILLINOIS
 DEPARTMENT OF TRANSPORTATION**

**EXISTING TYPICAL
 CROSS SECTIONS**

SCALE: SHEET 3 OF 12 SHEETS STA. TO STA.

F.A.S. RTE	SECTION	COUNTY	TOTAL SHEETS	SHEET NO.
484	15-00027-06-RS	MCLEAN	12	3
CONTRACT NO. 91585				
ILLINOIS FED. AID PROJECT				

PROPOSED TYPICAL CROSS SECTION

SEC 15-00027-06-RS
TOWANDA EAST (C.H. 14)
STA. 0+00 TO STA. 56+72.5
(NOT TO SCALE)

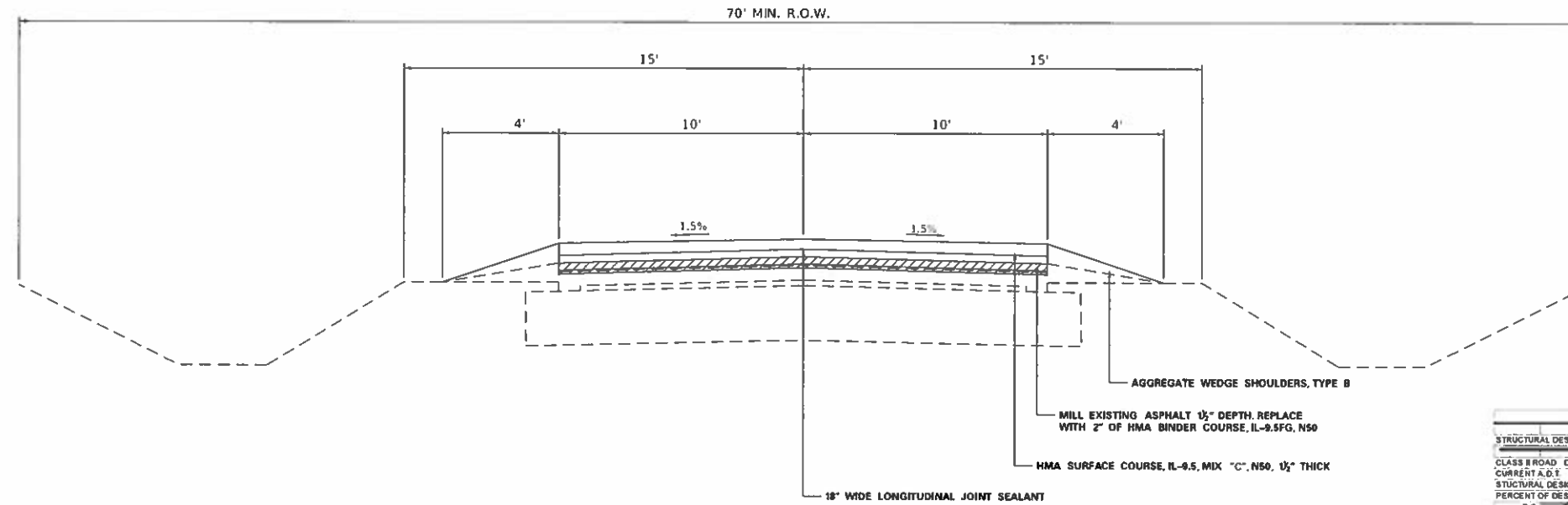

PROPOSED TYPICAL CROSS SECTION

SEC 15-00027-06-RS
TOWANDA EAST (C.H. 14)
STA. 56+72.5 TO STA. 196+50 (BRIDGE OMISSION 185')
STA. 198+35 TO STA. 237+63
(NOT TO SCALE)

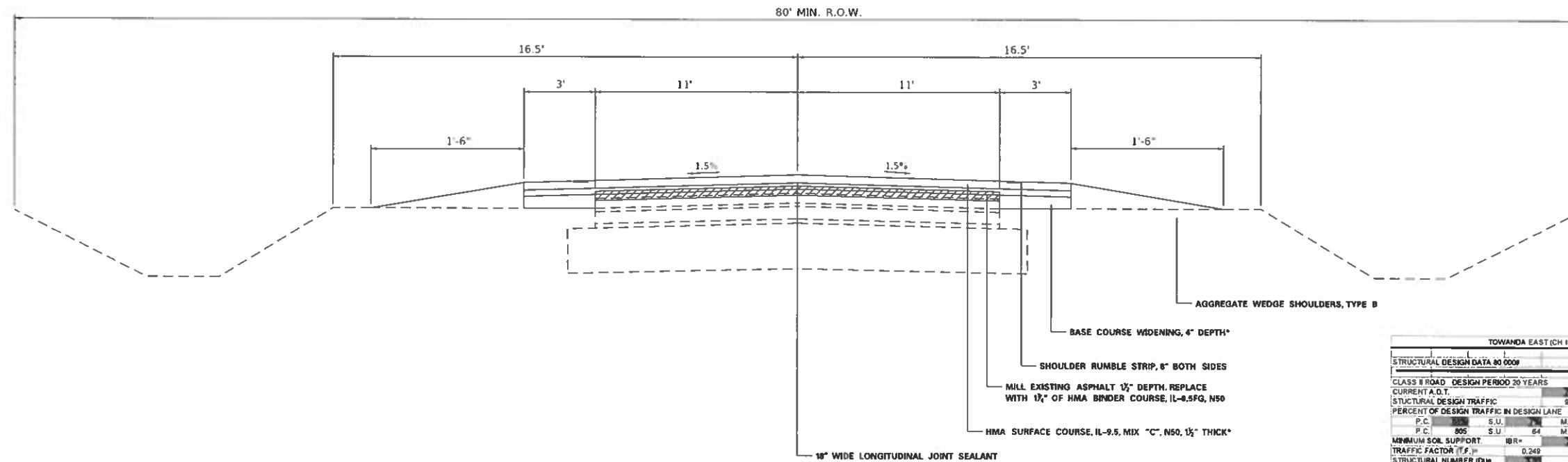

NOTES: EARTH EXCAVATION (WIDENING) TO BE PLACED ADJACENT TO WIDENING TRENCH AS SHOULDER MATERIAL.
BINDER AND SURFACE COURSE TO BE PLACED THE FULL LANE WIDTH (14').

TOWANDA EAST (CH 14) - STA 0+00 TO STA 56+72.5

STRUCTURAL DESIGN DATA 80 0000			
CLASS II ROAD	DESIGN PERIOD	20 YEARS	
CURRENT A.D.T.		331	YEAR 2018
STRUCTURAL DESIGN TRAFFIC			
PERCENT OF DESIGN TRAFFIC IN DESIGN LANE			
P.C.	S.U.	M.U.	
292	23	17	
MINIMUM SOIL SUPPORT	IBR=		
	3.4		
TRAFFIC FACTOR (T.F.)		0.080	
STRUCTURAL NUMBER (SN)		3.25	
PAVEMENT STRUCTURE MATERIALS			
SURFACE	PROPOSED BITUMINOUS CONCRETE	1.5	a1= 1.40
BASE	EXISTING BITUMINOUS CONCRETE	4	a2= 0.80
BASE	EXISTING BITUMINOUS CONCRETE	1.5	a3= 0.45
SUBBASE	EXISTING AGGREGATE BASE COURSE	12	a4= 1.00
PROPOSED DI TOTAL			2.85

TOWANDA EAST (CH 14) - STA 56+72.5 TO 257+80

STRUCTURAL DESIGN DATA 80 0000			
CLASS II ROAD	DESIGN PERIOD	20 YEARS	
CURRENT A.D.T.		915	YEAR 2018
STRUCTURAL DESIGN TRAFFIC			
PERCENT OF DESIGN TRAFFIC IN DESIGN LANE			
P.C.	S.U.	M.U.	
805	64	48	
MINIMUM SOIL SUPPORT	IBR=		
	3.4		
TRAFFIC FACTOR (T.F.)		0.249	
STRUCTURAL NUMBER (SN)		3.30	
PAVEMENT STRUCTURE MATERIALS			
SURFACE	PROPOSED BITUMINOUS CONCRETE	1.5	a1= 1.30
BASE	EXISTING BITUMINOUS CONCRETE	3.5	a2= 0.75
BASE	EXISTING BITUMINOUS CONCRETE	1	a3= 0.60
SUBBASE	EXISTING AGGREGATE BASE COURSE	10	a4= 0.80
PROPOSED DI TOTAL			3.54

MODEL: Tdcbp
FILE NAME: X:\CountyRoads\CH 14\15-00027-06-RS - Towanda East - 2020\Drawings\CH 14\15-00027-06-RS Cross Sections.dwg

USER NAME = cbl/n/w/z	DESIGNED - _____	REVISED - _____
PLOT SCALE = 1/20,000' = 1" = 200'	DRAWN - _____	REVISED - _____
PLOT DATE = 2/26/2020	CHECKED - _____	REVISED - _____
	DATE - _____	REVISED - _____

**STATE OF ILLINOIS
DEPARTMENT OF TRANSPORTATION**

**PROPOSED TYPICAL
CROSS SECTIONS**

F.A.S. R.I.E.	SECTION	COUNTY	TOTAL SHEETS	SHEET NO.
484	15-00027-06-RS	MCLEAN	12	4
CONTRACT NO. 91585				
ILLINOIS FED. AID PROJECT				

SCALE _____ SHEET 4 OF 12 SHEETS STA. _____ TO STA. _____

PROPOSED TYPICAL CROSS SECTION

SEC 15-00027-06-RS
TOWANDA EAST (C.H. 14)
STA. 237+63 TO STA. 257+80
(NOT TO SCALE)

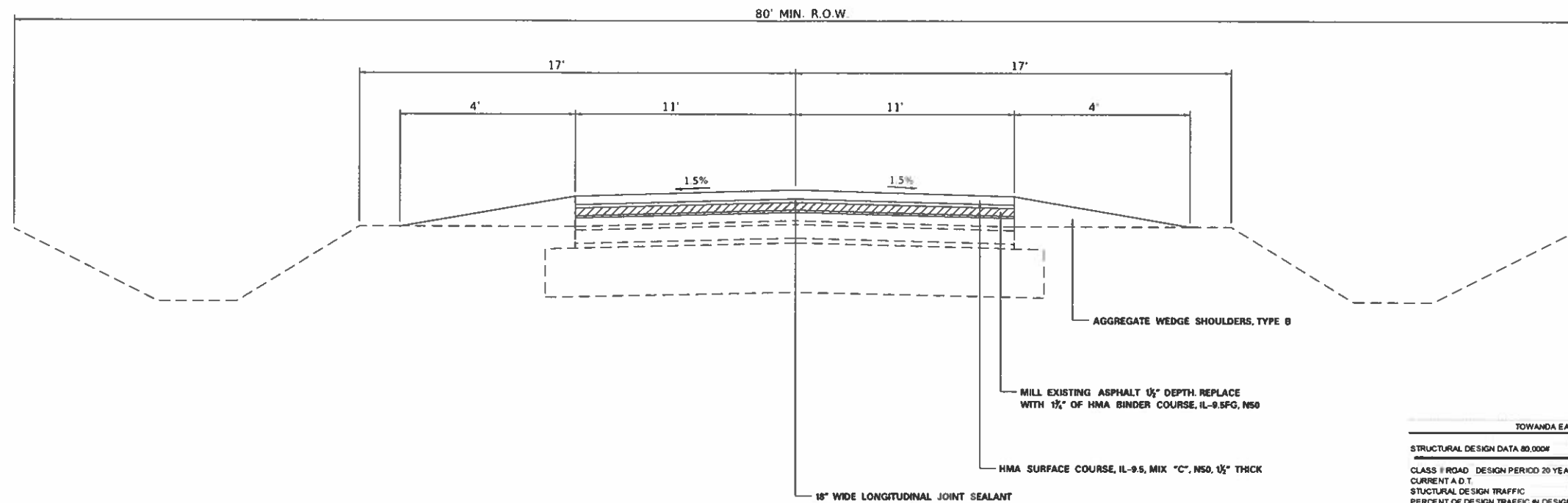

TOWANDA EAST (CH 14) - STA 237+63 TO 257+80

STRUCTURAL DESIGN DATA 80,000#			
CLASS # ROAD	DESIGN PERIOD	20 YEARS	
CURRENT A.D.T.		915	YEAR 2030
STRUCTURAL DESIGN TRAFFIC			
PERCENT OF DESIGN TRAFFIC IN DESIGN LANE			
P.C.	S.U.	M.U.	
85	64	46	
MINIMUM SOIL SUPPORT	BR#	3.0	
TRAFFIC FACTOR (T.F.)		0.240	
STRUCTURAL NUMBER (DN)		3.98	
PAVEMENT STRUCTURE MATERIALS			
SURFACE	PROPOSED BITUMINOUS CONCRETE	3.25 @ 0.40	a1= 1.30
BASE	EXISTING BITUMINOUS CONCRETE	2.5 @ 0.30	a2= 0.75
BASE	EXISTING BITUMINOUS CONCRETE	1 @ 0.25	a3= 0.60
SUBBASE	EXISTING AGGREGATE BASE COURSE	1 @ 0.10	a5= 0.60
PROPOSED DN TOTAL			3.54

STATE OF ILLINOIS
DEPARTMENT OF TRANSPORTATION

PROPOSED TYPICAL
CROSS SECTIONS

F.A.S. RTE	SECTION	COUNTY	TOTAL SHEETS	SHEET NO.
484	15-00027-06-RS	MCLEAN	12	5
				CONTRACT NO. 91585
ILLINOIS FED. AID PROJECT				

USER NAME	DESIGNED	REVISED
COBIN FAMILY	-	-
DRAWN	CHECKED	REVISED
-	-	-
DATE	DATE	REVISED
-	-	-

SCALE: _____ SHEET 5 OF 12 SHEETS STA. _____ TO STA. _____

MODEL: Delaur
FILE NAME: X:\CountyRoads\SCH 1413-00027-06-RS -Towanda East - 2020\Design\SubPlan_Stage\15-00027-06-RS_Cross Sections.dgn

IL ROUTE 165 INTERSECTION DETAIL

SEC 15-00027-06-RS
TOWANDA EAST (C.H. 14)
(NOT TO SCALE)

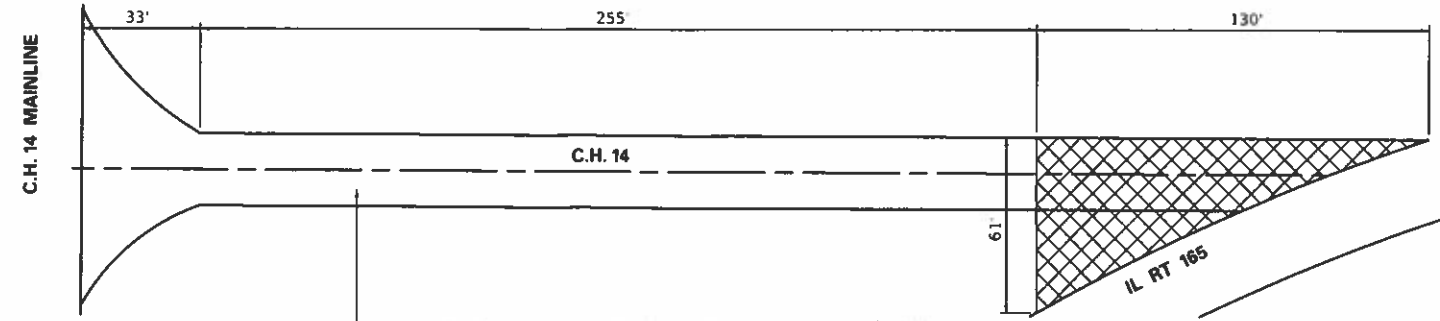

C.H. 14 HEADING EAST TOWARDS IL RT 165 SHALL BE PAVED 1 1/2" THICK ON EXISTING PAVEMENT AND PAID FOR USING INCIDENTAL HMA SURFACING QUANTITY.



2300E RD & 1900N RD INTERSECTION DETAIL

SEC 15-00027-06-RS
TOWANDA EAST (C.H. 14)
(NOT TO SCALE)

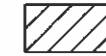
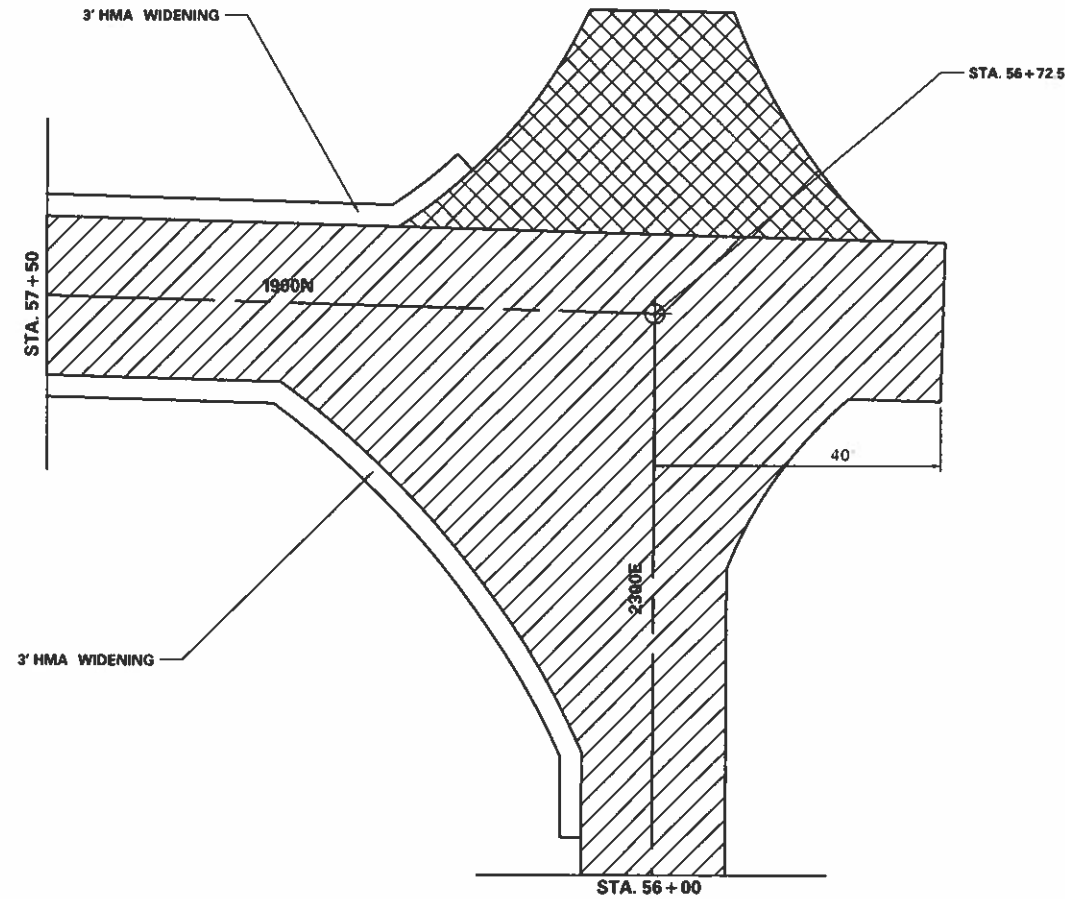

HMA SURFACE REMOVAL 1 1/2" REPLACE WITH 1 1/2" HMA SURFACE



HMA SURFACE REMOVAL 1 1/2" REPLACE WITH 1 1/2" INCIDENTAL HMA SURFACE

STATE OF ILLINOIS
DEPARTMENT OF TRANSPORTATION

INTERSECTION
DETAILS

F.A.S. RTE	SECTION	COUNTY	TOTAL SHEETS	SHEET NO.
484	15-00027-06-RS	MCLEAN	12	6

SCALE: SHEET 6 OF 12 SHEETS STA. TO STA.

ILLINOIS FED. AID PROJECT

USER NAME = cch@tranz	DESIGNED -	REVISED -
PLOT SCALE = 1/200000'	DRAWN -	REVISED -
PLOT DATE = 2/24/2020	CHECKED -	REVISED -
	DATE -	REVISED -

TYPICAL RURAL PRIVATE ENTRANCE

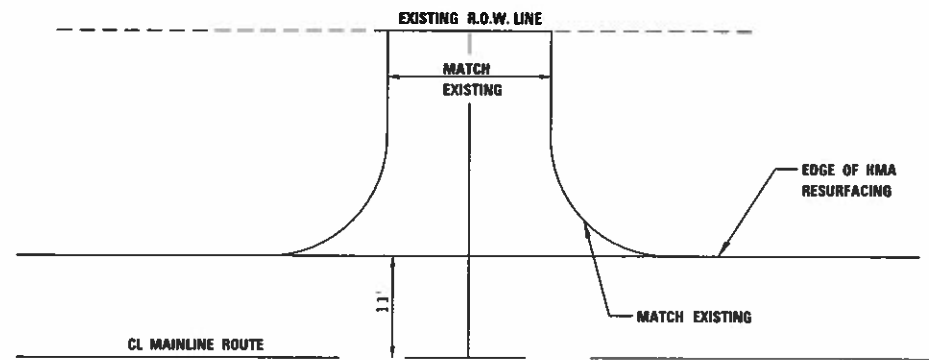

PLAN A

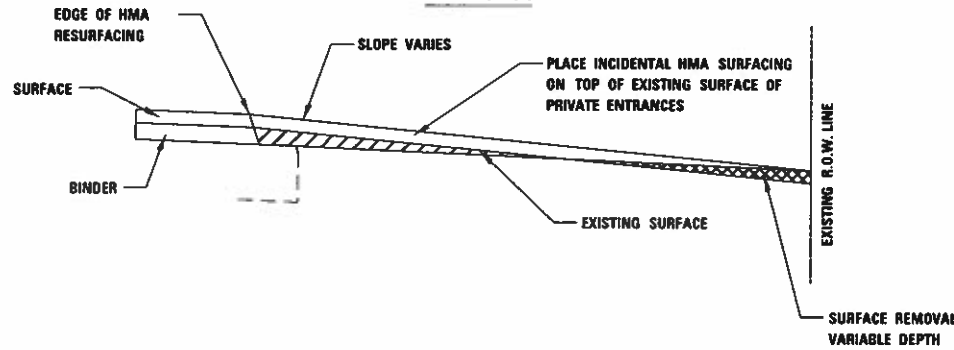

PROFILE A

TYPICAL FIELD ENTRANCE

13.8 SQ YDS (TYP.)

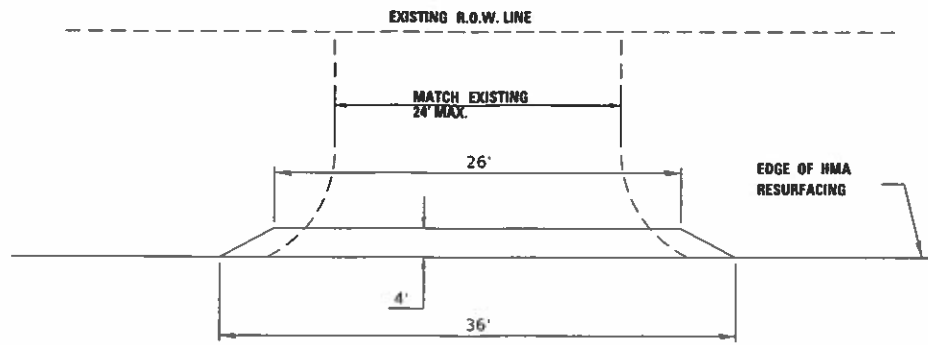

PLAN B

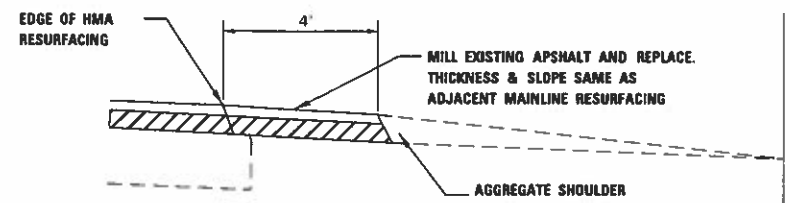

PROFILE B

TYPICAL RURAL MAILBOX TURNOUT

41 SQ YD EACH (TYP.)

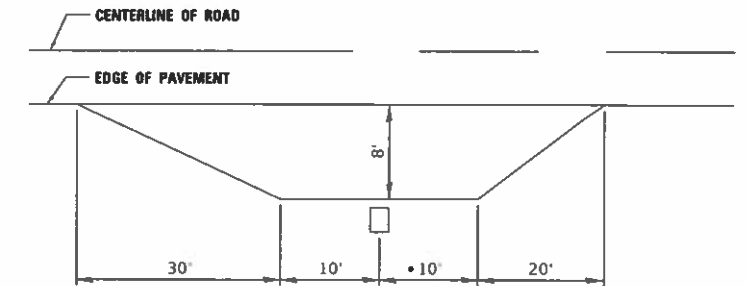

*NOTE: MULTIPLE MAILBOX CLUSTERS TO BE EXTENDED 2' FOR EACH ADDITIONAL MAILBOX

PLAN C

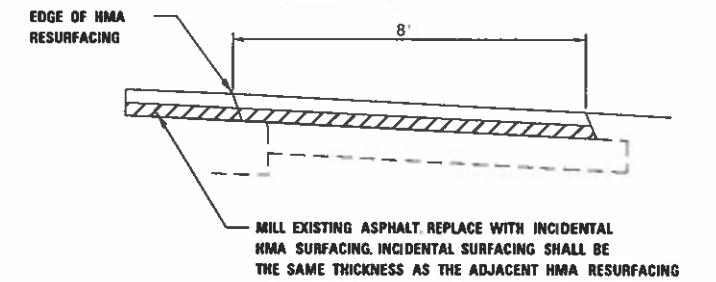

PROFILE C

TYPICAL SIDE ROAD DETAIL

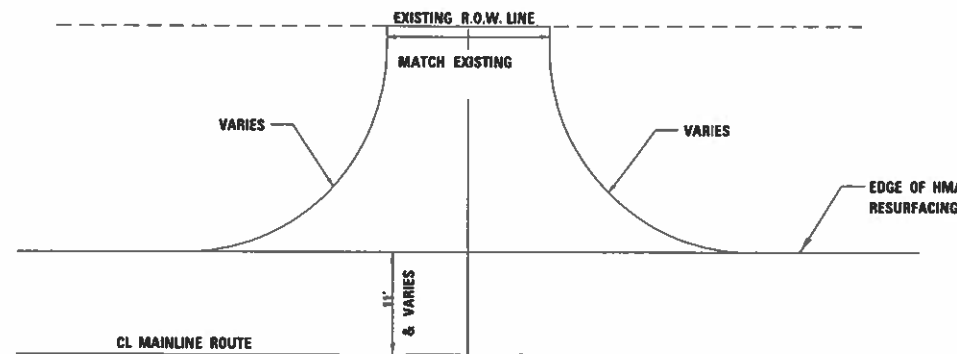

PLAN D

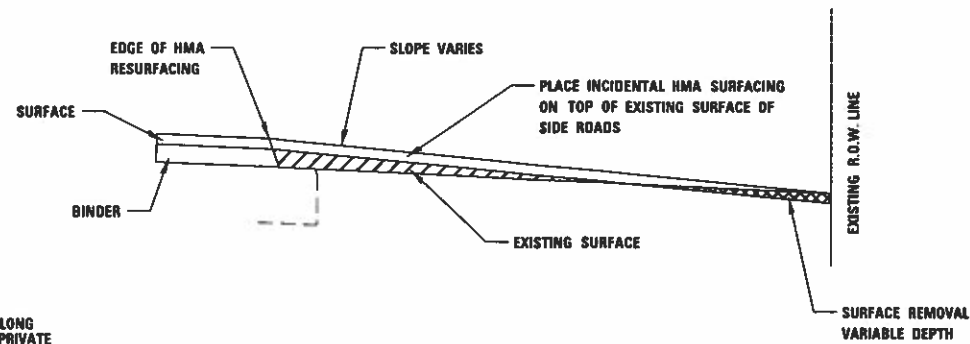

PROFILE D

NOTES:

1. ALL TEMPORARY STRIPING WILL BE DONE BY OTHERS.
2. ALL FIELD ENTRANCES SHALL BE CONSTRUCTED WITH THE EXTENDABLE SCREED WIDENER AND PAID FROM HOT-MIX ASPHALT BINDER AND SURFACE COURSES.
3. ALL SIDE ROAD RETURNS, PRIVATE ENTRANCES, COMMERCIAL ENTRANCES AND RURAL MAILBOX TURNOUTS ARE TO BE CONSTRUCTED AND PAID FROM INCIDENTAL HOT-MIX ASPHALT SURFACING.
4. AGGREGATE SHOULDERS SHALL BE PLACED ALONG ALL SIDEROAD RETURN RADII AND SHALL BE PLACED ALONG AND BEHIND ALL FIELD ENTRANCES, GUADRIL AND GUADRIL RUNOUTS, MAILBOX TURNOUTS AND ALL PRIVATE AND COMMERCIAL ENTRANCES UNLESS SPECIFIED BY THE RESIDENT ENGINEER.

STATE OF ILLINOIS
DEPARTMENT OF TRANSPORTATION

TYPICAL DETAILS

F.A.S RTE	SECTION	COUNTY	TOTAL SHEETS	SHEET NO.
484	15 00027-06-R5	MCLEAN	12	7
COUNTY HIGHWAY 14		CONTRACT NO. 91585		
FED. ROAD DIST. NO. 5 ILLINOIS FED. AID PROJECT				

SCALE: SHEET 7 OF 16 SHEETS STA. TO STA.

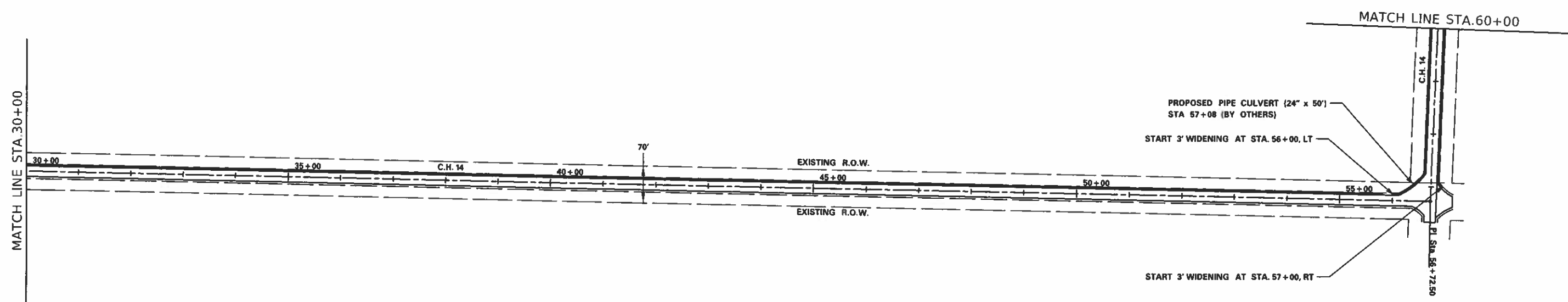
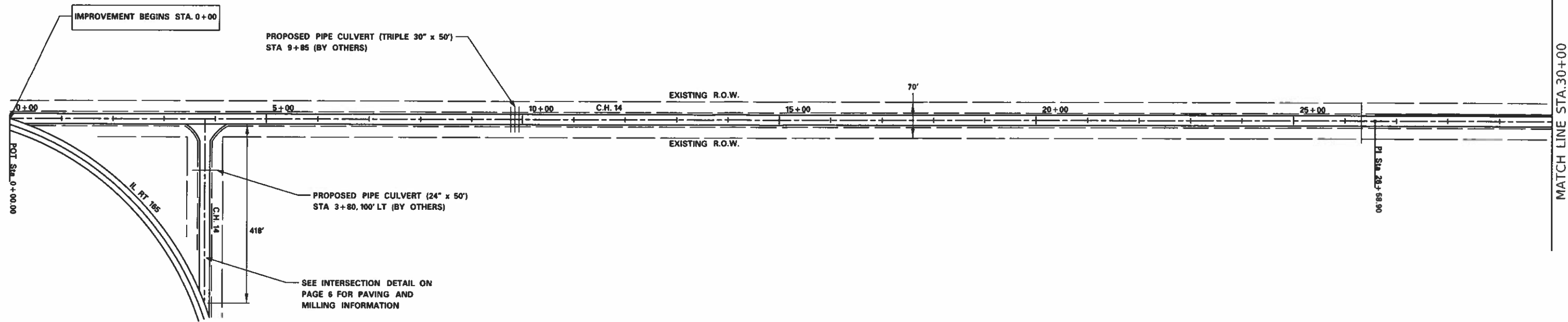

MDPFI - Default
 File Name: X:\County\Map\1415-00027.06-RS - Towards East - 2020\Drawings\DCMP\Plan Sheets\1415-00027.06-RS - Plan View_Sheets_Matchlines_TEST1.dwg

USER NAME = cplmfrantz	DESIGNED -	REVISED -
PLOT SCALE = 200 0000 . j in	DRAWN -	REVISED -
PLOT DATE = 2/24/2020	CHECKED -	REVISED -
	DATE -	REVISED -

**STATE OF ILLINOIS
DEPARTMENT OF TRANSPORTATION**

PLAN VIEW

SCALE: SHEET 8 OF 12 SHEETS STA. 0+00 TO STA. 60+00

F.A.S. RTE	SECTION	COUNTY	TOTAL SHEETS	SHEET NO.
484	15-00027.06-RS	MCLEAN	12	8
CONTRACT NO. 91585			ILLINOIS FED. AID PROJECT	

MDP/E: Defauld
 FILE NAME: X:\CountyRoads\SEC4_14115-00027-06-RS - Townships East - 2020\Design\DC\Plan_Sheets\TEST15_00027-06-RS - Plan View Sheets_MATCHLINES_TEST1.dgn

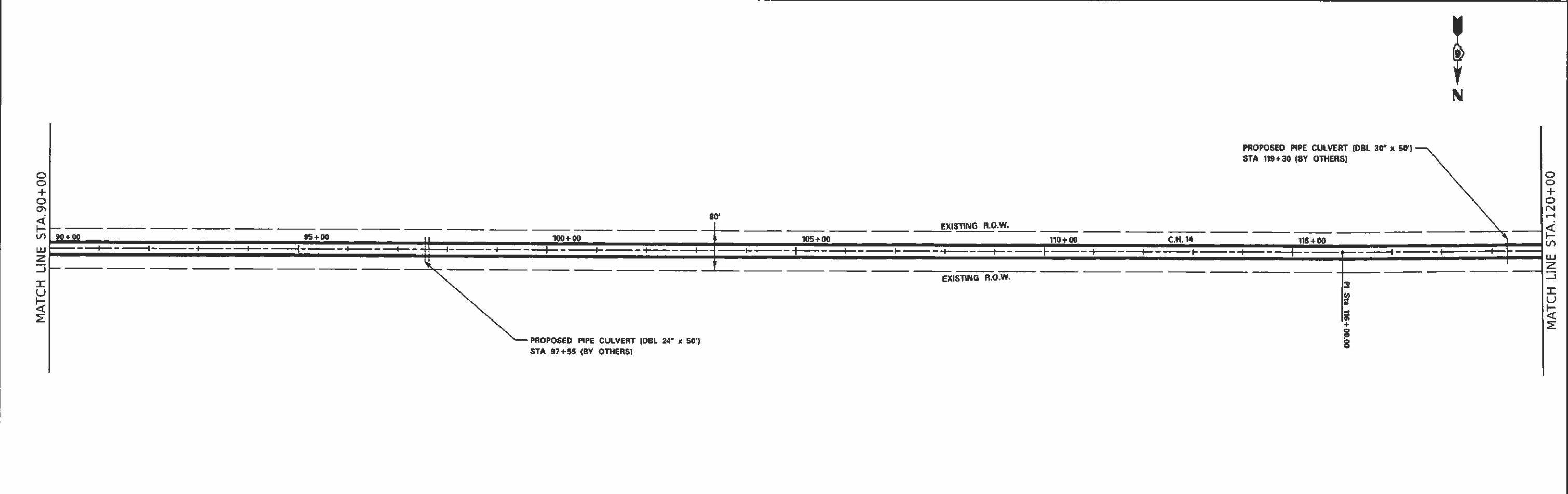
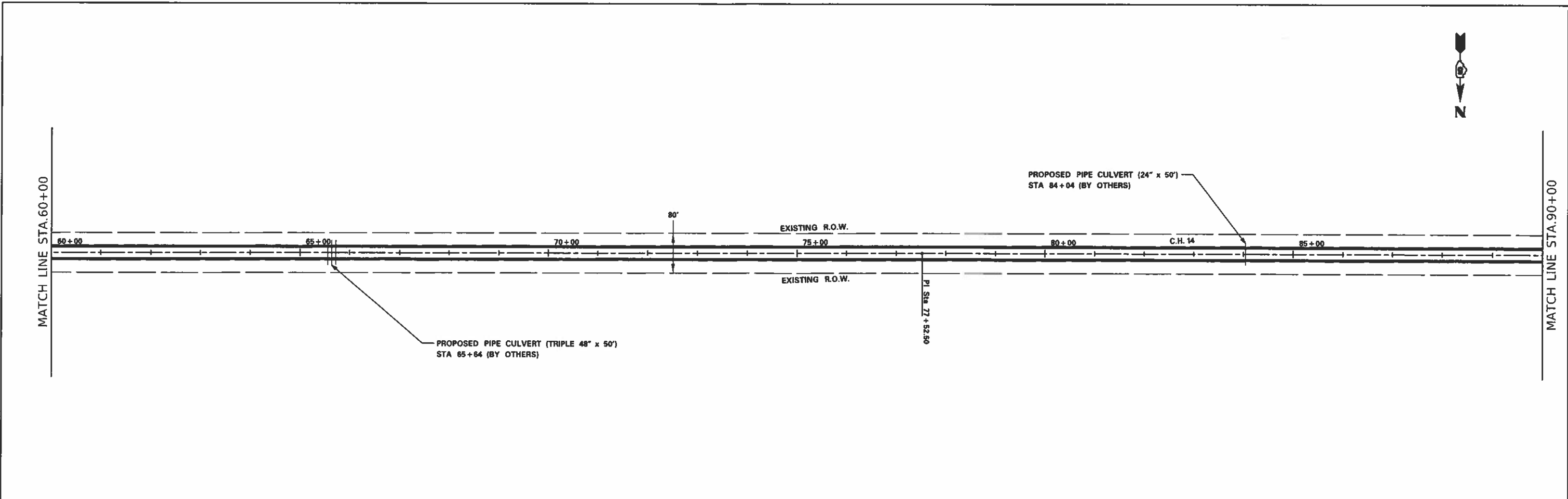

USER NAME = collin.trantz	DESIGNED -	REVISED -
PLOT SCALE = 200.0000 / in.	DRAWN -	REVISED -
PLOT DATE = 2/24/2020	CHECKED -	REVISED -
	DATE -	REVISED -

STATE OF ILLINOIS
DEPARTMENT OF TRANSPORTATION

PLAN VIEW	
SCALE:	SHEET 9 OF 12 SHEETS STA. 60+00 TO STA. 120+00

F.A.S. RTE. 484	SECTION 15-00027-06-R5	COUNTY MCLEAN	TOTAL SHEETS 12	SHEET NO. 9
CONTRACT NO. 91585				
ILLINOIS FED. AID PROJECT				

EXISTING CURVE CH14-1
 PI STA. = 132+00.00
 $\Delta = 2^\circ 10' 00''$ (RT)
 $D = 0^\circ 26' 00''$
 $R = 13,223.00'$
 $T = 250.05'$
 $L = 500.03'$
 $E = 2.36'$
 $e = \text{---}$
 $T.R. = \text{---}$
 $S.E. RUN = \text{---}$
 $P.C. STA. = 129+49.95$
 $P.T. STA. = 134+49.99$

EXISTING CURVE CH14-2
 PI STA. = 137+99.94
 $\Delta = 2^\circ 00' 00''$ (LT)
 $D = 0^\circ 24' 00''$
 $R = 14,324.00'$
 $T = 250.03'$
 $L = 500.00'$
 $E = 2.18'$
 $e = \text{---}$
 $T.R. = \text{---}$
 $S.E. RUN = \text{---}$
 $P.C. STA. = 135+49.91$
 $P.T. STA. = 140+49.92$

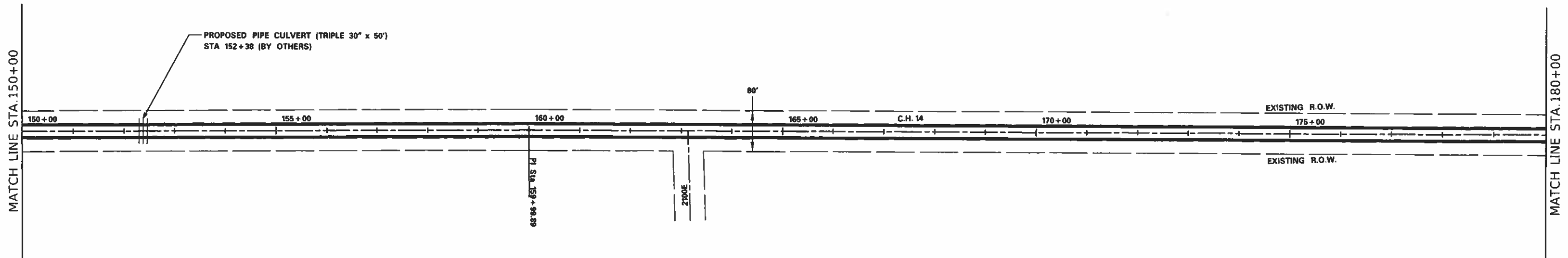
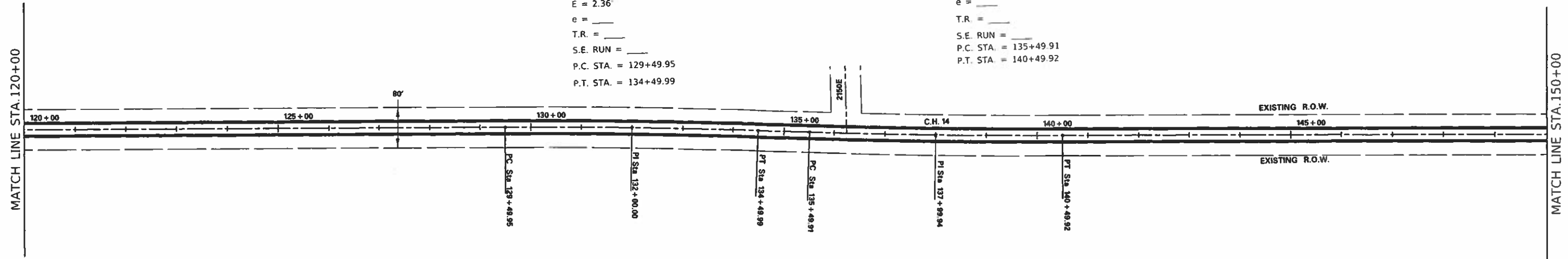

MOD: D:\pwr... 1415-00027-06-RS... 2020\Design\Drawings\Sheets\15-00027-06-RS-Plan_Sheets\MATCHLINES_EST1.dgn

USER NAME = colin brant	DESIGNED -	REVISED -
PLOT SCALE = 200 0000 / in	DRAWN -	REVISED -
PLOT DATE = 2/24/2020	CHECKED -	REVISED -
	DATE -	REVISED -

**STATE OF ILLINOIS
 DEPARTMENT OF TRANSPORTATION**

PLAN VIEW

SCALE: SHEET 10 OF 12 SHEETS STA. 120+00 TO STA. 180+00

F.A.S. RTE.	SECTION	COUNTY	TOTAL SHEETS	SHEET NO.
484	15 00027-06-RS	MCLEAN	12	10
CONTRACT NO. 91585				
ILLINOIS FED. AID PROJECT				

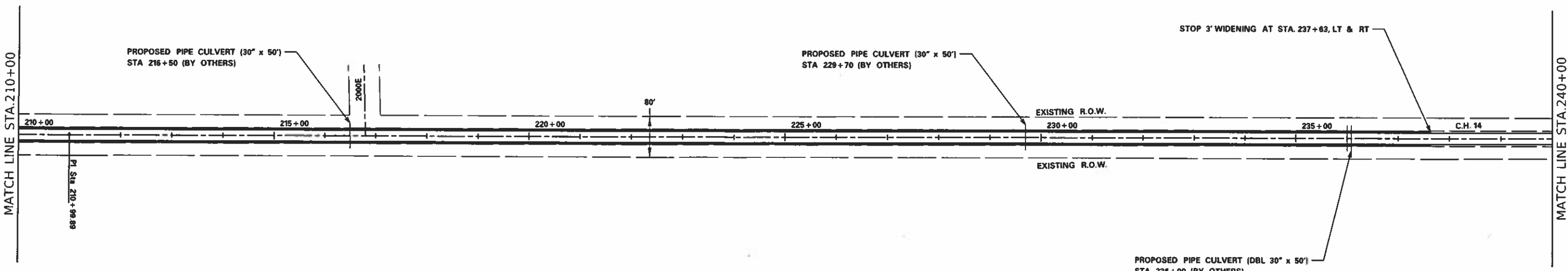
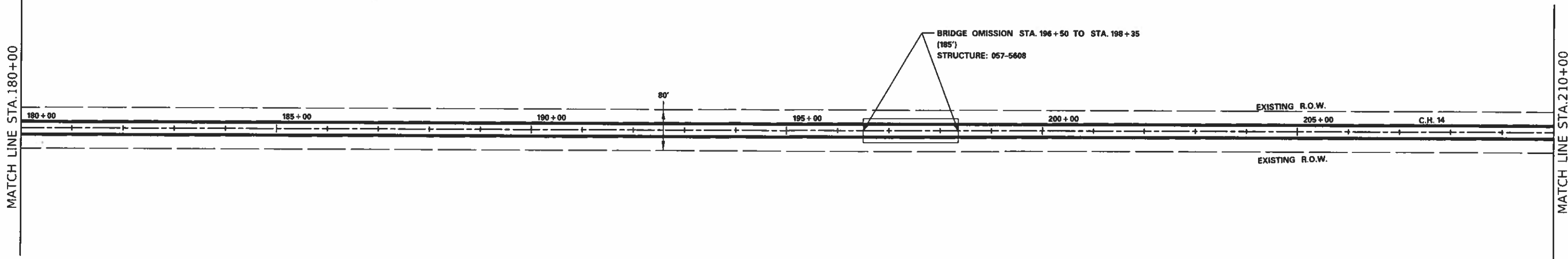

MODIFIED: D:\raur\ X:\CountryRoads\CH 14\15-00027-06-RS -Township East - 2020\Design\DCN\Plus Sheets\TEST\15-00027-06-RS -Plan View Sheets MATCHLINES TEST1.dgn

USER NAME = cavin francz	DESIGNED -	REVISED -
	DRAWN -	REVISED -
PLOT SCALE = 200.0000' / 1" in	CHECKED -	REVISED -
PLOT DATE = 2/24/2020	DATE -	REVISED -

**STATE OF ILLINOIS
DEPARTMENT OF TRANSPORTATION**

PLAN VIEW		
SCALE:	SHEET 11 OF 12 SHEETS	STA 180+00 TO STA. 240+00

F.A.S. RTE	SECTION	COUNTY	TOTAL SHEETS	SHEET NO.
484	15-00027-06-RS	MCLEAN	12	11
CONTRACT NO. 91585			ILLINOIS FED. AID PROJECT	

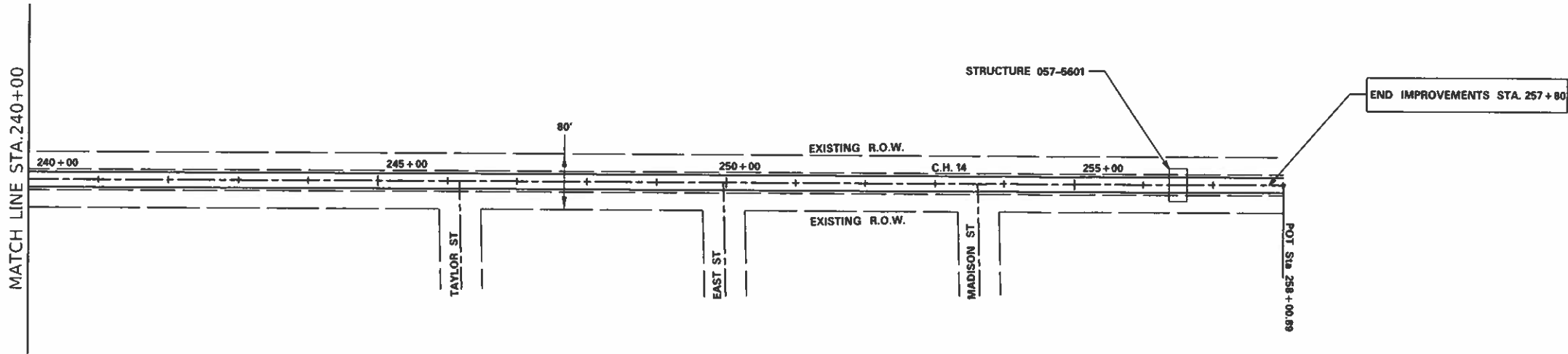

MDDP1 - Default
 FILE NAME: C:\CountyRoads\Ch 14\15-00027-06-PS - Townsld Ead - 2020\Drawings\DCMP\Plan Sheets\TEST\15-00027-06-PS Plan View Sheets MATCHLINES TEST1.dgn

USER NAME = colin iranz	DESIGNED -	REVISED -
	DRAWN -	REVISED -
PLOT SCALE = 200.0000 / in	CHECKED -	REVISED -
PLOT DATE = 2/24/2020	DATE -	REVISED -

STATE OF ILLINOIS
DEPARTMENT OF TRANSPORTATION

PLAN VIEW	
SCALE:	SHEET 12 OF 12 SHEETS
STA. 240+00	TO STA. 257+80

F A S RTE	SECTION	COUNTY	TOTAL SHEETS	SHEET NO.
484	15-00027-06-RS	MCLEAN	12	12
CONTRACT NO. 91585				
ILLINOIS FED. AID PROJECT				