

06-12-2020 LETTING ITEM 132

STATE OF ILLINOIS
DEPARTMENT OF TRANSPORTATION

ROUTE	SECTION	COUNTY	TOTAL SHEETS	SHEET NO.
FAS 901	19-00159-00-RS	SALINE	20	1
MILL STREET				
PROJECT C5VT(573)			JOB C-99-063-19	

PLANS FOR PROPOSED

SALINE COUNTY

MILL STREET (F.A.S. 901)
(FROM OAK STREET TO TOWN PARK ROAD)
SECTION 19-00159-00-RS
PROJECT C5VT(573)
JOB C-99-063-19

FUNCTIONAL CLASS, MAJOR COLLECTOR
ADT (2020): 2,200

INDEX OF SHEETS

- 1 COVER SHEET
- 2 SUMMARY OF QUANTITIES & TYPICAL SECTIONS
- 3-4 CONSTRUCTION SCHEDULES
- 5 INLET BOX SPECIAL AND MISCELLANEOUS DETAILS
- 6-10 PLAN VIEWS
- 11-20 SIDEWALK DETAILS

STANDARDS

- 000001-07 STANDARD SYMBOLS, ABBR, PATTERNS
- 001006 DECIMAL OF AN INCH AND FOOT
- 280001-07 TEMPORARY EROSION CONTROL
- 424001-11 PERPENDICULAR CURB RAMPS FOR SIDEWALKS
- 424006-04 DIAGONAL CURB RAMPS FOR SIDEWALKS
- 424011-04 CORNER PARALLEL CURB RAMPS FOR SIDEWALKS
- 424016-05 MID-BLOCK CURB RAMPS FOR SIDEWALKS
- 424021-05 DEPRESSED CORNER FOR SIDEWALKS
- 602601-06 PRECAST REINFORCED CONCRETE FLAT SLAB TOP
- 602701-02 MANHOLE STEPS
- 604001-05 FRAME AND LIDS TYPE 1
- 606001-07 COMB CONC CURB & GUTTER
- 701201-05 TRAFFIC CONTROL
- 701901-08 TRAFFIC CONTROL DEVICES
- 780001-05 TYPICAL PAVEMENT MARKINGS
- BLR 21-9 TRAFFIC CONTROL
- BLR 24-2 MAILBOX TURNOUT FOR LOCAL ROADS

PROPOSED IMPROVEMENTS

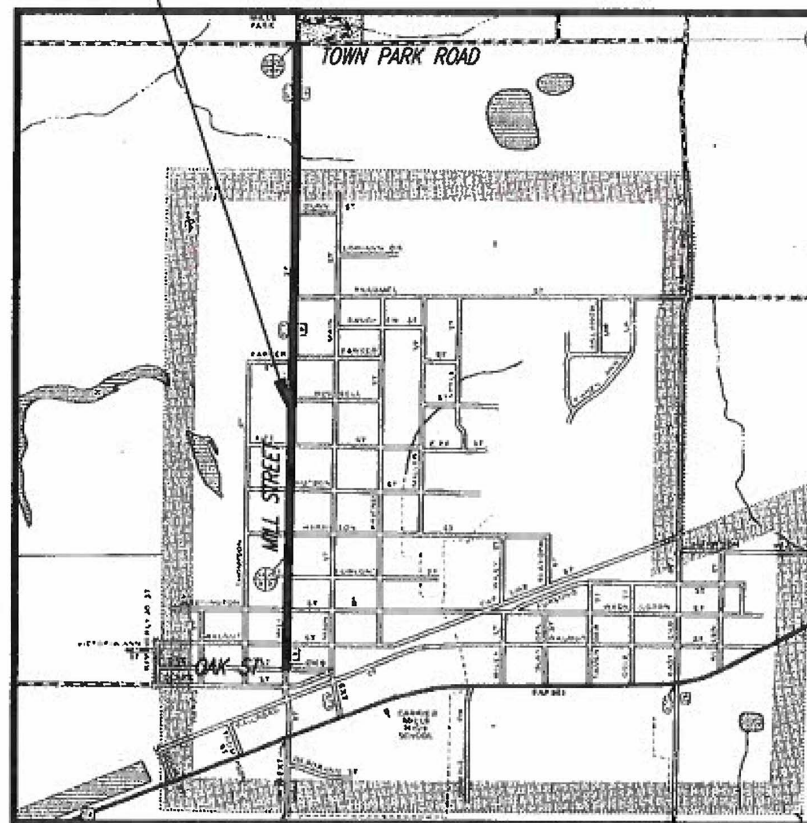

LOCATION MAP
LENGTH OF IMPROVEMENTS = 6,535.00 FT. = 1.238 MI.

ALL EXISTING UTILITIES AND LOCATIONS TO BE
CONFIRMED BY J.U.L.I.E. 800-892-0123

BROWN & ROBERTS, INC.
CONSULTING ENGINEERS & LAND SURVEYORS
1 WESTRIDGE ROAD HAWESBURG, IL. 62948 (618) 252-8111

BRI JOB NO. 19-077

CONTRACT NO. 99649

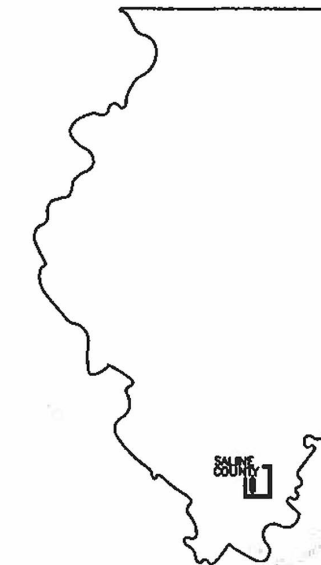

LOCATION OF SECTION INDICATED THUS -

Jim W. Brown

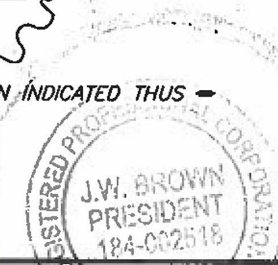

Jim W. Brown as President of Brown & Roberts, Inc.
Illinois Professional Design Firm
Land Survey & Professional Engineering Corporation
Number 184-002518
Expires April 30, 2021
Date: *March 20, 2020*

SALINE COUNTY	
APPROVED	<i>March 20, 2020</i> <i>Larry L. Piche</i> LARRY L. PICHE, SALINE COUNTY ENGINEER
PASSED	<i>04/01/2020</i> <i>[Signature]</i> DISTRICT 9 ENGINEER OF LOCAL ROADS & STREETS
RELEASING FOR BID BASED ON LIMITED REVIEW	<i>04/01/2020</i> <i>Keith Roberts</i> KEITH ROBERTS, P.E. ACTING REGION FIVE ENGINEER

STREET NAME	PROJECT NO.	JOB NO.	ROUTE	SECTION	COUNTY	TOTAL SHEETS	SHEET NO.
MILL STREET	C5VT(573)	C-99-063-19	FAS 901	19-00159-00-RS	SALINE	20	2

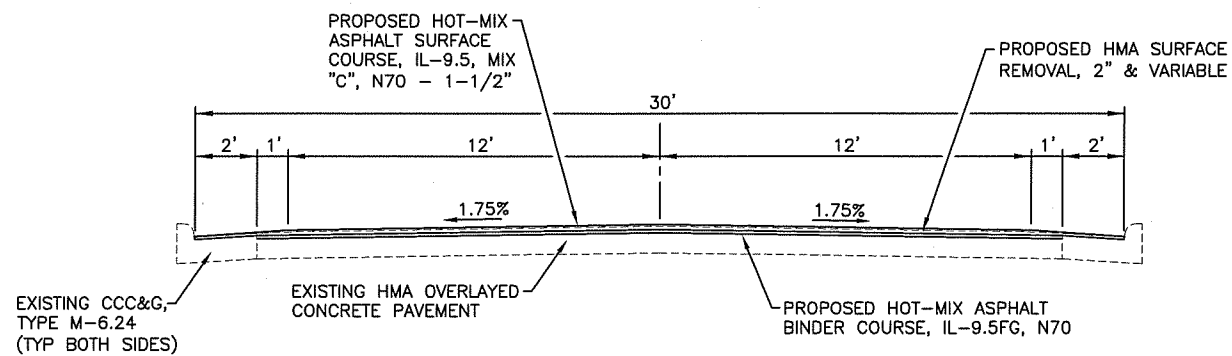

MILL STREET TYPICAL SECTION

NO SCALE
STA 0+00 TO STA 1+65

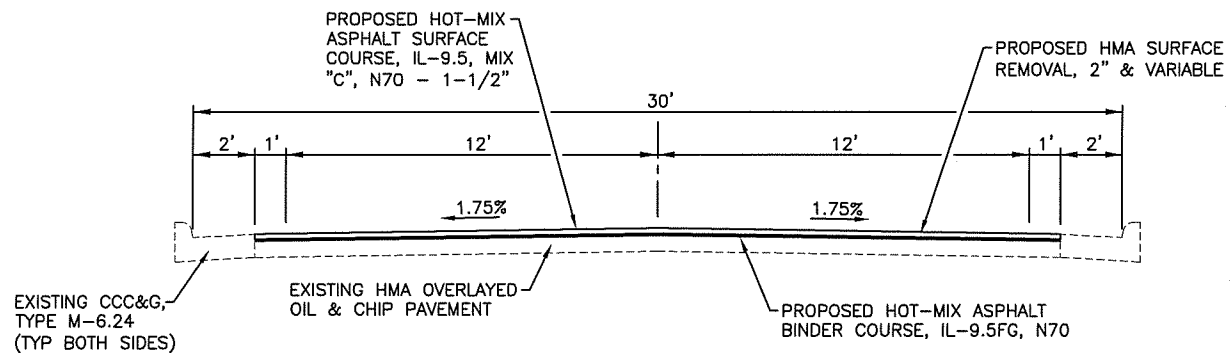

MILL STREET TYPICAL SECTION

NO SCALE
STA 1+65 TO STA 51+94

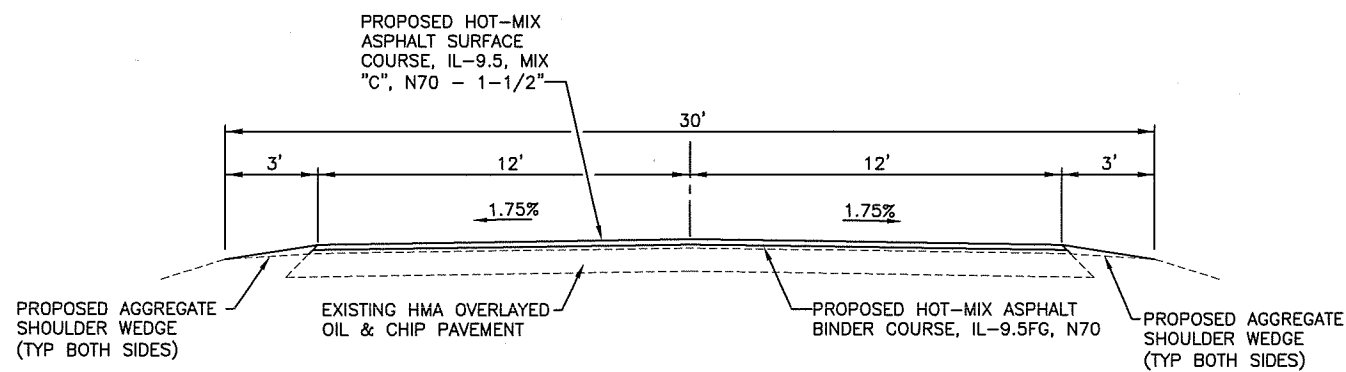

MILL STREET TYPICAL SECTION

NO SCALE
STA 51+94 TO STA 66+32

SUMMARY OF QUANTITIES

ITEM NUMBER	ITEM DESCRIPTION	UNIT	TOTAL QUANTITY
40600290	BITUMINOUS MATERIALS (TACK COAT)	POUND	8,935
40602970	HOT MIX ASPHALT BINDER COURSE, IL-9.5FG, N70	TON	1,094
40604052	HOT MIX ASPHALT SURFACE COURSE, IL-9.5, MIX "C", N70	TON	1,819
42400100	PORTLAND CEMENT CONCRETE SIDEWALK 4 INCH	SQ FT	1,957
42400800	DETECTABLE WARNINGS	SQ FT	299
44000600	SIDEWALK REMOVAL	SQ FT	1,633
48100100	AGGREGATE SHOULDERS, TYPE A	TON	181
60266600	VALVE BOXES TO BE ADJUSTED	EACH	6
67100100	MOBILIZATION	L SUM	1
Δ 78001110	PAINT PAVEMENT MARKING - LINE 4"	FOOT	4,352
Δ 78001130	PAINT PAVEMENT MARKING - LINE 6"	FOOT	160
Δ 78001180	PAINT PAVEMENT MARKING - LINE 24"	FOOT	224
*X1200108	INLET BOX, SPECIAL	EACH	1
*X4400220	CURB REMOVAL AND REPLACEMENT	FOOT	230
*X6025800	MANHOLE TO BE ADJUSTED WITH NEW TYPE 1 FRAME, CLOSED LID, SPECIAL	EACH	2
*X7010101	TRAFFIC CONTROL AND PROTECTION, STANDARD 701201	EACH	1
*Z0011500	COLD MILLING EXISTING SURFACE	SQ YD	16,923

* SEE SPECIAL PROVISION
Δ SPECIALTY ITEMS

06 Apr 2020 - 7:47am X:\2019\19077\AC\19077 Typical Sections.dwg: Layout Tab Typical Section & Summary of Quantities

STREET NAME	PROJECT NO.	JOB NO.	ROUTE	SECTION	COUNTY	TOTAL SHEETS	SHEET NO.
MILL STREET	C5VT(573)	C-99-063-19	FAS 901	19-00159-00-RS	SALINE	20	3

PAVEMENT SCHEDULE					
LOCATION	HMA BIND CSE, IL-9.5FG, N70 (1" LIFT) (TON)	HMA SURF CSE, MIX "C", N70 (1.5" LIFT) (TON)	BITUMINOUS MATERIALS (TACK COAT) (POUND)	COLD MILLING EXISTING SURFACE (SQ YD)	AGGREGATE SHOULDERS (TON)
STA 0+00 TO STA 51+94 (CURB SECTION)	882	1323	6752	15005	
STA 51+94 TO STA 53+44 (MILLING TRANSITION)	24	35	180	400	19
STA 53+44 TO STA 65+32 (NO MILLING)	188	282	1440		149
STA 65+32 TO STA 66+32 (MILLING TRANSITION)		31		267	13
OAK STREET LT		4	17	38	
OAK STREET RT		12	44	98	
WALNUT STREET LT		6	24	53	
WALNUT STREET RT		6	21	48	
WASHINGTON STREET LT		7	26	59	
WASHINGTON STREET RT		7	27	60	
FURLONG STREET RT		5	20	43	
HARRISON STREET LT		6	22	50	
HARRISON STREET RT		6	23	50	
HUTSON STREET LT		6	22	49	
HUTSON STREET RT		6	24	53	
FIFE STREET LT		6	23	51	
FIFE STREET RT		6	25	55	
RUSSELL STREET RT		6	23	50	
THOMPSON STREET LT		6	23	51	
PARKER STREET RT		6	22	49	
TRAMMEL STREET RT		6	23	51	
43+00 RT		7	25	56	
DUNN STREET RT		6	23	51	
51+50 LT		4	15	33	
TOWN PARK ROAD LT		13	50	112	
TOWN PARK ROAD RT		11	41	91	
TOTALS	1094	1819	8935	16923	181

SIDEWALK SCHEDULE				
LOCATION	SIDEWALK REMOVAL (SQ FT)	PCC SIDEWALK 4 INCH (SQ FT)	CCC&G REMOVAL AND REPLACEMENT (FOOT)	DETECTABLE WARNINGS (SQ FT)
OAK STREET (SOUTHWEST)	60.4	61.7		9.6
OAK STREET (SOUTHEAST)	175.4	175.4		26.0
OAK STREET (NORTHWEST)	63.4	63.4	4.0	8.0
OAK STREET (NORTHEAST)	122.4	122.4	15.0	16.0
WALNUT STREET (SOUTHWEST)	42.3	52.1	13.0	16.8
WALNUT STREET (SOUTHEAST)	135.5	201.8	16.0	16.0
WALNUT STREET (NORTHWEST)	80.4	93.4	15.0	21.0
WALNUT STREET (NORTHEAST)	108.2	123.8	6.0	8.0
WASHINGTON STREET (SOUTHWEST)	112.0	132.1	17.0	25.6
WASHINGTON STREET (SOUTHEAST)	163.5	189.5	14.0	23.4
WASHINGTON STREET (NORTHWEST)	50.5	73.5	18.0	24.3
WASHINGTON STREET (NORTHEAST)	75.7	90.0	27.0	20.4
FURLONG STREET (SOUTHEAST)	22.3	26.1	11.0	8.0
FURLONG STREET (NORTHEAST)	21.9	25.4	9.0	8.0
HARRISON STREET (SOUTHWEST)	42.0	47.1	14.0	18.0
HARRISON STREET (NORTHWEST CORNER)	18.0	39.7	15.0	10.3
HARRISON STREET (NORTHWEST MIDBLOCK)	64.8	87.2	7.0	8.0
HARRISON STREET (NORTHEAST MIDBLOCK)	127.4	164.6	7.0	8.0
HUTSON STREET (SOUTHWEST)	34.9	40.2	10.0	8.0
HUTSON STREET (NORTHWEST)	81.0	91.3	12.0	16.0
FIFE (SOUTHWEST)	31.2	56.0		
TOTALS	1633	1957	230	299

STREET NAME	PROJECT NO.	JOB NO.	ROUTE	SECTION	COUNTY	TOTAL SHEETS	SHEET NO.
MILL STREET	C5VT(573)	C-99-063-19	FAS 901	19-00159-00-RS	SALINE	20	4

PAVEMENT MARKING SCHEDULE			
LOCATION	PAINT PAVEMENT MARKING - LINE 4" (FOOT)	PAINT PAVEMENT MARKING - LINE 6" (FOOT)	PAINT PAVEMENT MARKING - LINE 24" (FOOT)
STA -0+13, 0'RT TO 14'RT (WHITE STOP BAR)			14
STA 0+05, SOUTH SIDE OAK STREET INTERSECTION (WHITE CROSSWALK)		76	
STA 0+18 TO 0+30, 28'LT (WHITE STOP BAR)			12
STA 0+30 TO STA 0+46, 28'RT (WHITE STOP BAR)			15
STA 0+62, 0'LT TO 13'LT (WHITE STOP BAR)			13
STA 0+75 TO STA 66+32 (YELLOW SKIP DASH CENTERLINE)	1640		
STA 2+64, SOUTH SIDE WALNUT STREET INTERSECTION (WHITE CROSSWALK)			10
STA 2+83 TO STA 2+93, 30'RT (WHITE STOP BAR)			10
STA 6+20 TO STA 6+32, 30'LT (WHITE STOP BAR)			12
STA 6+32 TO STA 6+44, 30'RT (WHITE STOP BAR)			12
STA 6+48, NORTH SIDE WASHINGTON STREET INTERSECTION (WHITE CROSSWALK)		84	
STA 9+65 TO STA 9+73, 30'RT (WHITE STOP BAR)			8
STA 14+08 TO STA 14+18, 30'LT (WHITE STOP BAR)			10
STA 14+18 TO STA 14+28, 30'RT (WHITE STOP BAR)			10
STA 18+63 TO STA 18+73, 30'LT (WHITE STOP BAR)			10
STA 18+75 TO STA 18+85, 30'RT (WHITE STOP BAR)			10
STA 23+20 TO STA 23+29, 30'LT (WHITE STOP BAR)			9
STA 23+32 TO STA 32+41, 30'RT (WHITE STOP BAR)			9
STA 27+89 TO STA 27+98, 30'RT (WHITE STOP BAR)			9
STA 31+92 TO STA 32+00, 30'LT (WHITE STOP BAR)			8
STA 32+47 TO STA 32+55, 30'RT (WHITE STOP BAR)			8
STA 38+64 TO STA 38+73, 30'RT (WHITE STOP BAR)			9
STA 47+22 TO STA 47+30, 30'RT (WHITE STOP BAR)			8
STA 51+94 TO STA 64+50, 11'LT AND 11'RT (WHITE EDGE LINE)	2512		
STA 64+82 TO STA 64+92, 45'LT (WHITE STOP BAR)			10
STA 64+90 TO STA 64+98, 40'RT (WHITE STOP BAR)			8
STA 65+32 TO STA 66+32, 11'LT AND 11'RT (WHITE EDGE LINE)	200		
TOTALS	4352	160	224

VALVE BOXES TO BE ADJUSTED
LOCATION
STA. 1+49.4, 10.6'LT
STA. 6+44.2, 19.5'LT
STA. 13+97, 19.1'LT (IN SIDEWALK)
STA. 18+53, 21.4'LT (IN SIDEWALK)
STA. 32+04.4, 10.8'RT
STA. 32+09.8, 10.0'RT

MANHOLE TO BE ADJUSTED, NEW TYPE 1 FRAME, CLOSED LID, SPECIAL
LOCATION
STA. 1+57.2, 9.5'RT
STA. 4+67.1, 10.1'RT

STREET NAME	PROJECT NO.	JOB NO.	ROUTE	SECTION	COUNTY	TOTAL SHEETS	SHEET NO.
MILL STREET	C5VT(573)	C-99-063-19	FAS 901	19-00159-00-RS	SALINE	20	5

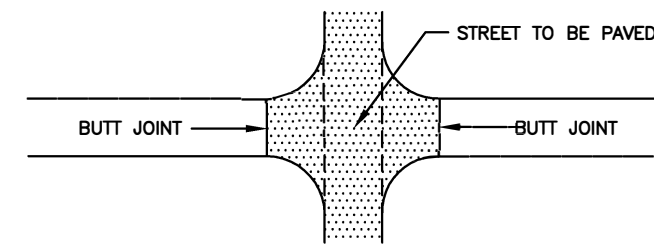
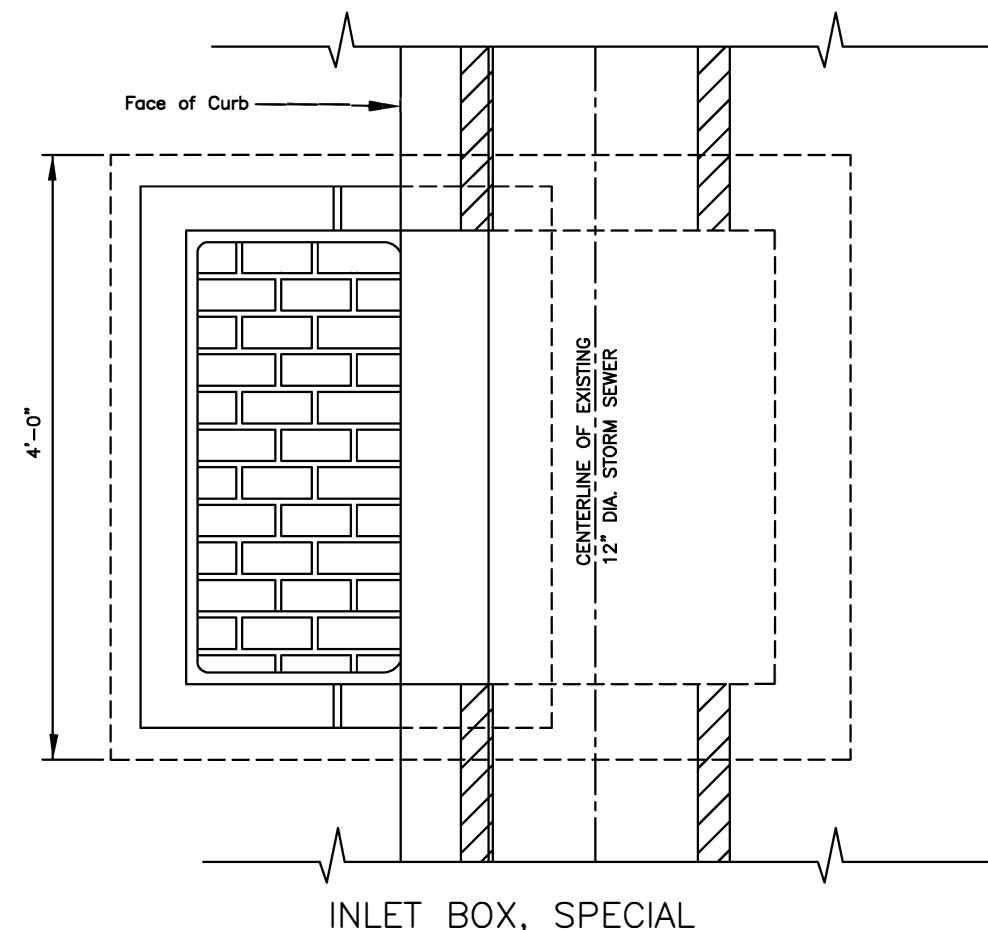

TYPICAL INTERSECTION DETAIL

NO SCALE

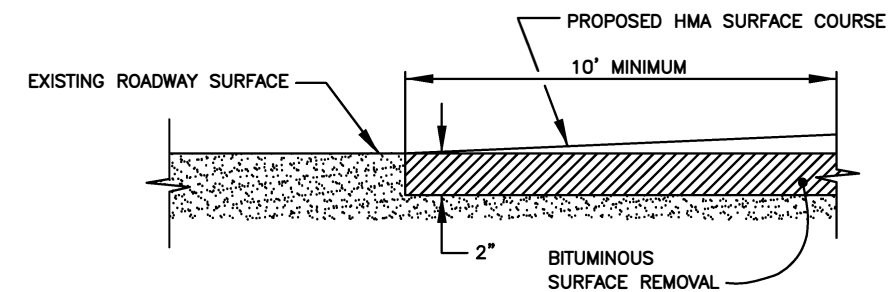

BUTT JOINT DETAIL

NO SCALE

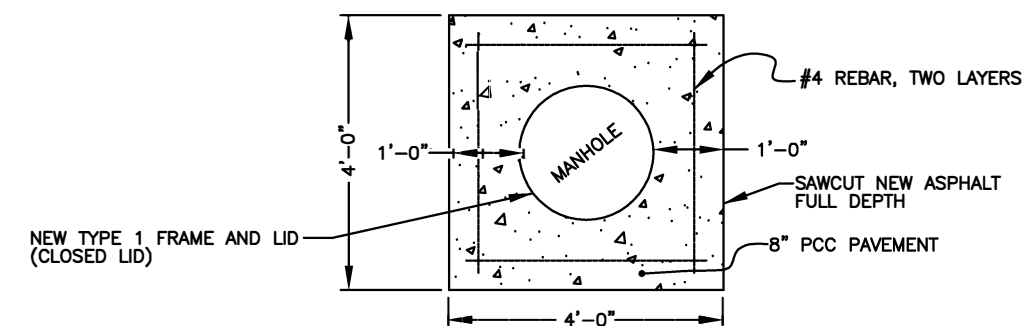
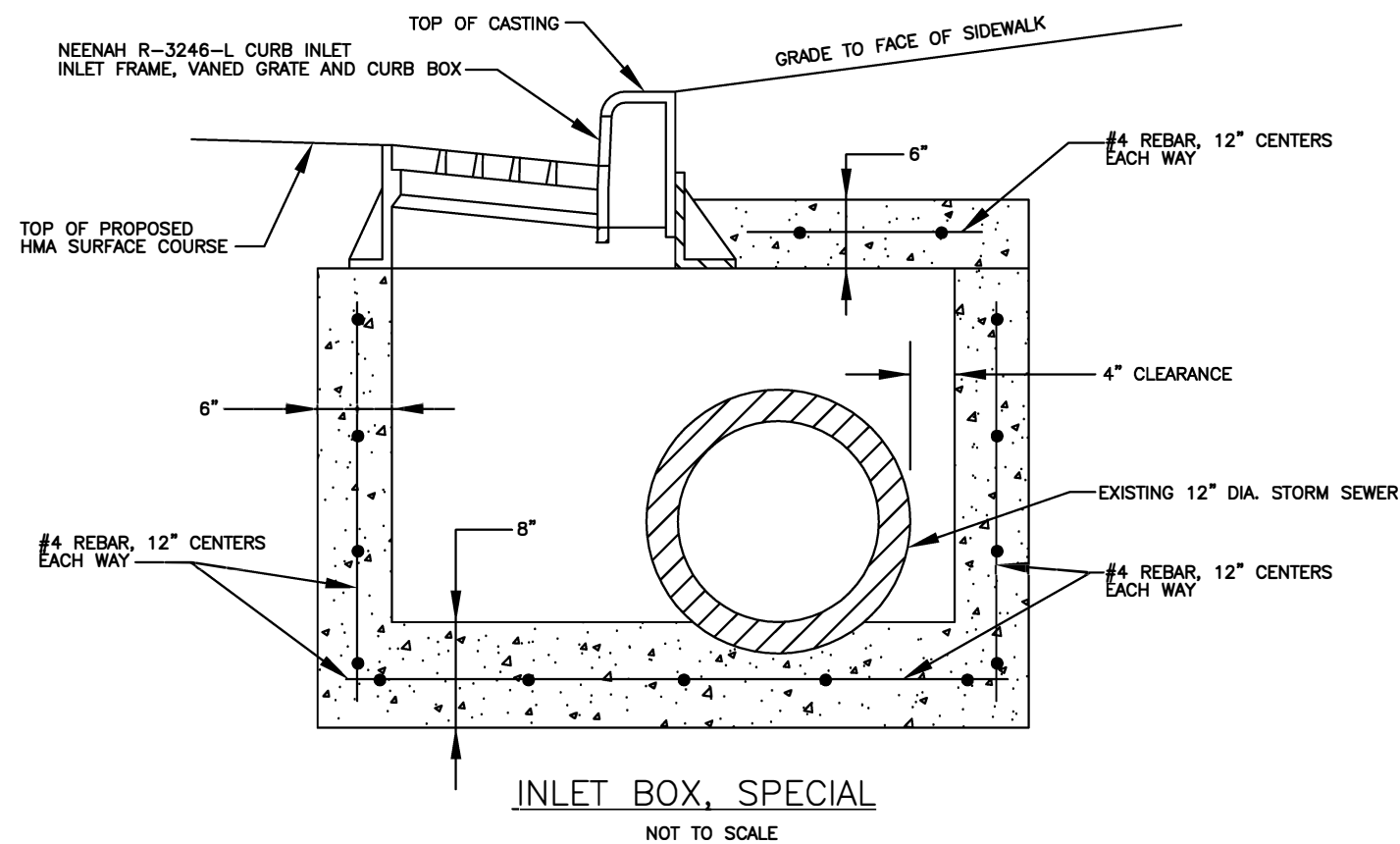

MANHOLE ADJUSTMENT, SPECIAL

NOT TO SCALE

23 Mar 2020 - 7:47am X:\2019\19077\AC\19077 Typical Sections.dwg: Layout Tab 'Inlet Details'

STREET NAME	PROJECT NO.	JOB NO.	ROUTE	SECTION	COUNTY	TOTAL SHEETS	SHEET NO.
MILL STREET	C5VT(573)	C-99-063-19	FAS 901	19-00159-00-RS	SALINE	20	6

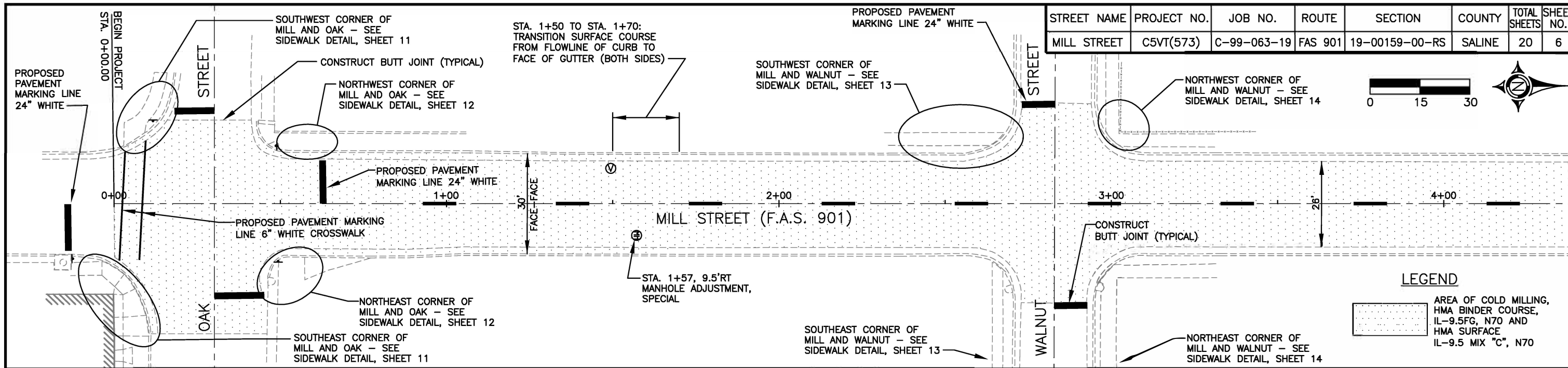

LEGEND
 AREA OF COLD MILLING, HMA BINDER COURSE, IL-9.5FG, N70 AND HMA SURFACE IL-9.5 MIX "C", N70

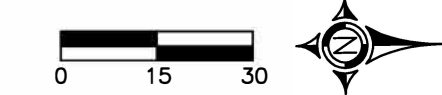
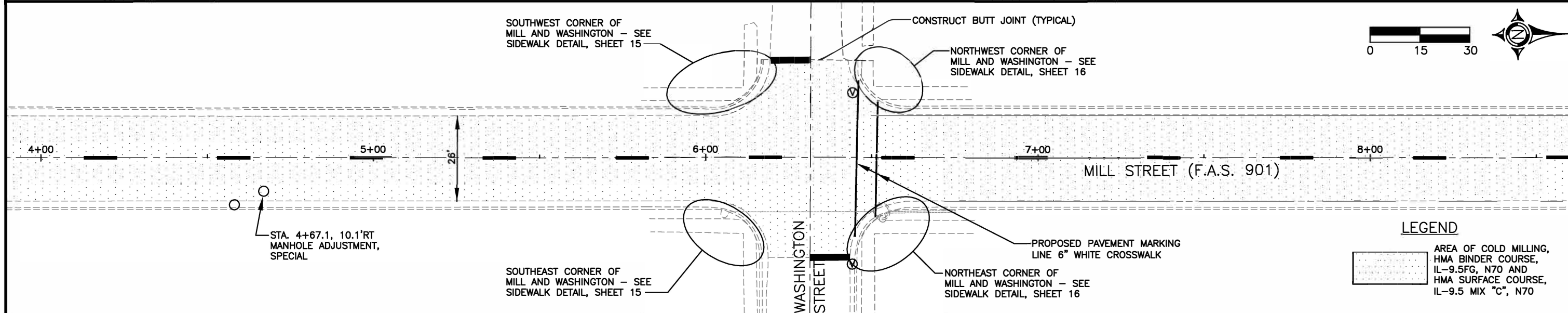

LEGEND
 AREA OF COLD MILLING, HMA BINDER COURSE, IL-9.5FG, N70 AND HMA SURFACE COURSE, IL-9.5 MIX "C", N70

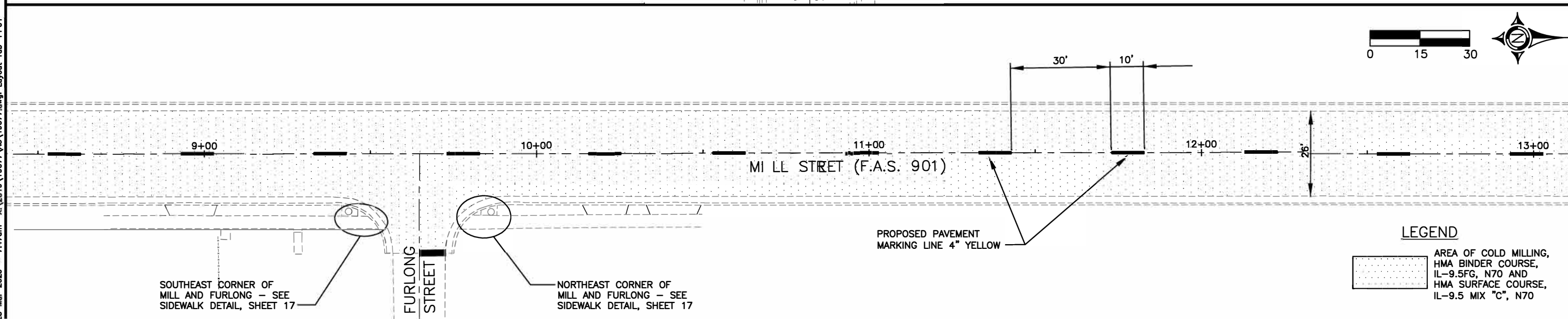

LEGEND
 AREA OF COLD MILLING, HMA BINDER COURSE, IL-9.5FG, N70 AND HMA SURFACE COURSE, IL-9.5 MIX "C", N70

23 Mar 2020 - 7:47am X:\2019\19077\Ac\19077.dwg: Layout Tab PP01

STREET NAME	PROJECT NO.	JOB NO.	ROUTE	SECTION	COUNTY	TOTAL SHEETS	SHEET NO.
MILL STREET	C5VT(573)	C-99-063-19	FAS 901	19-00159-00-RS	SALINE	20	7

PROPOSED PAVEMENT MARKING LINE 24" WHITE

SOUTHWEST CORNER OF MILL AND HARRISON - SEE SIDEWALK DETAIL, SHEET 18

NORTHWEST CORNER OF MILL AND HARRISON - SEE SIDEWALK DETAIL, SHEET 18

NORTHWEST CORNER OF MILL AND HARRISON MID-BLOCK - SEE SIDEWALK DETAIL, SHEET 19

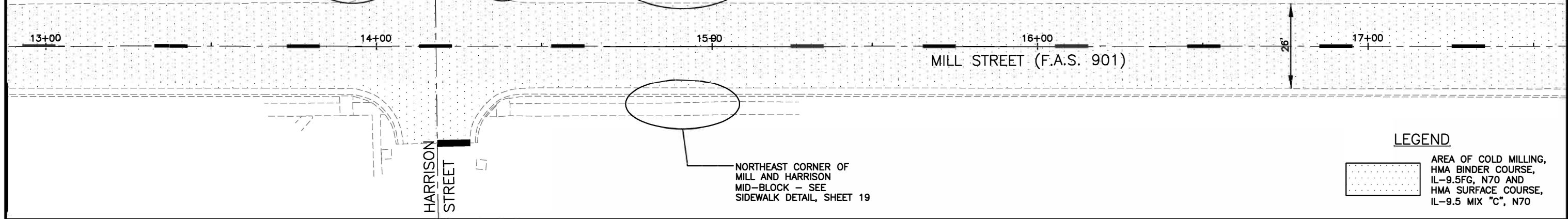
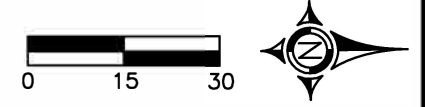

SOUTHWEST CORNER OF MILL AND HUTSON - SEE SIDEWALK DETAIL, SHEET 20

NORTHWEST CORNER OF MILL AND HUTSON - SEE SIDEWALK DETAIL, SHEET 20

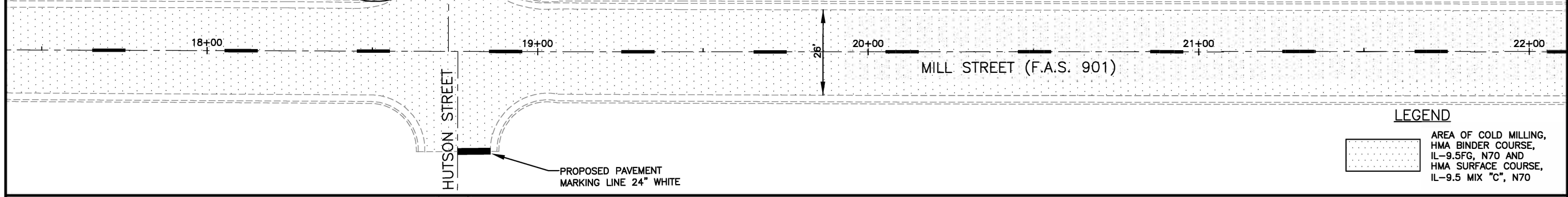
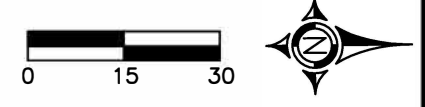

SOUTHWEST CORNER OF MILL AND FIFE - SEE SIDEWALK DETAIL, SHEET 20

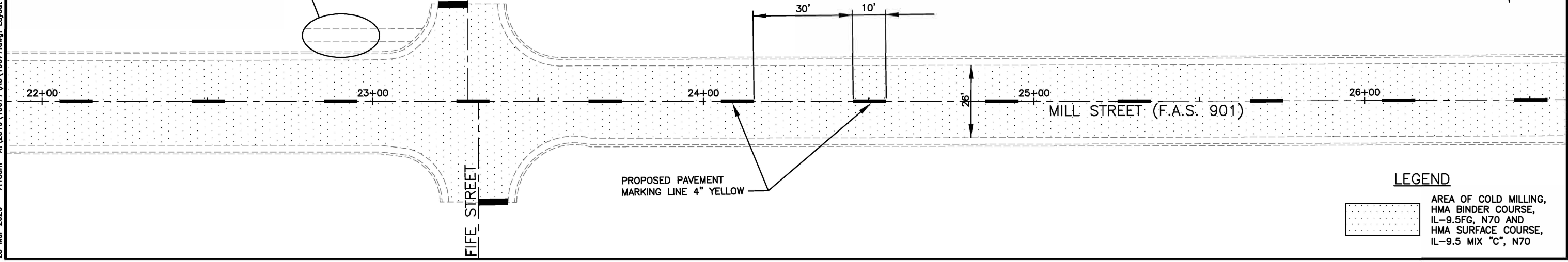
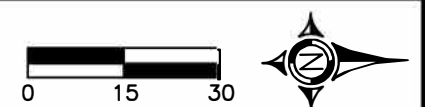

23 Mar 2020 - 7:48am X:\2019\19077\AC\19077.dwg: Layout Tab 'PP02'

STREET NAME	PROJECT NO.	JOB NO.	ROUTE	SECTION	COUNTY	TOTAL SHEETS	SHEET NO.
MILL STREET	C5VT(573)	C-99-063-19	FAS 901	19-00159-00-RS	SALINE	20	8

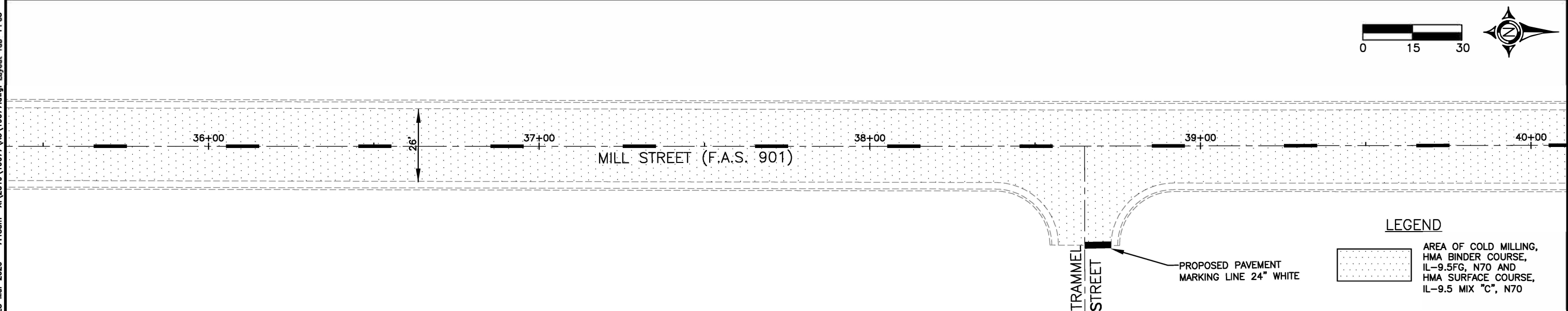
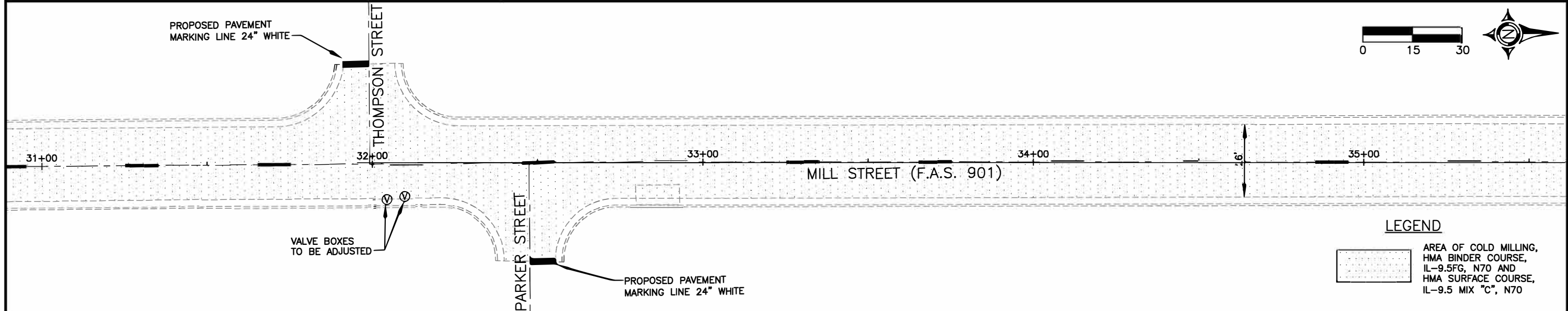
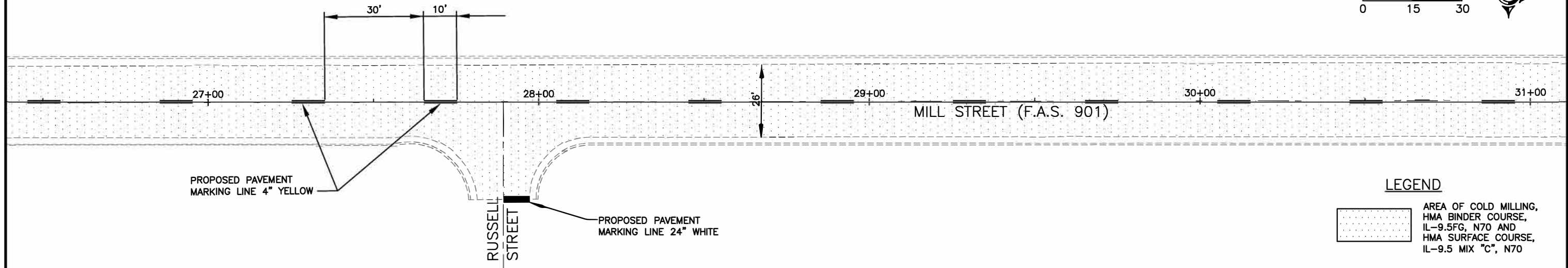
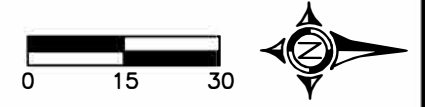

23 Mar 2020 - 7:48am x:\2019\19077\Ac\19077.dwg: Layout Tab 'PP03'

STREET NAME	PROJECT NO.	JOB NO.	ROUTE	SECTION	COUNTY	TOTAL SHEETS	SHEET NO.
MILL STREET	C5VT(573)	C-99-063-19	FAS 901	19-00159-00-RS	SALINE	20	9

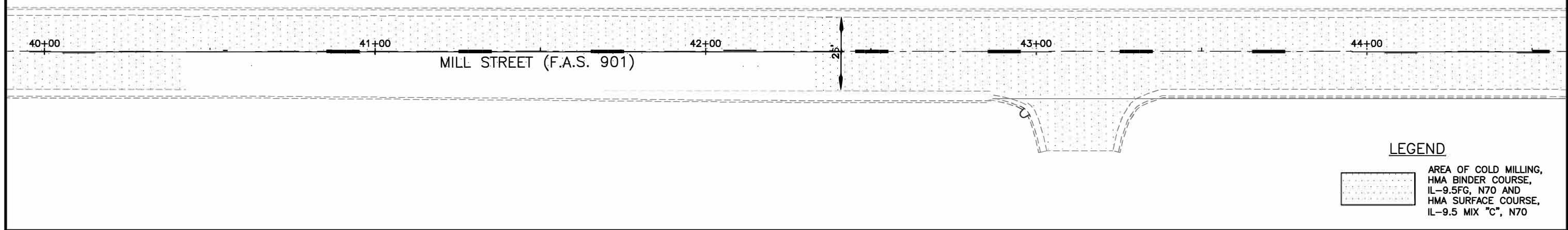
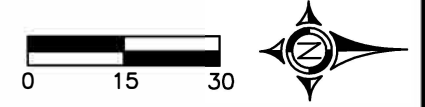

LEGEND

AREA OF COLD MILLING, HMA BINDER COURSE, IL-9.5FG, N70 AND HMA SURFACE COURSE, IL-9.5 MIX "C", N70

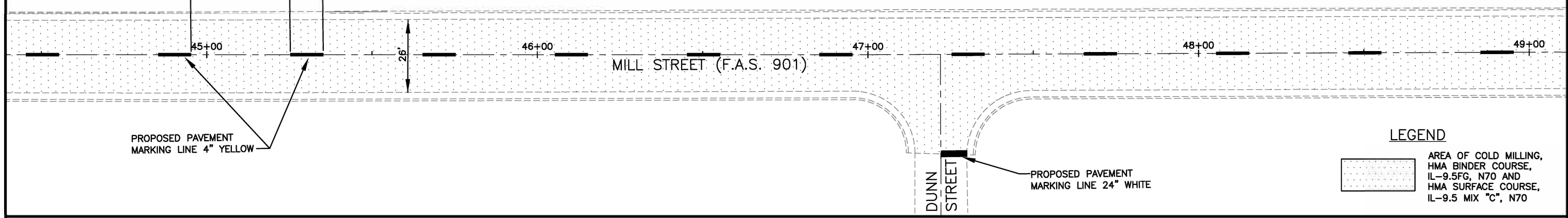
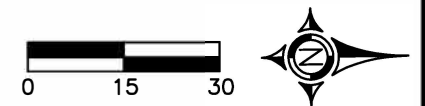

PROPOSED PAVEMENT MARKING LINE 4" YELLOW

PROPOSED PAVEMENT MARKING LINE 24" WHITE

LEGEND

AREA OF COLD MILLING, HMA BINDER COURSE, IL-9.5FG, N70 AND HMA SURFACE COURSE, IL-9.5 MIX "C", N70

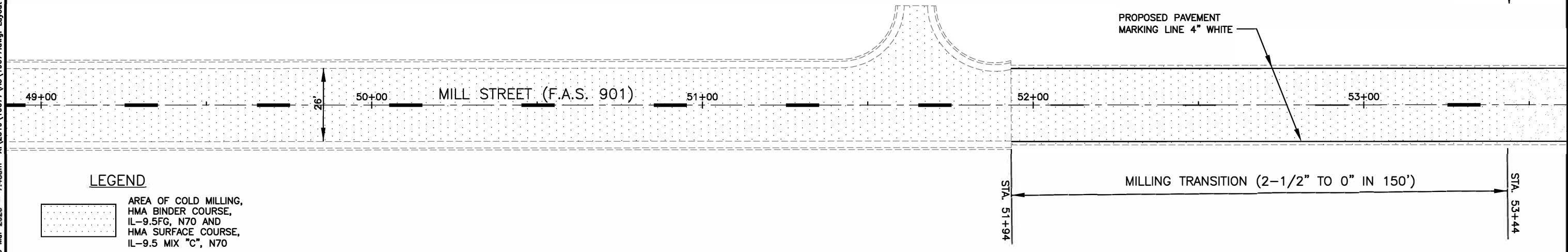
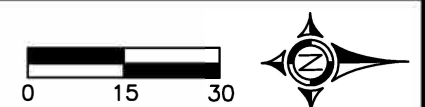

PROPOSED PAVEMENT MARKING LINE 4" WHITE

MILLING TRANSITION (2-1/2" TO 0" IN 150')

STA. 51+94

STA. 53+44

LEGEND

AREA OF COLD MILLING, HMA BINDER COURSE, IL-9.5FG, N70 AND HMA SURFACE COURSE, IL-9.5 MIX "C", N70

23 Mar 2020 - 7:48am x:\2019\19077\AC\19077.dwg: Layout Tab 'PP04'

STREET NAME	PROJECT NO.	JOB NO.	ROUTE	SECTION	COUNTY	TOTAL SHEETS	SHEET NO.
MILL STREET	C5VT(573)	C-99-063-19	FAS 901	19-00159-00-RS	SALINE	20	10

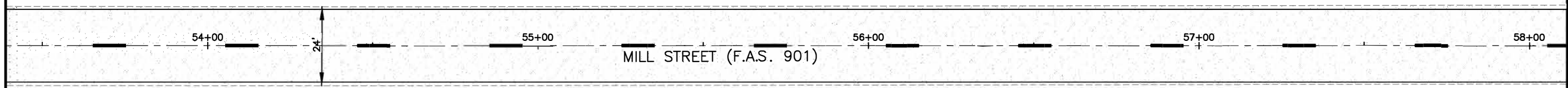
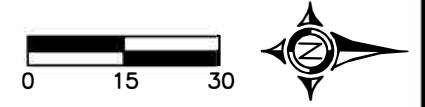

STA. 53+44

LEGEND

	AREA OF COLD MILLING, HMA BINDER COURSE, IL-9.5FG, N70 AND HMA SURFACE COURSE, IL-9.5 MIX "C", N70		AREA OF HMA BINDER COURSE, IL-9.5FG, N70 AND HMA SURFACE COURSE, IL-9.5 MIX "C", N70
--	--	--	--

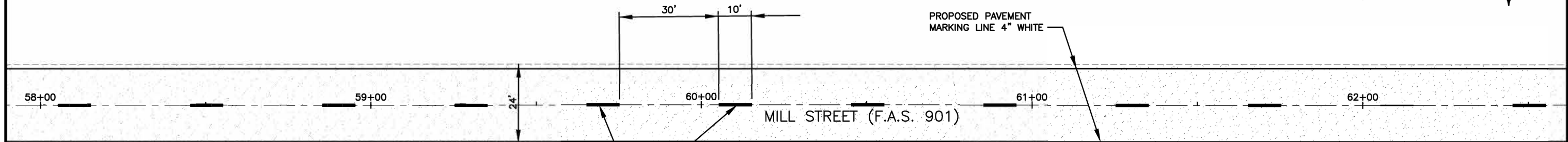
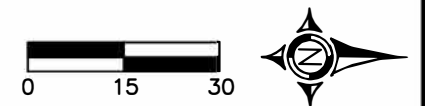

LEGEND

	AREA OF HMA BINDER COURSE, IL-9.5FG, N70 AND HMA SURFACE COURSE, IL-9.5 MIX "C", N70
--	--

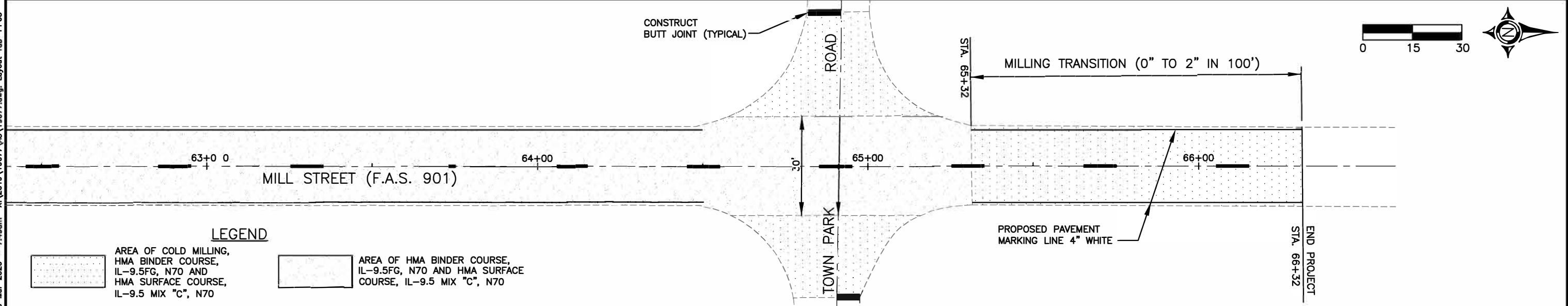
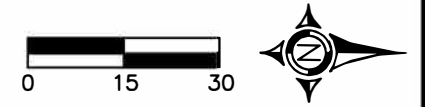

LEGEND

	AREA OF COLD MILLING, HMA BINDER COURSE, IL-9.5FG, N70 AND HMA SURFACE COURSE, IL-9.5 MIX "C", N70		AREA OF HMA BINDER COURSE, IL-9.5FG, N70 AND HMA SURFACE COURSE, IL-9.5 MIX "C", N70
--	--	--	--

23 Mar 2020 - 7:48am X:\2019\19077\AC\19077.dwg: Layout Tab 'PP05'

STREET NAME	PROJECT NO.	JOB NO.	ROUTE	SECTION	COUNTY	TOTAL SHEETS	SHEET NO.
MILL STREET	C5VT(573)	C-99-063-19	FAS 901	19-00159-00-RS	SALINE	20	11

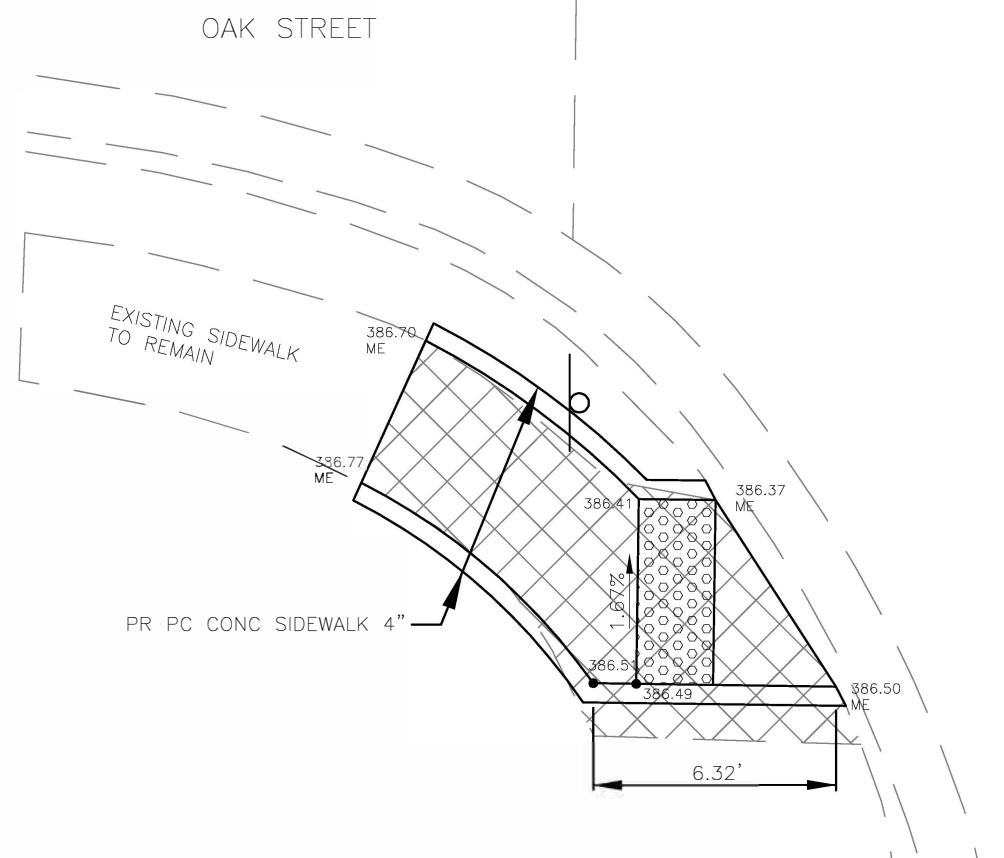

MILL STREET AND OAK STREET
SOUTHWEST CORNER – SIDEWALK DETAIL

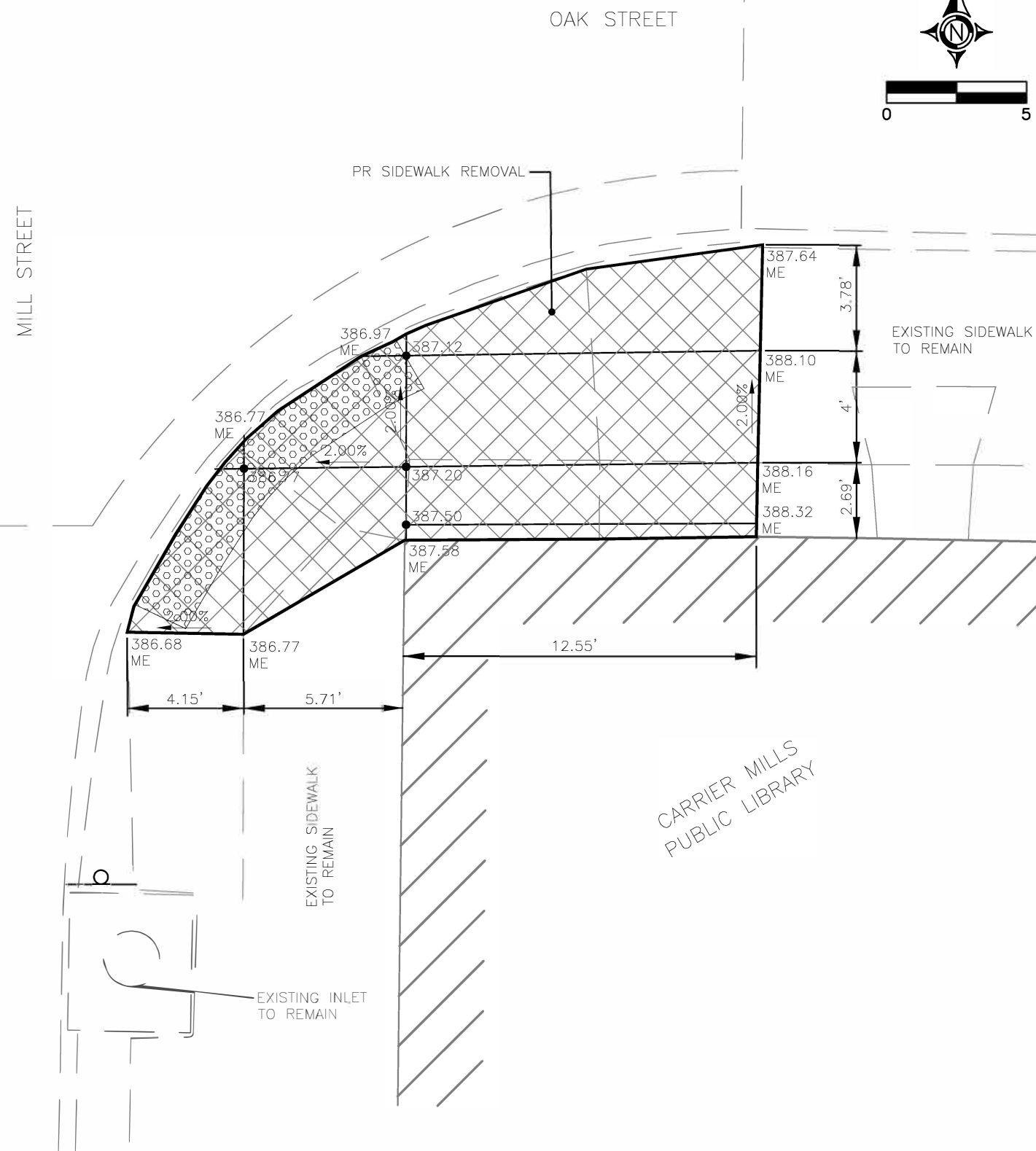

MILL STREET AND OAK STREET
SOUTHEAST CORNER – SIDEWALK DETAIL

STREET NAME	PROJECT NO.	JOB NO.	ROUTE	SECTION	COUNTY	TOTAL SHEETS	SHEET NO.
MILL STREET	C5VT(573)	C-99-063-19	FAS 901	19-00159-00-RS	SALINE	20	12

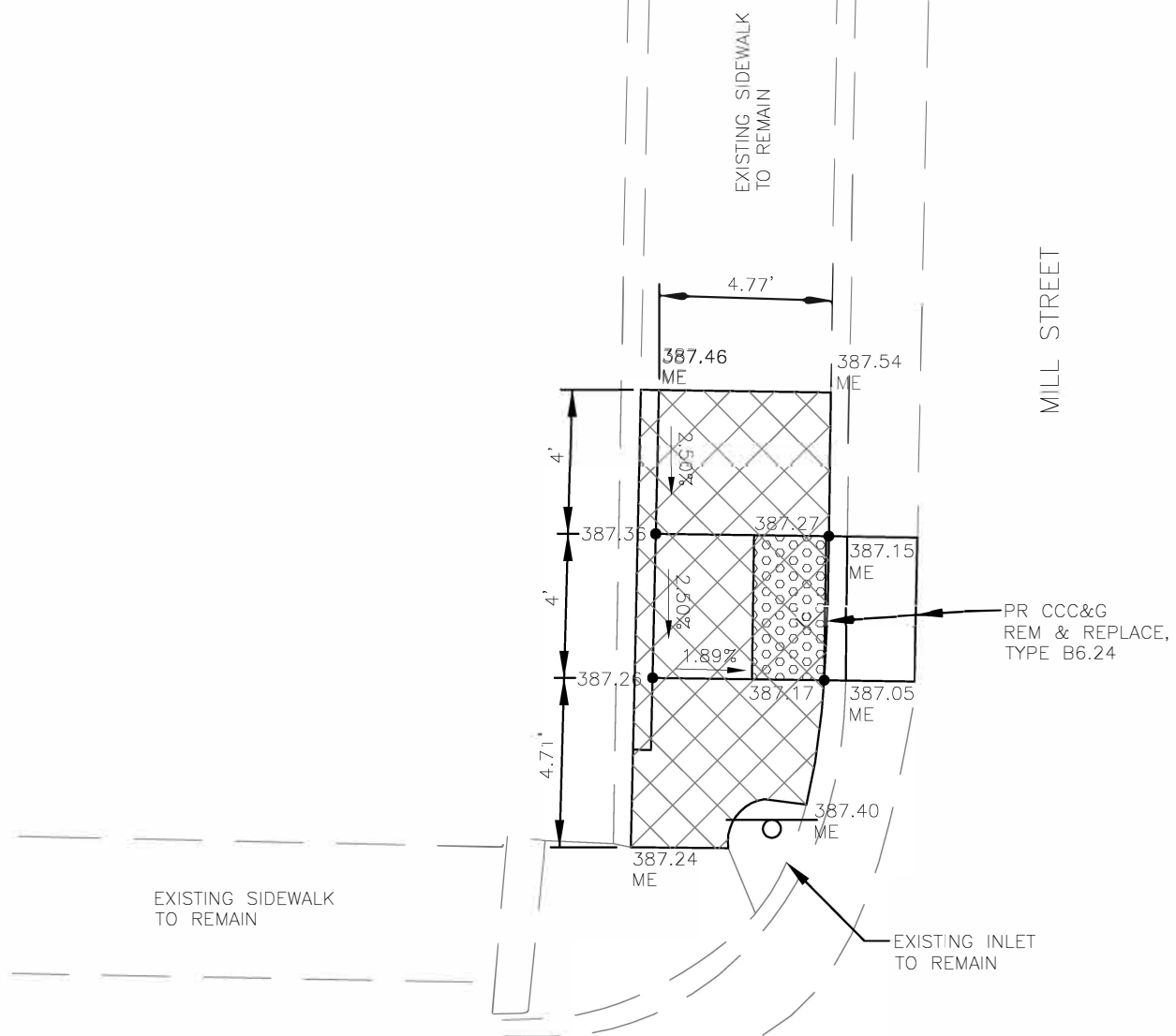
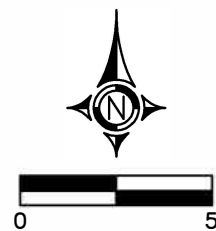

MILL STREET AND OAK STREET
NORTHWEST CORNER - SIDEWALK DETAIL

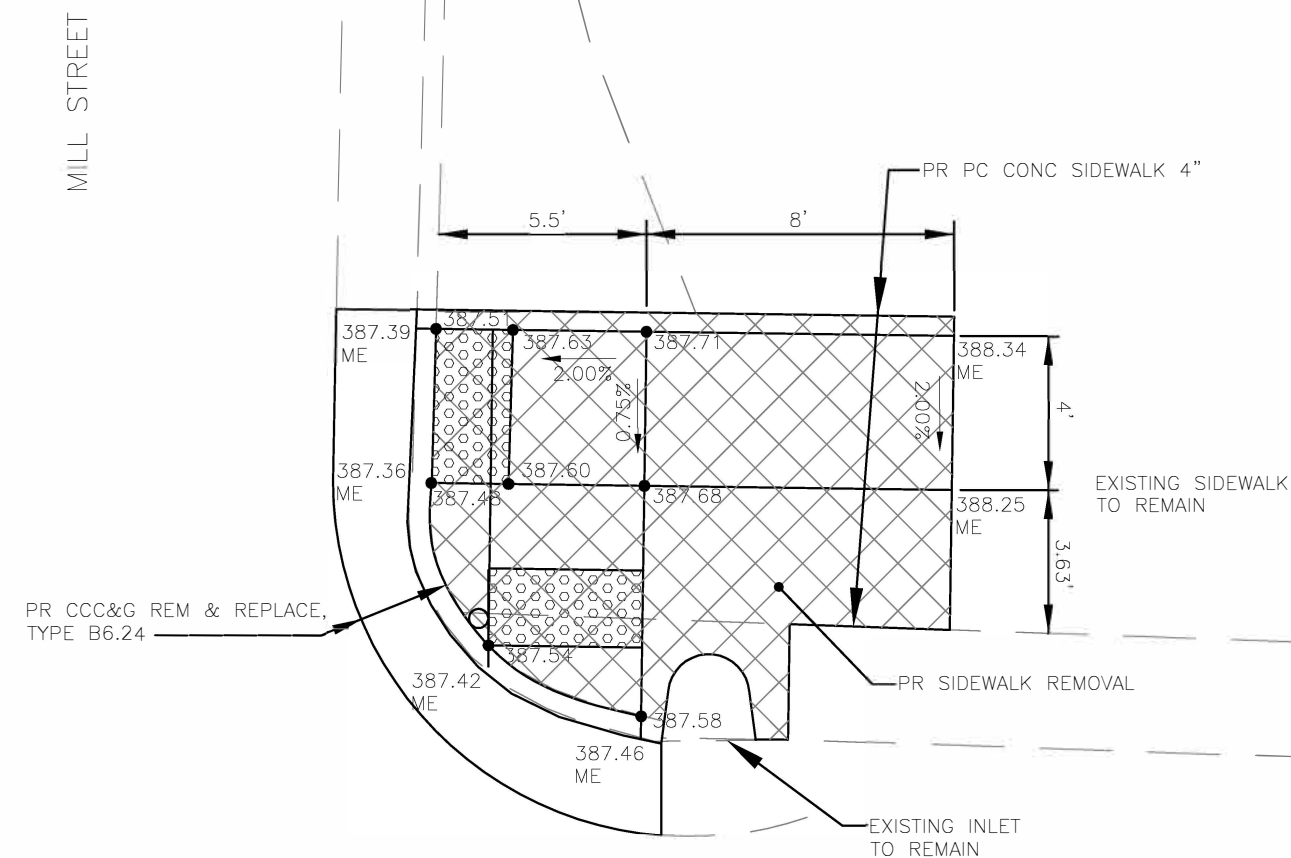

MILL STREET AND OAK STREET
NORTHEAST CORNER - SIDEWALK DETAIL

STREET NAME	PROJECT NO.	JOB NO.	ROUTE	SECTION	COUNTY	TOTAL SHEETS	SHEET NO.
MILL STREET	C5VT(573)	C-99-063-19	FAS 901	19-00159-00-RS	SALINE	20	13



WALNUT STREET

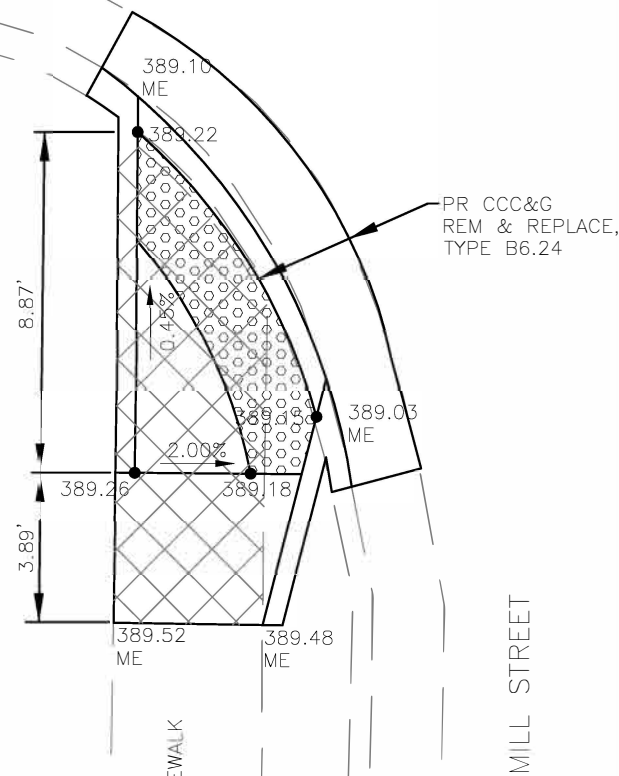

MILL STREET AND WALNUT STREET
SOUTHWEST CORNER - SIDEWALK DETAIL



WALNUT STREET

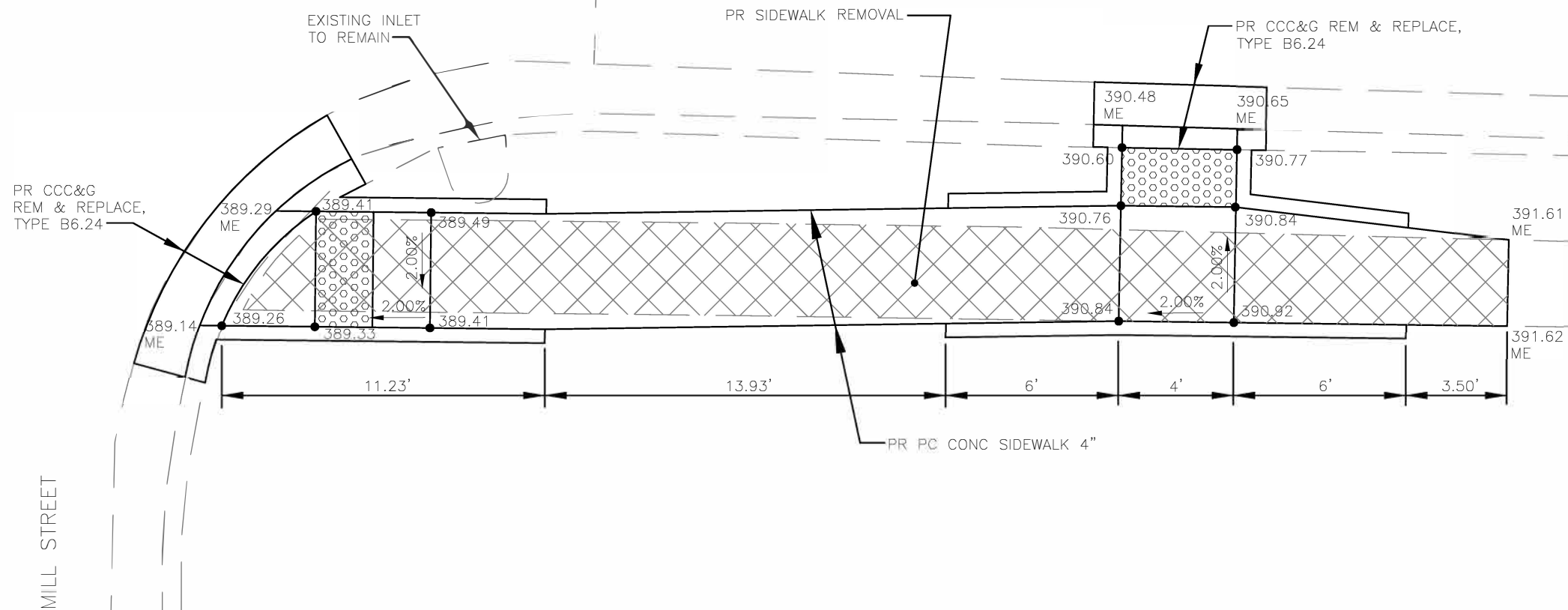

MILL STREET AND WALNUT STREET
SOUTHEAST CORNER - SIDEWALK DETAIL

STREET NAME	PROJECT NO.	JOB NO.	ROUTE	SECTION	COUNTY	TOTAL SHEETS	SHEET NO.
MILL STREET	C5VT(573)	C-99-063-19	FAS 901	19-00159-00-RS	SALINE	20	14

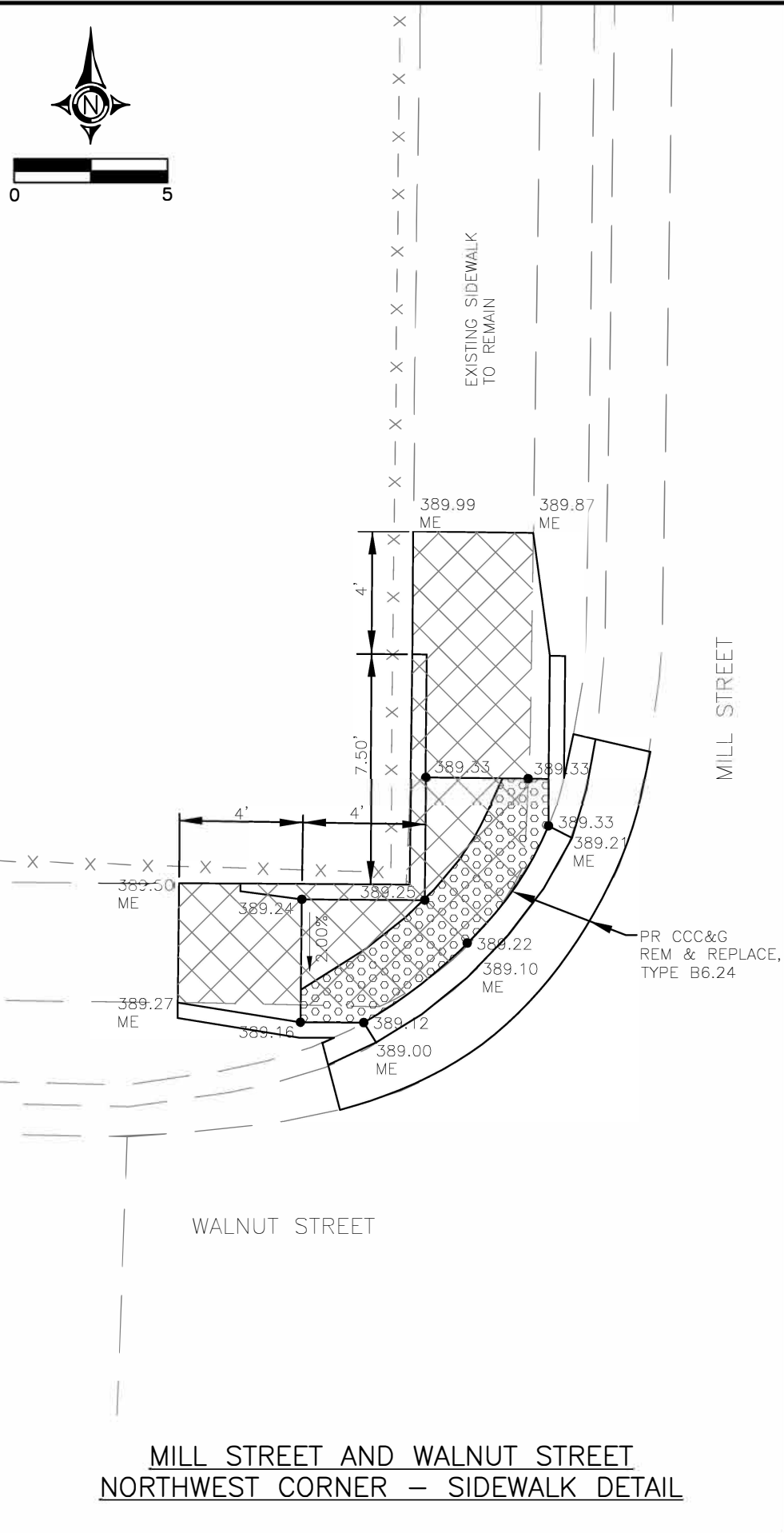

MILL STREET AND WALNUT STREET
NORTHWEST CORNER – SIDEWALK DETAIL

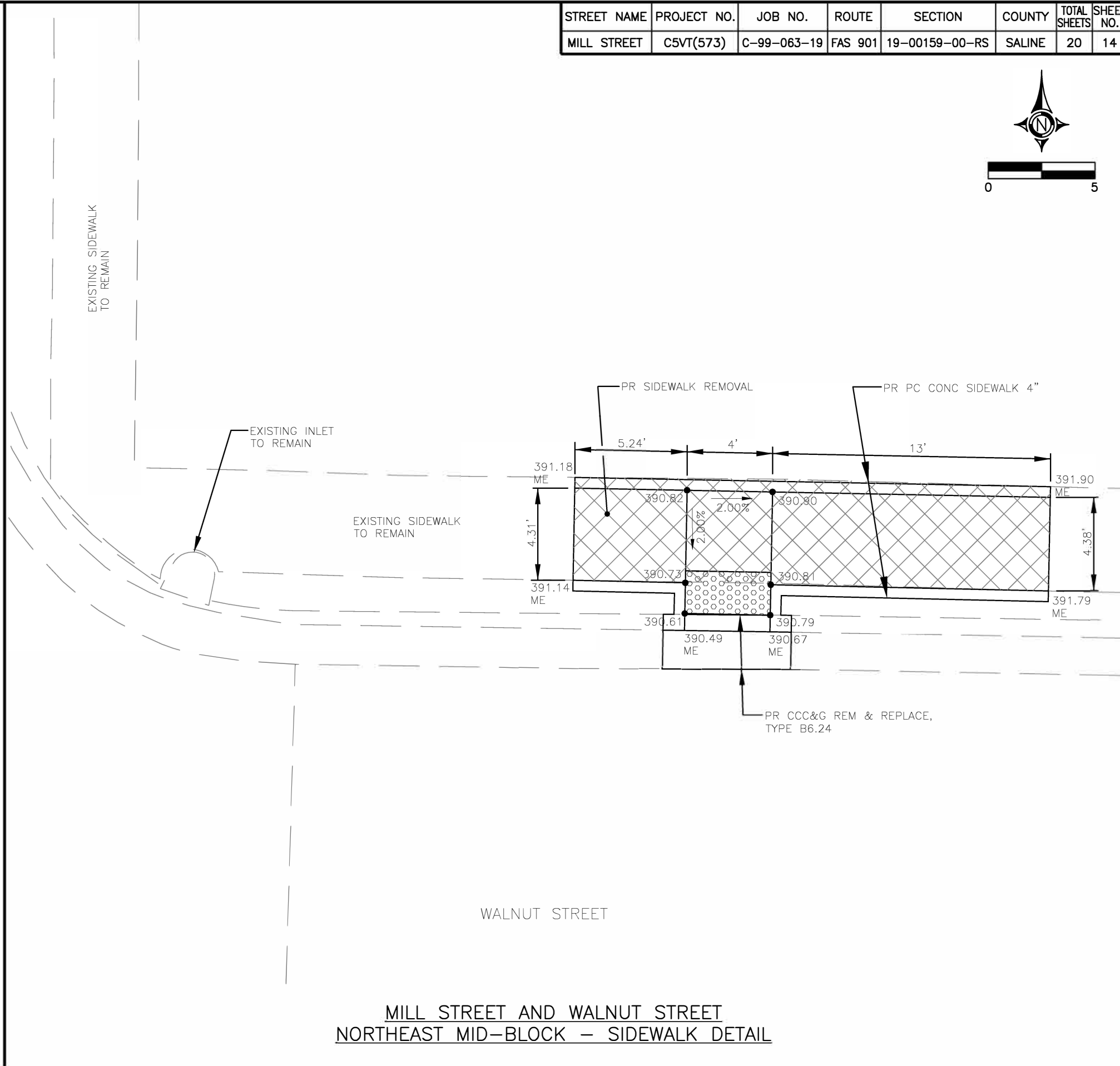

MILL STREET AND WALNUT STREET
NORTHEAST MID-BLOCK – SIDEWALK DETAIL

STREET NAME	PROJECT NO.	JOB NO.	ROUTE	SECTION	COUNTY	TOTAL SHEETS	SHEET NO.
MILL STREET	C5VT(573)	C-99-063-19	FAS 901	19-00159-00-RS	SALINE	20	15

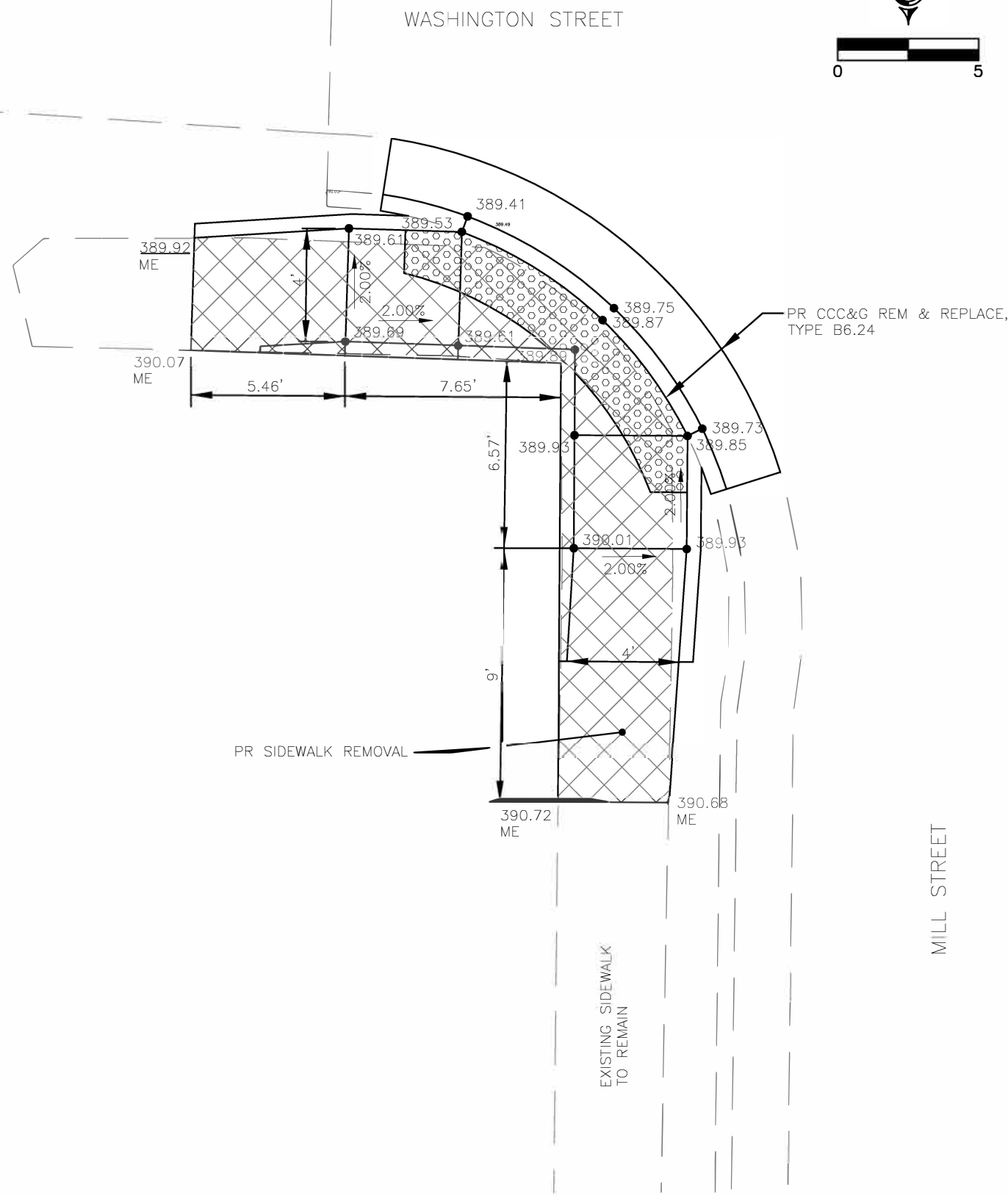
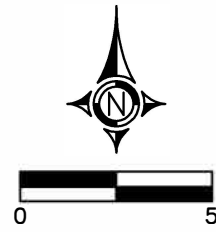

MILL STREET AND WASHINGTON STREET
SOUTHWEST CORNER – SIDEWALK DETAIL

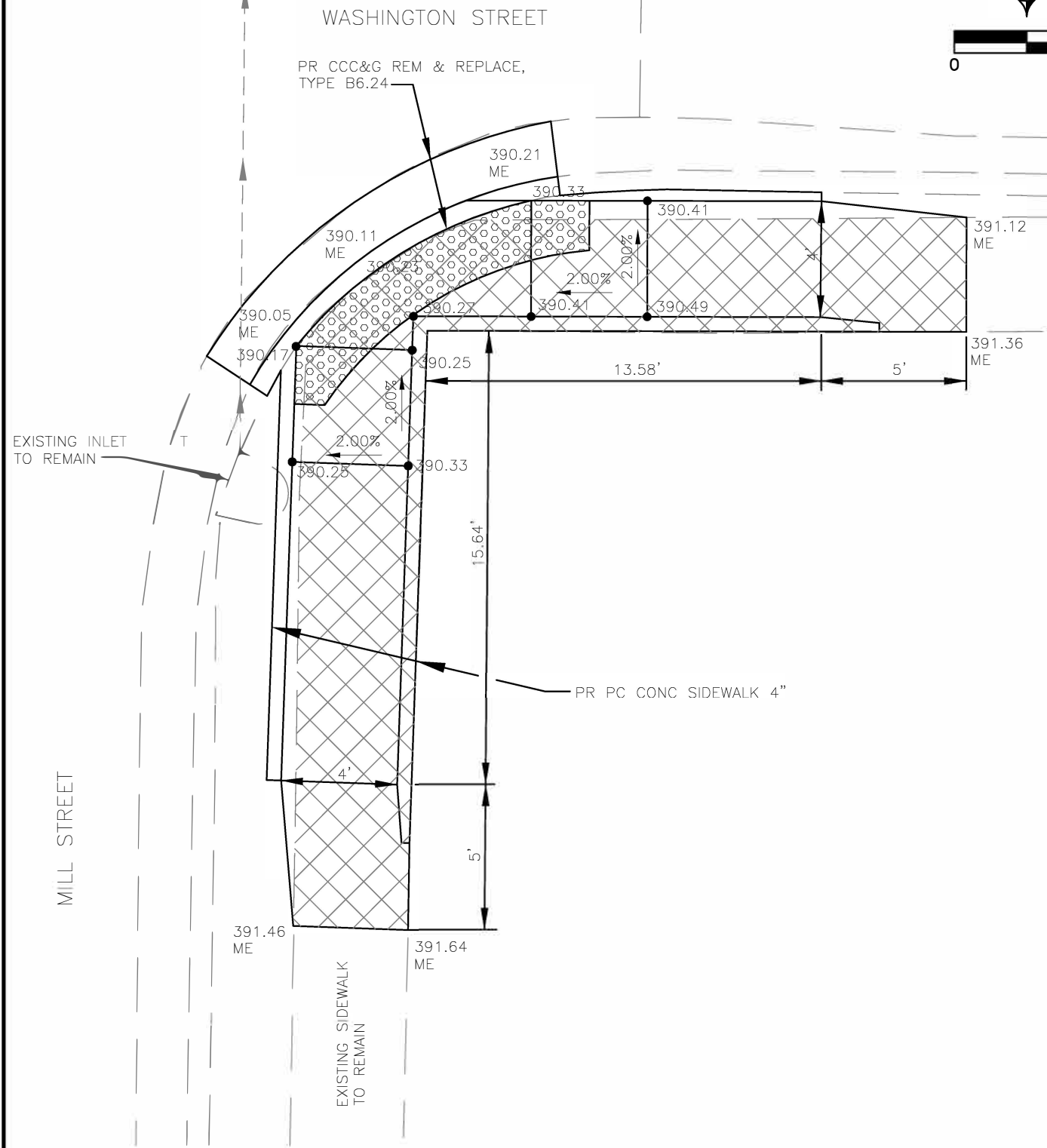
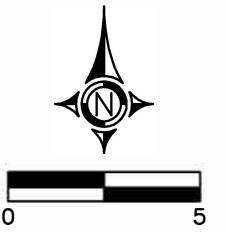

MILL STREET AND WASHINGTON STREET
SOUTHEAST CORNER – SIDEWALK DETAIL

STREET NAME	PROJECT NO.	JOB NO.	ROUTE	SECTION	COUNTY	TOTAL SHEETS	SHEET NO.
MILL STREET	C5VT(573)	C-99-063-19	FAS 901	19-00159-00-RS	SALINE	20	16

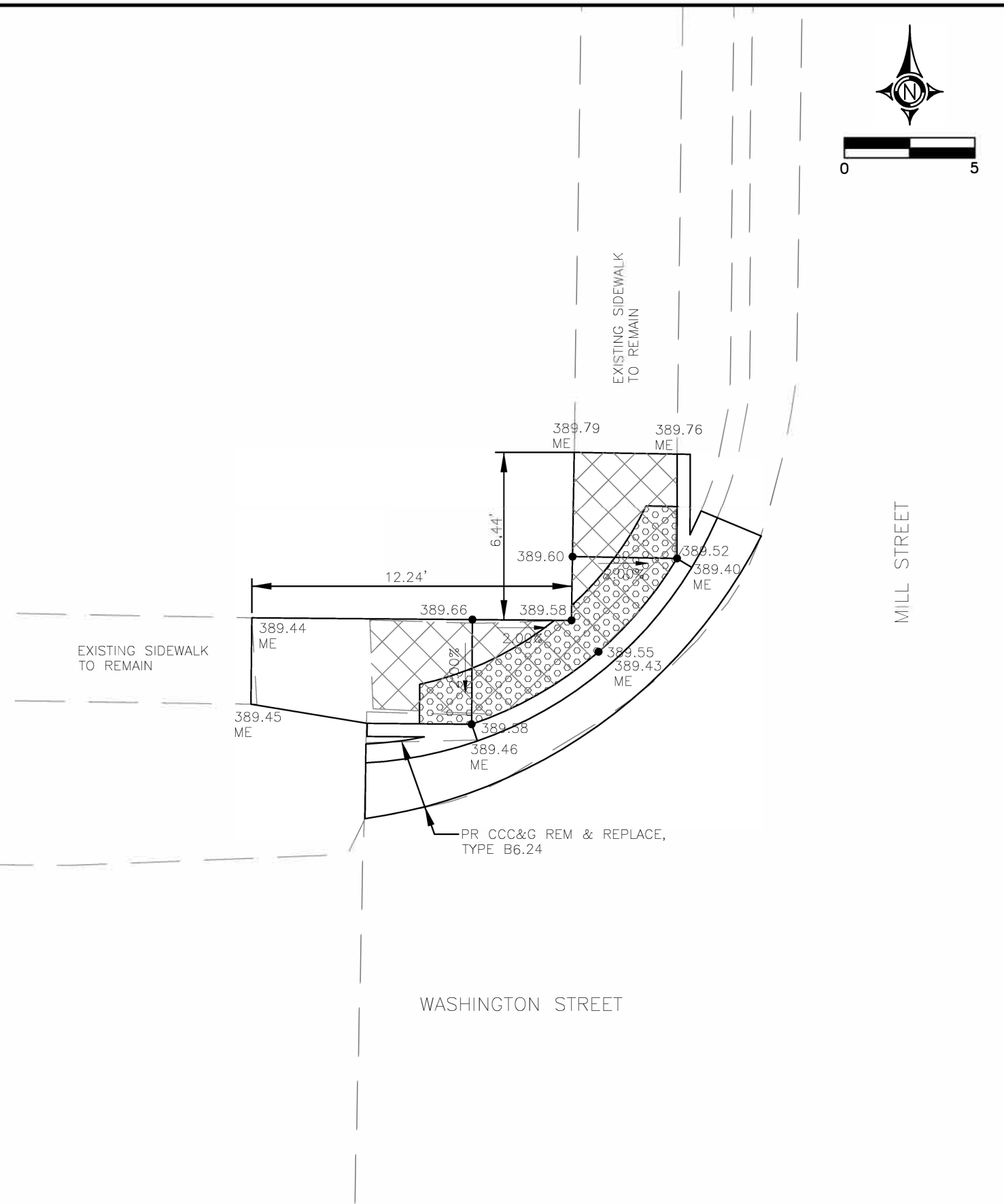

MILL STREET AND WASHINGTON STREET
NORTHWEST CORNER – SIDEWALK DETAIL

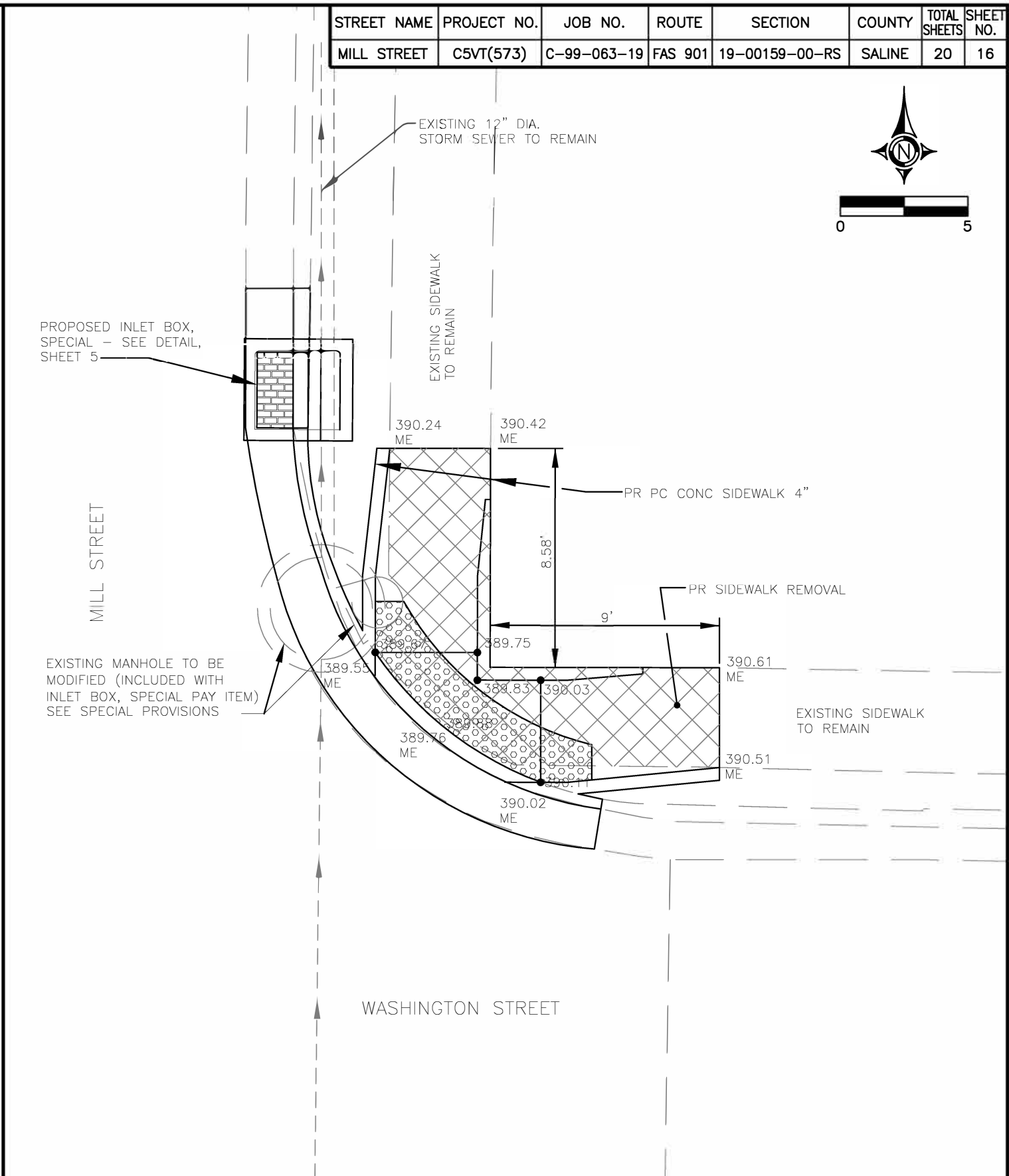

MILL STREET AND WASHINGTON STREET
NORTHEAST CORNER – SIDEWALK DETAIL

STREET NAME	PROJECT NO.	JOB NO.	ROUTE	SECTION	COUNTY	TOTAL SHEETS	SHEET NO.
MILL STREET	C5VT(573)	C-99-063-19	FAS 901	19-00159-00-RS	SALINE	20	17

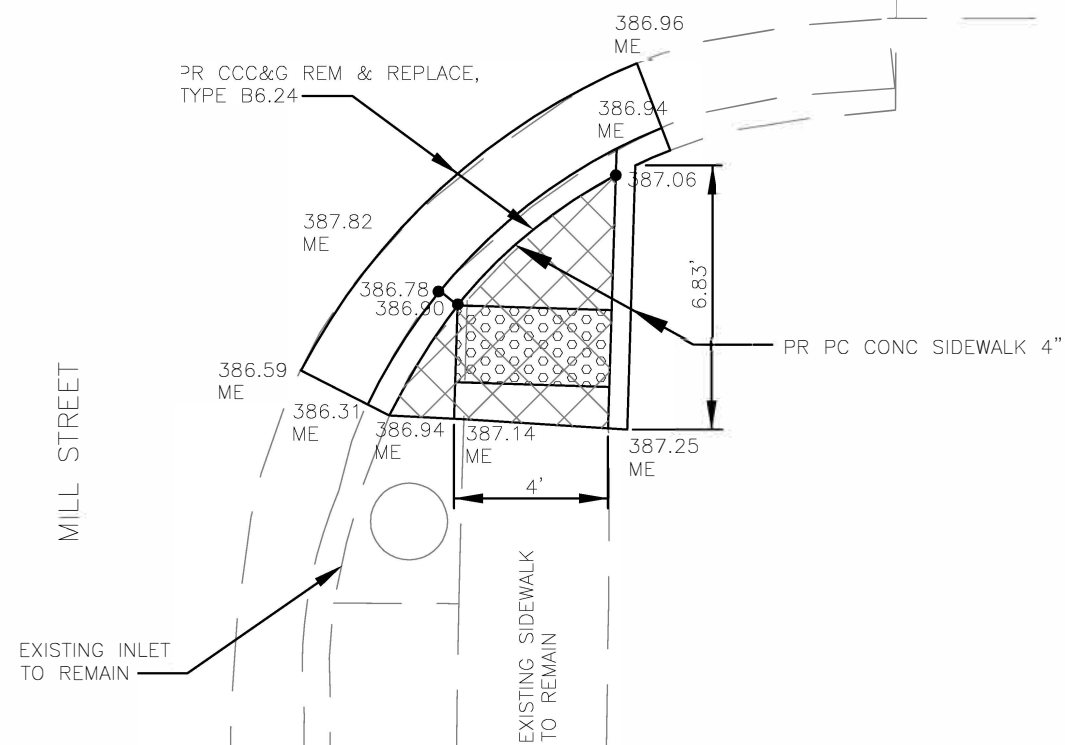

MILL STREET AND FURLONG STREET
SOUTHEAST CORNER – SIDEWALK DETAIL

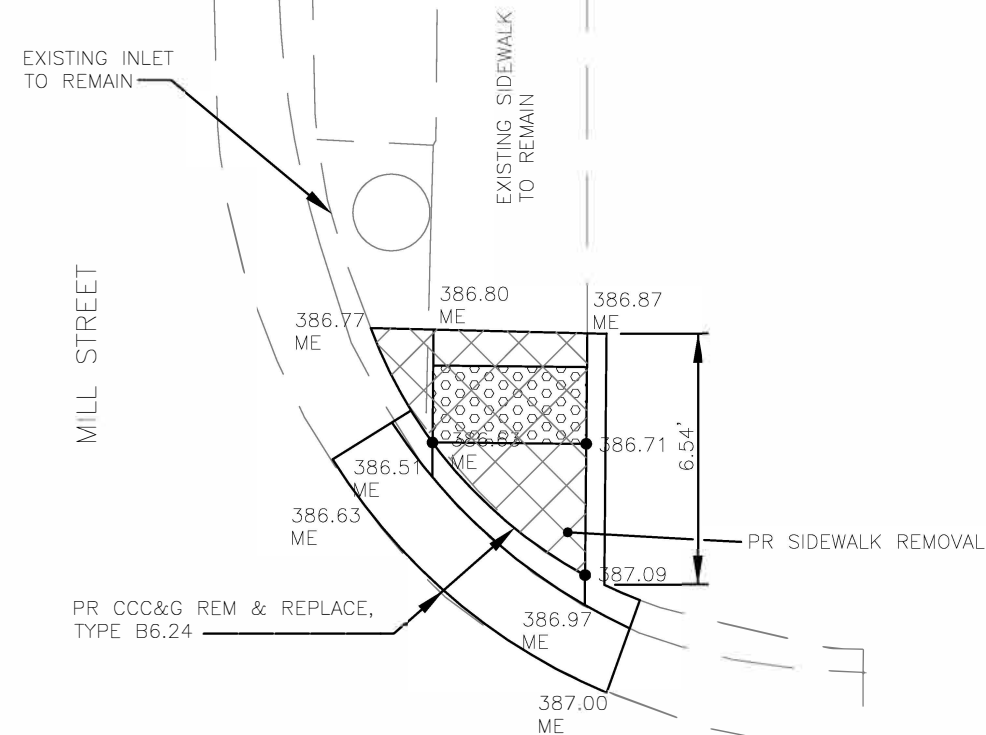

MILL STREET AND FURLONG STREET
NORTHEAST CORNER – SIDEWALK DETAIL

STREET NAME	PROJECT NO.	JOB NO.	ROUTE	SECTION	COUNTY	TOTAL SHEETS	SHEET NO.
MILL STREET	C5VT(573)	C-99-063-19	FAS 901	19-00159-00-RS	SALINE	20	18

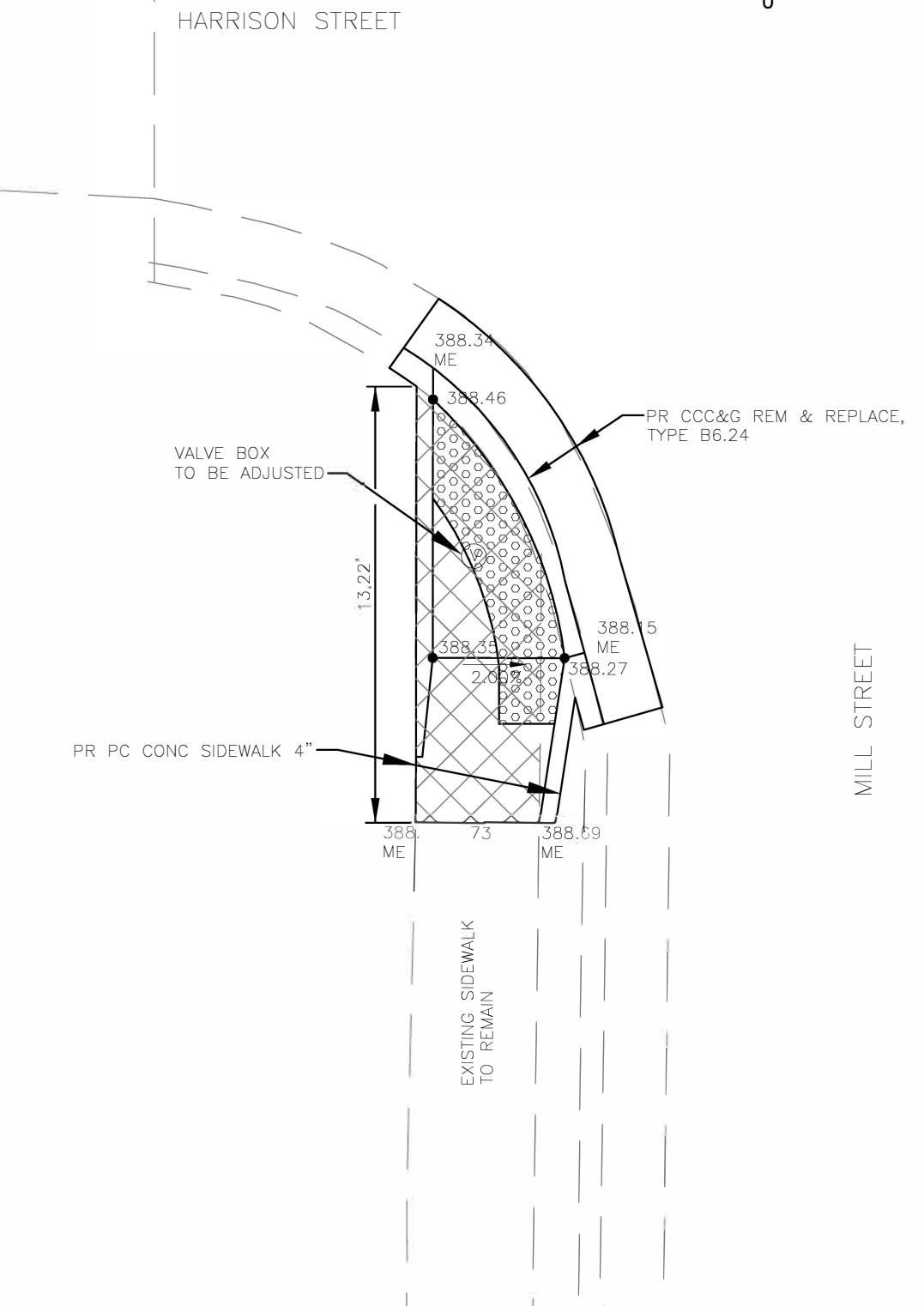
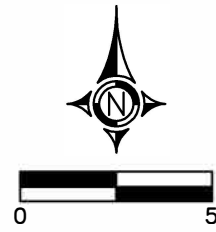

MILL STREET AND HARRISON STREET
SOUTHWEST CORNER – SIDEWALK DETAIL

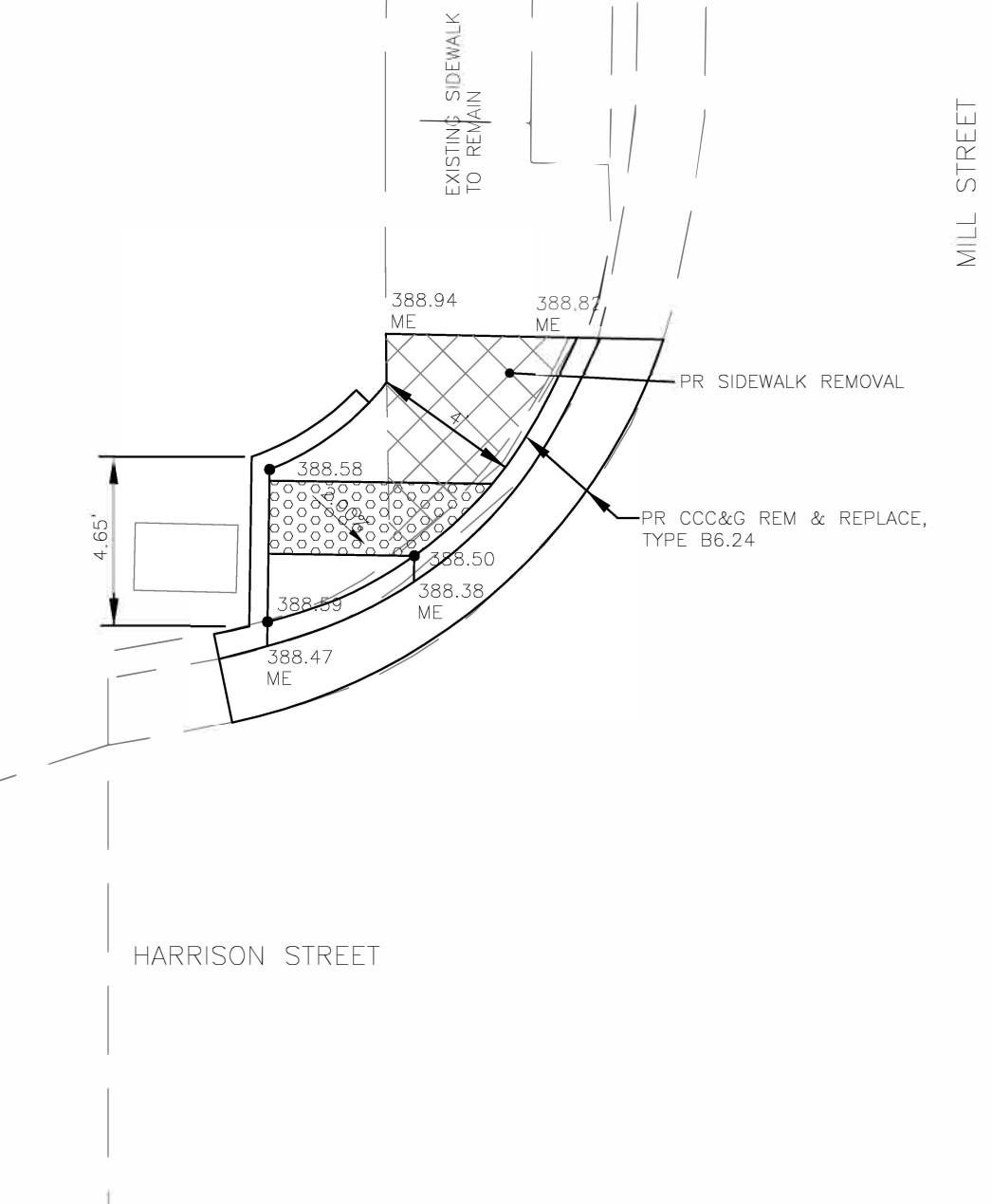

MILL STREET AND HARRISON STREET
NORTHWEST CORNER – SIDEWALK DETAIL

STREET NAME	PROJECT NO.	JOB NO.	ROUTE	SECTION	COUNTY	TOTAL SHEETS	SHEET NO.
MILL STREET	C5VT(573)	C-99-063-19	FAS 901	19-00159-00-RS	SALINE	20	19

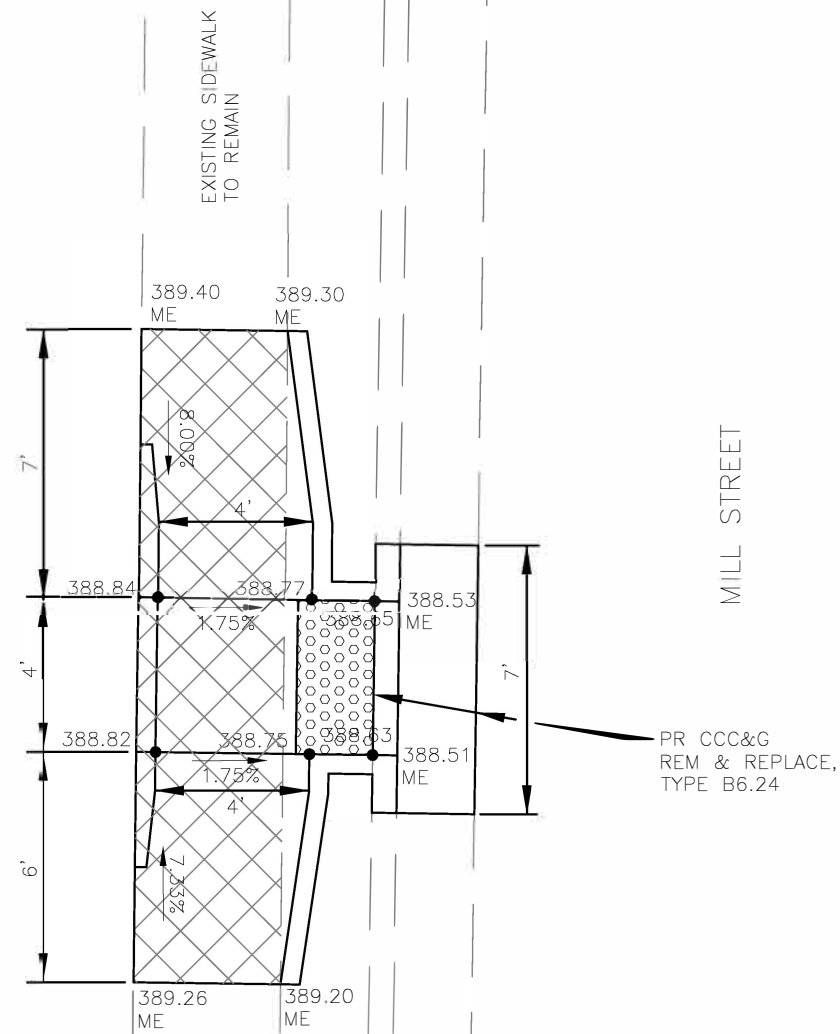
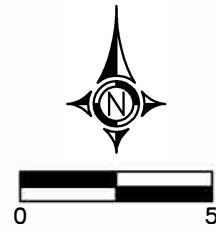

MILL STREET AND HARRISON STREET
NORTHWEST MID-BLOCK - SIDEWALK DETAIL

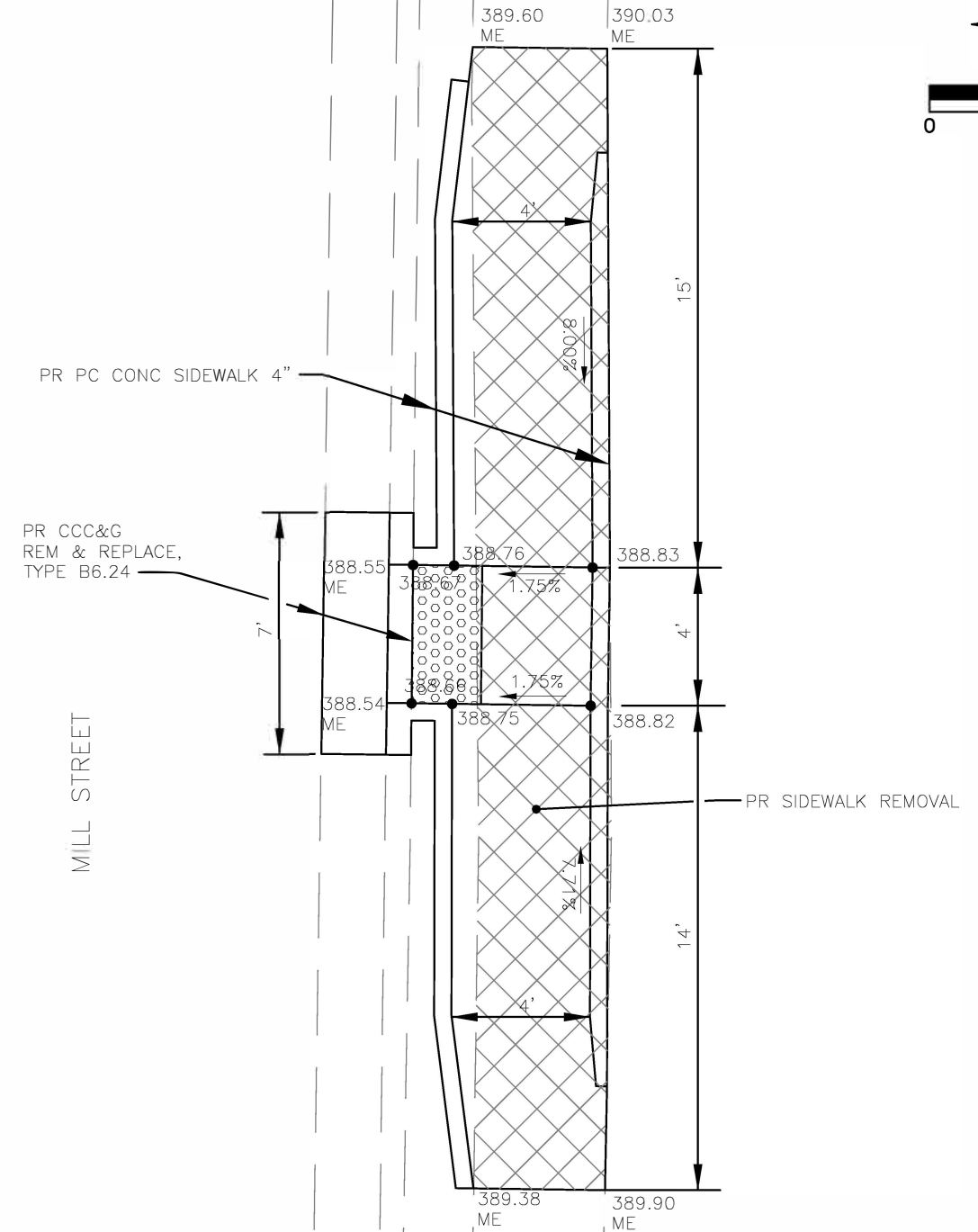

MILL STREET AND HARRISON STREET
NORTHEAST MID-BLOCK - SIDEWALK DETAIL

STREET NAME	PROJECT NO.	JOB NO.	ROUTE	SECTION	COUNTY	TOTAL SHEETS	SHEET NO.
MILL STREET	C5VT(573)	C-99-063-19	FAS 901	19-00159-00-RS	SALINE	20	20

