

	STATION	OFFSET	ELEVATION
A	104+91.07	88.7' LT	741.24
B	104+91.65	80.7' LT	741.32
C	104+92.50	88.8' LT	741.26
D	104+97.47	97.7' LT	741.90
E	104+98.38	89.1' LT	741.35
F	105+00.53	81.1' LT	741.40
G	105+02.16	81.2' LT	741.41 ME
H	105+02.41	89.2' LT	741.39
I	105+03.13	97.6' LT	741.99
J	105+03.99	89.2' LT	741.40 ME
K	105+33.48	89.6' LT	741.31 ME
L	105+37.21	81.6' LT	741.46 ME

	STATION	OFFSET	ELEVATION
M	105+34.99	89.6' LT	741.30
N	105+38.87	81.6' LT	741.45
O	105+46.30	89.7' LT	741.24
P	105+46.40	81.7' LT	741.32
Q	104+97.55	102.7' LT	742.00 ME
R	104+94.02	91.6' LT	741.31
S	105+03.10	102.7' LT	742.09 ME
T	105+01.83	95.3' LT	741.94
U	105+00.38	89.2' LT	741.37
V	105+38.80	89.6' LT	741.29
W	104+98.53	81.1' LT	741.38

LEGEND

LEVEL LANDING AREA

DETECTABLE WARNING TILE

NOTE:
STATIONS AND OFFSETS ARE BASED OFF THE HIGGINS ROAD CENTERLINE ALIGNMENT.

	STATION	OFFSET	ELEVATION
A	109+50.98	114.6' LT	739.92
B	109+50.75	106.6' LT	739.80
C	109+55.99	114.6' LT	739.87
D	109+55.76	106.6' LT	739.89
E	109+56.57	114.6' LT	739.87 ME
F	109+56.34	106.6' LT	739.89 ME
G	109+81.99	114.8' LT	739.88 ME
H	109+82.08	106.8' LT	739.92 ME
I	109+82.57	114.8' LT	739.88
J	109+82.66	106.8' LT	739.92
K	109+92.59	114.9' LT	739.92
L	109+92.68	106.9' LT	739.80

MODEL: Default
FILE NAME: N:\3101122610\Drawings\Main\CADD_Sheets\112261-sh-40A01.dgn

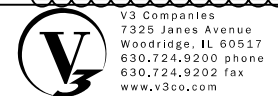

V3 Companies
7325 Janes Avenue
Woodridge, IL 60517
630.724.9200 phone
630.724.9202 fax
www.v3co.com

DESIGNED - BNP	REVISIONS - 5/26/2020
DRAWN - DRP	REVISIONS -
CHECKED - MJR	REVISIONS -
DATE - 4/10/2020	REVISIONS -

**STATE OF ILLINOIS
DEPARTMENT OF TRANSPORTATION**

ADA DETAILS

SCALE: 1"=5' SHEET 1 OF 5 SHEETS STA. TO STA.

F.A.P. RTE.	SECTION	COUNTY	TOTAL SHEETS	SHEET NO.
341	15-00122-00-BT	COOK	73	19
CONTRACT NO. 61G41				
ILLINOIS FED. AID PROJECT				IUG(914)

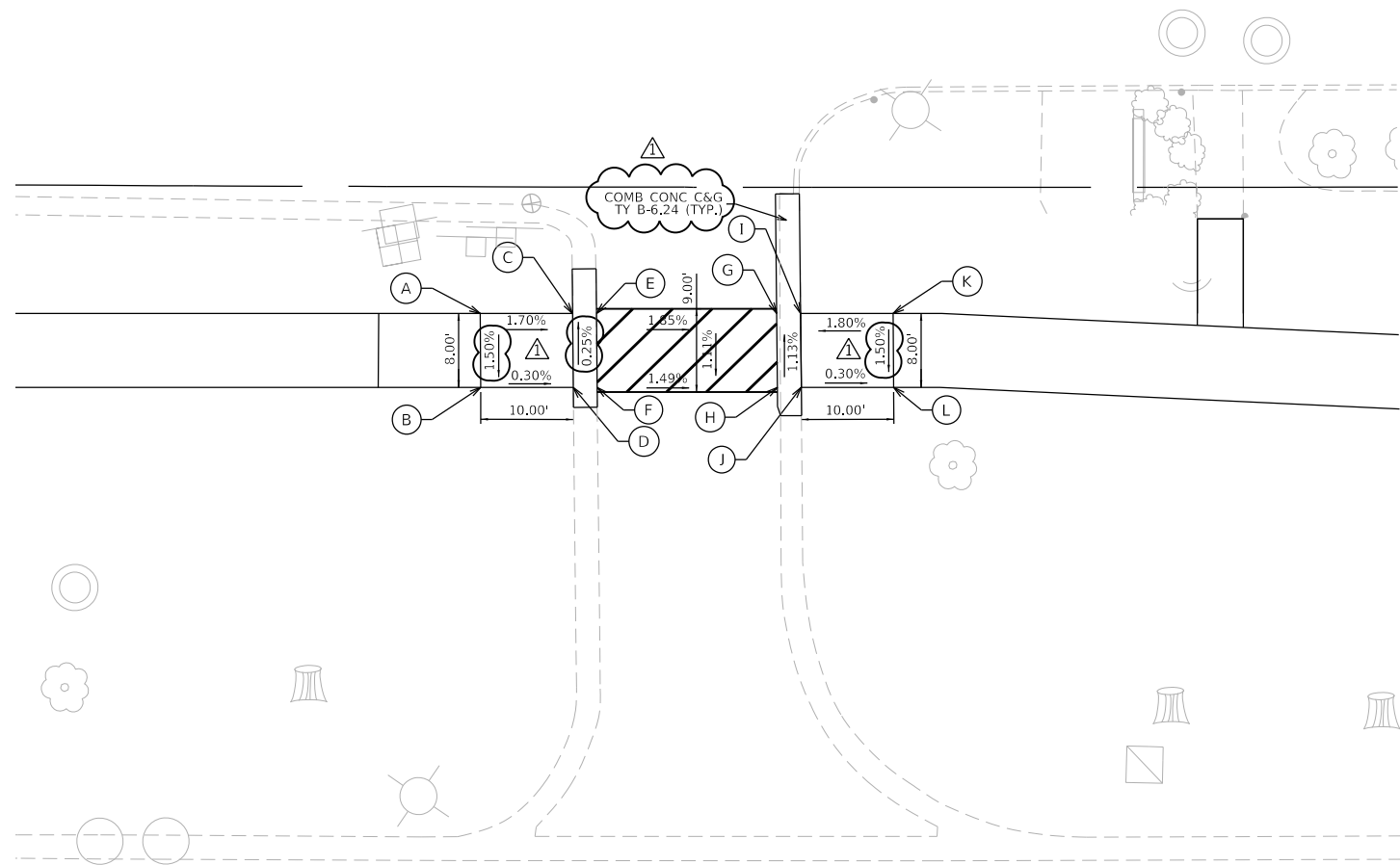

	STATION	OFFSET	ELEVATION
A	110+90.02	115.6' LT	740.38
B	110+90.15	107.6' LT	740.26
C	111+00.02	115.6' LT	740.21
D	111+00.15	107.6' LT	740.23
E	111+02.60	115.6' LT	740.27 ME
F	111+02.71	107.6' LT	740.29 ME
G	111+22.08	115.8' LT	739.85 ME
H	111+22.21	107.8' LT	739.94 ME
I	111+24.66	115.8' LT	739.79
J	111+24.80	107.8' LT	739.88
K	111+34.67	115.9' LT	739.97
L	111+34.80	107.9' LT	739.85

111

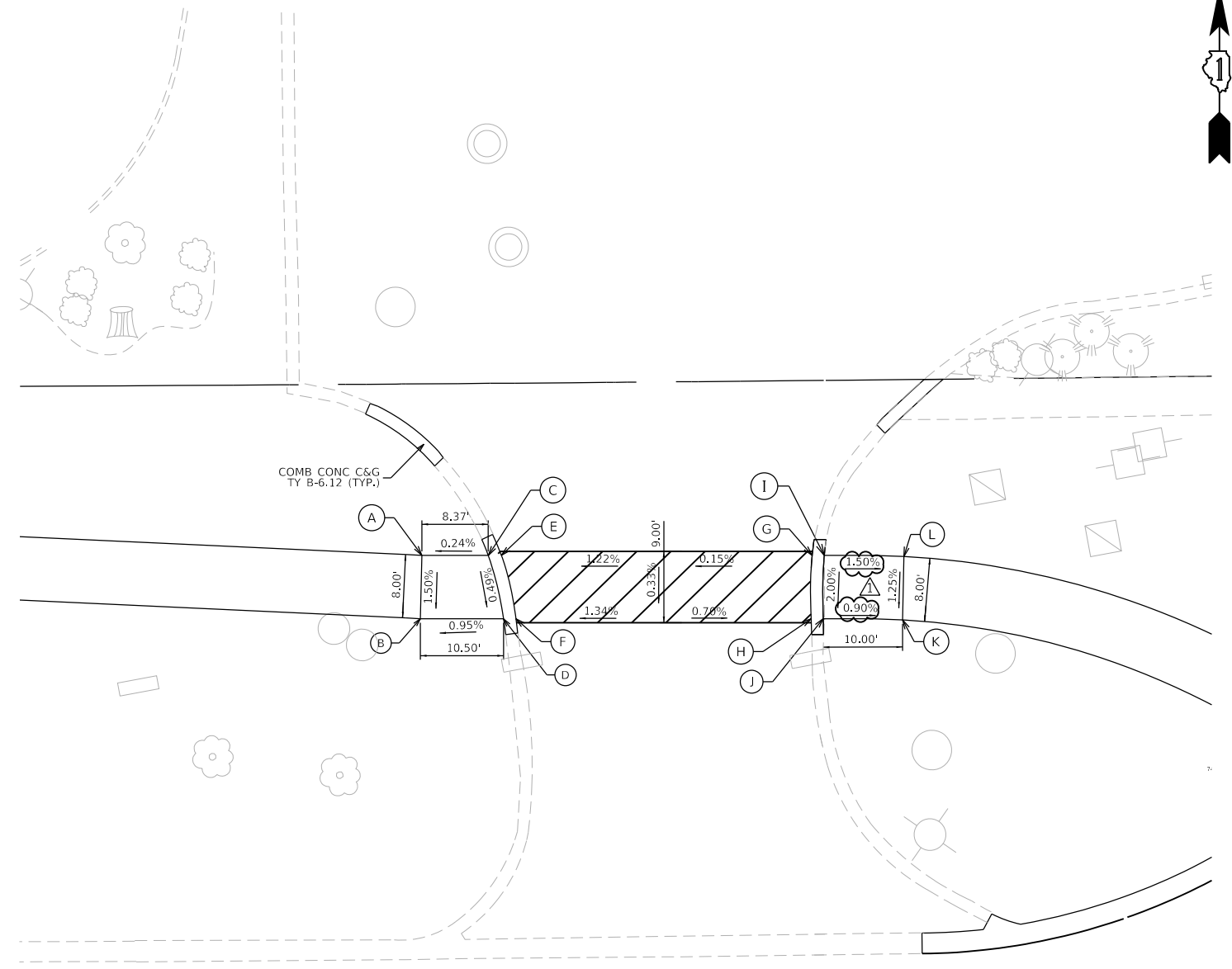
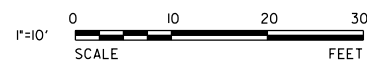

	STATION	OFFSET	ELEVATION
A	112+99.58	109.6' LT	741.14
B	112+99.45	101.6' LT	741.02
C	113+07.94	109.6' LT	741.16
D	113+09.94	101.6' LT	741.12
E	113+09.60	109.6' LT	741.17 ME
F	113+11.50	101.6' LT	741.13 ME
G	113+48.83	109.9' LT	741.43 ME
H	113+48.75	101.9' LT	741.27 ME
I	113+50.36	109.9' LT	741.42
J	113+50.27	101.9' LT	741.26
K	113+60.28	101.8' LT	741.17
L	113+60.40	109.8' LT	741.27

113

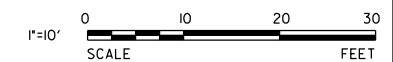

MODEL: Default
FILE NAME: N:\301151261\Drawings\Main\CADD_Sheets\01151261-sh1-40A02.dgn

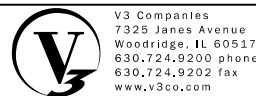

V3 Companies
7325 Janes Avenue
Woodridge, IL 60517
630.724.9200 phone
630.724.9202 fax
www.v3co.com

USER NAME = dpung	DESIGNED - BNP	REVISED - 5/26/2020
PLOT SCALE = 20'	DRAWN - DRP	REVISED -
PLOT DATE = 5/29/2020	CHECKED - MJR	REVISED -
	DATE - 4/10/2020	REVISED -

**STATE OF ILLINOIS
DEPARTMENT OF TRANSPORTATION**

ADA DETAILS

SCALE: 1"=10' SHEET 2 OF 5 SHEETS STA. TO STA.

F.A.P. RTE.	SECTION	COUNTY	TOTAL SHEETS	SHEET NO.
341	15-00122-00-BT	COOK	73	20
CONTRACT NO. 61G41				
ILLINOIS FED. AID PROJECT				IU2G(914)

MODEL: Default
 FILE NAME: N:\301\B11261\Drawings\Main\CADD_Sheets\B11261-sh1-40A03.dgn

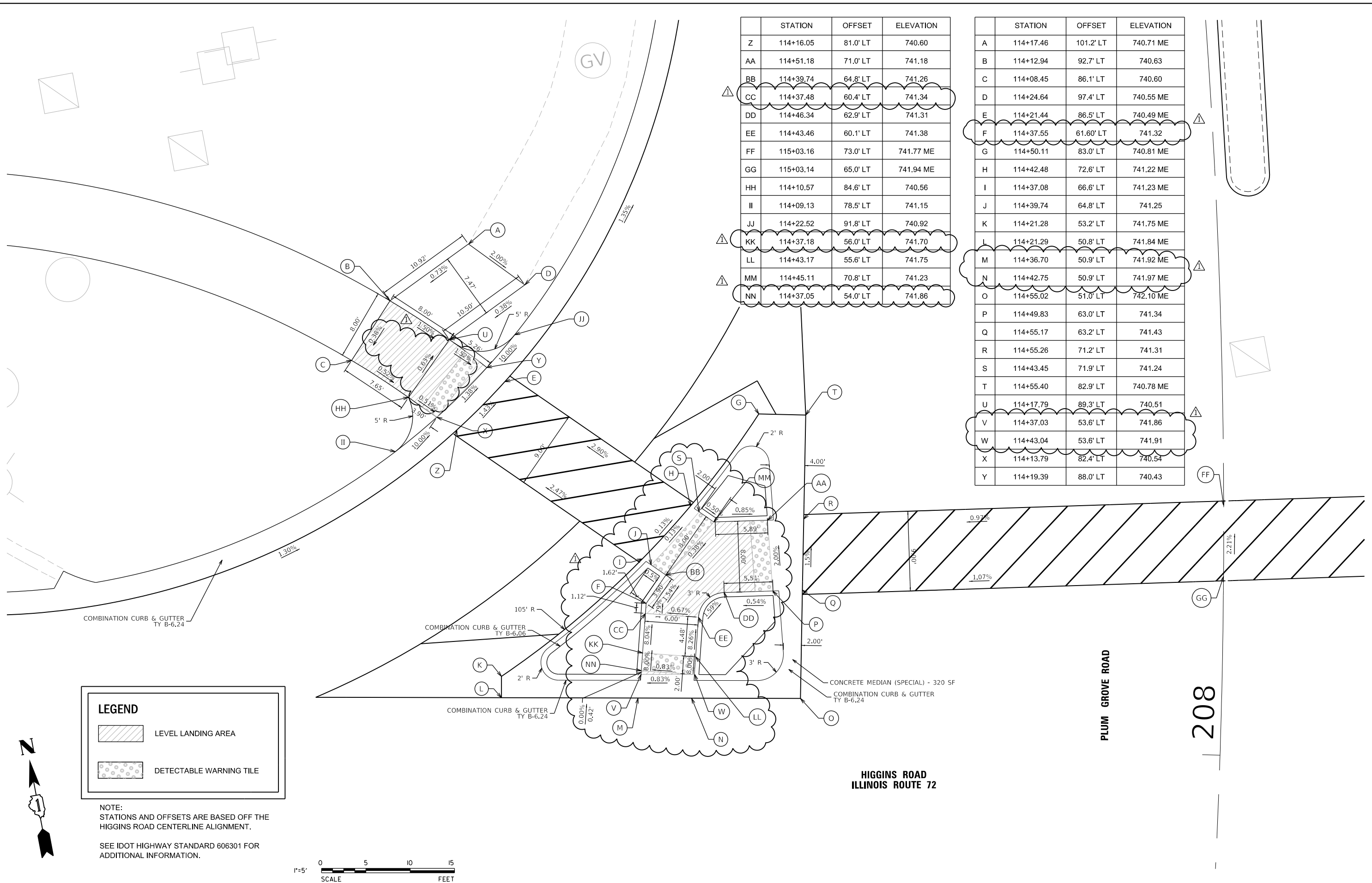

	STATION	OFFSET	ELEVATION
Z	114+16.05	81.0' LT	740.60
AA	114+51.18	71.0' LT	741.18
BB	114+39.74	64.8' LT	741.26
CC	114+37.48	60.4' LT	741.34
DD	114+46.34	62.9' LT	741.31
EE	114+43.46	60.1' LT	741.38
FF	115+03.16	73.0' LT	741.77 ME
GG	115+03.14	65.0' LT	741.94 ME
HH	114+10.57	84.6' LT	740.56
II	114+09.13	78.5' LT	741.15
JJ	114+22.52	91.8' LT	740.92
KK	114+37.18	56.0' LT	741.70
LL	114+43.17	55.6' LT	741.75
MM	114+45.11	70.8' LT	741.23
NN	114+37.05	54.0' LT	741.86

	STATION	OFFSET	ELEVATION
A	114+17.46	101.2' LT	740.71 ME
B	114+12.94	92.7' LT	740.63
C	114+08.45	86.1' LT	740.60
D	114+24.64	97.4' LT	740.55 ME
E	114+21.44	86.5' LT	740.49 ME
F	114+37.55	61.60' LT	741.32
G	114+50.11	83.0' LT	740.81 ME
H	114+42.48	72.6' LT	741.22 ME
I	114+37.08	66.6' LT	741.23 ME
J	114+39.74	64.8' LT	741.25
K	114+21.28	53.2' LT	741.75 ME
L	114+21.29	50.8' LT	741.84 ME
M	114+36.70	50.9' LT	741.92 ME
N	114+42.75	50.9' LT	741.97 ME
O	114+55.02	51.0' LT	742.10 ME
P	114+49.83	63.0' LT	741.34
Q	114+55.17	63.2' LT	741.43
R	114+55.26	71.2' LT	741.31
S	114+43.45	71.9' LT	741.24
T	114+55.40	82.9' LT	740.78 ME
U	114+17.79	89.3' LT	740.51
V	114+37.03	53.6' LT	741.86
W	114+43.04	53.6' LT	741.91
X	114+13.79	82.4' LT	740.54
Y	114+19.39	88.0' LT	740.43

LEGEND

- LEVEL LANDING AREA
- DETECTABLE WARNING TILE

NOTE:
 STATIONS AND OFFSETS ARE BASED OFF THE HIGGINS ROAD CENTERLINE ALIGNMENT.

SEE IDOT HIGHWAY STANDARD 606301 FOR ADDITIONAL INFORMATION.

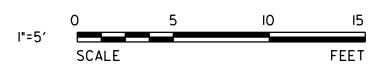

**HIGGINS ROAD
 ILLINOIS ROUTE 72**

PLUM GROVE ROAD

208

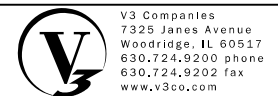

USER NAME = dpung	DESIGNED - BNP	REVISED - 5/26/2020
PLOT SCALE = 10'	DRAWN - DRP	REVISED -
PLOT DATE = 5/29/2020	CHECKED - MJR	REVISED -
	DATE - 4/10/2020	REVISED -

**STATE OF ILLINOIS
 DEPARTMENT OF TRANSPORTATION**

ADA AND ISLAND DETAILS

SCALE: 1"=5' SHEET 3 OF 5 SHEETS STA. TO STA.

F.A.P. RTE.	SECTION	COUNTY	TOTAL SHEETS	SHEET NO.
341	15-00122-00-BT	COOK	73	21
CONTRACT NO. 61G41				
ILLINOIS FED. AID PROJECT				IJ2G(914)

	STATION	OFFSET	ELEVATION
A	115+03.16	73.0' LT	741.77 ME
B	115+03.14	65.0' LT	741.94 ME
C	115+43.91	87.3' LT	742.03 ME
D	115+43.77	74.3' LT	742.16 ME
E	115+43.69	66.33' LT	742.23 ME
F	115+43.55	53.2' LT	742.44 ME
G	115+46.70	89.5' LT	741.99 ME
H	115+54.72	80.7' LT	742.09 ME
I	115+60.58	75.3' LT	742.18 ME
J	115+86.77	57.8' LT	742.44 ME
K	115+86.83	53.8' LT	742.56 ME
L	115+70.00	95.8' LT	741.88
M	115+75.90	90.4' LT	741.92
N	115+71.83	97.7' LT	741.82
O	115+77.74	92.2' LT	741.86
P	115+78.69	104.5' LT	741.68
Q	115+84.32	98.8' LT	741.72
R	115+46.44	74.4' LT	742.10
S	115+46.35	65.41' LT	742.17
T	115+54.15	80.1' LT	742.11
U	115+60.00	74.7' LT	742.20
V	115+48.45	74.5' LT	742.10
W	115+51.84	66.6' LT	742.18
X	115+68.22	101.4' LT	742.33
Y	115+82.27	88.7' LT	742.44

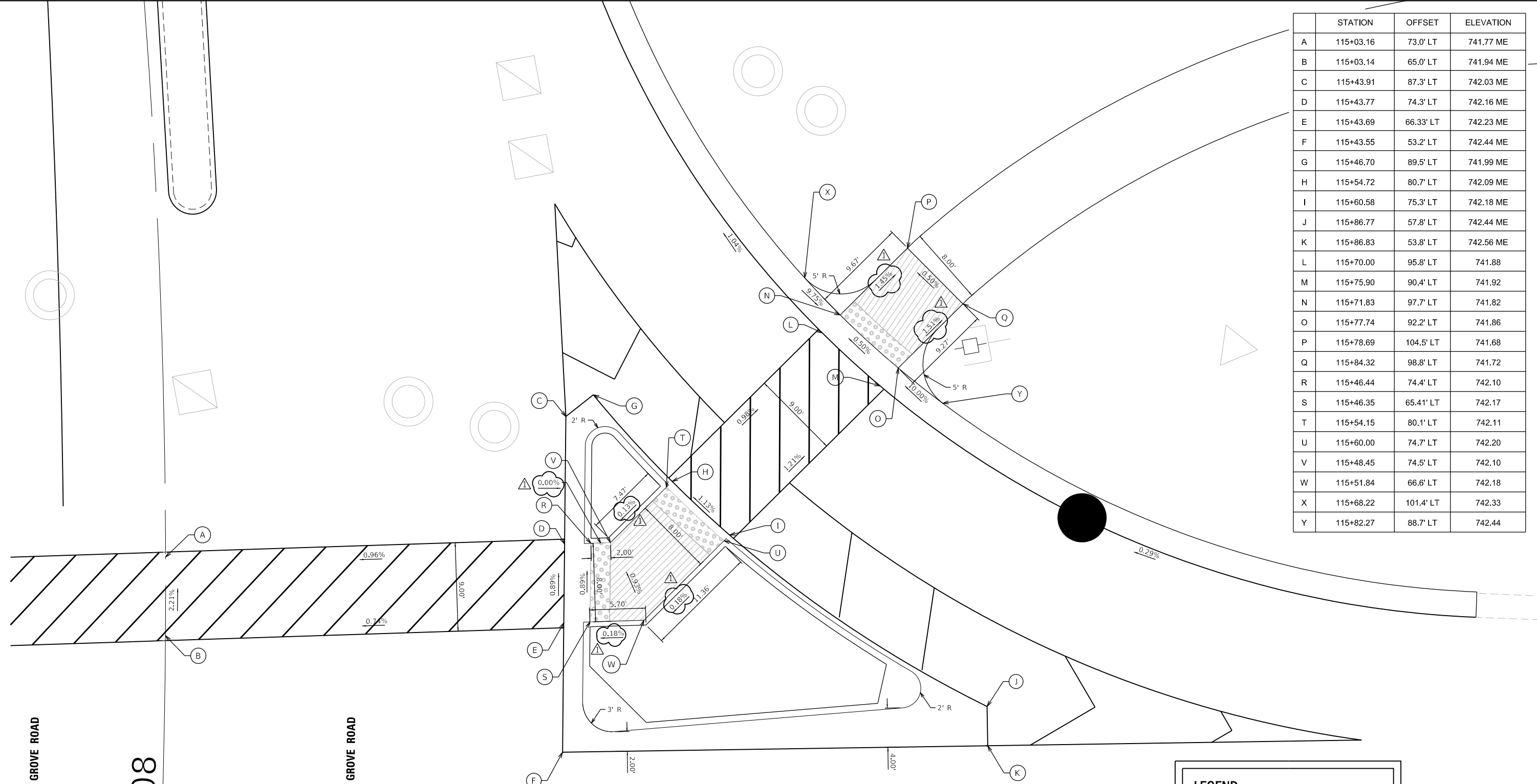

LEGEND

 LEVEL LANDING AREA

 DETECTABLE WARNING TILE

NOTE:
STATIONS AND OFFSETS ARE BASED OFF THE HIGGINS ROAD CENTERLINE ALIGNMENT.
SEE IDOT HIGHWAY STANDARD 606301 FOR ADDITIONAL INFORMATION.

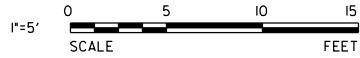

MODEL: Default
FILE NAME: N:\2018\1826\1\Drawings\Mstr\CADD_Sheets\011826_1-sit-ADA04.dgn

V3 Companies
7325 Janes Avenue
Woodridge, IL 60517
630.724.9200 phone
630.724.9202 fax
www.v3co.com

USER NAME = dpung	DESIGNED - BNP	REVISED -  5/26/2020
PLOT SCALE = 10"	DRAWN - DRP	REVISED -
PLOT DATE = 5/29/2020	CHECKED - MJR	REVISED -
	DATE - 4/10/2020	REVISED -

**STATE OF ILLINOIS
DEPARTMENT OF TRANSPORTATION**

ADA AND ISLAND DETAILS

SCALE: 1"=5' SHEET 4 OF 5 SHEETS STA. TO STA.

F.A.P. RTE. 341	SECTION 15-00122-00-BT	COUNTY COOK	TOTAL SHEETS 73	SHEET NO. 22
ILLINOIS FED. AID PROJECT			CONTRACT NO. 61G41	
			IU2G(914)	

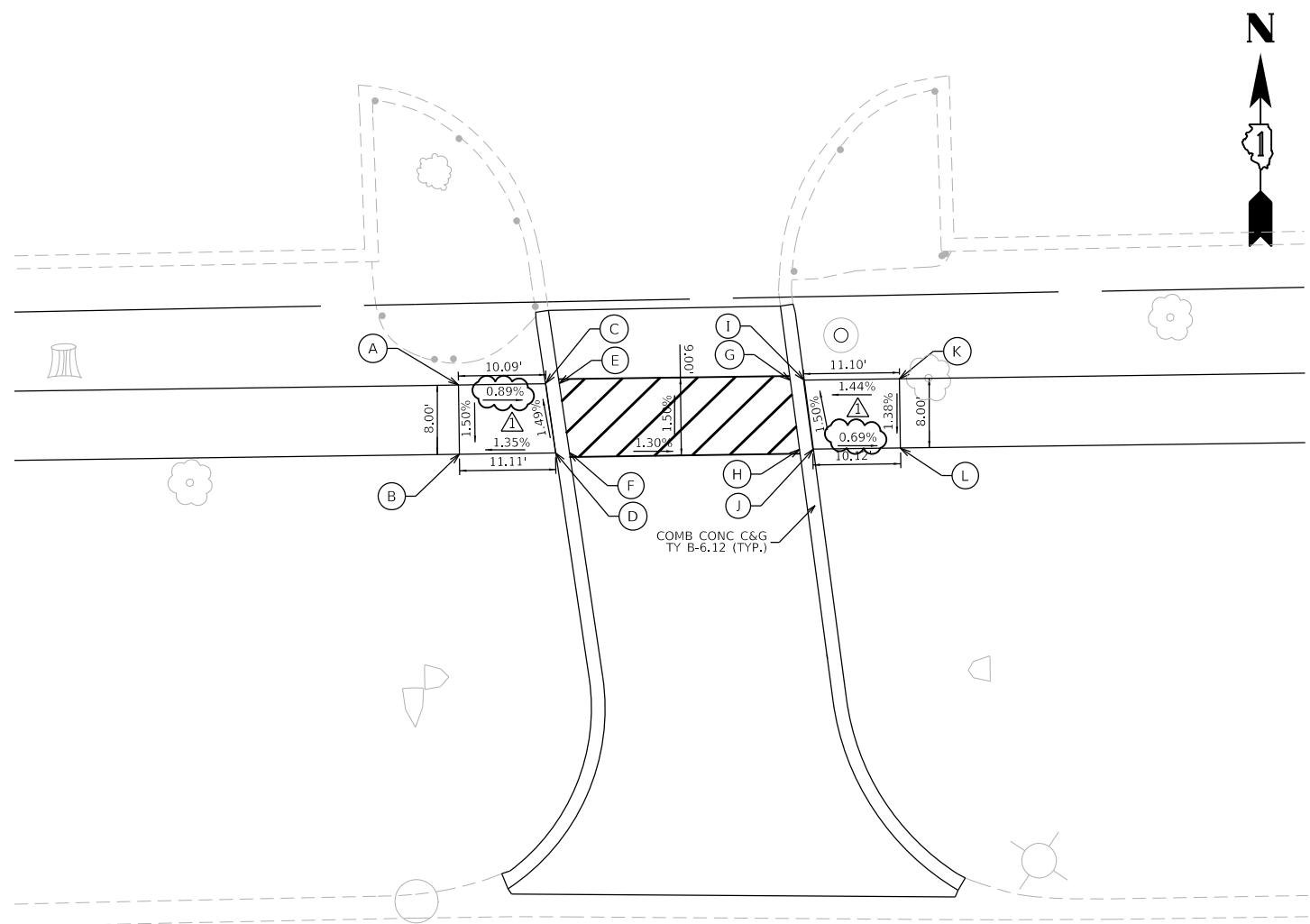

	STATION	OFFSET	ELEVATION
A	119+97.69	133.7' LT	737.83
B	119+97.73	125.7' LT	737.71
C	120+07.84	133.7' LT	737.74
D	120+08.90	125.7' LT	737.86
E	120+09.40	133.7' LT	737.75
F	120+10.51	125.7' LT	737.87
G	120+36.28	133.8' LT	737.40
H	120+37.26	125.8' LT	737.52
I	120+37.88	133.8' LT	737.39
J	120+38.86	125.8' LT	737.51
K	120+48.96	133.9' LT	737.55
L	120+48.99	125.9' LT	737.44

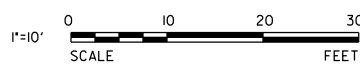
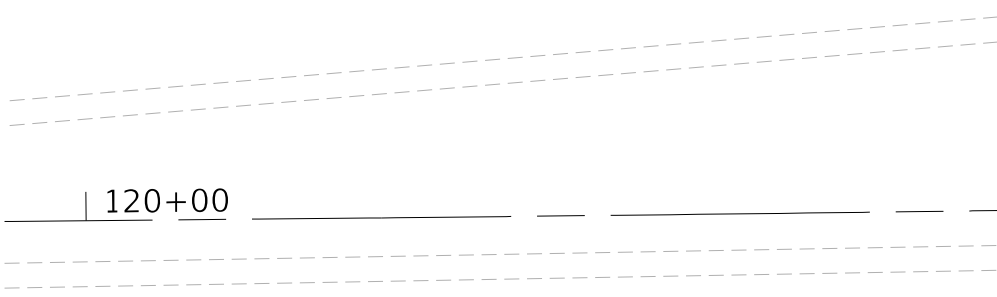

MODEL: Default
 FILE NAME: N:\301\12261\Drawings\Main\CADD_Sheets\0112261-sh1-4\0405.dgn

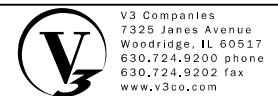

V3 Companies
 7325 Janes Avenue
 Woodridge, IL 60517
 630.724.9200 phone
 630.724.9202 fax
 www.v3co.com

USER NAME = dpung	DESIGNED - BNP	REVISED - 5/26/2020
PLOT SCALE = 20'	DRAWN - DRP	REVISED -
PLOT DATE = 5/29/2020	CHECKED - MJR	REVISED -
	DATE - 4/10/2020	REVISED -

STATE OF ILLINOIS
DEPARTMENT OF TRANSPORTATION

ADA DETAILS
 SCALE: 1"=10' SHEET 5 OF 5 SHEETS STA. TO STA.

F.A.P. RTE.	SECTION	COUNTY	TOTAL SHEETS	SHEET NO.
341	15-00122-00-BT	COOK	73	23
CONTRACT NO. 61G41				
ILLINOIS		FED. AID PROJECT		IU2G(914)

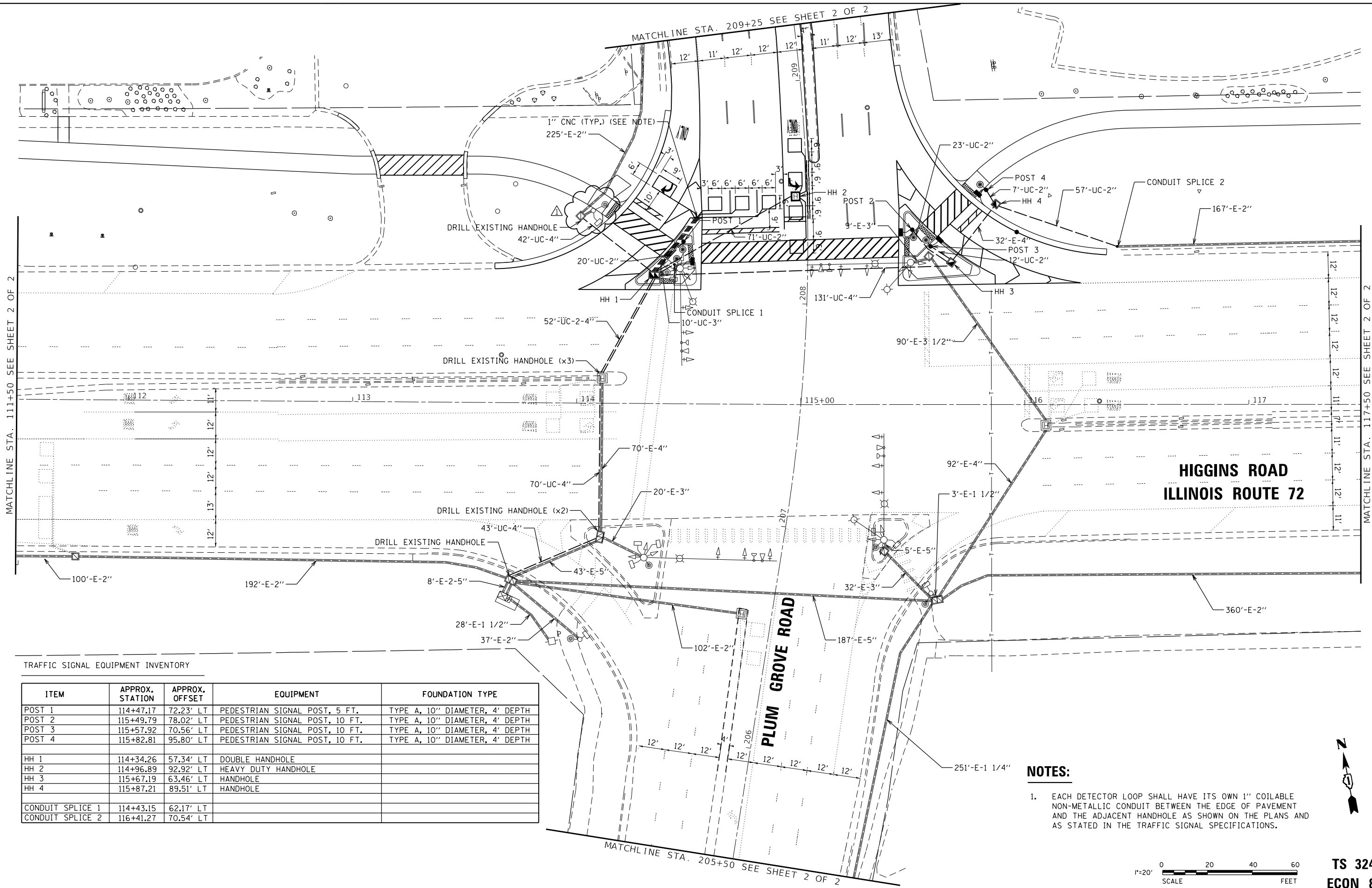

TRAFFIC SIGNAL EQUIPMENT INVENTORY

ITEM	APPROX. STATION	APPROX. OFFSET	EQUIPMENT	FOUNDATION TYPE
POST 1	114+47.17	72.23' LT	PEDESTRIAN SIGNAL POST, 5 FT.	TYPE A, 10" DIAMETER, 4' DEPTH
POST 2	115+49.79	78.02' LT	PEDESTRIAN SIGNAL POST, 10 FT.	TYPE A, 10" DIAMETER, 4' DEPTH
POST 3	115+57.92	70.56' LT	PEDESTRIAN SIGNAL POST, 10 FT.	TYPE A, 10" DIAMETER, 4' DEPTH
POST 4	115+82.81	95.80' LT	PEDESTRIAN SIGNAL POST, 10 FT.	TYPE A, 10" DIAMETER, 4' DEPTH
HH 1	114+34.26	57.34' LT	DOUBLE HANDHOLE	
HH 2	114+96.89	92.92' LT	HEAVY DUTY HANDHOLE	
HH 3	115+67.19	63.46' LT	HANDHOLE	
HH 4	115+87.21	89.51' LT	HANDHOLE	
CONDUIT SPLICE 1	114+43.15	62.17' LT		
CONDUIT SPLICE 2	116+41.27	70.54' LT		

NOTES:

- EACH DETECTOR LOOP SHALL HAVE ITS OWN 1" COILABLE NON-METALLIC CONDUIT BETWEEN THE EDGE OF PAVEMENT AND THE ADJACENT HANDHOLE AS SHOWN ON THE PLANS AND AS STATED IN THE TRAFFIC SIGNAL SPECIFICATIONS.

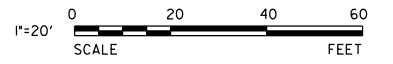

**TS 3245
ECON 84**

MODEL: Default
FILE NAME: R320112611Drawings\Main\CADD_Sheets\011261-shit-e01.dgn

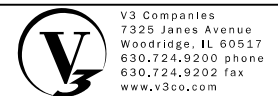

V3 Companies
7325 Janes Avenue
Woodridge, IL 60517
630.724.9200 phone
630.724.9202 fax
www.v3co.com

USER NAME = dpung	DESIGNED - CAS	REVISED - 5/26/2020
PLOT SCALE = 40'	DRAWN - DRP	REVISED -
PLOT DATE = 5/29/2020	CHECKED - MJR	REVISED -
	DATE = 4/10/2020	REVISED -

**STATE OF ILLINOIS
DEPARTMENT OF TRANSPORTATION**

**TRAFFIC SIGNAL MODERNIZATION PLAN (SHEET 1 OF 2)
RTE 72 (HIGGINS RD) AND PLUM GROVE RD**

SCALE: 1"=20' SHEET 1 OF 2 SHEETS STA. TO STA.

F.A.P. RTE.	SECTION	COUNTY	TOTAL SHEETS	SHEET NO.
341	15-00122-00-BT	COOK	73	36
CONTRACT NO. 61G41				
ILLINOIS FED. AID PROJECT				IUG(914)

MODEL: Definit
 FILE NAME: I:\2021\Drawings\WestCAD\Drawings\18265_sht.XS01.dgn



V3 Companies
 7325 Janes Avenue
 Woodridge, IL 60517
 630.724.9200 phone
 630.724.9202 fax
 www.v3co.com

USER NAME = dpung
 PLOT SCALE = 20"
 PLOT DATE = 5/29/2020

DESIGNED - BNP
 DRAWN - DRP
 CHECKED - MJR
 DATE - 4/10/2020

REVISED - 5/26/2020
 REVISED -
 REVISED -
 REVISED -

STATE OF ILLINOIS
 DEPARTMENT OF TRANSPORTATION

CROSS SECTIONS

SCALE: 1"=10' SHEET 4 OF 12 SHEETS STA. X+00.00 TO STA. X+50.00

F.A.P. RTE.	SECTION	COUNTY	TOTAL SHEETS	SHEET NO.
341	15-00122-00-BT	COOK	73	65
CONTRACT NO. 61G41				
ILLINOIS FED. AID PROJECT			IU2G(914)	

