

STATE OF ILLINOIS  
DEPARTMENT OF TRANSPORTATION

F.A.P. RTE.	SECTION	COUNTY	TOTAL SHEETS	SHEET NO.
339	FAP 0339 23 C&J2	MCHENRY	10	1
		ILLINOIS	CONTRACT NO. 62V63	

D-91-041-24



LOCATION OF SECTION INDICATED THUS: - [black bar] -

FOR INDEX OF SHEETS, SEE SHEET NO. 2

PROJECT LOCATION IN THE VILLAGE OF ALGONQUIN

PROPOSED  
HIGHWAY PLANS

FAP ROUTE 339 (ILL 62 ALGONQUIN RD)  
SECTION FAP 0339 23 C&J2  
MAIN ST. TO NW OF COUNTRYSIDE DR/ SANDBLOOM RD  
CRACK AND JOINT SEALING  
MCHENRY COUNTY

C-91-049-24

TRAFFIC DATA:  
ILL 62 ALGONQUIN RD  
ADT (2023) = 43,100  
POSTED AND DESIGN SPEED LIMIT = 30-40 MPH

PROJECT BEGINS  
STA 14+40.52

OMISSION STARTS  
STA 20+95.64

OMISSION ENDS  
STA 24+27.10

PROJECT ENDS  
STA 61+70.75

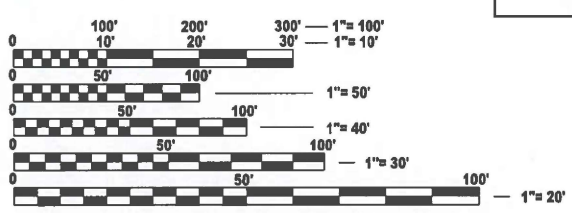
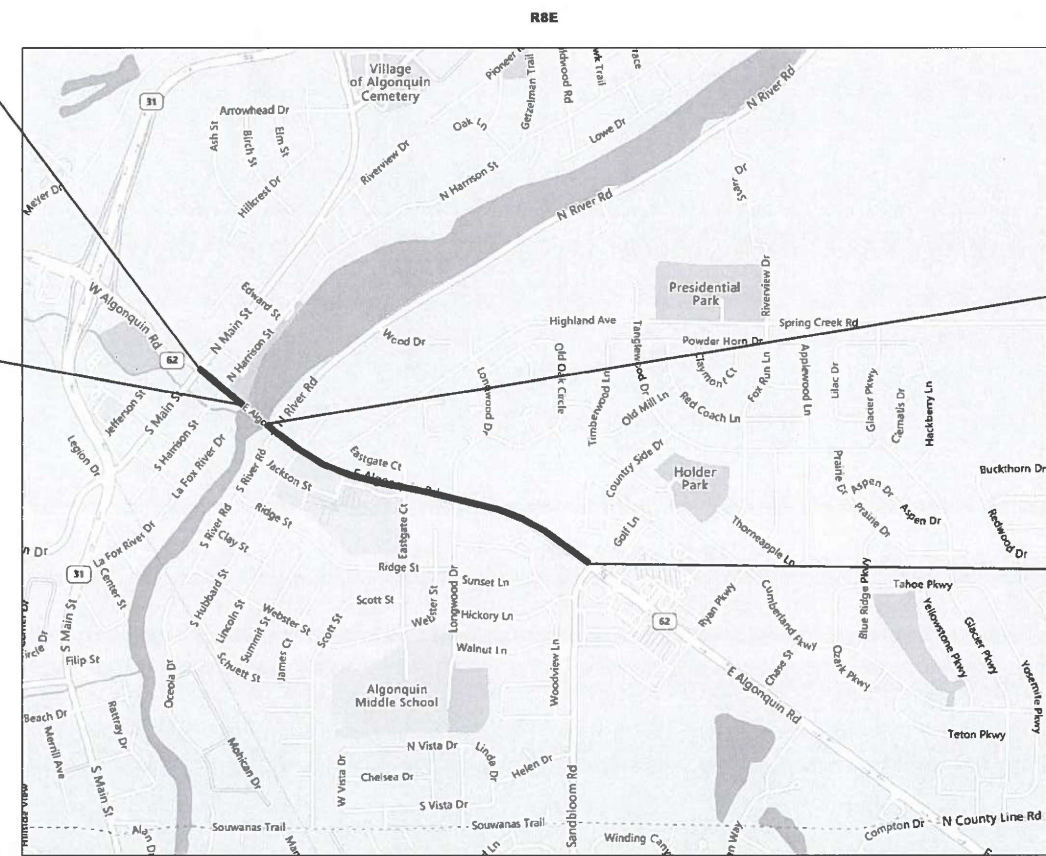

FULL SIZE PLANS HAVE BEEN PREPARED USING STANDARD ENGINEERING SCALES. REDUCED SIZED PLANS WILL NOT CONFORM TO STANDARD SCALES. IN MAKING MEASUREMENTS ON REDUCED PLANS, THE ABOVE SCALES MAY BE USED.

J.U.L.I.E.  
JOINT UTILITY LOCATION INFORMATION FOR EXCAVATION  
1-800-892-0123  
OR 811

PROJECT ENGINEER: DANIEL WILGREEN (847) 705-4240  
PROJECT MANAGER: J. ALAIN MIDY (847) 221-3056

GROSS LENGTH = 4730.23 FT. = 0.895 MILE  
NET LENGTH = 4398.77 FT. = 0.8331 MILE

CONTRACT NO. 62V63

STATE OF ILLINOIS  
DEPARTMENT OF TRANSPORTATION  
SUBMITTED March 25 20 26  
Joseph J. [Signature] IR  
REGIONAL ENGINEER  
May 8 20 26  
[Signature]  
ENGINEER OF DESIGN AND ENVIRONMENT  
May 8 20 26  
[Signature]  
DIRECTOR OF HIGHWAYS PROJECT IMPLEMENTATION

PRINTED BY THE AUTHORITY  
OF THE STATE OF ILLINOIS

## INDEX OF SHEETS

SHEET NO.	DESCRIPTION
1	COVER SHEET
2	INDEX OF SHEETS, STATE STANDARDS, AND GENERAL NOTES
3	SUMMARY OF QUANTITIES
4 - 5	ROADWAY PLANS
6	CRACK AND JOINT SEALING DETAIL (PD-11)
7	TRAFFIC CONTROL AND PROTECTION FOR SIDE ROADS, INTERSECTIONS AND DRIVEWAYS (TC-10)
8	DISTRICT ONE TYPICAL PAVEMENT MARKINGS (TC-13)
9	ARTERIAL ROAD INFORMATION SIGN (TC-22)
10	DRIVEWAY ENTRANCE SIGNING (TC-26)

## STATE STANDARDS

STANDARD NO.	DESCRIPTION
000001-09	STANDARD SYMBOLS, ABBREVIATIONS, AND PATTERNS
701101-05	OFF-RD OPERATIONS, MULTILANE, 15'(4.5m) TO 24" (600mm) FROM PAVEMENT EDGE
701106-02	OFF-RD OPERATIONS, MULTILANE, MORE THAN 15' (4.5 m) AWAY
701427-05	LANE CLOSURE, MULTILANE, INTERMITTENT OR MOVING OPERATIONS, FOR SPEEDS <= 40MPH
701602-10	URBAN LANE CLOSURE, MULTILANE, 2W WITH BIDIRECTIONAL LEFT TURN LANE
701606-10	URBAN SINGLE LANE CLOSURE, MULTILANE, 2W WITH MOUNTABLE MEDIAN
701701-10	URBAN LANE CLOSURE, MULTILANE INTERSECTION
701801-06	SIDEWALK, CORNER OR CROSSWALK CLOSURE
701901-11	TRAFFIC CONTROL DEVICES

## GENERAL NOTES

- BEFORE BEGINNING ANY WORK, THE CONTRACTOR SHALL RETAIN AND RECORD FOR FUTURE REFERENCE, ALL EXISTING PAVEMENT MARKING LINES (AND RAISED REFLECTIVE PAVEMENT MARKERS) IN ORDER THAT THESE LOCATIONS CAN BE RE-ESTABLISHED FOR STRIPING. EXACT LOCATIONS OF ALL PAVEMENT MARKINGS SHALL BE AS DIRECTED BY THE ENGINEER.
- THE CONTRACTOR WILL NOT BE ALLOWED TO SET UP A YARD OR FIELD OFFICE ON STATE PROPERTY WITHOUT PERMISSION FROM THE DEPARTMENT.
- ALL DAMAGE TO EXISTING PAVEMENT MARKINGS OR RAISED REFLECTIVE PAVEMENT MARKERS OUTSIDE THE REMOVAL LINE SHOWN ON THE PLANS SHALL BE REPLACED AT NO ADDITIONAL COST TO THE DEPARTMENT.
- IT SHALL BE THE CONTRACTORS RESPONSIBILITY TO VERIFY ALL DIMENSIONS AND CONDITIONS EXISTING IN THE FIELD PRIOR TO CONSTRUCTION AND ORDERING OF MATERIALS.
- THE CONTRACTOR SHALL CONTACT KALPANA KANNAN-HOSADURGA, THE DISTRICT ONE TRAFFIC CONTROL SUPERVISOR AT KALPANA.KANNAN-HOSADURGA@ILLINOIS.GOV A MINIMUM OF 72 HOURS IN ADVANCE OF BEGINNING WORK.
- CONTRACTORS SHALL MAINTAIN PEDESTRIAN ACCESS AT ALL TIMES DURING CONSTRUCTION.
- ALL DIRT AND DEBRIS CREATED BY THE ROUTING OPERATION SHALL BE CLEANED FROM THE PAVEMENT AND PAVED SHOULDERS AT THE END OF THE DAY'S OPERATION ACCORDING TO ARTICLE 107.15 OF THE STANDARD SPECIFICATIONS.
- ALL CRACK ROUTING & JOINT SEALING LOCATIONS WILL BE DETERMINED IN THE FIELD BY THE ENGINEER. CRACK ROUTING SHALL BE OMITTED WHERE VEHICLE DETECTOR LOOPS & RAISED REFLECTIVE PAVEMENT MARKERS ARE PRESENT IN THE PAVEMENT.
- ALL MODIFIED URETHANE PAVEMENT MARKING SHALL BE PLACED IMMEDIATELY AFTER CRACK & JOINT SEALER TEMPERATURE HAS COOLED DOWN AND DOES NOT AFFECT THE APPLICATION OF THE MODIFIED URETHANE PAVEMENT MARKING.
- MATERIALS RESULTING FROM THE ROUTING OF CRACKS IN THE EXISTING PAVEMENT MAY BE PLACED, SHAPED AND COMPACTED TO THE SATISFACTION OF THE ENGINEER ALONG EXISTING AGGREGATE SHOULDERS ADJACENT TO THE PAVEMENT. ALL MATERIALS RESULTING FROM THE ROUTING OF CRACKS IN PAVEMENTS WITHOUT AGGREGATE SHOULDERS AND SURPLUS MATERIALS RESULTING FROM THE ROUTING OF CRACKS IN PAVEMENTS WITH AGGREGATE SHOULDERS, WHERE ALL MATERIALS ARE NOT PLACED ALONG EXISTING AGGREGATE SHOULDERS, SHALL BE DISPOSED OF AS SPECIFIED IN ARTICLE 202.03 OF THE STANDARD SPECIFICATION.
- THE RESIDENT ENGINEER SHALL EMAIL BRANDY KENNEDY, TRAFFIC FIELD ENGINEER, AT BRANDY.KENNEDY@ILLINOIS.GOV AT LEAST (2) WEEKS BEFORE PLACING PERMANENT PAVEMENT MARKINGS.
- THE ROAD CONSTRUCTION AHEAD SIGNS SHALL REMAIN INSTALLED UNTIL COMPLETION OF THE PROJECT OR WHEN NO ROADWAY HAZARDS REMAIN WITHIN THE WORK ZONE.

HOT-MIX ASPHALT MIXTURE REQUIREMENTS			QMP
MIXTURE TYPE	AIR VOIDS @ Ndesign		
CLASS D PATCHING (SPECIAL)			
HOT-MIX ASPHALT SURFACE COURSE, IL-9.5, MIX "D", N70; 2"	4% @ 70 Gyr.		QC/QA
HOT-MIX ASPHALT BINDER COURSE, IL-19.0, N70; 12"	4% @ 70 Gyr.		QC/QA
QMP Designations: Quality Control/Quality Assurance (QC/QA); Quality Control for Performance (QCP); Pay for Performance (PFP)			

THE UNIT WEIGHT USED TO CALCULATE ALL HMA SURFACE MIXTURE QUANTITIES IS 112 LBS/SQ YD/IN.

THE "AC TYPE" FOR POLYMERIZED HMA MIXES SHALL BE "SBS/SBR PG 76-22" AND FOR NON-POLYMERIZED HMA THE "AC TYPE" SHALL BE "PG 64-22" UNLESS MODIFIED BY RECLAIMED MATERIALS SPECIFICATIONS

MODEL: GenNotesSh01 (Sheet)  
FILE NAME: c:\pw\work\pav\illinois.gov\baraa.alismadi\092650\010124-shi-gennote.dgn

USER NAME = Baraa.alismadi	DESIGNED -	REVISED -
	DRAWN -	REVISED -
PLOT SCALE = 0.16666633 1/in.	CHECKED -	REVISED -
PLOT DATE = 3/24/2026	DATE -	REVISED -

**STATE OF ILLINOIS  
DEPARTMENT OF TRANSPORTATION**

**INDEX OF SHEETS, STATE STANDARDS, AND GENERAL NOTES  
IL 62 - MAIN ST TO COUNTRYSIDE RD/SANDBLOOM RD**

SCALE: SHEET 1 OF 1 SHEETS STA. TO STA.

FAP RTE.	SECTION	COUNTY	TOTAL SHEETS	SHEET NO.
339	FAP 0339 23 C&J2	MCHENRY	10	2
			CONTRACT NO. 62V63	
ILLINOIS   FED. AID PROJECT				



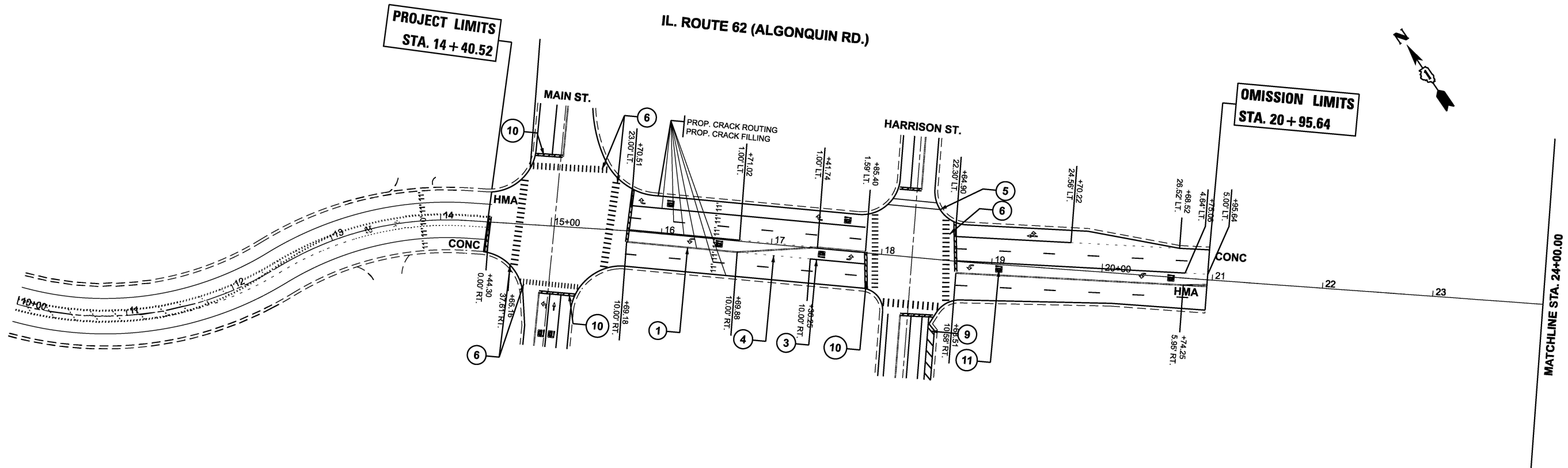

①	PROP. MODIFIED URETHANE PVMT. MARKING 4", DOUBLE YELLOW CENTERLINE (TYP.)	④	PROP. MODIFIED URETHANE PVMT. MARKING 6", 2' DASH, 6' SKIP WHITE (TYP.)	⑦	PROP. MODIFIED URETHANE PVMT. MARKING 12", CROSSWALK (BICYCLE) @ 45°, 6' MIN., 2' C-C WHITE (TYP.)	⑩	PROP. MODIFIED URETHANE PVMT. MARKING 24", STOP BAR WHITE (TYP.)
②	PROP. MODIFIED URETHANE PVMT. MARKING 4", 10' DASH, 30' SKIP WHITE (TYP.)	⑤	PROP. MODIFIED URETHANE PVMT. MARKING 6", CROSSWALK 2 @ 6' MIN. C-C WHITE (TYP.)	⑧	PROP. MODIFIED URETHANE PVMT. MARKING 12", @ 45°, MEDIAN LINE YELLOW (TYP.)	⑪	PROP. MODIFIED URETHANE PVMT. MARKING, LETTERS AND SYMBOLS WHITE (TYP.)
③	PROP. MODIFIED URETHANE PVMT. MARKING 6", TURN LANE WHITE (TYP.)	⑥	PROP. MODIFIED URETHANE PVMT. MARKING 12", CROSSWALK (SCHOOL) @ 90°, 6' MIN., 2' C-C WHITE (TYP.)	⑨	PROP. MODIFIED URETHANE PVMT. MARKING 12", @ 45°, SHOULDER LINE WHITE (TYP.)		

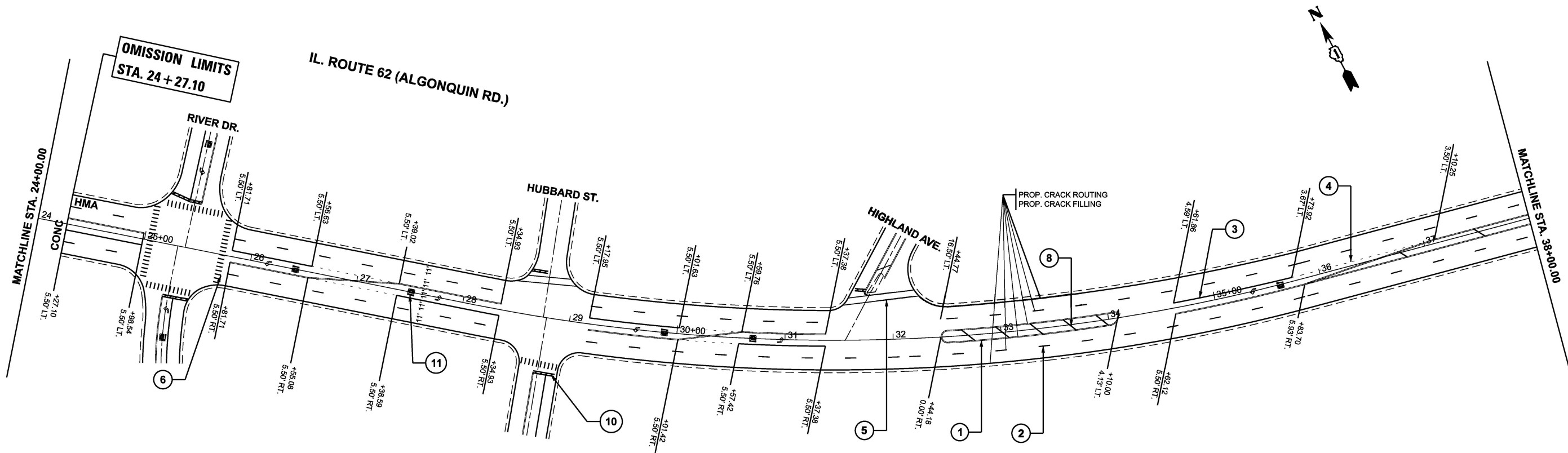

MODEL: IL 62\_E - RdwyPlan 1  
 FILE NAME: c:\pwworking\illinois.gov\baraa.alsmadi\illinois.gov\baraa.alsmadi\104124-shr-plan.dgn

USER NAME = Baraa.Alsamadi	DESIGNED -	REVISED -
PLOT SCALE = 0.16666633' / in.	DRAWN -	REVISED -
PLOT DATE = 4/3/2026	CHECKED -	REVISED -
	DATE -	REVISED -

**STATE OF ILLINOIS**  
**DEPARTMENT OF TRANSPORTATION**

<b>ROADWAY PLAN</b>			
<b>IL 62 - MAIN ST TO COUNTRYSIDE RD/SANDBLOOM RD</b>			
SCALE: 1"=50'	SHEET 1	OF 2 SHEETS	TO STA. 38+00.00

F.A.P. RTE.	SECTION	COUNTY	TOTAL SHEETS	SHEET NO.
339	FAP 0339 23 C&J2	MCHENRY	10	4
CONTRACT NO. 62V63			ILLINOIS FED. AID PROJECT	



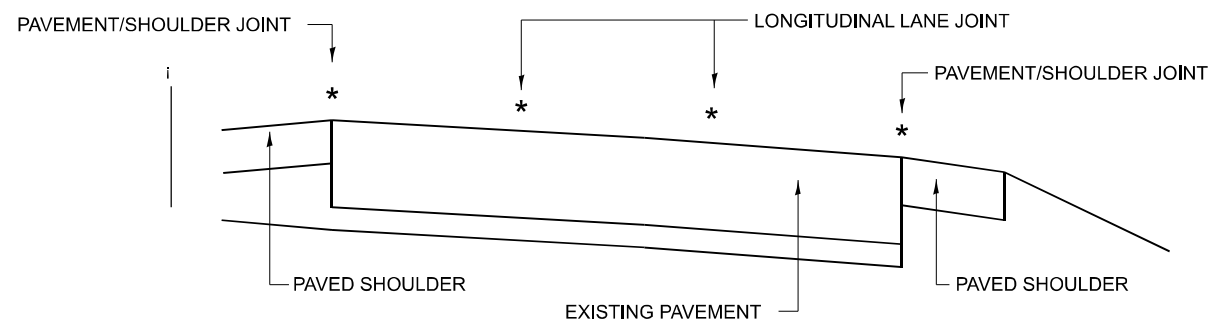

**MULTI-LANE DIVIDED PAVEMENT**

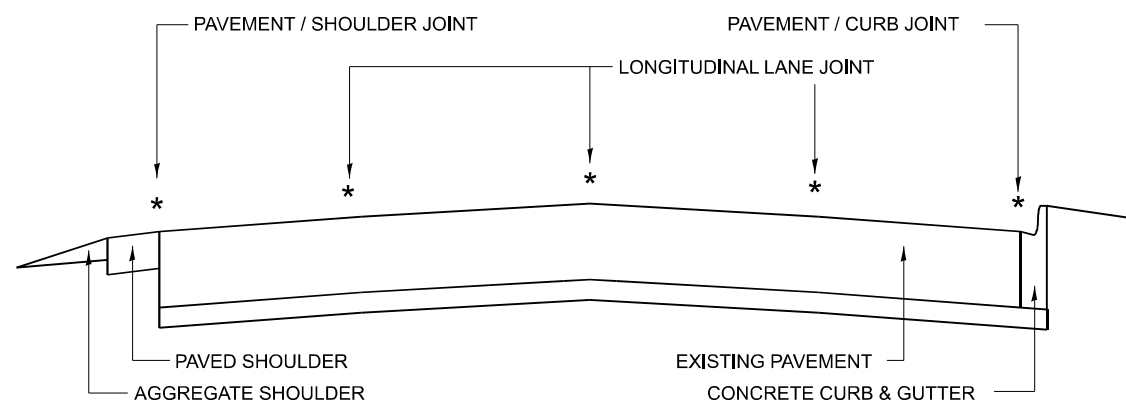

**MULTI-LANE UNDIVIDED PAVEMENT**

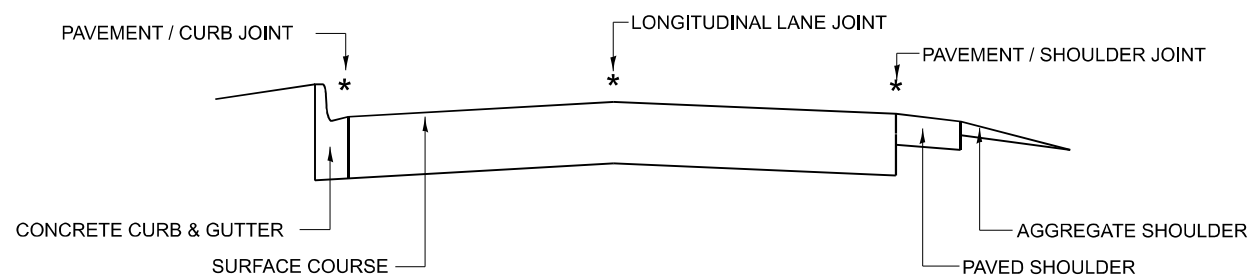

**TWO-LANE PAVEMENT**

\* PROPOSED LONGITUDINAL CRACK ROUTING (PAVEMENT) & CRACK FILLING LOCATIONS

**GENERAL EXISTING TYPICAL SECTIONS  
(APPLIES TO HMA AND PCC PAVEMENTS)**

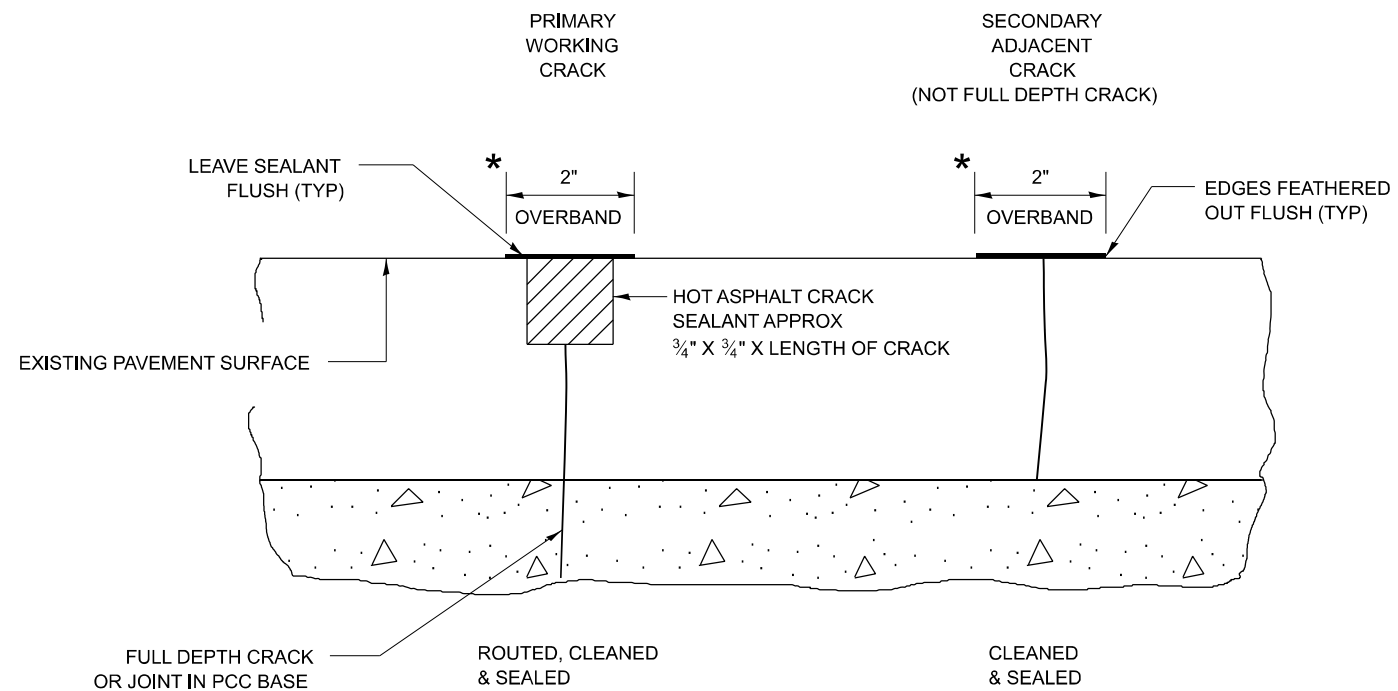

\* IN ALL LOCATIONS WHERE THE LONGITUDINAL CRACK CONFLICTS WITH EXISTING PAVEMENT MARKINGS (EITHER EDGE LINE OR LANE LINE) THE CRACK SHALL BE ROUTED & THE RESULTING RESERVOIR FILLED WITH SEALANT. ALL DAMAGES TO EXISTING RAISED REFLECTIVE PAVEMENT MARKERS SHALL BE REPLACED AT THE EXPENSE OF THE CONTRACTOR. ALL EXISTING PAVEMENT MARKINGS WITHIN THE PROJECT LIMITS SHALL BE RESTORED WITH MODIFIED URETHANE PAVEMENT MARKINGS.

**LONGITUDINAL JOINT**

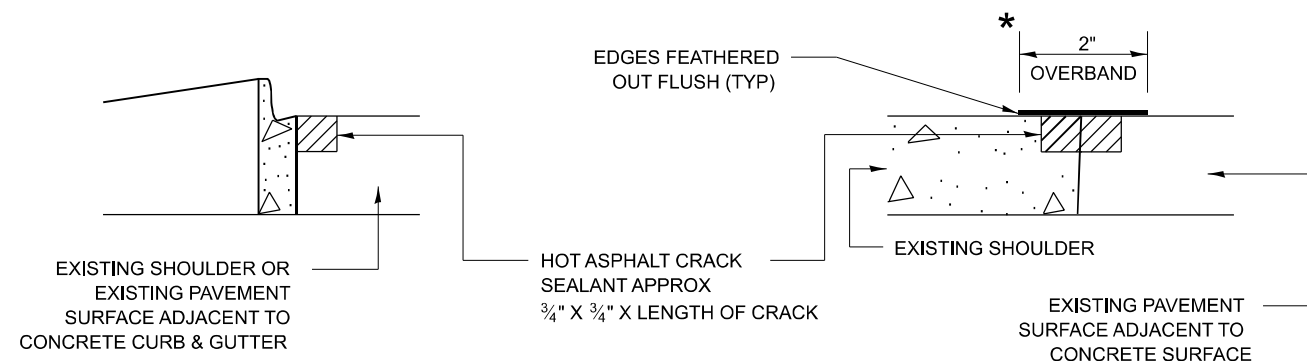

**CRACK & JOINT SEALING DETAIL**

MODEL: PD-11 (Sheet)  
FILE NAME: c:\p\work\vw\illinois.gov\baraa.alsmadi\illinois.gov\092650\1014124-sh-Dis\Dis.dgn

USER NAME = Baraa.alsmadi	DESIGNED - F. Aqueel / A. Midy	REVISED -
DRAWN -	REVISOR -	REVISOR -
PLOT SCALE = 0.16666633' / in.	CHECKED -	REVISOR -
PLOT DATE = 3/24/2026	DATE - 10/08/2020	REVISOR -

**STATE OF ILLINOIS  
DEPARTMENT OF TRANSPORTATION**

**CRACK & JOINT SEALING DETAIL  
(PD-11)**

SCALE: NONE SHEET 1 OF 1 SHEETS STA. TO STA.

F.A.P. RTE.	SECTION	COUNTY	TOTAL SHEETS	SHEET NO.
339	FAP 0339 23 C&J2	MCHENRY	10	6
PD-11		CONTRACT NO. 62V63		
ILLINOIS FED. AID PROJECT				

MODEL: TC-10 (Sheet)  
 FILE NAME: c:\p\work\vw\illinois.gov\_baraa\_alsmadi\illinois.gov\_0926650\104124-shr-Dist\Dist.dgn

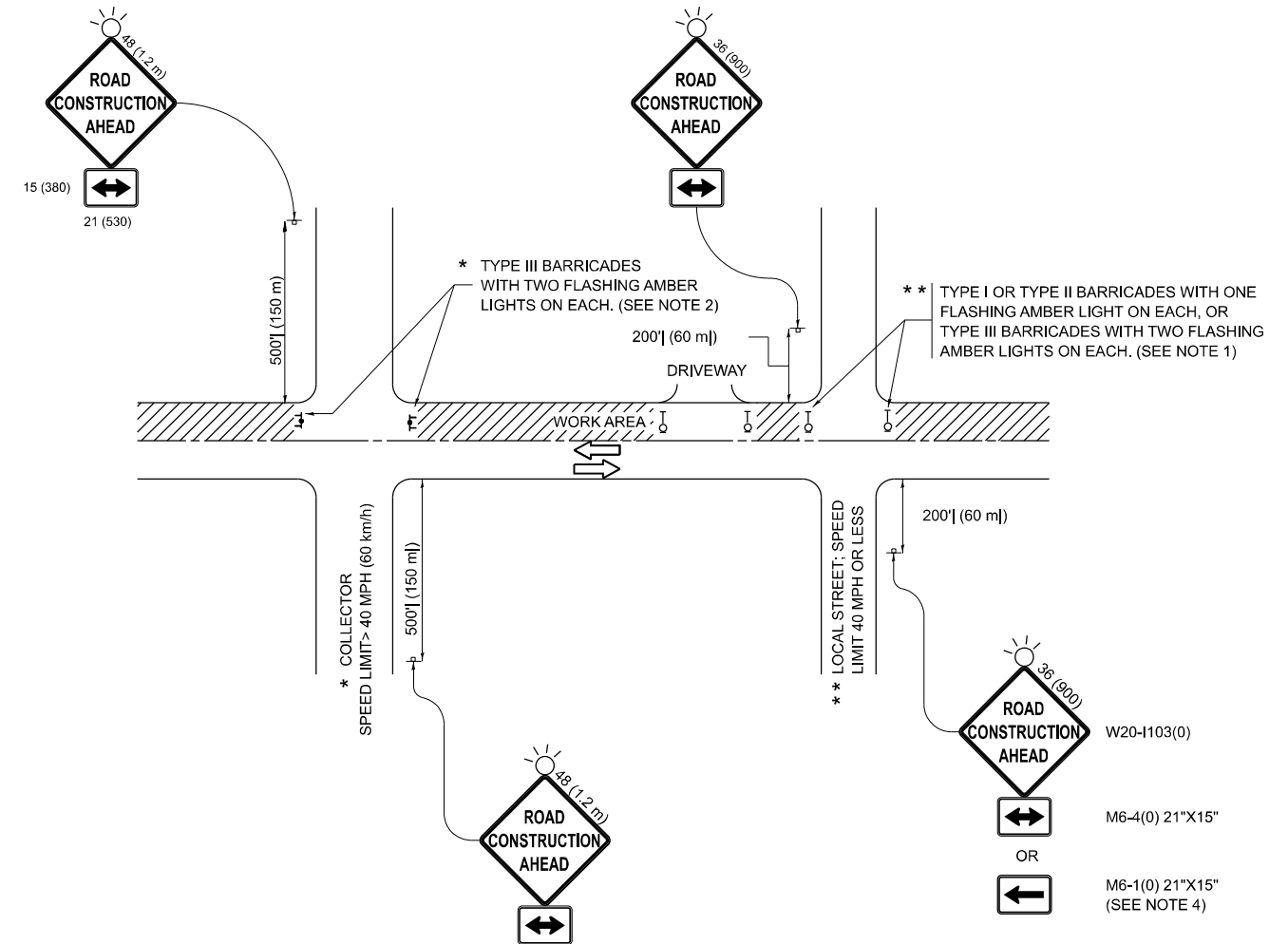

**NOTES:**

1. SIDE ROAD WITH A SPEED LIMIT OF 40 MPH (60 km/h) OR LESS AS SHOWN ON THE DRAWING AND AS DIRECTED BY THE ENGINEER:
  - a) ONE "ROAD CONSTRUCTION AHEAD" SIGN 36 x 36 (900x900) WITH A FLASHER MOUNTED ON IT APPROXIMATELY 200' (60 m) IN ADVANCE OF THE MAIN ROUTE.
  - b) THE CLOSED PORTION OF THE MAIN ROUTE SHALL BE PROTECTED BY BLOCKING WITH TYPE I, TYPE II OR TYPE III BARRICADES, 1/3 OF THE CROSS SECTION OF THE CLOSED PORTION.
2. SIDE ROAD WITH A SPEED LIMIT GREATER THAN 40 MPH (60 km/h) AS SHOWN ON THE DRAWING AND AS DIRECTED BY THE ENGINEER:
  - a) ONE "ROAD CONSTRUCTION AHEAD" SIGN 48 x 48 (1.2 m x 1.2 m) WITH A FLASHER MOUNTED ON IT APPROXIMATELY 500' (150 m) IN ADVANCE OF THE MAIN ROUTE.
  - b) THE CLOSED PORTION OF THE MAIN ROUTE SHALL BE PROTECTED BY BLOCKING WITH TYPE III BARRICADES, 1/2 OF THE CROSS SECTION OF THE CLOSED PORTION.
3. CONES MAY BE SUBSTITUTED FOR BARRICADES OR DRUMS AT HALF THE SPACING DURING DAY OPERATIONS. CONES SHALL BE A MINIMUM OF 28 (710) IN HEIGHT.
4. WHEN THE SIDE ROAD LIES BETWEEN THE BEGINNING OF THE MAINLINE SIGNING AND THE WORK ZONE, A SINGLE HEADED ARROW (M6-1) SHALL BE USED IN LIEU OF THE DOUBLE HEADED ARROW (M6-4).
5. WHEN WORK IS BEING PERFORMED ON A SIDE ROAD OR DRIVEWAY, FOLLOW THE APPLICABLE STANDARD(S). THE DIRECTIONAL ARROW (M6-1 OR M6-4) SHALL BE COVERED OR REMOVED WHEN NO LONGER CONSISTENT WITH THE TRAFFIC CONTROL SET-UP.
6. ADVANCE WARNING SIGNS ARE TO BE OMITTED ON DRIVEWAYS UNLESS OTHERWISE SPECIFIED IN THE PLANS OR BY THE ENGINEER.
7. THE TRAFFIC CONTROL AND PROTECTION FOR SIDE ROADS, INTERSECTIONS, AND DRIVEWAYS SHALL BE INCLUDED IN THE COST OF SPECIFIED TRAFFIC CONTROL STANDARDS OR ITEMS.

All dimensions are in inches (millimeters) unless otherwise shown.

USER NAME = Baraa.alsmadi	DESIGNED - L.H.A.	REVISED - T. RAMMACHER 01-06-00
PLOT SCALE = 0.16666633" / in.	CHECKED -	REVISED - A. SCHUETZE 07-01-13
PLOT DATE = 3/24/2026	DATE - 06-89	REVISED - A. SCHUETZE 09-15-06
		REVISED - D. SENDERAK 05-03-24

**STATE OF ILLINOIS  
 DEPARTMENT OF TRANSPORTATION**

**TRAFFIC CONTROL AND PROTECTION FOR  
 SIDE ROADS, INTERSECTIONS, AND DRIVEWAYS**

SCALE: SHEET OF SHEETS STA. TO STA.

F.A.P. RTE.	SECTION	COUNTY	TOTAL SHEETS	SHEET NO.
339	FAP 0339 23 C&J2	MCHENRY	10	7
<b>TC-10</b>			CONTRACT NO. 62V63	
ILLINOIS FED. AID PROJECT				

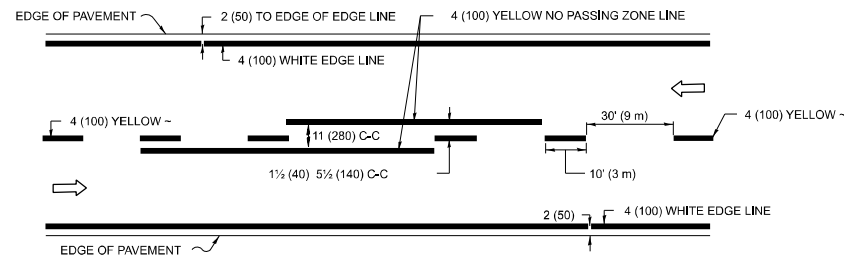

**2-LANE ROADWAY**

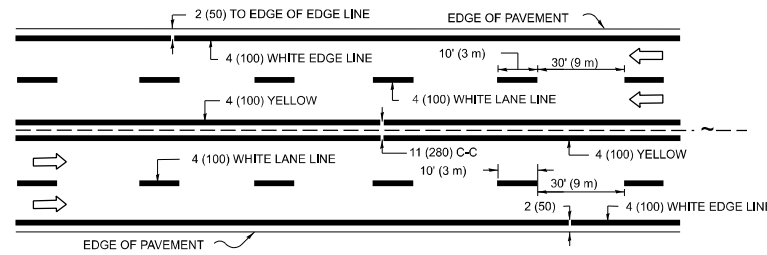

**MULTI-LANE UNDIVIDED**

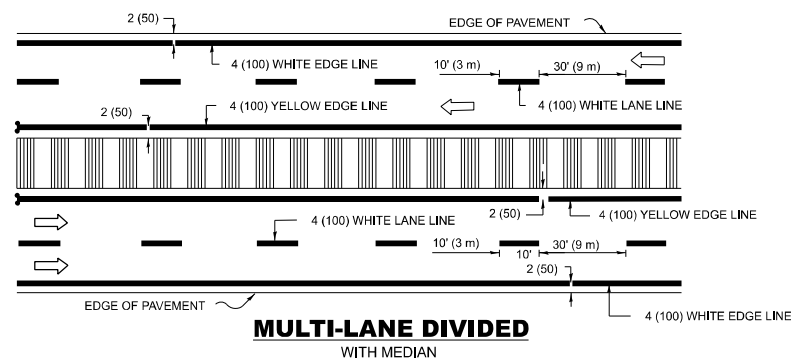

**MULTI-LANE DIVIDED WITH MEDIAN**

**TYPICAL LANE AND EDGE LINE MARKING**

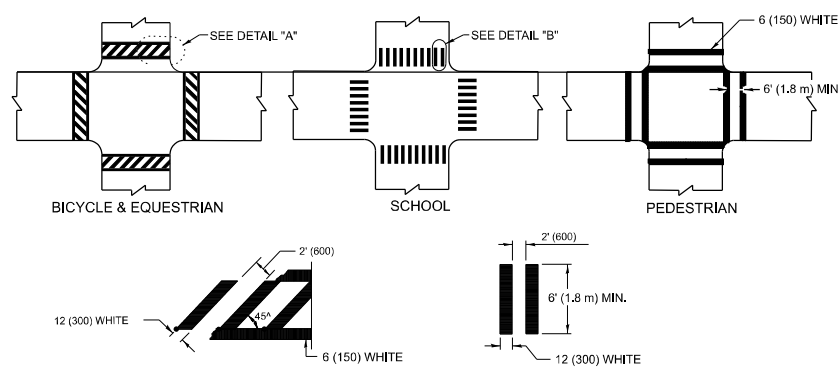

**DETAIL "A" TYPICAL CROSSWALK MARKING**

\* MARKINGS SHALL BE INSTALLED PARALLEL TO THE CENTERLINE OF THE ROAD WHICH IT CROSSES

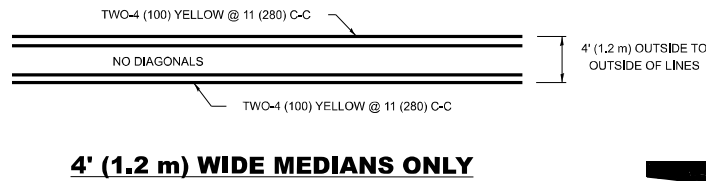

**4' (1.2 m) WIDE MEDIANS ONLY**

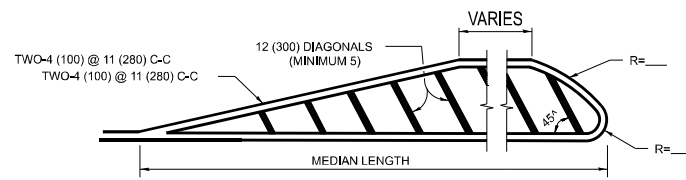

**MEDIANS OVER 4' (1.2 m) WIDE**

DIAGONAL LINE SPACING: 50' (15 m) C-C (LESS THAN 30MPH (50 km/h))  
75' (25 m) C-C 30MPH (50 km/h) TO 45MPH (70 km/h)  
150' (45 m) C-C (MORE THAN 45MPH (70 km/h))

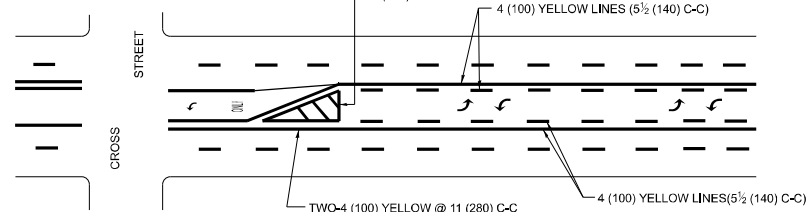

**MEDIAN WITH TWO-WAY LEFT TURN LANE TYPICAL PAINTED MEDIAN MARKING**

A MINIMUM OF TWO PAIRS OF TURN ARROWS SHALL BE USED, WHITE IN COLOR. ADDITIONAL PAIRS SHALL BE PLACED AT 200' (60 m) TO 300' (90 m) INTERVALS.

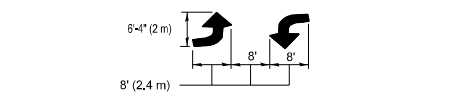

**TYPICAL LEFT (OR RIGHT) TURN LANE**

FULL SIZE LETTERS 8" (2.4 m) AND ARROWS SHALL BE USED. AREA = 15.6 SQ. FT. (1.5 m<sup>2</sup>) ONLY AREA = 20.8 SQ. FT. (1.9 m<sup>2</sup>)

\* TURN LANES IN EXCESS OF 400' (120 m) IN LENGTH MAY HAVE AN ADDITIONAL SET OF ARROW - "ONLY" INSTALLED MIDWAY BETWEEN THE OTHER TWO SETS OF ARROW - "ONLY".

**TYPICAL TURN LANE MARKING**

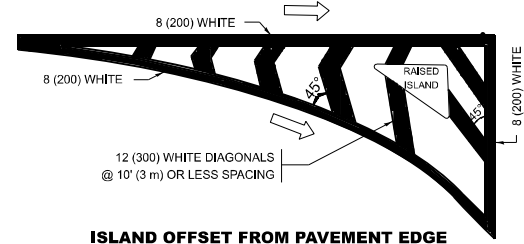

**ISLAND OFFSET FROM PAVEMENT EDGE**

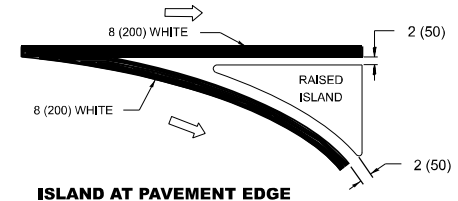

**ISLAND AT PAVEMENT EDGE TYPICAL ISLAND MARKING**

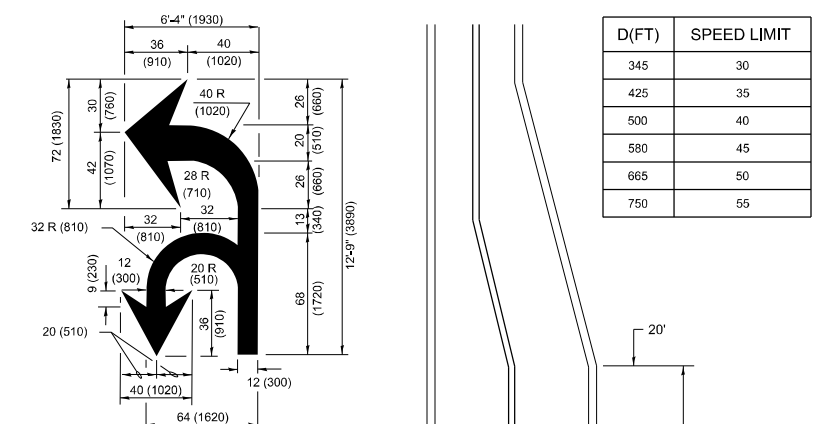

**COMBINATION LEFT AND U-TURN**

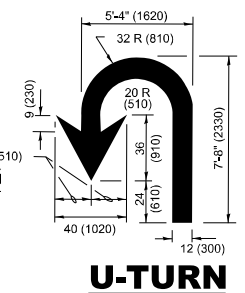

**U-TURN**

**LANE REDUCTION TRANSITION**

\* LANE REDUCTION ARROWS REQUIRED AT SPEEDS OF 45 MPH OR GREATER OR WHEN SPECIFIED IN PLANS.

D(FT)	SPEED LIMIT
345	30
425	35
500	40
580	45
665	50
750	55

TYPE OF MARKING	WIDTH OF LINE	PATTERN	COLOR	SPACING / REMARKS
CENTERLINE ON 2 LANE PAVEMENT	4 (100)	SKIP-DASH	YELLOW	10' (3 m) LINE WITH 30' (9 m) SPACE
CENTERLINE ON MULTI-LANE UNDIVIDED PAVEMENT	2 @ 4 (100)	SOLID	YELLOW	11 (280) C-C
NO PASSING ZONE LINES FOR ONE DIRECTION FOR BOTH DIRECTIONS	4 (100) 2 @ 4 (100)	SOLID SOLID	YELLOW YELLOW	5 1/2 (140) C-C FROM SKIP-DASH CENTERLINE 11 (280) C-C OMIT SKIP-DASH CENTERLINE BETWEEN
LANE LINES	4 (100) 5 (125) ON FREEWAYS	SKIP-DASH SKIP-DASH	WHITE WHITE	10' (3 m) LINE WITH 30' (9 m) SPACE
DOTTED LINES (EXTENSIONS OF CENTER, LANE OR TURN LANE MARKINGS)	SAME AS LINE BEING EXTENDED	SKIP-DASH	SAME AS LINE BEING EXTENDED	2' (600) LINE WITH 6' (1.8 m) SPACE
EDGE LINES	4 (100)	SOLID	YELLOW-LEFT WHITE-RIGHT	OUTLINE MEDIANS IN YELLOW
TURN LANE MARKINGS	6 (150) LINE-FULL SIZE LETTERS & SYMBOLS (8' (2.4m))	SOLID	WHITE	SEE TYPICAL TURN LANE MARKING DETAIL
TWO WAY LEFT TURN MARKING	2 @ 4 (100) EACH DIRECTION 8' (2.4m) LEFT ARROW	SKIP-DASH AND SOLID IN PAIRS	YELLOW WHITE	10' (3 m) LINE WITH 30' (9 m) SPACE FOR SKIP-DASH; 5 1/2 (140) C-C BETWEEN SOLID LINE AND SKIP-DASH LINE SEE TYPICAL TWO-WAY LEFT TURN MARKING DETAIL.
CROSSWALK LINES (PEDESTRIAN) A. DIAGONALS (BIKE & EQUESTRIAN) B. LONGITUDINAL BARS (SCHOOL)	2 @ 6 (150) 12 (300) @ 45° 12 (300) @ 90°	SOLID SOLID SOLID	WHITE WHITE WHITE	NOT LESS THAN 6' (1.8 m) APART 2' (600) APART SEE TYPICAL CROSSWALK MARKING DETAILS.
STOP LINES	24 (600)	SOLID	WHITE	PLACE 4' (1.2 m) IN ADVANCE OF AND PARALLEL TO CROSSWALK, IF PRESENT. OTHERWISE, PLACE AT DESIRED STOPPING POINT, PARALLEL TO CROSSROAD CENTERLINE, WHERE POSSIBLE.
PAINTED MEDIANS	2 @ 4 (100) WITH 12 (300) DIAGONALS @ 45° NO DIAGONALS USED FOR 4' (1.2 m) WIDE MEDIANS	SOLID	YELLOW; TWO WAY TRAFFIC WHITE; ONE WAY TRAFFIC	11 (280) C-C FOR THE DOUBLE LINE SEE TYPICAL PAINTED MEDIAN MARKING.
GORE MARKING AND CHANNELIZING LINES	8 (200) WITH 12 (300) DIAGONALS @ 45°	SOLID	WHITE	DIAGONALS: 15' (4.5 m) C-C (LESS THAN 30MPH (50 km/h)) 20' (6 m) C-C 30MPH (50 km/h) TO 45MPH (70 km/h) 30' (9 m) C-C (OVER 45MPH (70 km/h))
RAILROAD CROSSING	24 (600) TRANSVERSE LINES: "RR" IS 6' (1.8 m) LETTERS: 15 (400) LINE FOR "X"	SOLID	WHITE	SEE STATE STANDARD 780001 AREA OF: *R*=3.6 SQ. FT. (0.33 m <sup>2</sup> ) EACH *X*=54.0 SQ. FT. (5.0 m <sup>2</sup> )
SHOULDER DIAGONALS (REQUIRED FOR SHOULDERS ≥ 8')	12 (300) @ 45°	SOLID	WHITE - RIGHT YELLOW - LEFT	50' (15 m) C-C (LESS THAN 30MPH (50 km/h)) 75' (25 m) C-C (30 MPH (50 km/h) TO 45MPH (70 km/h)) 150' (45 m) C-C (OVER 45MPH (70 km/h))
U TURN ARROW	SEE DETAIL	SOLID	WHITE	16.3 SF
2 ARROW COMBINATION LEFT AND U TURN	SEE DETAIL	SOLID	WHITE	30.4 SF

FOR FURTHER DETAILS ON PAVEMENT MARKING REFER TO STANDARD SPECIFICATIONS FOR ROAD AND BRIDGE CONSTRUCTION AND STATE STANDARD 780001.

All dimensions are in inches (millimeters) unless otherwise shown.

MODEL: TC-13 (Sheet)  
FILE NAME: c:\p\work\wv\illinois.gov\_baraa\_alsmadi\illinois.gov\092650\0104124-shr-DistSds\ds.dgn

USER NAME = Baraa.alsmadi	DESIGNED - EVERS	REVISED - C. JUCIUS 09-09-09
DRAWN -	DRAWN - C. JUCIUS 07-01-13	REVISED - C. JUCIUS 07-01-13
PLOT SCALE = 0.16666633 / in.	CHECKED -	REVISED - C. JUCIUS 12-21-15
PLOT DATE = 3/23/2026	DATE - 03-19-90	REVISED - C. JUCIUS 04-12-16

**STATE OF ILLINOIS DEPARTMENT OF TRANSPORTATION**

<b>DISTRICT ONE TYPICAL PAVEMENT MARKINGS</b>			
SCALE: NONE	SHEET 1 OF 1 SHEETS	STA. TO STA.	

F.A.P RTE.	SECTION	COUNTY	TOTAL SHEETS	SHEET NO.
339	FAP 0339 23 C&J2	MCHENRY	10	8
<b>TC-13</b>		CONTRACT NO. 62V63		
ILLINOIS FED. AID PROJECT				

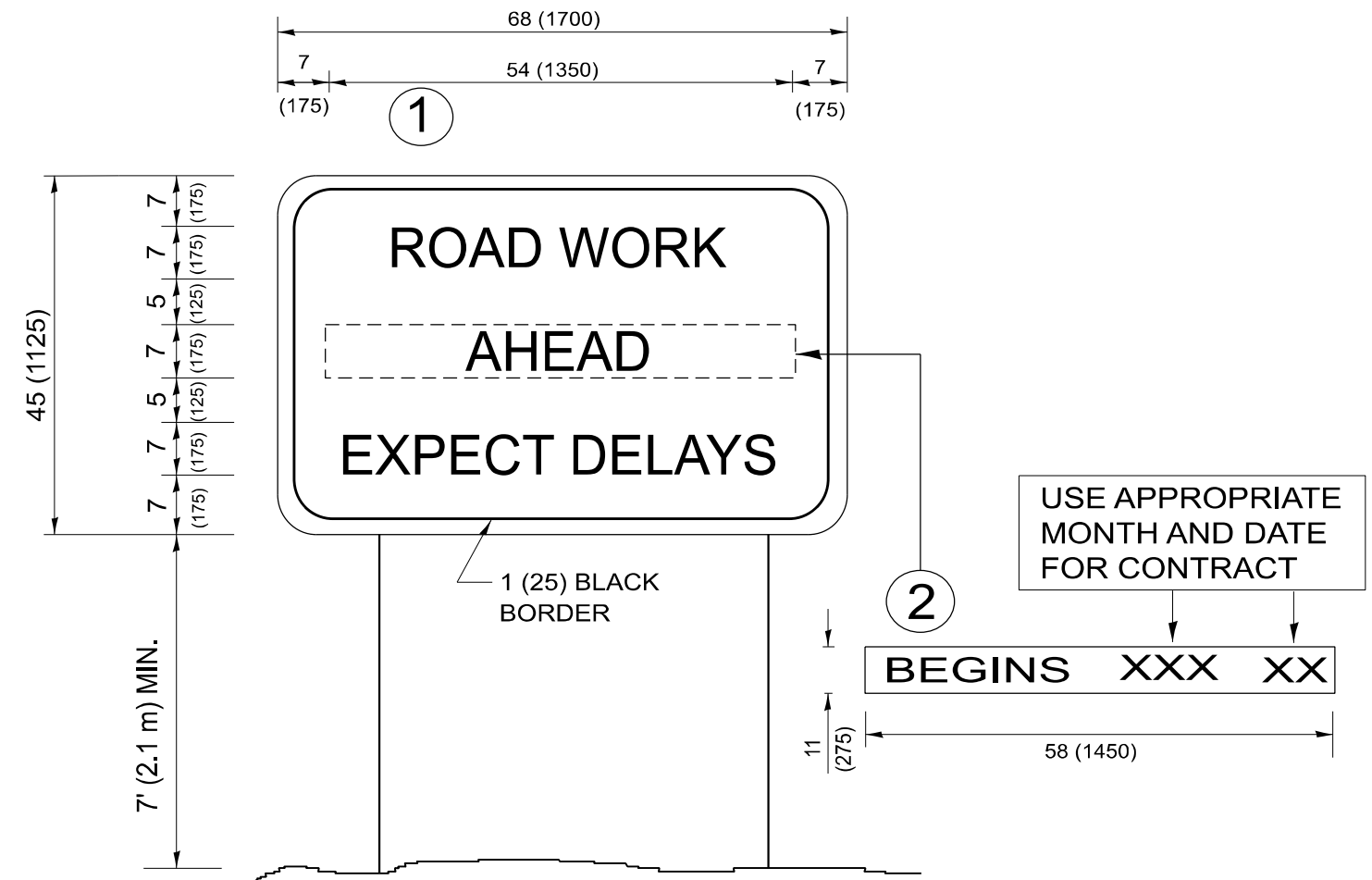

**NOTES:**

1. USE BLACK LETTERING ON ORANGE BACKGROUND.
2. ERECT SIGNS IN ADVANCE OF THE LOCATION FOR THE "ROAD CONSTRUCTION AHEAD" SIGN AT LOCATIONS AS DIRECTED BY THE ENGINEER.
3. ERECT SIGN ① WITH INSTALLED PANEL ② ONE WEEK PRIOR TO THE START OF CONSTRUCTION.
4. REMOVE PANEL ② SOON AFTER THE START OF CONSTRUCTION.
5. SEE SPECIAL PROVISION FOR "TEMPORARY INFORMATION SIGNING" FOR ADDITIONAL INFORMATION.
6. ONE SIGN ASSEMBLY EQUALS 25.70 SQ. FT. (2.3 SQ. M.)
7. SHALL BE PAID FOR AS TEMPORARY INFORMATION SIGNING.

ALL DIMENSIONS ARE IN INCHES (MILLIMETERS)  
UNLESS OTHERWISE SHOWN.

MODEL: TC-22 (Sheet)  
FILE NAME: c:\p\work\wv\illinois.gov\_baraa\_alsmadi\illinois.gov\092650\0104124-shr-Dist\Dist.dgn

USER NAME = Baraa.alsmadi	DESIGNED -	REVISED - R. MIRS 09-15-97
	DRAWN -	REVISED - R. MIRS 12-11-97
PLOT SCALE = 0.16666833 1/In.	CHECKED -	REVISED - T. RAMMACHER 02-02-99
PLOT DATE = 3/24/2026	DATE -	REVISED - C. JUCIUS 01-31-07

**STATE OF ILLINOIS  
DEPARTMENT OF TRANSPORTATION**

**ARTERIAL ROAD  
INFORMATION SIGN**

SCALE: NONE SHEET 1 OF 1 SHEETS STA. TO STA.

F.A.P. RTE.	SECTION	COUNTY	TOTAL SHEETS	SHEET NO.
339	FAP 0339 23 C&J2	MCHENRY	10	9
<b>TC-22</b>		CONTRACT NO. 62V63		
ILLINOIS FED. AID PROJECT				

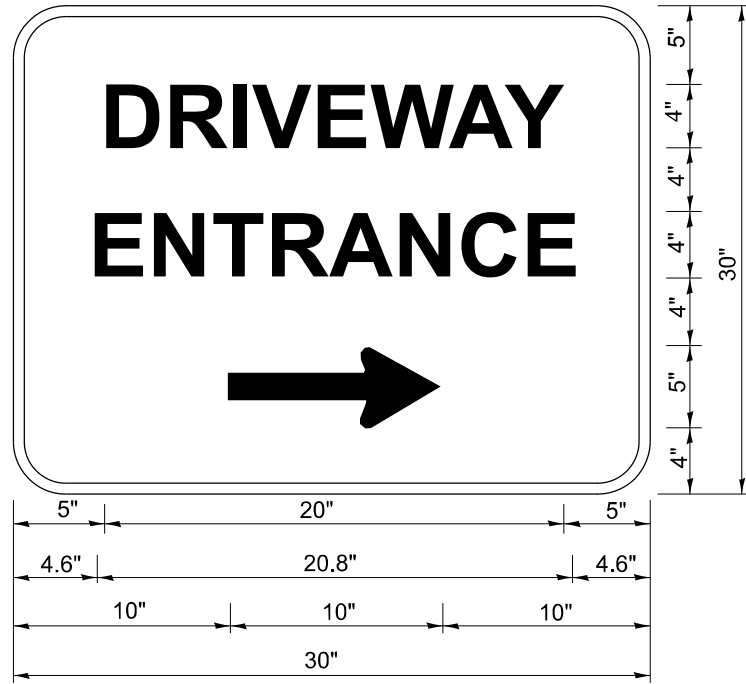

3.0" RADIUS, 0.5" BORDER, WHITE ON GREEN; REFLECTORIZED  
 "DRIVEWAY" D; "ENTRANCE" D; STANDARD ARROW CUSTOM 12.0" x 5.0"

**NOTES:**

1. HALF OF THE SIGNS WILL REQUIRE A LEFT HAND FACING ARROW.
2. TWO SIGNS SHALL BE USED AT EACH COMMERCIAL ENTRANCE PLACED BACK-TO-BACK: ONE WITH A RIGHT HAND ARROW (SHOWN) SHALL BE PLACED ON THE NEAR RIGHT SIDE THE DRIVEWAY AND ONE WITH A LEFT HAND ARROW SHALL BE PLACED ON THE FAR LEFT SIDE OF THE DRIVEWAY.
3. SIGNS TO BE PAID FOR AS ITEM "TEMPORARY INFORMATION SIGNING".

MODEL: TC-26 (Sheet)  
 FILE NAME: c:\p\work\project\illinois.gov\_baraa\_alsmadi\illinois.gov\092650\0104124-st-Dis-Sigs.dgn

USER NAME = Baraa.alsmadi	DESIGNED -	REVISED - C. JUCIUS 02-15-07
	DRAWN -	REVISED -
PLOT SCALE = 0.16666833' / in.	CHECKED -	REVISED -
PLOT DATE = 3/24/2026	DATE -	REVISED -

**STATE OF ILLINOIS  
 DEPARTMENT OF TRANSPORTATION**

**DRIVEWAY ENTRANCE SIGNING**

SCALE: NONE SHEET 1 OF 1 SHEETS STA. TO STA.

F.A.P. RTE.	SECTION	COUNTY	TOTAL SHEETS	SHEET NO.
339	FAP 0339 23 C&J2	MCHENRY	10	10
<b>TC-26</b>			CONTRACT NO. 62V63	
ILLINOIS FED. AID PROJECT				