

STATE OF ILLINOIS
DEPARTMENT OF TRANSPORTATION

F.A.P. RTE.	SECTION	COUNTY	TOTAL SHEETS	SHEET NO.
541	0541 23 C&J	LAKE	12	1
		ILLINOIS	CONTRACT NO. 62V77	

* 12 + 1 = 13 TOTAL SHEETS

FOR INDEX OF SHEETS, SEE SHEET NO. 2

THIS PROJECT IS LOCATED WITHIN THE VILLAGE OF LAKE VILLA AND UNINCORPORATED LAKE VILLA TOWNSHIP.

PROPOSED
HIGHWAY PLANS

FAP 541: IL 132 (GRAND AVENUE)
IL 59 TO CLEVELAND AVENUE
SECTION: FAP 0541 23 C&J
CRACK & JOINT SEALING
LAKE COUNTY

C-91-063-24

TRAFFIC DATA:

IL 132 - GRAND AVENUE (OTHER PRINCIPAL ARTERIAL):
ADT (2025) = 4300 VPD TO 8350 VPD
SPEED LIMIT = 30-50 MPH

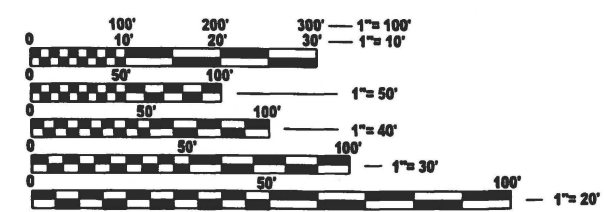
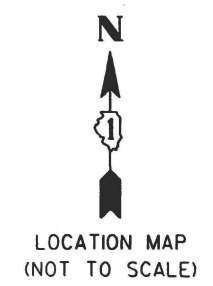
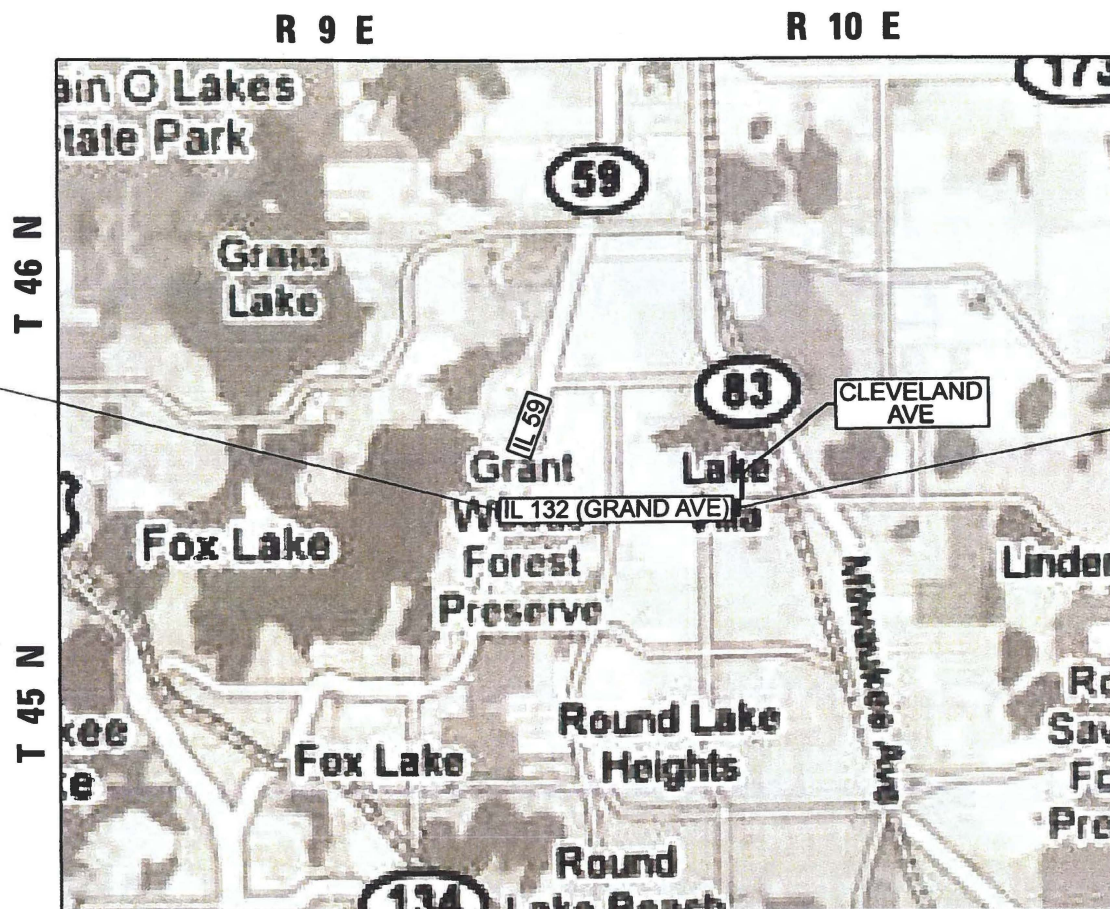
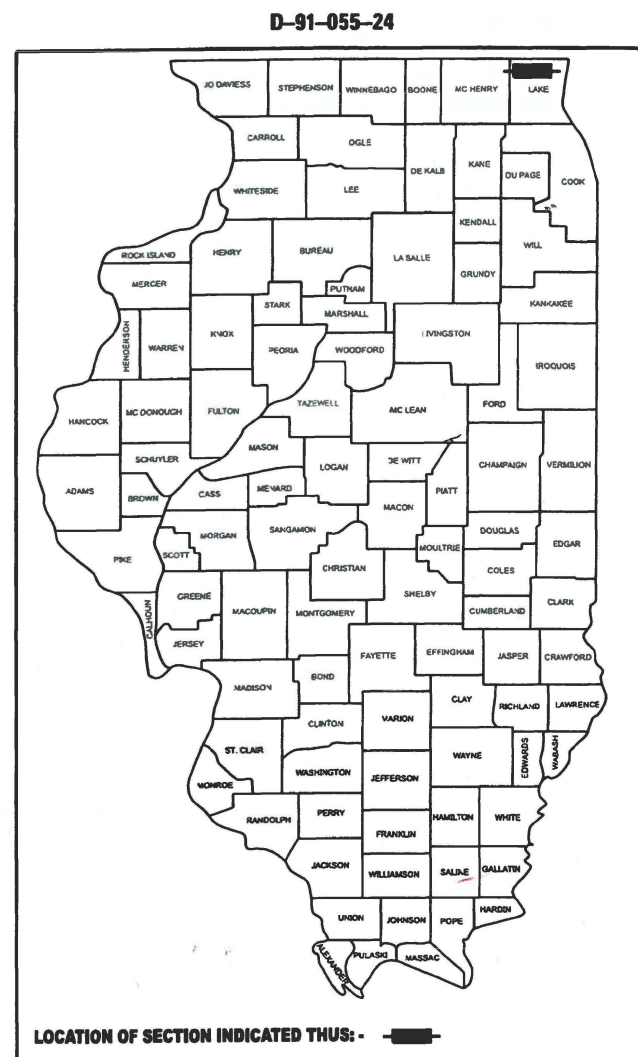

FULL SIZE PLANS HAVE BEEN PREPARED USING STANDARD ENGINEERING SCALES. REDUCED SIZED PLANS WILL NOT CONFORM TO STANDARD SCALES. IN MAKING MEASUREMENTS ON REDUCED PLANS, THE ABOVE SCALES MAY BE USED.

J.U.L.I.E.
JOINT UTILITY LOCATION INFORMATION FOR EXCAVATION
1-800-892-0123
OR 811

PROJECT ENGINEER : VESELIN VELICHKOV (847) 705-4432
PROJECT MANAGER : FAWAD AQUEEL

CONTRACT NO. 62V77

GROSS AND NET LENGTH = 9,669 FT. = 1.831 MILES

STATE OF ILLINOIS
DEPARTMENT OF TRANSPORTATION

SUBMITTED March 23, 2026
Joseph R. [Signature]
REGIONAL ENGINEER

May 8, 2026
[Signature]
ENGINEER OF DESIGN AND ENVIRONMENT

May 8, 2026
[Signature]
DIRECTOR OF HIGHWAYS PROJECT IMPLEMENTATION

PRINTED BY THE AUTHORITY
OF THE STATE OF ILLINOIS

INDEX OF SHEETS

SHEET NO.	DESCRIPTION
1	COVER SHEET
2	INDEX OF SHEETS, STATE STANDARDS, AND GENERAL NOTES
3	SUMMARY OF QUANTITIES
4-7	ROADWAY AND PAVEMENT MARKING PLANS
8	CRACK AND JOINT SEALING DETAIL (PD-11)
9	TRAFFIC CONTROL AND PROTECTION FOR SIDE ROADS, INTERSECTIONS, AND DRIVEWAYS (TC-10)
9A	RAISED REFLECTIVE PAVEMENT MARKERS (SNOW-PLOW RESISTANT) (TC-11)
10	DISTRICT ONE TYPICAL PAVEMENT MARKINGS (TC-13)
11	TRAFFIC CONTROL AND PROTECTION AT TURN BAYS (TO REMAIN OPEN TO TRAFFIC) (TC-14)
12	ARTERIAL ROAD INFORMATION SIGNING (TC-22)

STATE STANDARDS

STANDARD NO.	DESCRIPTION
000001-09	STANDARD SYMBOLS, ABBREVIATIONS, AND PATTERNS
701006-05	OFF-RD MOVING OPERATIONS, 2L, 2W, 15' (4.5 m) TO 24" (600 mm) FROM PAVEMENT EDGE
701011-04	OFF-RD MOVING OPERATIONS, 2L, 2W, DAY ONLY
701301-04	LANE CLOSURE, 2L, 2W, SHORT TIME OPERATIONS
701306-04	LANE CLOSURE, 2L, 2W, SLOW MOVING OPERATIONS DAY ONLY, FOR SPEEDS ≥ 45 MPH
701311-03	LANE CLOSURE, 2L, 2W, SLOW MOVING OPERATIONS - DAY ONLY
701501-06	URBAN LANE CLOSURE, 2L, 2W, UNDIVIDED
701502-09	URBAN LANE CLOSURE, 2L, 2W, WITH BIDIRECTIONAL LEFT TURN LANE
701701-10	URBAN LANE CLOSURE, MULTILANE INTERSECTION
701801-06	SIDEWALK, CORNER OR CROSSWALK CLOSURE
701901-11	TRAFFIC CONTROL DEVICES

GENERAL NOTES

- THE CONTRACTOR SHALL COORDINATE CONSTRUCTION ACTIVITIES WITH UTILITY COMPANIES AND THE VILLAGE OF LAKE VILLA.
- THE CONTRACTOR WILL NOT BE ALLOWED TO SET UP A YARD OR FIELD OFFICE ON STATE PROPERTY WITHOUT WRITTEN PERMISSION FROM THE DEPARTMENT.
- BEFORE BEGINNING ANY WORK, THE CONTRACTOR SHALL RETAIN AND RECORD FOR FUTURE REFERENCE, ALL EXISTING PAVEMENT MARKING LINES (AND RAISED REFLECTIVE PAVEMENT MARKERS) IN ORDER THAT THESE LOCATIONS CAN BE RE-ESTABLISHED FOR STRIPING. EXACT LOCATIONS OF ALL PAVEMENT MARKINGS SHALL BE AS DIRECTED BY THE ENGINEER.
- THE CONTRACTOR SHALL CONTACT KALPANA KANNAN-HOSADURGA, THE DISTRICT TRAFFIC CONTROL SUPERVISOR, AT KALPANA.KANNAN-HOSADURGA@ILLINOIS.GOV A MINIMUM OF 72 HOURS IN ADVANCE OF BEGINNING WORK.
- THE RESIDENT ENGINEER SHALL CONTACT BRANDY KENNEDY, AREA TRAFFIC FIELD ENGINEER, AT BRANDY.KENNEDY@ILLINOIS.GOV, A MINIMUM OF TWO (2) WEEKS PRIOR TO THE PLACEMENT OF PERMANENT PAVEMENT MARKINGS.
- IT SHALL BE THE CONTRACTOR'S RESPONSIBILITY TO VERIFY ALL DIMENSIONS AND CONDITIONS EXISTING IN THE FIELD PRIOR TO ORDERING MATERIALS AND BEGINNING CONSTRUCTION.
- THE CONTRACTOR SHALL BE REQUIRED TO PROVIDE ACCESS TO ABUTTING PROPERTY AT ALL TIMES DURING THE CONSTRUCTION OF THIS PROJECT.
- MATERIALS RESULTING FROM THE ROUTING OF CRACKS IN THE EXISTING PAVEMENT MAY BE PLACED, SHAPED AND COMPACTED TO THE SATISFACTION OF THE ENGINEER ALONG EXISTING AGGREGATE SHOULDERS ADJACENT TO THE PAVEMENT. ALL MATERIALS RESULTING FROM THE ROUTING OF CRACKS IN PAVEMENTS AND SURPLUS MATERIALS RESULTING FROM THE ROUTING OF CRACKS IN PAVEMENTS WITH AGGREGATE SHOULDERS, WHERE ALL MATERIALS ARE NOT PLACED ALONG EXISTING AGGREGATE SHOULDERS, SHALL BE DISPOSED OF AS SPECIFIED IN ARTICLE 202.03 OF THE STANDARD SPECIFICATIONS. OLD SEALANTS REMOVED PRIOR TO ROUTING SHALL BE DISPOSED OF AS SPECIFIED IN ARTICLE 202.03. THIS WORK WILL NOT BE PAID FOR SEPARATELY, BUT THE COST SHALL BE CONSIDERED AS INCLUDED IN THE CONTRACT UNIT PRICE FOR THE CONSTRUCTION ITEMS INVOLVED, AND NO ADDITIONAL COMPENSATION WILL BE ALLOWED.
- MODIFIED URETHANE PAVEMENT MARKING SHALL BE PLACED IMMEDIATELY AFTER CRACK AND JOINT SEALER TEMPERATURE HAS COOLED DOWN AND DOES NOT AFFECT THE APPLICATION OF THE MODIFIED URETHANE PAVEMENT MARKING.
- ALL CRACK ROUTING AND CRACK SEALING LOCATIONS WILL BE DETERMINED IN THE FIELD BY THE ENGINEER. CRACK ROUTING SHALL BE OMITTED WHERE VEHICLE DETECTOR LOOPS AND RAISED REFLECTIVE PAVEMENT MARKERS ARE PRESENT IN THE PAVEMENT.
- ALL DAMAGE TO EXISTING PAVEMENT MARKINGS OR RAISED REFLECTIVE PAVEMENT MARKERS OUTSIDE THE REMOVAL LINE SHOWN ON THE PLANS SHALL BE REPLACED AT NO ADDITIONAL COST TO THE DEPARTMENT.
- THE CONTRACTOR SHALL BE REQUIRED TO PROVIDE ACCESS TO ABUTTING PROPERTY AT ALL TIMES DURING THE CONSTRUCTION OF THIS PROJECT.
- DO NOT SCALE PLANS FOR CONSTRUCTION DIMENSIONS.
- THE "ROAD CONSTRUCTION AHEAD" SIGNS SHALL REMAIN INSTALLED UNTIL COMPLETION OF THE PROJECT OR WHEN NO ROADWAY HAZARDS REMAIN WITHIN THE WORK ZONE.

HOT-MIX ASPHALT MIXTURE REQUIREMENTS		QUALITY MANAGEMENT PROGRAM (QMP)
MIXTURE TYPE	AIR VOIDS @ Ndes	
CLASS D PATCHING (SPECIAL)		
HMA SURFACE COURSE, MIX "D", IL-9.5, N70, TOP 2"	4% @ 70 GYR.	QC/QA
HMA BINDER IL-19.0	4% @ 70 GYR.	QC/QA
QMP DESIGNATION: QUALITY CONTROL/QUALITY ASSURANCE (QC/QA); QUALITY CONTROL FOR PERFORMANCE (QCP) PAY FOR PERFORMANCE (PFP).		

NOTE 1: THE UNIT WEIGHT USED TO CALCULATE ALL HMA SURFACE MIXTURE QUANTITIES IS 112 LBS/SQ YD/IN.

NOTE 2: THE "AC TYPE" FOR POLYMERIZED HMA MIXES SHALL BE "SBS/SBR PG 76-22" AND FOR NON-POLYMERIZED HMA THE "AC TYPE" SHALL BE "PG 64-22" UNLESS MODIFIED BY RECLAIMED MATERIALS SPECIFICATIONS.

MODEL: [Untitled (Sheet)]
 FILE NAME: c:\p\work\project\hth\hth.dwg

USER NAME = Aya.Elkhailb	DESIGNED -	REVISED -	STATE OF ILLINOIS DEPARTMENT OF TRANSPORTATION	INDEX OF SHEETS, STATE STANDARDS, AND GENERAL NOTES IL 132 (GRAND AVE) (IL 59 TO CLEVELAND AVENUE)	F.A.P RTE.	SECTION	COUNTY	TOTAL SHEETS	SHEET NO.	
	DRAWN -	REVISED -			541	FAP 0541 23 C&J	LAKE	12	2	
	CHECKED -	REVISED -			CONTRACT NO. 62V77					
PLOT DATE = 4/29/2026	DATE -	REVISED -			ILLINOIS FED. AID PROJECT					

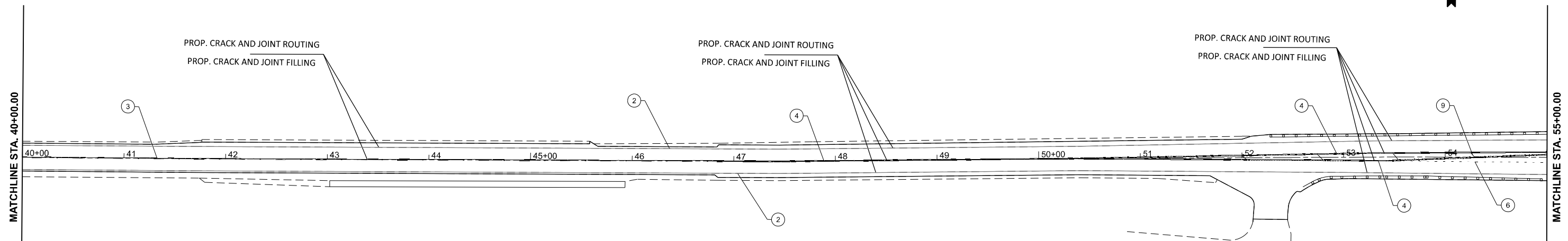

PAVEMENT MARKING LEGEND

- ① PROP. MODIFIED URETHANE PAVEMENT MARKING LINE, 4" SKIP DASH YELLOW LANE LINE @ 30' SKIP & 10' DASH (TYP.)
- ② PROP. MODIFIED URETHANE PAVEMENT MARKING LINE, 4" SOLID WHITE LINE (TYP.)
- ③ PROP. MODIFIED URETHANE PAVEMENT MARKING LINE, 4" SOLID YELLOW LINE AND 4" SKIP DASH YELLOW LINE (@30' SKIP & 10' DASH), 2 LINES @ 5½" C-C (TYP. NO PASSING ZONE LINES)
- ④ PROP. MODIFIED URETHANE PAVEMENT MARKING LINE, 4" DOUBLE SOLID YELLOW LINE, 2 LINES @ 11"C-C (TYP.)
- ⑤ PROP. MODIFIED URETHANE PAVEMENT MARKING LINE, 6" SOLID WHITE LINE (TYP.)
- ⑥ PROP. MODIFIED URETHANE PAVEMENT MARKING LINE, 6" SKIP DASH, WHITE TURN LANE @ 6' SKIP & 2' DASH (TYP.)
- ⑦ PROP. MODIFIED URETHANE PAVEMENT MARKING LINE, 8" SOLID WHITE GORE MARKING AND CHANNELIZING LINES (SEE DISTRICT DETAIL TC-13 FOR SPACING)
- ⑧ PROP. MODIFIED URETHANE PAVEMENT MARKING LINE, 12" SOLID WHITE GORE MARKING CHEVRONS (SEE DISTRICT DETAIL TC-13 FOR SPACING)
- ⑨ PROP. MODIFIED URETHANE PAVEMENT MARKING LINE, 12" SOLID YELLOW DIAGONAL LINE (SEE DISTRICT DETAIL TC-13 FOR SPACING)
- ⑩ PROP. MODIFIED URETHANE PAVEMENT MARKING LINE, 12" SOLID WHITE LONGITUDINAL BARS (CROSSWALK LINES) (TYP.)
- ⑪ PROP. MODIFIED URETHANE PAVEMENT MARKING LINE, 24" SOLID WHITE STOP BAR (TYP.)
- ⑫ PROP. MODIFIED URETHANE PAVEMENT MARKING LETTERS & SYMBOLS, SOLID WHITE (TYP.)

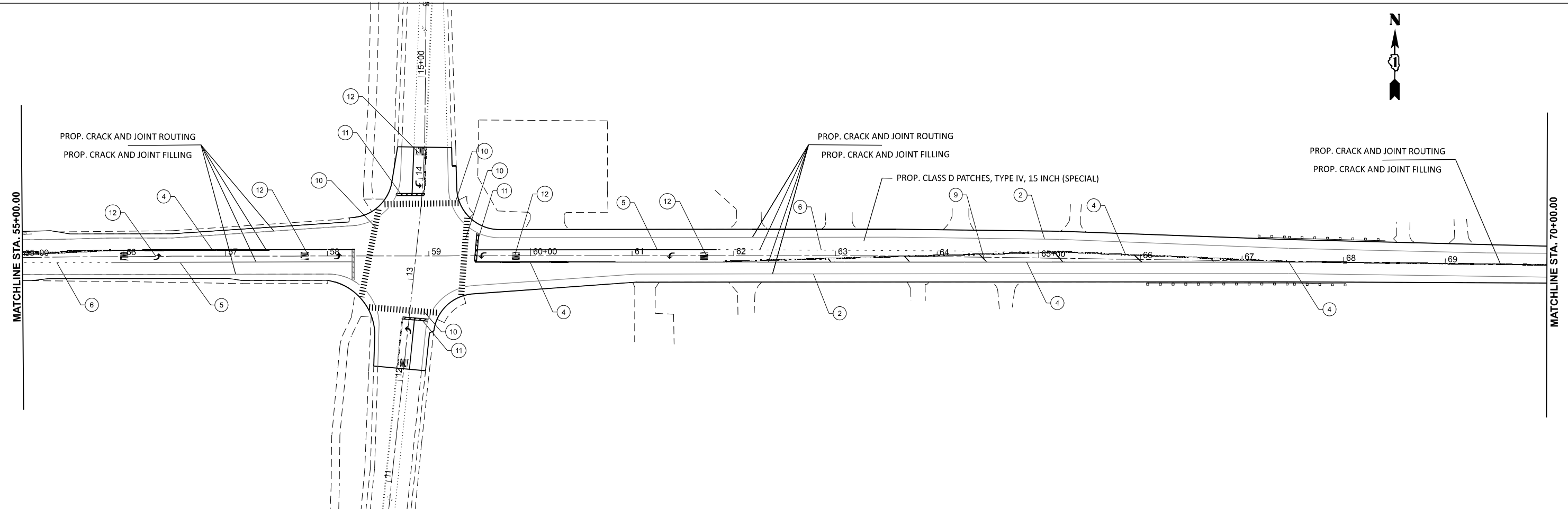

MODEL: GRAND_E - RdwyPlan03
 FILE NAME: c:\p\work\105524\105524-sh1-plan.dgn

USER NAME	= Aya.Elkhattib	DESIGNED	-	REVISED	-
DRAWN	-	REVISIONS	-	REVISED	-
CHECKED	-	REVISIONS	-	REVISED	-
PLOT DATE	= 3/18/2026	DATE	-	REVISED	-

STATE OF ILLINOIS
DEPARTMENT OF TRANSPORTATION

ROADWAY AND PAVEMENT MARKING PLANS
IL 132 (GRAND AVENUE) (IL 59 TO CLEVELAND AVENUE)
 SCALE: 1"=50' SHEET 2 OF 2 SHEETS STA. 40+00 TO STA. 63+59.52

F.A.P. RTE.	SECTION	COUNTY	TOTAL SHEETS	SHEET NO.
541	FAP 0541 23 C&J	LAKE	12	5
CONTRACT NO. 62V77				
ILLINOIS FED. AID PROJECT				

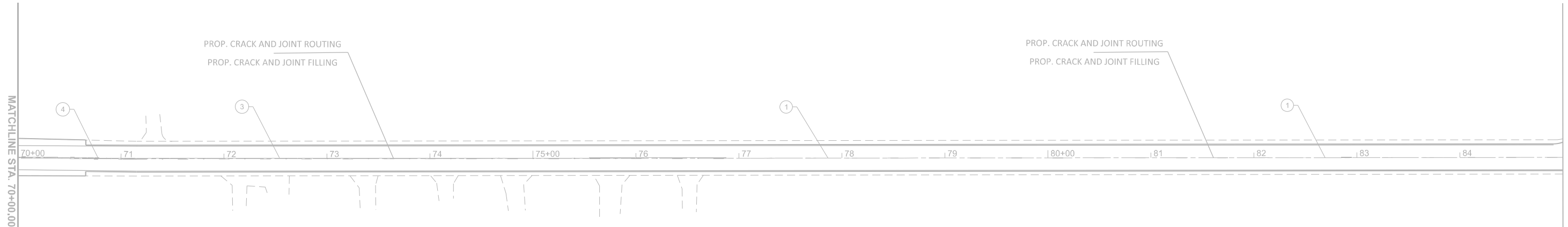

PAVEMENT MARKING LEGEND

- ① PROP. MODIFIED URETHANE PAVEMENT MARKING LINE, 4" SKIP DASH YELLOW LANE LINE @ 30' SKIP & 10' DASH (TYP.)
- ② PROP. MODIFIED URETHANE PAVEMENT MARKING LINE, 4" SOLID WHITE LINE (TYP.)
- ③ PROP. MODIFIED URETHANE PAVEMENT MARKING LINE, 4" SOLID YELLOW LINE AND 4" SKIP DASH YELLOW LINE (@30' SKIP & 10' DASH), 2 LINES @ 5½" C-C (TYP. NO PASSING ZONE LINES)
- ④ PROP. MODIFIED URETHANE PAVEMENT MARKING LINE, 4" DOUBLE SOLID YELLOW LINE, 2 LINES @ 11" C-C (TYP.)
- ⑤ PROP. MODIFIED URETHANE PAVEMENT MARKING LINE, 6" SOLID WHITE LINE (TYP.)
- ⑥ PROP. MODIFIED URETHANE PAVEMENT MARKING LINE, 6" SKIP DASH, WHITE TURN LANE @ 6' SKIP & 2' DASH (TYP.)
- ⑦ PROP. MODIFIED URETHANE PAVEMENT MARKING LINE, 8" SOLID WHITE GORE MARKING AND CHANNELIZING LINES (SEE DISTRICT DETAIL TC-13 FOR SPACING)
- ⑧ PROP. MODIFIED URETHANE PAVEMENT MARKING LINE, 12" SOLID WHITE GORE MARKING CHEVRONS (SEE DISTRICT DETAIL TC-13 FOR SPACING)
- ⑨ PROP. MODIFIED URETHANE PAVEMENT MARKING LINE, 12" SOLID YELLOW DIAGONAL LINE (SEE DISTRICT DETAIL TC-13 FOR SPACING)
- ⑩ PROP. MODIFIED URETHANE PAVEMENT MARKING LINE, 12" SOLID WHITE LONGITUDINAL BARS (CROSSWALK LINES) (TYP.)
- ⑪ PROP. MODIFIED URETHANE PAVEMENT MARKING LINE, 24" SOLID WHITE STOP BAR (TYP.)
- ⑫ PROP. MODIFIED URETHANE PAVEMENT MARKING LETTERS & SYMBOLS, SOLID WHITE (TYP.)

**ILLINOIS ROUTE 132
(GRAND AVE.)**

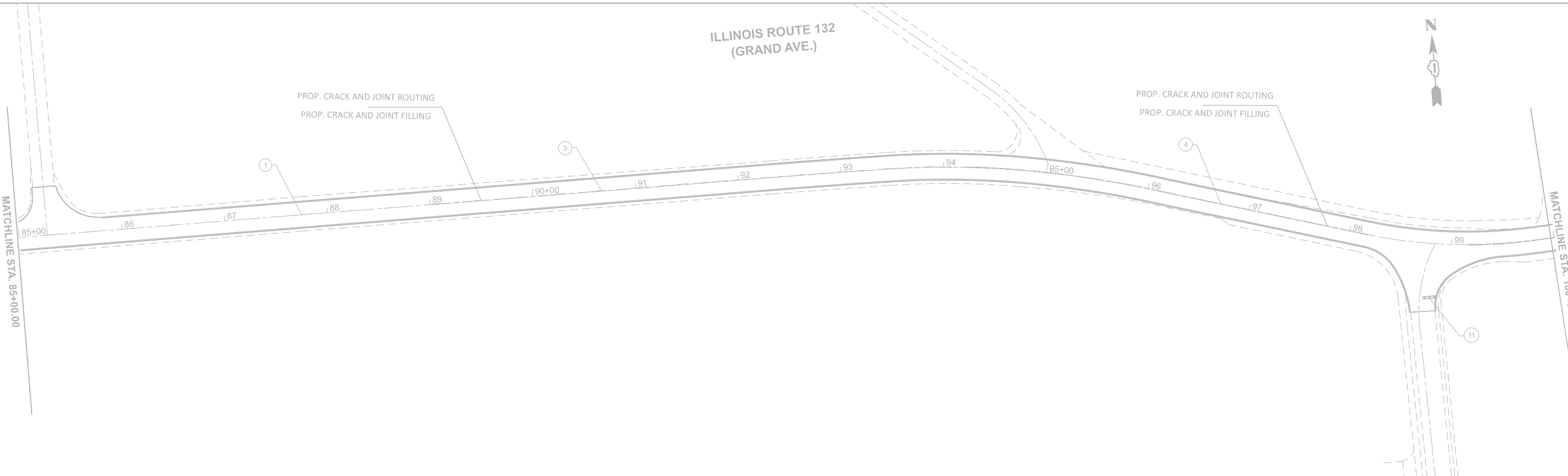

MODEL: GRAND_E - Plan 1 (Sheet)
 FILE NAME: c:\p\work\pwr\elkhalibaj\0903761\06524-shr-plan.dgn

USER NAME = Aya.Elkhallib	DESIGNED -	REVISED -
	DRAWN -	REVISED -
	CHECKED -	REVISED -
PLOT DATE = 4/29/2026	DATE -	REVISED -

**STATE OF ILLINOIS
DEPARTMENT OF TRANSPORTATION**

**ROADWAY AND PAVEMENT MARKING PLANS
IL 132 (GRAND AVENUE) (IL 59 TO CLEVELAND AVENUE)**

SCALE: 1"=50' SHEET 3 OF 4 SHEETS STA. 70+00.00 TO STA. 100+00.00

F.A.P. RTE.	SECTION	COUNTY	TOTAL SHEETS	SHEET NO.
541	FAP 0541 23 C&J	LAKE	12	6
CONTRACT NO. 62V77				
ILLINOIS FED. AID PROJECT				

**ILLINOIS ROUTE 132
(GRAND AVE.)**

**PROJECT ENDS
STA 110+09**

MATCHLINE STA. 100+00.00

PROP. CRACK AND JOINT ROUTING
PROP. CRACK AND JOINT FILLING

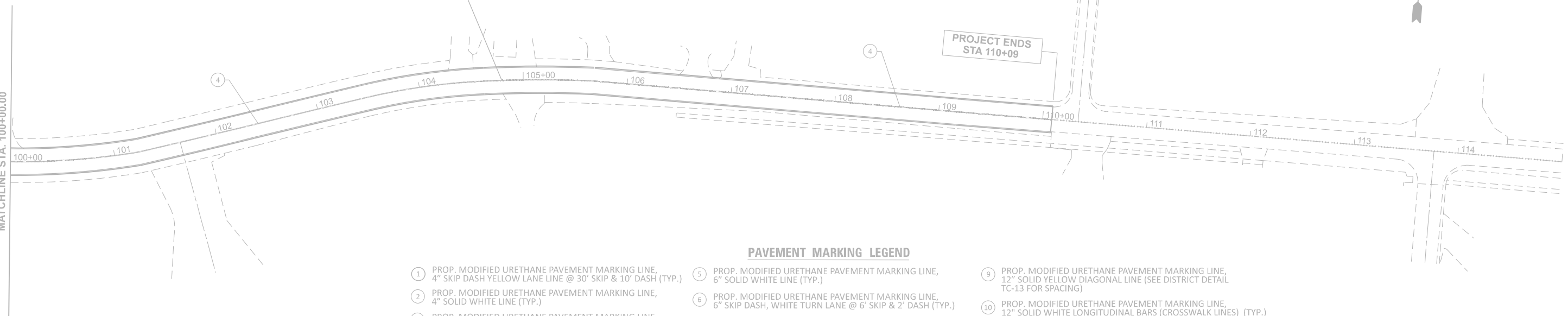

PAVEMENT MARKING LEGEND

- ① PROP. MODIFIED URETHANE PAVEMENT MARKING LINE, 4" SKIP DASH YELLOW LANE LINE @ 30' SKIP & 10' DASH (TYP.)
- ② PROP. MODIFIED URETHANE PAVEMENT MARKING LINE, 4" SOLID WHITE LINE (TYP.)
- ③ PROP. MODIFIED URETHANE PAVEMENT MARKING LINE, 4" SOLID YELLOW LINE AND 4" SKIP DASH YELLOW LINE (@30' SKIP & 10' DASH), 2 LINES @ 5½" C-C (TYP. NO PASSING ZONE LINES)
- ④ PROP. MODIFIED URETHANE PAVEMENT MARKING LINE, 4" DOUBLE SOLID YELLOW LINE, 2 LINES @ 11" C-C (TYP.)
- ⑤ PROP. MODIFIED URETHANE PAVEMENT MARKING LINE, 6" SOLID WHITE LINE (TYP.)
- ⑥ PROP. MODIFIED URETHANE PAVEMENT MARKING LINE, 6" SKIP DASH, WHITE TURN LANE @ 6' SKIP & 2' DASH (TYP.)
- ⑦ PROP. MODIFIED URETHANE PAVEMENT MARKING LINE, 8" SOLID WHITE GORE MARKING AND CHANNELIZING LINES (SEE DISTRICT DETAIL TC-13 FOR SPACING)
- ⑧ PROP. MODIFIED URETHANE PAVEMENT MARKING LINE, 12" SOLID WHITE GORE MARKING CHEVRONS (SEE DISTRICT DETAIL TC-13 FOR SPACING)
- ⑨ PROP. MODIFIED URETHANE PAVEMENT MARKING LINE, 12" SOLID YELLOW DIAGONAL LINE (SEE DISTRICT DETAIL TC-13 FOR SPACING)
- ⑩ PROP. MODIFIED URETHANE PAVEMENT MARKING LINE, 12" SOLID WHITE LONGITUDINAL BARS (CROSSWALK LINES) (TYP.)
- ⑪ PROP. MODIFIED URETHANE PAVEMENT MARKING LINE, 24" SOLID WHITE STOP BAR (TYP.)
- ⑫ PROP. MODIFIED URETHANE PAVEMENT MARKING LETTERS & SYMBOLS, SOLID WHITE (TYP.)

MATCHLINE STA. 115+00.00



MODEL: GRAND_E - Plan 3 (Sheet)
FILE NAME: c:\p\work\pwr\elkhalibaj\0903761\05524-sh1-plan.dgn

USER NAME = Aya.Elkhallib	DESIGNED -	REVISED -
	DRAWN -	REVISED -
	CHECKED -	REVISED -
PLOT DATE = 4/29/2026	DATE -	REVISED -

**STATE OF ILLINOIS
DEPARTMENT OF TRANSPORTATION**

**ROADWAY AND PAVEMENT MARKING PLANS
IL 132 (GRAND AVENUE) (IL 59 TO CLEVELAND AVENUE)**

SCALE: 1"=50' SHEET 4 OF 4 SHEETS STA. 100+00.00 TO STA. 130+00.00

F.A.P. RTE.	SECTION	COUNTY	TOTAL SHEETS	SHEET NO.
541	FAP 0541 23 C&J	LAKE	12	7
CONTRACT NO. 62V77				
ILLINOIS FED. AID PROJECT				

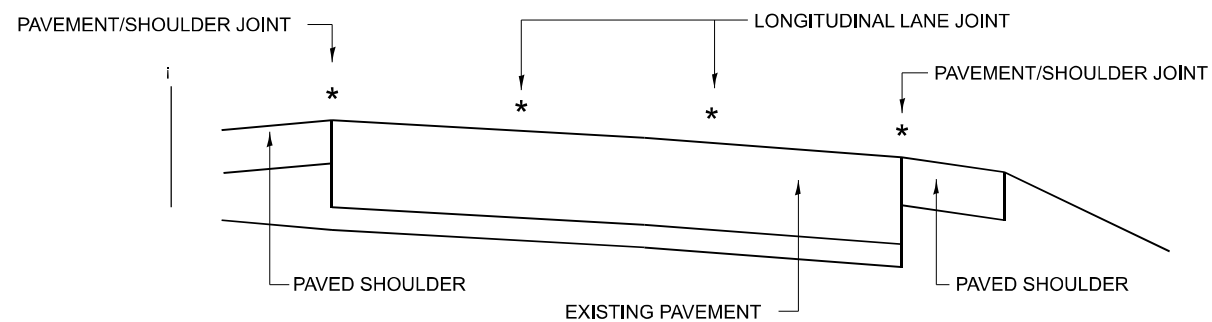

MULTI-LANE DIVIDED PAVEMENT

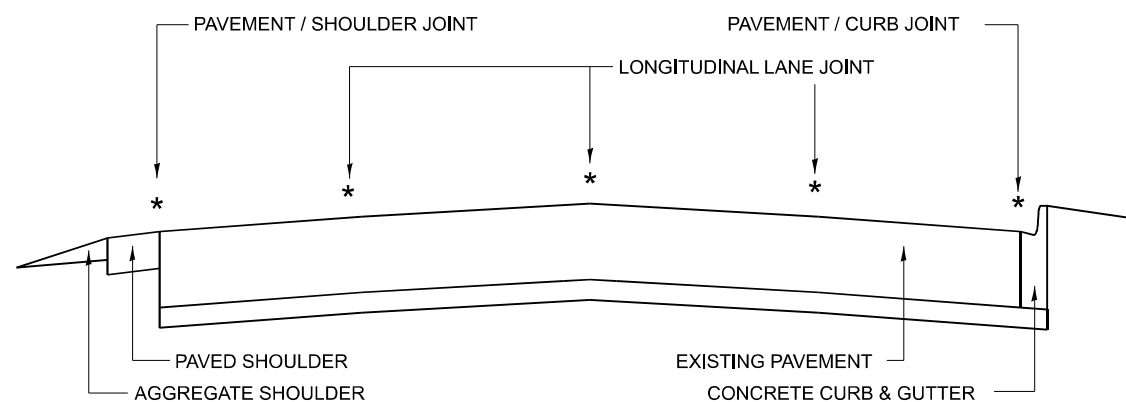

MULTI-LANE UNDIVIDED PAVEMENT

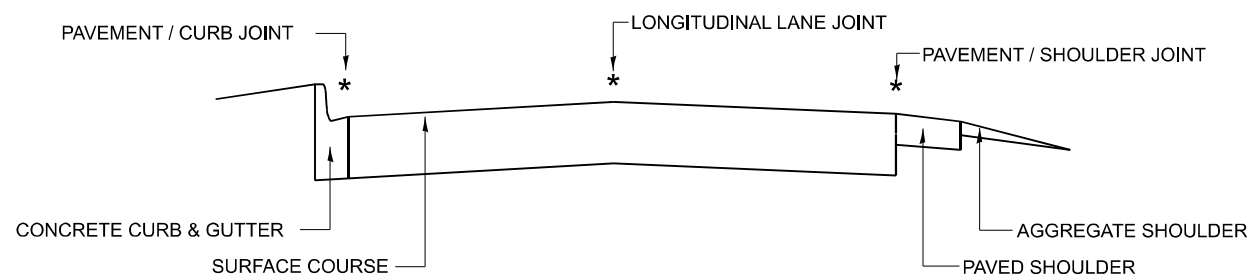

TWO-LANE PAVEMENT

* PROPOSED LONGITUDINAL CRACK ROUTING (PAVEMENT) & CRACK FILLING LOCATIONS

GENERAL EXISTING TYPICAL SECTIONS
(APPLIES TO HMA AND PCC PAVEMENTS)

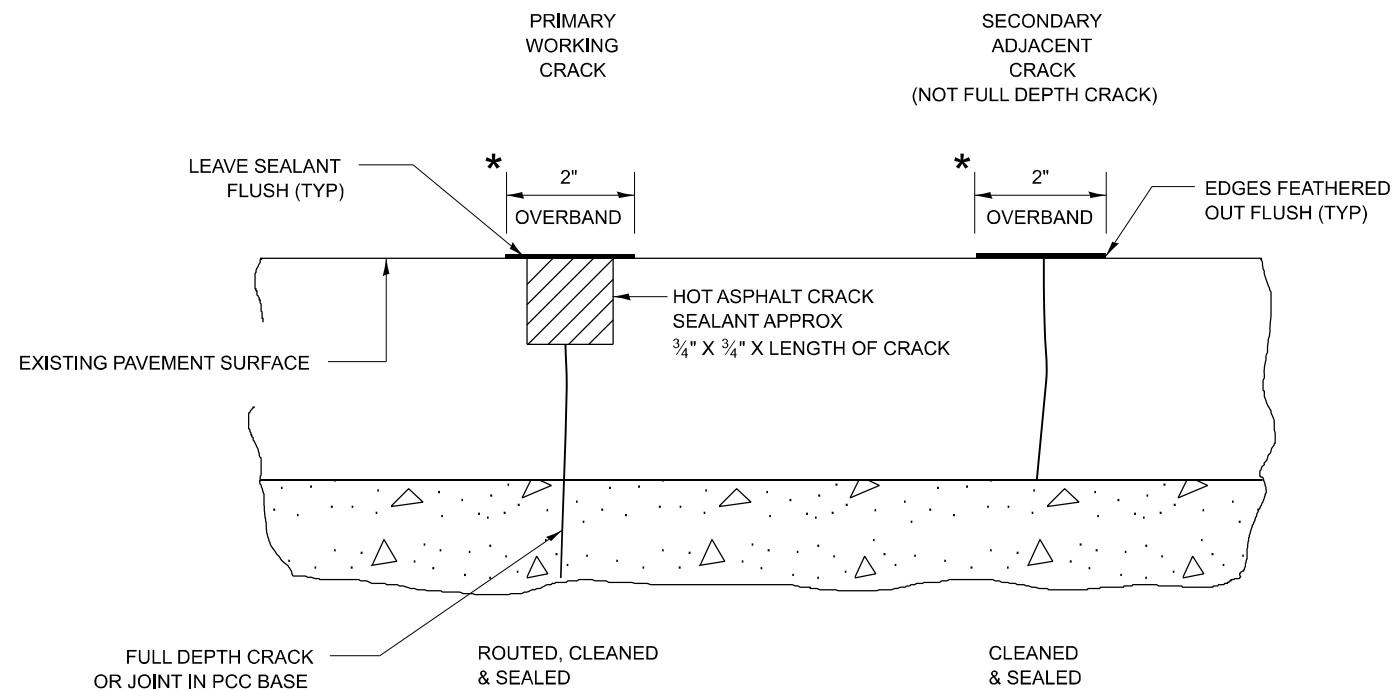

* IN ALL LOCATIONS WHERE THE LONGITUDINAL CRACK CONFLICTS WITH EXISTING PAVEMENT MARKINGS (EITHER EDGE LINE OR LANE LINE) THE CRACK SHALL BE ROUTED & THE RESULTING RESERVOIR FILLED WITH SEALANT. ALL DAMAGES TO EXISTING RAISED REFLECTIVE PAVEMENT MARKERS SHALL BE REPLACED AT THE EXPENSE OF THE CONTRACTOR. ALL EXISTING PAVEMENT MARKINGS WITHIN THE PROJECT LIMITS SHALL BE RESTORED WITH MODIFIED URETHANE PAVEMENT MARKINGS.

LONGITUDINAL JOINT

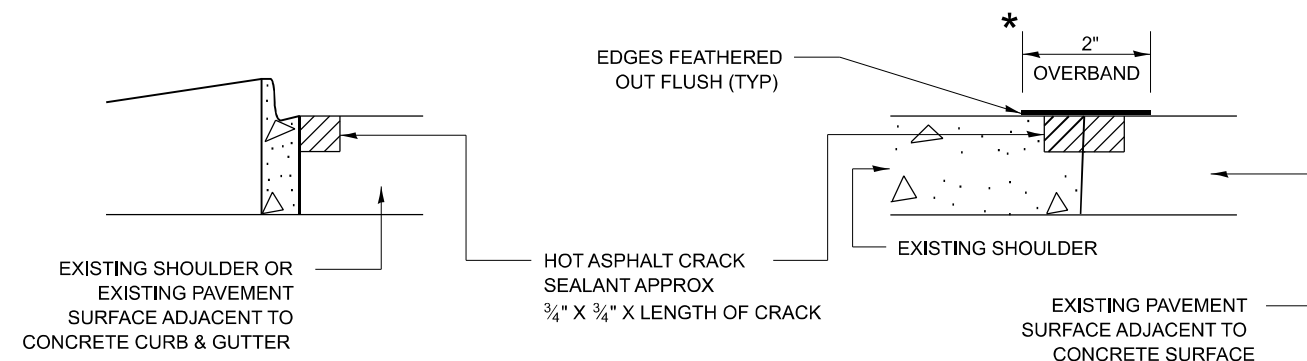

CRACK & JOINT SEALING DETAIL

MODEL: PD-11 (Sheet)
FILE NAME: c:\p\work\project\hth\hth\090376\10106524-shr-Dist\Sigs2.dgn.dgn

USER NAME = Aya.Elkhailb	DESIGNED - F. Aqueel / A. Midy	REVISED -
	DRAWN -	REVISED -
	CHECKED -	REVISED -
PLOT DATE = 3/18/2026	DATE - 10/08/2020	REVISED -

STATE OF ILLINOIS
DEPARTMENT OF TRANSPORTATION

CRACK & JOINT SEALING DETAIL
(PD-11)

SCALE: NONE SHEET 1 OF 1 SHEETS STA. TO STA.

F.A.P. RTE.	SECTION	COUNTY	TOTAL SHEETS	SHEET NO.
541	FAP 0541 23 C&J	LAKE	12	8
PD-11		CONTRACT NO. 62V77		
ILLINOIS FED. AID PROJECT				

TURN BAY ENTRANCE AT START OF LANE CLOSURE TAPER

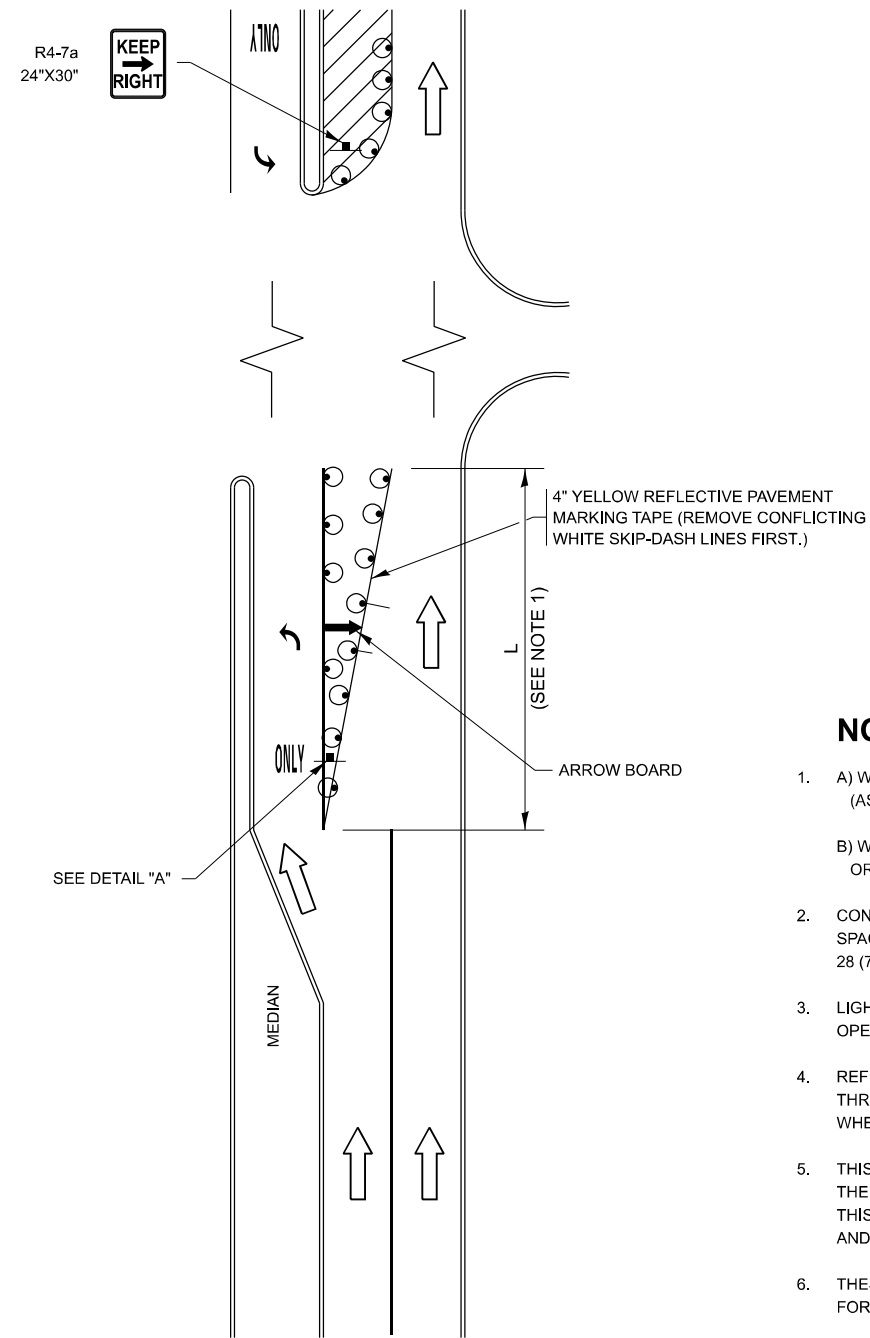

FIGURE 1

TURN BAY ENTRANCE WITHIN A LANE CLOSURE

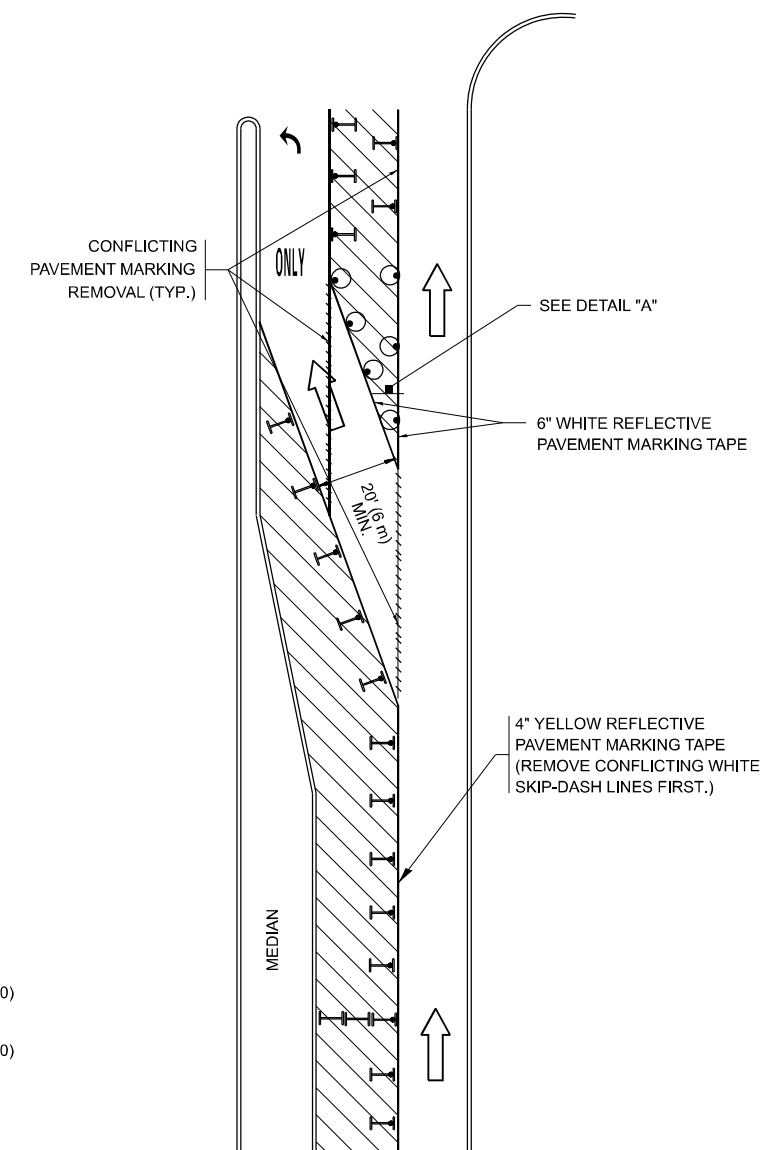

FIGURE 2

LEGEND

- WORK AREA
- LANE OPEN TO TRAFFIC
- ARROW BOARD
- TYPE I OR II BARRICADE OR DRUM WITH STEADY BURN LIGHT
- DRUM WITH STEADY BURN LIGHT
- SIGN ASSEMBLY
- TYPE I OR II CHECK BARRICADE WITH FLASHING LIGHT

NOTES:

1. A) WHEN "L" IS \leq THE STORAGE LENGTH OF THE TURN LANE (AS SHOWN IN FIG. 1), USE FIGURE 1.
B) WHEN "L" IS $>$ THE STORAGE LENGTH OF THE TURN LANE OR THE TURN LANE IS WITHIN THE LANE CLOSURE, USE FIGURE 2.
2. CONES MAY BE SUBSTITUTED FOR BARRICADES OR DRUMS AT HALF THE SPACING DURING DAY OPERATIONS. CONES SHALL BE A MINIMUM OF 28 (710) IN HEIGHT.
3. LIGHTS WILL NOT BE REQUIRED ON BARRICADES OR DRUMS FOR DAY OPERATIONS. ALL LIGHTS SHALL BE MONODIRECTIONAL.
4. REFLECTIVE TEMPORARY PAVEMENT MARKINGS SHALL BE PLACED THROUGHOUT THE BARRICADED AREAS OF EACH TURN BAY AS SHOWN WHERE THE CLOSURE TIME IS GREATER THAN FOURTEEN (14) DAYS.
5. THIS APPLICATION ALSO APPLIES WHEN WORK IS BEING PERFORMED IN THE RIGHT LANE(S) AND THE RIGHT TURN BAY IS TO REMAIN OPEN. UNDER THIS CONDITION, "RIGHT TURN LANE" R3-1100R 24 x 24 (600 x 600) AND M6-2R 21 x 15 (530 x 380) SHALL BE USED.
6. THESE CONTROLS SHALL SUPPLEMENT MAINLINE TRAFFIC CONTROL FOR LANE CLOSURES.
7. THE SIGNS SHALL BE MOUNTED ABOVE THE BARRICADES/DRUMS ON SEPARATE SIGN SUPPORTS THAT MEET NCHRP 350 OR MASH REQUIREMENTS.
8. TRAFFIC CONTROL AND PROTECTION AT TURN BAYS (TO REMAIN OPEN TO TRAFFIC) SHALL BE INCLUDED IN THE COST OF SPECIFIED TRAFFIC CONTROL STANDARDS OR ITEMS.

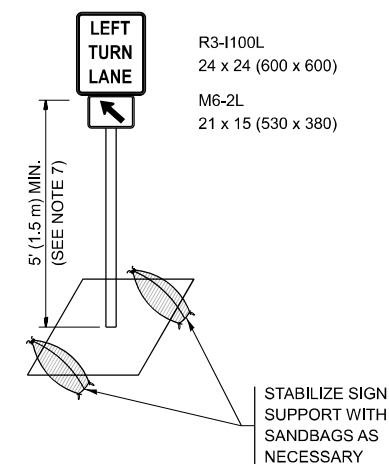

DETAIL A

All dimensions are in inches (millimeters) unless otherwise shown.

MODEL: TC-14
FILE NAME: c:\p\work\project\hailib\0903761\05524-shr-DistSigs2.dgn

USER NAME = Aya.Elkhailib	DESIGNED - T. RAMMACHER 09-08-94	REVISED - R. BORO 09-14-09
	DRAWN - A. HOUSEH 11-07-95	REVISED - A. SCHUETZE 07-01-13
	CHECKED - A. HOUSEH 10-12-96	REVISED - A. SCHUETZE 09-15-16
PLOT DATE = 3/18/2026	DATE - T. RAMMACHER 01-06-00	REVISED -

**STATE OF ILLINOIS
DEPARTMENT OF TRANSPORTATION**

**TRAFFIC CONTROL AND PROTECTION AT TURN BAYS
(TO REMAIN OPEN TO TRAFFIC)**

SCALE: NONE SHEET 1 OF 1 SHEETS STA. TO STA.

F.A.P. RTE.	SECTION	COUNTY	TOTAL SHEETS	SHEET NO.
541	FAP 0541 23 C&J	LAKE	12	11
TC-14		CONTRACT NO. 62V77		
ILLINOIS FED. AID PROJECT				

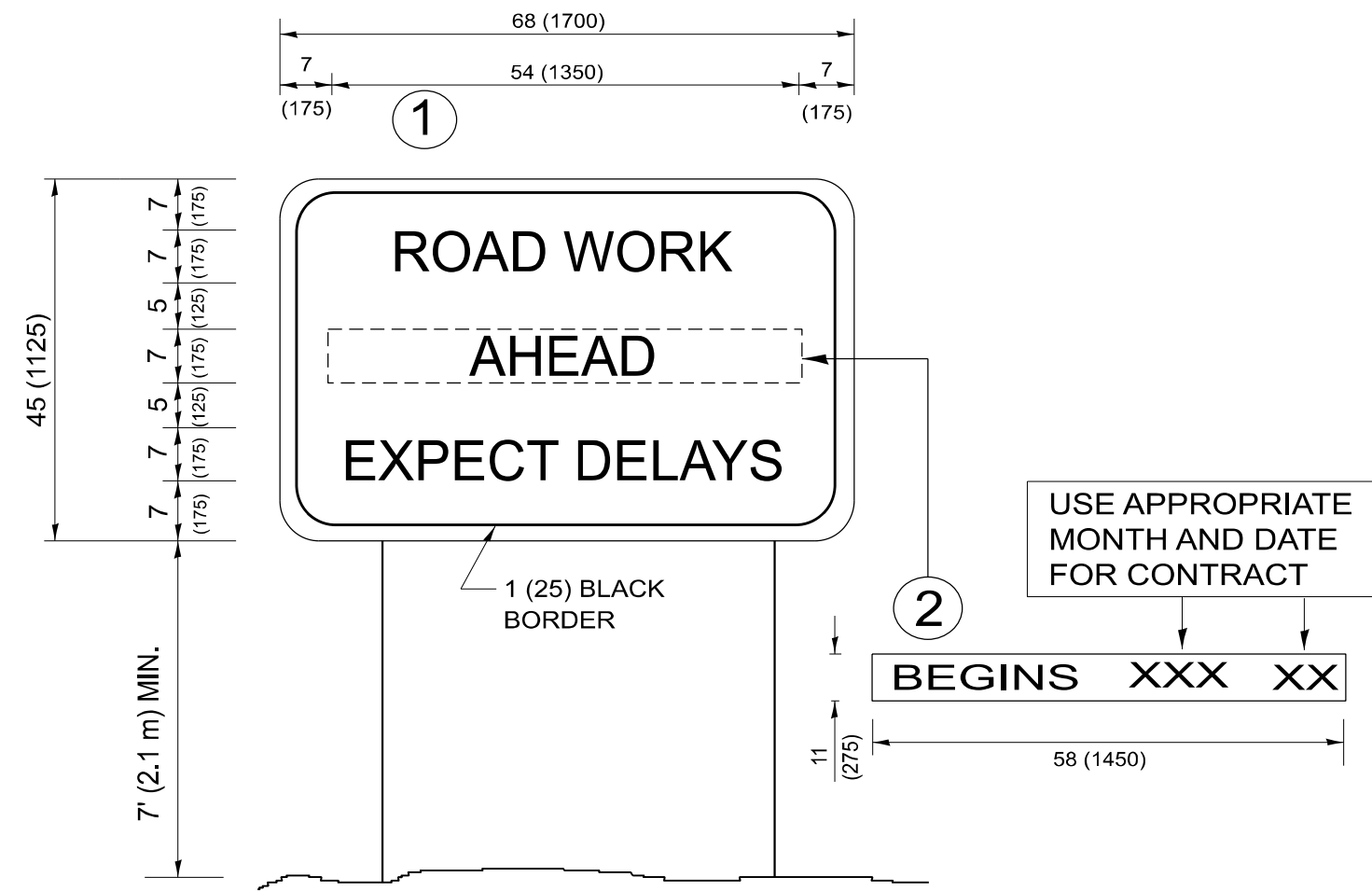

NOTES:

1. USE BLACK LETTERING ON ORANGE BACKGROUND.
2. ERECT SIGNS IN ADVANCE OF THE LOCATION FOR THE "ROAD CONSTRUCTION AHEAD" SIGN AT LOCATIONS AS DIRECTED BY THE ENGINEER.
3. ERECT SIGN ① WITH INSTALLED PANEL ② ONE WEEK PRIOR TO THE START OF CONSTRUCTION.
4. REMOVE PANEL ② SOON AFTER THE START OF CONSTRUCTION.
5. SEE SPECIAL PROVISION FOR "TEMPORARY INFORMATION SIGNING" FOR ADDITIONAL INFORMATION.
6. ONE SIGN ASSEMBLY EQUALS 25.70 SQ. FT. (2.3 SQ. M.)
7. SHALL BE PAID FOR AS TEMPORARY INFORMATION SIGNING.

ALL DIMENSIONS ARE IN INCHES (MILLIMETERS) UNLESS OTHERWISE SHOWN.

MODEL: TC-22 (Sheet) FILE NAME: c:\p\work\project\hth\hth\106524-shr-Dist\Sigs2.dgn.dgn

USER NAME = Aya,Elkhalib	DESIGNED -	REVISED - R. MIRS 09-15-97
	DRAWN -	REVISED - R. MIRS 12-11-97
	CHECKED -	REVISED - T. RAMMACHER 02-02-99
PLOT DATE = 3/18/2026	DATE -	REVISED - C. JUCIUS 01-31-07

**STATE OF ILLINOIS
DEPARTMENT OF TRANSPORTATION**

**ARTERIAL ROAD
INFORMATION SIGN**

SCALE: NONE SHEET 1 OF 1 SHEETS STA. TO STA.

F.A.P. RTE.	SECTION	COUNTY	TOTAL SHEETS	SHEET NO.
541	FAP 0541 23 C&J	LAKE	12	12
TC-22			CONTRACT NO. 62V77	
ILLINOIS FED. AID PROJECT				