

STATE OF ILLINOIS
DEPARTMENT OF TRANSPORTATION

F.A.P. RTE.	SECTION	COUNTY	TOTAL SHEETS	SHEET NO.
876A	2025-1091-RS	WILL	15	1
		ILLINOIS	CONTRACT NO. 80B17	

D-91-170-25

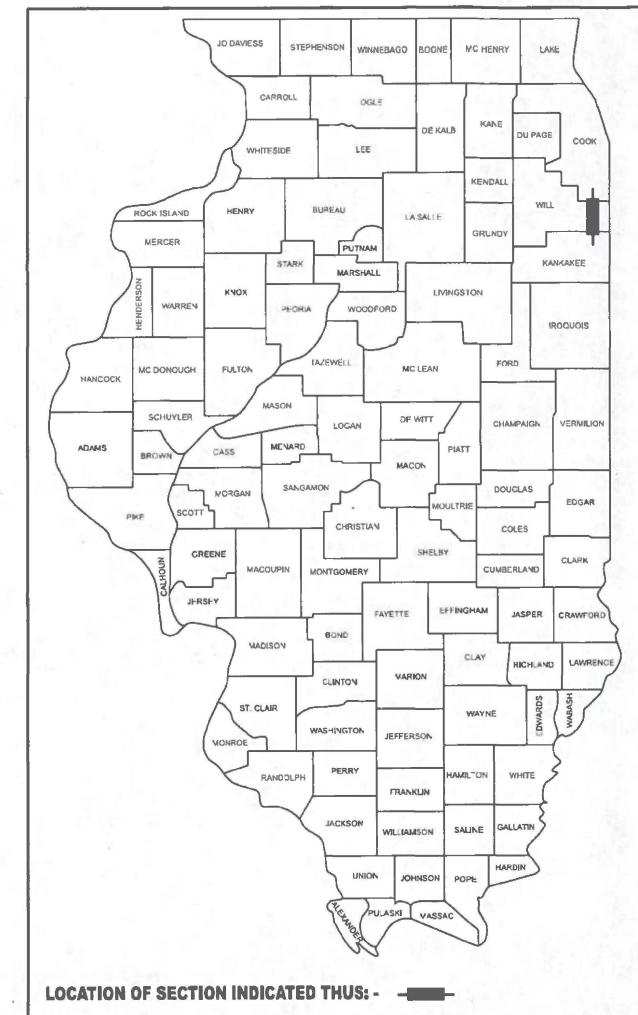

LOCATION OF SECTION INDICATED THIS: -

FOR INDEX OF SHEETS, SEE SHEET NO. 2

THIS PROJECT IS LOCATED IN THE VILLAGE OF CRETE

TRAFFIC DATA:
ADT: 20 (2019)
SPEED LIMIT: 50MPH

**PROPOSED
HIGHWAY PLANS**

**FAP 876A: OLD IL 1 / RIDGELAND AVE
FROM IL 1 to END OF RD
SECTION 2025-1091-RS
SMART OVERLAY
WILL COUNTY**

C-91-250-25

R 14 E

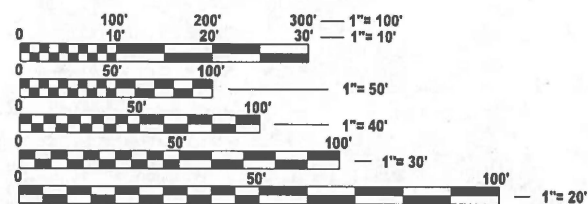

FULL SIZE PLANS HAVE BEEN PREPARED USING STANDARD ENGINEERING SCALES. REDUCED SIZED PLANS WILL NOT CONFORM TO STANDARD SCALES. IN MAKING MEASUREMENTS ON REDUCED PLANS, THE ABOVE SCALES MAY BE USED.

J.U.L.I.E.
JOINT UTILITY LOCATION INFORMATION FOR EXCAVATION
1-800-892-0123
OR 811

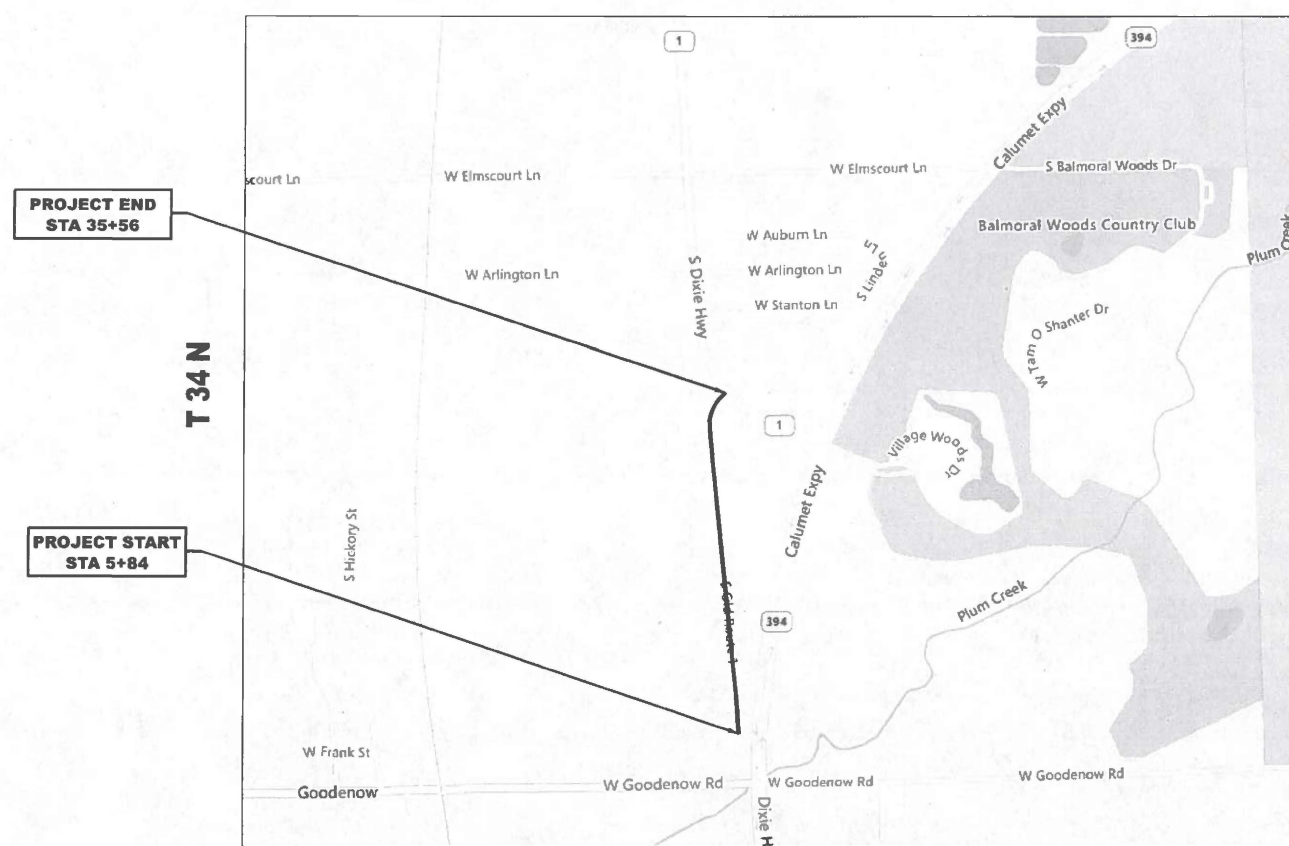

PROJECT ENGINEER: RODRIGO LEDEZMA (847) 705-4580
PROJECT MANAGER: J. ALAIN MIDY (847) 221-3056

CONTRACT NO. 80B17

GROSS & NET LENGTH = 3,009 FT. = 0.57 MILE

STATE OF ILLINOIS
DEPARTMENT OF TRANSPORTATION

SUBMITTED March 19, 2026
José Ros IR
REGIONAL ENGINEER

May 8, 2026
[Signature]
ENGINEER OF DESIGN AND ENVIRONMENT

May 8, 2026
[Signature]
DIRECTOR OF HIGHWAYS PROJECT IMPLEMENTATION

**PRINTED BY THE AUTHORITY
OF THE STATE OF ILLINOIS**

INDEX OF SHEETS

STATE STANDARDS

GENERAL NOTES

SHEET NO.	DESCRIPTION	STANDARD NO.	DESCRIPTION
1	COVER SHEET	000001-09	STANDARD SYMBOLS, ABBREVIATIONS AND PATTERNS
		442201-04	CLASS C AND D PATCHES
2	INDEX OF SHEETS, STATE STANDARDS & GENERAL NOTES	482011-03	HMA SHOULDER STRIPS WITH RESURFACING OR WIDENING & RESURFACING PROJECTS
		701006-05	OFF-RD OPERATIONS 2L 2W 15' TO 24" FROM PAVEMENT EDGE
3	SUMMARY OF QUANTITIES	701011-04	OFF-RD MOVING OPERATIONS 2L 2W DAY ONLY
		701201-05	LANE CLOSURE, 2L 2W, DAY ONLY 45 MPH OR MORE
4	EXISTING AND PROPOSED TYPICAL SECTIONS	701301-04	LANE CLOSURE, 2L 2W, SHORT TIME OPERATIONS
		701306-04	LANE CLOSURE, 2L 2W, SLOW MOVING OPERATIONS DAY ONLY 45 MPH OR MORE
5 - 6	ROADWAY PLANS	701311-03	LANE CLOSURE, 2L 2W, MOVING OPERATIONS DAY ONLY
		701901-11	TRAFFIC CONTROL DEVICES
7	PAVEMENT PATCHING FOR HMA SURFACED PAVEMENT (BD-22)		
8	BUTT JOINT AND HMA TAPER DETAILS (BD-32)		
9	PRUNING FOR SAFETY AND EQUIPMENT CLEARANCE (BM-20)		
10	TRAFFIC CONTROL AND PROTECTION FOR SIDE ROADS, INTERSECTIONS, AND DRIVEWAYS (TC-10)		
11	TYPICAL APPLICATIONS RAISED REFLECTIVE PAVEMENT MARKERS (SNOW-PLOW RESISTANT) (TC-11)		
12	DISTRICT ONE TYPICAL PAVEMENT MARKINGS (TC-13)		
13	SHORT TERM PAVEMENT MARKING LETTERS AND SYMBOLS (TC-16)		
14	ARTERIAL ROAD INFORMATION SIGN (TC-22)		
15	DRIVEWAY ENTRANCE SIGNING (TC-26)		

1. THE CONTRACTOR WILL NOT BE ALLOWED TO SET UP A YARD OR FIELD OFFICE ON STATE PROPERTY WITHOUT WRITTEN PERMISSION FROM THE DEPARTMENT (or ISTHA).
2. ALL MILLED SURFACES SHALL BE A UNIFORM CROSS SLOPE PER LANE AND FREE OF RIDGES BETWEEN PASSES. ANY DEVIATIONS SHALL BE CORRECTED AT NO COST TO THE DEPARTMENT.
3. BUTT JOINTS SHALL BE INSTALLED AT THE ENDS OF ALL RESURFACING (WHERE RESURFACING MEETS EXISTING PAVEMENT) ACCORDING TO THE "BUTT JOINT AND HOT-MIX ASPHALT TAPER DETAILS" SHEET INCLUDED IN THE PLANS, UNLESS OTHERWISE SPECIFIED.
4. ALL PAVEMENT PATCHING LOCATIONS WILL BE DETERMINED IN THE FIELD BY THE ENGINEER.
5. IT SHALL BE THE CONTRACTOR'S RESPONSIBILITY TO VERIFY ALL DIMENSIONS AND CONDITIONS EXISTING IN THE FIELD PRIOR TO CONSTRUCTION AND ORDERING OF MATERIALS.
6. THE CONTRACTOR SHALL CONTACT KALPANA KANNAN-HOSADURGA, THE DISTRICT ONE TRAFFIC CONTROL SUPERVISOR AT KALPANA.KANNAN-HOSADURGA@ILLINOIS.GOV A MINIMUM OF 72 HOURS IN ADVANCE OF BEGINNING WORK.
7. THE ENGINEER SHALL CONTACT ERIC.CAMPOS@ILLINOIS.GOV, AREA TRAFFIC FIELD ENGINEER, A MINIMUM OF TWO (2) WEEKS PRIOR TO THE PLACEMENT OF PERMANENT PAVEMENT MARKINGS.
8. PAVEMENT MARKING TAPE, TYPE IV SHALL BE USED FOR SHORT TERM PAVEMENT MARKINGS ON ALL FINAL SURFACES.
9. OVERNIGHT LANE CLOSURES SHALL NOT BE ALLOWED FOR REHABILITATION PROJECTS INVOLVING DAYTIME MILLING AND RESURFACING OPERATIONS AND CLASS D PATCHING UNLESS OTHER CONDITIONS WARRANT EXTENDED LANE CLOSURES AS DETERMINED AND APPROVED IN WRITING BY THE ENGINEER OR AS PROVIDED FOR IN THE CONTRACT SPECIFICATIONS.
10. BEFORE BEGINNING ANY WORK, THE CONTRACTOR SHALL RETAIN AND RECORD FOR FUTURE REFERENCE, ALL EXISTING PAVEMENT MARKING LINES (AND RAISED REFLECTIVE PAVEMENT MARKERS) IN ORDER THAT THESE LOCATIONS CAN BE RE-ESTABLISHED FOR STRIPING. EXACT LOCATIONS OF ALL PAVEMENT MARKINGS SHALL BE AS DIRECTED BY THE ENGINEER
11. "ROAD CONSTRUCTION AHEAD" SIGNS SHALL REMAIN INSTALLED AT LOCATIONS WHERE ROADWAY HAZARDS WITHIN THE WORK ZONE WILL REMAIN OVERNIGHT
12. TEMPORARY PAVEMENT MARKINGS OR SHORT TERM PAVEMENT MARKINGS ON INTERMEDIATE SURFACES SHALL NOT BE REMOVED, UNLESS DIRECTED BY THE ENGINEER
13. THE CONTRACTOR SHALL CONTACT THE ROADSIDE DEVELOPMENT UNIT AT (847)-705-4171 AT LEAST TWO WEEKS PRIOR TO PRUNING, MOWING, AND TREE CARE WORK SO THAT LAYOUT ASSISTANCE CAN BE PROVIDED FOR THESE ITEMS.
14. ALL PAVEMENT MARKING SHALL BE INSTALLED ACCORDING TO IDOT PM DETAIL TC-13
15. ALL RRPMS SHALL BE INSTALLED ACCORDING TO IDOT D1 RRPMS DETAIL TC-11

MODEL: Gen Note-01 [Sheet]
FILE NAME: c:\pwworking\idot\robert.torchalski@illinois.gov\d117025-shh-gennote.dgn

USER NAME = robert.torchalski	DESIGNED -	REVISED -
	DRAWN -	REVISED -
	CHECKED -	REVISED -
PLOT DATE = 2/18/2026	DATE -	REVISED -

**STATE OF ILLINOIS
DEPARTMENT OF TRANSPORTATION**

**INDEX OF SHEETS, STATE STANDARDS & GENERAL NOTES
RIDGELAND AVE (IL 1 TO END OF ROAD)**

SCALE: SHEET 1 OF 1 SHEETS STA. TO STA.

F.A.P. RTE.	SECTION	COUNTY	TOTAL SHEETS	SHEET NO.
876A	2025-1091-RS	WILL	15	2
ILLINOIS			FED. AID PROJECT	

CONTRACT NO. 80B17

SUMMARY OF QUANTITIES				TYPE CODE						
				URBAN	URBAN	URBAN	URBAN	URBAN	URBAN	
				ROADWAY						
Code No.	Item	Unit	Total Quantity	0005						
40600290	BITUMINOUS MATERIALS (TACK COAT)	POUND	3810	3810						
40600370	LONGITUDINAL JOINT SEALANT	FOOT	2809	2809						
40600400	MIXTURE FOR CRACKS, JOINTS, AND FLANGEWAYS	TON	13	13						
40600982	HOT-MIX ASPHALT SURFACE REMOVAL - BUTT JOINT	SQ YD	34	34						
40604060	HOT-MIX ASPHALT SURFACE COURSE, IL-9.5, MIX "D", N50	TON	949	949						
44000157	HOT-MIX ASPHALT SURFACE REMOVAL, 2"	SQ YD	8465	8465						
44201761	CLASS D PATCHES, TYPE I, 10 INCH	SQ YD	18	18						
44201765	CLASS D PATCHES, TYPE II, 10 INCH	SQ YD	150	150						
44201769	CLASS D PATCHES, TYPE III, 10 INCH	SQ YD	140	140						
44201771	CLASS D PATCHES, TYPE IV, 10 INCH	SQ YD	87	87						
44201811	CLASS D PATCHES, TYPE I, 14 INCH	SQ YD	4	4						
44201815	CLASS D PATCHES, TYPE II, 14 INCH	SQ YD	31	31						
44201819	CLASS D PATCHES, TYPE III, 14 INCH	SQ YD	23	23						
44201821	CLASS D PATCHES, TYPE IV, 14 INCH	SQ YD	19	19						
48102100	AGGREGATE WEDGE SHOULDER, TYPE B	TON	381	381						
67100100	MOBILIZATION	L SUM	1	1						
70100450	TRAFFIC CONTROL AND PROTECTION, STANDARD 701201	L SUM	1	1						
70100460	TRAFFIC CONTROL AND PROTECTION, STANDARD 701306	L SUM	1	1						
70300100	SHORT TERM PAVEMENT MARKING	FOOT	1592	1592						
70300150	SHORT TERM PAVEMENT MARKING REMOVAL	SQ FT	631	631						
70300221	TEMPORARY PAVEMENT MARKING - LINE 4"- PAINT	FOOT	11618	11618						
70300281	TEMPORARY PAVEMENT MARKING - LINE 24"- PAINT	FOOT	20	20						

SUMMARY OF QUANTITIES				TYPE CODE						
				URBAN	URBAN	URBAN	URBAN	URBAN	URBAN	
				ROADWAY						
Code No.	Item	Unit	Total Quantity	0005						
70307120	TEMPORARY PAVEMENT MARKING - LINE 4" - TYPE IV TAPE	FOOT	531	531						
* 78000200	THERMOPLASTIC PAVEMENT MARKING - LINE 4"	FOOT	11618	11618						
* 78000650	THERMOPLASTIC PAVEMENT MARKING - LINE 24"	FOOT	20	20						
* 78100100	RAISED REFLECTIVE PAVEMENT MARKER	EACH	88	88						
78300200	RAISED REFLECTIVE PAVEMENT MARKER REMOVAL	EACH	88	88						
K0026700	TREE CARE	EACH	3	3						
K1004595	PRUNING FOR SAFETY AND EQUIPMENT CLEARANCE	L SUM	1	1						
X2020110	GRADING AND SHAPING SHOULDERS	UNIT	57	57						
X2503110	MOWING (SPECIAL)	ACRE	0.5	0.5						
X6700407	ENGINEER'S FIELD OFFICE, TYPE A (D1)	CAL MO	6	6						
X7200061	TEMPORARY INFORMATION SIGNING	SQ FT	154.2	154.2						

* SPECIALTY ITEM

MODEL: SOQ FIXED 22426 (Sheet)
FILE NAME: c:\p\work\w\robert.torchalski@illinois.gov\117025-shh-SOQ.dgn

USER NAME = robert.torchalski	DESIGNED -	REVISED -
	DRAWN -	REVISED -
	CHECKED -	REVISED -
PLOT DATE = 2/24/2026	DATE -	REVISED -

**STATE OF ILLINOIS
DEPARTMENT OF TRANSPORTATION**

**SUMMARY OF QUANTITIES
RIDGELAND AVE (IL 1 TO END OF ROAD)**

SCALE: SHEET 1 OF 1 SHEETS STA. TO STA.

F.A.P. RTE.	SECTION	COUNTY	TOTAL SHEETS	SHEET NO.
876A	2025-1091-RS	WILL	15	3
CONTRACT NO. 80B17				
ILLINOIS FED. AID PROJECT				

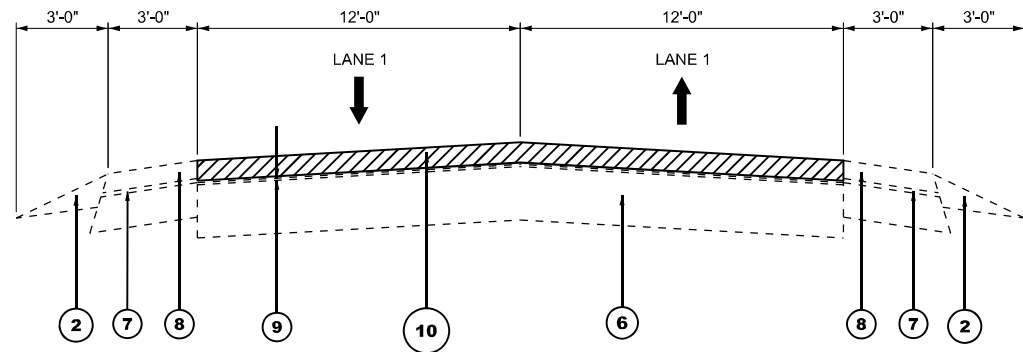

EXISTING TYPICAL SECTION

STA 10+00 TO STA 32+57

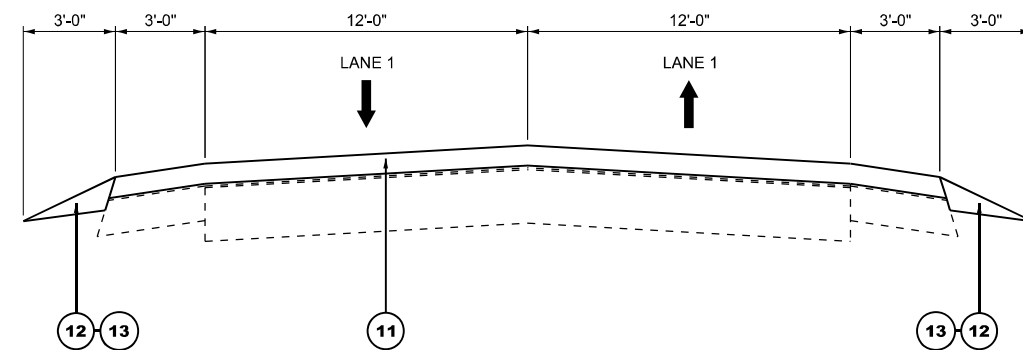

PROPOSED TYPICAL SECTION

STA 10+00 TO STA 32+57

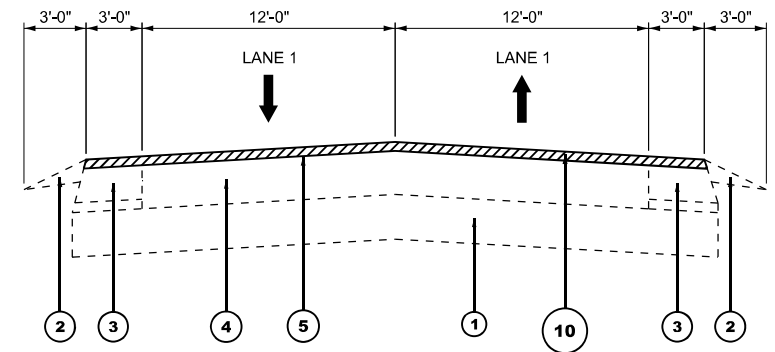

EXISTING TYPICAL SECTION

STA 32+57 TO STA 38+09

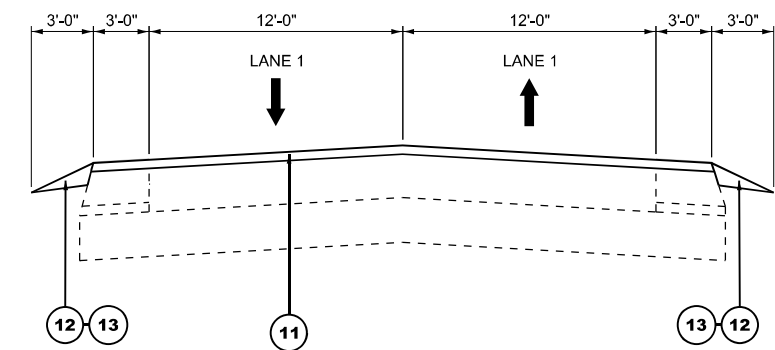

PROPOSED TYPICAL SECTION

STA 32+57 TO STA 38+09

LEGEND

- ① EXIST. AGGREGATE SUBGRADE, (12")
- ② EXIST. AGGREGATE WEDGE, TYPE B
- ③ EXIST. HMA SHOULDERS, (11")
- ④ EXIST. HMA BINDER COURSE (13½")
- ⑤ EXIST. HMA SURFACE COURSE (2")
- ⑥ EXIST. PCC PAVEMENT (9")
- ⑦ EXIST. LEVELING BINDER, IL-19, N70, (¾")
- ⑧ EXIST HMA SURFACE COURSE (1½")
- ⑨ EXIST HMA OVERLAY (¼")
- ⑩ PROPOSED HMA SURFACE REMOVAL 2"
- ⑪ PROPOSED HMA SURFACE COURSE MIX D, IL-9.5, N50, (2")
- ⑫ PROPOSED AGGREGATE WEDGE SHOULDER, TYPE B
- ⑬ PROPOSED GRADING AND SHAPING SHOULDERS

NOTES

1. THE CONTRACTOR SHALL MILL BEFORE PATCHING
2. THE UNIT WEIGHT USED TO CALCULATE ALL HMA SURFACE MIXTURE QUANTITIES IS 112 LBS/SQ YD/IN
3. THE "AC TYPE" FOR POLYMERIZED HMA MIXES SHALL BE "SBS/SBR PG 76-22" AND FOR NON-POLYMERIZED HMA THE "AC TYPE" SHALL BE "PG 64-22" UNLESS MODIFIED BY RECLAIMED MATERIALS SPECIFICATIONS
4. LONGITUDINAL JOINT SEALANT SHALL BE PLACED OVER THE MILLED SURFACE

HOT-MIX ASPHALT MIXTURE REQUIREMENTS

MIXTURE TYPE	AIR VOIDS @ Ndesign	QMP
PAVEMENT RESURFACING (SMART OVERLAY)		
HOT-MIX ASPHALT SURFACE COURSE, IL-9.5, MIX "D", N50, 2"	4% @ 50 Gyr.	QC/QA
PATCHING		
CLASS D PATCHES (HMA BINDER IL-19.0)	4% @ 50 Gyr.	QC/QA
QMP Designations: Quality Control/Quality Assurance (QC/QA); Quality Control for Performance (QCP); Pay for Performance (PFP)		

MODEL: TFS 2 (Sheet)
FILE NAME: c:\p\work\1\robert.torchalski@illinois.gov\1132528\117025-shh-typical.dgn

USER NAME = robert.torchalski	DESIGNED -	REVISED -
	DRAWN -	REVISED -
	CHECKED -	REVISED -
PLOT DATE = 2/24/2026	DATE -	REVISED -

**STATE OF ILLINOIS
DEPARTMENT OF TRANSPORTATION**

**EXISTING AND PROPOSED TYPICAL SECTIONS
RIDGELAND AVE (IL 1 TO END OF ROAD)**

SCALE: SHEET 1 OF 1 SHEETS STA. TO STA.

F.A.P. RTE. 876A	SECTION 2025-1091-RS	COUNTY WILL	TOTAL SHEETS 15	SHEET NO. 4
CONTRACT NO. 80B17				
ILLINOIS FED. AID PROJECT				

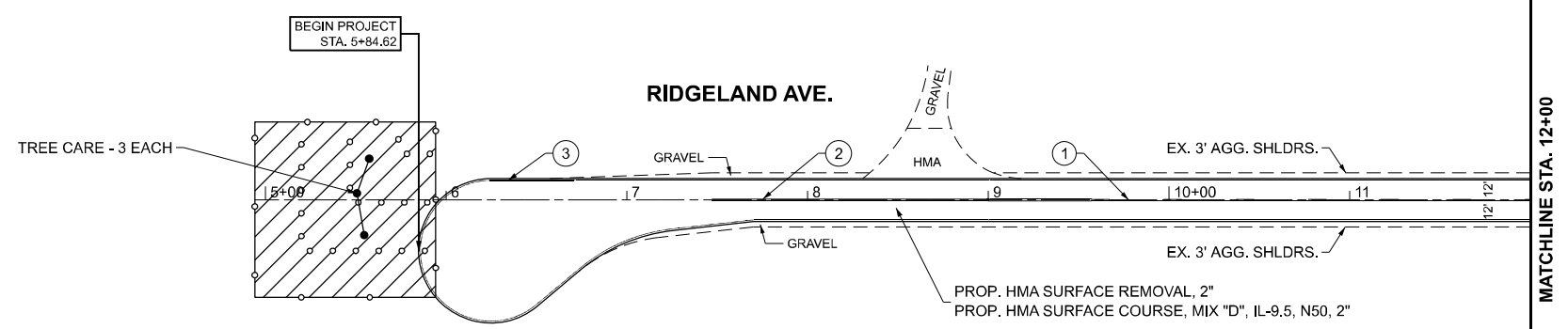
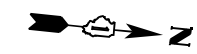

- | | | | |
|---|--|---|--|
| ① | PROP. THERMOPLASTIC PVMT MARKING 4", SOLID NO PASSING ZONE LINE FOR ONE DIRECTION, 5 1/2" C-C FROM SKIP-DASH CENTERLINE, YELLOW (TYP.) | ③ | PROP. THERMOPLASTIC PVMT MARKING 4", EDGELINE, WHITE (TYP.) |
| ② | PROP. THERMOPLASTIC PVMT MARKING 4", DOUBLE YELLOW @ 11" C-C (TYP.) | ④ | PROP. THERMOPLASTIC PVMT MARKING LINE, 24" STOPBAR, WHITE (TYP.) |
| | | | MOWING (SPECIAL) |

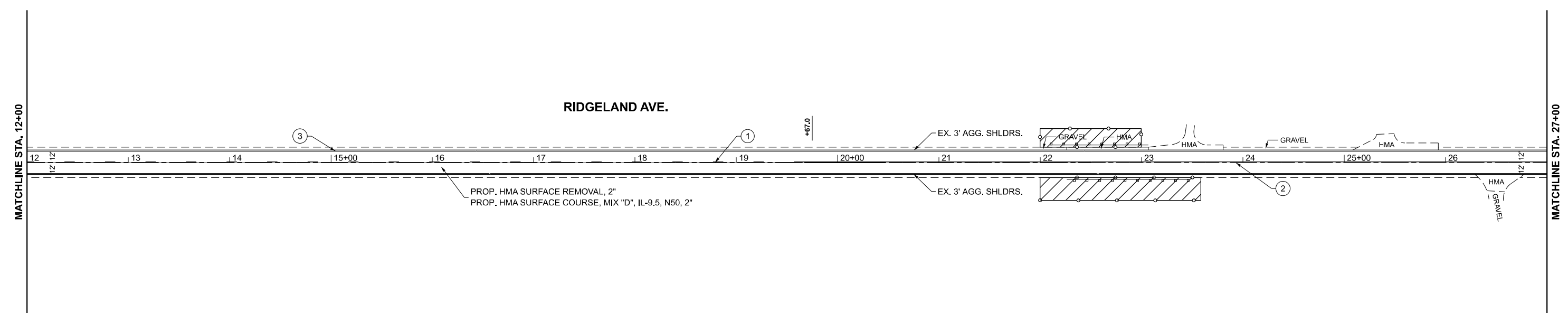

MODEL: RidgelandAve_E - Rdwy Plan 1 (Sheet)
 FILE NAME: c:\p\work\117025-shh-plan.dgn

USER NAME = robert.torchalski	DESIGNED -	REVISED -
	DRAWN -	REVISED -
	CHECKED -	REVISED -
PLOT DATE = 3/3/2026	DATE -	REVISED -

**STATE OF ILLINOIS
DEPARTMENT OF TRANSPORTATION**

**ROADWAY PLAN
RIDGELAND AVE (IL 1 TO END OF ROAD)**

SCALE: 1"=50' SHEET 1 OF 2 SHEETS STA. 0+00.00 TO STA. 30+00.00

F.A.P. RTE.	SECTION	COUNTY	TOTAL SHEETS	SHEET NO.
876A	2025-1091-RS	WILL	15	5
CONTRACT NO. 80B17			ILLINOIS FED. AID PROJECT	



MATCHLINE STA. 27+00

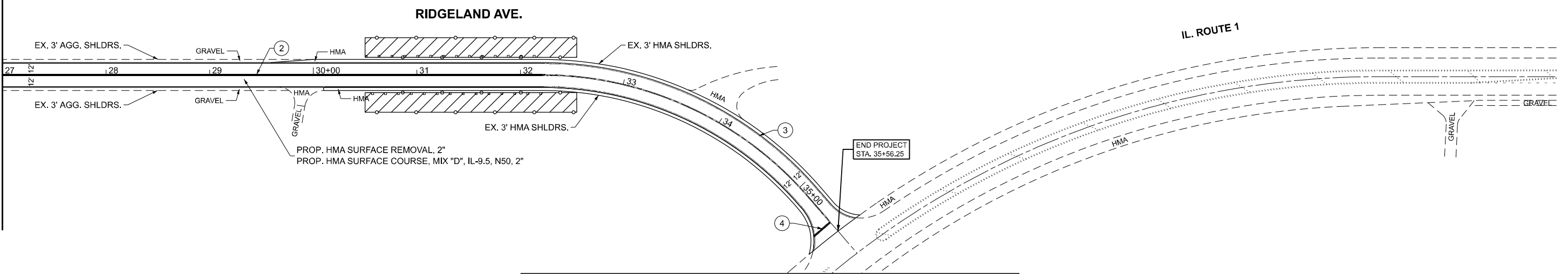

- | | | | |
|---|--|---|--|
| ① | PROP. THERMOPLASTIC PVTM MARKING 4", SOLID NO PASSING ZONE LINE FOR ONE DIRECTION, 5 1/2" C-C FROM SKIP-DASH CENTERLINE, YELLOW (TYP.) | ③ | PROP. THERMOPLASTIC PVTM MARKING 4", EDGELINE, WHITE (TYP.) |
| ② | PROP. THERMOPLASTIC PVTM MARKING 4", DOUBLE YELLOW @ 11" C-C (TYP.) | ④ | PROP. THERMOPLASTIC PVTM MARKING LINE, 24" STOPBAR, WHITE (TYP.) |
| | | | MOWING (SPECIAL) |

MODEL: RidgelandAve_E - Rdwy Plan 3 (Sheet)
FILE NAME: c:\p\work\1217\1217025-shh-plan.dgn

USER NAME = robert.torchalski	DESIGNED -	REVISED -
	DRAWN -	REVISED -
	CHECKED -	REVISED -
PLOT DATE = 3/3/2026	DATE -	REVISED -

**STATE OF ILLINOIS
DEPARTMENT OF TRANSPORTATION**

ROADWAY PLAN RIDGELAND AVE (IL 1 TO END OF ROAD)			
SCALE: 1"=50'	SHEET 2	OF 2 SHEETS	STA. 30+00.00 TO STA. 45+00.00

F.A.P. RTE.	SECTION	COUNTY	TOTAL SHEETS	SHEET NO.
876A	2025-1091-RS	WILL	15	6
CONTRACT NO. 80B17				
ILLINOIS FED. AID PROJECT				

METHOD OF MEASUREMENT

REFER TO SECTION 442 OF THE STANDARD SPECIFICATIONS FOR ROAD AND BRIDGE CONSTRUCTION AND THE RECURRING SPECIAL PROVISION "PATCHING WITH HOT-MIX ASPHALT OVERLAY REMOVAL."

BASIS OF PAYMENT

1. REFER TO SECTION 442 OF THE STANDARD SPECIFICATIONS FOR ROAD AND BRIDGE CONSTRUCTION AND THE RECURRING SPECIAL PROVISION "PATCHING WITH HOT-MIX ASPHALT OVERLAY REMOVAL."
2. SAW CUT/SCORING OF EXISTING HMA OVERLAY IS INCLUDED IN THE COST OF PAVEMENT PATCHING.
3. SAW CUT/SCORING OF EXISTING PAVEMENT IS INCLUDED IN THE COST OF PAVEMENT PATCHING.

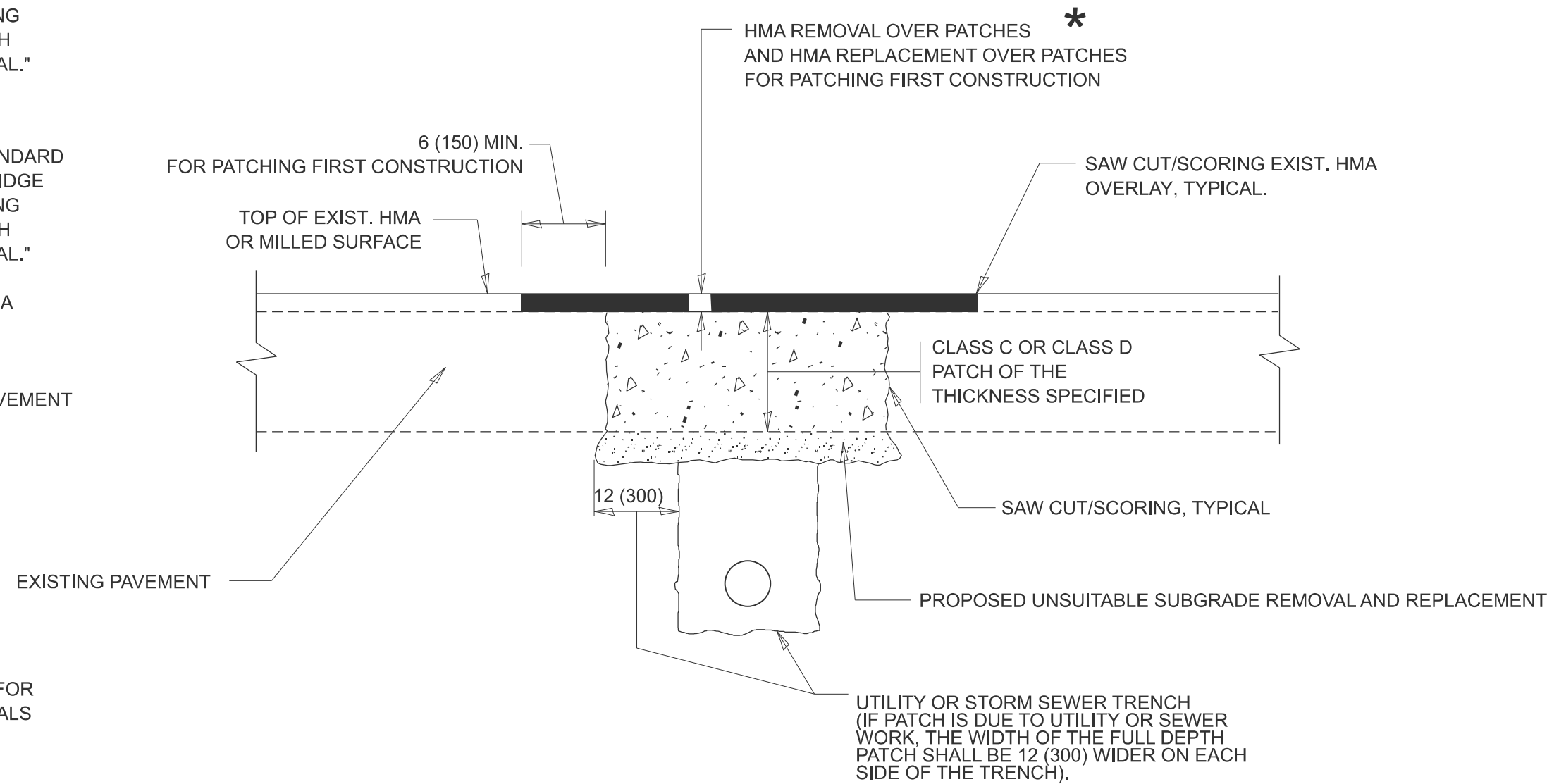

* SEE TYPICAL SECTIONS FOR THICKNESS AND MATERIALS

SEQUENCE OF CONSTRUCTION (PATCHING FIRST)

1. REMOVE THE EXISTING HMA MATERIAL OVER THE AREA TO BE PATCHED.
2. REMOVE AND REPLACE WITH CLASS C OR D PATCH.
3. REPLACE HMA MATERIAL OVER THE AREA TO BE PATCHED.

SEQUENCE OF CONSTRUCTION (MILLING FIRST)

1. MILL HMA FIRST IF THERE IS AT LEAST 4 ½ INCHES OR MORE OF HMA MATERIAL ON TOP OF THE EXISTING PAVEMENT OR IF THE PAVEMENT IS FULL DEPTH HMA. A MINIMUM OF 2 INCHES OF HMA MATERIAL SHALL BE IN PLACE AFTER MILLING.
2. REMOVE AND REPLACE WITH FULL DEPTH CLASS D PATCHES TO TOP OF MILLED SURFACE.

ALL DIMENSIONS ARE IN INCHES (MILLIMETERS) UNLESS OTHERWISE SHOWN.

MODEL: Plan Single (Sheet)
FILE NAME: Z:\DOT\CAD_ORD\Folder_Master\Master_Files\DOT_CONFIGURATION\Organization-Civil\DOT_Standards\Digital\Sheet_Seeds\Civil_Named_Boundary_SheetSeeds.dgn

USER NAME = Eric.L.thomas	DESIGNED - R. SHAH	REVISED - R. BORO 01-01-07
	DRAWN -	REVISED - R. BORO 09-04-07
	CHECKED -	REVISED - K. ENG 10-27-08
PLOT DATE = 12/2/2024	DATE - 10-25-94	REVISED - K. SMITH 11-18-22

STATE OF ILLINOIS
DEPARTMENT OF TRANSPORTATION

PAVEMENT PATCHING FOR
HMA SURFACED PAVEMENT

SCALE: NONE SHEET 1 OF 1 SHEETS STA. TO STA.

F.A.P. RTE.	SECTION	COUNTY	TOTAL SHEETS	SHEET NO.
876A	2025-1091-RS	WILL	15	7
BD400-04 (BD-22)			CONTRACT NO. 80B17	
ILLINOIS FED. AID PROJECT				

MODEL: Plan Single (Sheet)
 FILE NAME: Z:\DOT\CAD_ORD Folder Master\Master Files\DOT_CONFIGURATION\Organization-Civil\DOT_Standards\Drawings\Sheet Seeds\Civil_Named_Boundary_SheetSeeds.dgnlib

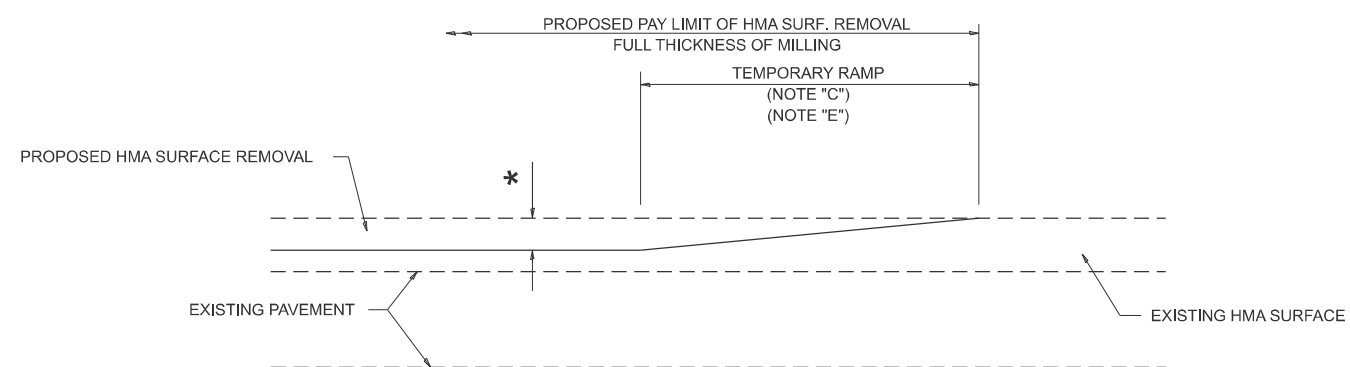

MILLED TEMPORARY RAMP

(FOR BUTT JOINT AND HMA TAPER SEE DETAIL BELOW)

OPTION 1

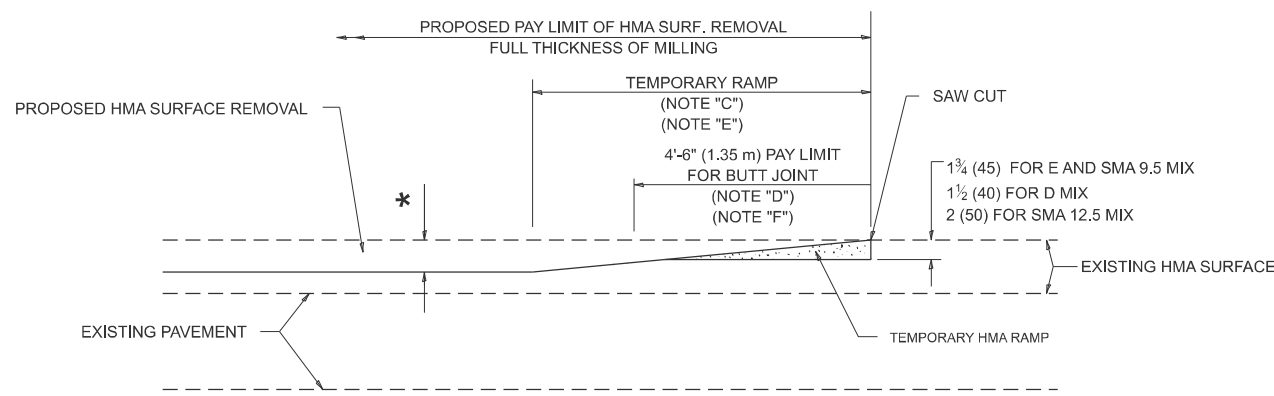

HMA CONSTRUCTED TEMPORARY RAMP

(FOR BUTT JOINT AND HMA TAPER SEE DETAIL BELOW)

OPTION 2

TYPICAL TEMPORARY RAMP

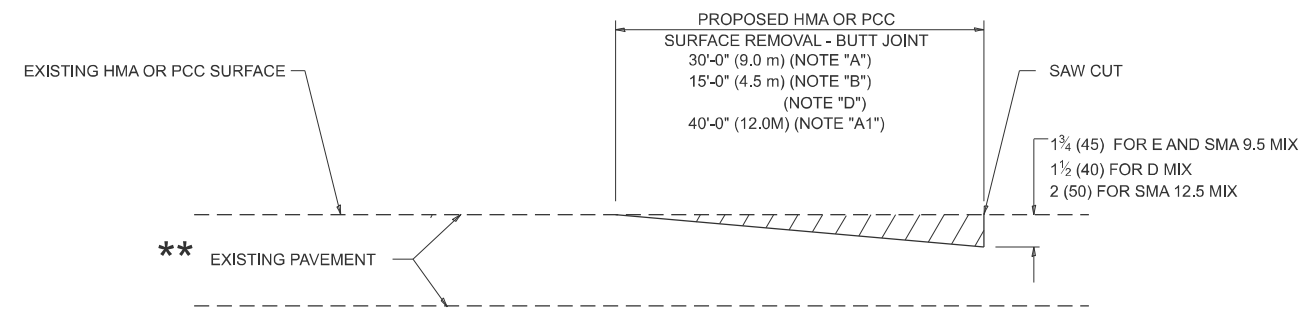

BUTT JOINT DETAIL

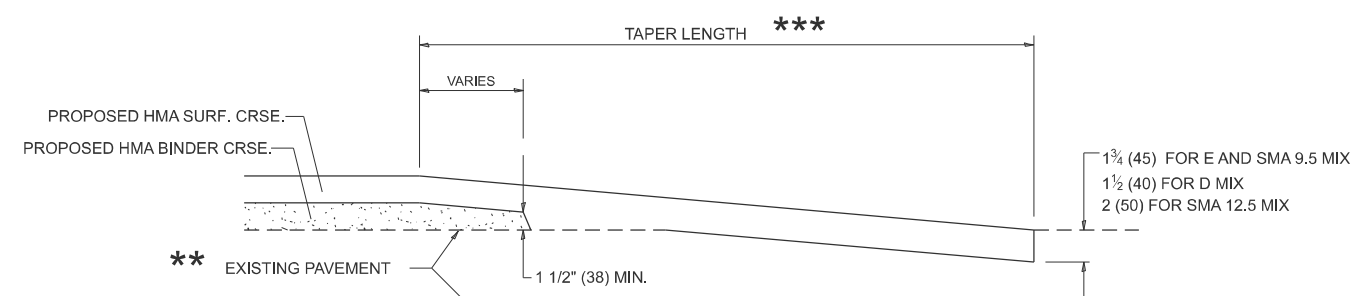

HMA TAPER DETAIL

TYPICAL BUTT JOINT AND HMA TAPER FOR RESURFACING ONLY

** PC CONCRETE, HMA OR HMA RESURFACED PAVEMENT.

GENERAL NOTES

- A. MAINLINE ARTERIAL ROADWAYS AND MAJOR SIDE ROADS.
- A1. INTERSTATES
- B. MINOR SIDE ROADS.
- C. THE TEMP. RAMP SHALL BE CONSTRUCTED IMMEDIATELY UPON REMOVAL OF THE EXISTING HMA SURFACE.
- D. THE BUTT JOINT SHALL BE CONSTRUCTED IMMEDIATELY PRIOR TO PLACING THE PROPOSED HMA COURSES.
- E. TAPER THE TEMP. RAMP AT A RATE OF 3' - 4" (1.02m) PER 1 INCH (25 mm) OF MILLING THICKNESS.
* SEE TYPICAL SECTIONS FOR MILLING THICKNESS.
- F. SEE ARTICLE 406.08 AND 406.14 OF THE STANDARD SPECIFICATIONS FOR "HMA AND/OR PCC SURFACE REMOVAL, BUTT JOINT".

20'-0" (6.1 m) PER 1 (25) RESURFACING (NOTE "A")
10'-0" (3.0 m) PER 1 (25) RESURFACING (NOTE "B")

BASIS OF PAYMENT

- 1. THE BUTT JOINT WILL BE PAID FOR AT THE CONTRACT UNIT PRICE PER SQUARE YARD (SQUARE METER) FOR "HOT-MIX ASPHALT SURFACE REMOVAL - BUTT JOINT" OR FOR "PORTLAND CEMENT CONCRETE SURFACE REMOVAL - BUTT JOINT".
- 2. THE TEMPORARY RAMP AND SAW CUT SHALL BE INCLUDED IN THE UNIT COST FOR HMA OR PCC SURFACE REMOVAL-BUTT JOINT.

ALL DIMENSIONS ARE IN INCHES (MILLIMETERS) UNLESS OTHERWISE SHOWN.

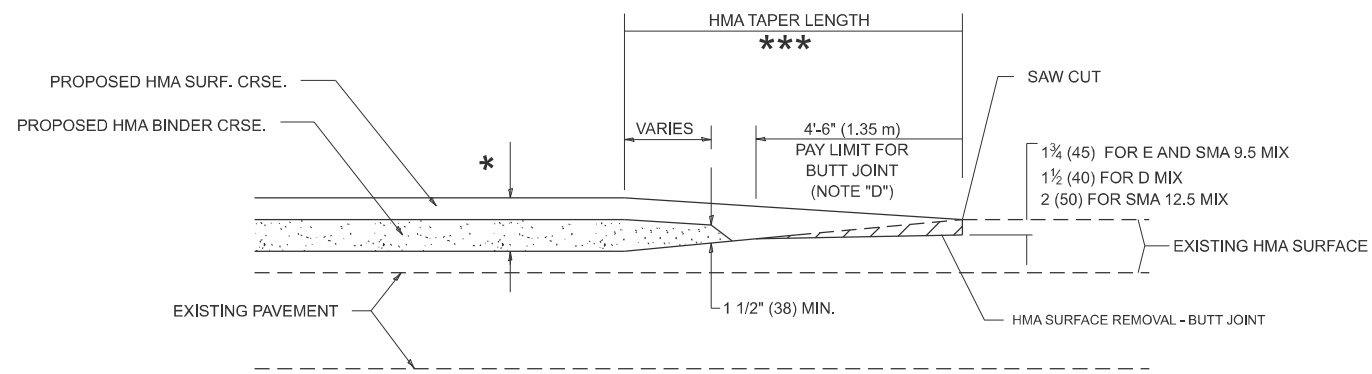

BUTT JOINT AND HMA TAPER

TYPICAL BUTT JOINT AND HMA TAPER FOR MILLING AND RESURFACING

USER NAME = Eric.L.Thomas	DESIGNED - M. DE YONG	REVISED - A. ABBAS 03-21-97
	DRAWN -	REVISED - M. GOMEZ 04-06-01
	CHECKED -	REVISED - R. BORO 01-01-07
PLOT DATE = 12/2/2024	DATE - 06-13-90	REVISED - K. SMITH 11-18-22

STATE OF ILLINOIS
DEPARTMENT OF TRANSPORTATION

BUTT JOINT AND HMA TAPER DETAILS

SCALE: NONE SHEET 1 OF 1 SHEETS STA. TO STA.

F.A.P RTE.	SECTION	COUNTY	TOTAL SHEETS	SHEET NO.
876A	2025-1091-RS	WILL	15	8
BD400-05 BD-32		CONTRACT NO. 80B17		
ILLINOIS FED. AID PROJECT				

MODEL: Plan Single (Sheet)
 FILE NAME: Z:\DOT\CAD_ORD\Folder_Master\Master_Files\DOT_CONFIGURATION\Organization-Civil\DOT_Standards\Drawings\Sheet_Seeds\Civil_Named_Boundary_SheetSeeds.dgn\lib

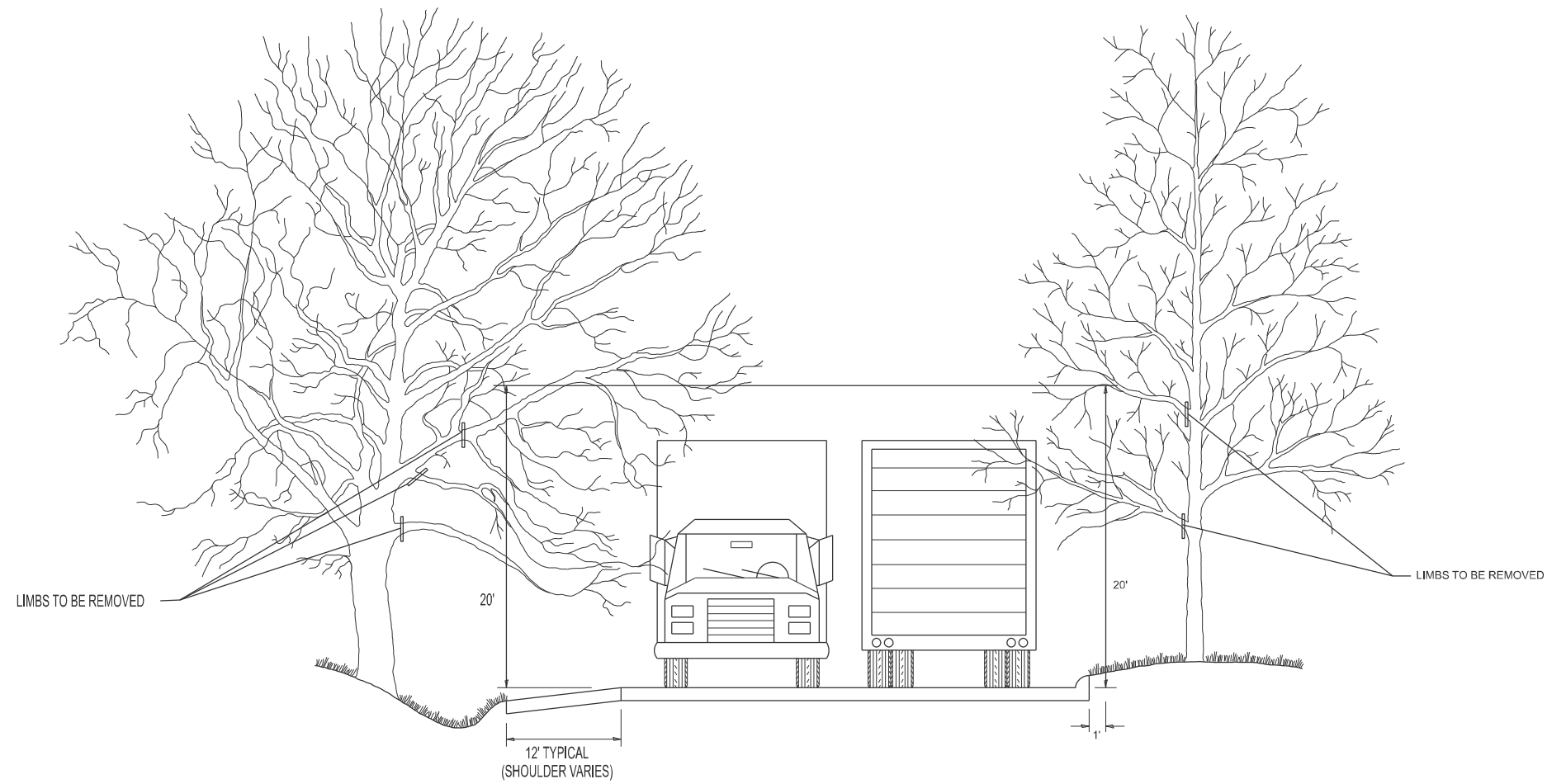

USER NAME = Eric.L.thomas	DESIGNED -	REVISED - R. BORO 10-31-06
	DRAWN -	REVISED -
	CHECKED -	REVISED -
PLOT DATE = 12/2/2024	DATE -	REVISED -

**STATE OF ILLINOIS
 DEPARTMENT OF TRANSPORTATION**

**PRUNING FOR SAFETY AND
 EQUIPMENT CLEARANCE**

SCALE: NONE SHEET 1 OF 1 SHEETS STA. TO STA.

F.A.P. RTE.	SECTION	COUNTY	TOTAL SHEETS	SHEET NO.
876A	2025-1091-RS	WILL	15	9
BM-20		CONTRACT NO. 80B17		
ILLINOIS FED. AID PROJECT				

MODEL: Plan Single (Sheet)
 FILE NAME: Z:\DOT\CAD_ORD\Folder_Master\Master_Files\DOT_CONFIGURATION\Organization-Civil\DOT_Standards\Digital\Sheet_Seeds\Civil_Named_Boundary_SheetSeeds.dgnlib

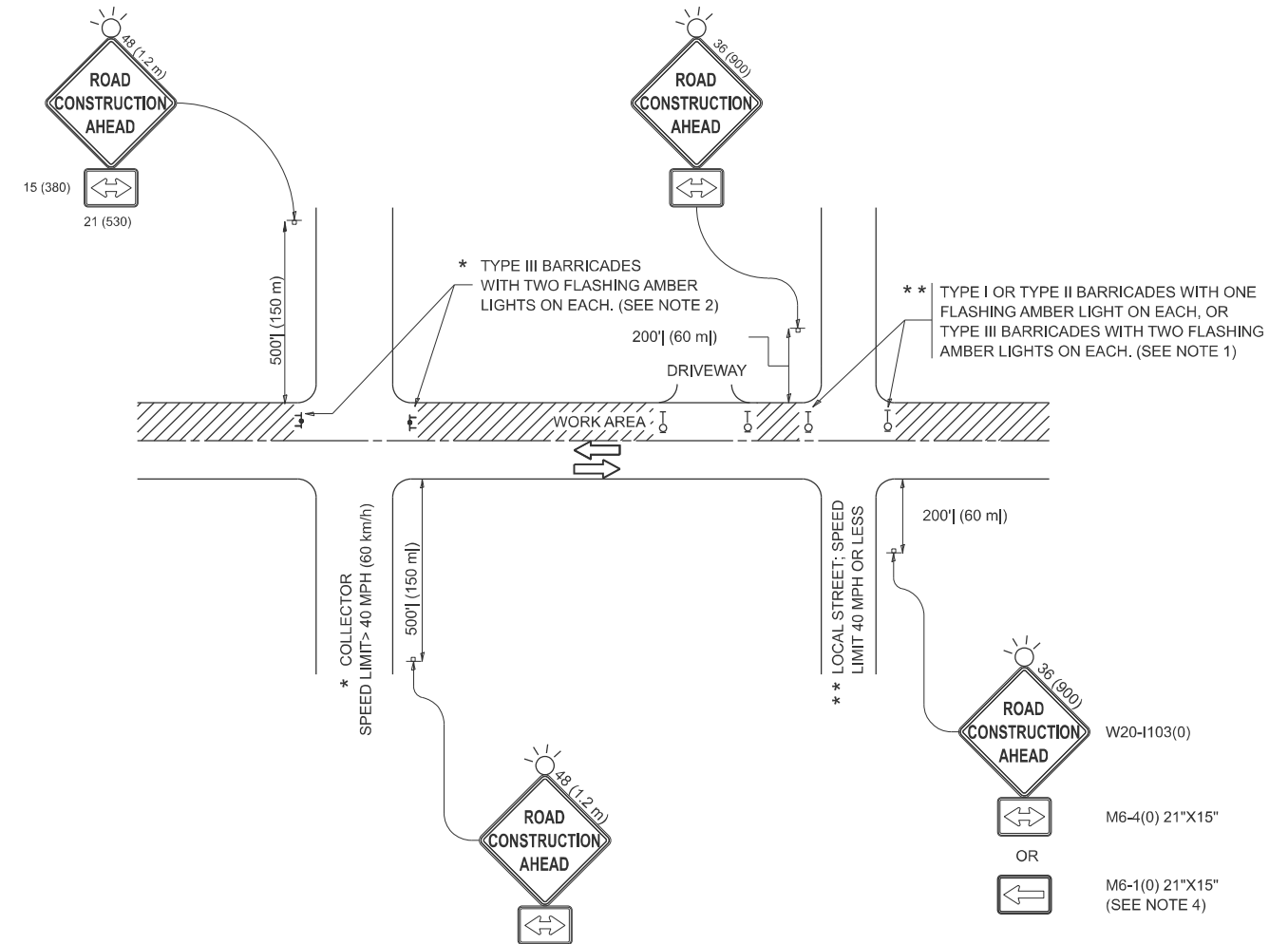

NOTES:

- SIDE ROAD WITH A SPEED LIMIT OF 40 MPH (60 km/h) OR LESS AS SHOWN ON THE DRAWING AND AS DIRECTED BY THE ENGINEER:
 - ONE "ROAD CONSTRUCTION AHEAD" SIGN 36 x 36 (900x900) WITH A FLASHER MOUNTED ON IT APPROXIMATELY 200' (60 m) IN ADVANCE OF THE MAIN ROUTE.
 - THE CLOSED PORTION OF THE MAIN ROUTE SHALL BE PROTECTED BY BLOCKING WITH TYPE I, TYPE II OR TYPE III BARRICADES, 1/3 OF THE CROSS SECTION OF THE CLOSED PORTION.
- SIDE ROAD WITH A SPEED LIMIT GREATER THAN 40 MPH (60 km/h) AS SHOWN ON THE DRAWING AND AS DIRECTED BY THE ENGINEER:
 - ONE "ROAD CONSTRUCTION AHEAD" SIGN 48 x 48 (1.2 m x 1.2 m) WITH A FLASHER MOUNTED ON IT APPROXIMATELY 500' (150 m) IN ADVANCE OF THE MAIN ROUTE.
 - THE CLOSED PORTION OF THE MAIN ROUTE SHALL BE PROTECTED BY BLOCKING WITH TYPE III BARRICADES, 1/2 OF THE CROSS SECTION OF THE CLOSED PORTION.
- CONES MAY BE SUBSTITUTED FOR BARRICADES OR DRUMS AT HALF THE SPACING DURING DAY OPERATIONS. CONES SHALL BE A MINIMUM OF 28 (710) IN HEIGHT.
- WHEN THE SIDE ROAD LIES BETWEEN THE BEGINNING OF THE MAINLINE SIGNING AND THE WORK ZONE, A SINGLE HEADED ARROW (M6-1) SHALL BE USED IN LIEU OF THE DOUBLE HEADED ARROW (M6-4).
- WHEN WORK IS BEING PERFORMED ON A SIDE ROAD OR DRIVEWAY, FOLLOW THE APPLICABLE STANDARD(S). THE DIRECTIONAL ARROW (M6-1 OR M6-4) SHALL BE COVERED OR REMOVED WHEN NO LONGER CONSISTENT WITH THE TRAFFIC CONTROL SET-UP.
- ADVANCE WARNING SIGNS ARE TO BE OMITTED ON DRIVEWAYS UNLESS OTHERWISE SPECIFIED IN THE PLANS OR BY THE ENGINEER.
- THE TRAFFIC CONTROL AND PROTECTION FOR SIDE ROADS, INTERSECTIONS, AND DRIVEWAYS SHALL BE INCLUDED IN THE COST OF SPECIFIED TRAFFIC CONTROL STANDARDS OR ITEMS.

All dimensions are in inches (millimeters) unless otherwise shown.

USER NAME = Eric.L.thomas	DESIGNED - L.H.A.	REVISED - T. RAMMACHER 01-06-00
	DRAWN -	REVISED - A. SCHUETZE 07-01-13
	CHECKED -	REVISED - A. SCHUETZE 09-15-06
PLOT DATE = 12/2/2024	DATE - 06-89	REVISED - D. SENDERAK 05-03-24

**STATE OF ILLINOIS
 DEPARTMENT OF TRANSPORTATION**

**TRAFFIC CONTROL AND PROTECTION FOR
 SIDE ROADS, INTERSECTIONS, AND DRIVEWAYS**

SCALE: SHEET OF SHEETS STA. TO STA.

F.A.P. RTE.	SECTION	COUNTY	TOTAL SHEETS	SHEET NO.
876A	2025-1091-RS	876A	15	10
TC-10			CONTRACT NO. 80B17	
ILLINOIS FED. AID PROJECT				

MODEL: Plan Single (Sheet)
 FILE NAME: Z:\DOT\CAD_ORD Folder\Master Files\DOT_CONFIGURATION\Organization-Civil\IDOT_Standards\Drawings\Sheet Seeds\Civil_Boundary_SheetSeeds.dgn

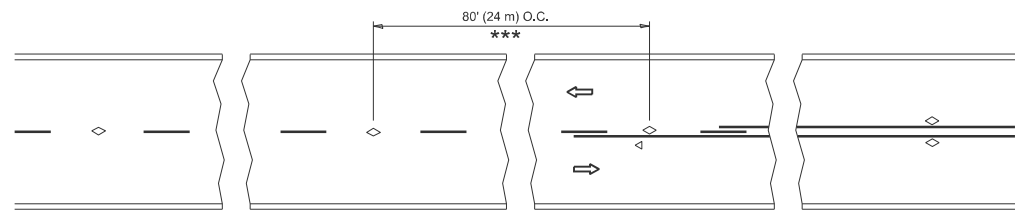

*** REDUCE TO 40' (12 m) O.C. ON CURVES WITH POSTED OR ADVISORY SPEED 45 M.P.H. (70 km/h) OR LESS.

TWO-LANE/TWO-WAY

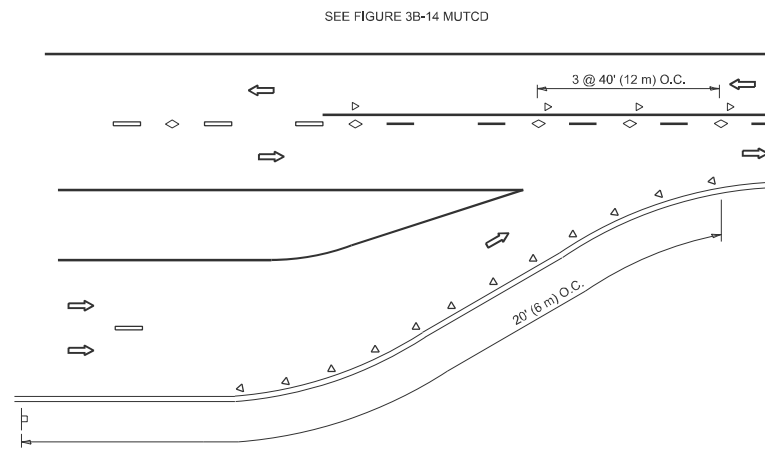

LANE REDUCTION TRANSITION

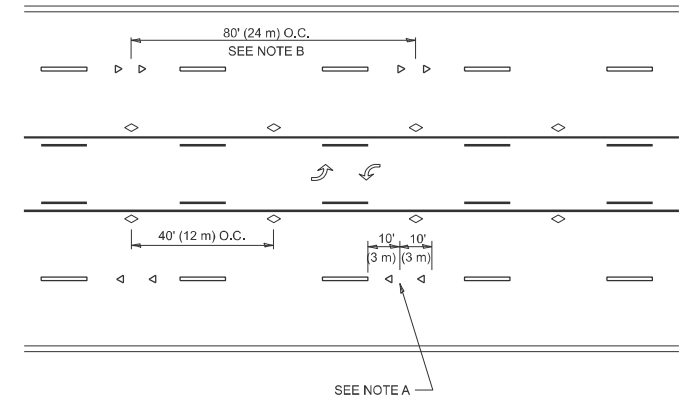

TWO-WAY LEFT TURN

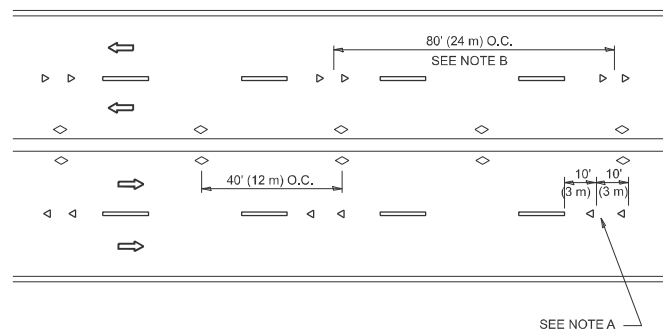

MULTI-LANE/UNDIVIDED

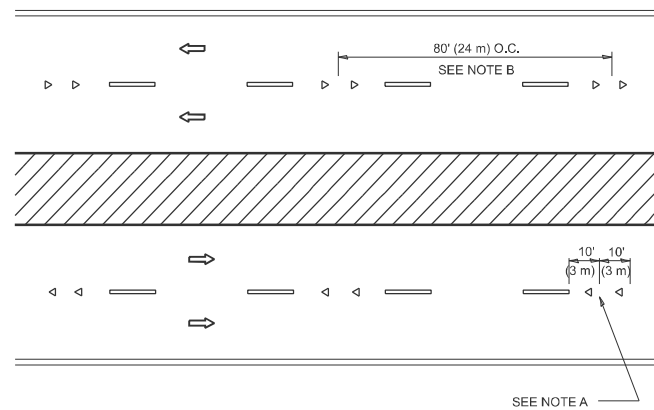

MULTI-LANE/DIVIDED

GENERAL NOTES

1. MARKERS USED WITH DASHED LINES SHALL BE CENTERED IN THE GAP BETWEEN SEGMENTS.
2. MARKERS USED ADJACENT TO SOLID LINES SHALL BE OFFSET 2 TO 3 (50 TO 75) TOWARD TRAFFIC AS SHOWN.
3. MARKERS THROUGH TANGENTS LESS THAN 500' (150 m) IN LENGTH BETWEEN CURVES SHALL BE INSTALLED AT THE LESSER OF THE TWO CURVE SPACINGS.
4. MARKERS ARE TO BE USED ADJACENT TO BOTH SOLID WHITE LINES IN DUAL LEFT TURN LANES

SYMBOLS

- YELLOW STRIPE
- WHITE STRIPE
- ◁ ONE-WAY AMBER MARKER
- ◁ ONE-WAY CRYSTAL MARKER (W/O)
- ◇ TWO-WAY AMBER MARKER

LANE MARKER NOTES

- A. USE DOUBLE LANE LINE MARKERS SPACED AS SHOWN.
- B. REDUCE TO 40' (12 m) O.C. ON CURVES WHERE ADVISORY SPEEDS ARE 10 M.P.H (20 km/h) LOWER THAN POSTED SPEEDS.

DESIGN NOTES

1. DOUBLE LANE LINE MARKERS SHALL BE USED UNLESS SPECIFIED OTHERWISE.
2. EXCEPT AS SHOWN ON THE LANE REDUCTION TRANSITION AND FREEWAY EXIT RAMP DETAIL, MARKERS ARE NOT TO BE SPECIFIED ON RIGHT EDGE LINES.
3. THE EXACT MARKER LIMITS, SPACING, AND COLOR SHALL BE INCLUDED IN THE PLANS WHEN STANDARD SPECIFICATIONS ARE NOT BEING USED.
4. MARKERS SHOULD NOT BE USED ALONGSIDE CURBS EXCEPT FOR EXTREMELY SHORT SECTIONS OF CURBS WHERE NOT MORE THAN TWO MARKERS WOULD BE INVOLVED.

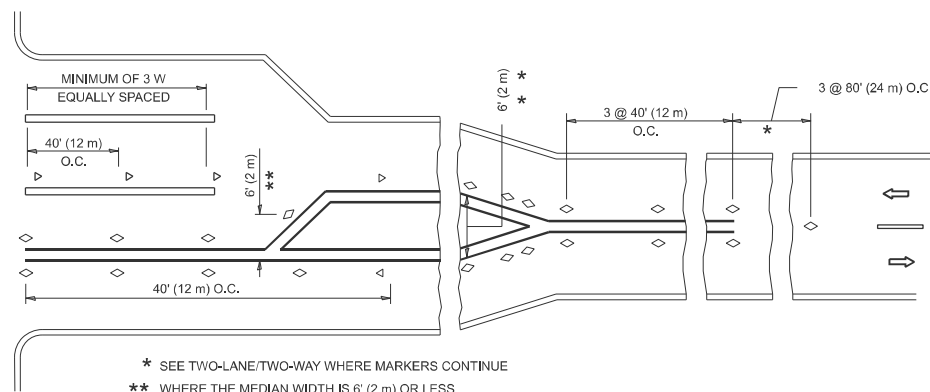
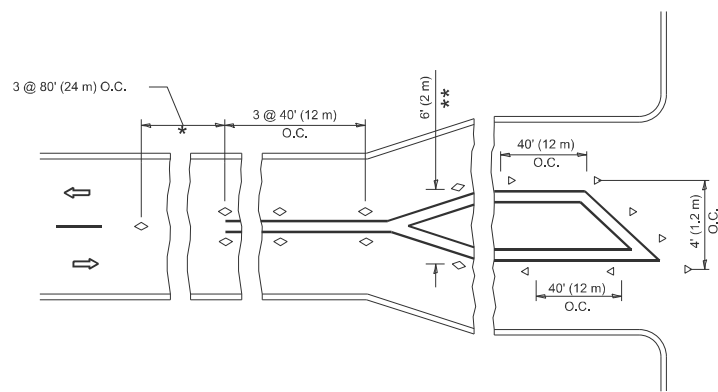

TURN LANES

- * SEE TWO-LANE/TWO-WAY WHERE MARKERS CONTINUE
- ** WHERE THE MEDIAN WIDTH IS 6' (2 m) OR LESS USE TWO-WAY MARKERS.

All dimensions are in inches (millimeters) unless otherwise shown.

USER NAME = Eric.L.thomas	DESIGNED -	REVISED - T. RAMMACHER 03-12-99
	DRAWN -	REVISED - T. RAMMACHER 01-06-00
	CHECKED -	REVISED - C. JUCIUS 09-09-09
PLOT DATE = 12/2/2024	DATE -	REVISED - C. JUCIUS 07-01-13

STATE OF ILLINOIS
 DEPARTMENT OF TRANSPORTATION

TYPICAL APPLICATIONS
 RAISED REFLECTIVE PAVEMENT MARKERS (SNOW-PLOW RESISTANT)

SCALE: NONE SHEET 1 OF 1 SHEETS STA. TO STA.

F.A.P. RTE.	SECTION	COUNTY	TOTAL SHEETS	SHEET NO.
876A	2025-1091-RS	WILL	15	11
TC-11			CONTRACT NO. 80B17	
ILLINOIS FED. AID PROJECT				

MODEL: Plan Single (Sheet)
 FILE NAME: Z:\DOT\CAD_ORD Folder Master\Master Files\DOT_CONFIGURATION\Organization-Civil\DOT_Standards\Digital\Sheet Seeds\Civil_Boundary_Sheets\Seeds.dgn

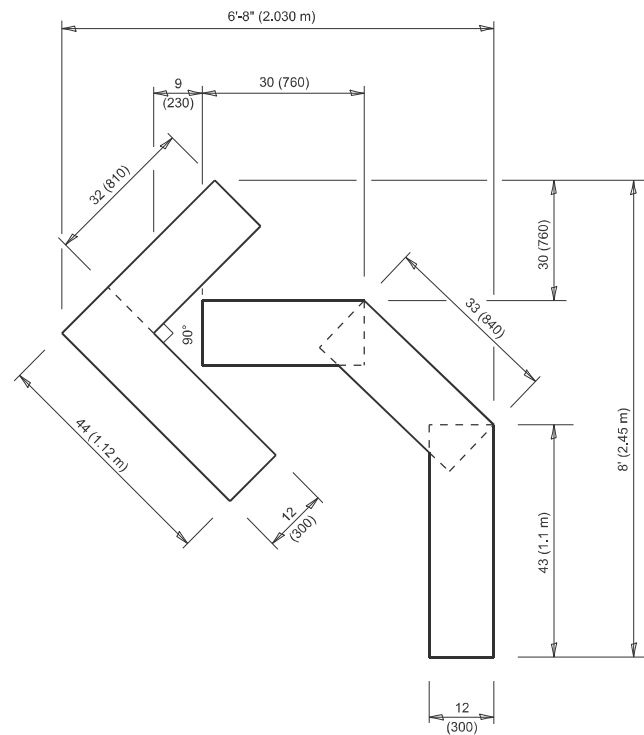

QUANTITY

4 (100) LINE = 45.5 ft. (13.9 m)
 15.2 sq. ft. (1.41 sq. m)

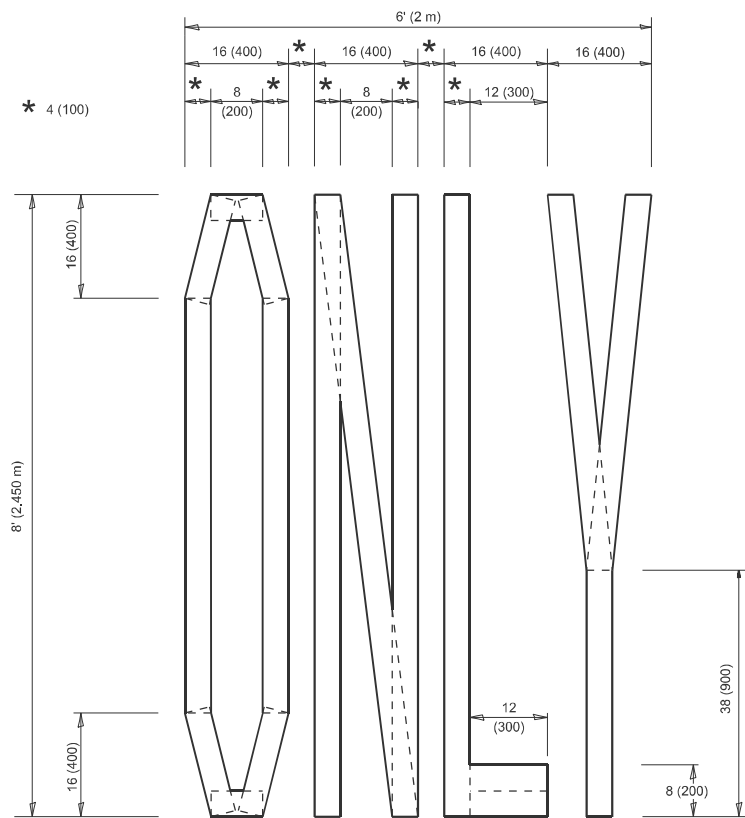

QUANTITY

4 (100) LINE = 64.1 ft. (19.5 m)
 21.4 sq. ft. (1.99 sq. m)

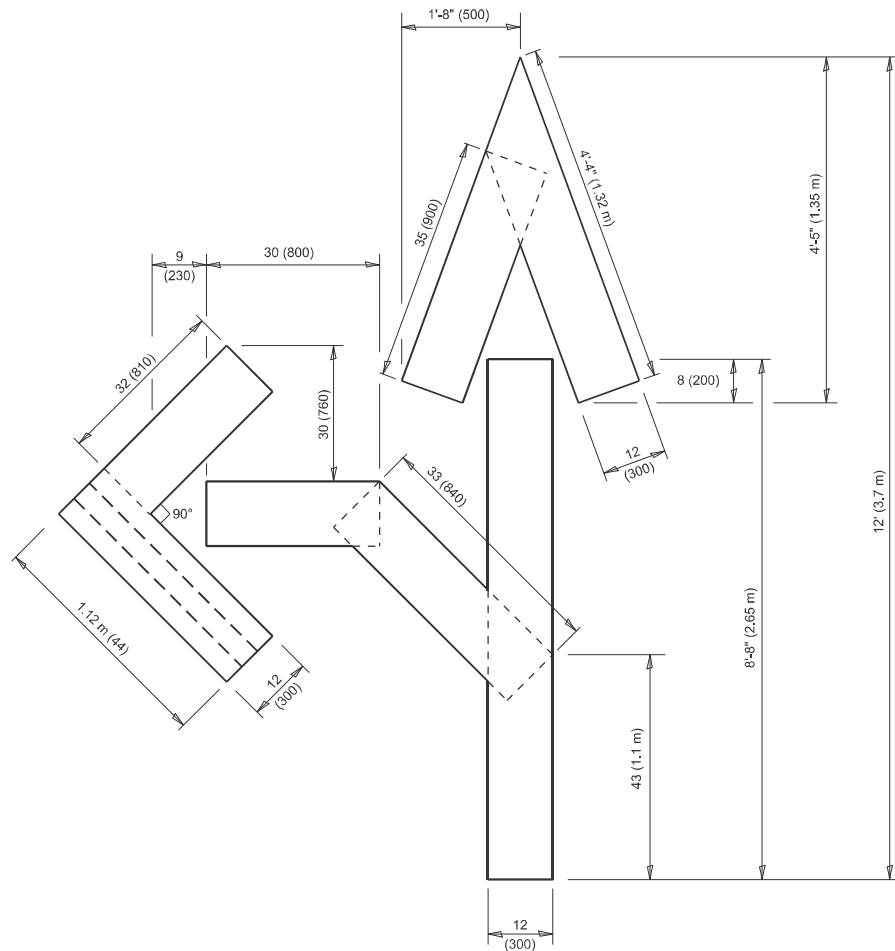

QUANTITY

4 (100) LINE = 82.5 ft. (25.1 m)
 27.5 sq. ft. (2.53 sq. m)

NOTE:

ALL QUANTITIES OF PLACEMENT ARE REPRESENTED IN LINEAR FEET OF 4" LINES TO MATCH THE 4" TEMPORARY TAPE PAY ITEM AND REPRESENTS THE TOTAL QUANTITY OF 4" TAPE REQUIRED.

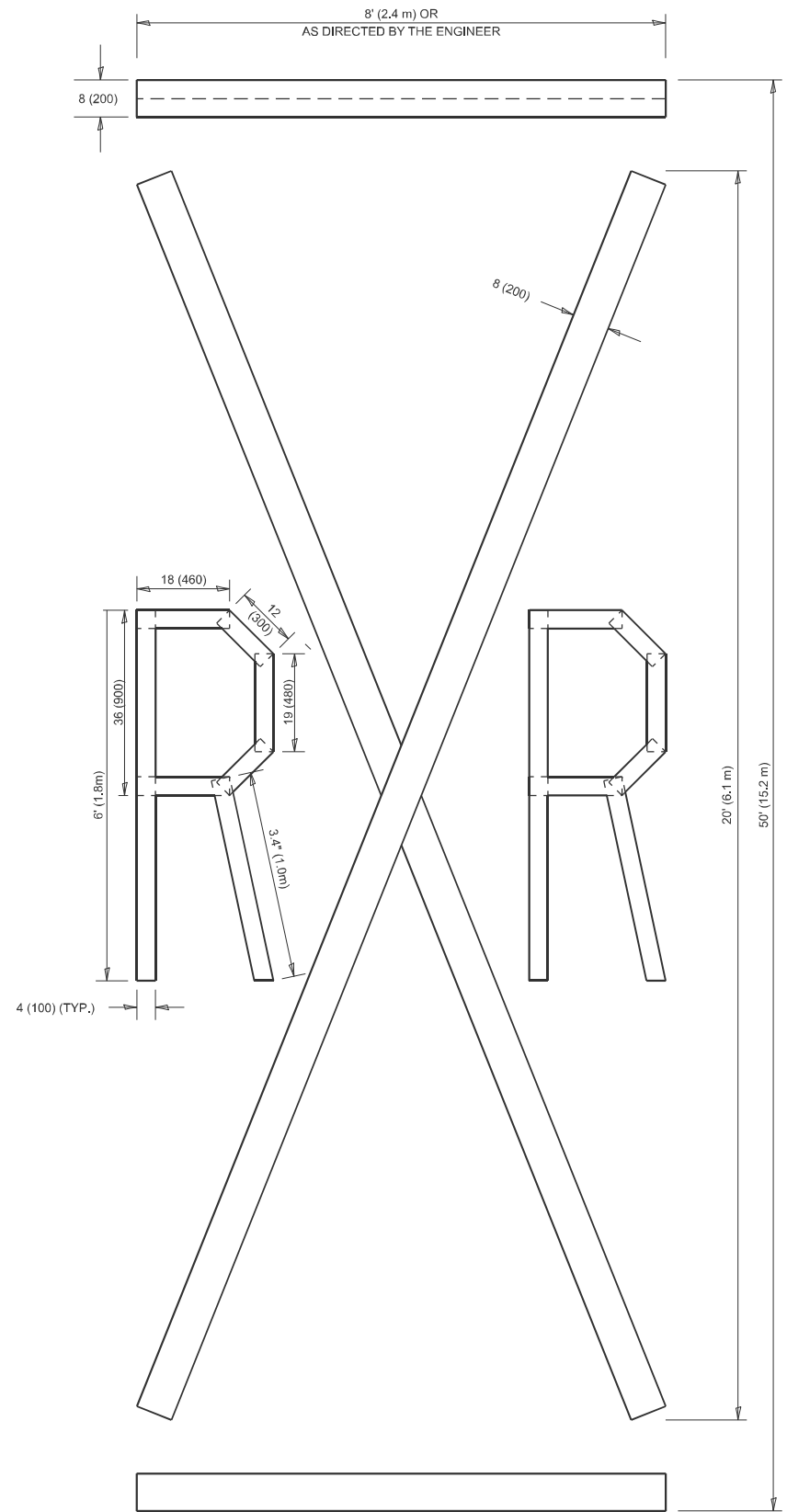

QUANTITY

4 (100) LINE = 225.9 ft. (68.9 m)
 75.3 sq. ft. (6.99 sq. m)

All dimensions are in inches (millimeters) unless otherwise shown.

USER NAME = Eric.L.Thomas	DESIGNED -	REVISED - T. RAMMACHER 03-02-98
	DRAWN -	REVISED - E. GOMEZ 08-28-00
	CHECKED -	REVISED - E. GOMEZ 08-28-00
PLOT DATE = 12/2/2024	DATE - 09-18-94	REVISED - A. SCHUETZE 09-15-16

**STATE OF ILLINOIS
 DEPARTMENT OF TRANSPORTATION**

SHORT TERM PAVEMENT MARKING LETTERS AND SYMBOLS

SCALE: NONE SHEET 1 OF 1 SHEETS STA. TO STA.

F.A.P. RTE.	SECTION	COUNTY	TOTAL SHEETS	SHEET NO.
876A	2025-1091-RS	WILL	15	13
TC-16		CONTRACT NO. 80B17		
ILLINOIS FED. AID PROJECT				

MODEL: Plan Sign (Sheet)
 FILE NAME: Z:\DOT\CAD_ORD Folder Master\Master Files\DOT_CONFIGURATION\Organization-Civil\DOT_Standards\Digital\Sheet Seeds\Civil_Named_Boundary_SheetSeeds.dgnlib

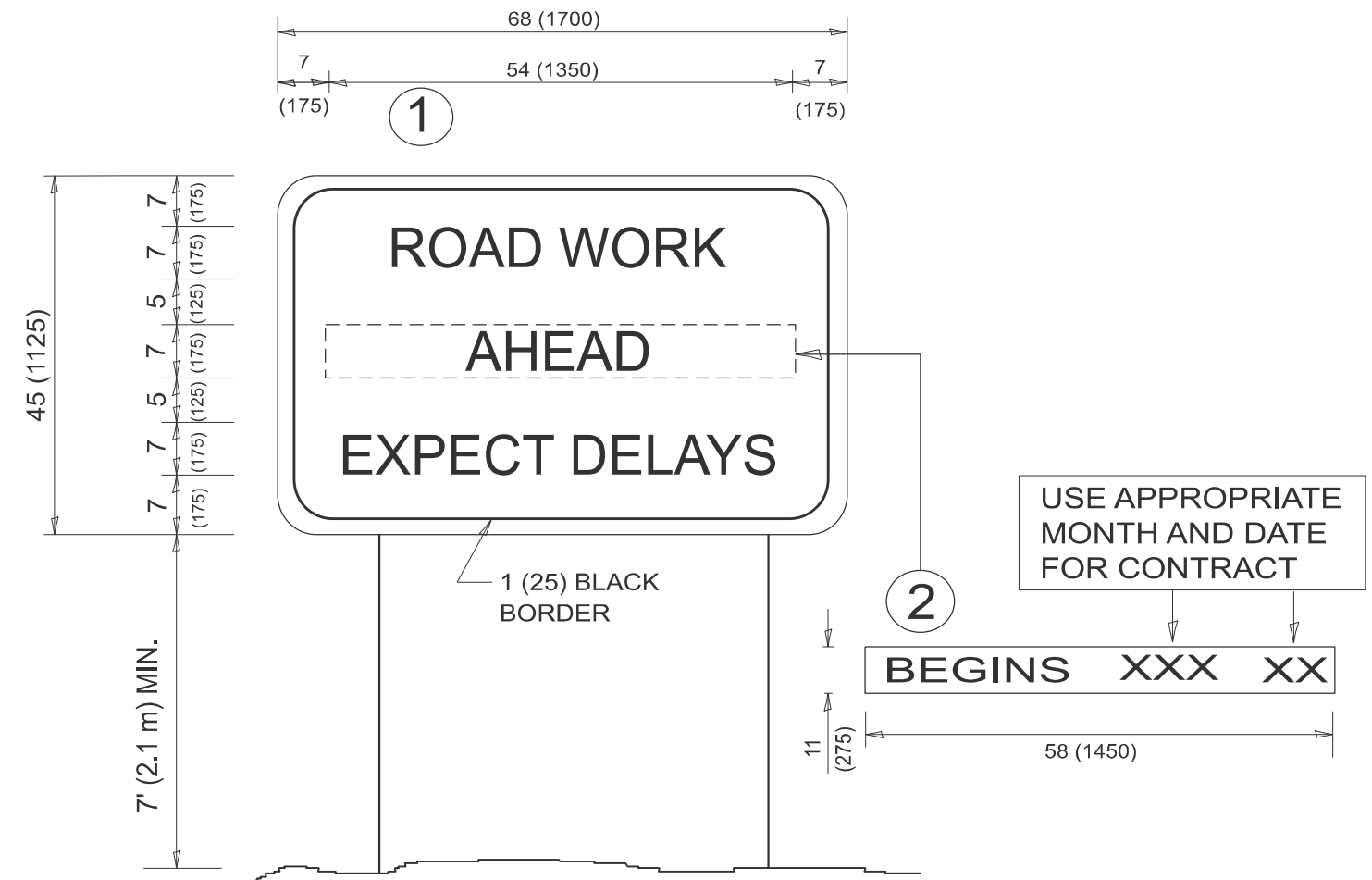

NOTES:

1. USE BLACK LETTERING ON ORANGE BACKGROUND.
2. ERECT SIGNS IN ADVANCE OF THE LOCATION FOR THE "ROAD CONSTRUCTION AHEAD" SIGN AT LOCATIONS AS DIRECTED BY THE ENGINEER.
3. ERECT SIGN ① WITH INSTALLED PANEL ② ONE WEEK PRIOR TO THE START OF CONSTRUCTION.
4. REMOVE PANEL ② SOON AFTER THE START OF CONSTRUCTION.
5. SEE SPECIAL PROVISION FOR "TEMPORARY INFORMATION SIGNING" FOR ADDITIONAL INFORMATION.
6. ONE SIGN ASSEMBLY EQUALS 25.70 SQ. FT. (2.3 SQ. M.)
7. SHALL BE PAID FOR AS TEMPORARY INFORMATION SIGNING.

ALL DIMENSIONS ARE IN INCHES (MILLIMETERS)
 UNLESS OTHERWISE SHOWN.

USER NAME = Eric.L.thomas	DESIGNED -	REVISED - R. MIRS 09-15-97
	DRAWN -	REVISED - R. MIRS 12-11-97
	CHECKED -	REVISED - T. RAMMACHER 02-02-99
PLOT DATE = 12/2/2024	DATE -	REVISED - C. JUCIUS 01-31-07

**STATE OF ILLINOIS
 DEPARTMENT OF TRANSPORTATION**

**ARTERIAL ROAD
 INFORMATION SIGN**

SCALE: NONE SHEET 1 OF 1 SHEETS STA. TO STA.

F.A.P. RTE.	SECTION	COUNTY	TOTAL SHEETS	SHEET NO.
876A	2025-1091-RS	WILL	15	14
TC-22			CONTRACT NO. 80B17	
ILLINOIS FED. AID PROJECT				

MODEL: Plan Studio (Sheet)
 FILE NAME: Z:\DOT\CAD_ORD\Folder Master\Master_Files\DOT_CONFIGURATION\Organization-Civil\DOT_Standards\Signs\Sheet Seeds\Civil_Named_Boundary_SheetSeeds.dgnlib

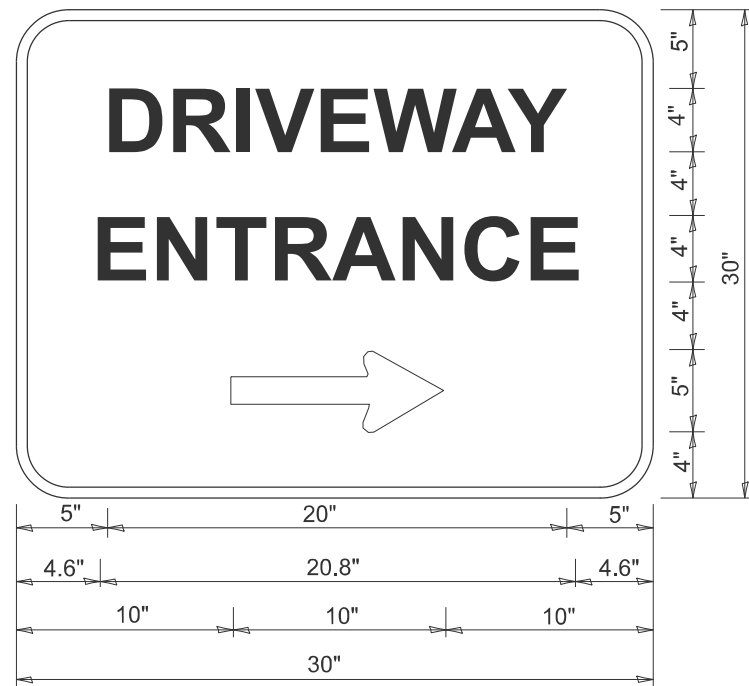

3.0" RADIUS, 0.5" BORDER, WHITE ON GREEN; REFLECTORIZED
 "DRIVEWAY" D; "ENTRANCE" D; STANDARD ARROW CUSTOM 12.0" x 5.0"

NOTES:

1. HALF OF THE SIGNS WILL REQUIRE A LEFT HAND FACING ARROW.
2. TWO SIGNS SHALL BE USED AT EACH COMMERCIAL ENTRANCE PLACED BACK-TO-BACK: ONE WITH A RIGHT HAND ARROW (SHOWN) SHALL BE PLACED ON THE NEAR RIGHT SIDE THE DRIVEWAY AND ONE WITH A LEFT HAND ARROW SHALL BE PLACED ON THE FAR LEFT SIDE OF THE DRIVEWAY.
3. SIGNS TO BE PAID FOR AS ITEM "TEMPORARY INFORMATION SIGNING".

USER NAME = Eric.L.thomas	DESIGNED -	REVISED - C. JUCIUS 02-15-07
	DRAWN -	REVISED -
	CHECKED -	REVISED -
PLOT DATE = 12/2/2024	DATE -	REVISED -

**STATE OF ILLINOIS
 DEPARTMENT OF TRANSPORTATION**

DRIVEWAY ENTRANCE SIGNING

SCALE: NONE SHEET 1 OF 1 SHEETS STA. TO STA.

F.A.P. RTE.	SECTION	COUNTY	TOTAL SHEETS	SHEET NO.
876A	2025-1091-RS	WILL	15	15
TC-26			CONTRACT NO. 80B17	
ILLINOIS FED. AID PROJECT				