

STATE OF ILLINOIS
DEPARTMENT OF TRANSPORTATION

F.A. RTE.	SECTION	COUNTY	TOTAL SHEETS	SHEET NO.
SBI 52	2025-2014-RS	COOK	24	1
		ILLINOIS	CONTRACT NO. 80B33	

FOR INDEX OF SHEETS, SEE SHEET NO.

THE PROJECT IS LOCATED WITHIN:
CITY OF HARVEY
UNINCORPORATED COOK COUNTY

PROPOSED
HIGHWAY PLANS

SBI ROUTE 52 (LOOMIS ST.)
THORNTON / VINCENNES RD. TO 150TH ST.
SECTION 2025-2014-RS
DESIGNED OVERLAY, ADA IMPROVEMENTS
COOK COUNTY

C-91-269-25

TRAFFIC DATA:

ADT: 1,050 (2025)
SPEED LIMIT: 30 - 35 MPH
LOCAL ROAD OR STREET

RESURFACING OMISSION:

STA. 33+57 TO 34+59 (IL 83 [SIBLEY BLVD.])

PROJECT ENDS
STA. 68+18

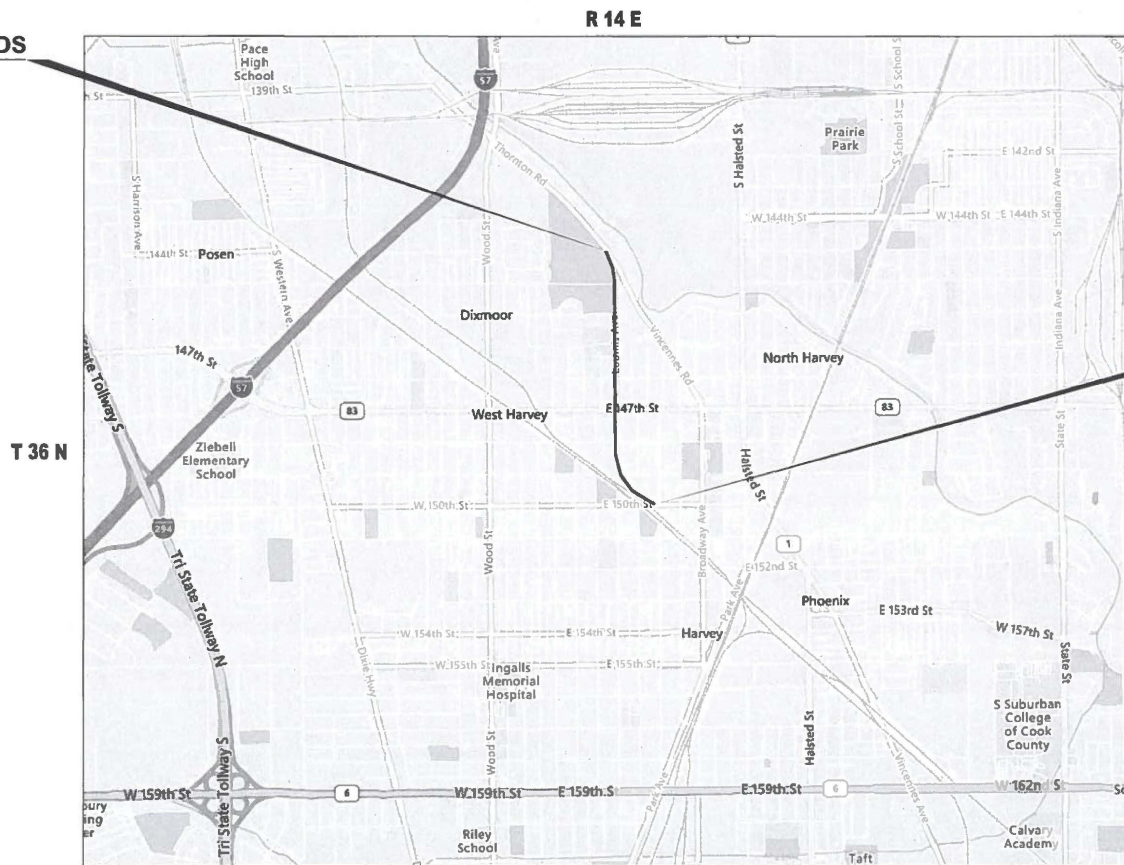

LOCATION MAP (NOT TO SCALE)

PROJECT BEGINS
STA. 10+54

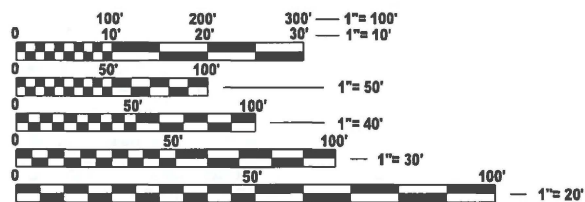

FULL SIZE PLANS HAVE BEEN PREPARED USING STANDARD ENGINEERING SCALES. REDUCED SIZED PLANS WILL NOT CONFORM TO STANDARD SCALES. IN MAKING MEASUREMENTS ON REDUCED PLANS, THE ABOVE SCALES MAY BE USED.

J.U.L.I.E.
JOINT UTILITY LOCATION INFORMATION FOR EXCAVATION
1-800-892-0123
OR 811

PROJECT ENGINEER LUKASZ POCIECHA (847) 705-4255
PROJECT MANAGER VESELIN VELICHKOV

CONTRACT NO. 80B33

THORNTON TOWNSHIP
GROSS LENGTH = 5764 FT. = 1.09 MILE
NET LENGTH = 5662 FT. = 1.07 MILE

D-91-195-25

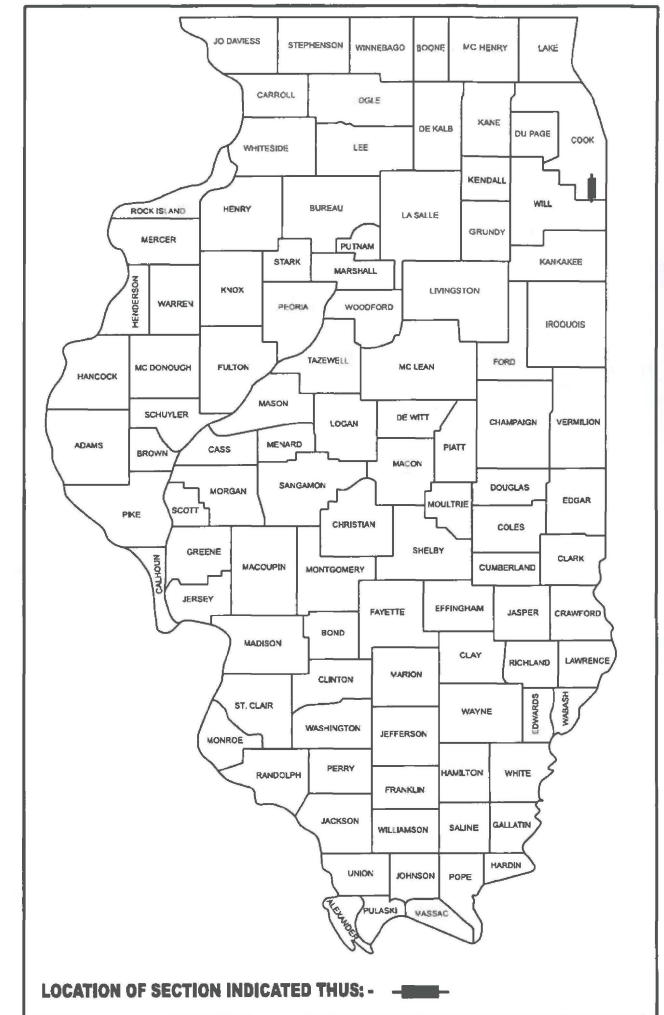

LOCATION OF SECTION INDICATED THUS: -

STATE OF ILLINOIS
DEPARTMENT OF TRANSPORTATION

SUBMITTED March 23rd 2026
Jose Rios IR
REGIONAL ENGINEER

May 8 2026
[Signature]
ENGINEER OF DESIGN AND ENVIRONMENT

May 8 2026
[Signature]
DIRECTOR OF HIGHWAYS PROJECT IMPLEMENTATION

PRINTED BY THE AUTHORITY
OF THE STATE OF ILLINOIS

INDEX OF SHEETS

SHEET NO.	DESCRIPTION
1	COVER SHEET
2	INDEX OF SHEETS, STATE STANDARDS, AND GENERAL NOTES
3-4	SUMMARY OF QUANTITIES
5-6	EXISTING AND PROPOSED TYPICAL SECTIONS
7-8	ROADWAY AND PAVEMENT MARKING PLANS
9	DETECTOR LOOP REPLACEMENT PLAN
10	PEDESTRIAN RAMP DESIGN DETAILS
11	PROJECT DETAIL FOR SINGLE PERPENDICULAR CURB RAMPS (PD-01)
12	PROJECT DETAIL FOR DOUBLE PERPENDICULAR CURB RAMPS (PD-03)
13	PROJECT DETAIL FOR SINGLE PERPENDICULAR CURB RAMPS WITH TURNING SPACE (PD-04)
14	DETAILS FOR FRAMES AND LIDS ADJUSTMENT WITH MILLING (BD-08)
15	DETAILS FOR P.C. CONCRETE DRIVEWAY, ALLEY RETURN AND SIDEWALK (BD-17)
16	PAVEMENT PATCHING FOR HMA SURFACED PAVEMENT (BD-22)
17	CURB OR CURB AND GUTTER REMOVAL AND REPLACEMENT (BD-24)
18	BUTT JOINT AND HMA TAPER DETAILS (BD-32)
19	TRAFFIC CONTROL AND PROTECTION FOR SIDE RAODS, INTERSECTIONS, AND DRIVEWAYS (TC-10)
20	TYPICAL APPLICATIONS RAISED REFLECTIVE PAVEMENT MARKERS (SNOW-FLOW RESISTANT) (TC-11)
21	DISTRICT ONE TYPICAL PAVEMENT MARKINGS (TC-13)
22	SHORT TERM PAVEMENT MARKING LETTERS AND SYMBOLS (TC-16)
23	ARTERIAL ROAD INFORMATION SIGN (TC-22)
24	DRIVEWAY ENTRANCE SIGNING (TC-26)

STATE STANDARDS

STANDARD NO.	DESCRIPTION
000001-09	STANDARD SYMBOLS, ABBREVIATIONS, AND PATTERNS
424001-12	PERPENDICULAR CURB RAMPS FOR SIDEWALKS
424026-04	ENTRANCE / ALLEY PEDESTRIAN CROSSINGS
442201-03	CLASS C AND D PATCHES
604001-05	FRAME AND LIDS, TYPE 1
606001-09	CONCRETE CURB TYPE B AND COMBINATION CONCRETE CURB AND GUTTER
701006-05	OFF-RD OPERATIONS, 2L, 2W, 15' TO 24" FROM PAVEMENT EDGE
701011-04	OFF-RD MOVING OPERATIONS, 2L, 2W, DAY ONLY
701301-04	LANE CLOSURE, 2L, 2W, SHORT TIME OPERATIONS
701311-03	LANE CLOSURE, 2L, 2W, MOVING OPERATIONS, DAY ONLY
701427-05	LANE CLOSURE, MULTILANE, INTERMITTENT OR MOVING OPER., FOR SPEEDS ≤ 40 MPH
701501-06	URBAN LANE CLOSURE, 2L, 2W, UNDIVIDED
701602-10	URBAN SINGLE LANE CLOSURE, MULTILANE, 2W WITH MOUNTABLE MEDIAN
701701-10	URBAN LANE CLOSURE, MULTILANE INTERSECTION
701801-06	SIDEWALK, CORNER OR CROSSWALK CLOSURE
701901-11	TRAFFIC CONTROL DEVICES
780001-05	TYPICAL PAVEMENT MARKINGS
781001-04	TYPICAL APPLICATIONS RAISED REFLECTIVE PAVEMENT MARKERS
886001-01	DETECTOR LOOP INSTALLATIONS
886006-01	TYPICAL LAYOUTS FOR DETECTOR LOOPS

GENERAL NOTES CONTINUED

- FRAMES AND GRATES ADJUSTMENT OF PRIVATE UTILITIES WITHIN THE LIMITS OF IMPROVEMENTS SHALL BE DONE BY THEIR RESPECTIVE OWNERS AND ARE NOT PART OF THIS CONTRACT.
- SIDEWALK REMOVAL AND P.C.C. SIDEWALK 5" LOCATIONS SHALL BE DETERMINED BY THE RESIDENT ENGINEER.
- THE CONTRACTOR SHALL CONTACT KALPANAKANNAN-HOSADURGA, THE DISTRICT ONE TRAFFIC CONTROL SUPERVISOR, AT KALPANA.KANNAN-HOSADURGA@ILLINOIS.GOV A MINIMUM OF 72 HOURS IN ADVANCE OF BEGINNING WORK.
- THE RESIDENT ENGINEER SHALL CONTACT PATRICE HARRIS, AREA TRAFFIC FIELD TECHNICIAN, VIA EMAIL AT PATRICE.HARRIS@ILLINOIS.GOV A MINIMUM OF TWO (2) WEEKS PRIOR TO THE PLACEMENT OF PERMANENT PAVEMENT MARKINGS.
- THE CONTRACTOR SHALL BE REQUIRED TO KEEP A RECORD OF THE LOCATIONS OF PLATED STRUCTURES BY STATION AND OFFSET LEFT OR RIGHT OF THE CENTERLINE OF PAVEMENT.
- THE CONTRACTOR SHALL BE REQUIRED TO KEEP A RECORD OF THE LOCATIONS OF THE BURIED STRUCTURES ACCORDING TO THE STATION AND DISTANCE LEFT OR RIGHT OF THE CENTERLINE OF PAVEMENT. UPON COMPLETION OF THE WORK, THE CONTRACTOR SHALL DELIVER THE RECORD TO THE ENGINEER.
- EXISTING BROKEN FRAMES AND LIDS SHALL BE REMOVED AND DISPOSED OF BY THE CONTRACTOR AND SHALL BE REPLACED AS DIRECTED BY THE ENGINEER. REPLACEMENT FRAMES AND LIDS WILL BE PAID FOR ACCORDING TO ARTICLE 109.04 OF THE STANDARD SPECIFICATIONS UNLESS A SEPARATE PAY ITEM HAS BEEN PROVIDED.
- PAVEMENT MARKING TAPE, TYPE IV SHALL BE USED FOR SHORT TERM PAVEMENT MARKINGS ON ALL FINAL SURFACES.
- BEFORE BEGINNING ANY WORK, THE CONTRACTOR SHALL RETAIN AND RECORD FOR FUTURE REFERENCE, ALL EXISTING PAVEMENT MARKING LINES (AND RAISED REFLECTIVE PAVEMENT MARKERS) IN ORDER THAT THESE LOCATIONS CAN BE RE-ESTABLISHED FOR STRIPING. EXACT LOCATIONS OF ALL PAVEMENT MARKINGS SHALL BE SHOWN ON THE PLANS OR AS DIRECTED BY THE ENGINEER.
- OVERNIGHT LANE CLOSURES SHALL NOT BE ALLOWED FOR REHABILITAION PROJECTS INVOLVING DAYTIME MILLING AND RESURFACING OPERATIONS AND CLASS D PATCHING UNLESS OTHER CONDITIONS WARRANT EXTENDED LANE CLOSURES AS DETERMINED AND APPROVED IN WRITING BY THE ENGINEER OR AS PROVIDED FOR IN THE CONTRACT SPECIFICATIONS.
- THE AGGREGATE GRADATION FOR THE LOWER 9 INCHES OF AGGREGATE SUBGRADE IMPROVEMENT 12" SHALL BE CS 1 OR RR 1".
- "ROAD CONSTRUCTION AHEAD" SIGNS SHALL REMAIN INSTALLED AT LOCATIONS WHERE ROADWAY HAZARDS WITHIN THE WORK ZONE WILL REMAIN OVERNIGHT.
- TEMPORARY PAVEMENT MARKINGS OR SHORT TERM PAVEMENT MARKINGS ON INTERMEDIATE SURFACES SHALL NOT BE REMOVED, UNLESS DIRECTED BY THE RESIDENT ENGINEER.
- GEOTECHNICAL FABRIC FOR GROUND STABILIZATION AND / OR AGGREGATE SUBGRADE IMPROVEMENT (CU YD) HAS BEEN PROVIDED FOR USE AT THE LOCATIONS INDICATED FOR SOILS THAT TEND TO BE UNSTABLE AND / OR UNSUITABLE. THE ACTUAL NEED FOR REMOVAL AND REPLACEMENT WITH ABOVE ITEM WILL BE DETERMINED IN THE FIELD AT THE TIME OF CONSTRUCTION BY THE GEOTECHNICAL ENGINEER. ALL POTENTIALLY UNSTABLE SOILS SHOULD BE TESTED WITH A STATIC OR DYNAMIC CONE PENETROMETER AND TREATED IN ACCORDANCE WITH ARTICLE 301.04 OF THE STANDARD SPECIFICATIONS AND IDOT SUBGRADE STABILITY MANUAL. IF UNSTABLE AND / OR UNSUITABLE SOILS ARE NOT ENCOUNTERED, THE THE QUANTITY SHALL BE DEDUCTED AND NO ADDITIONAL COMPENSATION WILL BE DUE TO THE CONTRACTOR.
- THE SUBGRADE STABILITY SHALL BE VERIFIED BY PROOF ROLLING WITH A FULLY LOADED TANDEM-AXLE TRUCK.
- ANY AGGREGATE SUBGRADE CONTAMINATED AND / OR DAMAGED BY THE CONTRACTOR'S VEHICLES AND / OR EQUIPMENT IS TO BE REMOVED AND REPLACED AS DIRECTED BY THE RESIDENT ENGINEER AT THE CONTRACTOR'S EXPENSE.
- GEOTECHNICAL FABRIC FOR GROUND STABILIZATION SHALL BE WOVEN.

GENERAL NOTES

- TEN (10) FOOT TRANSITIONS SHALL BE USED TO MATCH PROPOSED CURB AND GUTTER AND MEDIAN ITEMS OF WORK TO EXISTING CURBS AND GUTTER AND MEDIANS IN THE FIELD, UNLESS OTHERWISE SHOWN.
- THE CONTRACTOR WILL NOT BE ALLOWED TO SET UP A YARD OR FIELD OFFICE ON STATE PROPERTY WITHOUT WRITTEN PERMISSION FROM THE DEPARTMENT.
- ALL MILLED SURFACES SHALL BE A UNIFORM CROSS SLOPE PER LANE AND FREE OF RIDGES BETWEEN PASSES. ANY DEVIATIONS SHALL BE CORRECTED AT NO COST TO THE DEPARTMENT.
- ALL PAVEMENT PATCHING LOCATIONS WILL BE DETERMINED IN THE FIELD BY THE RESIDENT ENGINEER.
- LOCATION OF COMBINATION CONCRETE CURB AND GUTTER REMOVAL AND REPLACEMENT [OR COMBINATION CURB AND GUTTER (THE TYPE SPECIFIED ON THE PLANS)], WILL BE DETERMINED IN THE FIELD BY THE RESIDENT ENGINEER.
- IT SHALL BE THE CONTRACTOR'S RESPONSIBILITY TO VERIFY ALL DIMENSIONS AND CONDITIONS EXISTING IN THE FIELD PRIOR TO CONSTRUCTION AND ORDERING OF MATERIALS.
- FRAMES AND GRATES ADJUSTMENT OF PRIVATE UTILITIES WITHIN THE LIMITS OF IMPROVEMENTS SHALL BE DONE BY THEIR RESPECTIVE OWNERS AND ARE NOT PART OF THIS CONTRACT.
- SIDEWALK REMOVAL AND P.C.C. SIDEWALK 5" LOCATIONS SHALL BE DETERMINED BY THE RESIDENT ENGINEER.

MODEL: GenNotesSh01 (Sheet)
FILE NAME: c:\pw_wcrk\wcrk\tricholas.babul@illinois.gov\1109149\0119025-shr-gennote.dgn

USER NAME = nicholas.babul	DESIGNED -	REVISED -	STATE OF ILLINOIS DEPARTMENT OF TRANSPORTATION	INDEX OF SHEETS, STATE STANDARDS & GENERAL NOTES LOOMIS ST. [THORNTON / VINCENNES RD. TO 150TH ST.]	FA RTE.	SECTION	COUNTY	TOTAL SHEETS	SHEET NO.	
	DRAWN -	REVISED -			SBI 52	2025-2014-RS	COOK	24	2	
	CHECKED -	REVISED -			CONTRACT NO. 80B33					
PLOT DATE = 3/3/2026	DATE -	REVISED -			SCALE:	SHEET 1	OF 1	SHEETS	STA.	TO STA.

SUMMARY OF QUANTITIES				TYPE CODE					
				URBAN	URBAN	URBAN	URBAN	URBAN	URBAN
				ROADWAY	SIGNAL				
Code No.	Item	Unit	Total Quantity	0005	0021				
20200100	EARTH EXCAVATION	CU YD	750	750					
20201200	REMOVAL AND DISPOSAL OF UNSUITABLE MATERIAL	CU YD	83	83					
21001000	GEOTECHNICAL FABRIC FOR GROUND STABILIZATION	SQ YD	249	249					
21101600	TOPSOIL FURNISH AND PLACE, VARIABLE DEPTH	SQ YD	513	513					
25200110	SODDING, SALT TOLERANT	SQ YD	513	513					
25200200	SUPPLEMENTAL WATERING	UNIT	7.7	7.7					
30300001	AGGREGATE SUBGRADE IMPROVEMENT	CU YD	83	83					
30300112	AGGREGATE SUBGRADE IMPROVEMENT 12"	SQ YD	994	994					
31101200	SUBBASE GRANULAR MATERIAL, TYPE B 4"	SQ YD	108	108					
35501308	HOT-MIX ASPHALT BASE COURSE, 6"	SQ YD	14	14					
35600704	HOT-MIX ASPHALT BASE COURSE WIDENING, 7"	SQ YD	994	994					
40600275	BITUMINOUS MATERIALS (PRIME COAT)	POUND	2236	2236					
40600290	BITUMINOUS MATERIALS (TACK COAT)	POUND	12746	12746					
40600370	LONGITUDINAL JOINT SEALANT	FOOT	5662	5662					
40600400	MIXTURE FOR CRACKS, JOINTS, AND FLANGEWAYS	TON	27	27					
40600982	HOT-MIX ASPHALT SURFACE REMOVAL - BUTT JOINT	SQ YD	57	57					
40601005	HOT-MIX ASPHALT REPLACEMENT OVER PATCHES	TON	43	43					
40603200	POLYMERIZED HOT-MIX ASPHALT BINDER COURSE, IL-4.75, N50	TON	1039	1039					
40604060	HOT-MIX ASPHALT SURFACE COURSE, IL-9.5, MIX "D", N50	TON	2	2					
40604062	HOT-MIX ASPHALT SURFACE COURSE, IL-9.5, MIX "D", N70	TON	2115	2115					
42001300	PROTECTIVE COAT	SQ YD	788	788					
42300400	PORTLAND CEMENT CONCRETE DRIVEWAY PAVEMENT, 8 INCH	SQ YD	108	108					

* = SPECIALTY ITEM

SUMMARY OF QUANTITIES				TYPE CODE					
				URBAN	URBAN	URBAN	URBAN	URBAN	URBAN
				ROADWAY	SIGNAL				
Code No.	Item	Unit	Total Quantity	0005	0021				
42400200	PORTLAND CEMENT CONCRETE SIDEWALK 5 INCH	SQ FT	5362	5362					
42400800	DETECTABLE WARNINGS	SQ FT	203	203					
44000161	HOT-MIX ASPHALT SURFACE REMOVAL, 3"	SQ YD	17889	17889					
44000600	SIDEWALK REMOVAL	SQ FT	5437	5437					
44002212	HOT-MIX ASPHALT REMOVAL OVER PATCHES, 3"	SQ YD	252	252					
44201753	CLASS D PATCHES, TYPE II, 9 INCH	SQ YD	80	80					
44201757	CLASS D PATCHES, TYPE III, 9 INCH	SQ YD	48	48					
44201759	CLASS D PATCHES, TYPE IV, 9 INCH	SQ YD	95	95					
48102100	AGGREGATE WEDGE SHOULDER, TYPE B	TON	157	157					
60250200	CATCH BASINS TO BE ADJUSTED	EACH	6	6					
60252800	CATCH BASINS TO BE RECONSTRUCTED	EACH	1	1					
60300105	FRAMES AND GRATES TO BE ADJUSTED	EACH	2	2					
60300305	FRAMES AND LIDS TO BE ADJUSTED	EACH	2	2					
60406000	FRAMES AND LIDS, TYPE 1, OPEN LID	EACH	3	3					
60920012	PIPE CULVERTS TO BE CLEANED 12"	FOOT	60	60					
* 66900200	NON-SPECIAL WASTE DISPOSAL	CU YD	750	750					
* 66900530	SOIL DISPOSAL ANALYSIS	EACH	4	4					
* 66901001	REGULATED SUBSTANCES PRE-CONSTRUCTION PLAN	L SUM	1	1					
* 66901003	REGULATED SUBSTANCES FINAL CONSTRUCTION REPORT	L SUM	1	1					
* 66901006	REGULATED SUBSTANCES MONITORING	CAL DA	4	4					
67100100	MOBILIZATION	L SUM	1	1					

* = SPECIALTY ITEM

MODEL: SOC-1 [Sheet]
FILE NAME: c:\pwworking\icholas.babul@illinois.gov\d1109149\0119025-shr-SOC.dgn

USER NAME = nicholas.babul	DESIGNED -	REVISED -
	DRAWN -	REVISED -
	CHECKED -	REVISED -
PLOT DATE = 12/15/2025	DATE -	REVISED -

STATE OF ILLINOIS
DEPARTMENT OF TRANSPORTATION

SUMMARY OF QUANTITIES
LOOMIS ST. (150TH ST. TO THORNTON/VINCENNES RD.)

SCALE: SHEET 1 OF 2 SHEETS STA. TO STA.

F.A. RTE.	SECTION	COUNTY	TOTAL SHEETS	SHEET NO.
SBI 52	2025-2014-RS	COOK	24	3
CONTRACT NO. 80B33				
ILLINOIS FED. AID PROJECT				

SUMMARY OF QUANTITIES				TYPE CODE					
				URBAN	URBAN	URBAN	URBAN	URBAN	URBAN
				ROADWAY	SIGNAL				
Code No.	Item	Unit	Total Quantity	100% STATE	100% STATE				
70102620	TRAFFIC CONTROL AND PROTECTION, STANDARD 701501	L SUM	1	1					
70102632	TRAFFIC CONTROL AND PROTECTION, STANDARD 701602	L SUM	1	1					
70102635	TRAFFIC CONTROL AND PROTECTION, STANDARD 701701	L SUM	1	1					
70102640	TRAFFIC CONTROL AND PROTECTION, STANDARD 701801	L SUM	1	1					
70300100	SHORT TERM PAVEMENT MARKING	FOOT	1540	1540					
70300150	SHORT TERM PAVEMENT MARKING REMOVAL	SQ FT	129	129					
70300221	TEMPORARY PAVEMENT MARKING - LINE 4"- PAINT	FOOT	23958	23958					
70300251	TEMPORARY PAVEMENT MARKING - LINE 8"- PAINT	FOOT	230	230					
70300261	TEMPORARY PAVEMENT MARKING - LINE 12"- PAINT	FOOT	1060	1060					
70300281	TEMPORARY PAVEMENT MARKING - LINE 24"- PAINT	FOOT	216	216					
70307120	TEMPORARY PAVEMENT MARKING - LINE 4" - TYPE IV TAPE	FOOT	385	385					
* 72400310	REMOVE SIGN PANEL - TYPE 1	SQ FT	13	13					
* 78000200	THERMOPLASTIC PAVEMENT MARKING - LINE 4"	FOOT	11979	11979					
* 78000500	THERMOPLASTIC PAVEMENT MARKING - LINE 8"	FOOT	115	115					
* 78000600	THERMOPLASTIC PAVEMENT MARKING - LINE 12"	FOOT	530	530					
* 78000650	THERMOPLASTIC PAVEMENT MARKING - LINE 24"	FOOT	108	108					
* 78100100	RAISED REFLECTIVE PAVEMENT MARKER	EACH	128	128					
78300200	RAISED REFLECTIVE PAVEMENT MARKER REMOVAL	EACH	128	128					
X0320050	CONSTRUCTION LAYOUT (SPECIAL)	L SUM	1	1					
X2020110	GRADING AND SHAPING SHOULDERS	UNIT	55.2	55.2					
X4022000	TEMPORARY ACCESS (COMMERCIAL ENTRANCE)	EACH	3	3					
X4400501	COMBINATION CURB AND GUTTER REMOVAL AND REPLACEMENT LESS THAN OR EQUAL TO 10 FEET	FOOT	56	56					

* = SPECIALTY ITEM

SUMMARY OF QUANTITIES				TYPE CODE					
				URBAN	URBAN	URBAN	URBAN	URBAN	URBAN
				ROADWAY	SIGNAL				
Code No.	Item	Unit	Total Quantity	100% STATE	100% STATE				
X4400503	COMBINATION CURB AND GUTTER REMOVAL AND REPLACEMENT GREATER THAN 10 FEET	FOOT	322	322					
X5537800	STORM SEWERS TO BE CLEANED 12"	FOOT	150	150					
X6030310	FRAMES AND LIDS TO BE ADJUSTED (SPECIAL)	EACH	9	9					
X6700407	ENGINEER'S FIELD OFFICE, TYPE A (D1)	CAL MO	12	12					
X7200061	TEMPORARY INFORMATION SIGNING	SQ FT	184	184					
* X8860105	DETECTOR LOOP REPLACEMENT	FOOT	237		237				
Z0018500	DRAINAGE STRUCTURES TO BE CLEANED	EACH	10	10					

* = SPECIALTY ITEM

MODEL: SOQ-2 (Sheet)
FILE NAME: c:\p\work\wv\in\in\cholas.babul\illinois.gov\1109149\1109149-25-sh-SOQ.dgn

USER NAME = nicholas.babul	DESIGNED -	REVISED -
	DRAWN -	REVISED -
	CHECKED -	REVISED -
PLOT DATE = 3/3/2026	DATE -	REVISED -

STATE OF ILLINOIS
DEPARTMENT OF TRANSPORTATION

SUMMARY OF QUANTITIES
LOOMIS ST. (150TH ST. TO THORNTON/VINCENNES RD.)

SCALE: SHEET 2 OF 2 SHEETS STA. TO STA.

F.A. RTE.	SECTION	COUNTY	TOTAL SHEETS	SHEET NO.
SBI 52	2025-2014-RS	COOK	24	4
CONTRACT NO. 80B33				
ILLINOIS FED. AID PROJECT				

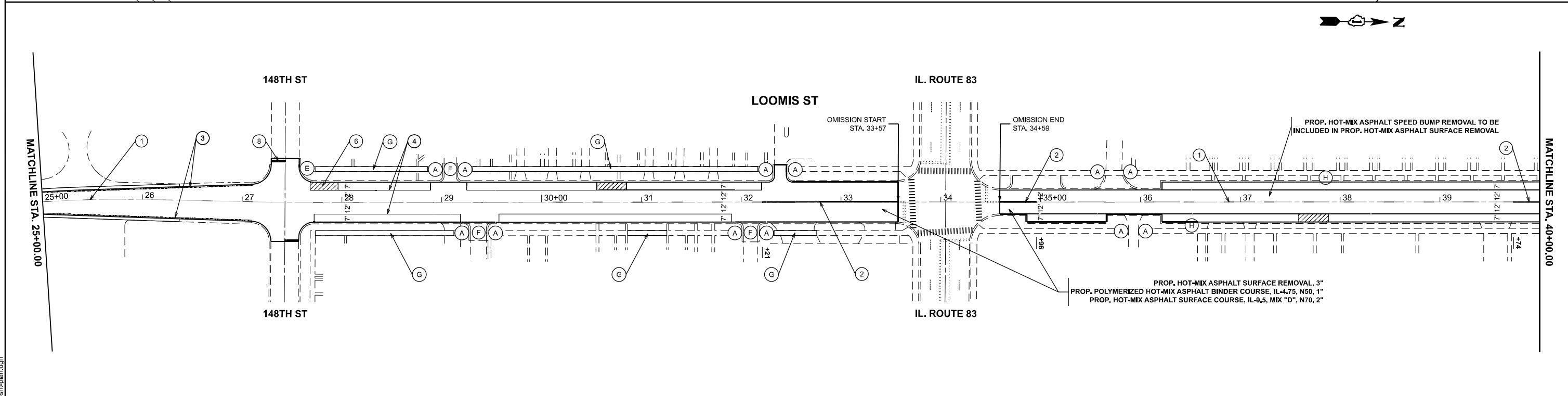
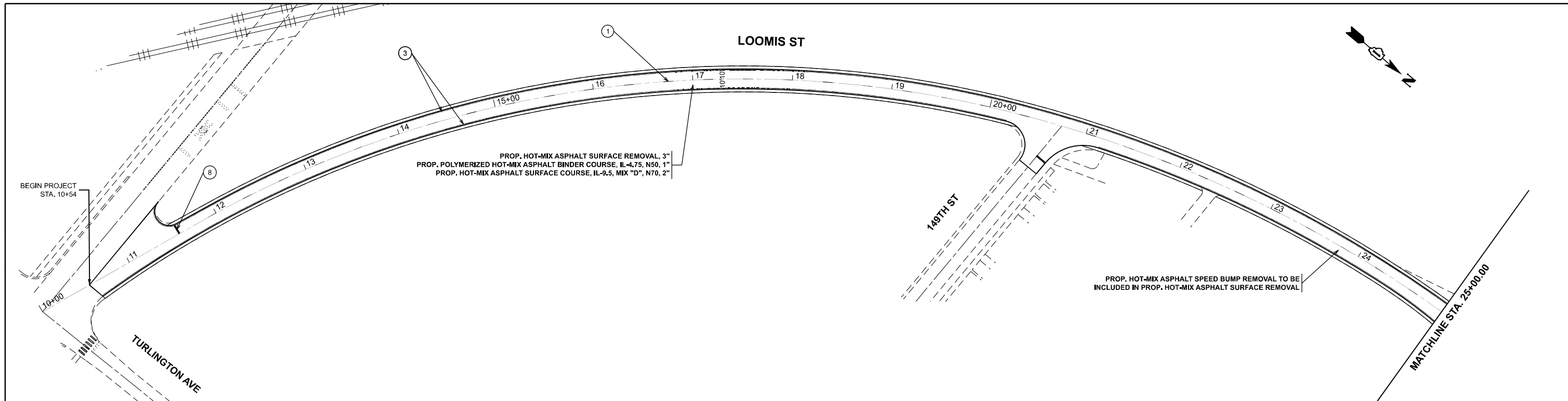

THERMOPLASTIC PAVEMENT MARKING LEGEND

- ① 4" SKIP DASH YELLOW CENTERLINE, 10' DASH - 30' SKIP (TYP.)
- ② 4" DOUBLE SOLID YELLOW CENTERLINE, 2 @ 11" C-C (TYP.)
- ③ 4" SINGLE SOLID WHITE EDGE LINE (TYP.)
- ④ 4" SINGLE SOLID WHITE PARKING LINE (TYP.)
- ⑤ 8" SOLID WHITE GORE MARKING WITH 12" SOLID WHITE DIAGONAL CHANNELIZING LINES (TYP.)
- ⑥ 12" SOLID WHITE DIAGONAL LINES (TYP.)
- ⑦ 12" SOLID WHITE SCHOOL CROSSWALK (TYP.)
- ⑧ 24" SOLID WHITE STOP BAR (TYP.)

ROADWAY LEGEND

- A PROPOSED PEDESTRIAN RAMP IMPROVEMENT, ADA DETAIL PD-01A
- B PROPOSED PEDESTRIAN RAMP IMPROVEMENT, ADA DETAIL PD-03A
- C PROPOSED PEDESTRIAN RAMP IMPROVEMENT, ADA DETAIL PD-04A
- D PROPOSED PEDESTRIAN RAMP IMPROVEMENT, SEE ADA DETAILS
- E PROPOSED PEDESTRIAN RAMP REMOVAL
- F PROPOSED PCC 8" ALLEY RETURN, ALLEY DETAIL BD-17 & HWY. STD. 424026
- G PROPOSED PCC 5" SIDEWALK REMOVAL AND REPLACEMENT
- H PROPOSED "SPEED BUMP" SIGN PANEL, TYPE 1 REMOVAL

NOTES

- 1) LIMITS OF RESURFACING ON THE SIDE-STREETS THROUGHOUT THE PROJECT SHALL BE TO THE RADIUS RETURN, UNLESS OTHERWISE SHOWN ON THE PLANS, OR AS DIRECTED BY THE RESIDENT ENGINEER.
- 2) ALL FINAL PAVEMENT MARKINGS SHALL BE PLACED IN ACCORDANCE WITH TC-13 "DISTRICT ONE TYPICAL PAVEMENT MARKINGS" STANDARD DETAIL.
- 3) ALL RAISED REFLECTIVE PAVEMENT MARKERS SHALL BE PLACED IN ACCORDANCE WITH TC-11 "TYPICAL APPLICATIONS RAISED REFLECTIVE PAVEMENT MARKERS (SNOW-PLOW RESISTANT)" STANDARD DETAIL.
- 4) BUTT JOINTS SHALL BE INSTALLED AT THE ENDS OF ALL RESURFACING (WHERE RESURFACING MEETS EXISTING PAVEMENT) ACCORDING WITH BD-32 "BUTT JOINT AND HOT-MIX ASPHALT TAPER DETAILS" UNLESS OTHERWISE SPECIFIED.

MODEL: LoomisAve_E-1 - Loomis Roadway (Sheet)
FILE NAME: c:\pwworkspace\iticholas.babul\iticholas_babul.dgn

USER NAME = nicholas.babul	DESIGNED -	REVISED -
	DRAWN -	REVISED -
	CHECKED -	REVISED -
PLOT DATE = 1/27/2026	DATE -	REVISED -

**STATE OF ILLINOIS
DEPARTMENT OF TRANSPORTATION**

**ROADWAY AND PAVEMENT MARKING PLAN
LOOMIS ST. (150TH ST. TO THORNTON/VINCENNES RD.)**

SCALE: SHEET 1 OF 2 SHEETS STA. 10+00.00 TO STA. 40+00.00

F.A. RTE.	SECTION	COUNTY	TOTAL SHEETS	SHEET NO.
SBI 52	2025-2014-RS	COOK	24	7
CONTRACT NO. 80B33				
ILLINOIS FED. AID PROJECT				

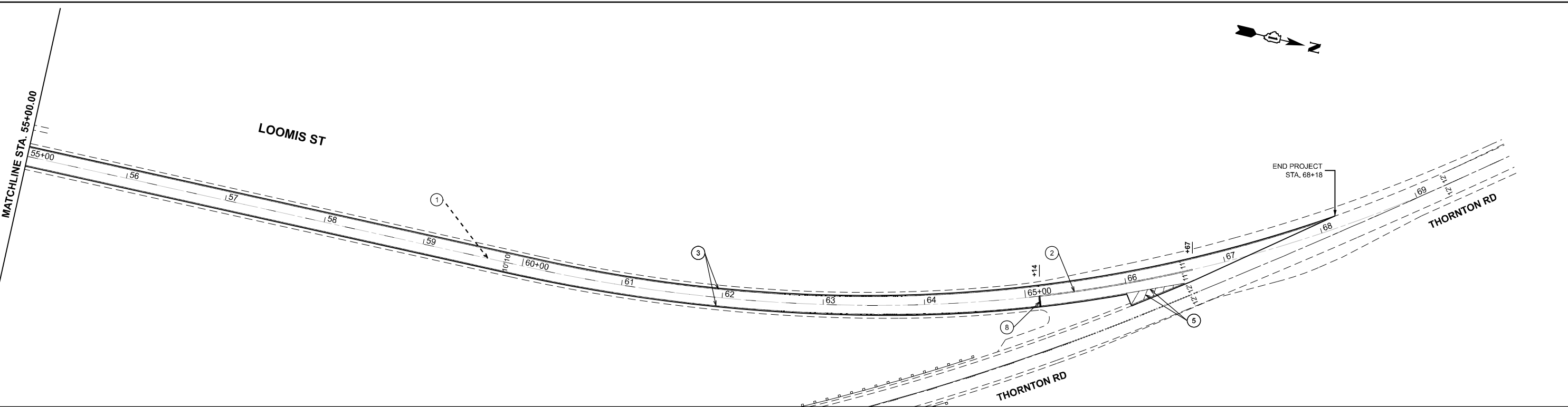
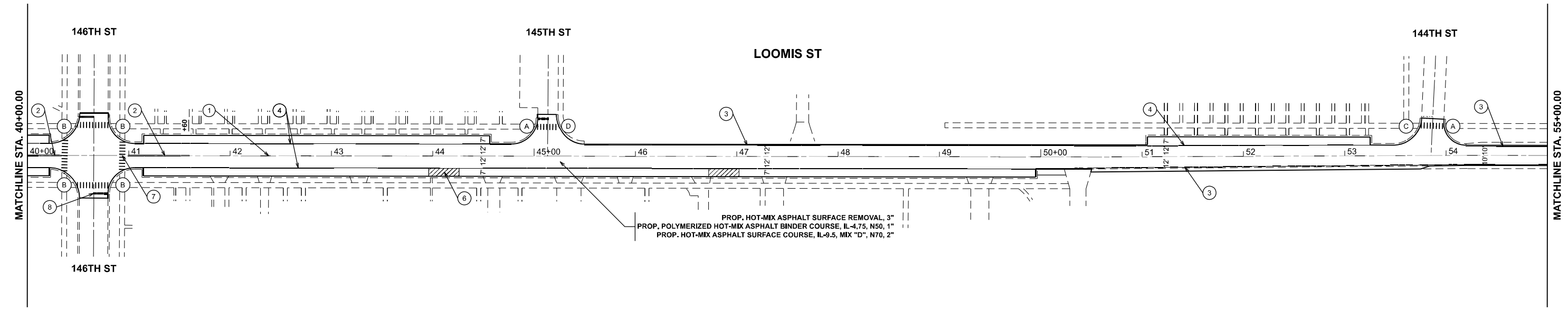
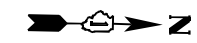

THERMOPLASTIC PAVEMENT MARKING LEGEND

- 1 - 4" SKIP DASH YELLOW CENTERLINE, 10' DASH - 30' SKIP (TYP.)
- 2 - 4" DOUBLE SOLID YELLOW CENTERLINE, 2 @ 11" C-C (TYP.)
- 3 - 4" SINGLE SOLID WHITE EDGE LINE (TYP.)
- 4 - 4" SINGLE SOLID WHITE PARKING LINE (TYP.)
- 5 - 8" SOLID WHITE GORE MARKING WITH 12" SOLID WHITE DIAGONAL CHANNELIZING LINES (TYP.)
- 6 - 12" SOLID WHITE DIAGONAL LINES (TYP.)
- 7 - 12" SOLID WHITE SCHOOL CROSSWALK (TYP.)
- 8 - 24" SOLID WHITE STOP BAR (TYP.)

ROADWAY LEGEND

- A - PROPOSED PEDESTRIAN RAMP IMPROVEMENT, ADA DETAIL PD-01A
- B - PROPOSED PEDESTRIAN RAMP IMPROVEMENT, ADA DETAIL PD-03A
- C - PROPOSED PEDESTRIAN RAMP IMPROVEMENT, ADA DETAIL PD-04A
- D - PROPOSED PEDESTRIAN RAMP IMPROVEMENT, SEE ADA DETAILS
- E - PROPOSED PEDESTRIAN RAMP REMOVAL
- F - PROPOSED PCC 8" ALLEY RETURN, ALLEY DETAIL BD-17 & HWY. STD. 424026
- G - PROPOSED PCC 5" SIDEWALK REMOVAL AND REPLACEMENT
- H - PROPOSED "SPEED BUMP" SIGN PANEL, TYPE 1 REMOVAL

NOTES

- 1) LIMITS OF RESURFACING ON THE SIDE-STREETS THROUGHOUT THE PROJECT SHALL BE TO THE RADIUS RETURN, UNLESS OTHERWISE SHOWN ON THE PLANS, OR AS DIRECTED BY THE RESIDENT ENGINEER.
- 2) ALL FINAL PAVEMENT MARKINGS SHALL BE PLACED IN ACCORDANCE WITH TC-13 "DISTRICT ONE TYPICAL PAVEMENT MARKINGS" STANDARD DETAIL.
- 3) ALL RAISED REFLECTIVE PAVEMENT MARKERS SHALL BE PLACED IN ACCORDANCE WITH TC-11 "TYPICAL APPLICATIONS RAISED REFLECTIVE PAVEMENT MARKERS (SNOW-PLOW RESISTANT)" STANDARD DETAIL.
- 4) BUTT JOINTS SHALL BE INSTALLED AT THE ENDS OF ALL RESURFACING (WHERE RESURFACING MEETS EXISTING PAVEMENT) ACCORDING WITH BD-32 "BUTT JOINT AND HOT-MIX ASPHALT TAPER DETAILS" UNLESS OTHERWISE SPECIFIED.

MODEL: Loomis Ave_E-1 - Loomis Roadway-2 (Sheet)
FILE NAME: c:\pwworking\inicholas.babul@illinois.gov\1109149\0119025-sh-plan.dgn

USER NAME = nicholas.babul	DESIGNED -	REVISED -
	DRAWN -	REVISED -
	CHECKED -	REVISED -
PLOT DATE = 3/31/2026	DATE -	REVISED -

**STATE OF ILLINOIS
DEPARTMENT OF TRANSPORTATION**

**ROADWAY AND PAVEMENT MARKING PLAN
LOOMIS ST. (150TH ST. TO THORNTON/VINCENNES RD.)**

SCALE: SHEET 2 OF 2 SHEETS STA. 40+00.00 TO STA. 70+00.00

F.A. RTE.	SECTION	COUNTY	TOTAL SHEETS	SHEET NO.
SBI 52	2025-2014-RS	COOK	24	8
CONTRACT NO. 80B33				
ILLINOIS FED. AID PROJECT				

ADA DETAIL FOR SINGLE PERPENDICULAR CURB RAMPS W/ EXIST. 5% OR LESS RUN. SLOPE

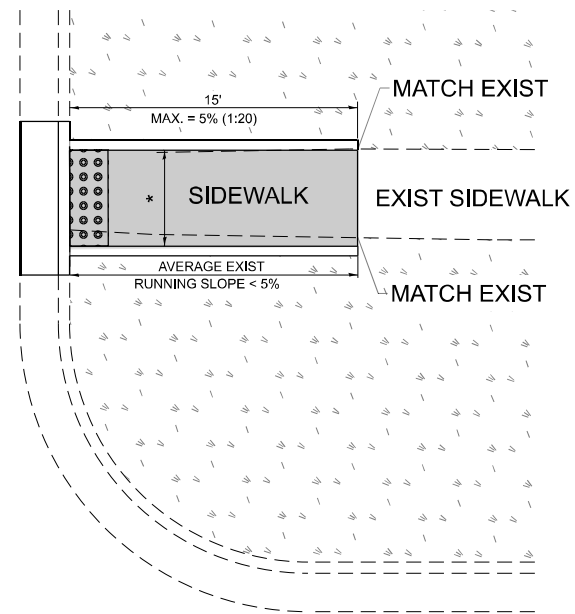

PD-01A

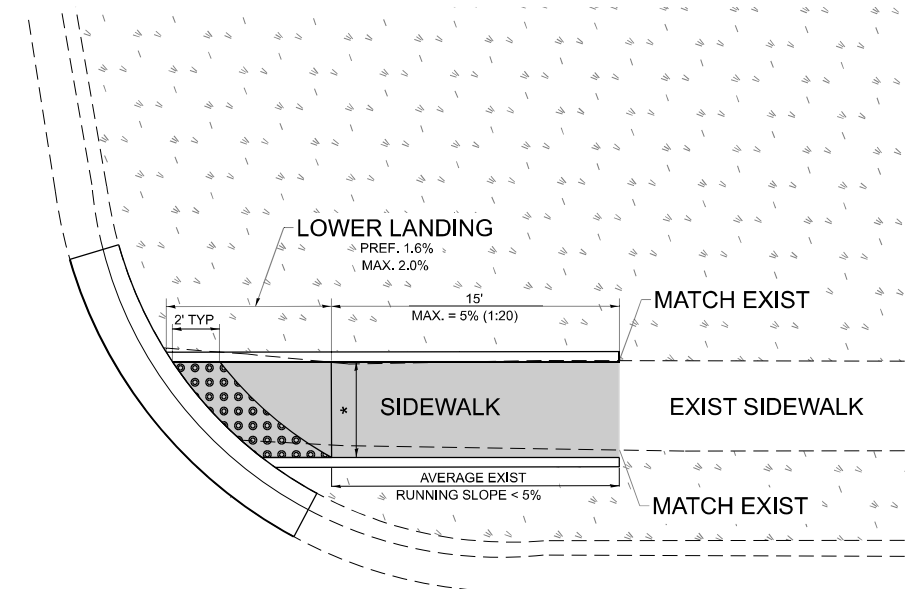

PD-01B

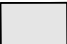

LEGEND

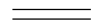
-  EXIST. GRASS
-  PROPOSED SIDEWALK
-  DETECTABLE WARNINGS
-  PROPOSED SIDE CURB

CONSTRUCTION NOTES:

- 1) ALL CROSS SLOPES ARE PREFERRED 1.6% (1:64), MAXIMUM 2% (1:50) EXCEPT WHEN TRANSITIONING TO EXISTING SIDEWALK
- * MATCH EXISTING SIDEWALK WIDTH

MODEL: PD-01 (Sheet)
FILE NAME: c:\pwworking\ntcholas.babu@illinois.gov\d1109149\d110925-sh-Dist\Sists.dgn

USER NAME = nicholas.babul	DESIGNED -	REVISED -
	DRAWN - R. LEDEZMA	REVISED -
	CHECKED -	REVISED -
PLOT DATE = 3/3/2026	DATE - 12/03/2025	REVISED -

**STATE OF ILLINOIS
DEPARTMENT OF TRANSPORTATION**

**PROJECT DETAIL FOR SINGLE PERPENDICULAR CURB RAMPS
(PD-01)**

SCALE: NONE SHEET 1 OF 1 SHEETS STA. TO STA.

F.A. RTE.	SECTION	COUNTY	TOTAL SHEETS	SHEET NO.
SBI 52	2025-2014-RS	COOK	24	11
PD-01			CONTRACT NO. 80B33	
ILLINOIS FED. AID PROJECT				

ADA DETAIL FOR SINGLE PERPENDICULAR CURB RAMPS W/ TURNING SPACE

PD-04A

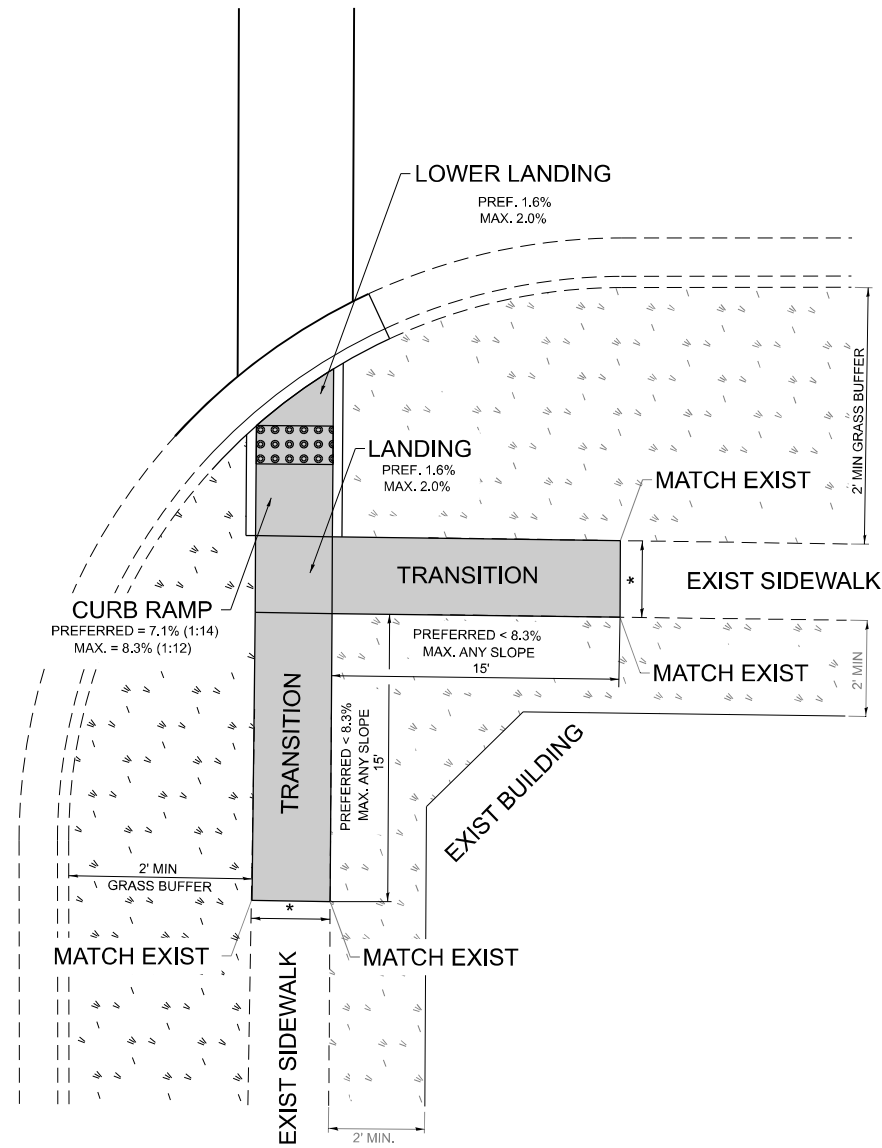

PD-04B

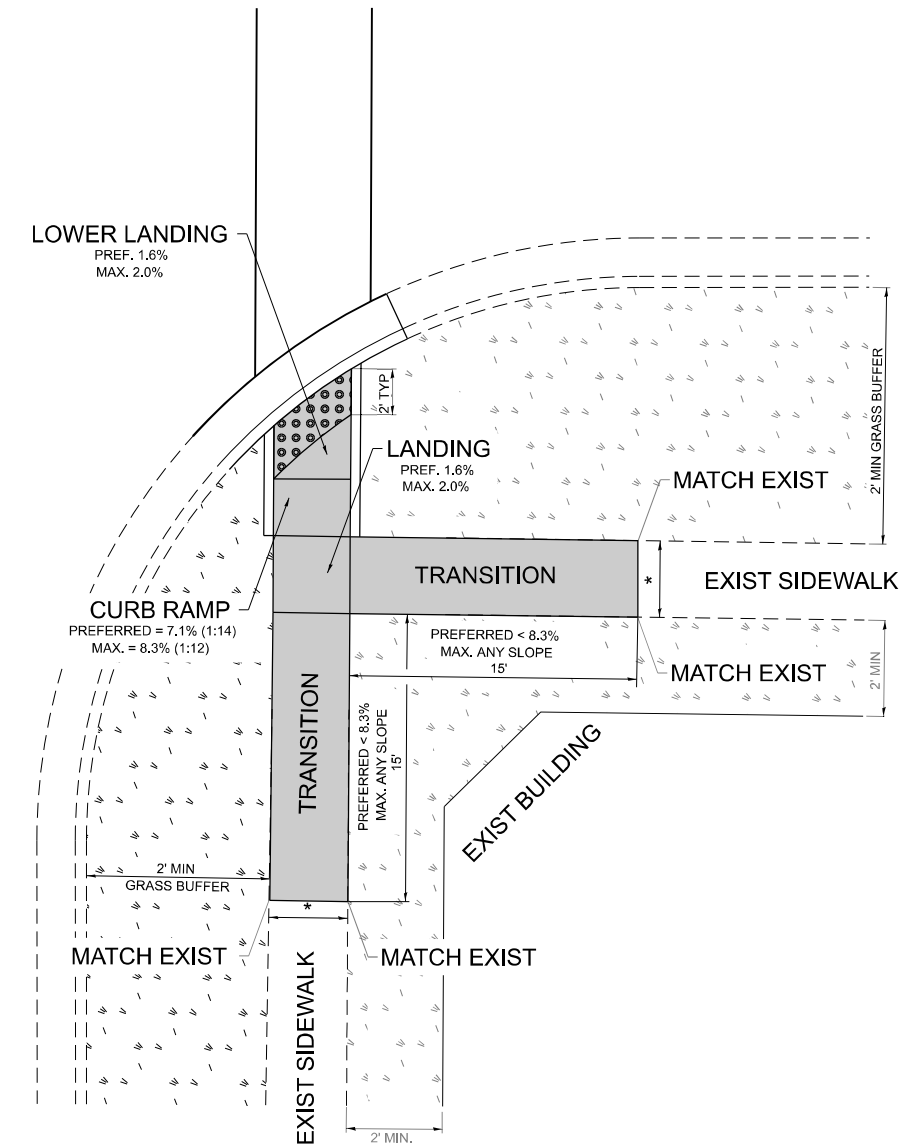

LEGEND

-  EXIST. GRASS
-  PROPOSED SIDEWALK
-  DETECTABLE WARNINGS
-  PROPOSED SIDE CURB

CONSTRUCTION NOTES:

- 1) ALL CROSS SLOPES ARE PREFERRED 1.6% (1:64), MAXIMUM 2% (1:50) EXCEPT WHEN TRANSITIONING TO EXISTING SIDEWALK
- * MATCH EXISTING SIDEWALK WIDTH

MODEL: PD-04 (Sheet)
FILE NAME: c:\pwworking\ntcholas.babul@illinois.gov\d1109149\d110925-sh-Dist-Dist.dgn

USER NAME = nicholas.babul	DESIGNED -	REVISED -
	DRAWN - R. LEDEZMA	REVISED -
	CHECKED -	REVISED -
PLOT DATE = 3/3/2026	DATE - 10/02/2019	REVISED -

**STATE OF ILLINOIS
DEPARTMENT OF TRANSPORTATION**

**PROJECT DETAIL FOR SINGLE PERPENDICULAR CURB RAMPS WITH
TURNING SPACE (PD-04)**

SCALE: NONE SHEET 1 OF 1 SHEETS STA. TO STA.

F.A. RTE.	SECTION	COUNTY	TOTAL SHEETS	SHEET NO.
SBI 52	2025-2014-RS	COOK	24	13
PD-04		CONTRACT NO. 80B33		
ILLINOIS FED. AID PROJECT				

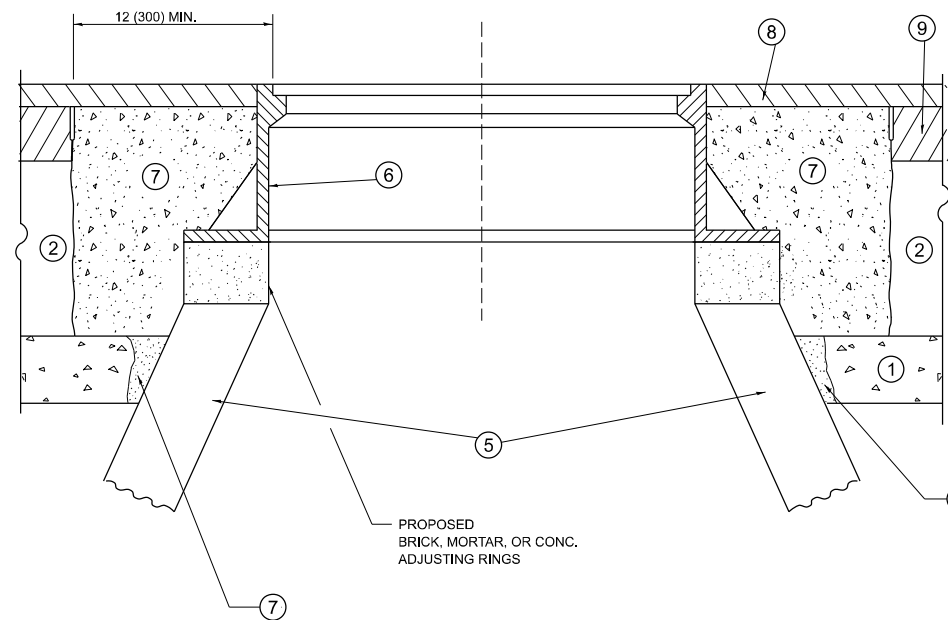
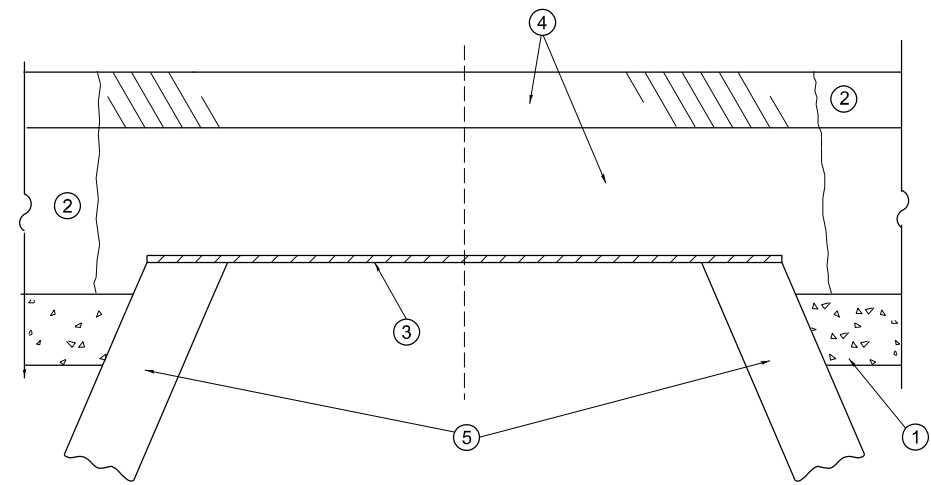

**DETAILS FOR FRAMES AND LIDS ADJUSTMENT
WITH MILLING**

NOTES

1. EXISTING BROKEN FRAMES AND LIDS SHALL BE REMOVED AND DISPOSED OF BY THE CONTRACTOR AND SHALL BE REPLACED AS DIRECTED BY THE ENGINEER. REPLACEMENT FRAMES AND LIDS WILL BE PAID FOR IN ACCORDANCE WITH ARTICLE 109.04 OF THE STANDARD SPECIFICATIONS UNLESS A SEPARATE PAY ITEM HAS BEEN PROVIDED.
2. IF THE EXISTING LIDS ARE OPEN, THE FRAME WILL BE ADJUSTED TO THE ELEVATION OF THE MILLED PAVEMENT SURFACE PRIOR TO THE MILLING OPERATION. THE FRAME WILL NOT BE REMOVED AND COVERED BY THE METAL PLATE.
3. CITY OF CHICAGO CASTINGS ARE THE PROPERTY OF THE CITY AND THE CONTRACTOR SHALL NOTIFY THE CITY FOR REMOVAL AND DISPOSITION OF THE CASTINGS.
4. THE METAL PLATE USED TO COVER THE STRUCTURE SHALL REMAIN THE PROPERTY OF THE CONTRACTOR.
5. THE CONTRACTOR SHALL REMOVE ALL TRAFFIC CONTROL DEVICES BY THE END OF EACH WORK SHIFT.

CONSTRUCTION PROCEDURES

STAGE 1 (BEFORE PAVEMENT MILLING)

- A) REMOVE A MINIMUM OF 12 (300) OF THE PAVEMENT FROM AROUND THE STRUCTURE.
- B) REMOVE THE EXISTING FRAME AND LID FROM THE STRUCTURE.
- C) COVER THE STRUCTURE OPENING WITH A 36 (900) DIAMETER METAL PLATE.
- D) BACKFILL WITH CRUSHED STONE AND HMA SURFACE MIX APPROVED BY THE ENGINEER. (MIN. 3 (80) HMA TO REMAIN AFTER MILLING).

STAGE 2 (AFTER PAVEMENT MILLING)

- A) REMOVE THE HMA SURFACE MIX AND CRUSHED STONE.
- B) INSTALL THE FRAME AND LID; ADJUST THE FRAME TO ITS FINAL SURFACE ELEVATION.
- C) THE SURROUNDING SPACE SHALL BE FILLED WITH CLASS PP-2* CONCRETE TO THE ELEVATION OF THE SURFACE OF THE EXISTING BASE COURSE OR THE BINDER COURSE.

*UNLESS OTHERWISE SPECIFIED IN THE PLANS.

THE PROCEDURE EXPLAINED ABOVE SHALL CONFORM TO THE APPLICABLE PORTIONS OF SECTIONS 353, 406, 602, AND 603 OF THE STANDARD SPECIFICATIONS EXCEPT THAT "THE CONTRACTOR SHALL ADJUST THE STRUCTURES TO THE FINISHED PAVEMENT ELEVATION NO MORE THAN 5 CALENDAR DAYS PRIOR TO PLACEMENT OF THE FINAL LIFT OF SURFACE UNLESS APPROVED BY THE ENGINEER."

LEGEND

- | | |
|--|-------------------------------|
| ① SUB-BASE GRANULAR MATERIAL | ⑥ FRAME AND LID (SEE NOTES) |
| ② EXISTING PAVEMENT | ⑦ CLASS PP-2* CONCRETE |
| ③ 36 (900) DIAMETER METAL PLATE | ⑧ PROPOSED HMA SURFACE COURSE |
| ④ PROPOSED CRUSHED STONE AND HMA SURFACE MIX | ⑨ PROPOSED HMA BINDER COURSE |
| ⑤ EXISTING STRUCTURE | |

LOCATION OF STRUCTURES

THE CONTRACTOR WILL BE REQUIRED TO KEEP A RECORD OF THE LOCATIONS OF THE BURIED STRUCTURES ACCORDING TO THE STATION AND DISTANCE LEFT OR RIGHT OF THE CENTERLINE OF PAVEMENT. UPON COMPLETION OF THE WORK, THE CONTRACTOR WILL DELIVER THE RECORD TO THE ENGINEER.

BASIS OF PAYMENT

1. REMOVING FRAMES AND LIDS ON DRAINAGE AND UTILITY STRUCTURES IN THE PAVEMENT PRIOR TO MILLING, AND ADJUSTING TO FINAL GRADE PRIOR TO PLACING THE SURFACE COURSE, WILL BE PAID FOR AT THE CONTRACT UNIT PRICE EACH FOR "FRAMES AND LIDS TO BE ADJUSTED (SPECIAL)."
2. THIS WORK WILL NOT BE PAID FOR WHEN DRAINAGE AND UTILITY STRUCTURES ARE SPECIFIED FOR PAYMENT AS STRUCTURE RECONSTRUCTION.
3. NEW FRAMES AND LIDS, WHEN SPECIFIED, WILL BE PAID FOR SEPARATELY.
4. WHEN STRUCTURES ARE TO BE ADJUSTED OR RECONSTRUCTED, THE LOWERING AND RAISING OF THE FRAMES AND LIDS WILL NOT BE PAID FOR SEPARATELY BUT WILL BE INCLUDED IN THE COST OF THE CORRESPONDING PAY ITEM.

ALL DIMENSIONS ARE IN INCHES (MILLIMETERS) UNLESS OTHERWISE SHOWN

MODEL: BD-08 (Sheet)
FILE NAME: c:\p\work\wv\wv\in\cholas.babul\illinois.gov\1109149\1109149-25-sh-1-Dist\Dist.dgn

USER NAME = nicholas.babul	DESIGNED - R. SHAH	REVISED - R. BORO 03-09-11
	DRAWN -	REVISED - R. BORO 12-06-11
	CHECKED -	REVISED - K. SMITH 11-18-22
PLOT DATE = 3/3/2026	DATE - 10-25-94	REVISED - K. SMITH 09-15-23

**STATE OF ILLINOIS
DEPARTMENT OF TRANSPORTATION**

**DETAILS FOR
FRAMES AND LIDS ADJUSTMENT WITH MILLING**

SCALE: NONE SHEET 1 OF 1 SHEETS STA. TO STA.

F.A. RTE.	SECTION	COUNTY	TOTAL SHEETS	SHEET NO.
SBI 52	2025-2014-RS	COOK	24	14
BD600-03 (BD-08)			CONTRACT NO. 80B33	
ILLINOIS FED. AID PROJECT				

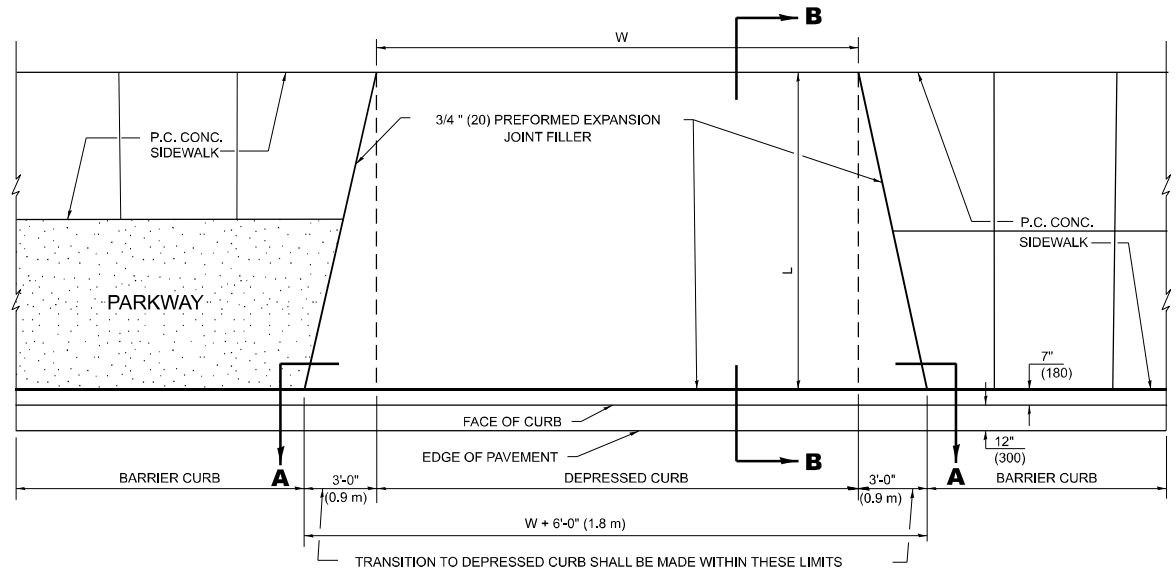

PLAN VIEW

NOTES:

1. EXPANSION JOINTS SHALL BE CONSTRUCTED AS SHOWN ON THE DETAILS FOR P.C.C. SIDEWALK.
2. THE CURB BETWEEN ADJACENT DRIVEWAYS SHALL BE FULL HEIGHT FOR A DISTANCE OF AT LEAST FOUR FEET (1.2 METERS).
3. P.C. CONCRETE DRIVEWAYS SHALL BE CONSTRUCTED AT LOCATIONS SHOWN ON THE PLANS OR AS DIRECTED BY THE ENGINEER.

BASIS OF PAVEMENT

1. 3/4" (20) PREFORMED EXPANSION JOINTS WILL NOT BE PAID FOR SEPARATELY BUT SHALL BE INCLUDED IN P.C.C. DRIVEWAY PAVEMENT 8" (200).
2. COMBINATION CONC. CURB AND GUTTER SHALL BE MEASURED STRAIGHT ACROSS THE DRIVEWAY. NO ADDITIONAL COMPENSATION WILL BE ALLOWED FOR THE TRANSITION CURB AND GUTTER.

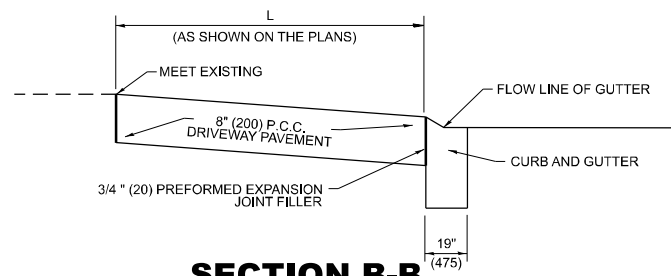

SECTION B-B

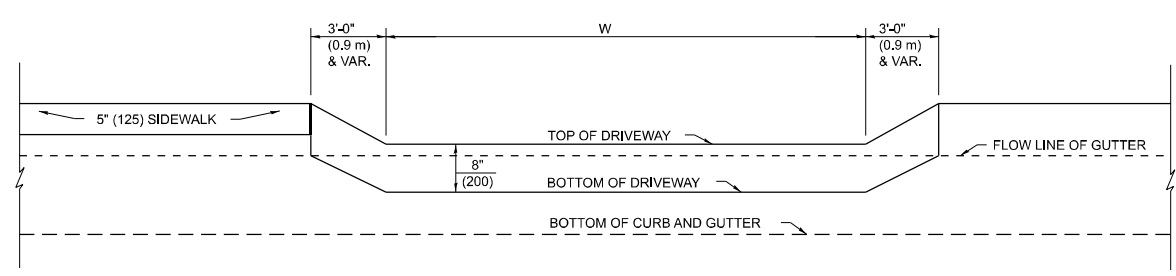

**SECTION A-A
P.C.C. DRIVEWAY PAVEMENT DETAIL**

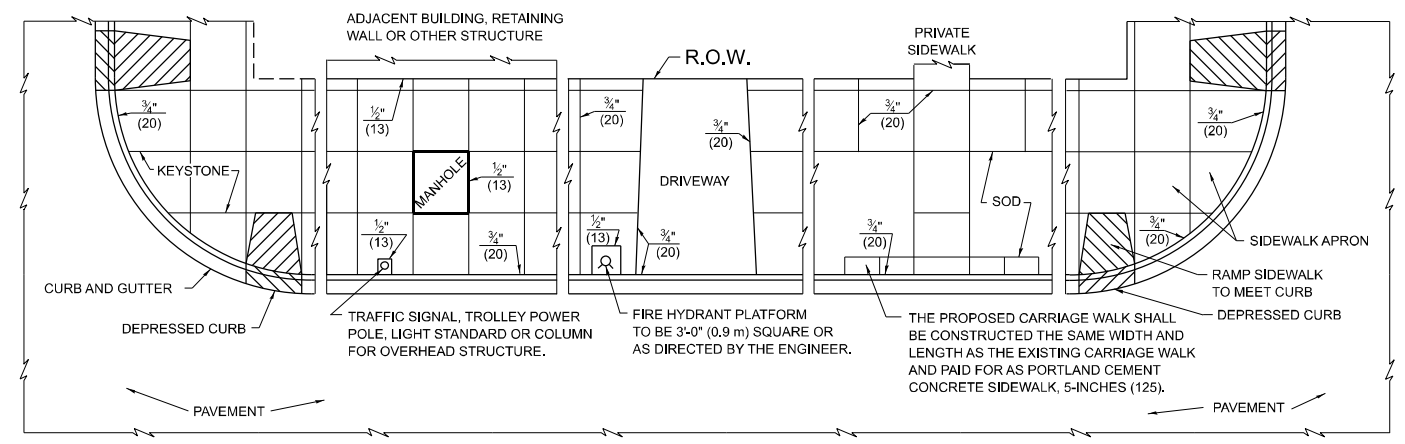

NOTES:

1. ONE-HALF INCH THICK EXPANSION JOINTS SHALL BE PLACED BETWEEN THE SIDEWALK AND ALL STRUCTURES SUCH AS LIGHT STANDARDS, TRAFFIC LIGHT STANDARDS, MANHOLES, WHICH EXTEND THROUGH THE SIDEWALK.
2. 3/4" (20) THICK EXPANSION JOINTS SHALL BE PLACED AT INTERVALS OF NOT MORE THAN 100 FEET (30 METERS) IN THE SIDEWALK, WHERE THE SIDEWALK IS CONSTRUCTED ADJACENT TO PAVEMENT OR CURB HAVING EXPANSION JOINTS, THE EXPANSION JOINTS IN THE SIDEWALK SHALL BE PLACED OPPOSITE THE EXISTING EXPANSION JOINTS AS NEARLY AS PRACTICABLE. EXPANSION JOINTS SHALL ALSO BE PLACED WHERE THE SIDEWALK ABUTS EXISTING SIDEWALKS, BETWEEN DRIVEWAY PAVEMENT AND SIDEWALK, AND BETWEEN SIDEWALK AND CURBS WHERE THE SIDEWALK ABUTS THE CURB.

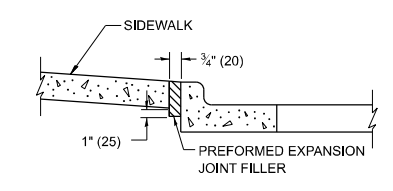

SLOPE FOR SIDEWALK
1" (25) IN 3'-0" (0.9 m) IN CHICAGO

PORTLAND CEMENT CONCRETE SIDEWALK DETAILS

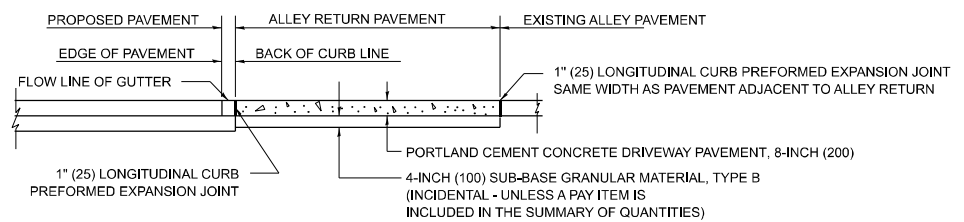
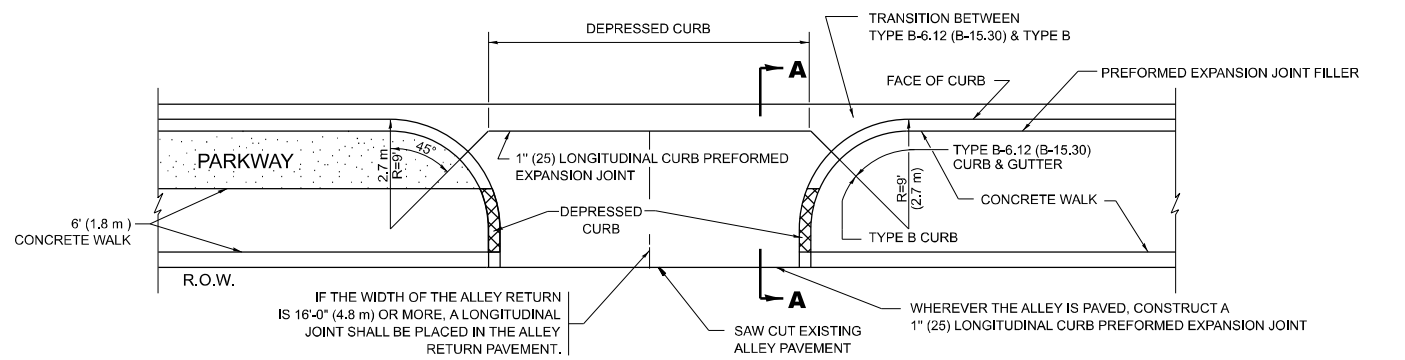

SECTION A-A

ALLEY RETURN DETAIL

BASIS OF PAVEMENT

1. SUB-BASE GRANULAR MATERIAL TYPE B SHALL BE PAID FOR SEPARATELY.
2. NO EXTRA COMPENSATION SHALL BE ALLOWED FOR THE GUTTER FLARE.

ALL DIMENSIONS ARE IN INCHES (MILLIMETERS) UNLESS OTHERWISE SHOWN

MODEL: BD-17 (Sheet) FILE NAME: c:\pwwork\w\chicobas.babul\illinois.gov\1109149\110925-sh-Dis\Dis.dgn

USER NAME = nicholas.babul	DESIGNED - M. DE YONG	REVISED - K. SMITH 02-01-22
	DRAWN -	REVISED - K. SMITH 11-18-22
	CHECKED -	REVISED -
PLOT DATE = 3/3/2026	DATE - 06-13-90	REVISED -

**STATE OF ILLINOIS
DEPARTMENT OF TRANSPORTATION**

**CITY OF CHICAGO
DETAILS FOR P.C. CONCRETE DRIVEWAY, ALLEY RETURN AND SIDEWALK**

SCALE: NONE SHEET 1 OF 1 SHEETS STA. TO STA.

F.A. RTE.	SECTION	COUNTY	TOTAL SHEETS	SHEET NO.
981 52	2025-2014-RS	COOK	24	15
BD400-03 (BD-17)		CONTRACT NO. 80B33		
ILLINOIS FED. AID PROJECT				

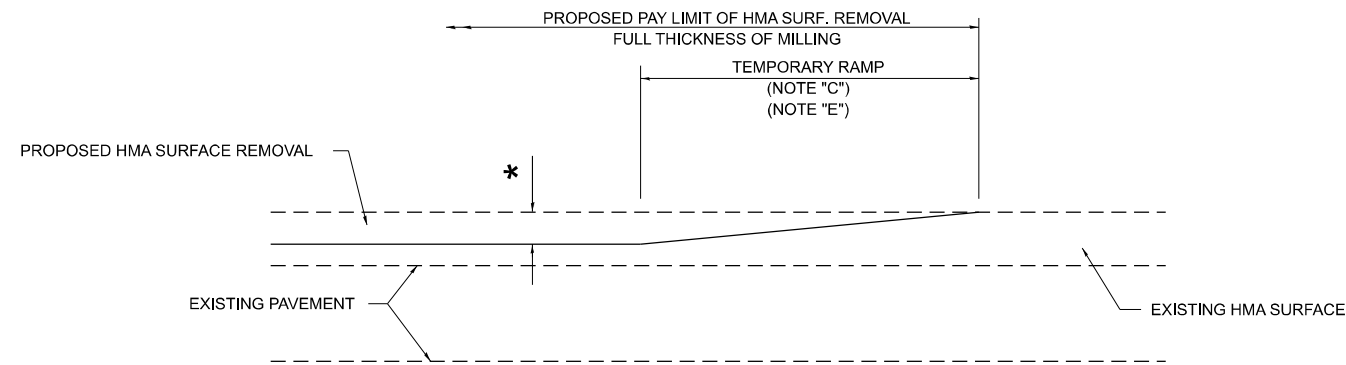

MILLED TEMPORARY RAMP

(FOR BUTT JOINT AND HMA TAPER SEE DETAIL BELOW)

OPTION 1

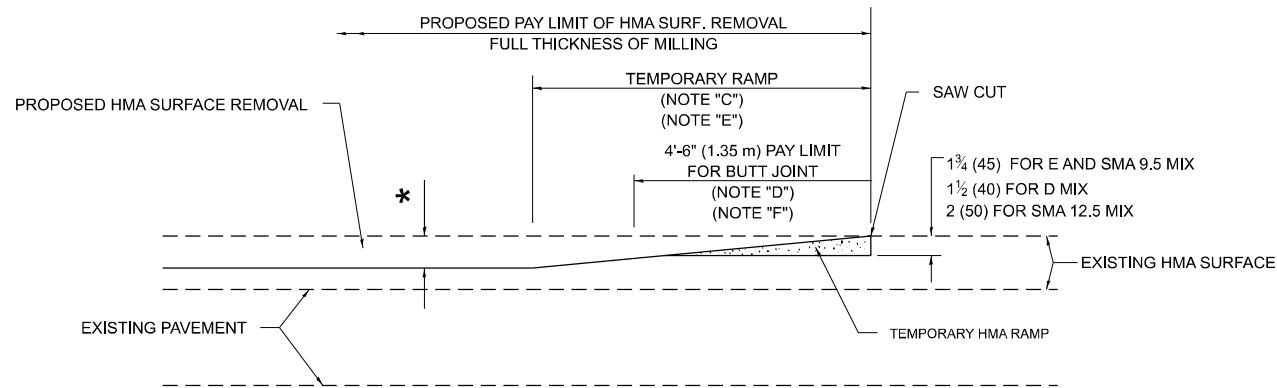

HMA CONSTRUCTED TEMPORARY RAMP

(FOR BUTT JOINT AND HMA TAPER SEE DETAIL BELOW)

OPTION 2

TYPICAL TEMPORARY RAMP

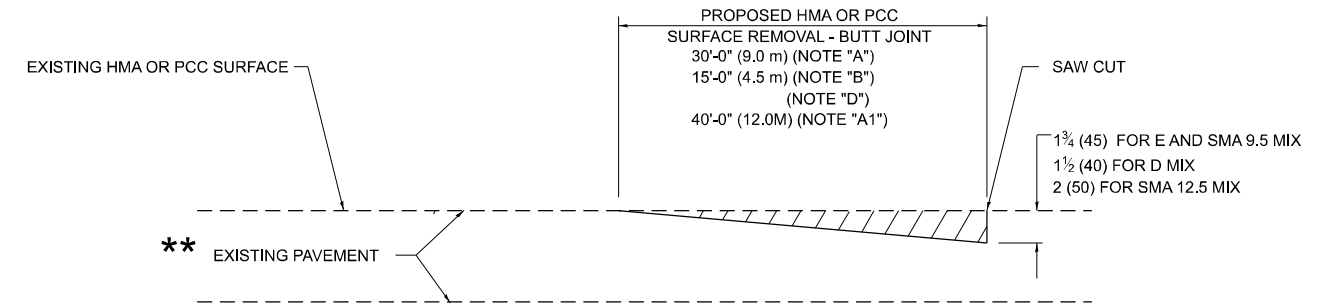

BUTT JOINT DETAIL

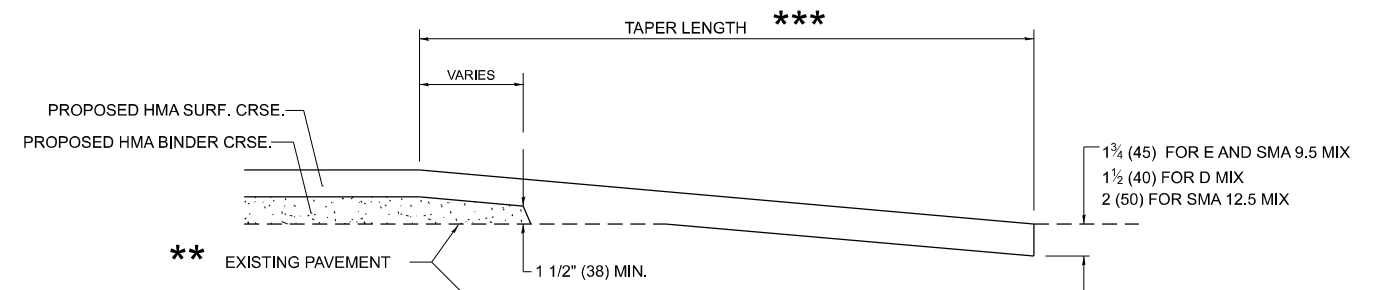

HMA TAPER DETAIL

TYPICAL BUTT JOINT AND HMA TAPER FOR RESURFACING ONLY

** PC CONCRETE, HMA OR HMA RESURFACED PAVEMENT.

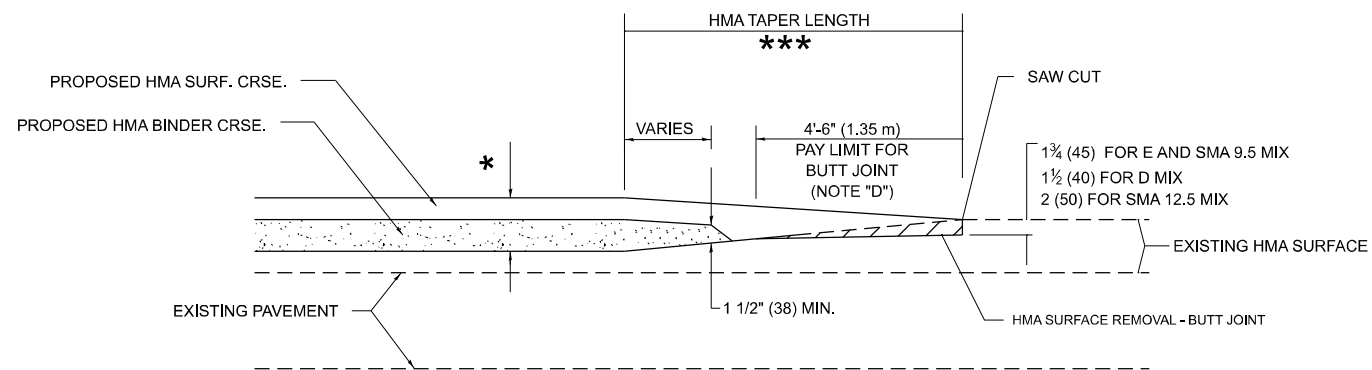

BUTT JOINT AND HMA TAPER

TYPICAL BUTT JOINT AND HMA TAPER FOR MILLING AND RESURFACING

GENERAL NOTES

- A. MAINLINE ARTERIAL ROADWAYS AND MAJOR SIDE ROADS.
- A1. INTERSTATES
- B. MINOR SIDE ROADS.
- C. THE TEMP. RAMP SHALL BE CONSTRUCTED IMMEDIATELY UPON REMOVAL OF THE EXISTING HMA SURFACE.
- D. THE BUTT JOINT SHALL BE CONSTRUCTED IMMEDIATELY PRIOR TO PLACING THE PROPOSED HMA COURSES.
- E. TAPER THE TEMP. RAMP AT A RATE OF 3' - 4" (1.02m) PER 1 INCH (25 mm) OF MILLING THICKNESS.
* SEE TYPICAL SECTIONS FOR MILLING THICKNESS.
- F. SEE ARTICLE 406.08 AND 406.14 OF THE STANDARD SPECIFICATIONS FOR "HMA AND/OR PCC SURFACE REMOVAL, BUTT JOINT".

20'-0" (6.1 m) PER 1 (25) RESURFACING (NOTE "A")
10'-0" (3.0 m) PER 1 (25) RESURFACING (NOTE "B")

BASIS OF PAYMENT

- 1. THE BUTT JOINT WILL BE PAID FOR AT THE CONTRACT UNIT PRICE PER SQUARE YARD (SQUARE METER) FOR "HOT-MIX ASPHALT SURFACE REMOVAL - BUTT JOINT" OR FOR "PORTLAND CEMENT CONCRETE SURFACE REMOVAL - BUTT JOINT".
- 2. THE TEMPORARY RAMP AND SAW CUT SHALL BE INCLUDED IN THE UNIT COST FOR HMA OR PCC SURFACE REMOVAL-BUTT JOINT.

ALL DIMENSIONS ARE IN INCHES (MILLIMETERS) UNLESS OTHERWISE SHOWN.

MODEL: BD-32 (Sheet)
FILE NAME: c:\paw_wor\k\vw\ch\ntch\bas.babul\illinois.gov\1109149\110925-sh-Dis\Sts.dgn

USER NAME = nicholas.babul	DESIGNED - M. DE YONG	REVISED - A. ABBAS 03-21-97
	DRAWN -	REVISED - M. GOMEZ 04-06-01
	CHECKED -	REVISED - R. BORO 01-01-07
PLOT DATE = 3/3/2026	DATE - 06-13-90	REVISED - K. SMITH 11-18-22

STATE OF ILLINOIS
DEPARTMENT OF TRANSPORTATION

BUTT JOINT AND HMA TAPER DETAILS

SCALE: NONE SHEET 1 OF 1 SHEETS STA. TO STA.

F.A. RTE.	SECTION	COUNTY	TOTAL SHEETS	SHEET NO.
SBI 52	2025-2014-RS	COOK	24	18
BD400-05 BD-32		CONTRACT NO. 80B33		
ILLINOIS FED. AID PROJECT				

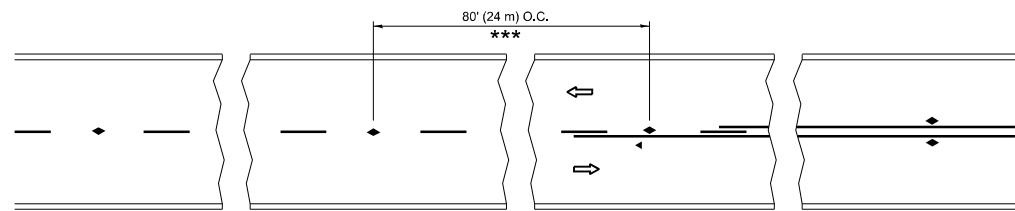

*** REDUCE TO 40' (12 m) O.C. ON CURVES WITH POSTED OR ADVISORY SPEED 45 M.P.H. (70 km/h) OR LESS.

TWO-LANE/TWO-WAY

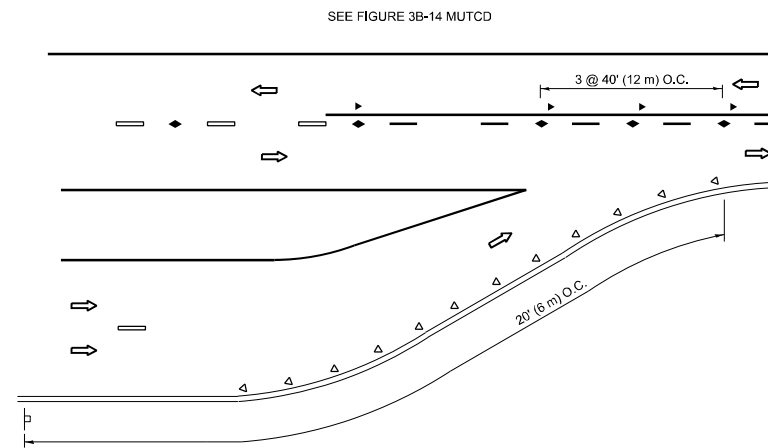

LANE REDUCTION TRANSITION

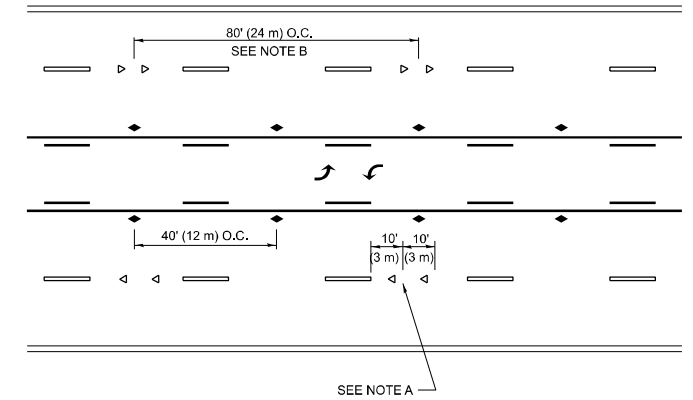

TWO-WAY LEFT TURN

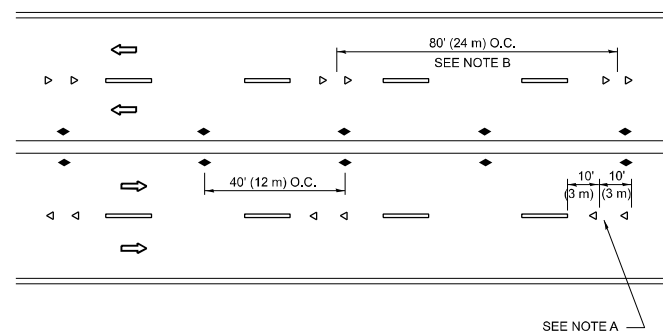

MULTI-LANE/UNDIVIDED

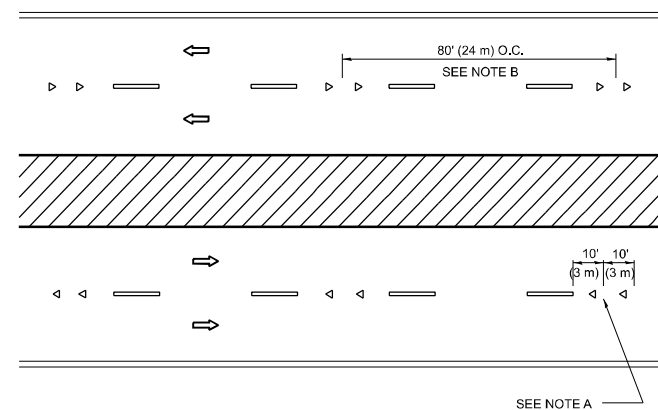

MULTI-LANE/DIVIDED

GENERAL NOTES

1. MARKERS USED WITH DASHED LINES SHALL BE CENTERED IN THE GAP BETWEEN SEGMENTS.
2. MARKERS USED ADJACENT TO SOLID LINES SHALL BE OFFSET 2 TO 3 (50 TO 75) TOWARD TRAFFIC AS SHOWN.
3. MARKERS THROUGH TANGENTS LESS THAN 500' (150 m) IN LENGTH BETWEEN CURVES SHALL BE INSTALLED AT THE LESSER OF THE TWO CURVE SPACINGS.
4. MARKERS ARE TO BE USED ADJACENT TO BOTH SOLID WHITE LINES IN DUAL LEFT TURN LANES

SYMBOLS

- YELLOW STRIPE
- WHITE STRIPE
- ◀ ONE-WAY AMBER MARKER
- ◀ ONE-WAY CRYSTAL MARKER (W/O)
- ◆ TWO-WAY AMBER MARKER

LANE MARKER NOTES

- A. USE DOUBLE LANE LINE MARKERS SPACED AS SHOWN.
- B. REDUCE TO 40' (12 m) O.C. ON CURVES WHERE ADVISORY SPEEDS ARE 10 M.P.H (20 km/h) LOWER THAN POSTED SPEEDS.

DESIGN NOTES

1. DOUBLE LANE LINE MARKERS SHALL BE USED UNLESS SPECIFIED OTHERWISE.
2. EXCEPT AS SHOWN ON THE LANE REDUCTION TRANSITION AND FREEWAY EXIT RAMP DETAIL, MARKERS ARE NOT TO BE SPECIFIED ON RIGHT EDGE LINES.
3. THE EXACT MARKER LIMITS, SPACING, AND COLOR SHALL BE INCLUDED IN THE PLANS WHEN STANDARD SPECIFICATIONS ARE NOT BEING USED.
4. MARKERS SHOULD NOT BE USED ALONGSIDE CURBS EXCEPT FOR EXTREMELY SHORT SECTIONS OF CURBS WHERE NOT MORE THAN TWO MARKERS WOULD BE INVOLVED.

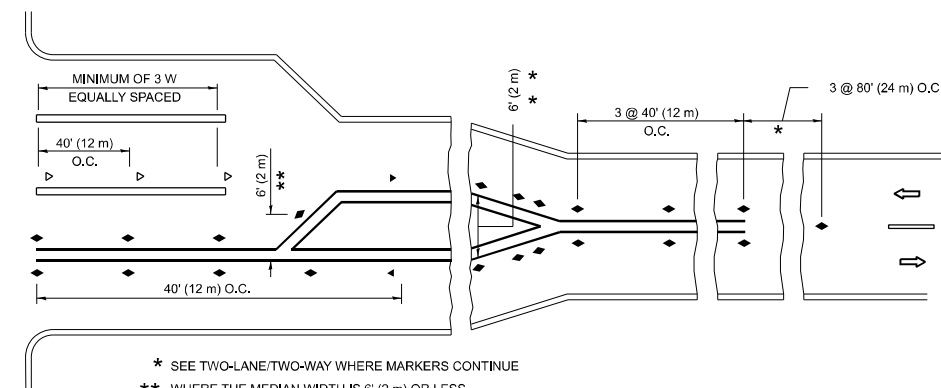
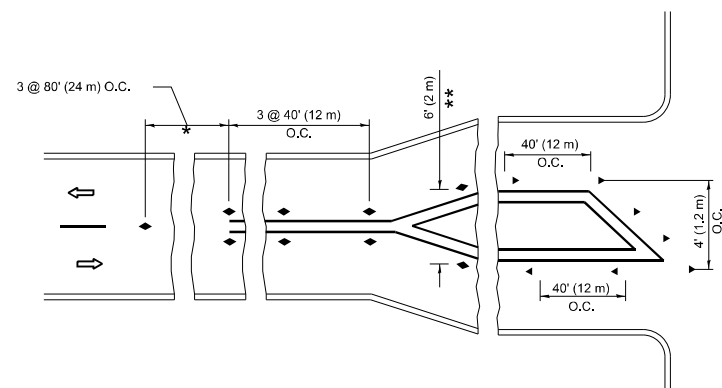

* SEE TWO-LANE/TWO-WAY WHERE MARKERS CONTINUE
 ** WHERE THE MEDIAN WIDTH IS 6' (2 m) OR LESS USE TWO-WAY MARKERS.

TURN LANES

All dimensions are in inches (millimeters) unless otherwise shown.

MODEL: TC-11 (Sheet)
 FILE NAME: c:\p\work\pavement\cholas.babul\illinois.gov\1109149\110925-sh-Dist-Dist.dwg

USER NAME = nicholas.babul	DESIGNED -	REVISED - T. RAMMACHER 03-12-99
	DRAWN -	REVISED - T. RAMMACHER 01-06-00
	CHECKED -	REVISED - C. JUCIUS 09-09-09
PLOT DATE = 3/3/2026	DATE -	REVISED - C. JUCIUS 07-01-13

STATE OF ILLINOIS
 DEPARTMENT OF TRANSPORTATION

TYPICAL APPLICATIONS
 RAISED REFLECTIVE PAVEMENT MARKERS (SNOW-PLOW RESISTANT)

SCALE: NONE SHEET 1 OF 1 SHEETS STA. TO STA.

F.A. RTE.	SECTION	COUNTY	TOTAL SHEETS	SHEET NO.
SBI 52	2025-2014-RS	COOK	24	20
TC-11			CONTRACT NO. 80B33	
ILLINOIS FED. AID PROJECT				

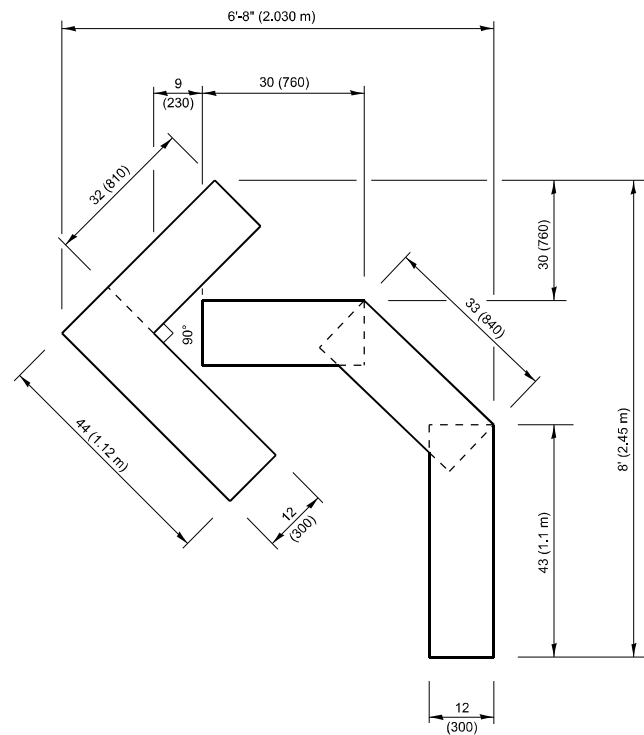

QUANTITY

4 (100) LINE = 45.5 ft. (13.9 m)
15.2 sq. ft. (1.41 sq. m)

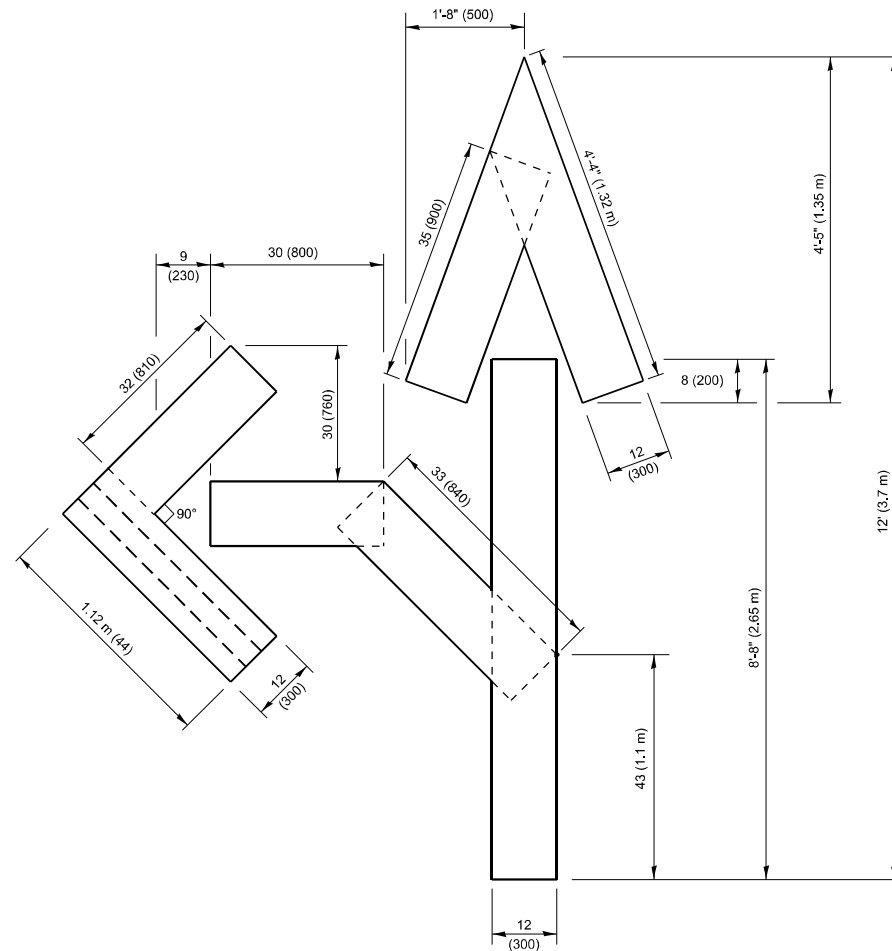

QUANTITY

4 (100) LINE = 82.5 ft. (25.1 m)
27.5 sq. ft. (2.53 sq. m)

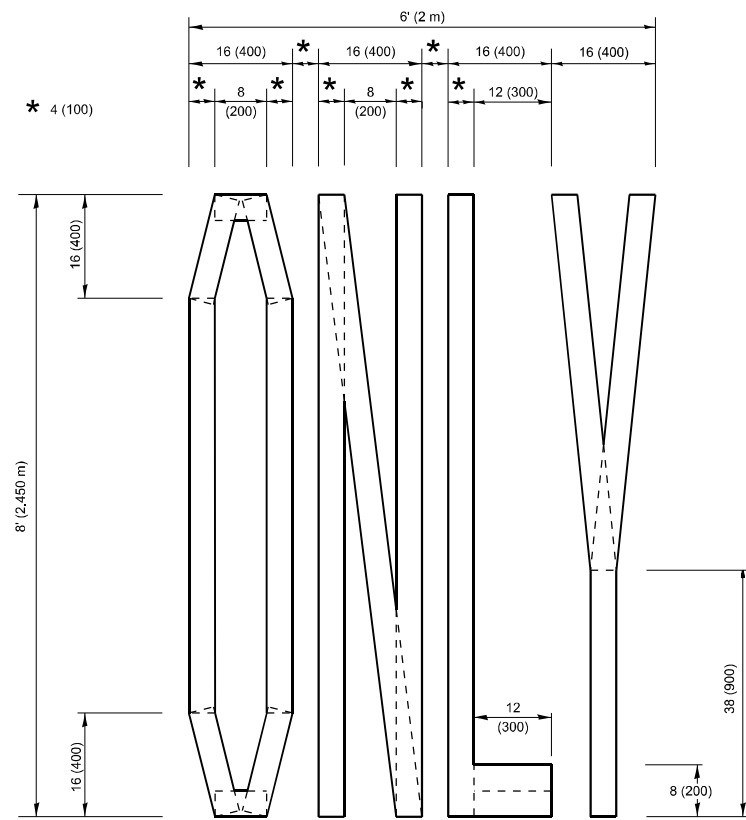

QUANTITY

4 (100) LINE = 64.1 ft. (19.5 m)
21.4 sq. ft. (1.99 sq. m)

NOTE:

ALL QUANTITIES OF PLACEMENT ARE REPRESENTED IN LINEAR FEET OF 4" LINES TO MATCH THE 4" TEMPORARY TAPE PAY ITEM AND REPRESENTS THE TOTAL QUANTITY OF 4" TAPE REQUIRED.

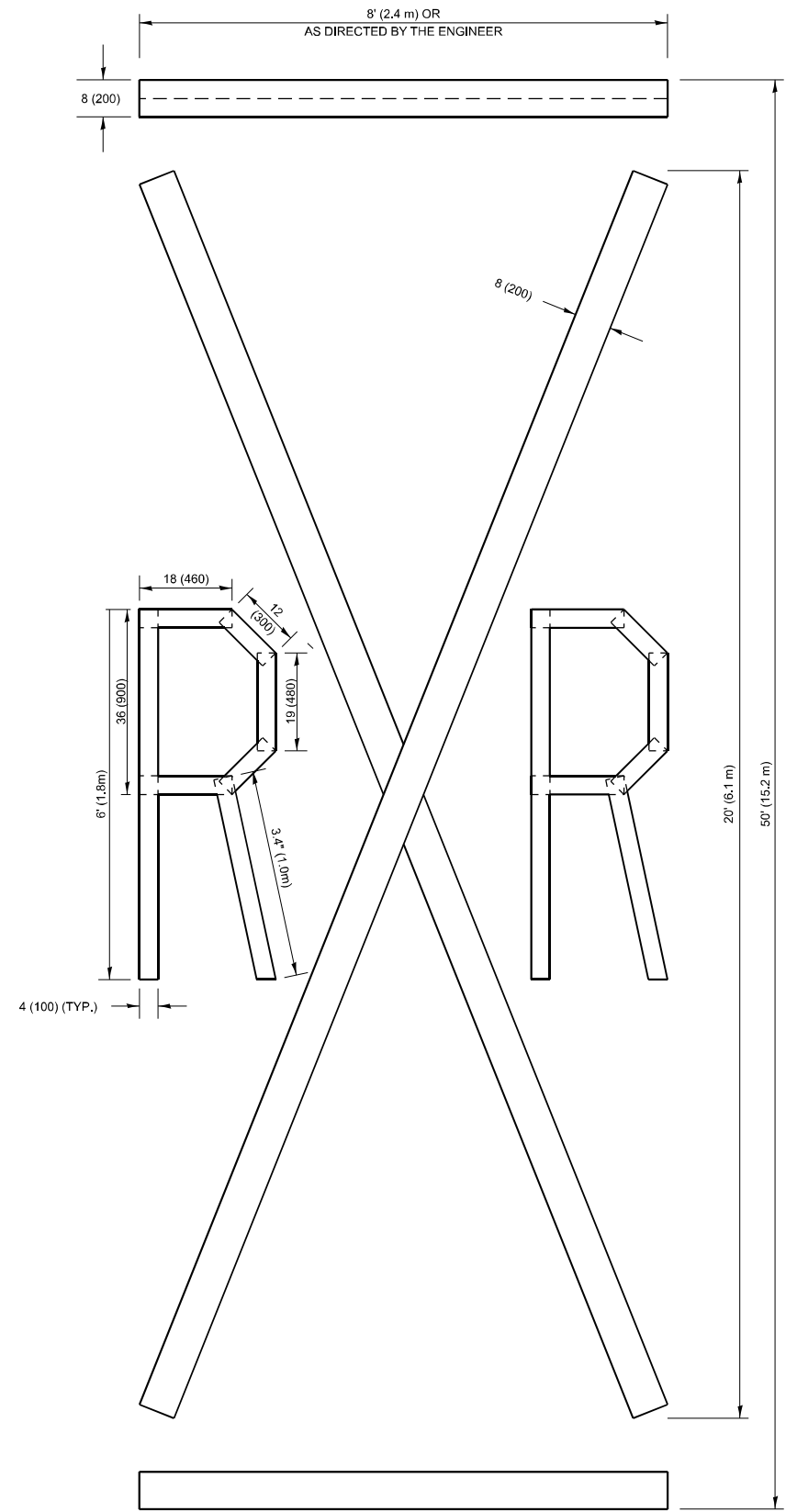

QUANTITY

4 (100) LINE = 225.9 ft. (68.9 m)
75.3 sq. ft. (6.99 sq. m)

All dimensions are in inches (millimeters) unless otherwise shown.

MODEL: TC-16 (Sheet)
FILE NAME: c:\p\work\pav\in\cholas.babul\illinois.gov\1109149\1109149-D119525-sh-Dis\Dist\sis.dgn

USER NAME = nicholas.babul	DESIGNED -	REVISED - T. RAMMACHER 03-02-98
	DRAWN -	REVISED - E. GOMEZ 08-28-00
	CHECKED -	REVISED - E. GOMEZ 08-28-00
PLOT DATE = 3/3/2026	DATE - 09-18-94	REVISED - A. SCHUETZE 09-15-16

**STATE OF ILLINOIS
DEPARTMENT OF TRANSPORTATION**

SHORT TERM PAVEMENT MARKING LETTERS AND SYMBOLS

SCALE: NONE SHEET 1 OF 1 SHEETS STA. TO STA.

F.A. RTE.	SECTION	COUNTY	TOTAL SHEETS	SHEET NO.
SBI 52	2025-2014-RS	COOK	24	22
TC-16		CONTRACT NO. 80B33		
ILLINOIS FED. AID PROJECT				

