

06-12-2026 LETTING ITEM 039

STATE OF ILLINOIS  
DEPARTMENT OF TRANSPORTATION

FAU ROUTE	SECTION	COUNTY	TOTAL SHEETS	SHEET NO.
2305	25-00037-00-RS	KANE	26	1
ILLINOIS CONTRACT NO. 61M42				

FOR INDEX OF SHEETS, SEE SHEET NO. 2  
FOR LIST OF HIGHWAY STANDARDS, SEE SHEET NO. 2

# PLANS FOR PROPOSED FEDERAL AID HIGHWAY

FAU ROUTE 2305 (WHEELER ROAD)  
FROM ESKER DRIVE TO 700-FEET WEST OF ILLINOIS ROUTE 47  
ROAD RESURFACING IMPROVEMENTS  
SECTION NO.: 25-00037-00-RS  
PROJECT NO.: S6NX(960)  
VILLAGE OF SUGAR GROVE  
KANE COUNTY  
C-91-177-26

TRAFFIC DATA  
ADT:  
WHEELER ROAD

2023 TRAFFIC  
625-1,300 VPD

ROADWAY  
WHEELER ROAD

SPEED LIMIT  
40-45 MPH

DESIGN SPEED  
45 MPH

DESIGN DESIGNATION  
WHEELER ROAD - MINOR COLLECTOR



LOCATION OF SECTION INDICATED THIS: -



2363 SEQUOIA DRIVE SUITE 101 | AURORA, ILLINOIS 80508  
Phone: 630.553.7500 | Toll Free: 800.728.7605 | Fax: 630.553.7646 | HRGreen.com  
ILLINOIS PROFESSIONAL DESIGN FIRM #184-001322

STATE OF ILLINOIS  
DEPARTMENT OF TRANSPORTATION

APPROVED 3-2 2026  
[Signature]  
VILLAGE OF SUGAR GROVE DIRECTOR OF PUBLIC WORKS

PASSED April 9 2026  
[Signature]  
DISTRICT ONE ENGINEER OF LOCAL ROADS AND STREETS

REVIEWING FOR  
BID BASED ON  
LIMITED  
REVIEW Apr 9 2026  
[Signature] REGIONAL ENGINEER

PRINTED BY THE AUTHORITY  
OF THE STATE OF ILLINOIS



PROJECT LOCATION MAP  
NOT TO SCALE  
GROSS LENGTH = 8,198 FT. = 1.55 MILES  
NET LENGTH = 8,198 FT. = 1.55 MILES



[Signature] 3/2/2026  
JEFFREY R. STANKO, P.E.  
NO. 062-060033  
EXPIRES: 11/30/2027  
HR GREEN, INC.



FULL SIZE PLANS HAVE BEEN PREPARED USING STANDARD  
ENGINEERING SCALES. REDUCED SIZED PLANS WILL NOT  
CONFORM TO STANDARD SCALES. IN MAKING MEASUREMENTS  
ON REDUCED PLANS, THE ABOVE SCALES MAY BE USED.

J.U.L.I.E.  
JOINT UTILITY LOCATION INFORMATION FOR EXCAVATION  
1-800-892-0123  
OR 811

PROJECT ENGINEER: COLBY WEDWICK, P.E.  
PROJECT MANAGER: JEFF STANKO, P.E.

CONTRACT NO. 61M42

FEDERAL AID PROGRAM ENGINEER: CARMEN E. RAMOS, P.E., SCHAUMBURG, IL

**INDEX OF SHEETS**

1	COVER SHEET
2	INDEX OF SHEETS, LIST OF HIGHWAY STANDARDS, GENERAL NOTES, AND COMMITMENTS
3 - 5	SUMMARY OF QUANTITIES
6 - 7	TYPICAL SECTIONS
8 - 10	SCHEDULE OF QUANTITIES
11 - 18	RESURFACING PLANS
19 - 26	MISCELLANEOUS DETAILS

**IDOT HIGHWAY STANDARDS**

000001-09	STANDARD SYMBOLS, ABBREVIATIONS AND PATTERNS
001001-02	AREAS OF REINFORCEMENT BARS
001006	DECIMAL OF AN INCH AND OF A FOOT
280001-07	TEMPORARY EROSION CONTROL SYSTEMS
406201-01	MAILBOX TURNOUT
424001-12	PERPENDICULAR CURB RAMPS FOR SIDEWALKS
442201-04	CLASS C&D PATCHES
606001-09	CONCRETE CURB TYPE B AND COMBINATION CONCRETE CURB AND GUTTER
701001-02	OFF-RD OPERATIONS 2L 2W MORE THAN 15FT
701006-05	OFF-RD OPERATIONS 2L 2W 15' TO 24" FROM PAVEMENT EDGE
701011-04	OFF-RD MOVING OPERATIONS 2L 2W DAY ONLY
701201-05	LANE CLOSURE, 2L 2W, DAY ONLY 45MPH OR MORE
701301-04	LANE CLOSURE, 2L 2W, SHORT TIME OPERATIONS
701306-04	LANE CLOSURE, 2L 2W, SLOW MOVING OPERATIONS DAY ONLY 45MPH OR MORE
701311-03	LANE CLOSURE, 2L 2W, MOVING OPERATIONS DAY ONLY
701336-07	LANE CLOSURE, 2L 2W, WORK AREAS IN SERIES 45MPH OR MORE
701501-06	URBAN LANE CLOSURE, 2L 2W, UNDIVIDED
701801-06	SIDEWALK, CORNER OR CROSSWALK CLOSURE
701901-11	TRAFFIC CONTROL DEVICES
780001-05	TYPICAL PAVEMENT MARKINGS
B.L.R. 24-2	MAILBOX TURNOUT FOR LOCAL ROADS

**IDOT DISTRICT ONE STANDARD DETAILS**

BD-22	PAVEMENT PATCHING FOR HMA SURFACE PAVEMENT
BD-24	CURB OR CURB AND GUTTER REMOVAL AND REPLACEMENT
BD-32	BUTT JOINT AND HMA TAPER DETAILS
TC-10	TRAFFIC CONTROL AND PROTECTION FOR SIDE ROADS, INTERSECTIONS, AND DRIVEWAYS
TC-13	DISTRICT ONE TYPICAL PAVEMENT MARKINGS
TC-16	SHORT TERM PAVEMENT MARKING LETTERS AND SYMBOLS
TC-22	ARTERIAL ROAD INFORMATION SIGN

**GENERAL NOTES**

MISCELLANEOUS

IT IS THE CONTRACTOR'S RESPONSIBILITY TO ASCERTAIN EXISTING FIELD CONDITIONS BEFORE BIDDING ON THE CONTRACT.

WHERE NEW WORK MEETS EXISTING FEATURES TO REMAIN, THE CONTRACTOR SHALL FIELD CHECK ALL DIMENSIONS AND ELEVATIONS PRIOR TO PROCEEDING WITH CONSTRUCTION AND NOTIFY THE ENGINEER IMMEDIATELY OF ANY DISCREPANCIES.

SEEDING WILL NOT BE PERMITTED AT ANY TIME WHEN THE GROUND IS FROZEN, WET, OR IN AN UNTILLABLE CONDITION. LOCATIONS TO BE SEEDED WILL BE DETERMINED BY THE ENGINEER.

ANY REFERENCE TO A STANDARD THROUGHOUT THE PLANS OR SPECIAL PROVISIONS SHALL BE INTERPRETED TO MEAN THE EDITION AS INDICATED BY THE SUBNUMBER SHOWN IN THE LIST OF STANDARDS INCLUDED IN THESE PLANS.

SAW CUTTING WILL BE REQUIRED FOR ALL REMOVAL ITEMS LISTED IN SECTION 440 OF THE STANDARD SPECIFICATIONS, SHOWN IN THE PLANS, AND AS DIRECTED BY THE ENGINEER.

THE CONTRACTOR WILL BE REQUIRED TO COMPLY WITH ALL STATE REGULATIONS REGARDING AIR, WATER, AND NOISE POLLUTION. THE CONTRACTOR IS PROHIBITED FROM BURNING ANY MATERIAL WITHIN OR ADJACENT TO THE IMPROVEMENT.

THE CONTRACTOR SHALL ENSURE THAT POSITIVE DRAINAGE IS MAINTAINED AT ALL TIMES DURING AND AFTER THE CONSTRUCTION.

ANY LOOSE MATERIAL DEPOSITED IN THE FLOWLINE OF DRAINAGE STRUCTURES, CULVERTS, OR DITCHES, WHICH OBSTRUCTS THE NATURAL FLOW OF WATER SHALL BE REMOVED AT THE CLOSE OF EACH WORKING DAY. PRIOR TO ACCEPTANCE OF THE IMPROVEMENT, ALL DRAINAGE STRUCTURES SHALL BE FREE OF DIRT AND DEBRIS.

THE CONTRACTOR SHALL BE RESPONSIBLE FOR SWEEPING AND CLEANING STREETS OF ANY DEBRIS AND MATERIAL THAT HAS ACCUMULATED AS A RESULT OF THE CONSTRUCTION ACTIVITY. A MECHANICAL SWEEPER, MECHANICALLY DRIVEN AIR AND HANDWORK WITH SHOVEL AND BROOM SHALL BE UTILIZED TO PROVIDE A CLEAN STREET FOR THE MOTORING PUBLIC. WITHIN 24 HOURS OF PLACING PRIME COAT AND THE LAYING OF HMA, THE CONTRACTOR SHALL SWEEP THE PAVEMENT AND REMOVE STANDING WATER, EARTH, WEEDS, LEAVES, DIRT, CONSTRUCTION DEBRIS, AND ALL LOOSE MATERIAL.

CONTRACTOR SHALL TAKE PRECAUTION BY PRESERVING EXISTING TREES WITHIN THE RIGHT OF WAY. IF ANY DAMAGE OCCURS, TREES SHALL BE REPLACED IN KIND PER ARTICLE 201.07 REPAIR OR REPLACEMENT OF EXISTING PLANT MATERIAL REQUIREMENTS STATED HEREIN.

UTILITIES

THE CONTRACTOR SHALL BE RESPONSIBLE FOR CONTACTING THE OWNERS OF ALL UTILITIES PRIOR TO CONSTRUCTION TO DETERMINE THE LOCATION OF ALL UTILITY EQUIPMENT. THE CONTRACTOR SHALL COOPERATE WITH ALL UTILITY OWNERS IN ACCORDANCE WITH THE STANDARD SPECIFICATIONS IF UTILITY RELOCATION, ADJUSTMENT, OR PROTECTION IS NECESSARY.

ABANDONED UNDERGROUND UTILITIES THAT CONFLICT WITH CONSTRUCTION SHALL BE DISPOSED OF OUTSIDE THE LIMITS OF THE RIGHT OF WAY ACCORDING TO ARTICLE 202.03 OF THE STANDARD SPECIFICATIONS AND AS DIRECTED BY THE ENGINEER.

THE LOCATION OF EXISTING DRAINAGE STRUCTURES, STORM SEWERS, WATER MAINS, SANITARY SEWERS, AND ANY OTHER PUBLIC OR PRIVATE UTILITIES AS SHOWN ON THE PLANS IS APPROXIMATE AND THEIR EXACT LOCATION IS TO BE DETERMINED IN THE FIELD BY THE CONTRACTOR.

THE CONTRACTOR SHALL BE RESPONSIBLE FOR THE PROTECTION OF ALL UNDERGROUND AND SURFACE UTILITIES EVEN THOUGH THEY MIGHT NOT BE SHOWN ON THE PLANS. ANY UTILITY PROPERTY DAMAGED DURING CONSTRUCTION SHALL BE REPAIRED OR REPLACED TO THE SATISFACTION OF THE OWNER.

PAVING

LONGITUDINAL CONSTRUCTION JOINTS WILL NOT BE PERMITTED.

TRANSVERSE CONSTRUCTION JOINTS WILL BE ALLOWED DURING PAVING PROVIDED THE CONTRACTOR COMPLETE A SAWCUT AT LEAST SIX INCHES INTO THE ADJACENT MAT AT THE START OF PAVING THE FOLLOWING DAY.

CONSTRUCTION JOINTS THAT SIT OVERNIGHT WILL REQUIRE CRACK ROUTING AND SEALING UPON COMPLETION OF SURFACE COURSE CONSTRUCTION. JOIN SEALANT SHALL MEET THE REQUIREMENTS OF ARTICLE 1050.02 OF THE STANDARD SPECIFICATIONS.

SIGNING AND STRIPING

THE CONTRACTOR WILL BE REQUIRED TO TEMPORARILY RESET ALL SUCH SIGNS THAT INTERFERE WITH THEIR CONSTRUCTION OPERATIONS. ALL SUCH SIGNS MUST BE MAINTAINED STRAIGHT AND CLEAN FOR THE DURATION OF THE TEMPORARY SETTING AND MUST BE RE-ERECTED AT A TEMPORARY LOCATION IN A WORKMANLIKE MANNER AND BE VISIBLE TO THE TRAFFIC FOR WHICH IT IS INTENDED.

SEE IDOT DISTRICT ONE DETAILS AND PLAN SHEETS FOR PAVEMENT MARKING DETAILS.

GRINDING OF PAVEMENT MARKINGS ON NEWLY CONSTRUCTED HOT-MIX ASPHALT PAVEMENT WILL NOT BE PERMITTED.

THE CONTRACTOR SHALL BE RESPONSIBLE FOR POSTING 'FRESH OIL' SIGNS (48'X48' MINIMUM) AS NEEDED FOR THE PROJECT. THE CONTRACTOR SHALL INSTALL AND MAINTAIN TEMPORARY SIGNS IN THE PARKWAY TWENTY-FOUR (24) HOURS PRIOR TO STARTING WORK. THE CONTRACTOR SHALL REMOVE THE SIGNS AND REINSTALL THEM AS NEEDED.

IN ACCORDANCE WITH THE IDOT DROP OFF POLICY AT INSTANCES IN WHICH THERE IS A GREATER THAN 1.5 INCH HEIGHT DIFFERENCE IN VERTICAL MILLED FACE, OR WHEN THERE IS A GREATER THAN 2.5 INCH LIFT DIFFERENCE, UNEVEN LANE SIGNS (W8-11) WILL BE REQUIRED.

**COMMITMENTS**

NONE.

MODEL: gen\_sht\_01  
FILE NAME: \\hrgreen.com\hrg\Drawings\2023\2303999\CAD\Sheets\2303999\_gen-notes.dgn

 HRGreen.com Illinois Professional Design Firm # 184-001322	USER NAME = cowedmck	DESIGNED - CWW	REVISED -	STATE OF ILLINOIS DEPARTMENT OF TRANSPORTATION	INDEX OF SHEETS, HIGHWAY STANDARDS, AND GENERAL NOTES WHEELER ROAD	F.A.U. RTE. = 2305	SECTION = 25-00037-00-RS	COUNTY = KANE	TOTAL SHEETS = 26	SHEET NO. = 2
	PLOT SCALE = 0.16666833' / in.	CHECKED - JRS	REVISED -			CONTRACT NO. = 61M42				
PLOT DATE = 3/24/2026	DATE = 3/24/2026	REVISED -	SCALE:	SHEET 1 OF 1 SHEETS	STA. TO STA.	ILLINOIS FED. AID PROJECT				

CODE NUMBER	ITEM	UNIT	TOTAL QUANTITY	CONSTRUCTION CODE
				STR 75% FEDERAL 25% VILLAGE 0005
21101615	TOPSOIL FURNISH AND PLACE, 4"	SQ YD	28	28
25000210	SEEDING, CLASS 2A	ACRE	0.1	0.1
25000400	NITROGEN FERTILIZER NUTRIENT	POUND	9	9
25000500	PHOSPHORUS FERTILIZER NUTRIENT	POUND	9	9
25000600	POTASSIUM FERTILIZER NUTRIENT	POUND	9	9
25100630	EROSION CONTROL BLANKET	SQ YD	112	112
25200110	SODDING, SALT TOLERANT	SQ YD	27	27
25200200	SUPPLEMENTAL WATERING	UNIT	1.5	1.5
28000400	PERIMETER EROSION BARRIER	FOOT	140	140
35101600	AGGREGATE BASE COURSE, TYPE B 4"	SQ YD	49	49
40600290	BITUMINOUS MATERIALS (TACK COAT)	POUND	15758	15758
40600370	LONGITUDINAL JOINT SEALANT	FOOT	8980	8980
40600400	MIXTURE FOR CRACKS, JOINTS, AND FLANGWAYS	TON	20	20
40600982	HOT-MIX ASPHALT SURFACE REMOVAL - BUTT JOINT	SQ YD	72	72
40603080	HOT-MIX ASPHALT BINDER COURSE, IL-19.0, N50	TON	2978	2978
40604060	HOT-MIX ASPHALT SURFACE COURSE, IL-9.5, MIX "D", N50	TON	1986	1986

S = SPECIALITY ITEM

MODEL: SN - 01  
FILE NAME: W:\green.com\byg\Draws\2025\20250309\99\CAD\Sheet\20250309\_99\_sum-quant.dgn



USER NAME = cweidick	DESIGNED - CWW	REVISED -
PLOT SCALE = 0.16666633' / in.	DRAWN - AJM	REVISED -
PLOT DATE = 3/25/2025	CHECKED - JRS	REVISED -
	DATE = 3/25/2025	REVISED -

STATE OF ILLINOIS  
DEPARTMENT OF TRANSPORTATION

SUMMARY OF QUANTITIES  
WHEELER ROAD

SCALE: SHEET 1 OF 3 SHEETS STA. TO STA.

FAU. RTE.	SECTION	COUNTY	TOTAL SHEETS	SHEET NO.
2305	25-00037-00-RS	KANE	26	3
ILLINOIS FED. AID PROJECT			CONTRACT NO. 61M42	

CODE NUMBER	ITEM	UNIT	TOTAL QUANTITY	CONSTRUCTION CODE
				STR 75% FEDERAL 25% VILLAGE 0005
4080029	BITUMINOUS MATERIALS (TACK COAT)	POUND	203	203
4080050	INCIDENTAL HOT-MIX ASPHALT SURFACING	TON	51	51
42001300	PROTECTIVE COAT	SQ YD	51	51
42400200	PORTLAND CEMENT CONCRETE SIDEWALK 5 INCH	SQ FT	315	315
42400800	DETECTABLE WARNINGS	SQ FT	34	34
44000161	HOT-MIX ASPHALT SURFACE REMOVAL, 3"	SQ YD	7185	7185
44000163	HOT-MIX ASPHALT SURFACE REMOVAL, 3 1/2"	SQ YD	16449	16449
44000500	COMBINATION CURB AND GUTTER REMOVAL	FOOT	68	68
44000600	SIDEWALK REMOVAL	SQ FT	231	231
44201713	CLASS D PATCHES, TYPE I, 6 INCH	SQ YD	150	150
44201717	CLASS D PATCHES, TYPE II, 6 INCH	SQ YD	150	150
44201721	CLASS D PATCHES, TYPE III, 6 INCH	SQ YD	150	150
48101200	AGGREGATE SHOULDERS, TYPE B	TON	568	568
60603900	COMBINATION CONCRETE CURB AND GUTTER, TYPE B-6.12 (ABUTTING EXISTING PAVEMENT)	FOOT	68	68
67100100	MOBILIZATION	L SUM	1	1
70100450	TRAFFIC CONTROL AND PROTECTION, STANDARD 701201	L SUM	1	1

S = SPECIALITY ITEM

MODEL: SR - 02  
FILE NAME: W:\green.com\hr\g\Drawn\2023\03035959\CAD\Sheet\23039999\_sum-quant.dgn

 <b>HRGreen.com</b> Illinois Professional Design Firm # 184-031322	USER NAME = cwedwck	DESIGNED - CWW	REVISED -	<b>STATE OF ILLINOIS</b> <b>DEPARTMENT OF TRANSPORTATION</b>	<b>SUMMARY OF QUANTITIES</b> <b>WHEELER ROAD</b>				F.A.U. RTE.	SECTION	COUNTY	TOTAL SHEETS	SHEET NO.
		DRAWN - AJM	REVISED -		SCALE:	SHEET 2 OF 3 SHEETS	STA.	TO STA.	2305	25-00037-00-RS	KANE	26	4
	CHECKED - JRS	REVISED -					CONTRACT NO. 61M42						
	PLOT DATE = 3/25/2026	DATE - 3/25/2026	REVISED -		ILLINOIS FED. AID PROJECT								

CODE NUMBER	ITEM	UNIT	TOTAL QUANTITY	CONSTRUCTION CODE STR 75% FEDERAL 25% VILLAGE 0005
70100460	TRAFFIC CONTROL AND PROTECTION, STANDARD 701306	L SUM	1	1
70100600	TRAFFIC CONTROL AND PROTECTION, STANDARD 701336	L SUM	1	1
70102620	TRAFFIC CONTROL AND PROTECTION, STANDARD 701501	L SUM	1	1
70102640	TRAFFIC CONTROL AND PROTECTION, STANDARD 701801	L SUM	1	1
70300100	SHORT TERM PAVEMENT MARKING	FOOT	2797	2797
70300150	SHORT TERM PAVEMENT MARKING REMOVAL	SQ FT	2113	2113
70307120	TEMPORARY PAVEMENT MARKING - LINE 4" - TYPE IV TAPE	FOOT	11895	11895
S 78000100	THERMOPLASTIC PAVEMENT MARKING - LETTERS AND SYMBOLS	SQ FT	37	37
S 78000200	THERMOPLASTIC PAVEMENT MARKING - LINE 4"	FOOT	27437	27437
S 78000400	THERMOPLASTIC PAVEMENT MARKING - LINE 6"	FOOT	309	309
S 78000600	THERMOPLASTIC PAVEMENT MARKING - LINE 12"	FOOT	80	80
S 78000650	THERMOPLASTIC PAVEMENT MARKING - LINE 24"	FOOT	30	30
X0327036	BIKE PATH REMOVAL	SQ YD	14	14
X4400196	HOT-MIX ASPHALT SURFACE REMOVAL (SPECIAL)	SQ YD	96	96
X7010238	CHANGEABLE MESSAGE SIGN (SPECIAL)	CAL MO	6	6
X7200061	TEMPORARY INFORMATION SIGNING	SQ FT	52	52
Z0013798	CONSTRUCTION LAYOUT	L SUM	1	1

S = SPECIALITY ITEM

MODEL: SH - 03  
FILE NAME: W:\rgreen.com\hrg\Date\2023\23035959\CA D\Sheets\2303899\_sum-quant.dgn



USER NAME = cwe2Mk	DESIGNED - CWW	REVISED -
	DRAWN - AJM	REVISED -
	CHECKED - JRS	REVISED -
PLOT DATE = 3/25/2026	DATE - 3/25/2026	REVISED -

STATE OF ILLINOIS  
DEPARTMENT OF TRANSPORTATION

SUMMARY OF QUANTITIES			
WHEELER ROAD			
SCALE:	SHEET 3 OF 3 SHEETS	STA.	TO STA.

F.A.U. RTE.	SECTION	COUNTY	TOTAL SHEETS	SHEET NO.
2305	25-0037-00-RS	KANE	26	5
CONTRACT NO.			61M42	
ILLINOIS FED. AID PROJECT				

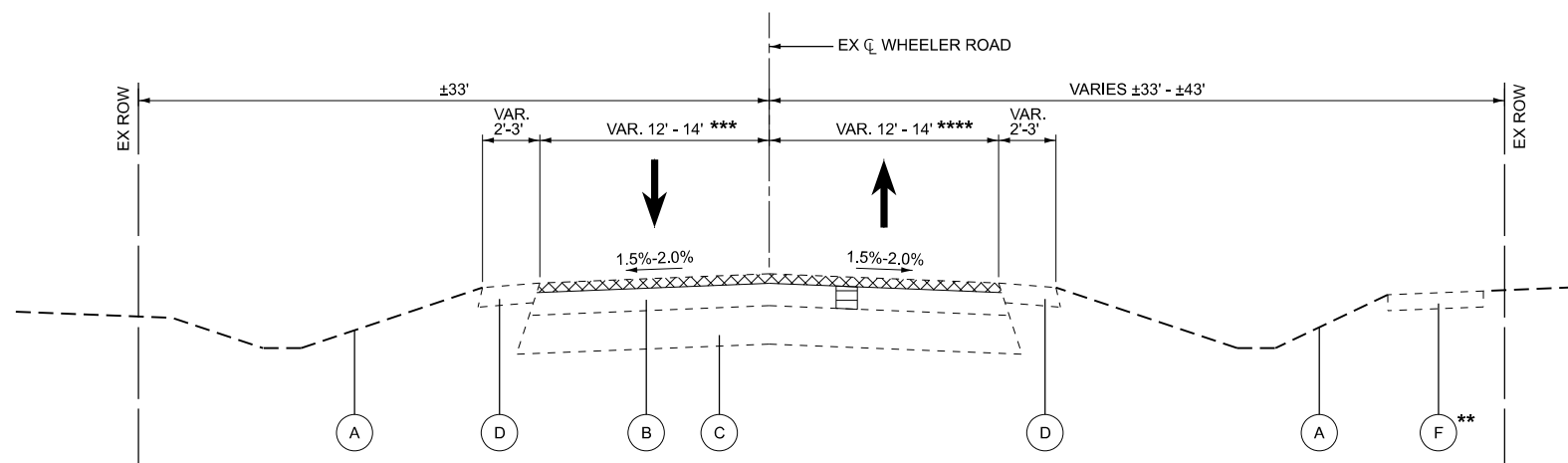

**EXISTING TYPICAL SECTION**

WHEELER ROAD  
 STA 103+05.00 TO STA 170+08.00  
 STA 178+62.00 TO STA 185+03.00

- \* EXISTING CONCRETE CURB & GUTTER PRESENT:  
STA 172+10.00 TO STA 176+32.00
- \*\* EXISTING CONCRETE SIDEWALK PRESENT:  
STA 170+31.00 TO STA 185+03.00
- \*\*\* LANE VARIES BETWEEN 12' - 14':  
STA 183+85.00 TO STA 185+03.00
- \*\*\*\* LANE VARIES BETWEEN 12' - 14':  
STA 176+32.00 TO STA 185+03.00

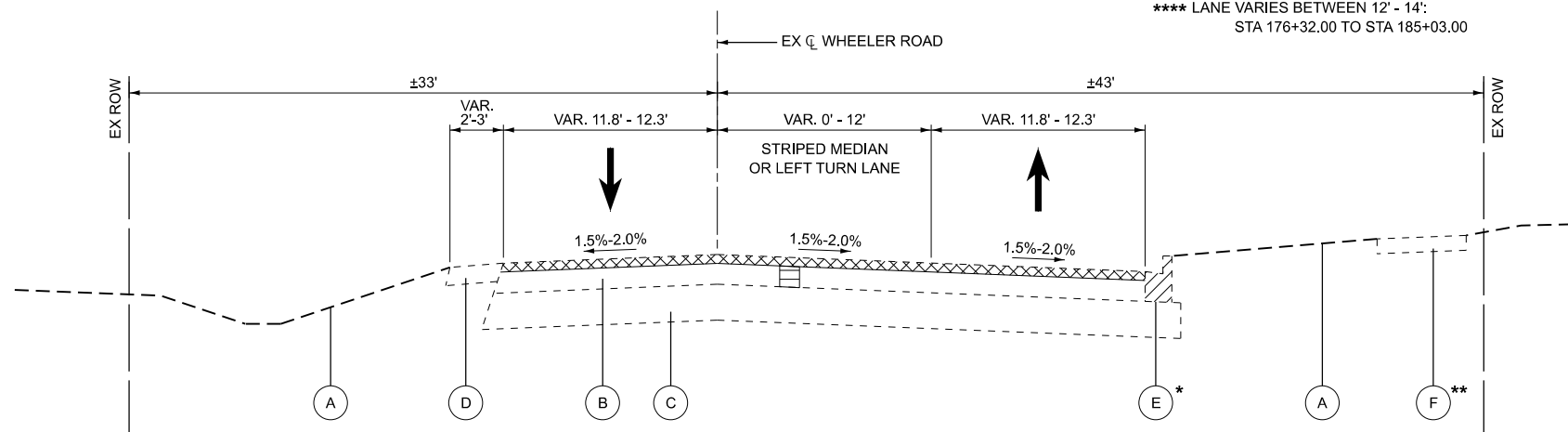

**EXISTING TYPICAL SECTION**

WHEELER ROAD  
 STA 170+08.00 TO STA 178+62.00

**EXISTING LEGEND**

- (A) EXISTING GROUND
- (B) EXISTING HOT-MIX ASPHALT PAVEMENT (SEE TABLE)
- (C) EXISTING AGGREGATE BASE COURSE (SEE TABLE)
- (D) EXISTING AGGREGATE SHOULDERS
- (E) EXISTING CONCRETE CURB & GUTTER TYPE B6.12
- (F) EXISTING CONCRETE SIDEWALK

**REMOVAL LEGEND**

- HOT-MIX ASPHALT SURFACE REMOVAL, 3 1/2" \*  
\* 3" - FROM STA 127+00.00 TO STA 153+00.00
- COMBINATION CONCRETE CURB AND GUTTER REMOVAL  
(SPOT REMOVAL AT THE DISCRETION OF THE ENGINEER)
- PAVEMENT PATCHING  
(SIZES AND LOCATIONS TO BE MARKED BY THE ENGINEER AFTER MILLING OPERATIONS)

**EXISTING PAVEMENT THICKNESS TABLE**

LOCATION	THICKNESS
WHEELER ROAD (STA 103+05.00 - STA 126+45.00)	
HOT-MIX ASPHALT PAVEMENT	6 1/4" - 9"
AGGREGATE BASE COURSE	5 1/2" - 11 3/4"
WHEELER ROAD (STA 126+45.00 - STA 155+36.88)	
HOT-MIX ASPHALT PAVEMENT	5" - 5 1/2"
AGGREGATE BASE COURSE	13" - 14 1/2"
WHEELER ROAD (STA 155+36.88 - STA 185+03.00)	
HOT-MIX ASPHALT PAVEMENT	7" +/-
AGGREGATE BASE COURSE	6 1/2" - 7"

MODEL: Typ\_Sht\_01  
 FILE NAME: \\hrgreen.com\hrg\Drawings\CAD\Sheets\2303999\_jrp.dgn

HRGreen.com  
 Illinois Professional Design Firm  
 # 184-001322

USER NAME = cowedmck	DESIGNED - CWW	REVISED -
	DRAWN - AJM	REVISED -
PLOT SCALE = 0.16666633' / In.	CHECKED - JRS	REVISED -
PLOT DATE = 3/24/2026	DATE - 3/24/2026	REVISED -

**STATE OF ILLINOIS**  
**DEPARTMENT OF TRANSPORTATION**

**EXISTING TYPICAL SECTIONS**  
**WHEELER ROAD**

SCALE: N.T.S. SHEET 1 OF 2 SHEETS STA. TO STA.

F.A.U. RTE.	SECTION	COUNTY	TOTAL SHEETS	SHEET NO.
2305	25-00037-00-RS	KANE	26	6
CONTRACT NO. 61M42			ILLINOIS FED. AID PROJECT	

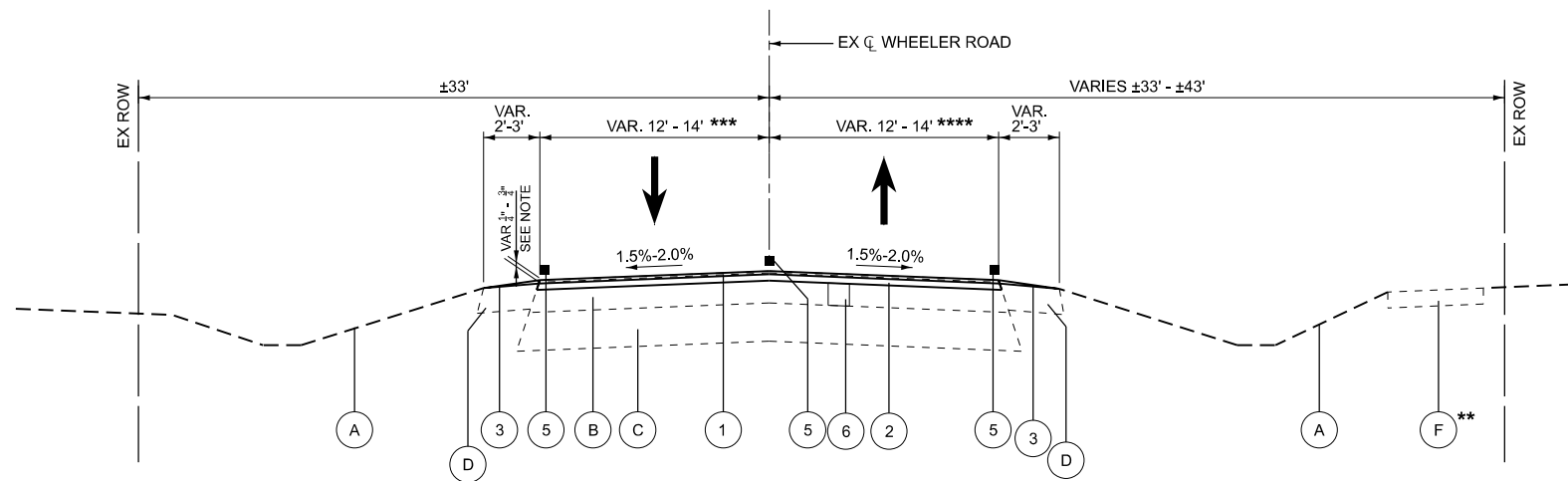

**PROPOSED TYPICAL SECTION**

WHEELER ROAD  
 STA 103+05.00 TO STA 170+08.00  
 STA 178+62.00 TO STA 185+03.00

- \* EXISTING CONCRETE CURB & GUTTER PRESENT:  
STA 172+10.00 TO STA 176+32.00
- \*\* EXISTING CONCRETE SIDEWALK PRESENT:  
STA 170+31.00 TO STA 185+03.00
- \*\*\* LANE VARIES BETWEEN 12' - 14':  
STA 183+85.00 TO STA 185+03.00
- \*\*\*\* LANE VARIES BETWEEN 12' - 14':  
STA 176+32.00 TO STA 185+03.00

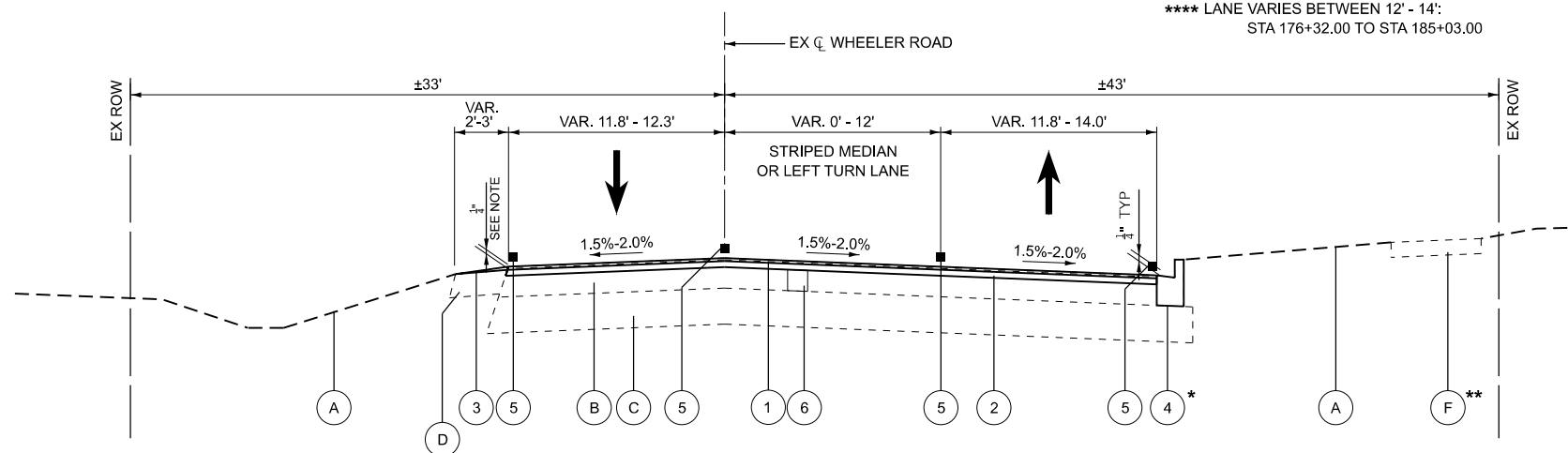

**PROPOSED TYPICAL SECTION**

WHEELER ROAD  
 STA 170+08.00 TO STA 178+62.00

**EXISTING LEGEND**

- (A) EXISTING GROUND
- (B) EXISTING HOT-MIX ASPHALT PAVEMENT
- (C) EXISTING AGGREGATE BASE COURSE
- (D) EXISTING AGGREGATE SHOULDERS
- (E) EXISTING CONCRETE CURB & GUTTER TYPE B6.12
- (F) EXISTING CONCRETE SIDEWALK

**PROPOSED LEGEND**

- (1) HOT-MIX ASPHALT SURFACE COURSE, IL-9.5, MIX "D", N50 1 1/2"
- (2) HOT-MIX ASPHALT BINDER COURSE, IL-19.0, N50 2 1/4"
- (3) AGGREGATE SHOULDERS TYPE B VARIES BETWEEN 0.25"-3" (9% MAX SLOPE) (TOP OFF EXISTING SHOULDERS TO REMAIN)
- (4) COMBINATION CONCRETE CURB AND GUTTER TYPE B6.12 (SPOT REPLACEMENT AT THE DISCRETION OF THE ENGINEER)
- (5) PAVEMENT MARKING, LINE VARIES 4"-6"
- (6) CLASS D PATCHES, 6" (SIZES AND LOCATIONS TO BE MARKED BY THE ENGINEER AFTER MILLING OPERATIONS)

HOT-MIX ASPHALT MIXTURE REQUIREMENTS		
MIXTURE TYPE	AIR VOIDS @ Ndes	QMP
<b>INCIDENTAL HMA SURFACING (DRIVEWAYS)</b>		
HMA SURFACE COURSE, MIX "D", N50; (IL-9.5mm); 2"	4.0% @ 50 GYR.	LR 1030-2
<b>RESURFACING</b>		
HOT-MIX ASPHALT SURFACE COURSE, IL-9.5, MIX "D", N50; 1 1/2"	4.0% @ 50 GYR.	LR 1030-2
HOT-MIX ASPHALT BINDER COURSE, IL-19.0, N50; 2 1/4"	4.0% @ 50 GYR.	LR 1030-2
<b>PATCHING</b>		
CLASS D PATCHES, 6" (HMA BINDER IL-19.0mm)	4.0% @ 70 GYR.	LR 1030-2
QMP DESIGNATION: QUALITY CONTROL/QUALITY ASSURANCE (QC/QA) PER LR 1030-2		

THE UNIT WEIGHT USED TO CALCULATE ALL HMA SURFACE MIXTURE QUANTITIES IS 112 LBS/SQ YD/IN.  
 THE "AC TYPE" FOR POLYMERIZED HMA MIXES SHALL BE "SBS/SBR PG76-22" AND FOR NON-POLYMERIZED HMA THE "AC TYPE" SHALL BE "PG 64-22" UNLESS MODIFIED BY RECLAIMED MATERIALS SPECIFICATIONS.  
 PATCHING LOCATIONS TO BE DETERMINED BY THE ENGINEER AFTER MILLING OPERATIONS.  
 LONGITUDINAL JOINT SEALANT SHALL BE PLACED OVER THE HMA BC IL-19.0, N50

NOTE:  
 TOTAL PROPOSED HMA THICKNESS IS 3.75". THIS WILL RESULT IN AN OVERLAY THAT VARIES BETWEEN 0.25" AND 0.75" BASED ON THE REMOVAL THICKNESS AS FOLLOWS:  
 STA 103+05.00 TO STA 127+00.00 - 0.25" OVERLAY  
 STA 127+00.00 TO STA 153+00.00 - 0.75" OVERLAY  
 STA 153+00.00 TO STA 185+03.00 - 0.25" OVERLAY

MODEL: Typ\_Sht\_02  
 FILE NAME: \\hrgreen.com\hrg\Drawings\CAD\Sheets\2303999\_1yp.dgn

HRGreen.com Illinois Professional Design Firm # 184-001322	USER NAME = cwedwck DESIGNED - CWW DRAWN - AJM CHECKED - JRS PLOT DATE = 3/24/2026	REVISED - REVISED - REVISED - REVISED -	<b>STATE OF ILLINOIS          DEPARTMENT OF TRANSPORTATION</b>	<b>PROPOSED TYPICAL SECTIONS          WHEELER ROAD</b>		F.A.U. RTE. = 2305 SECTION = 25-00037-00-RS COUNTY = KANE TOTAL SHEETS = 26 SHEET NO. = 7
	SCALE: N.T.S. SHEET 2 OF 2 SHEETS STA. TO STA.			ILLINOIS FED. AID PROJECT		

### PAVEMENT SCHEDULE

LOCATION	AGGREGATE BASE COURSE, TYPE B 4"		BITUMINOUS MATERIALS (TACK COAT)		LONGITUDINAL JOINT SEALANT	MIXTURE FOR CRACKS, JOINTS, AND FLANGEWAYS	HOT-MIX ASPHALT SURFACE REMOVAL - BUTT JOINT		HOT-MIX ASPHALT BINDER COURSE, IL-19.0, N50		HOT-MIX ASPHALT SURFACE COURSE, IL-9.5, MIX "D", N50		INCIDENTAL HOT-MIX ASPHALT SURFACING		BITUMINOUS MATERIALS (TACK COAT)		PROTECTIVE COAT	PORTLAND CEMENT CONCRETE SIDEWALK 5 INCH		DETECTABLE WARNINGS	
	SQ YD		POUND		FOOT	TON	SQ YD		TON		TON		TON		POUND		SQ YD	SQ FT		SQ FT	
	LT	RT	LT	RT	CL		LT	RT	LT	RT	LT	RT	LT	RT	LT	RT		LT	RT	LT	RT
<b>WHEELER ROAD</b>																					
STA 103+05 TO STA 107+50			400.5	407.8	445.0		6.0	6.0	74.8	76.1	49.8	50.8									
STA 107+50 TO STA 113+50			540.0	540.0	600.0				100.8	100.8	67.2	67.2									
STA 113+50 TO STA 119+50			540.0	540.0	600.0				100.8	100.8	67.2	67.2									
STA 119+50 TO STA 125+50			540.0	540.0	600.0				100.8	100.8	67.2	67.2									
STA 125+50 TO STA 131+50			554.9	549.5	600.0				103.6	102.6	69.1	68.4									
STA 131+50 TO STA 137+50			546.2	540.0	600.0				102.0	100.8	68.0	67.2									
STA 137+50 TO STA 143+50			674.3	555.1	600.0		17.0		125.9	103.6	83.9	69.1									
STA 143+50 TO STA 149+50			544.7	549.3	600.0				101.7	102.5	67.8	68.4									
STA 149+50 TO STA 155+50			540.0	540.0	600.0				100.8	100.8	67.2	67.2									
STA 155+50 TO STA 161+50			540.0	571.3	600.0				100.8	108.0	67.2	72.0									
STA 161+50 TO STA 167+50			540.0	585.0	600.0				100.8	109.2	67.2	72.8									
STA 167+50 TO STA 172+00			404.9	489.8	570.0				75.6	91.4	50.4	60.9									
STA 172+00 TO STA 177+00		48.9	450.1	888.5	1000.0			29.0	84.0	200.9	56.0	133.9				51.0		314.5		33.8	
STA 177+00 TO STA 182+00			452.9	563.7	662.0						84.5	105.2	56.4	70.2							
STA 182+00 TO STA 185+03			315.3	313.5	303.0		7.0	7.0	58.9	58.5	39.2	39.0									
<b>ENTRANCES</b>																					
14334 RT															6.3	25.3					
14704 LT													3.4	13.5							
15613 RT														3.5	14.0						
15685 LT													1.2	4.9							
15770 RT														4.3	17.2						
15867 RT														1.6	6.4						
15881 LT													1.2	4.9							
15966 RT														2.4	9.6						
16008 LT													1.0	4.1							
16074 RT														4.9	19.6						
16085 LT													1.0	4.2							
16240 RT														2.1	8.3						
16295 LT													1.2	4.9							
16337 RT														2.9	11.5						
16420 RT														2.4	9.5						
16530 RT														1.7	7						
16612 RT														2.6	10.5						
16900 RT														0.6	2.6						
16905 LT													1.2	4.9							
18437 LT													4.8	19.4							
<b>TOTALS</b>	<b>49</b>		<b>15758</b>		<b>8980</b>	<b>20</b>	<b>72</b>		<b>2978</b>		<b>1986</b>		<b>51.0</b>		<b>203.0</b>		<b>51</b>	<b>315</b>		<b>34</b>	

THE USES, LOCATIONS, AND EXACT DIMENSIONS OF THIS ITEM SHALL BE DETERMINED AT THE DISCRETION OF THE RESIDENT ENGINEER.

MODEL: SH - 01  
FILE NAME: \\hrgreen.com\hrgreen\CAD\Sheets\2303999\_sch-quant.dgn



HRGreen.com  
Illinois Professional Design Firm  
# 184-001322

USER NAME = cwedmck	DESIGNED - CWW	REVISED -
	DRAWN - AJM	REVISED -
PLOT SCALE = 0.16666633' / In.	CHECKED - JRS	REVISED -
PLOT DATE = 3/24/2026	DATE - 3/24/2026	REVISED -

**STATE OF ILLINOIS  
DEPARTMENT OF TRANSPORTATION**

**SCHEDULE OF QUANTITIES  
WHEELER ROAD**

SCALE: SHEET 1 OF 3 SHEETS STA. TO STA.

F.A.U. RTE.	SECTION	COUNTY	TOTAL SHEETS	SHEET NO.
2305	25-00037-00-RS	KANE	26	8
CONTRACT NO.			61M42	
ILLINOIS		FED. AID PROJECT		

**PAVEMENT SCHEDULE (CONTINUED)**

LOCATION	HOT-MIX ASPHALT SURFACE REMOVAL, 3"		HOT-MIX ASPHALT SURFACE REMOVAL, 3 1/2"		COMBINATION CURB AND GUTTER REMOVAL		SIDEWALK REMOVAL		CLASS D PATCHES, TYPE I, 6 INCH	CLASS D PATCHES, TYPE II, 6 INCH	CLASS D PATCHES, TYPE III, 6 INCH	AGGREGATE SHOULDERS, TYPE B		COMBINATION CONCRETE CURB AND GUTTER, TYPE B-6.12 (ABUTTING EXISTING PAVEMENT)		BIKE PATH REMOVAL		HOT-MIX ASPHALT SURFACE REMOVAL (SPECIAL)		
	SQ YD		SQ YD		FOOT		SQ FT		SQ YD	SQ YD	SQ YD	LT	RT	LT	RT	LT	RT	LT	RT	
	LT	RT	LT	RT	LT	RT	LT	RT												
<b>WHEELER ROAD</b>																				
STA 103+05 TO STA 107+50			593.3	604.2									16.8	15.6						
STA 107+50 TO STA 113+50			800.0	800.0									22.7	22.7						
STA 113+50 TO STA 119+50			800.0	800.0									22.7	22.7						
STA 119+50 TO STA 125+50			800.0	800.0									22.7	22.7						
STA 125+50 TO STA 131+50	600.0	600.0	222.1	214.0									20.2	21.1						
STA 131+50 TO STA 137+50	809.2	800.0											21.6	22.7						
STA 137+50 TO STA 143+50	999.0	822.4											15.2	20.7						
STA 143+50 TO STA 149+50	807.0	813.8											22.1	21.2						
STA 149+50 TO STA 155+50	466.7	466.7	333.4	333.3									22.7	21.0						
STA 155+50 TO STA 161+50			800.0	857.0									22.7	17.1						
STA 161+50 TO STA 167+50			800.0	866.6									22.7	16.9						
STA 167+50 TO STA 172+00			599.8	725.6									17.0	14.6						
STA 172+00 TO STA 177+00			666.8	1594.4			68.0	230.5					18.9	2.6	68.0	14.0				
STA 177+00 TO STA 182+00			671.0	835.2									19.2	18.6						
STA 182+00 TO STA 185+03			467.1	464.5									9.0	11.1						
<b>ENTRANCES</b>																				
14334 RT																				9.5
14704 LT																			4.6	
15613 RT																				4.9
15685 LT																				
15770 RT																				7.7
15867 RT																				6.2
15881 LT																				
15966 RT																				3.4
16008 LT																				
16074 RT																				5.5
16085 LT																				
16240 RT																				8.1
16295 LT																				
16337 RT																				12.0
16420 RT																				7.4
16530 RT																				5.0
16612 RT																				5.6
16900 RT																				5.4
16905 LT																				
18437 LT																				10.3
<b>TOTALS</b>	<b>7185</b>		<b>16449</b>		<b>68</b>		<b>231</b>		<b>150</b>	<b>150</b>	<b>150</b>	<b>568</b>		<b>68</b>		<b>14</b>		<b>96</b>		

THE USES, LOCATIONS, AND EXACT DIMENSIONS OF THIS ITEM SHALL BE DETERMINED AT THE DISCRETION OF THE RESIDENT ENGINEER.

THE USES, LOCATIONS, AND EXACT DIMENSIONS OF THIS ITEM SHALL BE DETERMINED AT THE DISCRETION OF THE RESIDENT ENGINEER.

THE USES, LOCATIONS, AND EXACT DIMENSIONS OF THIS ITEM SHALL BE DETERMINED AT THE DISCRETION OF THE RESIDENT ENGINEER.

MODEL: SH-02  
FILE NAME: \\hrgreen.com\hrg\Drawings\2023\2303999\CAD\Sheets\2303999\_sch-quant.dgn



USER NAME = cowedmck	DESIGNED - CWW	REVISED -
	DRAWN - AJM	REVISED -
	CHECKED - JRS	REVISED -
PLOT DATE = 3/25/2026	DATE - 3/25/2026	REVISED -

**STATE OF ILLINOIS  
DEPARTMENT OF TRANSPORTATION**

**SCHEDULE OF QUANTITIES  
WHEELER ROAD**

SCALE: SHEET 2 OF 3 SHEETS STA. TO STA.

F.A.U. RTE.	SECTION	COUNTY	TOTAL SHEETS	SHEET NO.
2305	25-00037-00-RS	KANE	26	9
CONTRACT NO.			61M42	
ILLINOIS		FED. AID PROJECT		

### PAVEMENT MARKING SCHEDULE

LOCATION	SHORT TERM PAVEMENT MARKING		SHORT TERM PAVEMENT MARKING REMOVAL		TEMPORARY PAVEMENT MARKING - LINE 4" - TYPE IV TAPE		THERMOPLASTIC PAVEMENT MARKING											
							LETTERS AND SYMBOLS		LINE 4"						LINE 6"			
									SOLID EDGE LINE, WHITE		10' DASH 30' SKIP, YELLOW	NO PASSING ZONE, YELLOW	DOUBLE SOLID CENTERLINE, YELLOW		SOLID LANE LINE, WHITE	2' DASH 6' SKIP, WHITE	CROSSWALK, WHITE	
									FOOT	FOOT	FOOT	FOOT	FOOT	FOOT	FOOT	FOOT	FOOT	
CL		RT		CL	RT	LT	RT	LT	RT	CL	CL	CL	RT	RT	RT			
WHEELER ROAD																		
STA 103+05 TO STA 107+50	133.5		44.1					445.0	445.0	111.3								
STA 107+50 TO STA 113+50	180.0		111.5		521.3			600.0	600.0	115.3	173.8							
STA 113+50 TO STA 119+50	180.0		284.4		2250.0			600.0	600.0		750.0							
STA 119+50 TO STA 125+50	180.0		284.4		2250.0			600.0	600.0		750.0							
STA 125+50 TO STA 131+50	180.0		177.5		1181.3			600.0	600.0		393.8							
STA 131+50 TO STA 137+50	180.0		166.3		1068.8			600.0	600.0		356.3							
STA 137+50 TO STA 143+50	180.0		284.5		2250.0			482.0	600.0		750.0							
STA 143+50 TO STA 149+50	180.0		230.0		1706.3			600.0	600.0		568.8							
STA 149+50 TO STA 155+50	180.0		69.9		105.0			600.0	556.0	112.5	35.0	500.0						
STA 155+50 TO STA 161+50	180.0		115.6		562.5			600.0	584.0	87.5	187.5	1200.0						
STA 161+50 TO STA 167+50	180.0		59.4					600.0	600.0			1200.0						
STA 167+50 TO STA 172+00	135.0	57.6	44.6	19.0				450.0	450.0			900.0	384.0					
STA 172+00 TO STA 177+00	150.0	231.3	49.5	76.4			36.4	500.0	76.0			282.0	854.7	100.0	33.5	175.3		
STA 177+00 TO STA 182+00	150.0	48.6	49.5	16.0				500.0	500.0			1000.0	324.0					
STA 182+00 TO STA 185+03	90.9		30.0					303.0	303.0			606.0						
<b>TOTALS</b>	<b>2797</b>		<b>2113</b>		<b>11895</b>		<b>37</b>	<b>27437</b>						<b>309</b>				

MODEL: SH - 03  
 FILE NAME: \\hrgreen.com\hrg\Drawings\2023\2303999\CAD\Sheets\2303999\_sch-quant.dgn

	USER NAME = cwedwck	DESIGNED - CWW	REVISED -	<b>STATE OF ILLINOIS DEPARTMENT OF TRANSPORTATION</b>	<b>SCHEDULE OF QUANTITIES WHEELER ROAD</b>	F.A.U. RTE.	SECTION	COUNTY	TOTAL SHEETS	SHEET NO.		
	PLOT DATE = 3/25/2026	DRAWN - AJM	CHECKED - JRS			REVISED -	2305	25-00037-00-RS	KANE	26	10	
					SCALE:	SHEET 3 OF 3 SHEETS		STA.	TO STA.		CONTRACT NO. 61M42	
											ILLINOIS FED. AID PROJECT	

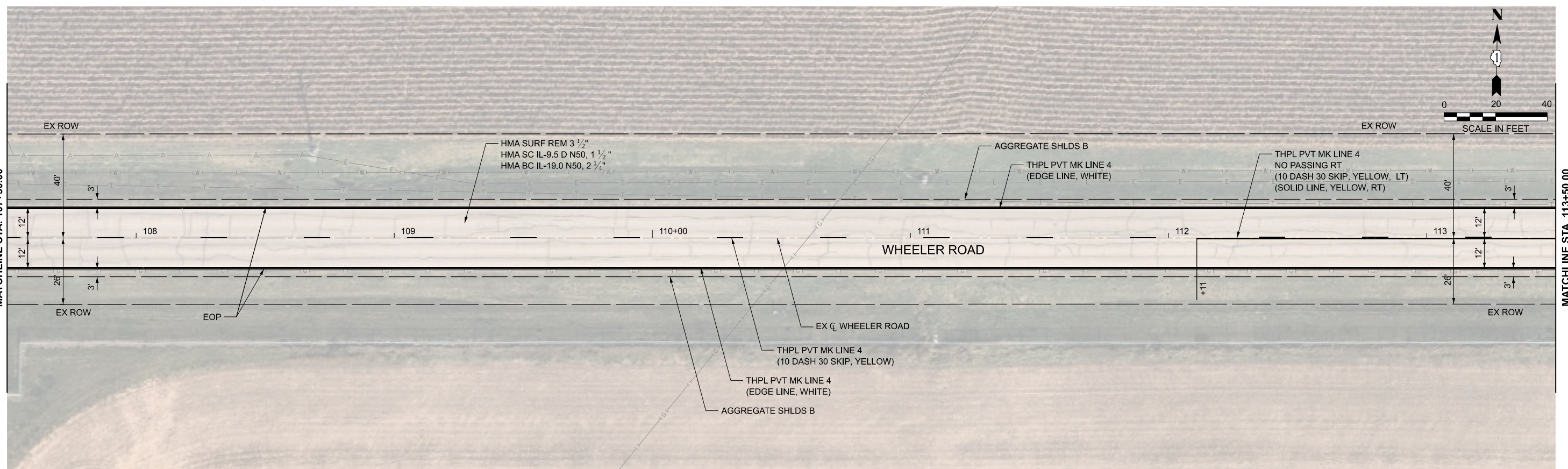
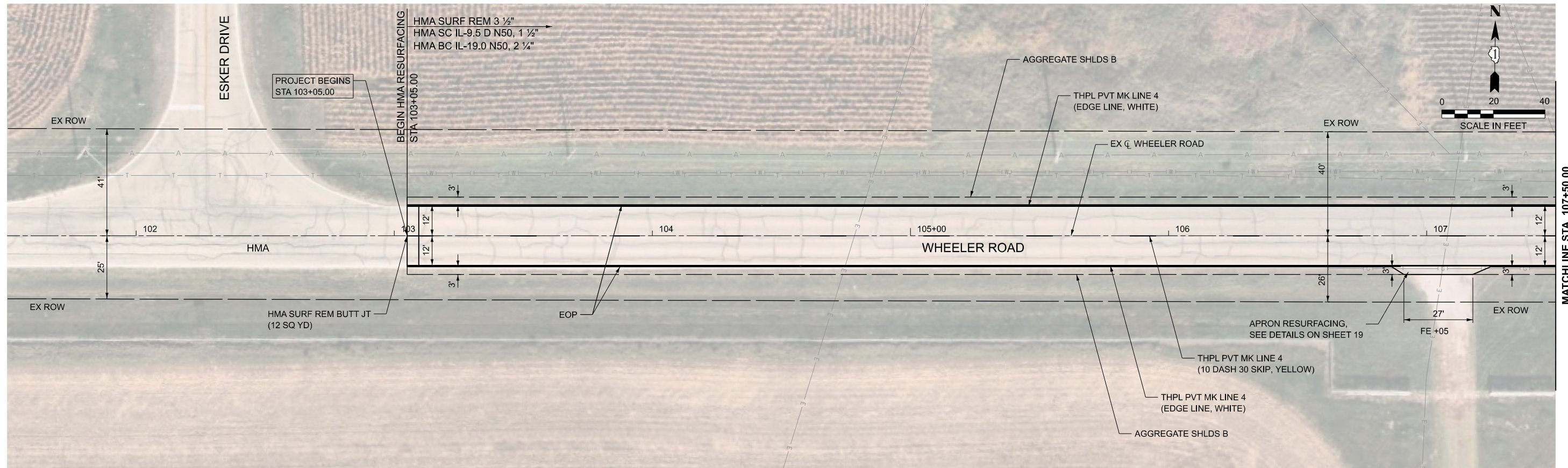

MODEL: SH-01  
 FILE NAME: \\hrgreen.com\hrg\Data\2023\2303999\CAD\Sheets\2303999\_plan.dgn



USER NAME = cwedwck	DESIGNED - CWW	REVISED -
	DRAWN - AJM	REVISED -
PLOT SCALE = 0.16666633' / in.	CHECKED - JRS	REVISED -
PLOT DATE = 3/24/2026	DATE - 3/24/2026	REVISED -

**STATE OF ILLINOIS  
 DEPARTMENT OF TRANSPORTATION**

**RESURFACING PLANS  
 WHEELER ROAD**

SCALE: 1"=20' SHEET 1 OF 8 SHEETS STA. 101+50.00 TO STA. 113+50.00

F.A.U. RTE.	SECTION	COUNTY	TOTAL SHEETS	SHEET NO.
2305	25-00037-00-RS	KANE	26	11
CONTRACT NO. 61M42				
ILLINOIS FED. AID PROJECT				

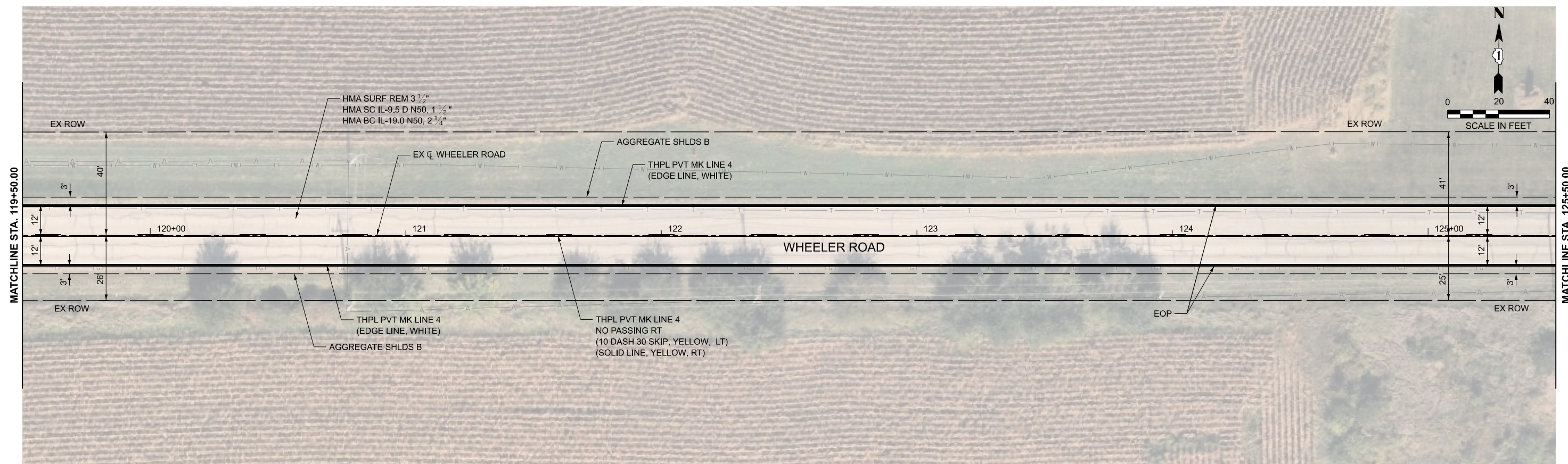
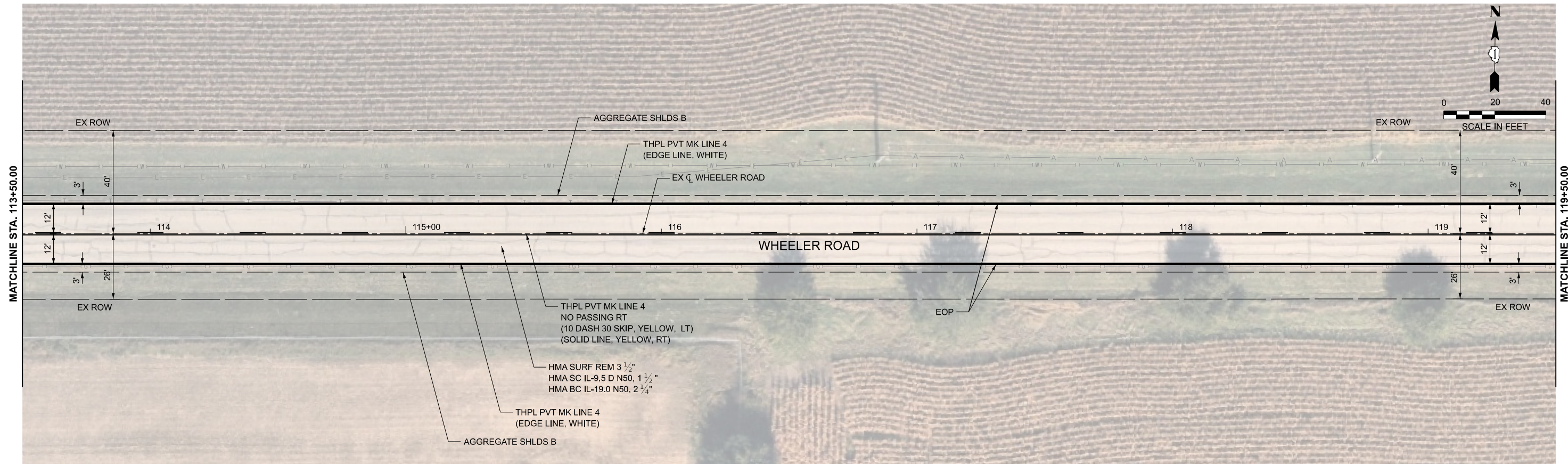

MODEL: SH-02  
 FILE NAME: \\hrgreen.com\hrg\Drawings\2023\2303999\CAD\Sheets\2303999\_plan.dgn



USER NAME = cwedwck	DESIGNED - CWW	REVISED -
DRAWN - AJM	REVISED -	
PLOT SCALE = 0.16666633' / in.	CHECKED - JRS	REVISED -
PLOT DATE = 3/24/2026	DATE - 3/24/2026	REVISED -

**STATE OF ILLINOIS  
 DEPARTMENT OF TRANSPORTATION**

**RESURFACING PLANS  
 WHEELER ROAD**

SCALE: 1"=20'      SHEET 2 OF 8 SHEETS      STA. 113+50.00 TO STA. 125+50.00

F.A.U. RTE.	SECTION	COUNTY	TOTAL SHEETS	SHEET NO.
2305	25-00037-00-RS	KANE	26	12
CONTRACT NO. 61M42				
ILLINOIS FED. AID PROJECT				

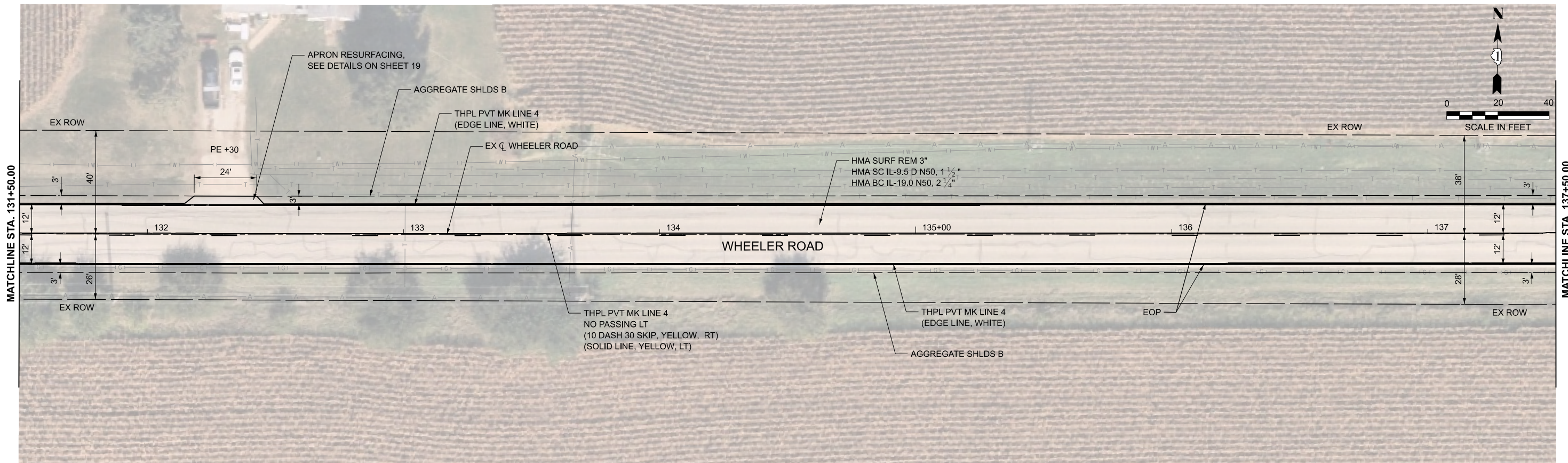
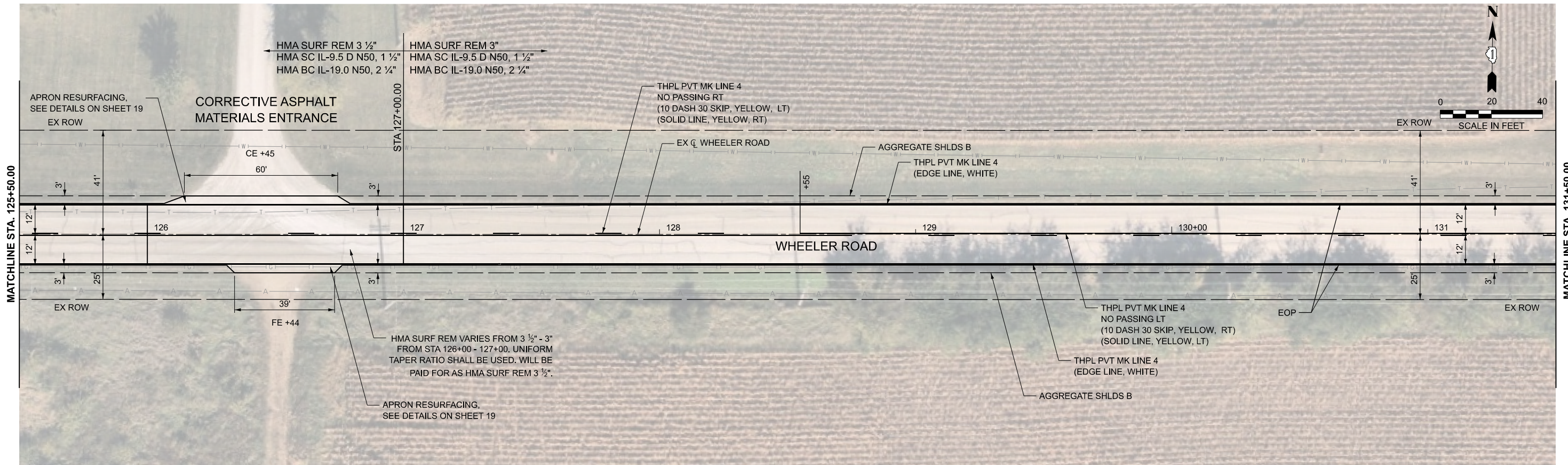

MODEL: SH-03  
 FILE NAME: \\hrgreen.com\hrg\Drawings\2023\2303999\CAD\Sheets\2303999\_plan.dgn



USER NAME = cwedwck	DESIGNED - CWW	REVISED -
PLOT SCALE = 0.16666633' / in.	DRAWN - AJM	REVISED -
PLOT DATE = 3/24/2026	CHECKED - JRS	REVISED -
	DATE - 3/24/2026	REVISED -

**STATE OF ILLINOIS  
 DEPARTMENT OF TRANSPORTATION**

**RESURFACING PLANS  
 WHEELER ROAD**

SCALE: 1"=20' SHEET 3 OF 8 SHEETS STA. 125+50.00 TO STA. 137+50.00

F.A.U. RTE.	SECTION	COUNTY	TOTAL SHEETS	SHEET NO.
2305	25-00037-00-RS	KANE	26	13
CONTRACT NO. 61M42			ILLINOIS FED. AID PROJECT	

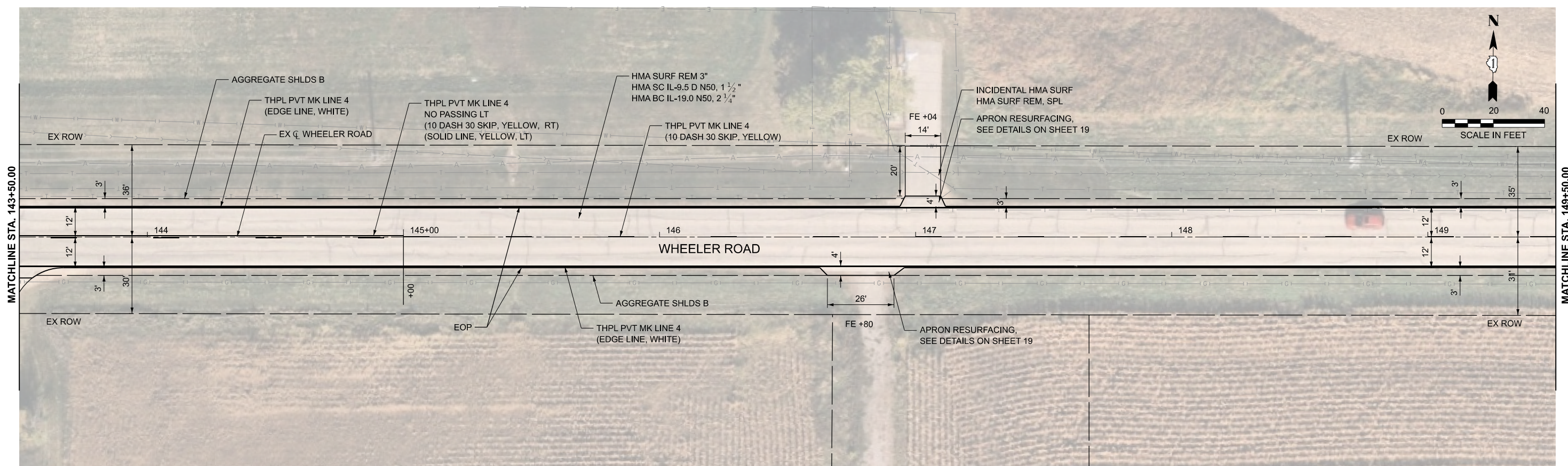
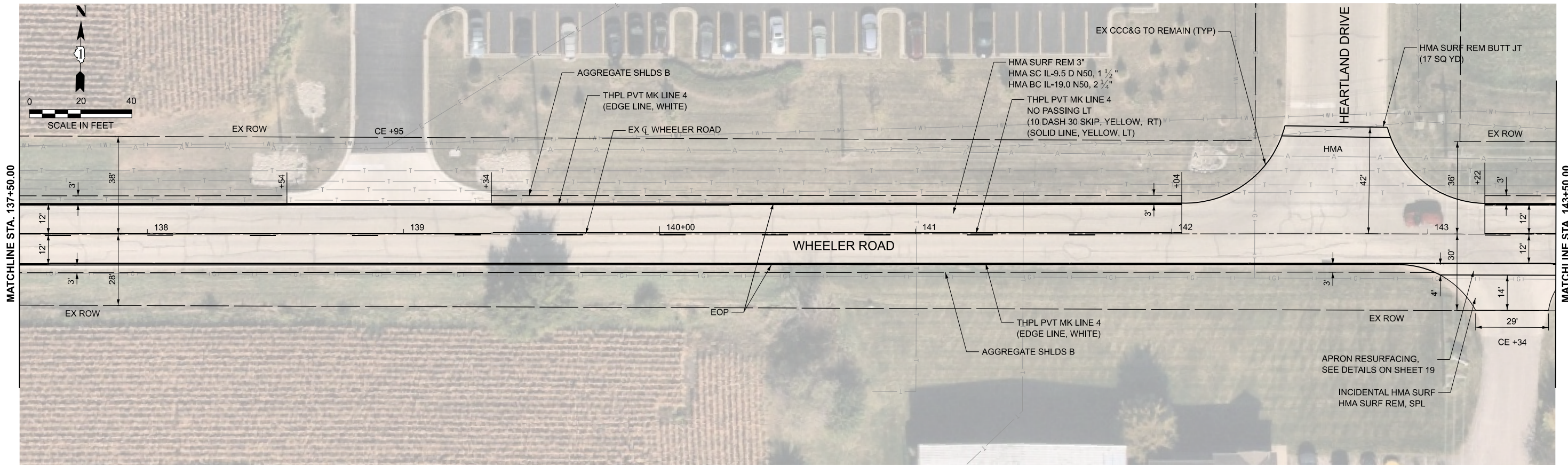

MODEL: SH-04  
 FILE NAME: \\hrgreen.com\hrg\Drawings\2023\2303999\CAD\Sheets\2303999\_plan.dgn



USER NAME = cwwd\mck	DESIGNED - CWW	REVISED -
DRAWN - AJM	REVISED -	
PLOT SCALE = 0.16666633' / in.	CHECKED - JRS	REVISED -
PLOT DATE = 3/24/2026	DATE - 3/24/2026	REVISED -

**STATE OF ILLINOIS  
 DEPARTMENT OF TRANSPORTATION**

**RESURFACING PLANS  
 WHEELER ROAD**

SCALE: 1"=20'    SHEET 4 OF 8 SHEETS    STA. 137+50.00 TO STA. 149+50.00

F.A.U. RTE.	SECTION	COUNTY	TOTAL SHEETS	SHEET NO.
2305	25-00037-00-RS	KANE	26	14
CONTRACT NO. 61M42			ILLINOIS FED. AID PROJECT	

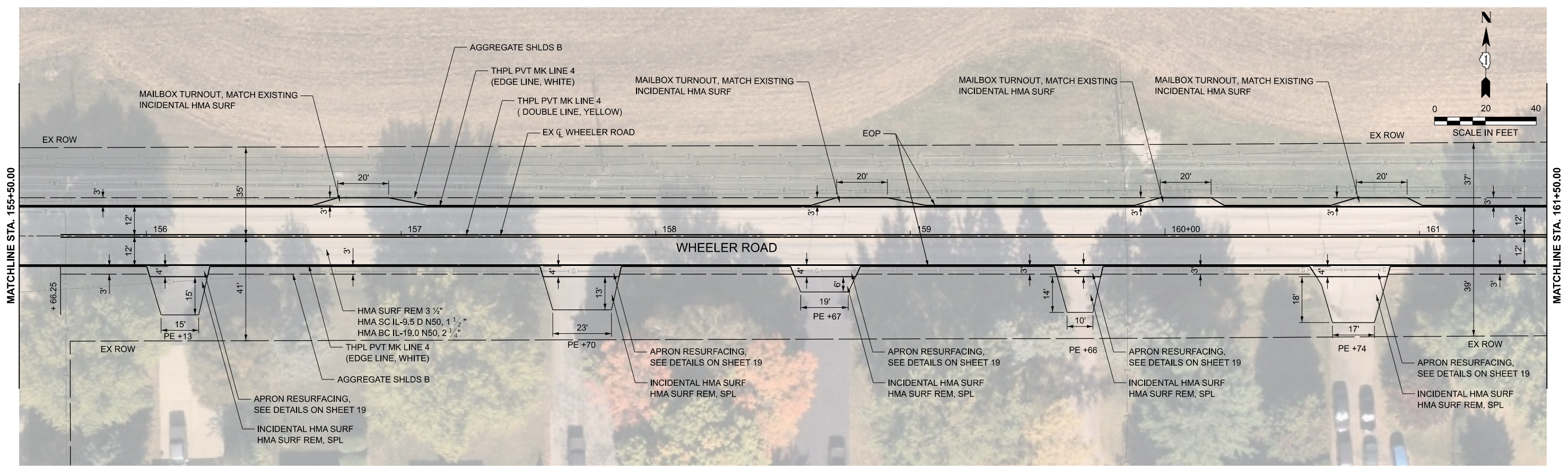
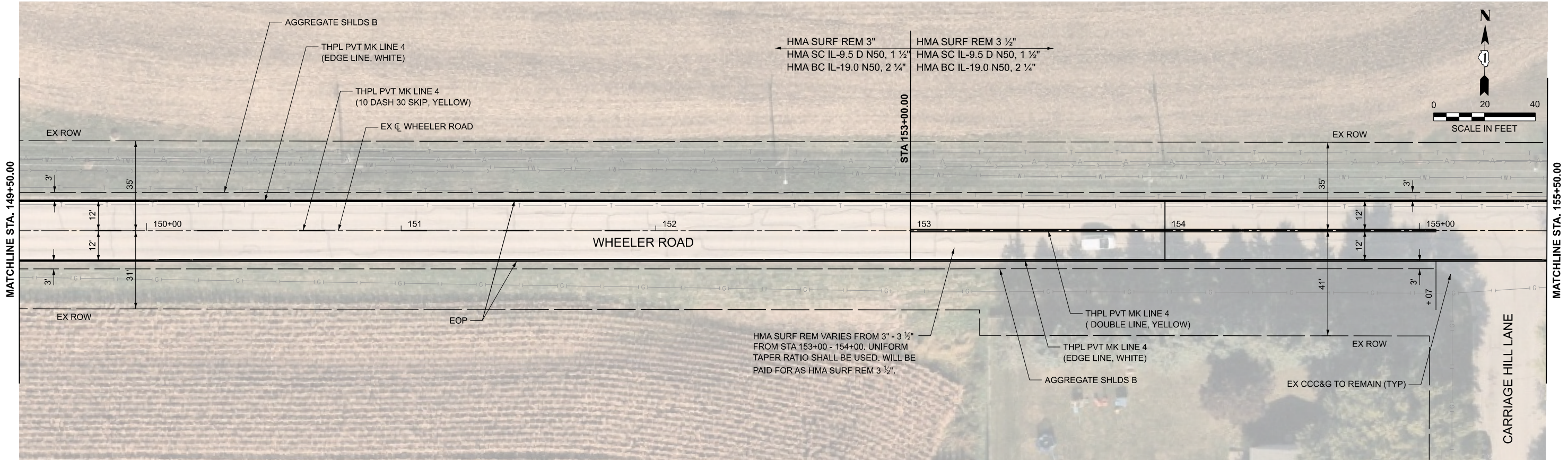

MODEL: SN-05  
 FILE NAME: \\hrgreen.com\hrg\Drawings\2023\2303999\CAD\Sheets\2303999\_plan.dgn



USER NAME = cowedmck	DESIGNED - CWW	REVISED -
DRAWN - AJM	REVISED -	
PLOT SCALE = 0.16666633' / in.	CHECKED - JRS	REVISED -
PLOT DATE = 3/24/2026	DATE - 3/24/2026	REVISED -

**STATE OF ILLINOIS  
 DEPARTMENT OF TRANSPORTATION**

**RESURFACING PLANS  
 WHEELER ROAD**

SCALE: 1"=20'    SHEET 5 OF 8 SHEETS    STA. 149+50.00 TO STA. 161+50.00

F.A.U. RTE.	SECTION	COUNTY	TOTAL SHEETS	SHEET NO.
2305	25-00037-00-RS	KANE	26	15
CONTRACT NO. 61M42				
ILLINOIS FED. AID PROJECT				

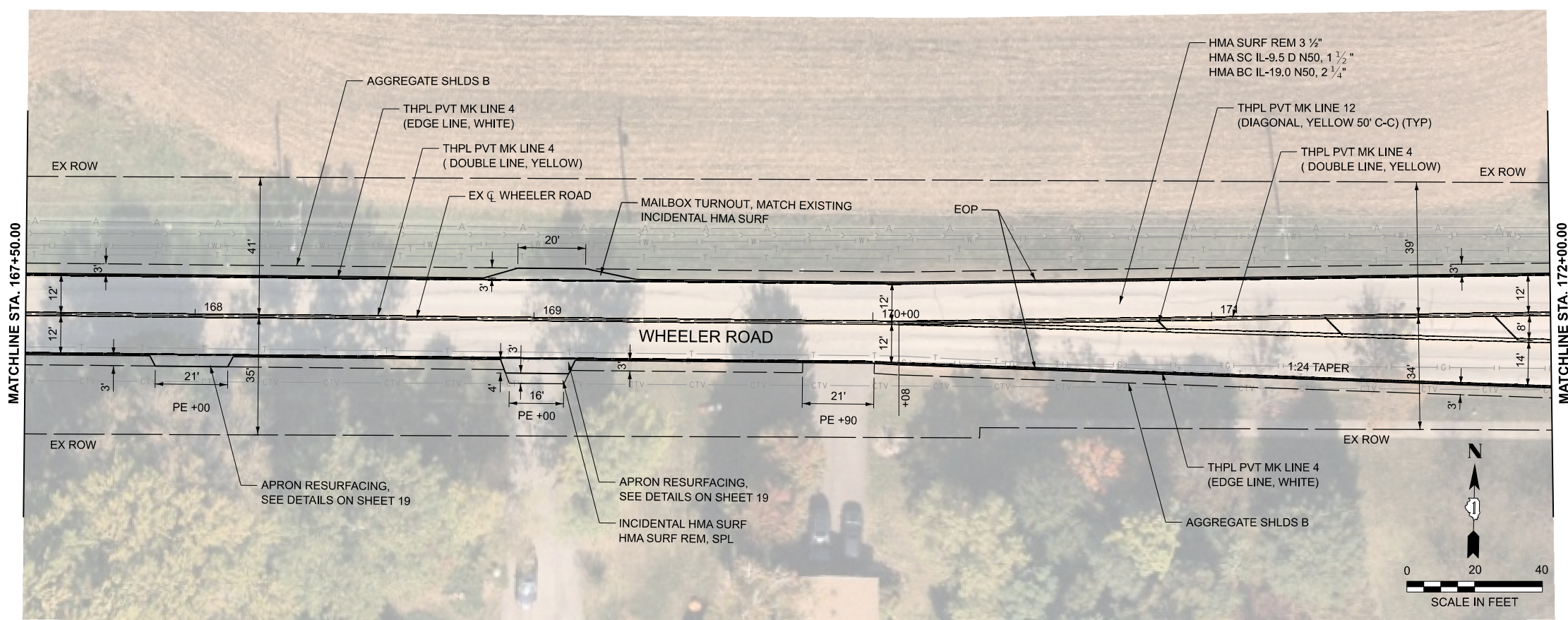
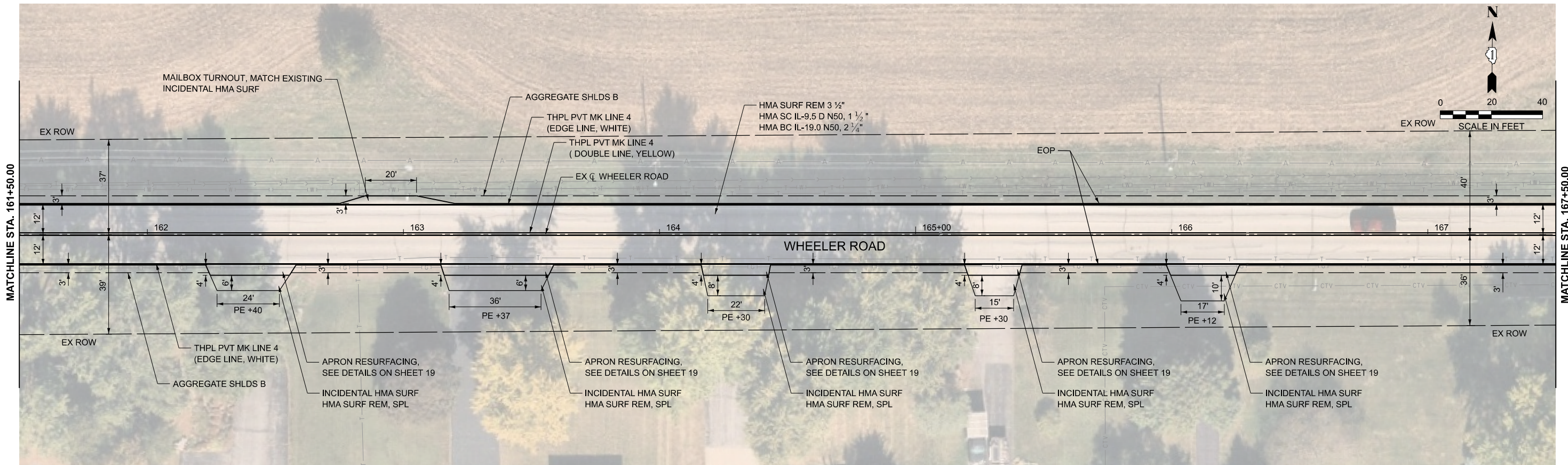

MODEL: SN-06  
 FILE NAME: \\hrgreen.com\hrg\Drawings\2023\2303999\CAD\Sheets\2303999\_pln.dgn



USER NAME = cowedmck	DESIGNED - CWW	REVISED -
DRAWN - AJM	REVISED -	
PLOT SCALE = 0.16666833' / in.	CHECKED - JRS	REVISED -
PLOT DATE = 3/24/2026	DATE - 3/24/2026	REVISED -

**STATE OF ILLINOIS  
 DEPARTMENT OF TRANSPORTATION**

**RESURFACING PLANS  
 WHEELER ROAD**

SCALE: 1"=20' SHEET 6 OF 8 SHEETS STA. 161+50.00 TO STA. 172+00.00

F.A.U. RTE.	SECTION	COUNTY	TOTAL SHEETS	SHEET NO.
2305	25-00037-00-RS	KANE	26	16
CONTRACT NO. 61M42				
ILLINOIS FED. AID PROJECT				

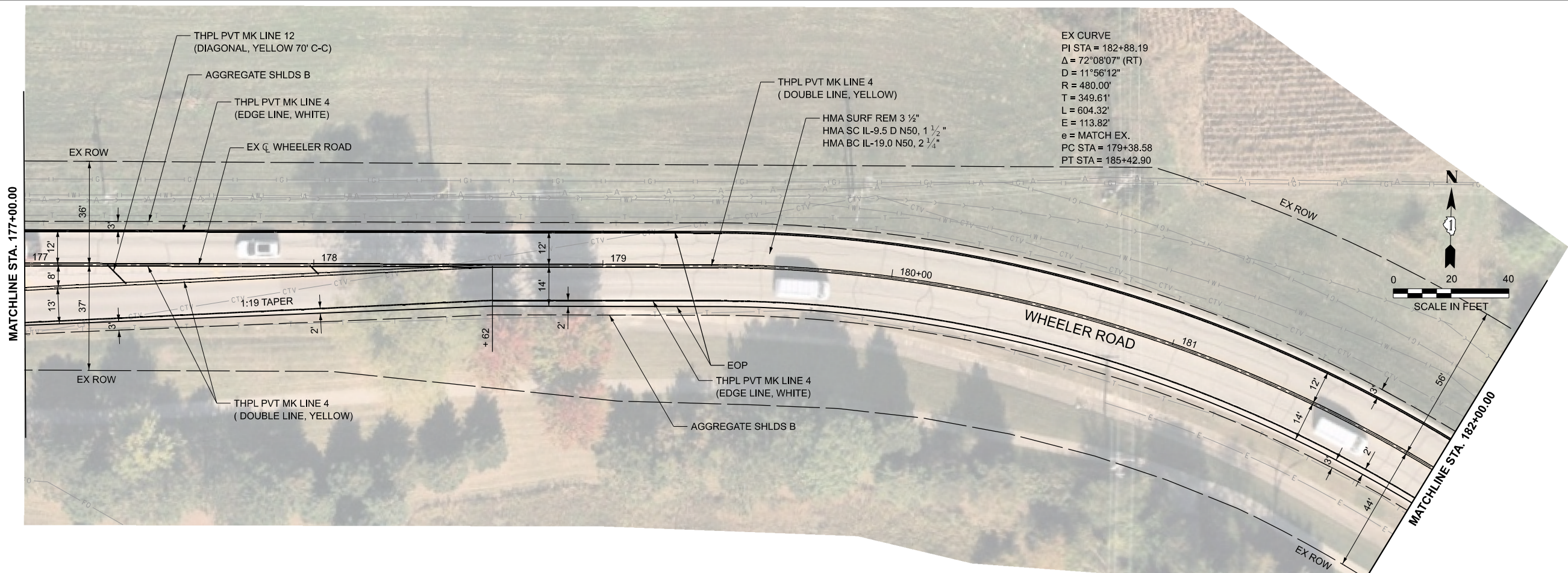
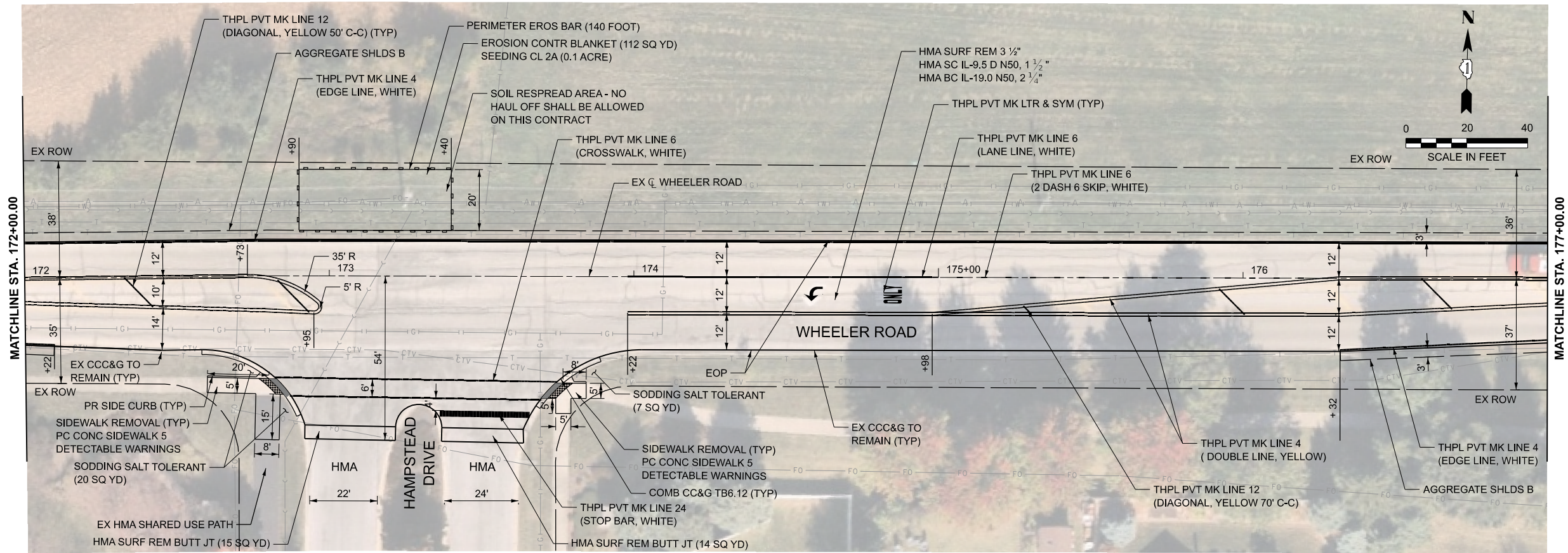

EX CURVE  
 PI STA = 182+88.19  
 $\Delta = 72^{\circ}08'07''$  (RT)  
 $D = 11^{\circ}56'12''$   
 $R = 480.00'$   
 $T = 349.61'$   
 $L = 604.32'$   
 $E = 113.82'$   
 $e = \text{MATCH EX.}$   
 PC STA = 179+38.58  
 PT STA = 185+42.90

MODEL: SN-07  
 FILE NAME: \\hrgreen.com\hrg\Drawings\2023\2303999\CAD\Sheets\2303999\_plan.dgn



USER NAME = cowedmck	DESIGNED - CWW	REVISED -
	DRAWN - AJM	REVISED -
PLOT SCALE = 0.16666633' / in.	CHECKED - JRS	REVISED -
PLOT DATE = 3/24/2026	DATE - 3/24/2026	REVISED -

**STATE OF ILLINOIS  
 DEPARTMENT OF TRANSPORTATION**

**RESURFACING PLANS  
 WHEELER ROAD**

SCALE: 1"=20' SHEET 7 OF 8 SHEETS STA. 172+00.00 TO STA. 182+00.00

F.A.U. RTE.	SECTION	COUNTY	TOTAL SHEETS	SHEET NO.
2305	25-00037-00-RS	KANE	26	17
CONTRACT NO. 61M42				
ILLINOIS FED. AID PROJECT				

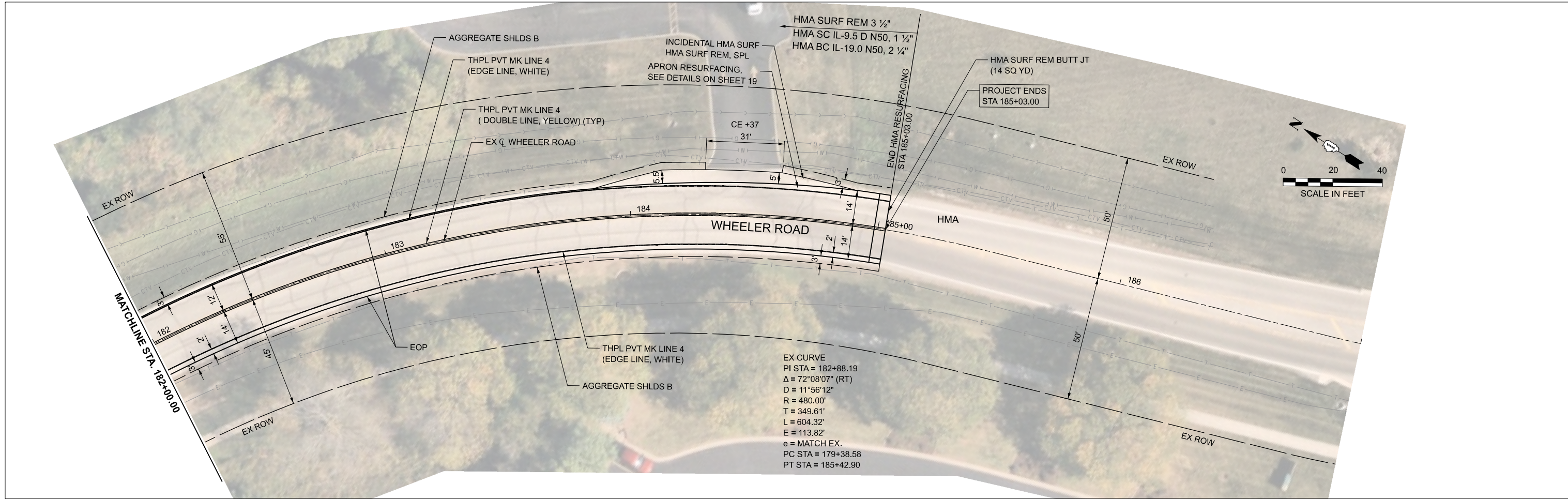

EX CURVE  
 PI STA = 182+88.19  
 $\Delta = 72^{\circ}08'07''$  (RT)  
 $D = 11^{\circ}56'12''$   
 $R = 480.00'$   
 $T = 349.61'$   
 $L = 604.32'$   
 $E = 113.82'$   
 $e =$  MATCH EX.  
 PC STA = 179+38.58  
 PT STA = 185+42.90

MODEL: SH-08  
 FILE NAME: \\hrgreen.com\hrg\Drawings\2023\2303999\CAD\Sheets\2303999\_plan.dgn



USER NAME = cwedwck	DESIGNED - CWW	REVISED -
DRAWN - AJM	REVISED -	
PLOT SCALE = 0.16666633' / in.	CHECKED - JRS	REVISED -
PLOT DATE = 3/24/2026	DATE - 3/24/2026	REVISED -

**STATE OF ILLINOIS  
 DEPARTMENT OF TRANSPORTATION**

**RESURFACING PLANS  
 WHEELER ROAD**

SCALE: 1"=20' SHEET 8 OF 8 SHEETS STA. 182+00.00 TO STA. 187+00.00

F.A.U. RTE.	SECTION	COUNTY	TOTAL SHEETS	SHEET NO.
2305	25-00037-00-RS	KANE	26	18
CONTRACT NO. 61M42			ILLINOIS FED. AID PROJECT	

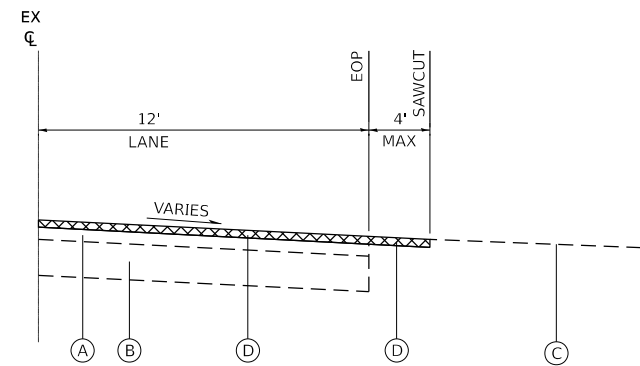

EXISTING / REMOVAL DETAIL

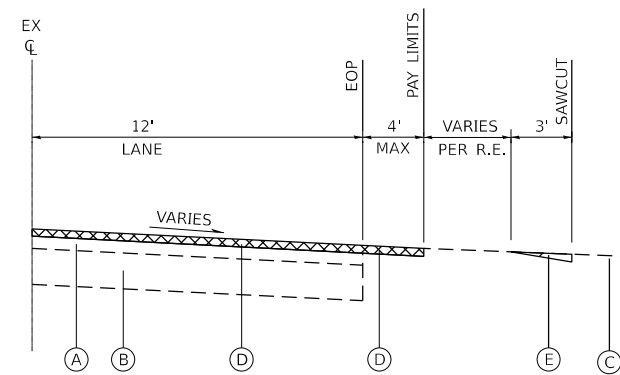

EXISTING / REMOVAL DETAIL

**EXISTING LEGEND**

- (A) EXISTING HOT-MIX ASPHALT PAVEMENT, VARIES
- (B) EXISTING AGGREGATE BASE COURSE
- (C) EXISTING DRIVEWAY PAVEMENT
- (D) HOT-MIX ASPHALT SURFACE REMOVAL, MATCH PLANS 3"-3½"  
(SEE RESURFACING PLANS)
- (E) HOT-MIX ASPHALT SURFACE REMOVAL, SPECIAL (PER SQ YD)

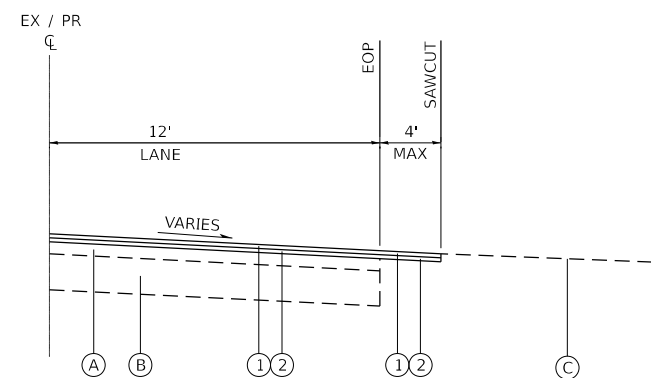

PROPOSED / RESURFACING DETAIL

**CASE I**

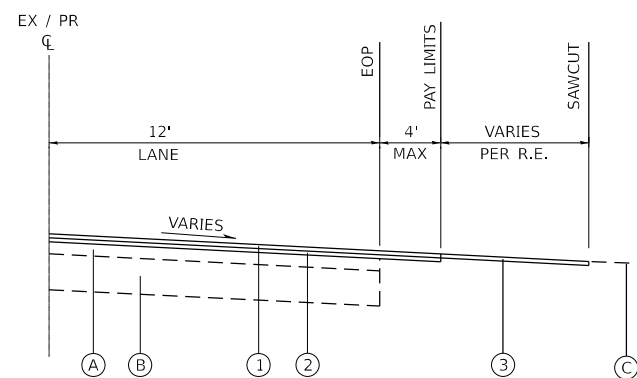

PROPOSED / RESURFACING DETAIL

**CASE II**

**PROPOSED LEGEND**

- (1) PROPOSED RESURFACING: HMA SURFACE COURSE (SEE HMA MIX TABLE)
- (2) PROPOSED RESURFACING: HMA BINDER COURSE (SEE HMA MIX TABLE)
- (3) INCIDENTAL HOT-MIX ASPHALT SURFACING (PER TON)

**DRIVEWAY RESURFACING DETAILS**

STATE OF ILLINOIS  
DEPARTMENT OF TRANSPORTATION

MISCELLANEOUS DETAILS  
WHEELER ROAD

F.A.U. RTE.	SECTION	COUNTY	TOTAL SHEETS	SHEET NO.
2305	25-00037-00-RS	KANE	26	19
CONTRACT NO.			61M42	
ILLINOIS		FED. AID PROJECT		

SCALE: N.T.S. SHEET 1 OF 9 SHEETS STA. TO STA.

MODEL: SH - 01  
FILE NAME: \\hrgreen.com\hrg\Drawings\2023\2303999\CAD\Sheets\2303999\_det.dgn



USER NAME = cwedmck	DESIGNED - CWW	REVISED -
	DRAWN - AJM	REVISED -
PLOT SCALE = 0.16666833' / In.	CHECKED - JRS	REVISED -
PLOT DATE = 3/24/2026	DATE - 3/24/2026	REVISED -



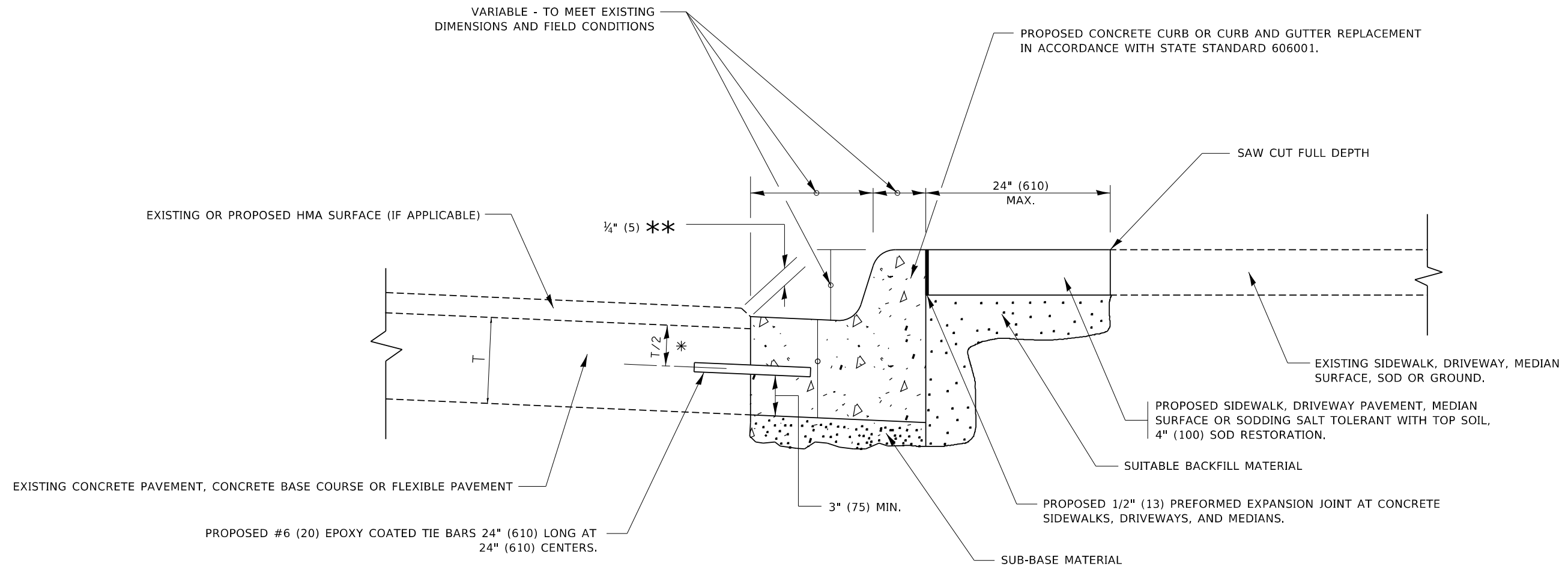

- \* 3" (75) MINIMUM FROM TOP AND BOTTOM OF THE CONCRETE PAVEMENT OR BASE COURSE.
- \*\* IF THE FINAL SURFACE OF THE PAVEMENT IS CONCRETE, THE GUTTER IS TO BE FLUSH WITH THE PAVEMENT.

# CURB OR CURB AND GUTTER REMOVAL AND REPLACEMENT

ALL DIMENSIONS ARE IN INCHES (MILLIMETERS) UNLESS OTHERWISE SHOWN.

MODEL: D:\inf\...  
 FILE: 104416...  
 PROJECT: RWIDOT\Documents\DOT Office\Herf...

USER NAME - footemj	DESIGNED - A. HOUSEH	REVISED - A. ABBAS 03-21-97
	DRAWN -	REVISED - M. GOMEZ 01-22-01
PLOT SCALE - 50.0000 */ in.	CHECKED -	REVISED - R. BORO 12-15-09
PLOT DATE - 7/11/2019	DATE - 03-11-94	REVISED - K. SMITH 07-11-19

**STATE OF ILLINOIS  
DEPARTMENT OF TRANSPORTATION**

**CURB OR CURB AND GUTTER  
REMOVAL AND REPLACEMENT**

SCALE: NONE    SHEET 1 OF 1 SHEETS    STA.    TO STA.

F.A.U. RTE.	SECTION	COUNTY	TOTAL SHEETS	SHEET NO.
2305	25-00037-00-RS	KANE	26	21
<b>BD600-06 (BD-24)</b>			CONTRACT NO. 61M42	
ILLINOIS FED. AID PROJECT				

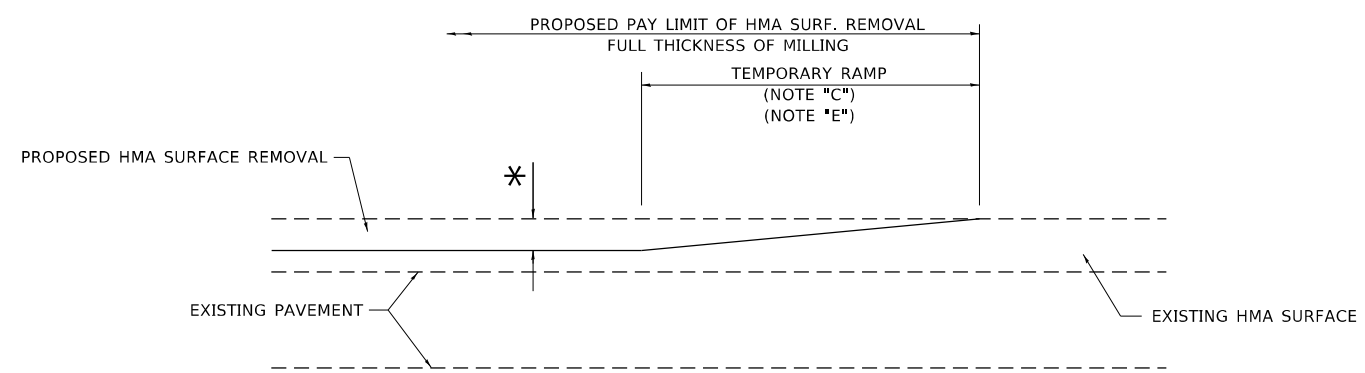

**MILLED TEMPORARY RAMP**  
(FOR BUTT JOINT AND HMA TAPER SEE DETAIL BELOW)

**OPTION 1**

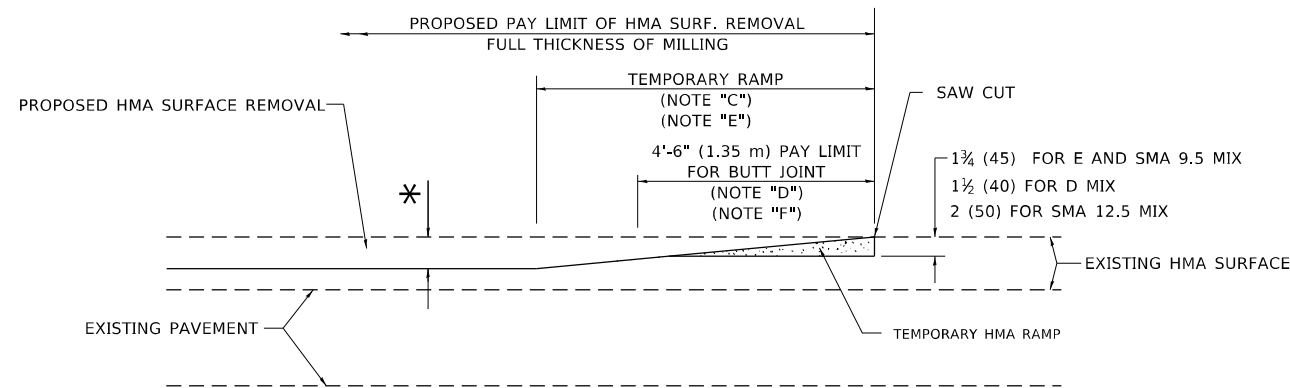

**HMA CONSTRUCTED TEMPORARY RAMP**  
(FOR BUTT JOINT AND HMA TAPER SEE DETAIL BELOW)

**OPTION 2**

**TYPICAL TEMPORARY RAMP**

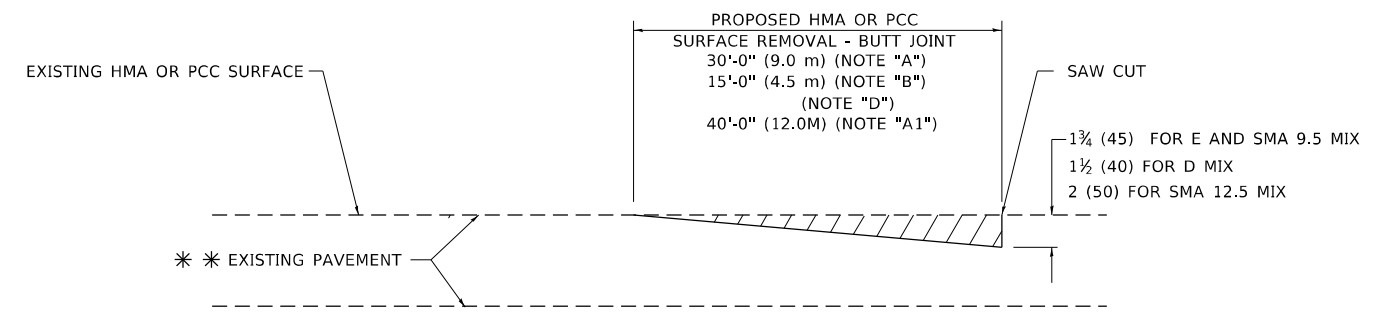

**BUTT JOINT DETAIL**

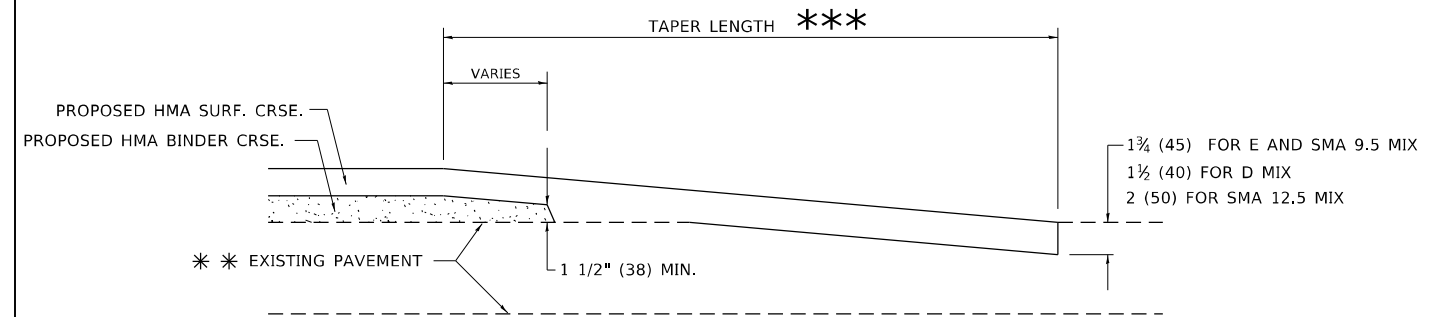

**HMA TAPER DETAIL**

**TYPICAL BUTT JOINT AND HMA TAPER FOR RESURFACING ONLY**

\*\*\* PC CONCRETE, HMA OR HMA RESURFACED PAVEMENT.

**GENERAL NOTES**

- A. MAINLINE ARTERIAL ROADWAYS AND MAJOR SIDE ROADS.
- A1. INTERSTATES
- B. MINOR SIDE ROADS.
- C. THE TEMP. RAMP SHALL BE CONSTRUCTED IMMEDIATELY UPON REMOVAL OF THE EXISTING HMA SURFACE.
- D. THE BUTT JOINT SHALL BE CONSTRUCTED IMMEDIATELY PRIOR TO PLACING THE PROPOSED HMA COURSES.
- E. TAPER THE TEMP. RAMP AT A RATE OF 3' - 4" (1.02m) PER 1 INCH (25 mm) OF MILLING THICKNESS.  
\* SEE TYPICAL SECTIONS FOR MILLING THICKNESS.
- F. SEE ARTICLE 406.08 AND 406.14 OF THE STANDARD SPECIFICATIONS FOR "HMA AND/OR PCC SURFACE REMOVAL, BUTT JOINT".  
\*\*\* 20'-0" (6.1 m) PER 1 (25) RESURFACING (NOTE "A")  
10'-0" (3.0 m) PER 1 (25) RESURFACING (NOTE "B")

**BASIS OF PAYMENT**

1. THE BUTT JOINT WILL BE PAID FOR AT THE CONTRACT UNIT PRICE PER SQUARE YARD (SQUARE METER) FOR "HOT-MIX ASPHALT SURFACE REMOVAL - BUTT JOINT" OR FOR "PORTLAND CEMENT CONCRETE SURFACE REMOVAL- BUTT JOINT".
2. THE TEMPORARY RAMP AND SAW CUT SHALL BE INCLUDED IN THE UNIT COST FOR HMA OR PCC SURFACE REMOVAL-BUTT JOINT.

ALL DIMENSIONS ARE IN INCHES (MILLIMETERS) UNLESS OTHERWISE SHOWN.

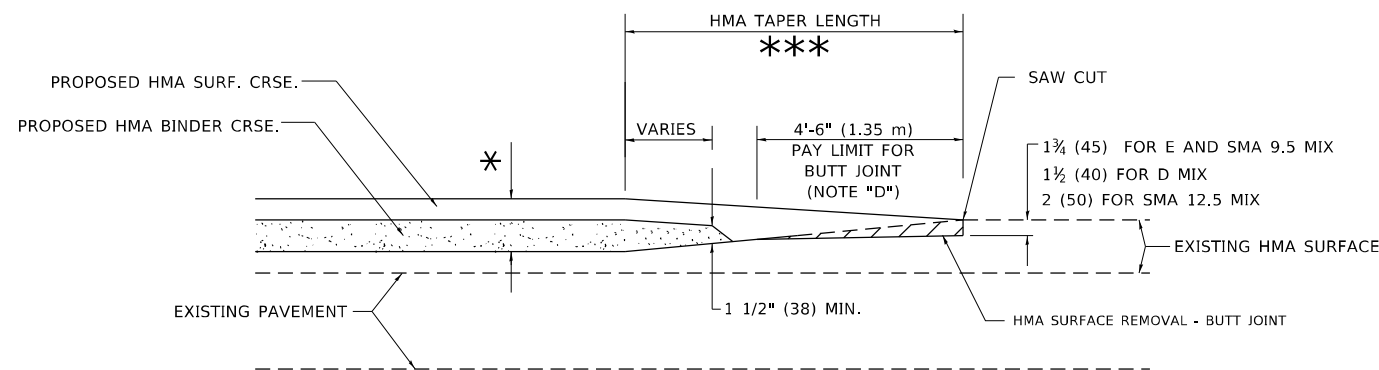

**BUTT JOINT AND HMA TAPER**

**TYPICAL BUTT JOINT AND HMA TAPER FOR MILLING AND RESURFACING**

MODEL: Default  
 FILE: hma\_rs\_surf\_remove\_butt\_joints.dwg  
 PROJECT: 25-00037-00-RS  
 SHEET: 22 OF 26  
 DATE: 11/18/2022

USER NAME	Lawrence, DeManche	DESIGNED	M. DE YONG	REVISED	A. ABBAS 03-21-97
DRAWN		REVISION	M. GOMEZ 04-06-01		
PLOT SCALE	100.0000' / in.	CHECKED		REVISED	R. BORO 01-01-07
PLOT DATE	11/18/2022	DATE	06-13-90	REVISED	K. SMITH 11-18-22

STATE OF ILLINOIS  
DEPARTMENT OF TRANSPORTATION

SCALE: NONE		SHEET 1 OF 1 SHEETS		STA. TO STA.	
-------------	--	---------------------	--	--------------	--

BUTT JOINT AND HMA TAPER DETAILS

F.A.U. RTE.	SECTION	COUNTY	TOTAL SHEETS	SHEET NO.
2305	25-00037-00-RS	KANE	26	22
BD400-05 BD-32		CONTRACT NO. 61M42		
ILLINOIS FED. AID PROJECT				

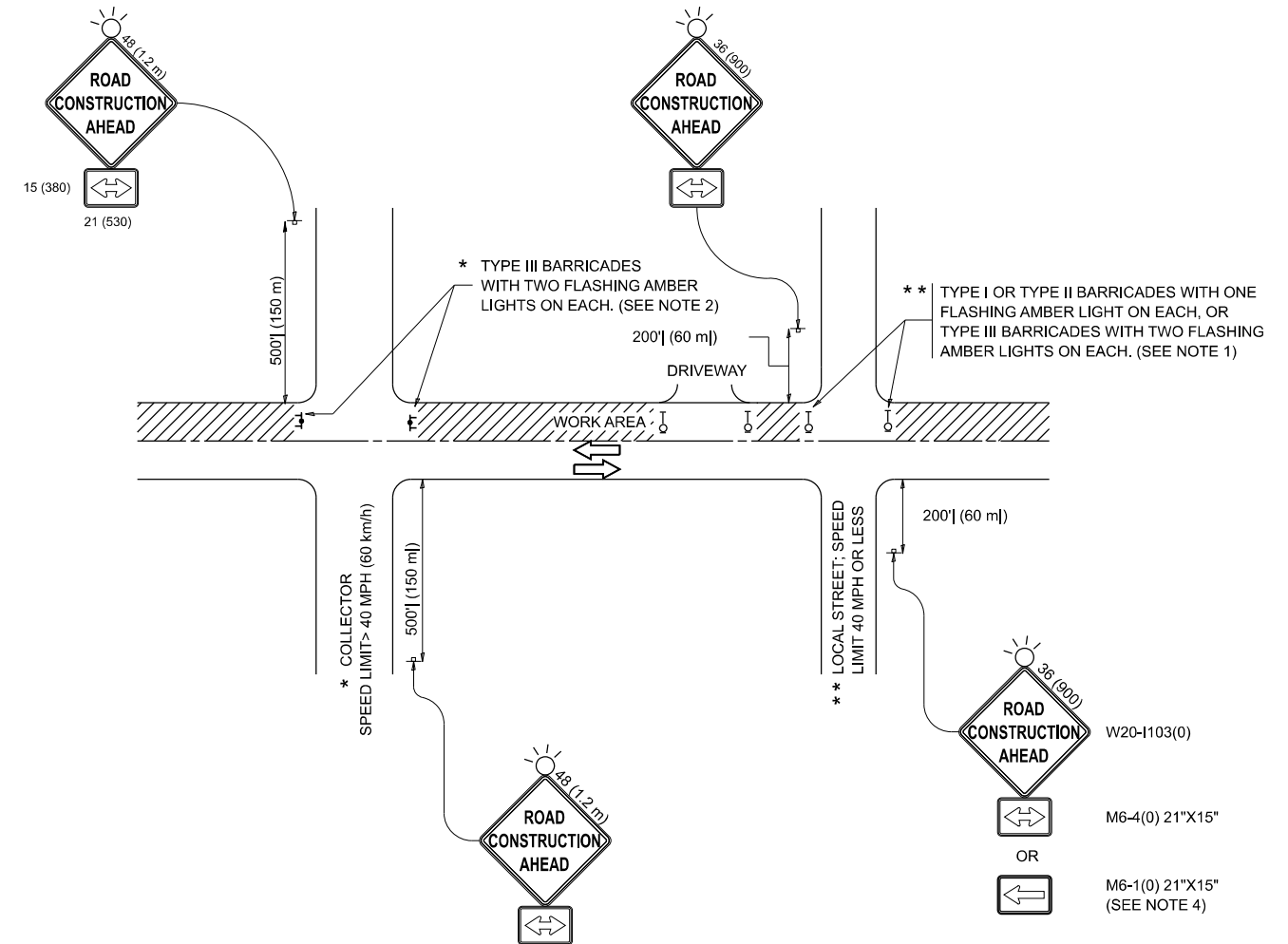

**NOTES:**

1. SIDE ROAD WITH A SPEED LIMIT OF 40 MPH (60 km/h) OR LESS AS SHOWN ON THE DRAWING AND AS DIRECTED BY THE ENGINEER:
  - a) ONE "ROAD CONSTRUCTION AHEAD" SIGN 36 x 36 (900x900) WITH A FLASHER MOUNTED ON IT APPROXIMATELY 200' (60 m) IN ADVANCE OF THE MAIN ROUTE.
  - b) THE CLOSED PORTION OF THE MAIN ROUTE SHALL BE PROTECTED BY BLOCKING WITH TYPE I, TYPE II OR TYPE III BARRICADES, 1/3 OF THE CROSS SECTION OF THE CLOSED PORTION.
2. SIDE ROAD WITH A SPEED LIMIT GREATER THAN 40 MPH (60 km/h) AS SHOWN ON THE DRAWING AND AS DIRECTED BY THE ENGINEER:
  - a) ONE "ROAD CONSTRUCTION AHEAD" SIGN 48 x 48 (1.2 m x 1.2 m) WITH A FLASHER MOUNTED ON IT APPROXIMATELY 500' (150 m) IN ADVANCE OF THE MAIN ROUTE.
  - b) THE CLOSED PORTION OF THE MAIN ROUTE SHALL BE PROTECTED BY BLOCKING WITH TYPE III BARRICADES, 1/2 OF THE CROSS SECTION OF THE CLOSED PORTION.
3. CONES MAY BE SUBSTITUTED FOR BARRICADES OR DRUMS AT HALF THE SPACING DURING DAY OPERATIONS. CONES SHALL BE A MINIMUM OF 28 (710) IN HEIGHT.
4. WHEN THE SIDE ROAD LIES BETWEEN THE BEGINNING OF THE MAINLINE SIGNING AND THE WORK ZONE, A SINGLE HEADED ARROW (M6-1) SHALL BE USED IN LIEU OF THE DOUBLE HEADED ARROW (M6-4).
5. WHEN WORK IS BEING PERFORMED ON A SIDE ROAD OR DRIVEWAY, FOLLOW THE APPLICABLE STANDARD(S). THE DIRECTIONAL ARROW (M6-1 OR M6-4) SHALL BE COVERED OR REMOVED WHEN NO LONGER CONSISTENT WITH THE TRAFFIC CONTROL SET-UP.
6. ADVANCE WARNING SIGNS ARE TO BE OMITTED ON DRIVEWAYS UNLESS OTHERWISE SPECIFIED IN THE PLANS OR BY THE ENGINEER.
7. THE TRAFFIC CONTROL AND PROTECTION FOR SIDE ROADS, INTERSECTIONS, AND DRIVEWAYS SHALL BE INCLUDED IN THE COST OF SPECIFIED TRAFFIC CONTROL STANDARDS OR ITEMS.

All dimensions are in inches (millimeters) unless otherwise shown.

**STATE OF ILLINOIS  
DEPARTMENT OF TRANSPORTATION**

**TRAFFIC CONTROL AND PROTECTION FOR  
SIDE ROADS, INTERSECTIONS, AND DRIVEWAYS**

F.A.U. RTE.	SECTION	COUNTY	TOTAL SHEETS	SHEET NO.
2305	25-00037-00-RS	KANE	26	23
<b>TC-10</b>			CONTRACT NO. 61M42	
ILLINOIS FED. AID PROJECT				

SCALE: SHEET OF SHEETS STA. TO STA.

USER NAME	■ lawrence.demanche	DESIGNED	- L.H.A.	REVISED	- T. RAMMACHER 01-06-00
DRAWN	-	CHECKED	-	REVISED	- A. SCHUETZE 07-01-13
PLOT SCALE	■ 0.08333317" / in.	DATE	- 06-89	REVISED	- A. SCHUETZE 09-15-06
PLOT DATE	■ 10/2/2025	DATE	- 06-89	REVISED	- D. SENDERAK 05-03-25

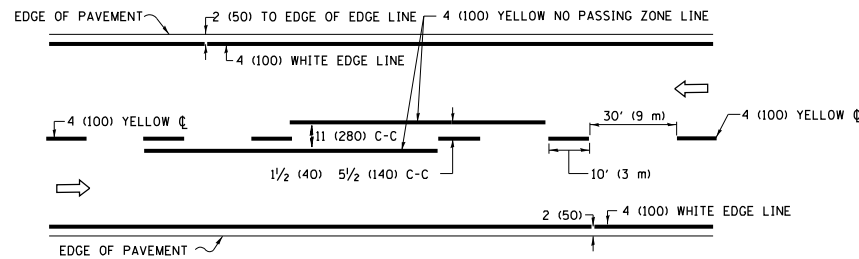

**2-LANE ROADWAY**

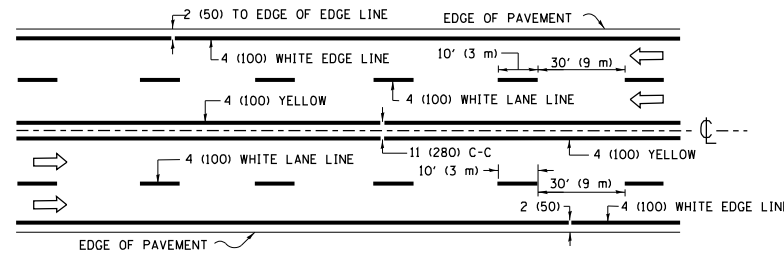

**MULTI-LANE UNDIVIDED**

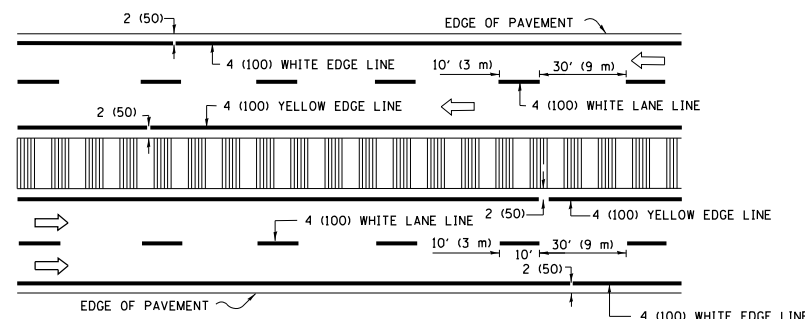

**MULTI-LANE DIVIDED WITH MEDIAN**

**TYPICAL LANE AND EDGE LINE MARKING**

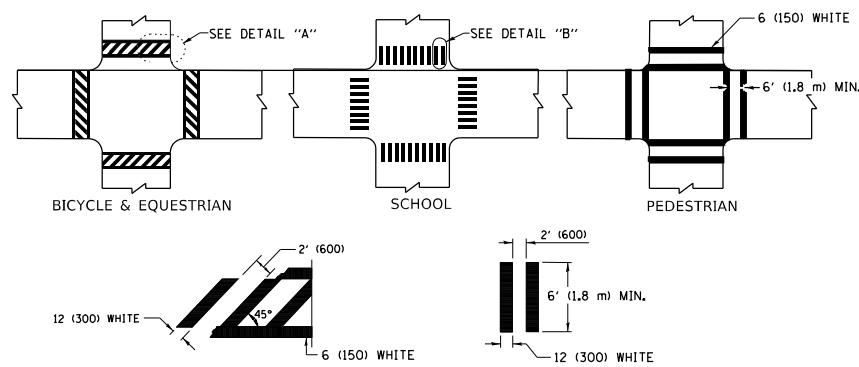

**TYPICAL CROSSWALK MARKING**

\* MARKINGS SHALL BE INSTALLED PARALLEL TO THE CENTERLINE OF THE ROAD WHICH IT CROSSES

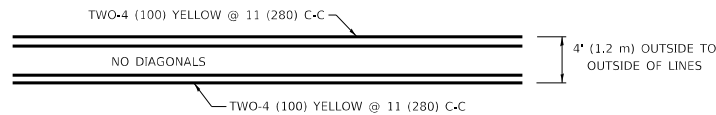

**4' (1.2 m) WIDE MEDIANS ONLY**

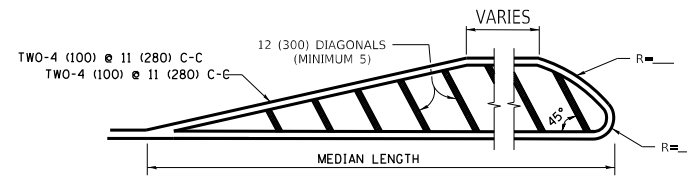

**MEDIANS OVER 4' (1.2 m) WIDE**

DIAGONAL LINE SPACING: 50' (15 m) C-C (LESS THAN 30MPH (50 km/h))  
75' (25 m) C-C 30MPH (50 km/h) TO 45MPH (70 km/h)  
150' (45 m) C-C (MORE THAN 45MPH (70 km/h))

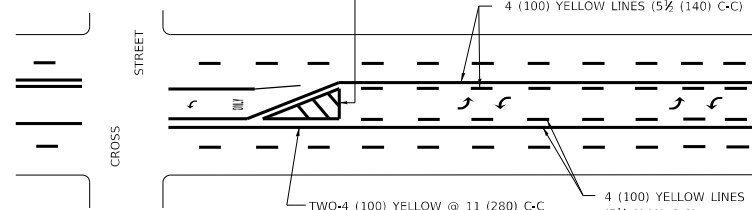

**MEDIAN WITH TWO-WAY LEFT TURN LANE TYPICAL PAINTED MEDIAN MARKING**

A MINIMUM OF TWO PAIRS OF TURN ARROWS SHALL BE USED, WHITE IN COLOR. ADDITIONAL PAIRS SHALL BE PLACED AT 200' (60 m) TO 300' (90 m) INTERVALS.

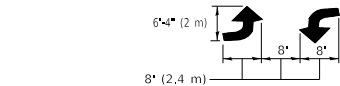

**TYPICAL LEFT (OR RIGHT) TURN LANE**

**TYPICAL TURN LANE MARKING**

FULL SIZE LETTERS 8' (2.4 m) AND ARROWS SHALL BE USED.  
AREA = 15.6 SQ. FT. (1.5 m<sup>2</sup>) ONLY AREA = 20.8 SQ. FT. (1.9 m<sup>2</sup>)  
\* TURN LANES IN EXCESS OF 400' (120 m) IN LENGTH MAY HAVE AN ADDITIONAL SET OF ARROW - \*ONLY\* INSTALLED MIDWAY BETWEEN THE OTHER TWO SETS OF ARROW - \*ONLY\*.

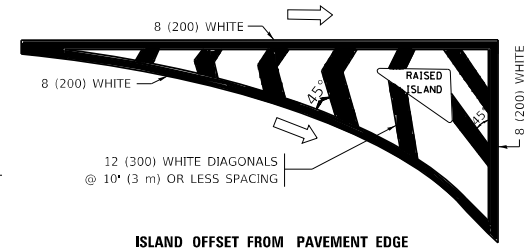

**ISLAND OFFSET FROM PAVEMENT EDGE**

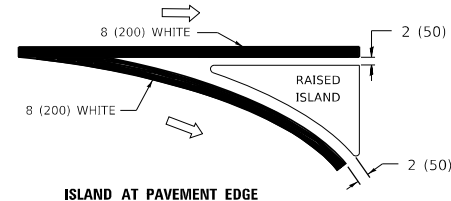

**ISLAND AT PAVEMENT EDGE**

**TYPICAL ISLAND MARKING**

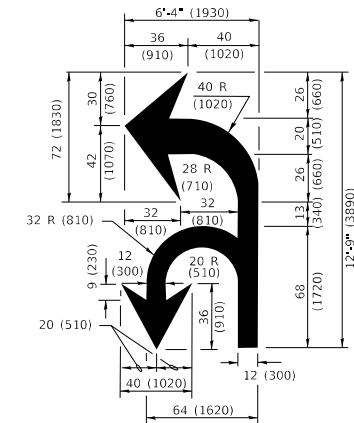

**COMBINATION LEFT AND U-TURN**

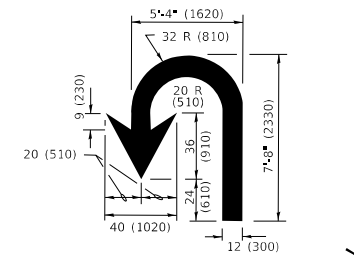

**U-TURN**

**LANE REDUCTION TRANSITION**

\* LANE REDUCTION ARROWS REQUIRED AT SPEEDS OF 45 MPH OR GREATER OR WHEN SPECIFIED IN PLANS.

D(FT)	SPEED LIMIT
345	30
425	35
500	40
580	45
665	50
750	55

TYPE OF MARKING	WIDTH OF LINE	PATTERN	COLOR	SPACING / REMARKS
CENTERLINE ON 2 LANE PAVEMENT	4 (100)	SKIP-DASH	YELLOW	10' (3 m) LINE WITH 30' (9 m) SPACE
CENTERLINE ON MULTI-LANE UNDIVIDED PAVEMENT	2 @ 4 (100)	SOLID	YELLOW	11 (280) C-C
NO PASSING ZONE LINES: FOR ONE DIRECTION FOR BOTH DIRECTIONS	4 (100) 2 @ 4 (100)	SOLID SOLID	YELLOW YELLOW	5 1/2 (140) C-C FROM SKIP-DASH CENTERLINE 11 (280) C-C OMIT SKIP-DASH CENTERLINE BETWEEN
LANE LINES	4 (100) 5 (125) ON FREEWAYS	SKIP-DASH SKIP-DASH	WHITE WHITE	10' (3 m) LINE WITH 30' (9 m) SPACE
DOTTED LINES (EXTENSIONS OF CENTER, LANE OR TURN LANE MARKINGS)	SAME AS LINE BEING EXTENDED	SKIP-DASH	SAME AS LINE BEING EXTENDED	2' (600) LINE WITH 6' (1.8 m) SPACE
EDGE LINES	4 (100)	SOLID	YELLOW-LEFT WHITE-RIGHT	OUTLINE MEDIANS IN YELLOW
TURN LANE MARKINGS	6 (150) LINE: FULL SIZE LETTERS & SYMBOLS (8' (2.4m))	SOLID	WHITE	SEE TYPICAL TURN LANE MARKING DETAIL
TWO WAY LEFT TURN MARKING	2 @ 4 (100) EACH DIRECTION 8' (2.4m) LEFT ARROW	SKIP-DASH AND SOLID IN PAIRS	YELLOW WHITE	10' (3 m) LINE WITH 30' (9 m) SPACE FOR SKIP-DASH; 5 1/2 (140) C-C BETWEEN SOLID LINE AND SKIP-DASH LINE SEE TYPICAL TWO-WAY LEFT TURN MARKING DETAIL
CROSSWALK LINES (PEDESTRIAN) A. DIAGONALS (BIKE & EQUESTRIAN) B. LONGITUDINAL BARS (SCHOOL)	2 @ 6 (150) 12 (300) @ 45° 12 (300) @ 90°	SOLID SOLID SOLID	WHITE WHITE WHITE	NOT LESS THAN 6' (1.8 m) APART 2' (600) APART 2' (600) APART SEE TYPICAL CROSSWALK MARKING DETAILS.
STOP LINES	24 (600)	SOLID	WHITE	PLACE 4' (1.2 m) IN ADVANCE OF AND PARALLEL TO CROSSWALK, IF PRESENT. OTHERWISE, PLACE AT DESIRED STOPPING POINT, PARALLEL TO CROSSROAD CENTERLINE, WHERE POSSIBLE
PAINTED MEDIANS	2 @ 4 (100) WITH 12 (300) DIAGONALS @ 45° NO DIAGONALS USED FOR 4' (1.2 m) WIDE MEDIANS	SOLID	YELLOW: TWO WAY TRAFFIC WHITE: ONE WAY TRAFFIC	11 (280) C-C FOR THE DOUBLE LINE SEE TYPICAL PAINTED MEDIAN MARKING.
GORE MARKING AND CHANNELIZING LINES	8 (200) WITH 12 (300) DIAGONALS @ 45°	SOLID	WHITE	DIAGONALS: 15' (4.5 m) C-C (LESS THAN 30MPH (50 km/h)) 20' (6 m) C-C 30MPH (50 km/h) TO 45MPH (70 km/h) 30' (9 m) C-C (OVER 45MPH (70 km/h))
RAILROAD CROSSING	24 (600) TRANSVERSE LINES: *RR* IS 6' (1.8 m) LETTERS: 16 (400) LINE FOR *X*	SOLID	WHITE	SEE STATE STANDARD 780001 AREA OF: *R* = 3.6 SQ. FT. (0.33 m <sup>2</sup> ) EACH *X* = 54.0 SQ. FT. (5.0 m <sup>2</sup> )
SHOULDER DIAGONALS (REQUIRED FOR SHOULDERS ≥ 8')	12 (300) @ 45°	SOLID	WHITE - RIGHT YELLOW - LEFT	50' (15 m) C-C (LESS THAN 30MPH (50 km/h)) 75' (25 m) C-C (30 MPH (50 km/h) TO 45MPH (70 km/h)) 150' (45 m) C-C (OVER 45MPH (70 km/h))
U TURN ARROW	SEE DETAIL	SOLID	WHITE	16.3 SF
2 ARROW COMBINATION LEFT AND U TURN	SEE DETAIL	SOLID	WHITE	30.4 SF

FOR FURTHER DETAILS ON PAVEMENT MARKING REFER TO STANDARD SPECIFICATIONS FOR ROAD AND BRIDGE CONSTRUCTION AND STATE STANDARD 780001.

All dimensions are in inches (millimeters) unless otherwise shown.

MODEL: D:\ref\1... FILE: I:\state\pav\DOT\Documents\DOT\Office\Ref\1\proj\csl\RS\0223-24\CADD\data\CAD\sheet\c13.dwg

USER NAME - footemj	DESIGNED - EVERS	REVISED - C. JUCIUS 09-09-09
PLOT SCALE = 50.0000" / in.	CHECKED -	REVISED - C. JUCIUS 07-01-13
PLOT DATE = 3/4/2019	DATE - 03-19-90	REVISED - C. JUCIUS 12-21-15
		REVISED - C. JUCIUS 04-12-16

**STATE OF ILLINOIS DEPARTMENT OF TRANSPORTATION**

**DISTRICT ONE TYPICAL PAVEMENT MARKINGS**

SCALE: NONE SHEET 1 OF 2 SHEETS STA. TO STA.

F.A.U. RTE.	SECTION	COUNTY	TOTAL SHEETS	SHEET NO.
2305	25-00037-00-RS	KANE	26	24
TC-13		CONTRACT NO.	61M42	
		ILLINOIS	FED. AID PROJECT	

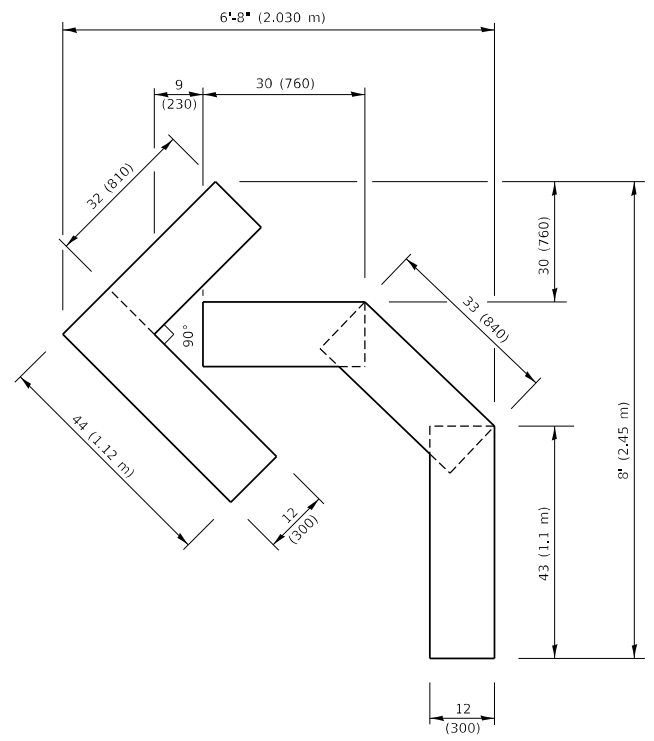

**QUANTITY**  
 4 (100) LINE = 45.5 ft. (13.9 m)  
 15.2 sq. ft. (1.41 sq. m)

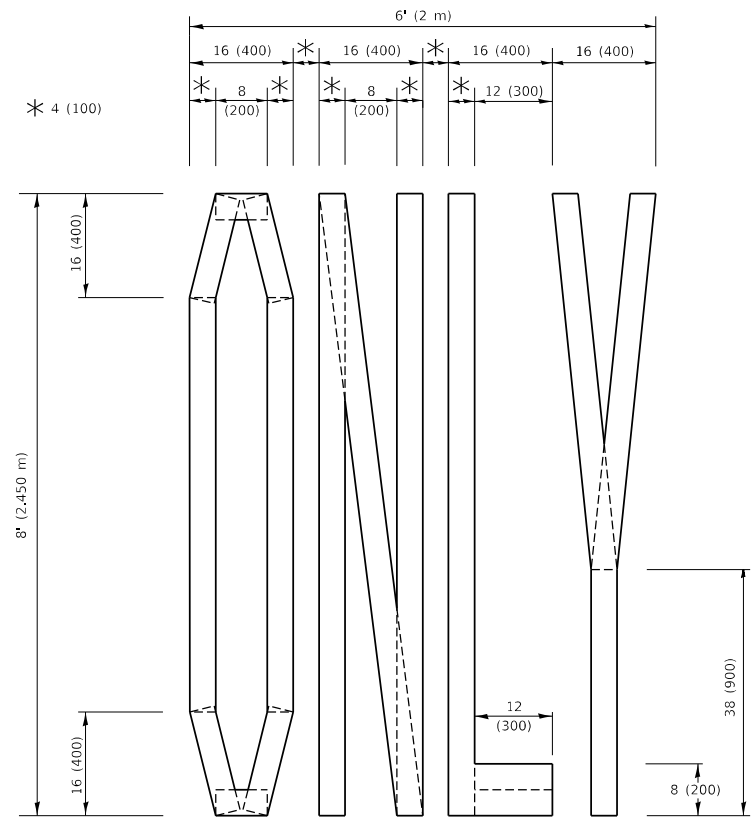

**QUANTITY**  
 4 (100) LINE = 64.1 ft. (19.5 m)  
 21.4 sq. ft. (1.99 sq. m)

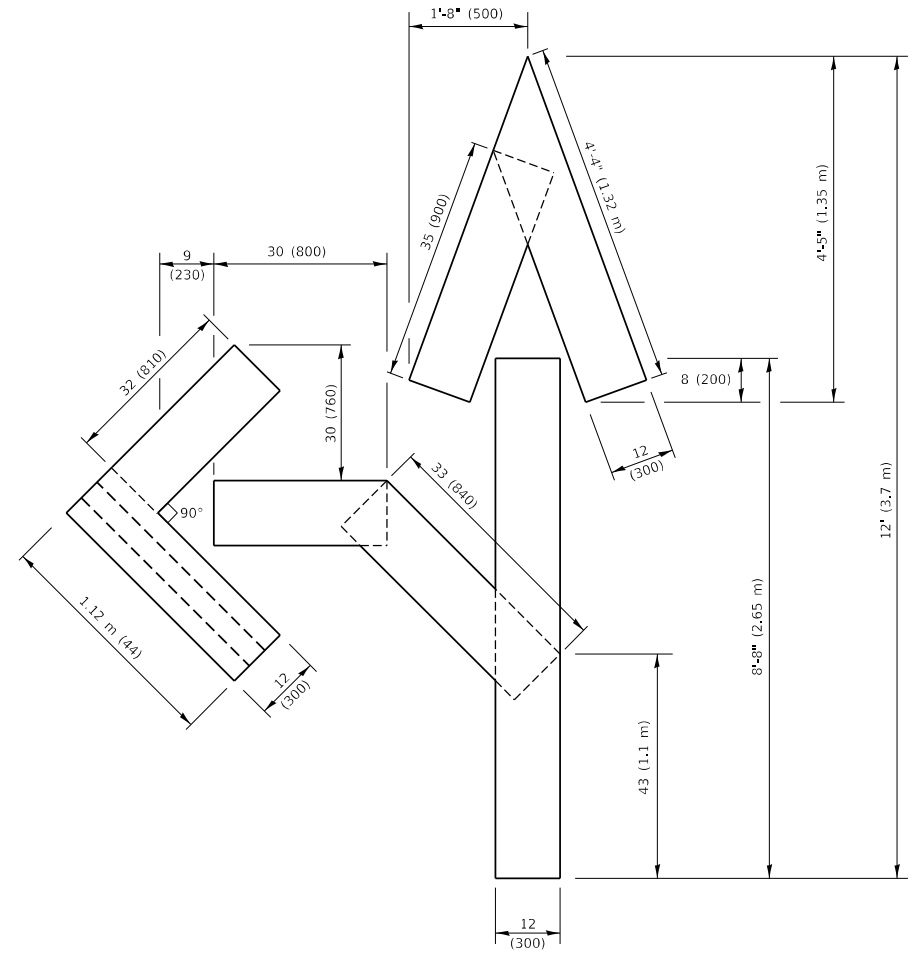

**QUANTITY**  
 4 (100) LINE = 82.5 ft. (25.1 m)  
 27.5 sq. ft. (2.53 sq. m)

**NOTE:**  
 ALL QUANTITIES OF PLACEMENT ARE REPRESENTED IN LINEAR FEET OF 4" LINES TO MATCH THE 4" TEMPORARY TAPE PAY ITEM AND REPRESENTS THE TOTAL QUANTITY OF 4" TAPE REQUIRED.

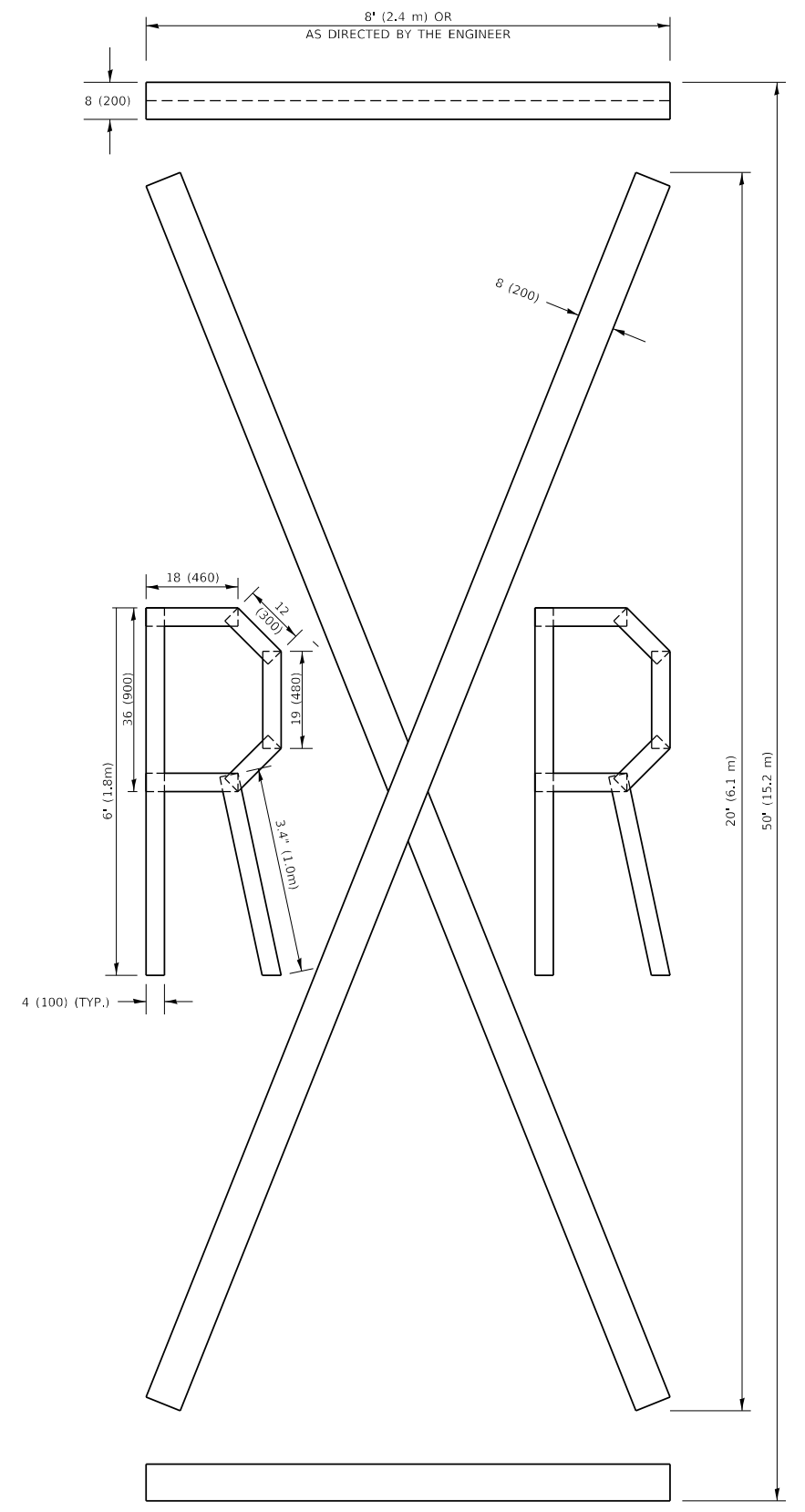

**QUANTITY**  
 4 (100) LINE = 225.9 ft. (68.9 m)  
 75.3 sq. ft. (6.99 sq. m)

All dimensions are in inches (millimeters) unless otherwise shown.

MODEL: Default  
 FILE: \\mapc1108\FEBID\ITEC\H\ak-310\p\WIDOT\Documents\DOT Office\Bartct 1\Projects\BHS\27240\CAD\BNA\CAD\sheet\TC 16.dgn

USER NAME	footemj	DESIGNED	-	REVISED	- T. RAMMACHER 03-02-98
DRAWN	-	CHECKED	-	REVISED	- E. GOMEZ 08-28-00
PLOT SCALE	= 50.0068 * / in.	DATE	- 09-18-94	REVISED	- E. GOMEZ 08-28-00
PLOT DATE	= 3/4/2019	DATE	- 09-18-94	REVISED	- A. SCHUETZE 09-15-16

**STATE OF ILLINOIS  
 DEPARTMENT OF TRANSPORTATION**

**SHORT TERM PAVEMENT MARKING LETTERS AND SYMBOLS**

SCALE: NONE SHEET 1 OF 1 SHEETS STA. TO STA.

F.A.U. RTE.	SECTION	COUNTY	TOTAL SHEETS	SHEET NO.
2305	25-00037-00-RS	KANE	26	25
TC-16			CONTRACT NO. 61M42	
ILLINOIS FED. AID PROJECT				

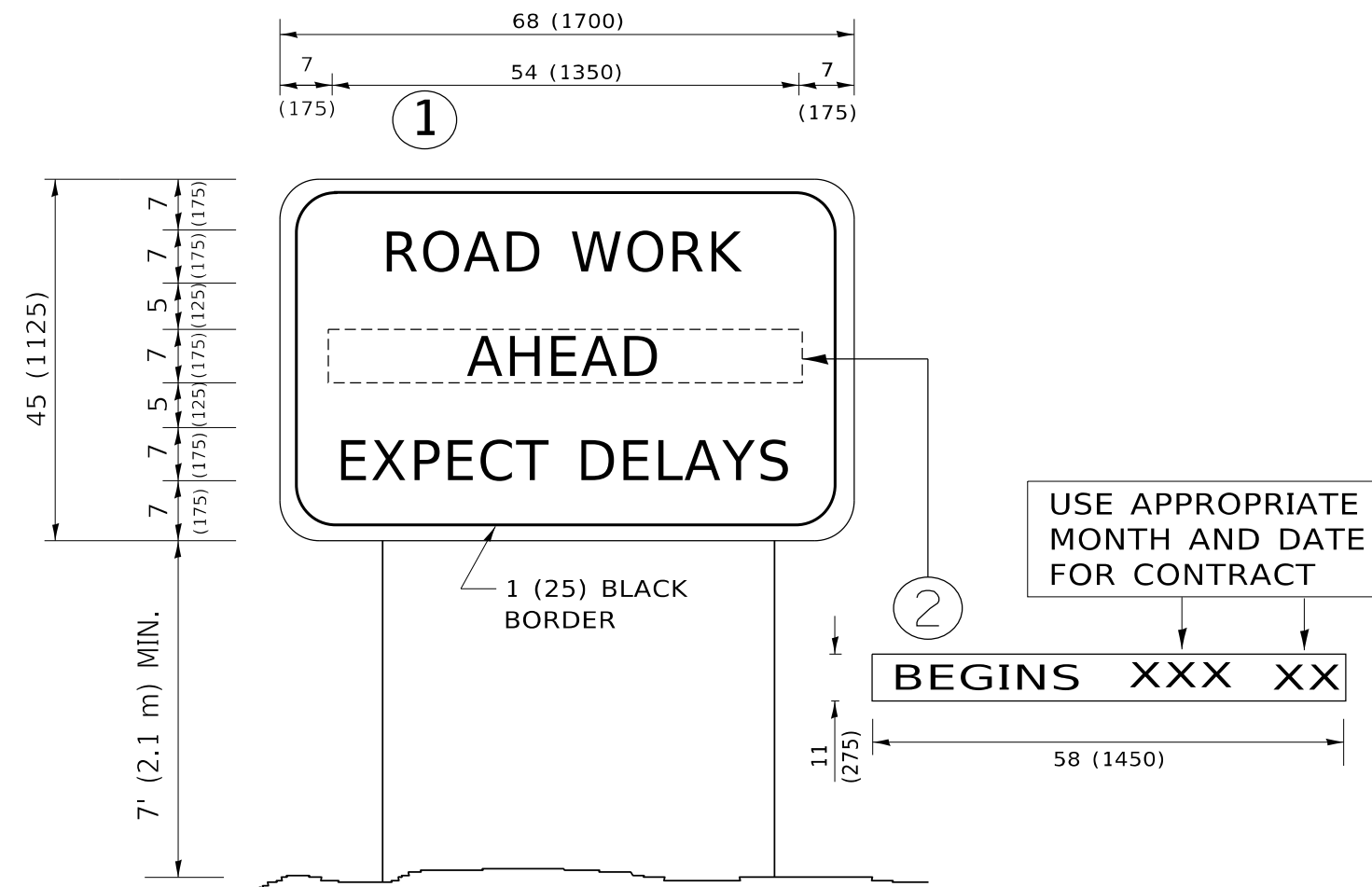

**NOTES:**

1. USE BLACK LETTERING ON ORANGE BACKGROUND.
2. ERECT SIGNS IN ADVANCE OF THE LOCATION FOR THE "ROAD CONSTRUCTION AHEAD" SIGN AT LOCATIONS AS DIRECTED BY THE ENGINEER.
3. ERECT SIGN ① WITH INSTALLED PANEL ② ONE WEEK PRIOR TO THE START OF CONSTRUCTION.
4. REMOVE PANEL ② SOON AFTER THE START OF CONSTRUCTION.
5. SEE SPECIAL PROVISION FOR "TEMPORARY INFORMATION SIGNING" FOR ADDITIONAL INFORMATION.
6. ONE SIGN ASSEMBLY EQUALS 25.70 SQ. FT. (2.3 SQ. M.)
7. SHALL BE PAID FOR AS TEMPORARY INFORMATION SIGNING.

ALL DIMENSIONS ARE IN INCHES (MILLIMETERS) UNLESS OTHERWISE SHOWN.

MODEL: D:\inf\it...  
 FILE: h:\m\c...

USER NAME	- footej	DESIGNED	-	REVISED	- R. MIRS 09-15-97
PLOT SCALE	= 50.0000 * / in.	DRAWN	-	REVISED	- R. MIRS 12-11-97
PLOT DATE	= 3/4/2019	CHECKED	-	REVISED	- T. RAMMACHER 02-02-99
		DATE	-	REVISED	- C. JUCIUS 01-31-07

**STATE OF ILLINOIS  
DEPARTMENT OF TRANSPORTATION**

**ARTERIAL ROAD  
INFORMATION SIGN**

SCALE: NONE SHEET 1 OF 1 SHEETS STA. TO STA.

F.A.U. RTE.	SECTION	COUNTY	TOTAL SHEETS	SHEET NO.
2305	25-00037-00-RS	KANE	26	26
<b>TC-22</b>			CONTRACT NO. 61M42	
ILLINOIS FED. AID PROJECT				