

F.A.P. RTE.	SECTION	COUNTY	TOTAL SHEETS	SHEET NO.
46	(1B)BC-5	LASALLE	6	1
		ILLINOIS	CONTRACT NO. 66T11	

INDEX OF SHEETS

1. COVER SHEET
2. GENERAL NOTES
3. SUMMARY OF QUANTITIES
4. TYPICAL SECTIONS
5. EXISTING PLAN AND ELEVATION FOR STRUCTURE NO. 050-0079
6. BRIDGE DECK SEALING DETAILS

HIGHWAY STANDARDS

- | | |
|-----------|--|
| 000001-09 | STANDARD SYMBOLS, ABBREVIATIONS AND PATTERNS |
| 001006 | DECIMAL OF AN INCH AND OF A FOOT |
| 701001-02 | OFF-ROAD OPERATIONS 2L, 2W, MORE THAN 15' (4.5 m) AWAY |
| 701006-05 | OFF-ROAD OPERATIONS 2L, 2W, 15' (4.5 m) TO 24" (600 mm) FROM PAVEMENT EDGE |
| 701101-05 | OFF-ROAD OPERATIONS, MULTILANE, 15' (4.5 m) TO 24" (600 mm) FROM PAVEMENT EDGE |
| 701106-02 | OFF-ROAD OPERATIONS, MULTILANE, MORE THAN 15' (4.5 m) AWAY |
| 701301-04 | LANE CLOSURE, 2L, 2W, SHORT TIME OPERATIONS |
| 701501-06 | URBAN LANE CLOSURE, 2L, 2W, UNDIVIDED |
| 701901-11 | TRAFFIC CONTROL DEVICES |

PROPOSED HIGHWAY PLANS

F.A.P. ROUTE 46 (IL 251) SECTION (1B)BC-5 PROJECT NHPP-SMV4(537) BRIDGE WASHING LASALLE COUNTY

C-93-170-25

PROJECT LOCATION

**STRUCTURE NO. 050-0079
CARRYING F.A.P. ROUTE 46 (IL 251)
OVER THE ILLINOIS RIVER,
ILLINOIS RAILWAY, AND
IOWA INTERSTATE RAILROAD
0.1 MILES SOUTH OF US ROUTE 6
LASALLE COUNTY**

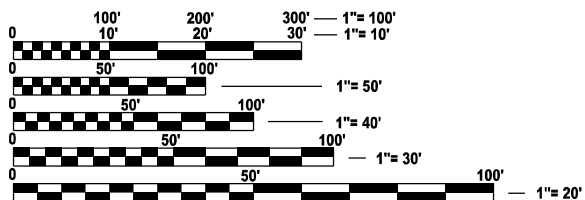

FULL SIZE PLANS HAVE BEEN PREPARED USING STANDARD ENGINEERING SCALES. REDUCED SIZED PLANS WILL NOT CONFORM TO STANDARD SCALES. IN MAKING MEASUREMENTS ON REDUCED PLANS, THE ABOVE SCALES MAY BE USED.

J.U.L.I.E.
JOINT UTILITY LOCATION INFORMATION FOR EXCAVATION
1-800-892-0123
OR 811

**PROJECT ENGINEER: JUNIOR SENAT P.E.
UNIT CHIEF: RON WOODSHANK
DISTRICT 3 (815) 434-6131
CONTRACT NO. 66T11**

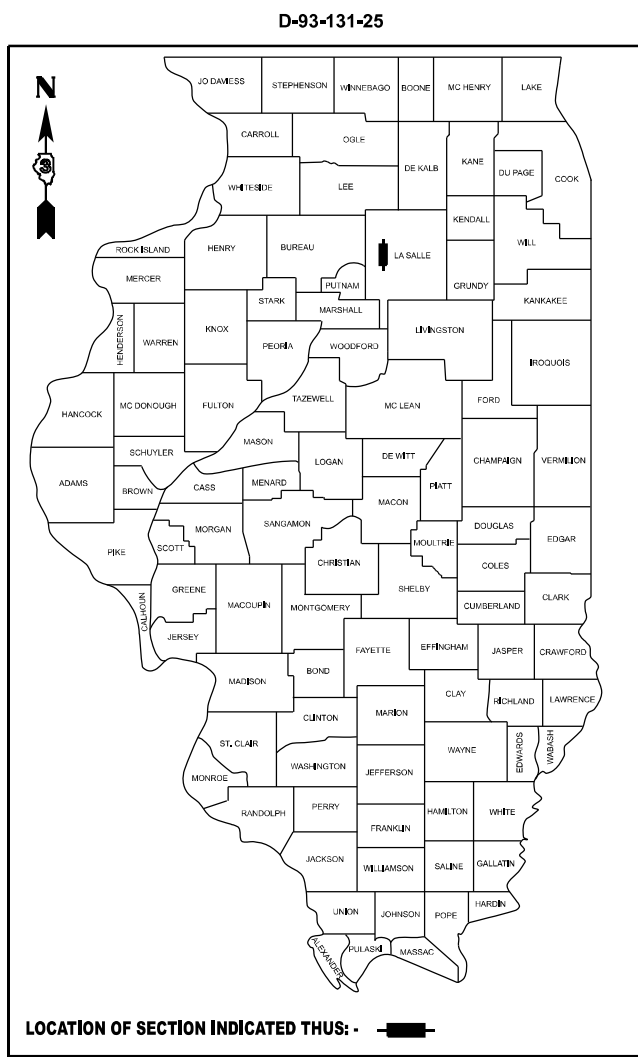
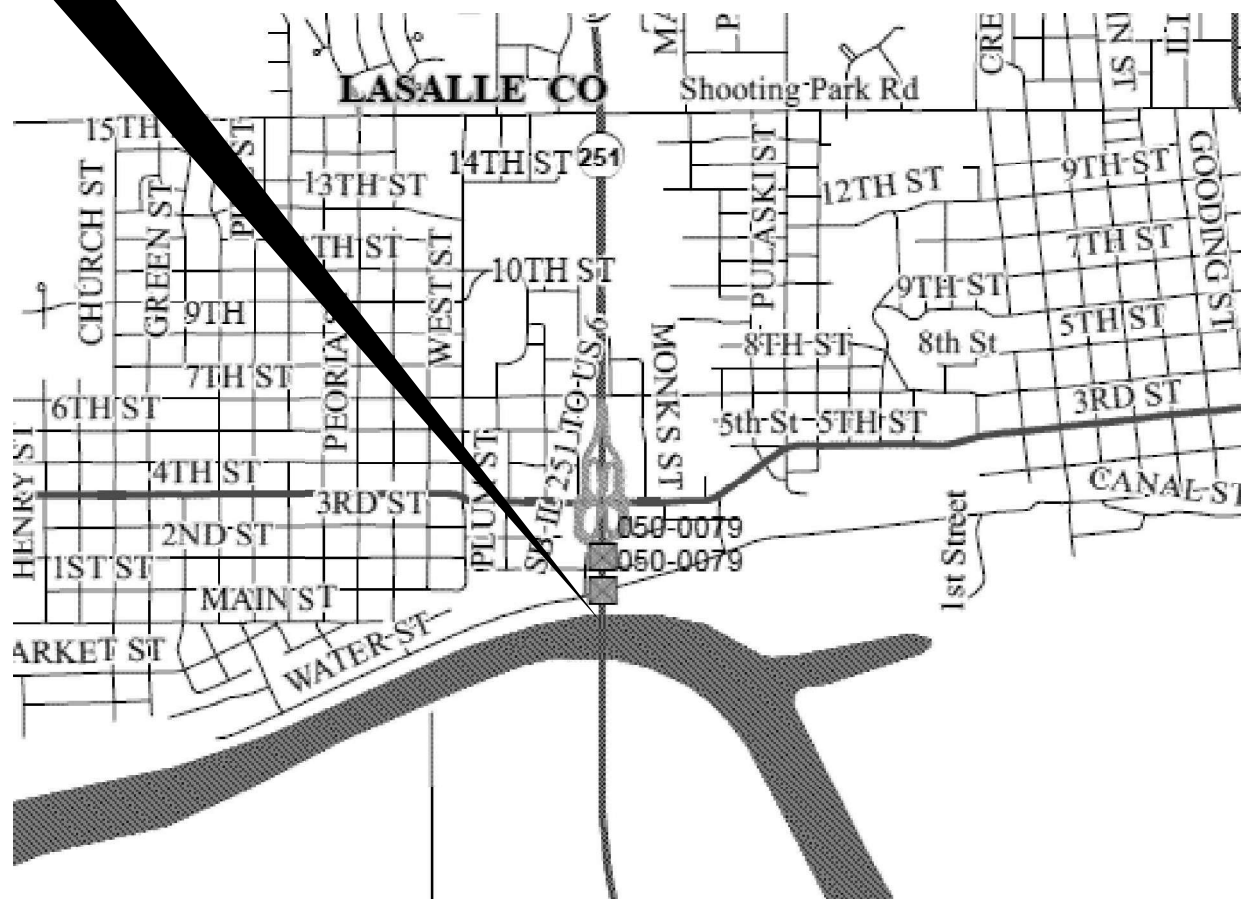

FUNCTIONAL CLASSIFICATION
URBAN - OTHER PRINCIPLE ARTERIAL
F.A.P. ROUTE 46 (IL ROUTE 251)
2023 ADT = 9,700
P.V. 96.0 % S.U. 2.0 % M.U. 2.0 %

STATE OF ILLINOIS
DEPARTMENT OF TRANSPORTATION

SUBMITTED March 25, 2026
Trisha Thompson REGIONAL ENGINEER

May 8, 2026
[Signature] ENGINEER OF DESIGN AND ENVIRONMENT

May 8, 2026
[Signature] DIRECTOR OF HIGHWAYS PROJECT IMPLEMENTATION

**PRINTED BY THE AUTHORITY
OF THE STATE OF ILLINOIS**

GENERAL NOTES

BRIDGE WASHING SHALL INCLUDE THE BRIDGE DECK SURFACE, INSIDE FACE AND TOP SURFACE OF PARAPETS, DECK DRAINS, SCUPPERS, ALL ELEMENTS OF THE SUPERSTRUCTURE, (STEEL FRAMING), AND SUBSTRUCTURE ELEMENTS, (TOP OF ABUTMENT BEARING SEATS AND TOP OF ALL PIERS), FINGER PLATE EXPANSION JOINTS AND TROUGHS.

PRIOR TO ANY CONSTRUCTION WORK BEING PERFORMED ON STRUCTURES OVER NAVIGATIONAL WATERS, IN ACCORDANCE WITH THE SPECIAL PROVISION FOR "COAST GUARD REQUIREMENTS FOR WORKING ABOVE NAVIGATIONAL WATERS", **THE CONTRACTOR** SHALL OBTAIN APPROVAL FROM THE "UNITED STATE COAST GUARD (USCG)

ALL WORK BELOW THE BOTTOM OF THE DECK INCLUDING WASHING THE STRUCTURAL STEEL FROM THE CENTERLINE OF PIER 2 TO THE CENTERLINE OF PIER 4 AND THE CONCRETE SEALING OF THE TOP OF PIER 3 SHALL BE OMITTED. THE CONTRACTOR PERSONNEL SHALL NOT ENCROACH IN THE AREA FROM THE GROUND LEVEL TO THE BOTTOM OF THE DECK BETWEEN PIERS 2 AND PIER 4

COMMITMENTS

THE APPROPRIATE CONTACT INFORMATION AND INSTRUCTIONS ARE PROVIDED IN THE USCG MEMORANDUM INCLUDED IN THIS PROJECT'S COMMITMENT FILE. THE RESIDENT ENGINEER / TECHNICIAN SHALL REVIEW THE SUBJECT MEMORANDUM AND CONVEY THE REQUIRED INFORMATION TO THE CONTRACTOR FOR APPROPRIATE COORDINATION.

**STATE OF ILLINOIS
DEPARTMENT OF TRANSPORTATION
DISTRICT THREE
AS BUILT INFORMATION**

SUPERVISING CONSTRUCTION FIELD ENGINEER

RESIDENT ENGINEER / TECHNICIAN

START & END DATES
OF CONSTRUCTION:

INSPECTORS:

MODEL: D:\InRoads\Projects\I11\CDOT\Documents\DOT Office\District 3\ORD Projects\66T11\CAD\Bldg66T11.dgn
FILE NAME: D:\InRoads\Projects\I11\CDOT\Documents\DOT Office\District 3\ORD Projects\66T11\CAD\Bldg66T11.dgn

USER NAME = Oladele,O.Popoola	DESIGNED - RW	REVISED -
	DRAWN - RW	REVISED -
PLOT SCALE = \$SCALE\$	CHECKED - JS	REVISED -
PLOT DATE = 3/18/2026	DATE - 8/19/2025	REVISED -

**STATE OF ILLINOIS
DEPARTMENT OF TRANSPORTATION**

GENERAL NOTES

SCALE: SHEET 1 OF 1 SHEETS STA. TO STA.

F.A.P. RTE.	SECTION	COUNTY	TOTAL SHEETS	SHEET NO.
46	(1B)BC-5	LASALLE	6	2
CONTRACT NO. 66T11				
		ILLINOIS	FED. AID PROJECT	

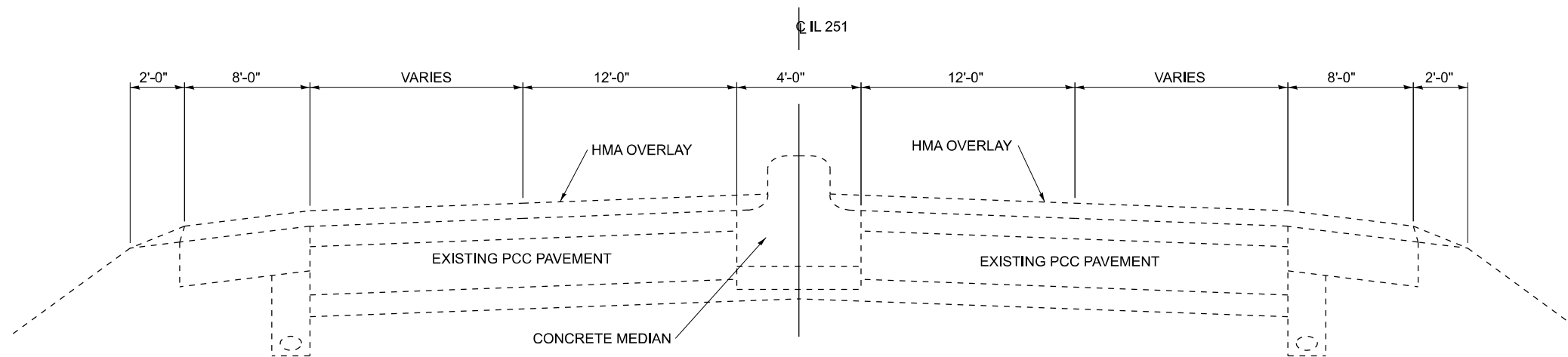

TYPICAL SECTION NO. 1
IL ROUTE 251
 NORTH OF THE RIVER

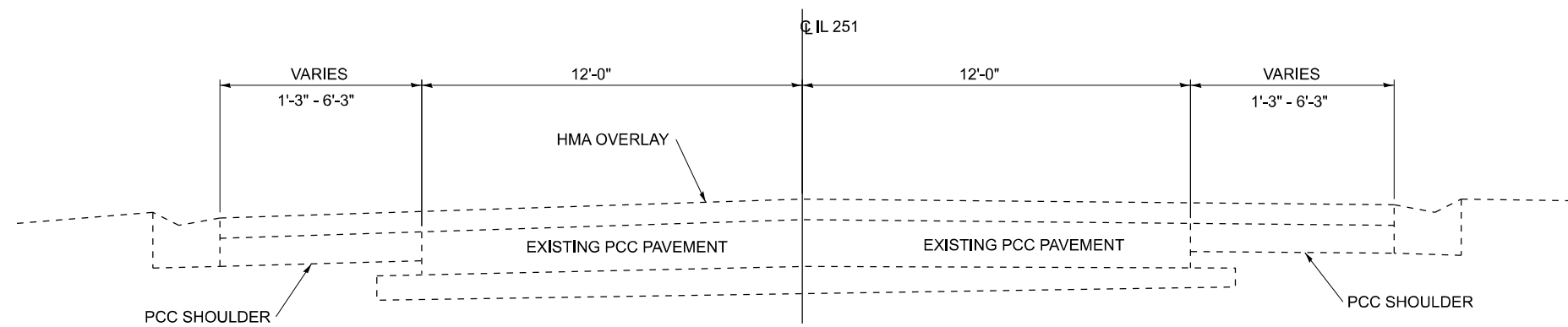

TYPICAL SECTION NO. 2
IL ROUTE 251
 SOUTH OF THE RIVER

MODEL: D:\infuit...
 FILE NAME: ...

USER NAME = Oladele,O.Popoola	DESIGNED - RW	REVISED -
	DRAWN - RW	REVISED -
PLOT SCALE = \$SCALE\$	CHECKED - JS	REVISED -
PLOT DATE = 3/18/2026	DATE - 8/19/2025	REVISED -

STATE OF ILLINOIS
DEPARTMENT OF TRANSPORTATION

TYPICAL SECTION			
SCALE:	SHEET 1	OF 1 SHEETS	STA. TO STA.

F.A.P. RTE.	SECTION	COUNTY	TOTAL SHEETS	SHEET NO.
46	(1B)BC-5	LASALLE	6	4
CONTRACT NO. 66T11				
ILLINOIS FED. AID PROJECT				

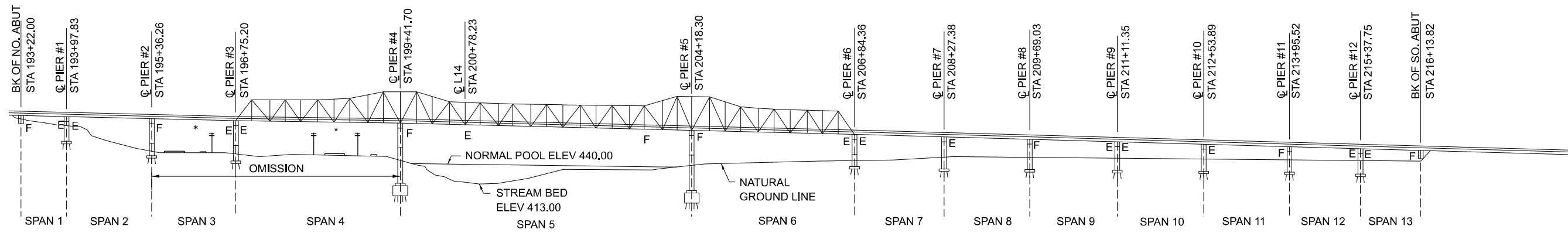

ELEVATION

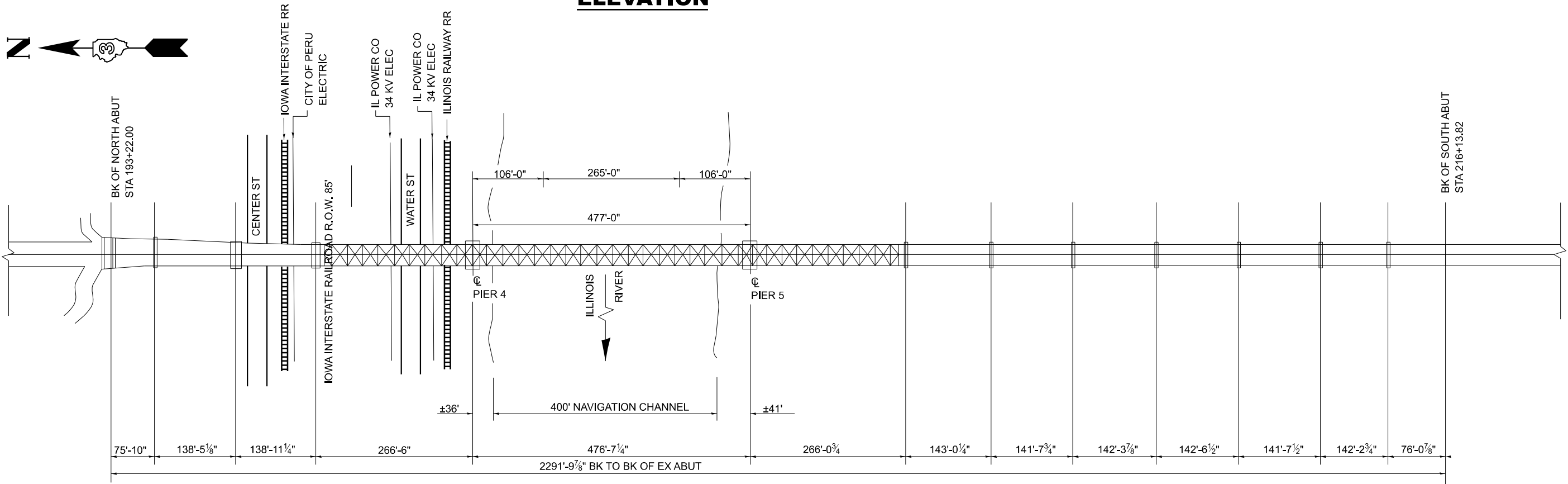

**PLAN
STRUCTURE NO. 050-0079**

MODEL: D:\inf\...
FILE NAME: ...

USER NAME = Oladele, O. Popoola	DESIGNED - RW	REVISED -
DRAWN - RW	REVISOR -	
PLOT SCALE = \$SCALE\$	CHECKED - JS	REVISED -
PLOT DATE = 3/18/2026	DATE - 8/19/2025	REVISED -

**STATE OF ILLINOIS
DEPARTMENT OF TRANSPORTATION**

**EXISTING PLAN AND ELEVATION
FOR STRUCTURE NO. 050-0079**

SCALE: SHEET 1 OF 8 SHEETS STA. TO STA.

F.A.P. RTE. 46	SECTION (1B)BC-5	COUNTY LASALLE	TOTAL SHEETS 6	SHEET NO. 5
CONTRACT NO. 66T11				
ILLINOIS FED. AID PROJECT				

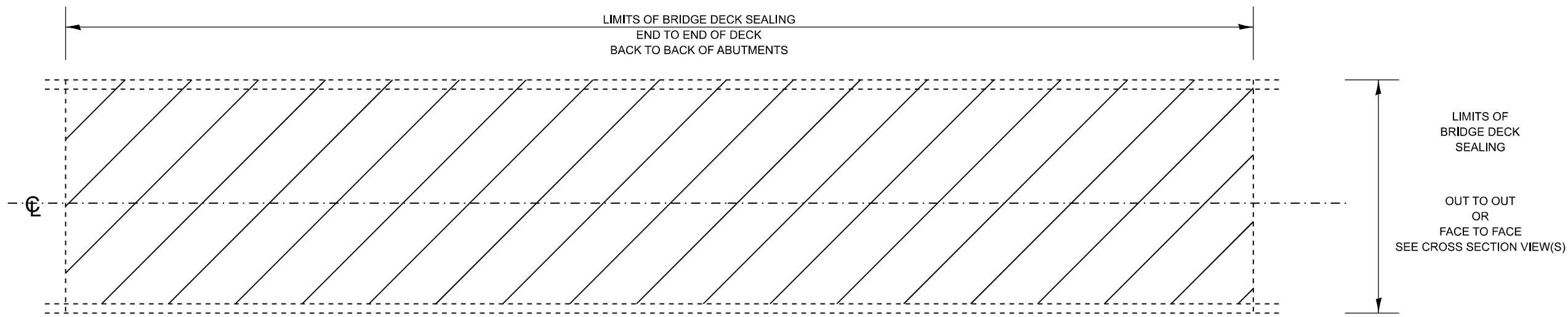

PLAN

NOTE: BRIDGE APPROACH PAVEMENT SHALL NOT BE SEALED.

EXISTING PAVEMENT MARKINGS AND RAISED REFLECTIVE PAVEMENT MARKERS SHALL BE TEMPORARILY COVERED PRIOR TO APPLICATION OF THE DECK SURFACE TREATMENT TO PREVENT THE MATERIAL FROM BEING APPLIED TO THE MARKINGS AND TO PROTECT THE REFLECTIVE PROPERTIES OF THE MARKINGS. THE TEMPORARY COVERING MATERIAL USED SHALL BE SUCH THAT IT WILL NOT AFFECT THE MARKING'S REFLECTIVITY WHEN REMOVED AFTER APPLICATION OF THE DECK SURFACE TREATMENT AND PRIOR TO OPENING TO TRAFFIC. COST INCLUDED WITH CONCRETE SEALER.

EXISTING EXPANSION JOINTS SHALL BE TEMPORARILY COVERED, PRIOR TO APPLICATION OF THE DECK SURFACE TREATMENT, TO PREVENT THE MATERIAL FROM BEING APPLIED TO THE JOINTS. THE TEMPORARY COVERING SHALL BE REMOVED AFTER THE APPLICATION OF THE DECK SURFACE TREATMENT AND PRIOR TO OPENING TO TRAFFIC. COST IS INCLUDED WITH CONCRETE SEALER.

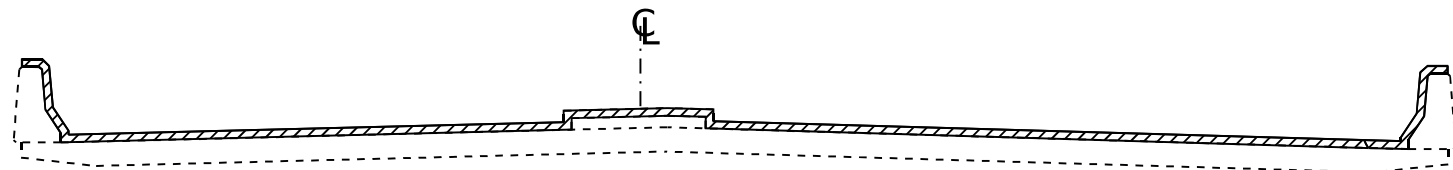

**SECTION 1
WITH PARAPET & MEDIAN**

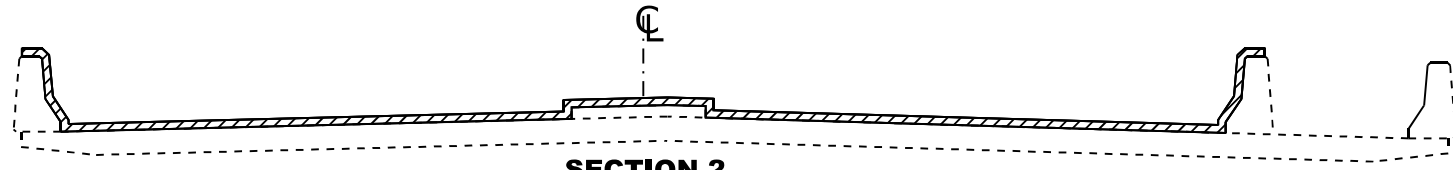

**SECTION 2
WITH PARAPET, MEDIAN
& SHARED - USE PATH OR SIDEWALK
(PARAPET TYPES MAY VARY)**

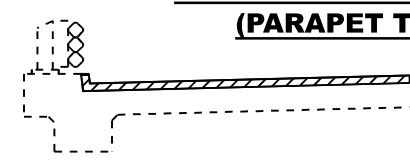

**SECTION 3
WITH CURB AND
TUBULAR THRIE BEAM RETROFIT RAIL**

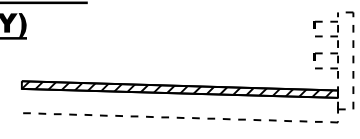

**SECTION 4
WITH BRIDGE RAIL**

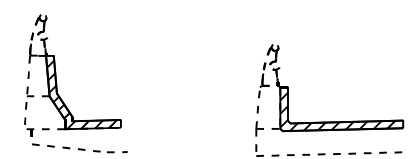

**SECTION 5
WITH CONCRETE
AND ALUMINUM RAILER**

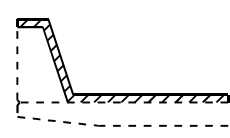

**SECTION 6
WITH CONSTANT SLOPE PARAPET**

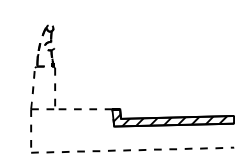

**CONCRETE AND
ALUMINUM RAILING**

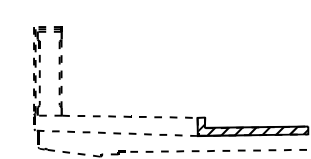

**CONCRETE
BRIDGE RAILING**

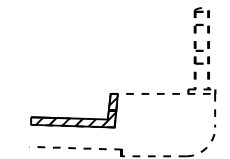

BRIDGE RAIL

VARIOUS SECTION WITH SIDEWALK AND CONCRETE CURB

AREA TO BE SEALED

MODEL: D:\initial... FILE NAME: ...

USER NAME = Oladele,O.Popoola	DESIGNED - RW	REVISED -
	DRAWN - RW	REVISED -
PLOT SCALE = \$SCALE\$	CHECKED - JS	REVISED -
PLOT DATE = 3/18/2026	DATE - 8/19/2025	REVISED -

**STATE OF ILLINOIS
DEPARTMENT OF TRANSPORTATION**

**CONCRETE BRIDGE DECK &
PARAPET SEALING DETAILS**

SCALE: SHEET 1 OF 1 SHEETS STA. TO STA.

F.A.P. RTE. 46	SECTION (1B)BC-5	COUNTY LASALLE	TOTAL SHEETS 6	SHEET NO. 6
CONTRACT NO. 66T11				
ILLINOIS FED. AID PROJECT				