

INDEX

- 1 COVER SHEET
- 2 GENERAL NOTES
- 3 SUMMARY OF QUANTITIES
- 4 TYPICAL SECTIONS
- 5-6 SCHEDULES
- 7-12 DETAILS

**STATE OF ILLINOIS  
DEPARTMENT OF TRANSPORTATION**

**PROPOSED  
HIGHWAY PLANS**

**FAI-39 ROUTE (I-39)  
SECTION (50-6)PP-1  
PROJECT  
PATCHING  
LASALLE COUNTY**

C-93-074-26

BEGIN PROJECT  
STA 191+44  
0.47 MILES WEST OF I-39

END PROJECT  
STA 234+23  
0.35 MILES EAST OF I-39

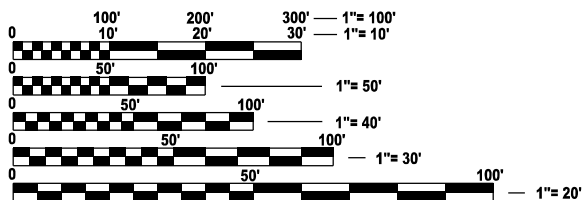
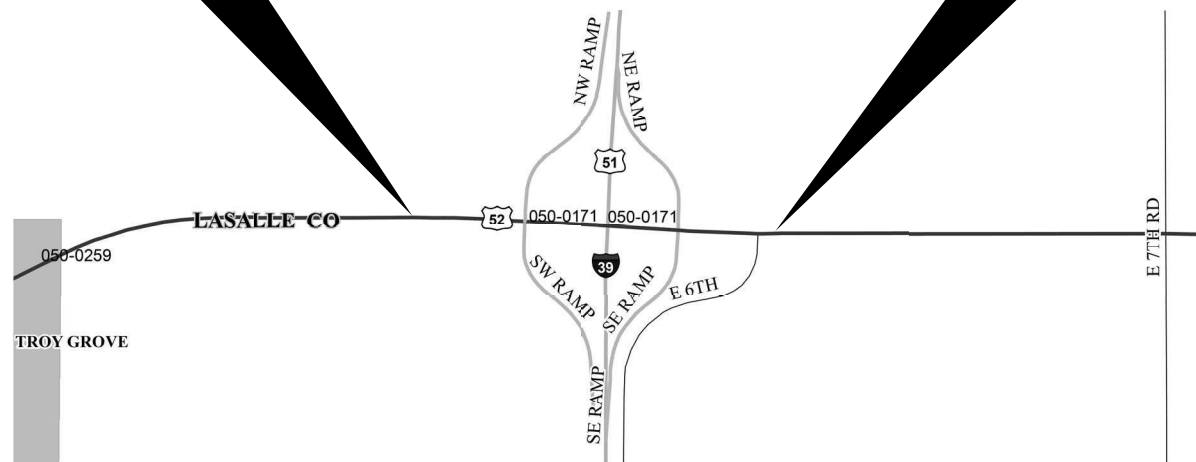

FULL SIZE PLANS HAVE BEEN PREPARED USING STANDARD ENGINEERING SCALES. REDUCED SIZED PLANS WILL NOT CONFORM TO STANDARD SCALES. IN MAKING MEASUREMENTS ON REDUCED PLANS, THE ABOVE SCALES MAY BE USED.

J.U.L.I.E.  
JOINT UTILITY LOCATION INFORMATION FOR EXCAVATION  
1-800-892-0123  
OR 811

**PROJECT ENGINEER: KYLIE LAUTERBACH, PE**  
**PROJECT MANAGER: DARCY MITCHELL**

**CONTRACT NO. 66T45**

GROSS LENGTH = 4500.00 FT. = 0.852 MILE  
NET LENGTH = 894.00 FT. = 0.169 MILE

F.A.I. RTE.	SECTION	COUNTY	TOTAL SHEETS	SHEET NO.
39	(50-6)PP-1	LASALLE	12	1
		ILLINOIS	CONTRACT NO. 66T45	

D-93-060-26

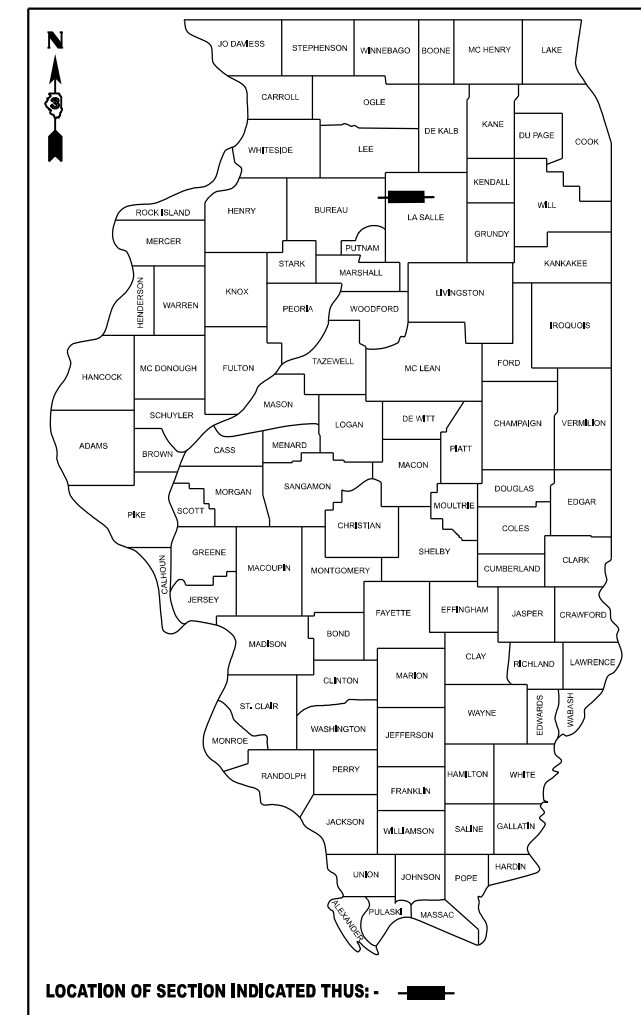

MINOR ARTERIAL  
2025 ADT = 1900  
P.V. = 76.32%  
S.U. = 9.21%  
M.U. = 14.47%

**STATE OF ILLINOIS  
DEPARTMENT OF TRANSPORTATION**

SUBMITTED March 11, 2026

*Trisha Thompson*  
REGIONAL ENGINEER

May 8, 2026  
*[Signature]*  
ENGINEER OF DESIGN AND ENVIRONMENT

May 8, 2026  
*[Signature]*  
DIRECTOR OF HIGHWAYS PROJECT IMPLEMENTATION

**PRINTED BY THE AUTHORITY  
OF THE STATE OF ILLINOIS**



MODEL: Default  
 FILE NAME: c:\p\work\pww\coll\ferguson\jhd1193182\66T45-Cover-CemNotes-SQO.dgn

CODE NO.	ITEM	UNIT	TOTAL QUANTITY	CONSTR. CODE
				100% STATE ROADWAY 0006 RURAL
44200050	WELDED WIRE REINFORCEMENT	SQ YD	1781	1781
44200934	CLASS B PATCHES, TYPE II, 8 INCH	SQ YD	468	468
44200942	CLASS B PATCHES, TYPE III, 8 INCH	SQ YD	248	248
44200944	CLASS B PATCHES, TYPE IV, 8 INCH	SQ YD	1981	1981
44201299	DOWEL BARS 1 1/2"	EACH	1856	1856
44213200	SAW CUTS	FOOT	7122	7122
44213204	TIE BARS 3/4"	EACH	618	618
67100100	MOBILIZATION	L SUM	1	1
70100825	TRAFFIC CONTROL AND PROTECTION, STANDARD 701456	L SUM	1	1
70107025	CHANGEABLE MESSAGE SIGN	CAL DA	60	60
* 78009004	MODIFIED URETHANE PAVEMENT MARKING - LINE 4"	FOOT	31396	31396
* 78009006	MODIFIED URETHANE PAVEMENT MARKING - LINE 6"	FOOT	600	600
* 78009008	MODIFIED URETHANE PAVEMENT MARKING - LINE 8"	FOOT	1572	1572
* 78100100	RAISED REFLECTIVE PAVEMENT MARKER	EACH	52	52

\*= SPECIALTY ITEM

USER NAME = Joshua.Ferguson	DESIGNED -	REVISED -
	DRAWN -	REVISED -
	CHECKED -	REVISED -
PLOT DATE = 3/11/2026	DATE -	REVISED -

**STATE OF ILLINOIS  
 DEPARTMENT OF TRANSPORTATION**

**SUMMARY OF QUANTITIES**

SCALE: SHEET OF SHEETS STA. TO STA.

F.A.I RTE.	SECTION	COUNTY	TOTAL SHEETS	SHEET NO.
39	(50-6)PP-1	LASALLE	12	3
CONTRACT NO. 66T45			ILLINOIS FED. AID PROJECT	

MODEL: Default  
 FILE NAME: c:\pw\_work\widott\ferguson\hd1193182\66T45-Cover-Gen\Notes-SOO.dgn

CODE NO.	ITEM	UNIT	TOTAL QUANTITY	CONSTR. CODE
				100% STATE ROADWAY 0005 RURAL
X7010520	TRAFFIC CONTROL AND PROTECTION, STANDARD 701201 (SPECIAL)	L SUM	1	1
X7200061	TEMPORARY INFORMATION SIGNING	SQ FT	42	42
Z0017099	DOWEL BAR ASSEMBLY	EACH	93	93

USER NAME = Joshua,Ferguson	DESIGNED -	REVISED -
	DRAWN -	REVISED -
	CHECKED -	REVISED -
PLOT DATE = 3/11/2026	DATE -	REVISED -

**STATE OF ILLINOIS  
 DEPARTMENT OF TRANSPORTATION**

**SUMMARY OF QUANTITIES**

SCALE: SHEET OF SHEETS STA. TO STA.

F.A.J RTE.	SECTION	COUNTY	TOTAL SHEETS	SHEET NO.
39	(50-6)PP-1	LASALLE	12	4
CONTRACT NO. 66T45				
ILLINOIS FED. AID PROJECT				

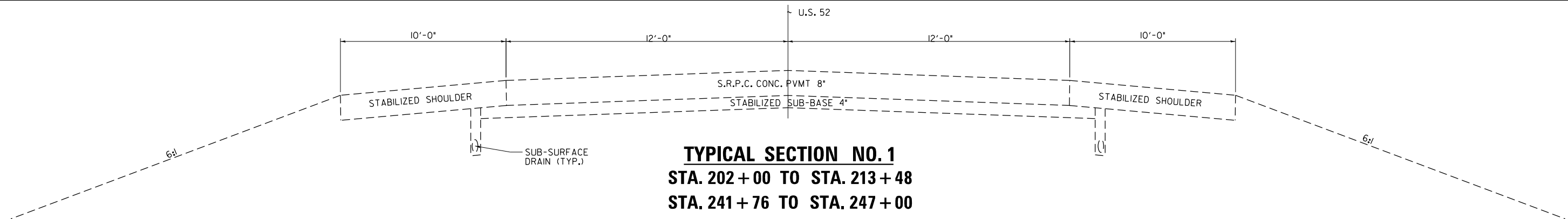

**TYPICAL SECTION NO. 1**  
**STA. 202 + 00 TO STA. 213 + 48**  
**STA. 241 + 76 TO STA. 247 + 00**

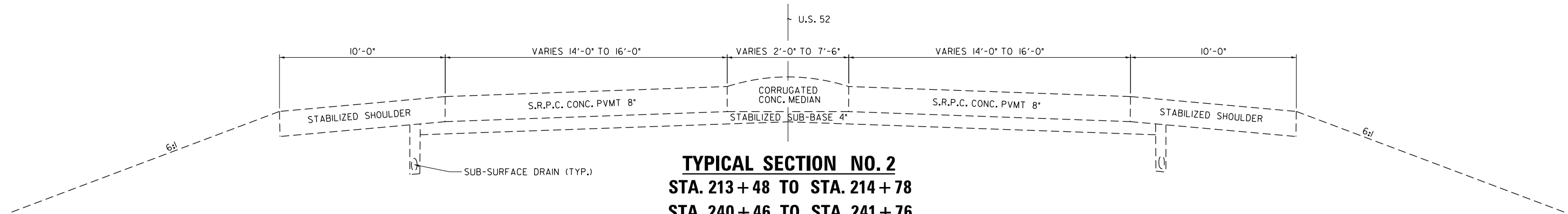

**TYPICAL SECTION NO. 2**  
**STA. 213 + 48 TO STA. 214 + 78**  
**STA. 240 + 46 TO STA. 241 + 76**

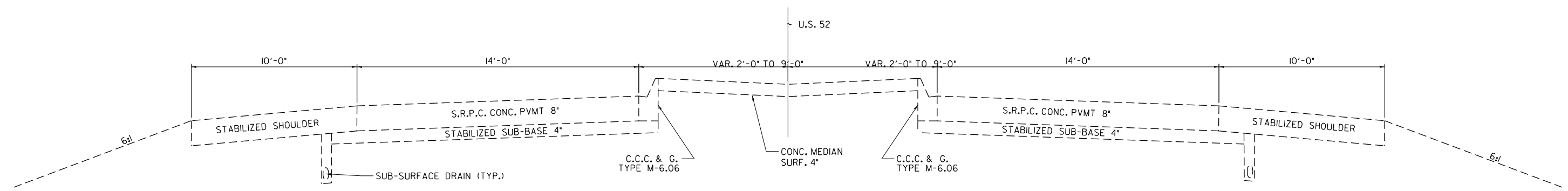

**TYPICAL SECTION NO. 3**  
**STA. 214 + 78 TO STA. 219 + 33**  
**STA. 235 + 91 TO STA. 240 + 46**

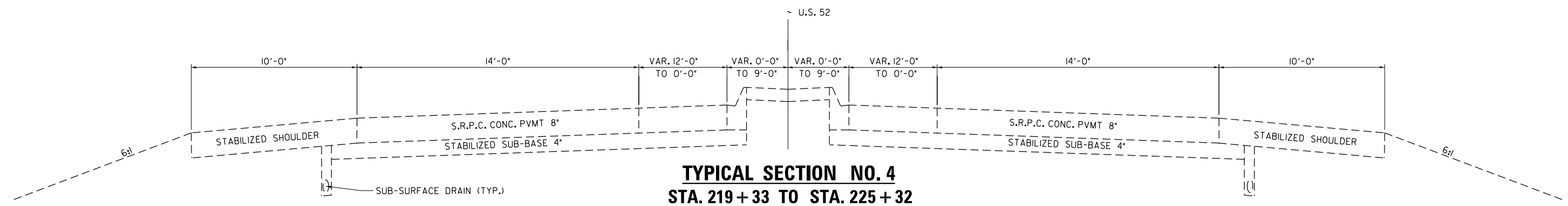

**TYPICAL SECTION NO. 4**  
**STA. 219 + 33 TO STA. 225 + 32**  
**STA. 229 + 91 TO STA. 235 + 91**

MODEL: Default  
 FILE NAME: c:\pwwork\jferguson\jhd1193182\66T45-Typical-Schedules-Details.dgn

USER NAME = Joshua.Ferguson	DESIGNED -	REVISED -
	DRAWN -	REVISED -
	CHECKED -	REVISED -
PLOT DATE = 3/11/2026	DATE -	REVISED -

STATE OF ILLINOIS  
 DEPARTMENT OF TRANSPORTATION

SCALE: SHEET OF SHEETS STA. TO STA.

TYPICAL SECTIONS

F.A.I RTE.	SECTION	COUNTY	TOTAL SHEETS	SHEET NO.
39	(50-6)PP-1	LASALLE	12	5
CONTRACT NO. 66T45				
ILLINOIS FED. AID PROJECT				

**PATCHING SCHEDULE 1 OF 2**

LOCATION	PATCH LENGTH	PATCH WIDTH	EAST BOUND								WEST BOUND										
			CLASS B PATCHES			WELDED WIRE FABRIC	DOWEL BARS 1 1/2"	SAW CUTS	TIE BAR 3/4"	DOWEL BAR ASSEMBLIES	CLASS B PATCHES			WELDED WIRE FABRIC	DOWEL BARS 1 1/2"	SAW CUTS	TIE BAR 3/4"	DOWEL BAR ASSEMBLIES			
			TYPE II	TYPE III	TYPE IV						TYPE II	TYPE III	TYPE IV								
			8 INCH								8 INCH										
STATION	FOOT	FOOT	SQ YD	SQ YD	SQ YD	SQ YD	EACH	FOOT	EACH	EACH	STATION	FOOT	FOOT	SQ YD	SQ YD	SQ YD	SQ YD	EACH	FOOT	EACH	EACH
205+25	6	12	8					20	48		201+60	40	12			53	53	10	116	14	3
207+80	12	12		16				20	60		210+50	6	12	8			20	48			
207+20	6	12	8					20	48		210+51	300	4		133	*	4	612	202	20	
212+90	8	12	11					20	52		211+50	15	15		25		26	75			
214+85	8	12	11					20	52		211+85	8	15	13			26	61			
215+30	18	16			32	32	28	84		1	212+70	150	15		250	250	26	345	51	10	
216+50	180	16			320	320	28	408	61	12	215+30	6	14	9			24	54			
220+35	8	16	14				28	64			217+70	6	14	9			24	54			
220+55	6	14	9				24	54			218+25	6	14	9			24	54			
220+95	14	14		22			24	70			218+60	6	14	9			24	54			
222+50	75	14			117	117	24	192	26	5	221+10	125	16		222	222	28	298	43	8	
224+60	10	14		16			24	62			224+65	28	8		25		12	80	10	2	
230+00	40	14			62	62	24	122	14	3	229+40	6	16	11			28	60			
233+00	6	14	9				24	54			234+45	15	16		27	27	28	78			
234+60	6	14	9				24	54			235+50	15	16		27	27	28	78			
235+90	14	14		22			24	70			237+00	100	16		178	178	28	248	34	7	
237+55	6	14	9				24	54			239+45	180	16		320	320	28	408	61	12	
237+75	6	14	9				24	54			240+50	15	15		25		26	75			
241+15	10	15		17			26	65			241+90	12	15		20		26	69			
242+20	6	15	10				26	57			242+60	6	15	10			26	57			
244+50	10	12	13				20	56			245+50	150	4		67	*	4	312	102	10	
<b>TOTAL</b>			<b>120</b>	<b>93</b>	<b>531</b>	<b>531</b>	<b>496</b>	<b>1780</b>	<b>101</b>	<b>21</b>	<b>TOTAL</b>			<b>78</b>	<b>95</b>	<b>1277</b>	<b>1077</b>	<b>470</b>	<b>3236</b>	<b>517</b>	<b>72</b>

\* PATCHES AT THE CENTERLINE JOINT WILL NOT REQUIRE WELDED WIRE REINFORCEMENT

MODEL: Default  
FILE NAME: c:\pwwork\jwfcoll\ferguson\jhd1193182\66T45-Typical-Schedules-Details.dgn

USER NAME = Joshua,Ferguson	DESIGNED -	REVISED -
	DRAWN -	REVISED -
	CHECKED -	REVISED -
PLOT DATE = 3/11/2026	DATE -	REVISED -

**STATE OF ILLINOIS  
DEPARTMENT OF TRANSPORTATION**

SCALE: SHEET OF SHEETS STA. TO STA.

**SCHEDULES**

F.A.I RTE.	SECTION	COUNTY	TOTAL SHEETS	SHEET NO.
39	(50-6)PP-1	LASALLE	12	6
CONTRACT NO. 66T45				
ILLINOIS FED. AID PROJECT				

**PATCHING SCHEDULE 2 OF 2**

LOCATION	PATCH LENGTH	PATCH WIDTH	PATCH AREA	CLASS B PATCHES			WELDED WIRE FABRIC	DOWEL BARS 1 1/2"	SAW CUTS	LOCATION	PATCH LENGTH	PATCH WIDTH	PATCH AREA	CLASS B PATCHES			WELDED WIRE FABRIC	DOWEL BARS 1 1/2"	SAW CUTS		
				TYPE II	TYPE III	TYPE IV								TYPE II	TYPE III	TYPE IV					
				8 INCH										8 INCH							
STATION	FOOT	FOOT	SQ YD	SQ YD	SQ YD	SQ YD	SQ YD	EACH	FOOT	STATION	FOOT	FOOT	SQ YD	SQ YD	SQ YD	SQ YD	SQ YD	EACH	FOOT		
<b>SB EXIT RAMP</b>										<b>NB EXIT RAMP</b>											
309+75	6	16	11	11					28	60	508+80	6	16	11	11					14	60
310+90	6	16	11	11					28	60	511+00	6	16	11	11					28	60
311+60	6	16	11	11					28	60	512+75	8	16	14	14					28	64
313+00	6	16	11	11					28	60											
314+00	6	16	11	11					28	60											
315+50	10	16	18		18				28	68											
316+50	16	16	28			28		28	28	80											
318+10	12	16	21		21				28	72											
<b>SUBTOTAL</b>				<b>55</b>	<b>39</b>	<b>28</b>	<b>28</b>	<b>224</b>	<b>520</b>		<b>SUBTOTAL</b>			<b>36</b>	<b>0</b>	<b>0</b>	<b>0</b>	<b>70</b>	<b>184</b>		
<b>SB ENTRANCE RAMP</b>										<b>NB ENTRANCE RAMP</b>											
601+40	15	16	27			27		27	28	78	400+50	6	20	13	13					36	72
602+50	12	16	21		21				28	72	402+00	8	16	14	14					28	64
603+75	15	16	27			27		27	28	78	402+60	6	16	11	11					28	60
604+50	8	16	14	14					28	64	403+20	6	16	11	11					28	60
605+50	8	16	14	14					28	64	405+30	6	16	11	11					28	60
607+15	6	16	11	11					28	60	407+20	6	16	11	11					28	60
609+50	6	16	11	11					28	60	410+50	6	16	11	11					28	60
611+20	6	16	11	11					28	60	413+50	16	16	28			28		28	28	80
612+30	20	16	36			36		36	28	88	414+30	6	16	11	11					28	60
612+90	8	16	14	14					28	64											
614+60	6	16	11	11					28	60											
616+00	15	16	27			27		27	28	78											
<b>SUBTOTAL</b>				<b>86</b>	<b>21</b>	<b>117</b>	<b>117</b>	<b>336</b>	<b>826</b>		<b>SUBTOTAL</b>			<b>93</b>	<b>0</b>	<b>28</b>	<b>28</b>	<b>260</b>	<b>576</b>		
<b>TOTAL</b>				<b>141</b>	<b>60</b>	<b>145</b>	<b>145</b>	<b>560</b>	<b>1346</b>		<b>TOTAL</b>			<b>129</b>	<b>0</b>	<b>28</b>	<b>28</b>	<b>330</b>	<b>760</b>		

**PAVEMENT MARKING SCHEDULE**

LOCATION	DESCRIPTION	MODIFIED URETHANE PAVMENT MARKING				RAISED REFLECTIVE PAVEMENT MARKERS
		4" LINE		6" LINE	8" LINE	
		YELLOW	WHITE			
STA TO STA	DESCRIPTION	FOOT	FOOT	FOOT	SQFT	EACH
201+50 TO 208+50			2800	360		9
208+50 TO 213+48		996	1992	240		6
213+48 TO 220+50		2808	2284		142	9
220+50 TO 221+16			264			1
221+16 TO 223+75		1036	1036		518	3
223+75 TO 226+33		1032	1032		120	3
226+33 TO 228+91	SN 050-0171	1032	1032			
228+91 TO 231+50		1036	1036		120	3
231+50 TO 234+15		1060	1060		530	3
234+15 TO 234+47			128			
234+47 TO 235+91		576	52		142	2
235+91 TO 241+76		2340	2340			7
241+76 TO 243+50		696	348			2
243+50 TO 246+33		1132	1132			4
SB EXIT	RAMP	136	136			
SB ENTRANCE	RAMP	250	250			
NB EXIT	RAMP	40	40			
NB ENTRANCE	RAMP	132	132			
<b>TOTAL</b>			<b>31396</b>	<b>600</b>	<b>1572</b>	<b>52</b>

\*QUANTITY IS FOR 2 APPLICATIONS OF MODIFIED URETHANE

MODEL: Default  
FILE NAME: c:\pwwork\work\coll\ferguson\jhd1193182\66T45-Typical-Schedules-Details.dgn

USER NAME = Joshua.Ferguson	DESIGNED -	REVISED -
	DRAWN -	REVISED -
	CHECKED -	REVISED -
PLOT DATE = 3/11/2026	DATE -	REVISED -

**STATE OF ILLINOIS  
DEPARTMENT OF TRANSPORTATION**

SCALE:	SHEET	OF	SHEETS	STA.	TO STA.
--------	-------	----	--------	------	---------

**SCHEDULES**

F.A.I. RTE.	SECTION	COUNTY	TOTAL SHEETS	SHEET NO.
39	(50-6)PP-1	LASALLE	12	7
CONTRACT NO. 66T45				
ILLINOIS FED. AID PROJECT				

# FOR INFORMATION ONLY

ROUTE	SECTION	COUNTY	TOTAL SHEETS
FA 412	*	LASALLE	9
PROJECT NO.	ILLINOIS PROJECT		4
* (50-5HB)L, (50-6HB-1)L & (50-8HB)L			

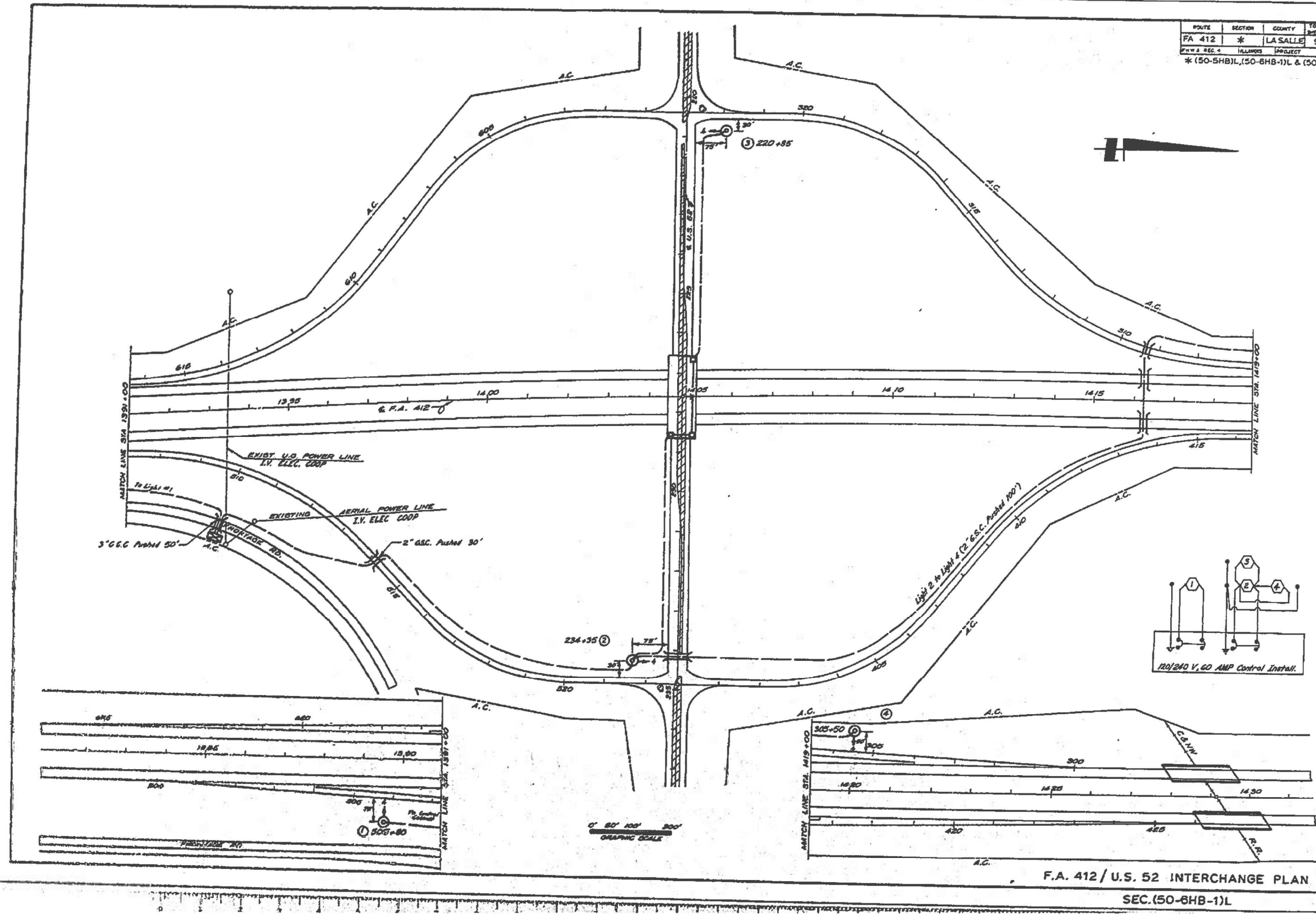

MODEL: Default  
 FILE NAME: c:\pwwork\jw\td\ferguson\jhd1193182\66T45-Typical-Schedules-Details.dgn

USER NAME = Joshua.Ferguson	DESIGNED -	REVISED -
	DRAWN -	REVISED -
	CHECKED -	REVISED -
PLOT DATE = 3/11/2026	DATE -	REVISED -

**STATE OF ILLINOIS**  
**DEPARTMENT OF TRANSPORTATION**

SCALE:	SHEET	OF	SHEETS	STA.	TO	STA.

**DETAILS**

F.A. RTE.	SECTION	COUNTY	TOTAL SHEETS	SHEET NO.
39	(50-6)PP-1	LASALLE	12	8
CONTRACT NO. 66T45				
ILLINOIS FED. AID PROJECT				

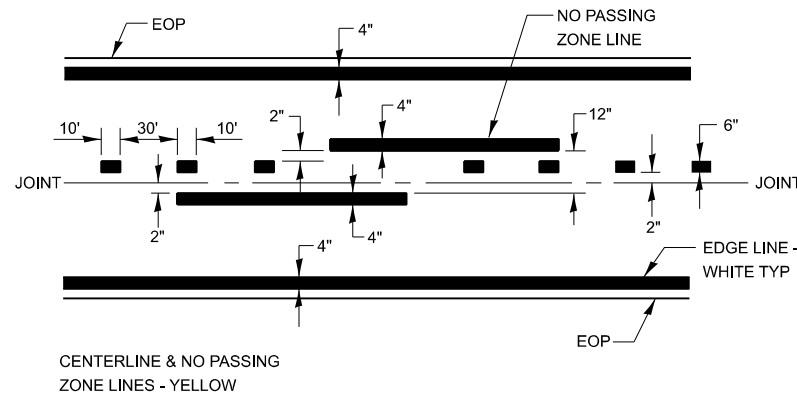

**PAVEMENT MARKING**

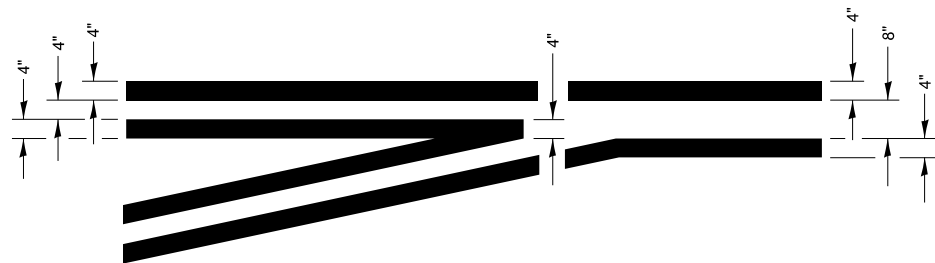

**TYPICAL APPLICATION @ LEFT TURN LANES**

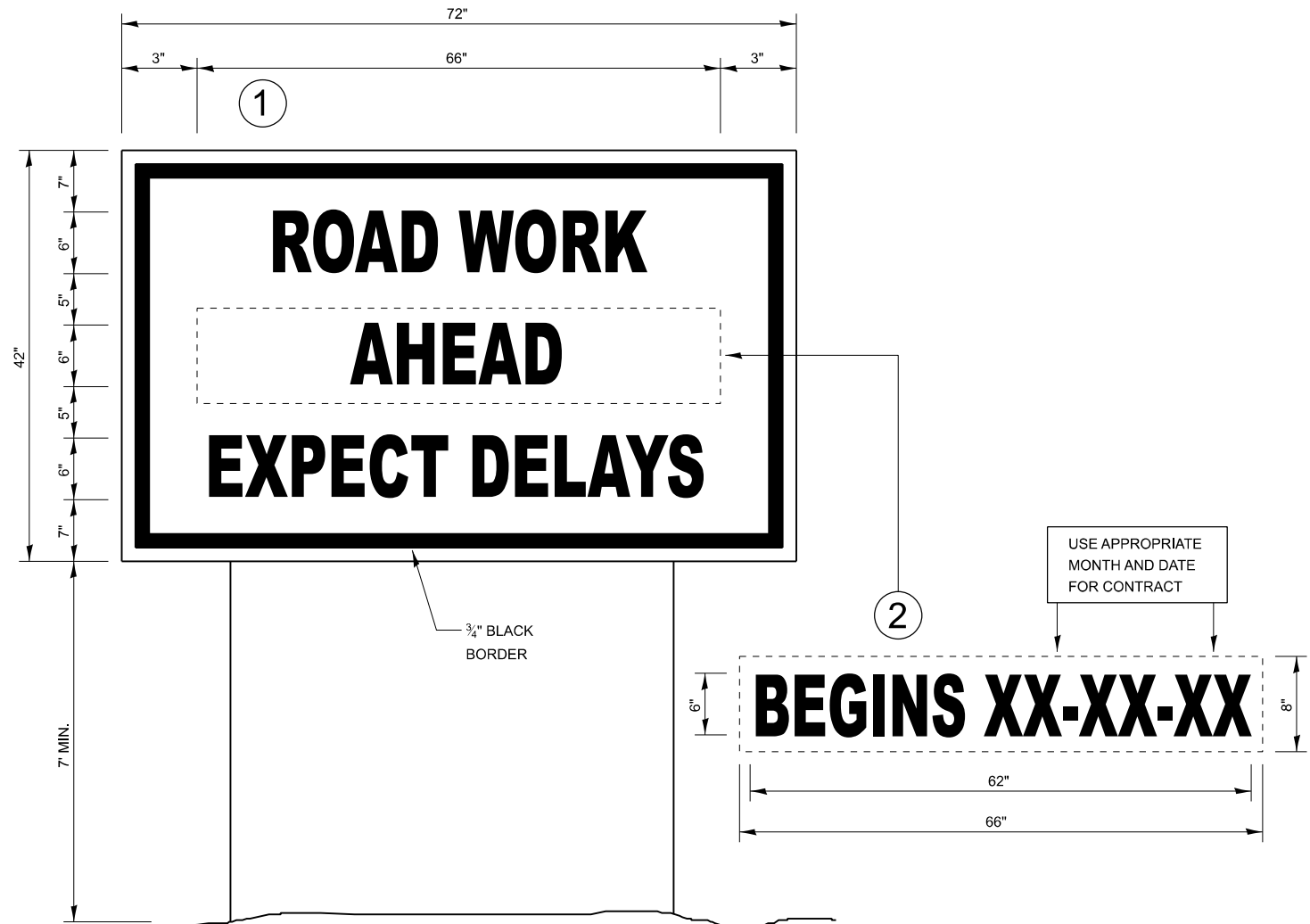

**TEMPORARY INFORMATION SIGNING**

**NOTES:**

- USE 6" D BLACK LETTERING ON FLUORESCENT ORANGE BACKGROUND.
- ERECT SIGNS AT LOCATIONS IN ADVANCE OF THE "ROAD CONSTRUCTION AHEAD" SIGNS AS DIRECTED BY THE ENGINEER.
- ERECT SIGN ① WITH INSTALLED PANEL ② A MINIMUM OF ONE WEEK PRIOR TO THE START OF THE LANE CLOSURE.
- REMOVE PANEL ② ON THAT DATE.
- SEE SPECIAL PROVISION "TEMPORARY INFORMATION SIGNING" FOR ADDITIONAL INFORMATION.
- WILL BE PAID FOR PER SQ FT AS "TEMPORARY INFORMATION SIGNING". EACH SIGN = 21 SQ FT AND THE DATE PANEL ② WILL NOT BE MEASURED SEPARATELY FOR PAYMENT.

MODEL: Default  
FILE NAME: c:\pwwork\jw\coll\fergus\jhd1193182\66T45-Typical-Schedule-Details.dgn

USER NAME = Joshua.Ferguson	DESIGNED -	REVISED -
	DRAWN -	REVISED -
	CHECKED -	REVISED -
PLOT DATE = 3/11/2026	DATE -	REVISED -

**STATE OF ILLINOIS  
DEPARTMENT OF TRANSPORTATION**

**DETAILS**

SCALE: SHEET OF SHEETS STA. TO STA.

F.A.I RTE.	SECTION	COUNTY	TOTAL SHEETS	SHEET NO.
39	(50-6)PP-1	LASALLE	12	9
CONTRACT NO. 66T45			ILLINOIS FED. AID PROJECT	

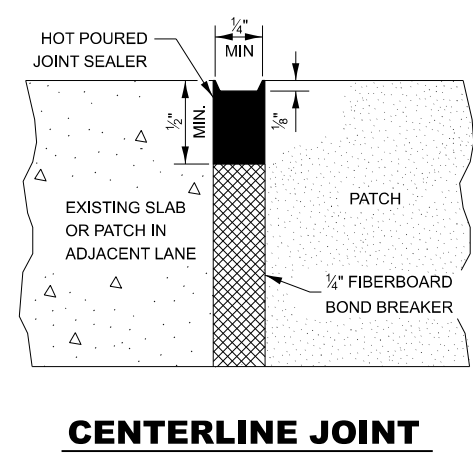
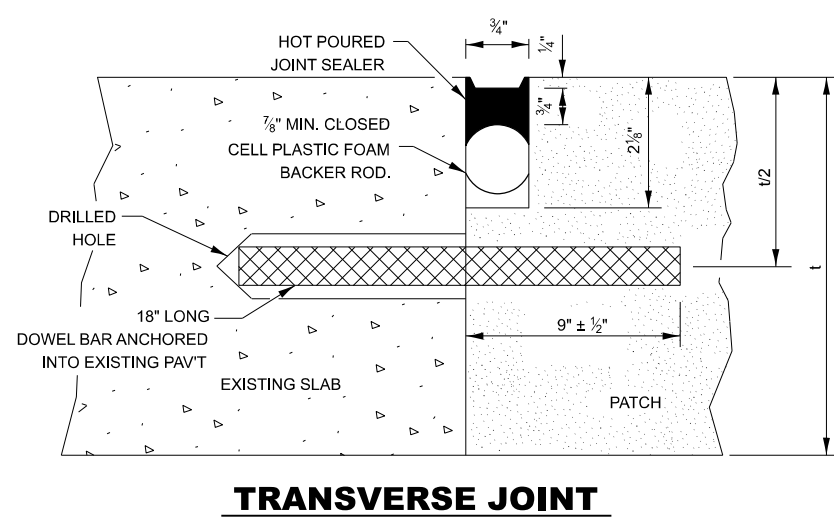
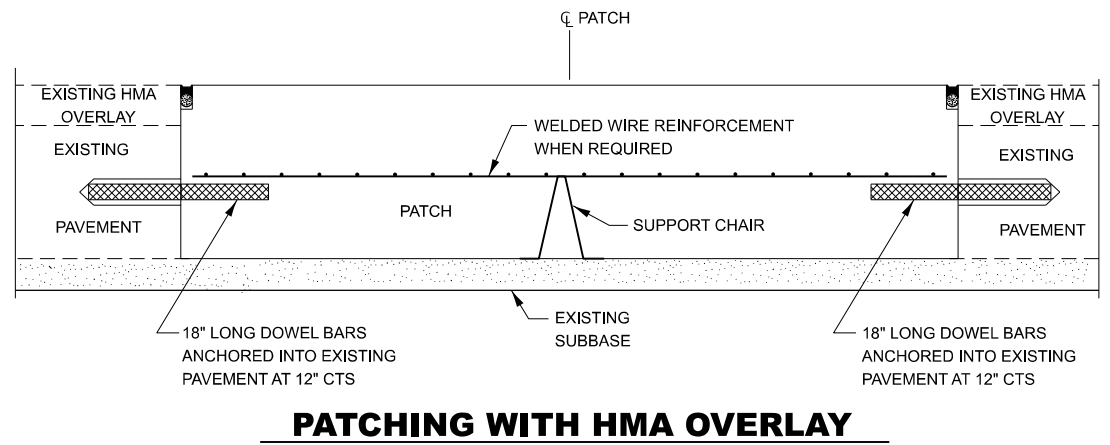
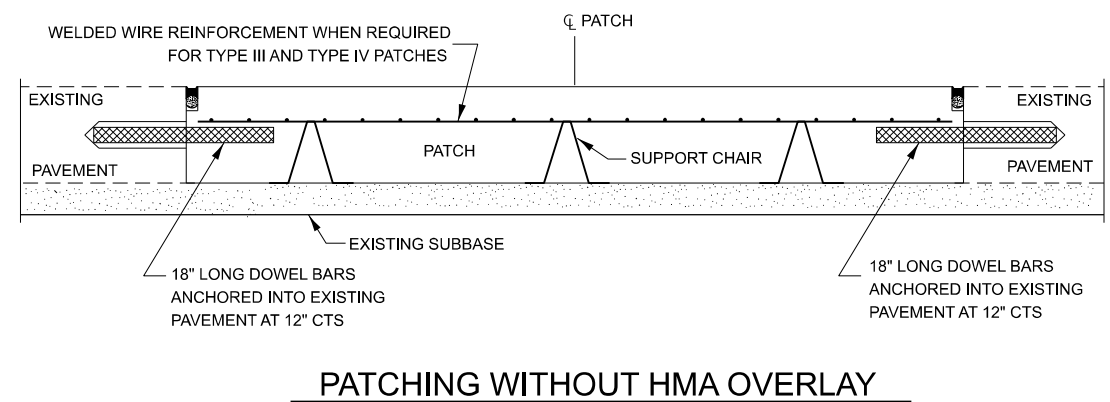
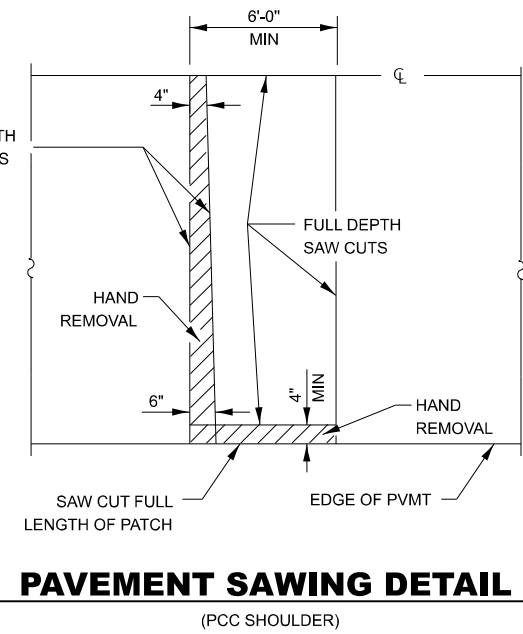
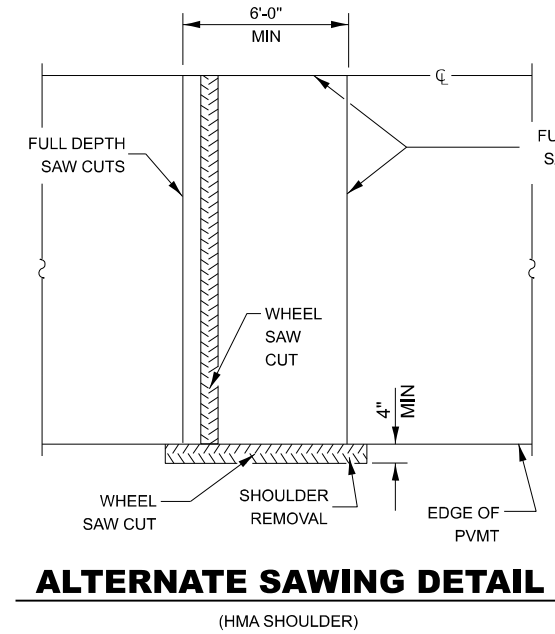
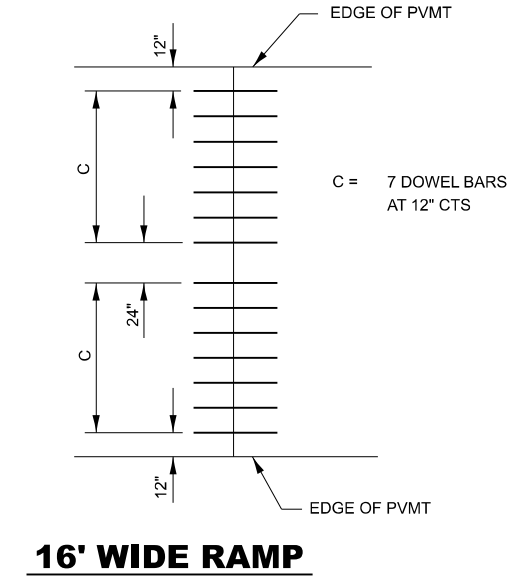
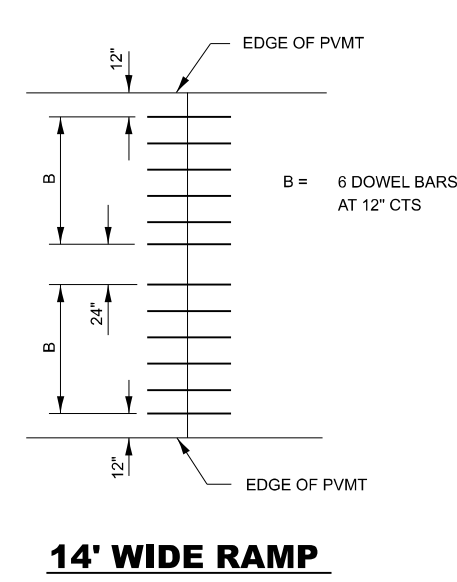
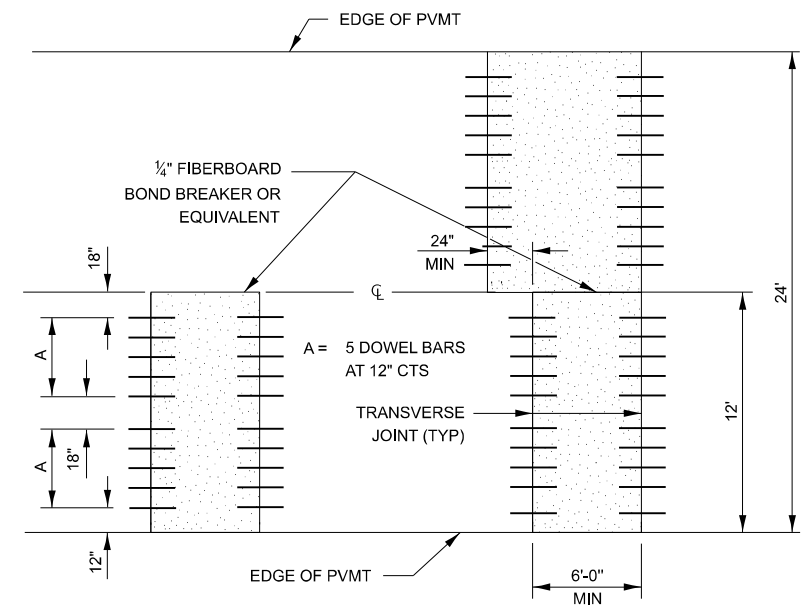
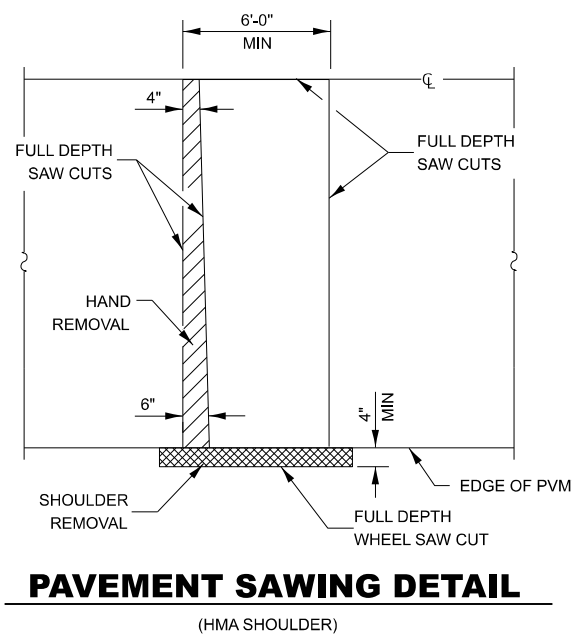

DOWEL BAR TABLE		
PAVEMENT THICKNESS	DOWEL BAR DIAMETER	HOLE DIAMETER
8" OR GREATER	1 1/2"	1 3/8"
7" THRU 7.99"	1 1/4"	1 3/8"
LESS THAN 7"	1"	1 1/8"

**GENERAL NOTES**

THE TRANSVERSE JOINTS FOR CLASS B PATCHES SHALL ALIGN WITH JOINTS OR CRACKS IN THE ADJACENT LANE WHENEVER POSSIBLE.

SEE STANDARD 420701 FOR DETAILS OF PAVEMENT WELDED WIRE REINFORCEMENT.

MODEL - Default  
FILE NAME: c:\pwwork\work\illinois\193182\66T45-Typical-Schedules-Details.dgn

USER NAME = Joshua, Ferguson	DESIGNED -	REVISED -
	DRAWN -	REVISED -
	CHECKED -	REVISED -
PLOT DATE = 3/11/2026	DATE -	REVISED -

**STATE OF ILLINOIS  
DEPARTMENT OF TRANSPORTATION**

**CLASS B PATCHING DETAILS**

SCALE: SHEET OF SHEETS STA. TO STA.

F.A.I. RTE.	SECTION	COUNTY	TOTAL SHEETS	SHEET NO.
39	(50-6)PP-1	LASALLE	12	10
CONTRACT NO. 66T45				
ILLINOIS		FED. AID PROJECT		

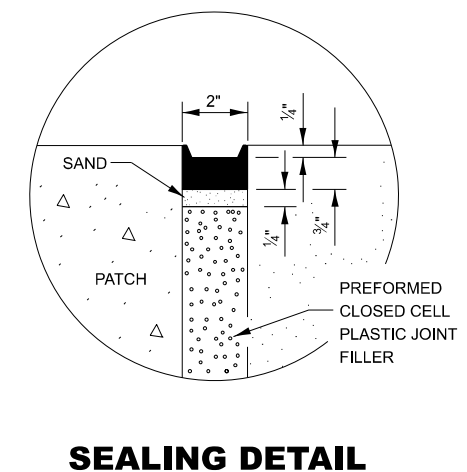
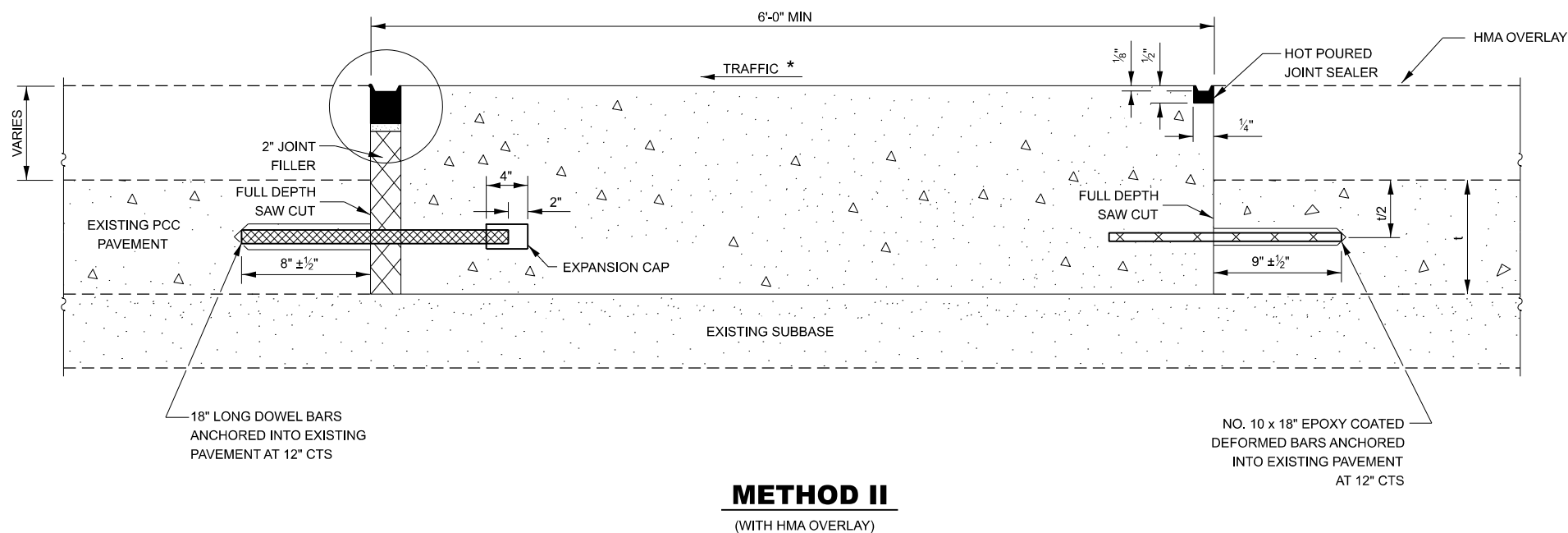
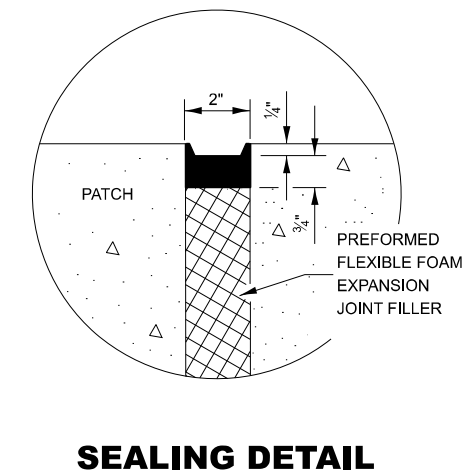
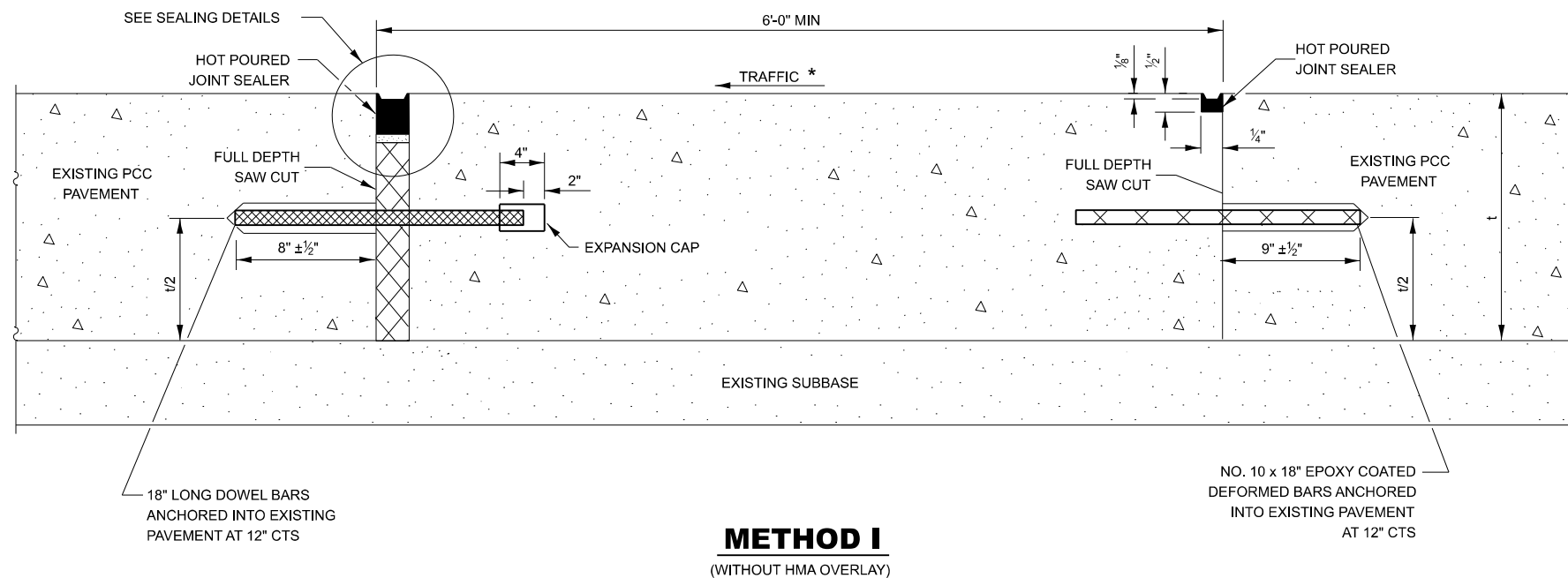

**NOTE**  
 \* WHEN RE-ESTABLISHING A TRANSVERSE EXPANSION JOINT ON A TWO-WAY ROAD, REVERSE THE ORIENTATION OF THE DOWEL BARS WITH RESPECT TO TRAFFIC FOR ONE OF THE PATCHES SUCH THAT THE JOINT WILL BE CONTINUOUS ACROSS BOTH LANES.

MODEL: Default  
 FILE NAME: c:\pwwork\jferguson\jhd1193182\66T45-Typical-Schedule-Details.dgn

USER NAME = Joshua.Ferguson	DESIGNED -	REVISED -
	DRAWN -	REVISED -
	CHECKED -	REVISED -
PLOT DATE = 3/11/2026	DATE -	REVISED -

STATE OF ILLINOIS  
 DEPARTMENT OF TRANSPORTATION

CLASS B PATCHING DETAILS

SCALE: SHEET OF SHEETS STA. TO STA.

F.A.I. RTE.	SECTION	COUNTY	TOTAL SHEETS	SHEET NO.
39	(50-6)PP-1	LASALLE	12	11
CONTRACT NO. 66T45				
ILLINOIS FED. AID PROJECT				

