

F.A.S. RTE.	SECTION	COUNTY	TOTAL SHEETS	SHEET NO.
1194	(106,105)PP	STARK	12	1
		ILLINOIS	CONTRACT NO. 68K98	

**INDEX OF SHEETS**

- 1 COVER SHEET
- 2 GENERAL NOTES AND COMMITMENTS
- 3 SUMMARY OF QUANTITIES
- 4 - 6 TYPICAL SECTIONS
- 7 SCHEDULE OF QUANTITIES
- 8 LOCATION MAP
- 9 CONSTRUCTION DETAILS
- 10-12 BUTT JOINTS

**IDOT HIGHWAY STANDARDS**

- 000001-09 STANDARD SYMBOLS, ABBREVIATIONS AND PATTERNS
- 701306-04 LANE CLOSURE, 2L, 2W SLOW MOVING OPERATIONS DAY ONLY, FOR SPEEDS ≥ 45 MPH
- 701901-11 TRAFFIC CONTROL DEVICES

**DISTRICT STANDARDS**

406101-D4

**STATE OF ILLINOIS  
DEPARTMENT OF TRANSPORTATION**

**PROPOSED  
HIGHWAY PLANS**

**FAS ROUTE 1194 (IL 93)  
SECTION (106,105)PP  
PARTIAL DEPTH HMA PATCHING  
IL 91 TO IL 40  
STARK COUNTY**

C-94-015-26

D-94-013-26



DESIGN DESIGNATION  
IL 93: MAJOR COLLECTOR  
ADT: 950  
SU: 4.2%  
MU: 12.6%

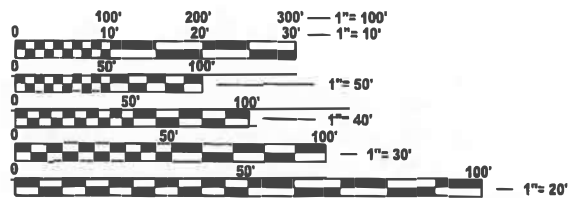

FULL SIZE PLANS HAVE BEEN PREPARED USING STANDARD ENGINEERING SCALES. REDUCED SIZED PLANS WILL NOT CONFORM TO STANDARD SCALES. IN MAKING MEASUREMENTS ON REDUCED PLANS, THE ABOVE SCALES MAY BE USED.

**J.U.L.I.E.**  
JOINT UTILITY LOCATION INFORMATION FOR EXCAVATION  
1-800-892-0123  
OR 811

BEGIN IMPROVEMENT  
STA. 1185+55.00

END IMPROVEMENT  
STA. 1689+15.00

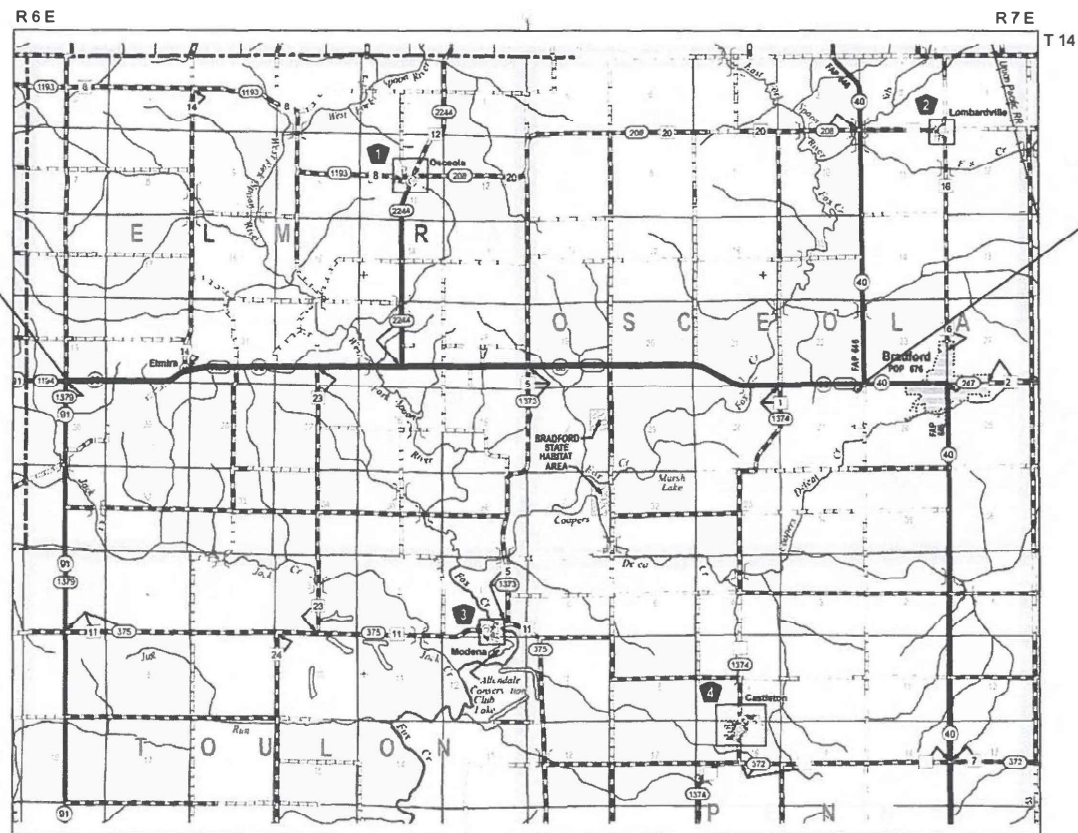

NOT TO SCALE

GROSS LENGTH = 50,360 FT. = 9.54 MILES  
NET LENGTH = 48,711 FT. = 9.22 MILES

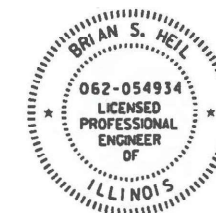

*Brian S. Heil* 2/26/26  
BRIAN S. HEIL  
LICENSED PROFESSIONAL ENGINEER OF ILLINOIS  
IL P.E. NO. 062-054934 EXPIRATION DATE 11/30/27

**OATES ASSOCIATES**

Collinsville: 100 Lanier Court, Suite 1, Collinsville, IL 62234, 618.345.2200  
Belleville: 1 South Church, Suite 200, Belleville, IL 62220, 618.416.4688  
www.oatesassociates.com  
ILLINOIS DESIGN FIRM LICENSE NO.: 184.001115

St. Louis: 720 Olive, Suite 700, St. Louis, MO 63101, 314.588.8381  
St. Charles: 820 South Main, Suite 309, St. Charles, MO 63301, 636.493.6277

STATE OF ILLINOIS  
DEPARTMENT OF TRANSPORTATION

SUBMITTED *March 24 20 26*  
*Rensil L. Darnett* REGIONAL ENGINEER

May 8 20 26  
*Scott A. [Signature]* ENGINEER OF DESIGN AND ENVIRONMENT

May 8 20 26  
*[Signature]* DIRECTOR OF HIGHWAYS PROJECT IMPLEMENTATION

**PRINTED BY THE AUTHORITY  
OF THE STATE OF ILLINOIS**

**PROJECT ENGINEER: BEN TELLEFSON  
PROJECT MANAGER: ERIC PRICHARD  
CONTRACT NO. 68K98  
CATALOG NO. 036745-00D**

## COMMITMENTS

COMMITMENTS ARE NOT TO BE ALTERED WITHOUT THE WRITTEN APPROVAL OF ALL PARTIES TO WHICH THE COMMITMENT WAS MADE.

NO COMMITMENTS HAVE BEEN MADE ON THIS PROJECT.

## ENVIRONMENTAL REVIEWS

PRIOR TO THE USE OF ANY PROPOSED BORROW AREAS, USE AREAS (TEMPORARY ACCESS ROADS, DETOURS, RUN-AROUNDS, ETC.) AND/OR WASTE AREAS, THE CONTRACTOR SHALL FILE THE REQUIRED ENVIRONMENTAL RESOURCE REQUEST SURVEYS ACCORDING TO THE SECTION 107.22 OF THE STANDARD SPECIFICATIONS. THESE SURVEYS ARE REQUIRED IN ORDER FOR THE DEPARTMENT TO CONDUCT CULTURAL AND BIOLOGICAL RESOURCE SURVEYS FOR THE PROPOSED SITE.

THE REQUIRED ENVIRONMENTAL RESOURCE DOCUMENTATION SHALL INCLUDE THE FOLLOWING:

- BDE FORM 2290 (WASTE/USE AREA REVIEW)
- A LOCATION MAP SHOWING THE SIZE LIMITS AND LOCATION OF THE USE AREA
- COLOR PHOTOGRAPHS DEPICTING THE USE AREA
- BORROW AREA ENTRY AGREEMENT FORM - D4 PI0101

PRIOR TO ANY WASTE MATERIALS BEING REMOVED FROM THE CONSTRUCTION SITE THE REQUIRED ENVIRONMENTAL RESOURCE SURVEYS SHALL BE OBTAINED AND FILED BY THE CONTRACTOR. EXCESS WASTE PRODUCTS REMOVED FROM THE CONSTRUCTION SITE SHALL BE DISPOSED OF AS REQUIRED IN SECTION 202.03 OF THE STANDARD SPECIFICATIONS.

## ADDITIONAL SUPPLEMENTAL TRAFFIC CONTROL

THE DEPARTMENT RESERVES THE RIGHT AT ANY TIME TO ADD ADDITIONAL TRAFFIC CONTROL SYSTEMS OR DEVICES WITHIN THE ACTIVE CONTRACT LIMITS, BY MEANS OF AN ADDITIONAL CONTRACT. ALL TERMS OF ARTICLE 105.08 OF THE STANDARD SPECIFICATIONS SHALL BE FOLLOWED BY EACH CONTRACTOR.

## PROJECT SPECIFIC NOTES

FLAGGERS, WHEN SHOWN, SHALL BE INCLUDED IN THE COST OF TRAFFIC CONTROL STANDARD PAY ITEMS.

TWO CHANGEABLE MESSAGE SIGNS SHALL BE PLACED IN ADVANCE OF THE PROJECT, ONE PER EACH DIRECTION OF TRAVEL ON IL 93 ONE WEEK PRIOR TO CONSTRUCTION.

## MIXTURES TABLE

LOCATION(S):	MAINLINE
MIXTURE USE(S):	PARTIAL DEPTH (1 @ 2.5")
PG:	PG 58-28
DESIGN AIR VOIDS:	4% @ N = 50
MIXTURE COMPOSITION:	IL 9.5
FRICTION AGG:	MIX C
MIXTURE WEIGHT:	112 LBS/SY/IN
QUALITY MANAGEMENT PROGRAM:	QC/QA
SUBLOT SIZE:	N/A
MATERIAL TRANSFER DEVICE (REQUIRED?)	NO

## POLYMERIZED BITUMINOUS MATERIALS (TACK COAT) RATES

SURFACE TYPE	RESIDUAL RATE
MILLED (HMA OR PCC)	0.08 LB/ SQ FT
EXISTING PAVEMENT	0.08 LB/ SQ FT
FOG COAT (BETWEEN LIFTS)	0.08 LB/ SQ FT

MODEL: General Notes (Sheet)  
 FILE NAME: H:\P\223104 - D4 1-V1\WO 38-HMA patching\_IL\_93\CADD\Microstation\CADD Drawings\0468K98-sh1-gannote.dgn



USER NAME = breanna.frahm	DESIGNED -	REVISED -
	DRAWN -	REVISED -
	CHECKED -	REVISED -
PLOT DATE = 1/6/2026	DATE -	REVISED -

**STATE OF ILLINOIS**  
**DEPARTMENT OF TRANSPORTATION**

**GENERAL NOTES AND COMMITMENTS**  
 SCALE: SHEET 1 OF 1 SHEETS STA. TO STA.

F.A.S RTE.	SECTION	COUNTY	TOTAL SHEETS	SHEET NO.
1194	(106,105)PP	STARK	9	2
CONTRACT NO. 68K98				
ILLINOIS FED. AID PROJECT				



**LEGEND - EXISTING**

- (A) PCC PAVEMENT - 9"
- (B) HMA OVERLAY - 2 1/2" - 7"
- (C) HMA BASE COURSE WIDENING - VAR.
- (D) AGGREGATE SHOULDERS - 6"
- (E) HMA SHOULDERS - 6"
- (F) CONCRETE GUTTER, TYPE B MODIFIED
- (G) STEEL PLATE BEAM GUARD RAIL, TYPE A

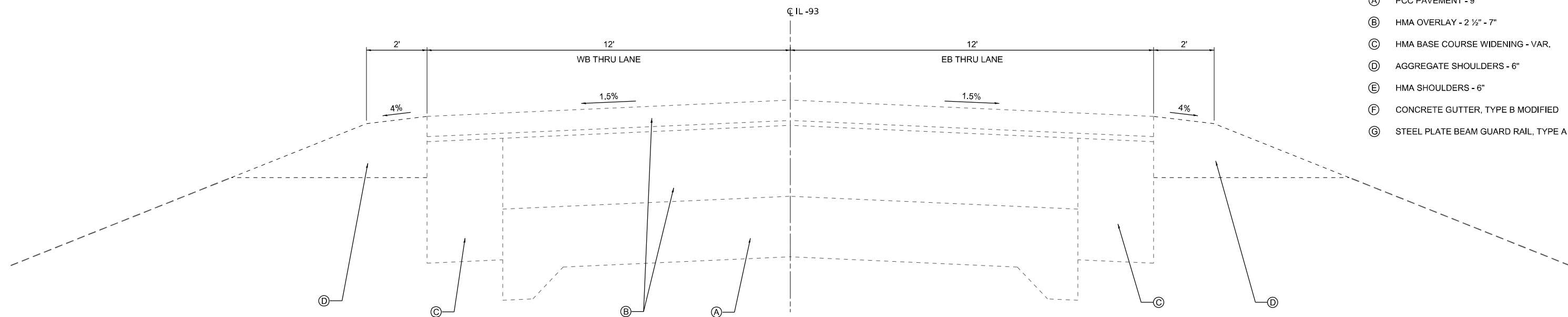

**TYPICAL SECTION 1**

NOT TO SCALE  
 STA. 1185+55 TO STA. 1330+38  
 STA. 1340+50 TO STA. 1343+50  
 STA. 1370+10 TO STA. 1378+00  
 STA. 1384+50 TO STA. 1409+00  
 STA. 1423+00 TO STA. 1610+60  
 STA. 1627+00 TO STA. 1689+15

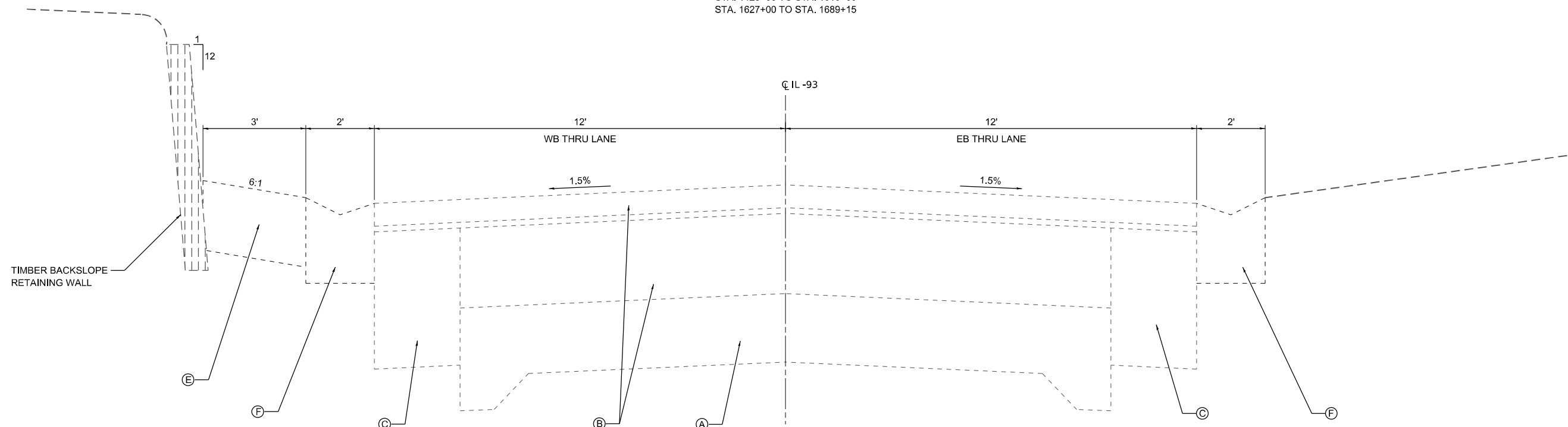

**TYPICAL SECTION 2**

NOT TO SCALE  
 STA. 1330+38 TO STA. 1337+50  
 STA. 1343+50 TO STA. 1351+00  
 STA. 1354+50 TO STA. 1370+10  
 STA. 1409+00 TO STA. 1423+00  
 STA. 1610+60 TO STA. 1614+00

MODEL: Typical (Sheet)  
 FILE NAME: H:\P\223104 - D4 VAVIWO 36-HMA patching IL 93\CADD\Microstation\CADD Drawings\68K98-sh2-Typical.dgn



USER NAME = breanna.frahm	DESIGNED -	REVISED -
	DRAWN -	REVISED -
	CHECKED -	REVISED -
	DATE -	REVISED -
PLOT DATE = 1/16/2026		

**STATE OF ILLINOIS  
 DEPARTMENT OF TRANSPORTATION**

**TYPICAL SECTIONS**

SCALE: SHEET 1 OF 3 SHEETS STA. TO STA.

F.A.S. RTE.	SECTION	COUNTY	TOTAL SHEETS	SHEET NO.
1194	(106,105)PP	STARK	9	4
CONTRACT NO. 68K98				
ILLINOIS FED. AID PROJECT				

**LEGEND - EXISTING**

- (A) PCC PAVEMENT - 9"
- (B) HMA OVERLAY - 2 1/2" - 7"
- (C) HMA BASE COURSE WIDENING - VAR.
- (D) AGGREGATE SHOULDERS - 6"
- (E) HMA SHOULDERS - 6"
- (F) CONCRETE GUTTER, TYPE B MODIFIED
- (G) STEEL PLATE BEAM GUARD RAIL, TYPE A

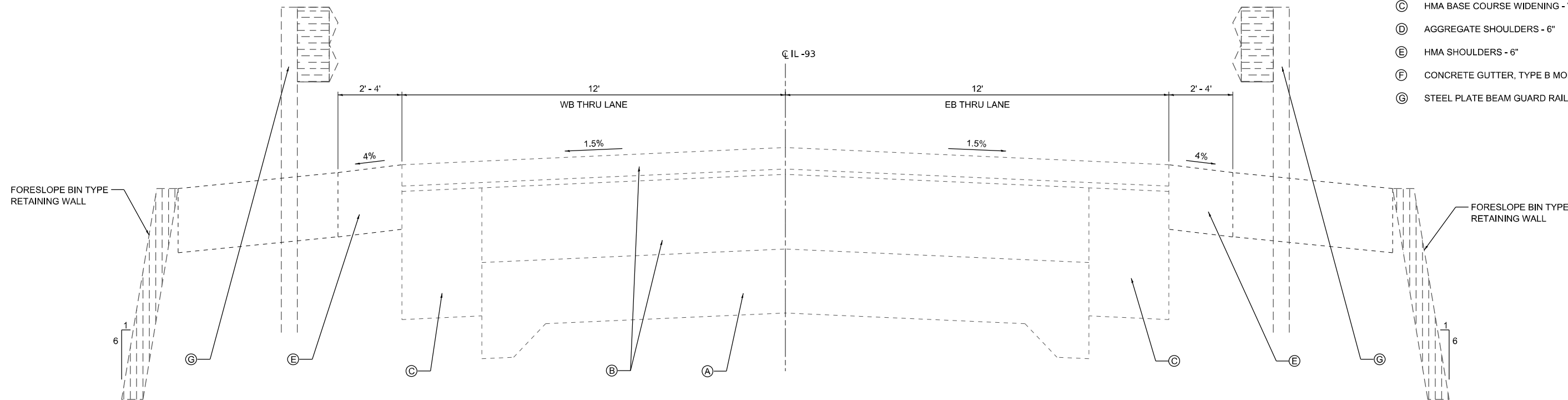

**TYPICAL SECTION 3**

NOT TO SCALE  
 STA. 1337+50 TO STA. 1340+50  
 STA. 1351+00 TO STA. 1354+50  
 STA. 1378+00 TO STA. 1384+50

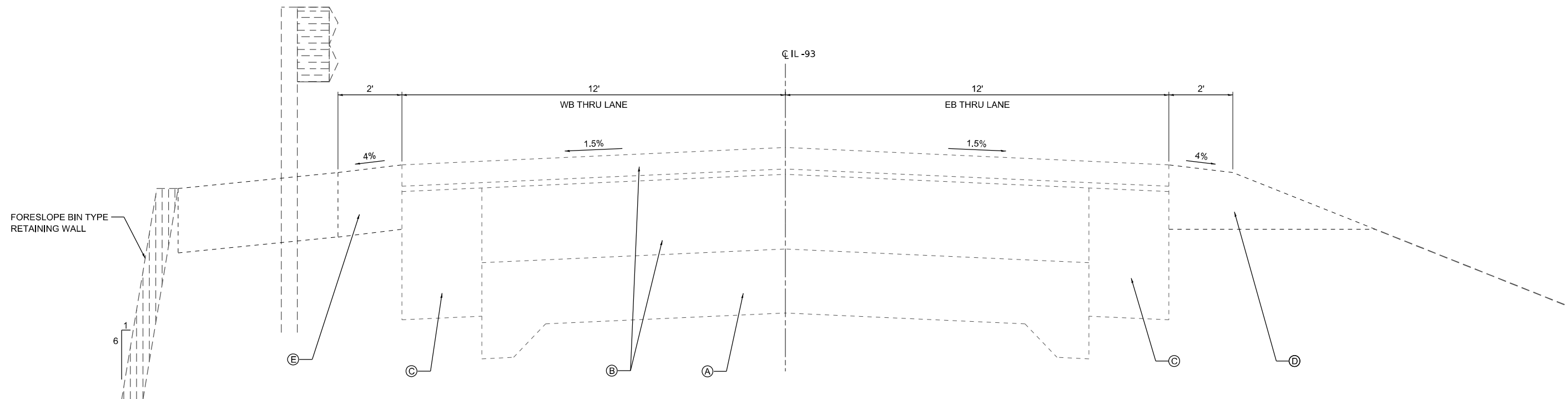

**TYPICAL SECTION 4**

NOT TO SCALE  
 STA. 1614+00 TO STA. 1627+00

MODEL: Typical-2 (Sheet)  
 FILE NAME: H:\P\223104 - D4 VAVIWO 36-HMA patching IL 93\CADD\Microstation\CADD Drawings\68K98-sh4-typical.dgn



USER NAME = breanna.frahm	DESIGNED -	REVISED -
	DRAWN -	REVISED -
	CHECKED -	REVISED -
DATE -		REVISED -
PLOT DATE = 1/16/2026		

**STATE OF ILLINOIS  
 DEPARTMENT OF TRANSPORTATION**

**TYPICAL SECTIONS**

SCALE: SHEET 2 OF 3 SHEETS STA. TO STA.

F.A.S. RTE. 1194	SECTION (106,105)PP	COUNTY STARK	TOTAL SHEETS 9	SHEET NO. 5
CONTRACT NO. 68K98				
ILLINOIS FED. AID PROJECT				

**LEGEND - EXISTING**

- (A) PCC PAVEMENT - 9"
- (B) HMA OVERLAY - 2 1/2" - 7"
- (C) HMA BASE COURSE WIDENING - VAR.
- (D) AGGREGATE SHOULDERS - 6"
- (E) HMA SHOULDERS - 6"
- (F) CONCRETE GUTTER, TYPE B MODIFIED
- (G) STEEL PLATE BEAM GUARD RAIL, TYPE A

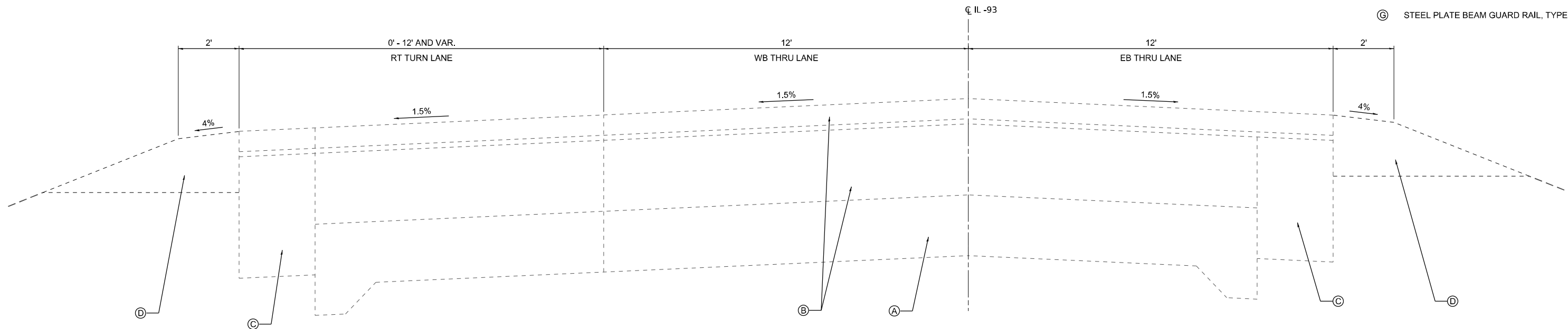

**TYPICAL SECTION 5**  
 NOT TO SCALE  
 STA. 1398+05 TO STA. 1403+05

MODEL: Typical-5 (Sheet)  
 FILE NAME: H:\P\223104 - D4 VAVWO 36-HMA patching\_IL\_93\CADD\Microstation\CADD Drawings\68K98-sh5-typical.dgn



USER NAME = breanna.frahm	DESIGNED -	REVISED -
	DRAWN -	REVISED -
	CHECKED -	REVISED -
DATE -		REVISED -
PLOT DATE = 1/15/2026		

**STATE OF ILLINOIS  
 DEPARTMENT OF TRANSPORTATION**

<b>TYPICAL SECTIONS</b>			
SCALE:	SHEET 3	OF 3 SHEETS	STA. TO STA.

F.A.S. RTE. 1194	SECTION (106,105)PP	COUNTY STARK	TOTAL SHEETS 9	SHEET NO. 6
ILLINOIS FED. AID PROJECT			CONTRACT NO. 68K98	

### IL 93 HMA PARTIAL DEPTH PATCHING SCHEDULE

STATION	STATION	OFFSET	LENGTH	WIDTH	PARTIAL DEPTH PATCHING	PARTIAL DEPTH PATCHING (SPECIAL)	LONGITUDINAL JOINT REPAIR	HOT-MIX ASPHALT SURFACE REMOVAL - LONGITUDINAL JOINT
			(FT)	(FT)	(TON)	(SQ YD)	(TON)	(SQ YD)
1190+19	1193+30	RT	311	4	19	138		
1190+19	1200+50	CL	1031	3			48	344
1190+70	1193+30	LT	260	6	24	173		
1195+80	1196+80	LT	100	3	5	33		
1196+25	1198+74	RT	249	4	15	111		
1198+10	1199+30	LT	120	3	6	40		
1223+00	1226+00	LT	300	3	14	100		
1223+00	1226+00	CL	300	3			14	100
1223+40	1226+09	RT	269	3	13	90		
1227+00	1230+00	LT	300	4	19	133		
1227+00	1230+00	RT	300	4	19	133		
1244+00	1254+00	CL	1000	3			47	333
1304+00	1312+00	RT	800	4	50	356		
900E	950E	RT	100	2	3	22		
950E		RT	100	3	5	33		
1426+16	1426+83	LT	67	12	13	89		
1424+00	1428+00	LT	400	4	25	178		
1431+90	1432+90	LT	130	4	8	58		
1443+00	1446+00	LT	300	3	14	100		
1444+50	1446+00	LT	150	7	16	117		
1446+96	1448+30	LT	134	4	8	60		
1448+30	1456+00	LT	770	4	48	342		
1451+00	1456+00	RT	500	4	31	222		
1499+78	1502+30	LT	252	4	16	112		
1500+05	1500+75	LT	70	6	7	47		
1516+97	1521+98	LT	501	3	23	167		
1518+87	1520+93	RT	206	6	19	137		
1521+47	1525+09	RT	362	6	34	241		
1547+42	1550+68	RT	326	6	30	217		
1563+25	1569+39	RT	614	4	38	273		
1563+25	1564+11	LT	86	4	5	38		
1564+38	1564+56	LT	18	12	3	24		
1565+30	1565+38	LT	12	12	2	16		
1576+81	1577+40	RT	59	12	11	79		
1614+00	1614+67	LT	67	13	14	97		
1614+00	1614+67	RT	67	14	15	104		
1639+72	1640+00	RT	28	12	5	37		
1640+45	1641+37	RT	92	4	6	41		
1643+26	1644+26	RT	100	4	6	44		
1650+38	1650+66	LT	28	12	5	37		
1650+38	1650+66	RT	28	12	5	37		
1652+35	1653+09	RT	74	12	14	99		
1655+95	1656+44	RT	49	12	9	65		
1662+37	1664+00	RT	163	4	10	72		
1674+78	1677+30	RT	252	4	16	112		
<b>TOTAL</b>					<b>648</b>	<b>4627</b>	<b>109</b>	<b>777</b>

MODEL: Schedule (Sheet)  
 FILE NAME: H:\P\223104 - D4 VAVIWO 38-HMA patching\_IL\_93\CADD\Microstation\CADD Drawings\0468K98-sh-schedule.dgn



USER NAME = breanna.frahm	DESIGNED -	REVISED -
	DRAWN -	REVISED -
	CHECKED -	REVISED -
PLOT DATE = 1/22/2026	DATE -	REVISED -

**STATE OF ILLINOIS**  
**DEPARTMENT OF TRANSPORTATION**

**SCHEDULES**  
 SCALE: SHEET 1 OF 1 SHEETS STA. TO STA.

F.A.S. RTE.	SECTION	COUNTY	TOTAL SHEETS	SHEET NO.
1194	(106,105)PP	STARK	9	7
CONTRACT NO. 68K98				
ILLINOIS FED. AID PROJECT				

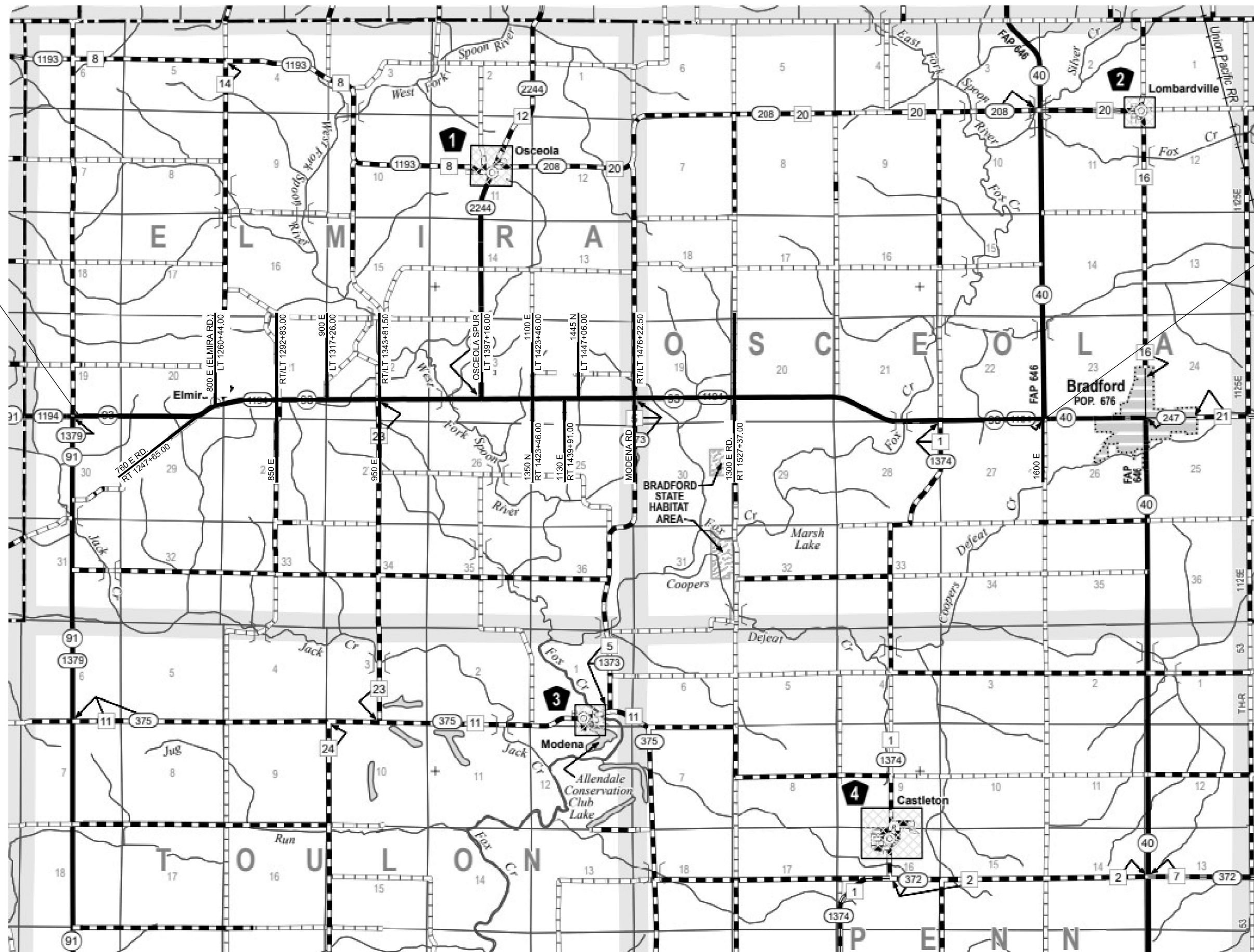

BEGIN IMPROVEMENTS  
INTERSECTION OF IL 93 AND IL 91  
STA. 1185+55.00

END IMPROVEMENT  
INTERSECTION OF IL 93 AND IL 40  
STA. 1689+15.00

MODEL: Location Map (Sheet)  
FILE NAME: H:\P\223104 - D4 VAVIWO 36-HMA patching IL 93\CADD\Microstation\CADD Drawings\68K98-sh1-location\_map.dgn



USER NAME = breanna.frahm  
DESIGNED -  
DRAWN -  
CHECKED -  
DATE -  
PLOT DATE = 1/22/2026

REVISD -  
REVISD -  
REVISD -  
REVISD -

STATE OF ILLINOIS  
DEPARTMENT OF TRANSPORTATION

LOCATION MAP

SCALE: SHEET 1 OF 1 SHEETS STA. TO STA.

F.A.S. RTE.	SECTION	COUNTY	TOTAL SHEETS	SHEET NO.
1194	(106,105)PP	STARK	9	8
CONTRACT NO. 68K98				
ILLINOIS FED. AID PROJECT				

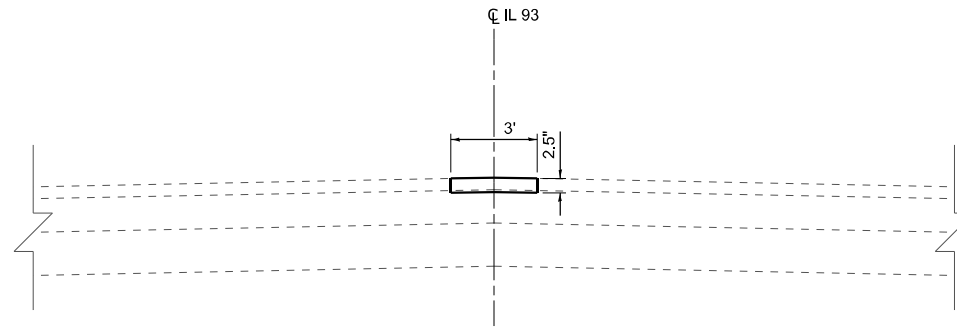

**LONGITUDINAL JOINT REPAIR DETAIL**

NOT TO SCALE

NOTE: TACK COAT INCLUDED IN UNIT PRICE FOR HMA PLACEMENT

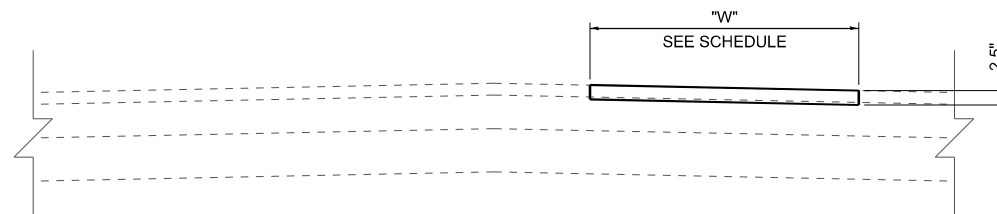

**PARTIAL DEPTH PATCHING DETAIL**

NOT TO SCALE

NOTE: TACK COAT INCLUDED IN UNIT PRICE FOR HMA PLACEMENT

MODEL: Construction Details (Sheet)  
 FILE NAME: H:\P\223104 - D4 VAVVO 38-HMA patching IL 93\CADD\Microstation\CADD Drawings\D468K98-sh1-details.dgn



USER NAME = breanna.frahm	DESIGNED -	REVISED -
	DRAWN -	REVISED -
	CHECKED -	REVISED -
PLOT DATE = 1/16/2026	DATE -	REVISED -

**STATE OF ILLINOIS  
 DEPARTMENT OF TRANSPORTATION**

**CONSTRUCTION DETAILS**

SCALE: SHEET 1 OF 1 SHEETS STA. TO STA.

F.A.S RTE.	SECTION	COUNTY	TOTAL SHEETS	SHEET NO.
1194	(106,105)PP	STARK	9	9
ILLINOIS FED. AID PROJECT			CONTRACT NO. 68K98	

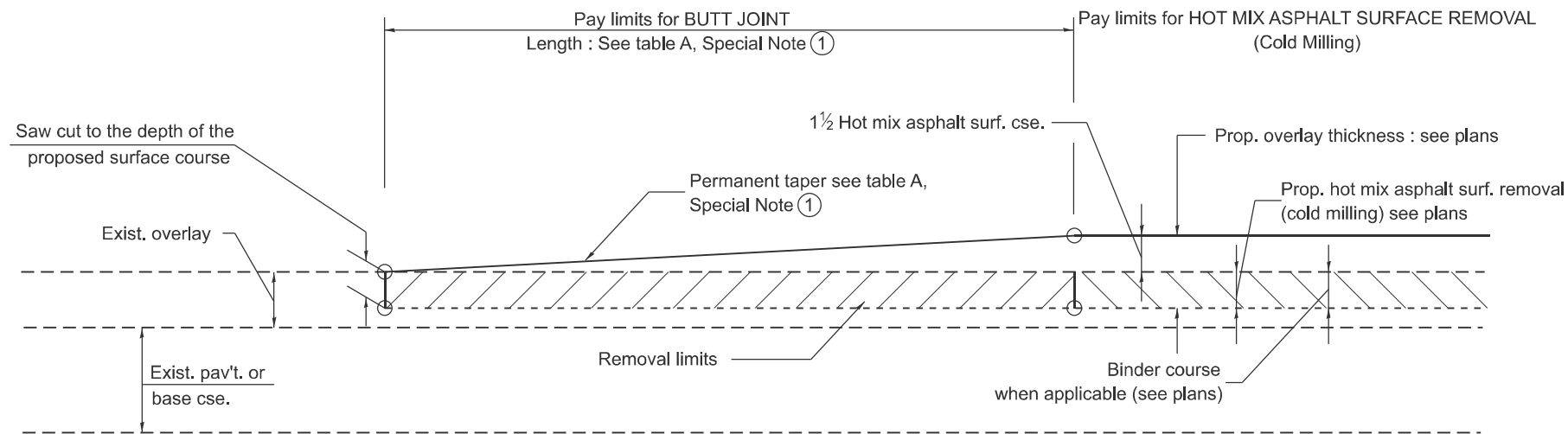

**CASE 1 : WITH HOT MIX ASPHALT SURFACE REMOVAL (COLD MILLING)**

**TABLE A  
TAPER RATES**

SPECIAL NOTE NUMBER	ELEMENT	MAINLINE INTERSTATES & 4-LANE EXPRESSWAYS	ALL OTHERS
①	BUTT JOINT TAPER RATE	1:480	1:240
②	TEMPORARY RAMP TAPER RATE	1:80	1:40

**GENERAL NOTES**

1. The work shall be done in accordance with Article 406.08 and the Special Provision for Butt Joints.
2. The pavement surface to be removed may be either bituminous or P.C. concrete. The work shall be performed in accordance with Article 440.04 and the Special Provisions for Butt Joints.
3. The saw cut joints shall be primed just prior to the placing of bituminous material. The work will be in accordance with the applicable portions of Article 406.05.
4. The length of butt joint is based on the taper rate times change in cold milling depth within the butt joint pay limits, unless otherwise indicated.
5. Temporary ramps are paid for separately and not included in the cost of the butt joints.

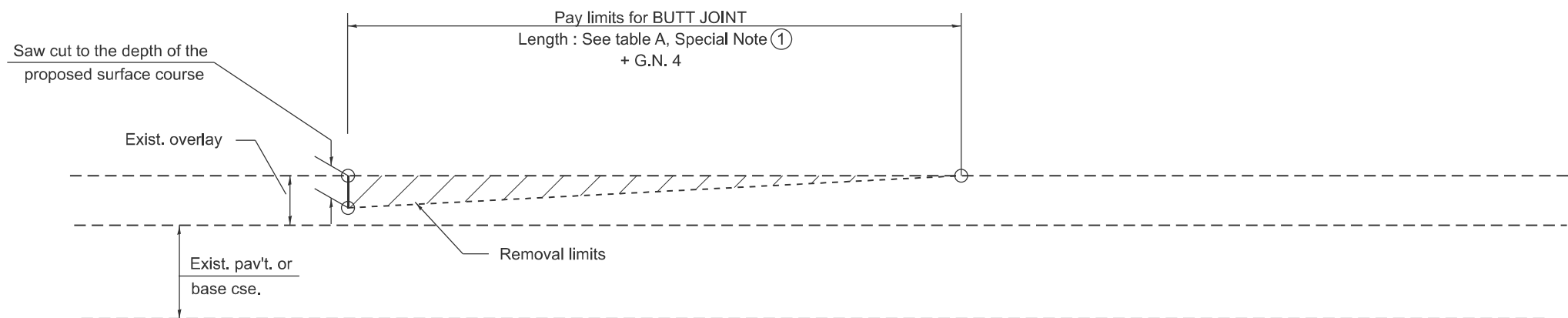

**CASE 2 : NO HOT MIX ASPHALT SURFACE REMOVAL (COLD MILLING)**

All dimensions are in inches unless otherwise noted.

MODEL: D4-06101-01  
FILE NAME: c:\p\work\pav\illinois.gov\thomas.cox\illinois.gov\10559441D4-06101.dgn

USER NAME = thomas.cox	DESIGNED -	REVISED -
	DRAWN -	REVISED -
	CHECKED -	REVISED -
PLOT DATE = 9/17/2025	DATE -	REVISED -

**STATE OF ILLINOIS  
DEPARTMENT OF TRANSPORTATION**

**BUTT JOINTS**

SCALE: NOT TO SCALE SHEET 000 1 OF 3 SHEETS STA. TO STA.

F.A. RTE.	SECTION	COUNTY	TOTAL SHEETS	SHEET NO.
				0
DISTRICT 4 STANDARD NO. 406101		CONTRACT NO.		
ILLINOIS FED. AID PROJECT				

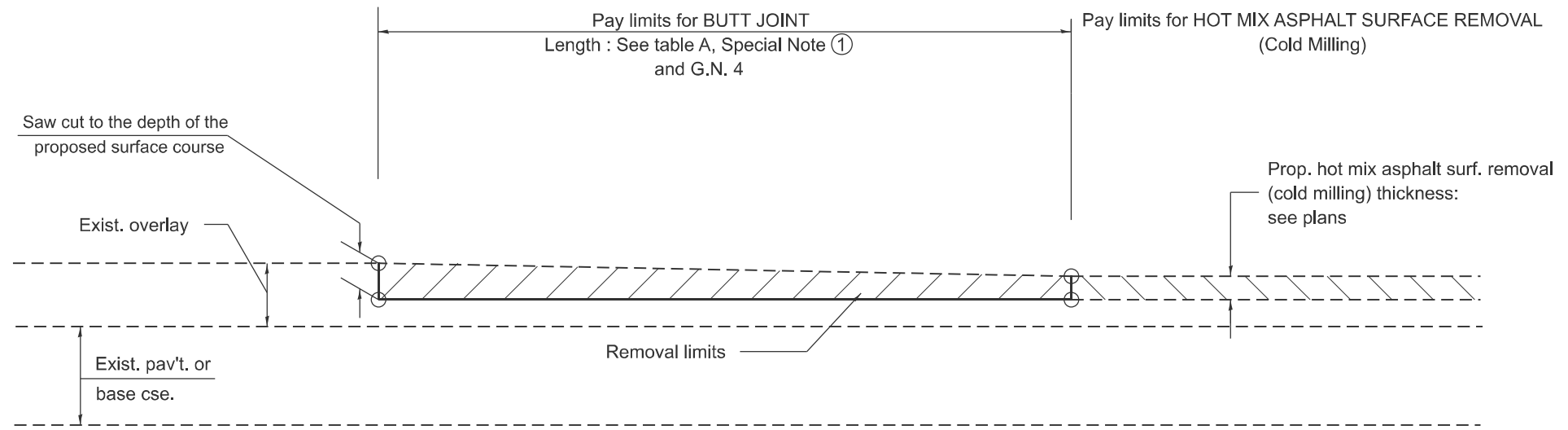

**CASE 3 : HOT MIX ASPHALT SURFACE REMOVAL (COLD MILLING)  
TIE-IN TO EXISTING BITUMINOUS TAPER**

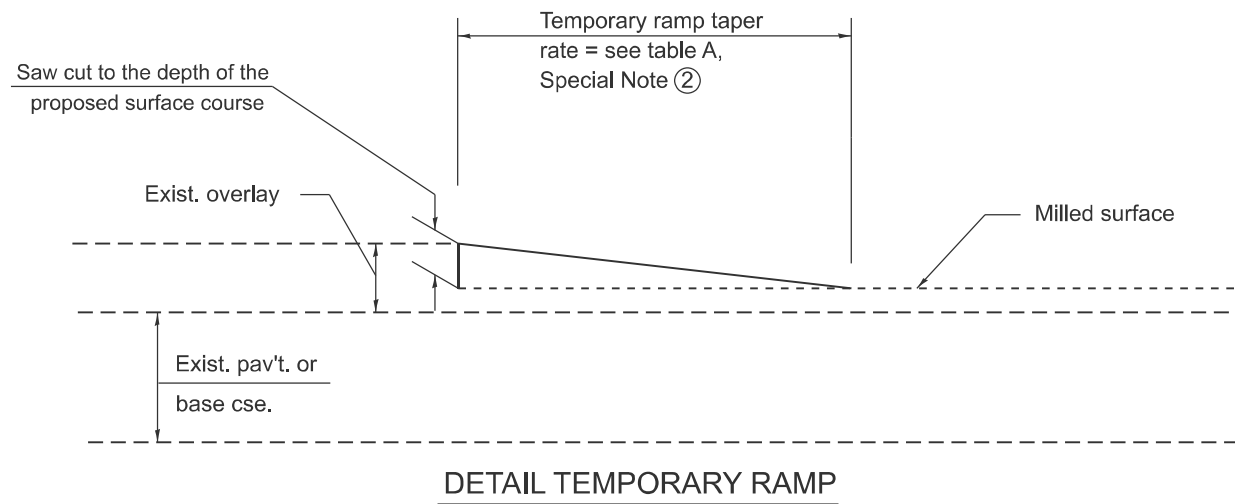

All dimensions are in inches unless otherwise noted.

MODEL: D4-06101-02  
FILE NAME: c:\p\work\pav\illinois.gov\thomas.cox\illinois.gov\td\0559441D4-06101.dgn

USER NAME = thomas.cox	DESIGNED -	REVISED -
	DRAWN -	REVISED -
	CHECKED -	REVISED -
PLOT DATE = 9/17/2025	DATE -	REVISED -

**STATE OF ILLINOIS  
DEPARTMENT OF TRANSPORTATION**

**BUTT JOINTS**

SCALE: NOT TO SCALE SHEET 000 2 OF 3 SHEETS STA. TO STA.

F.A. RTE.	SECTION	COUNTY	TOTAL SHEETS	SHEET NO.
				0
DISTRICT 4 STANDARD NO. 406101			CONTRACT NO.	
ILLINOIS FED. AID PROJECT				

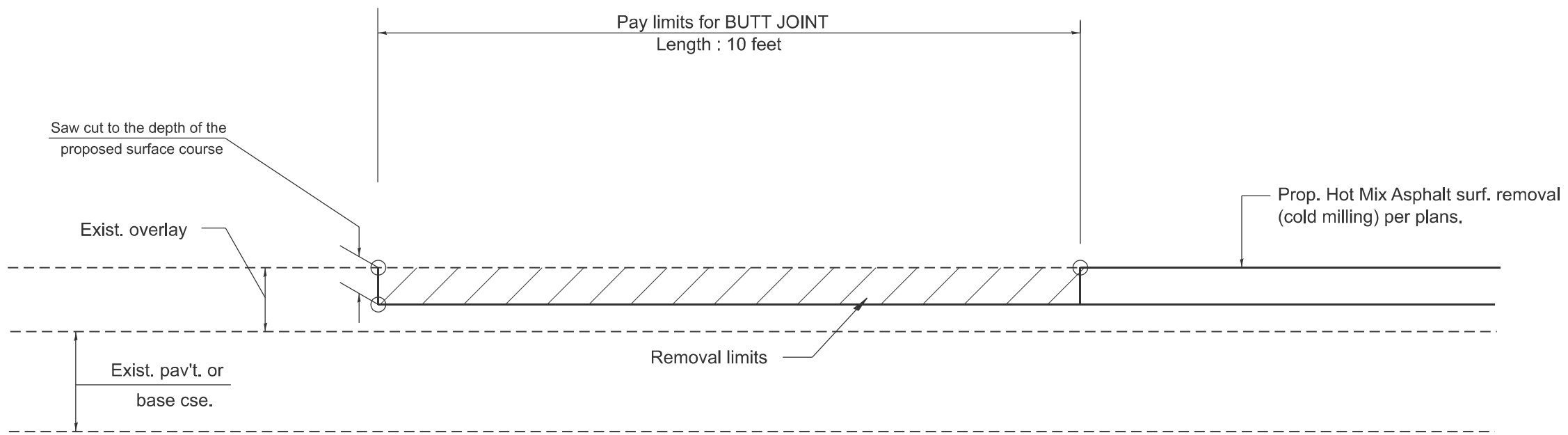

**CASE 4 : SINGLE LIFT OVERLAY WITH EQUIVALENT DEPTH**  
**HOT MIX ASPHALT SURFACE REMOVAL (COLD MILLING)**  
**TIE-IN TO EXISTING BITUMINOUS TAPER**

MODEL: D4-06101-03  
 FILE NAME: c:\p\work\pav\illinois.gov\thomas.cox\illinois.gov\td\055944\D4-06101.dgn

All dimensions are in inches unless otherwise noted.

USER NAME = thomas.cox PLOT DATE = 9/17/2025	DESIGNED -	REVISED -	<b>STATE OF ILLINOIS</b> <b>DEPARTMENT OF TRANSPORTATION</b>	<b>BUTT JOINTS</b>		F.A. RTE.	SECTION	COUNTY	TOTAL SHEETS	SHEET NO.	
	DRAWN -	REVISED -									0
	CHECKED -	REVISED -				DISTRICT 4 STANDARD NO. 406101		CONTRACT NO.			
	DATE -	REVISED -		SCALE: NOT TO SCALE	SHEET 000 3 OF 3 SHEETS	STA.	TO STA.	ILLINOIS FED. AID PROJECT			