

CITY OF ALEDO
MERCER COUNTY

SW 6TH ST SIDEWALK RECONSTRUCTION

INDEX OF SHEETS

- 1 COVER SHEET
- 2 GENERAL NOTES, LIST OF STANDARDS & SUMMARY OF QUANTITIES
- 3 TYPICAL SECTIONS
- 4 SCHEDULES OF QUANTITIES
- 5-7 PLANS
- 8-11 ADA DETAILS

**SECTION 24-00051-00-SW
PROJECT 72MC(138)
SW 6TH ST
SW 10TH AVE TO S COLLEGE AVE**

C-94-021-25

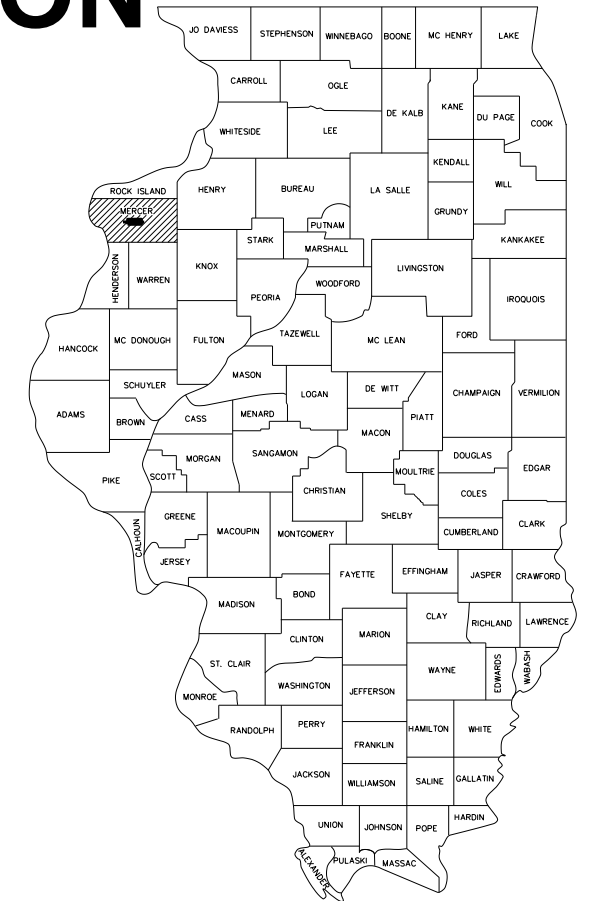

PROJECT LOCATION:-



LOCATION MAP
NOT TO SCALE

PROPOSED IMPROVEMENT:
THE PROJECT CONSISTS OF REMOVAL AND REPLACEMENT OF SIDEWALK, ADA RAMPS, EARTHWORK AND OTHER COLLATERAL WORK.

**BEGIN IMPROVEMENT
STA 74+10.33**

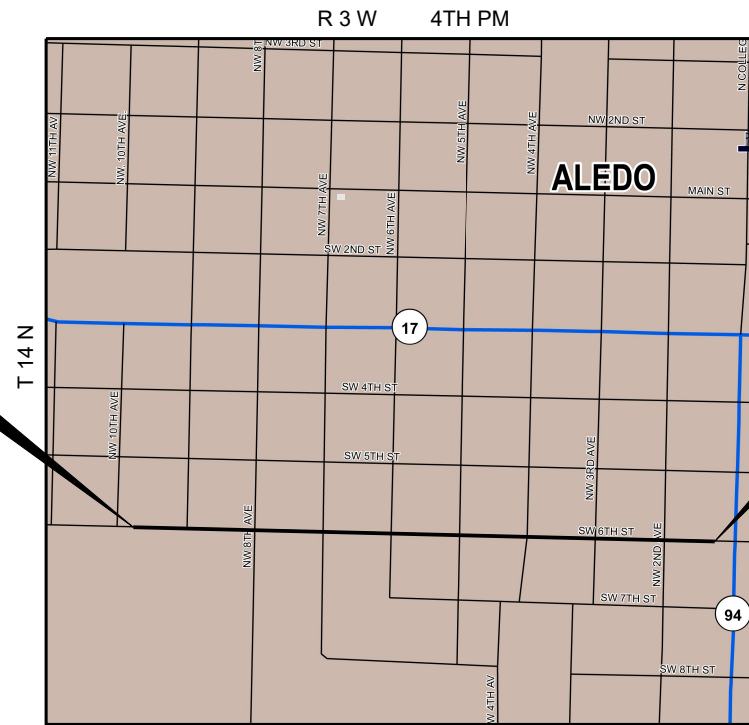

**END IMPROVEMENT
STA 100+27.97**

J.U.L.I.E.
JOINT UTILITY LOCATION INFORMATION FOR EXCAVATION
1-800-892-0123
OR 811

**PROJECT MANAGER: SHANE LARSON, P.E.
PROJECT ENGINEER: RYAN BRADLE, P.E.**

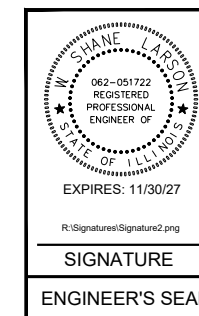

APPROVED	<u>3/16/26</u>	DATE
		LOCAL AGENCY OFFICIAL SIGNATURE
PASSED	<u>04-15</u>	20 <u>26</u>
		DISTRICT 4 ENGINEER OF LOCAL ROADS & STREETS
Releasing For Bid Based on Limited Review	<u>0416</u>	20 <u>26</u>
		DEPUTY DIRECTOR OF HIGHWAYS, REGION 3 ENGINEER
		STATE OF ILLINOIS DEPARTMENT OF TRANSPORTATION

GENERAL NOTES

AVAILABILITY OF ELECTRONIC FILES

AUTOCAD FILES OF THIS PROJECT WILL BE MADE AVAILABLE TO THE CONTRACTOR AFTER CONTRACT AWARD. IF THERE IS A CONFLICT BETWEEN THE ELECTRONIC FILES AND THE PRINTED CONTRACT PLANS AND DOCUMENTS, THE PRINTED CONTRACT PLANS AND DOCUMENTS SHALL TAKE PRECEDENCE OVER THE ELECTRONIC FILES. THE CONTRACTOR SHALL ACCEPT ALL RISK ASSOCIATED WITH USING THE ELECTRONIC FILES AND SHALL HOLD THE DEPARTMENT HARMLESS FOR ANY ERRORS OR OMISSIONS IN THE ELECTRONIC FILES AND THE DATA CONTAINED THEREIN. ERROR OR DELAYS RESULTING FROM THE USE OF THE ELECTRONIC FILES BY THE CONTRACTOR SHALL NOT RESULT IN A EXTENSION OF TIME FOR ANY INTERIM OR FINAL COMPLETION DATE OR SHALL NOT BE CONSIDERED CAUSE FOR ADDITIONAL COMPENSATION. THE CONTRACTOR SHALL NOT USE, SHARE OR DISTRIBUTE THESE ELECTRONIC FILES EXCEPT FOR THE PURPOSE OF CONSTRUCTING THIS CONTRACT. ANY CLAIMS BY THIRD PARTIES DUE TO USE OR ERRORS SHALL BE THE SOLE RESPONSIBILITY OF THE CONTRACTOR. THE CONTRACTOR SHALL INCLUDE THIS DISCLAIMER WITH THE TRANSFER OF THESE ELECTRONIC FILES TO ANY OTHER PARTIES AND SHALL INCLUDE APPROPRIATE LANGUAGE BINDING THEM TO SIMILAR RESPONSIBILITIES.

ENVIRONMENTAL REVIEWS

PRIOR TO THE USE OF ANY PROPOSED BORROW AREAS, USE AREAS (TEMPORARY ACCESS ROADS, DETOURS, RUN-AROUNDS, ETC.) AND/OR WASTE AREAS, THE CONTRACTOR SHALL FILE THE REQUIRED ENVIRONMENTAL RESOURCE REQUEST SURVEYS ACCORDING TO SECTION 107.22 OF THE STANDARD SPECIFICATIONS. THESE SURVEYS ARE REQUIRED IN ORDER FOR THE DEPARTMENT TO CONDUCT CULTURAL AND BIOLOGICAL RESOURCE SURVEYS FOR THE PROPOSED SITE.

THE REQUIRED ENVIRONMENTAL RESOURCE DOCUMENTATION SHALL INCLUDE THE FOLLOWING:

BDE FORM 2289 (BORROW SITE REVIEW)
 BDE FORM 2290 (WASTE/USE AREA REVIEW)
 A LOCATION MAP SHOWING THE SIZE LIMITS AND LOCATION OF THE USE AREA
 COLOR PHOTOGRAPHS DEPICTING THE USE AREA
 BORROW AREA ENTRY AGREEMENT FORM - D4 PI0101

PRIOR TO ANY WASTE MATERIALS BEING REMOVED FROM THE CONSTRUCTION SITE THE REQUIRED ENVIRONMENTAL RESOURCE SURVEYS SHALL BE OBTAINED AND FILED BY THE CONTRACTOR. EXCESS WASTE PRODUCTS REMOVED FROM THE CONSTRUCTION SITE SHALL BE DISPOSED OF AS REQUIRED IN SECTION 202.03 OF THE STANDARD SPECIFICATIONS.

ANY PROTRUDING METAL BARS SHALL BE REMOVED PRIOR TO THE DISPOSAL OF BROKEN CONCRETE AT APPROVED DISPOSAL SITES. PLEASE NOTE THAT A MINIMUM OF FOUR WEEKS SHALL BE ALLOWED FOR THE DISTRICT TO OBTAIN THE REQUIRED WASTE SITE ENVIRONMENTAL CLEARANCES AND SIX WEEKS FOR THE REQUIRED BORROW SITE ENVIRONMENTAL CLEARANCES.

MISCELLANEOUS

ALL PROPERTY PINS DISTURBED DURING CONSTRUCTION SHALL BE RESET BY THE ENGINEER AT THE EXPENSE OF THE CONTRACTOR PER ILLINOIS STATE LAW.

ANY PROPERTY DAMAGE OR DISTURBANCE TO PRIVATE PROPERTY SHALL REQUIRE THE CONTRACTOR TO RESTORE THE PROPERTY TO ORIGINAL OR BETTER CONDITION AT THEIR OWN EXPENSE.

CONTRACTOR SHALL PROTECT ALL EXISTING SIDEWALK, PAVEMENT, LANDSCAPING, FENCES, RETAINING WALL, AND ANY OTHER ITEMS AND APPURTENANCES THAT ARE NOT MARKED FOR REMOVAL. ANY DAMAGE CAUSED DURING CONSTRUCTION SHALL BE REPAIRED AT THE CONTRACTOR'S EXPENSE.

COMMITMENTS

NO COMMITMENTS HAVE BEEN MADE FOR THIS PROJECT.

LIST OF HIGHWAY STANDARDS

000001-09	STANDARD SYMBOLS, ABBREVIATIONS AND PATTERNS
424001-12	PERPENDICULAR CURB RAMPS FOR SIDEWALKS
606001-09	CONCRETE CURB TYPE B AND COMBINATION CONCRETE CURB & GUTTER
701801-06	SIDEWALK, CORNER OR CROSSWALK CLOSURE
701901-11	TRAFFIC CONTROL DEVICES
780001-05	TYPICAL PAVEMENT MARKINGS

SUMMARY OF QUANTITIES

CODE NO.	DESCRIPTION	UNIT	TOTAL QUANTITY
42300300	PORTLAND CEMENT CONCRETE DRIVEWAY PAVEMENT, 7 INCH	SQ YD	117
42400100	PORTLAND CEMENT CONCRETE SIDEWALK 4 INCH	SQ FT	9971
42400800	DETECTABLE WARNINGS	SQ FT	181
44000200	DRIVEWAY PAVEMENT REMOVAL	SQ YD	117
44000500	COMBINATION CURB AND GUTTER REMOVAL	FOOT	40
44000600	SIDEWALK REMOVAL	SQ FT	9980
50105220	PIPE CULVERT REMOVAL	FOOT	19
60603800	COMBINATION CONCRETE CURB AND GUTTER, TYPE B-6.12	FOOT	40
67100100	MOBILIZATION	L SUM	1
* 78001130	PAINT PAVEMENT MARKING - LINE 6"	FOOT	286
X7010216	TRAFFIC CONTROL AND PROTECTION, (SPECIAL)	L SUM	1
Z0013798	CONSTRUCTION LAYOUT	L SUM	1

* SPECIALTY ITEM

V:\5555 - Aledo - SW 6th St. Sidewalk - PH I-III\CADD\CADD Sheets\5555-sht-gennote.dwg



DESIGNED ----- DATE - ##-##-25
 DRAWN -----
 CHECKED -----
 PROJECT #: 5555

SW 6TH ST SIDEWALK CONSTRUCTION



CITY OF ALEDO

GENERAL NOTES, LIST OF STANDARDS & SUMMARY OF QUANTITIES

SHEET
2 OF 11

V:\5555 - Aledo - SW 6th St. Sidewalk - PH I-II\CADD\CADD Sheets\5555-sht-typ.dwg

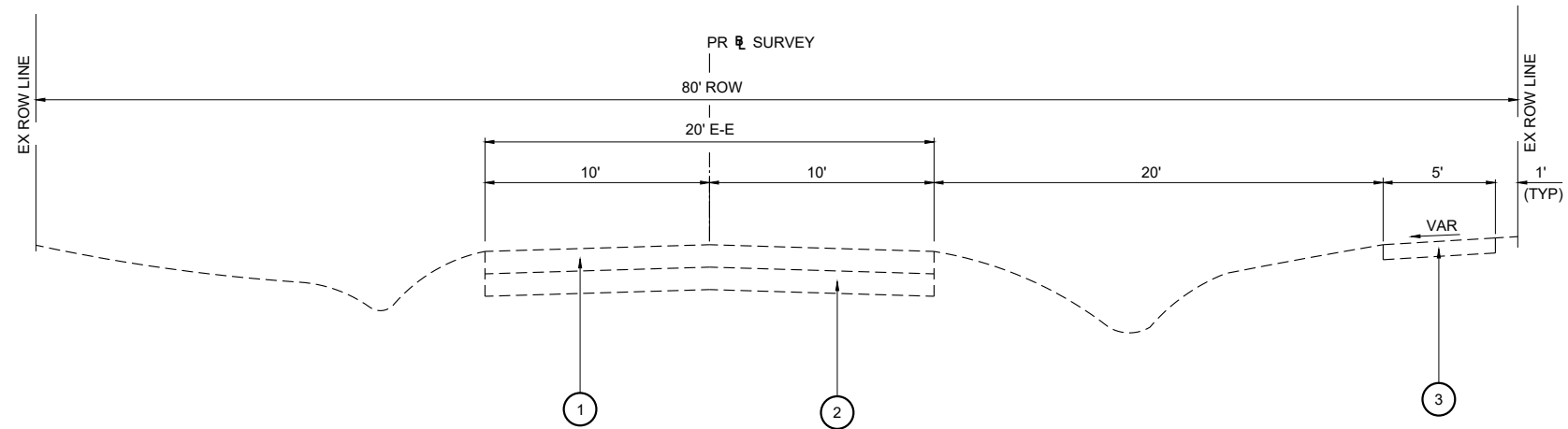

**EXISTING TYPICAL SECTION
SW 6TH ST SIDEWALK**

STA 78+00 TO STA 98+00

- ① EXISTING SEALCOAT SURFACE MATERIAL (VAR)
- ② EXISTING AGGREGATE BASE COURSE (VAR)
- ③ EXISTING PORTLAND CEMENT CONCRETE SIDEWALK
- ④ PROPOSED PORTLAND CEMENT CONCRETE SIDEWALK, 4 INCH

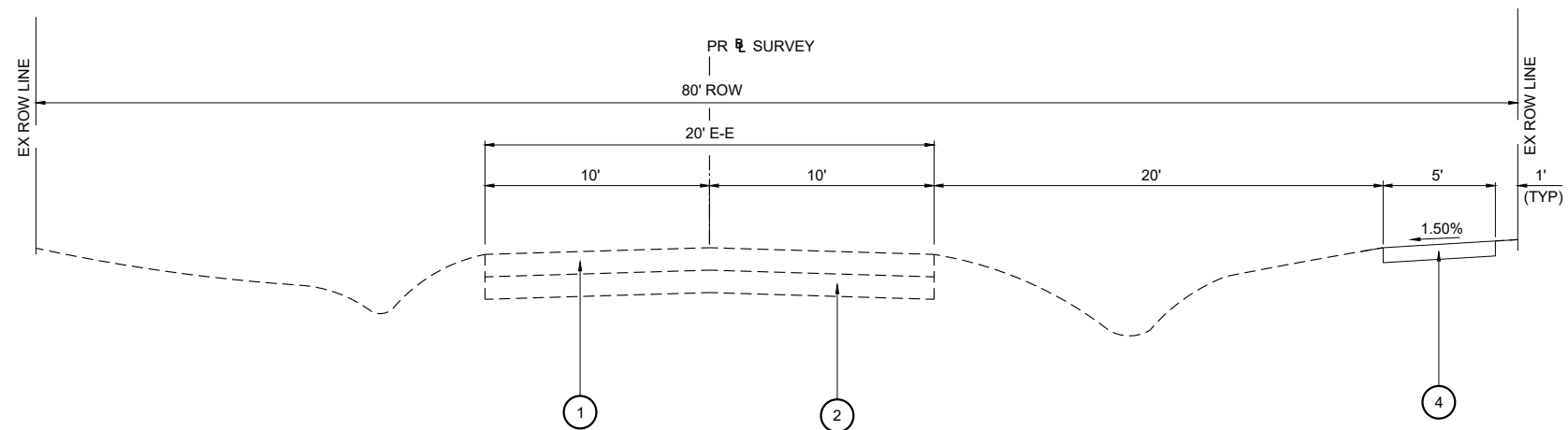

**PROPOSED TYPICAL SECTION
SW 6TH ST SIDEWALK**

STA 78+00 TO STA 98+00 (VARIOUS LOCATIONS)

V:\5555 - Aledo - SW 6th St. Sidewalk - PH I-III\CADD\CADD Sheets\5555-sht-schedules.dwg

DETECTABLE WARNINGS				
STATION	TO	STATION	LOCATION	42400800
				SQ FT
78+17.39	TO	78+18.89	RT	10.7
78+42.76	TO	78+42.81	RT	10.0
78+66.98	TO	78+71.76	LT & RT	20.4
81+43.69	TO	81+43.99	RT	10.0
81+59.91	TO	81+60.00	RT	10.0
84+63.00	TO	84+63.55	RT	10.0
84+79.48	TO	84+79.60	RT	10.0
87+83.15	TO	87+83.27	RT	10.0
88+02.07	TO	88+02.20	RT	10.0
91+03.33	TO	91+03.46	RT	10.0
91+24.39	TO	91+24.59	RT	10.0
94+23.79	TO	94+23.93	RT	10.0
94+45.28	TO	94+45.38	RT	10.2
97+16.51	TO	97+21.49	LT & RT	20.0
97+43.00	TO	97+43.22	RT	10.0
97+68.19	TO	97+69.49	RT	10.0
TOTAL				181.2
USE				181

PCC SIDEWALK, 4 INCH AND CCC&G, TYPE B-6.12					
STATION	TO	STATION	LOCATION	60603800	42400100
				COMBINATION CONCRETE CURB AND GUTTER, TYPE B-6.12	PORTLAND CEMENT CONCRETE SIDEWALK, 4 INCH
				FOOT	SQ FT
74+10.33	TO	74+15.33	RT		25.0
78+07.38	TO	78+18.96	RT		67.2
78+42.76	TO	79+73.50	RT & LT		816.3
80+08.50	TO	81+44.00	RT		677.5
81+59.90	TO	82+67.50	LT		538.0
82+92.50	TO	84+63.55	RT		855.2
84+79.48	TO	86+40.00	RT		802.6
86+70.00	TO	87+83.27	RT		566.4
88+02.07	TO	89+54.00	RT		759.7
89+64.00	TO	91+03.46	RT		697.3
91+23.52	TO	92+77.00	RT		767.4
92+97.00	TO	94+24.93	RT		669.7
94+45.00	TO	95+51.50	RT		651.3
95+76.50	TO	96+12.00	RT		177.5
96+32.00	TO	97+43.72	RT & LT		778.6
97+67.68	TO	98+65.00	RT		506.6
98+85.00	TO	99+30.00	RT		225.0
99+50.00	TO	100+27.97	RT		389.8
97+14.01	TO	97+24.06	LT	10	
97+13.95	TO	97+23.94	RT	10	
97+43.22	TO	97+45.39	RT	10	
97+66.19	TO	97+68.19	RT	10	
TOTAL				40.0	9971.0
USE				40	9971

SIDEWALK AND CC&G REMOVAL					
STATION	TO	STATION	LOCATION	44000500	44000600
				COMBINATION CURB AND GUTTER REMOVAL	SIDEWALK REMOVAL
				FOOT	SQ FT
74+10.33	TO	74+15.33	RT		25.0
78+07.38	TO	78+18.96	RT		67.2
78+42.76	TO	79+73.50	RT & LT		816.3
80+08.50	TO	81+44.00	RT		677.5
81+59.90	TO	82+67.50	LT		538.0
82+92.50	TO	84+63.55	RT		855.2
84+79.48	TO	86+40.00	RT		802.6
86+70.00	TO	87+83.27	RT		566.4
88+02.07	TO	89+54.00	RT		759.7
89+64.00	TO	91+03.46	RT		697.3
91+23.52	TO	92+77.00	RT		767.4
92+97.00	TO	94+24.93	RT		758.4
94+45.00	TO	95+51.50	RT		651.3
95+76.50	TO	96+12.00	RT		177.5
96+32.00	TO	97+43.72	RT & LT		718.6
97+67.68	TO	98+65.00	RT		486.6
98+85.00	TO	99+30.00	RT		225.0
99+50.00	TO	100+27.97	RT		389.8
97+14.01	TO	97+24.06	LT	10	
97+13.95	TO	97+23.94	RT	10	
97+43.22	TO	97+45.39	RT	10	
97+66.19	TO	97+68.19	RT	10	
TOTAL				40.0	9979.7
USE				40	9980

PCC DRIVEWAY PAVEMENT, 7 INCH				
STATION	TO	STATION	LOCATION	42300300
				PCC DRIVEWAY PAVEMENT, 7 INCH
				SQ YD
79+73.50	TO	80+08.50	RT	19.4
82+67.50	TO	82+92.50	RT	13.9
86+40.00	TO	86+70.00	RT	16.7
89+54.00	TO	89+64.00	RT	5.6
92+77.00	TO	92+97.00	RT	13.9
95+51.50	TO	95+76.50	RT	13.9
96+12.00	TO	96+32.00	RT	11.1
98+65.00	TO	98+85.00	RT	11.1
99+30.00	TO	99+50.00	RT	11.1
TOTAL				116.7
USE				117

PIPE CULVERT REMOVAL		
STATION	LOCATION	50105220
		PIPE CULVERT REMOVAL
		FOOT
81+41.79	RT	9.0
88+04.07	RT	10.0
TOTAL		19.0
USE		19

PAVEMENT MARKING				
STATION	TO	STATION	LOCATION	78001130
				PAINT PAVEMENT MARKING -LINE 6"
				FOOT
78+17.43	TO	78+42.78	RT	50.7
81+43.74	TO	81+59.87	RT	32.3
84+63.32	TO	84+79.51	RT	32.4
87+83.24	TO	88+02.09	RT	37.7
91+03.47	TO	91+24.64	RT	42.3
94+23.94	TO	94+45.28	RT	42.7
97+43.72	TO	97+67.69	RT	47.9
TOTAL				286.0
USE				286

DRIVEWAY PAVEMENT REMOVAL				
STATION	TO	STATION	LOCATION	44000200
				DRIVEWAY PAVEMENT REMOVAL
				SQ YD
79+73.50	TO	80+08.50	RT	19.4
82+67.50	TO	82+92.50	RT	13.9
86+40.00	TO	86+70.00	RT	16.7
89+54.00	TO	89+64.00	RT	5.6
92+77.00	TO	92+97.00	RT	13.9
95+51.50	TO	95+76.50	RT	13.9
96+12.00	TO	96+32.00	RT	11.1
98+65.00	TO	98+85.00	RT	11.1
99+30.00	TO	99+50.00	RT	11.1
TOTAL				116.7
USE				117

V:\5555 - Aledo - SW 6th St. Sidewalk - PH I-III\CADD\CADD Sheets\5555-sht-plnprf.dwg

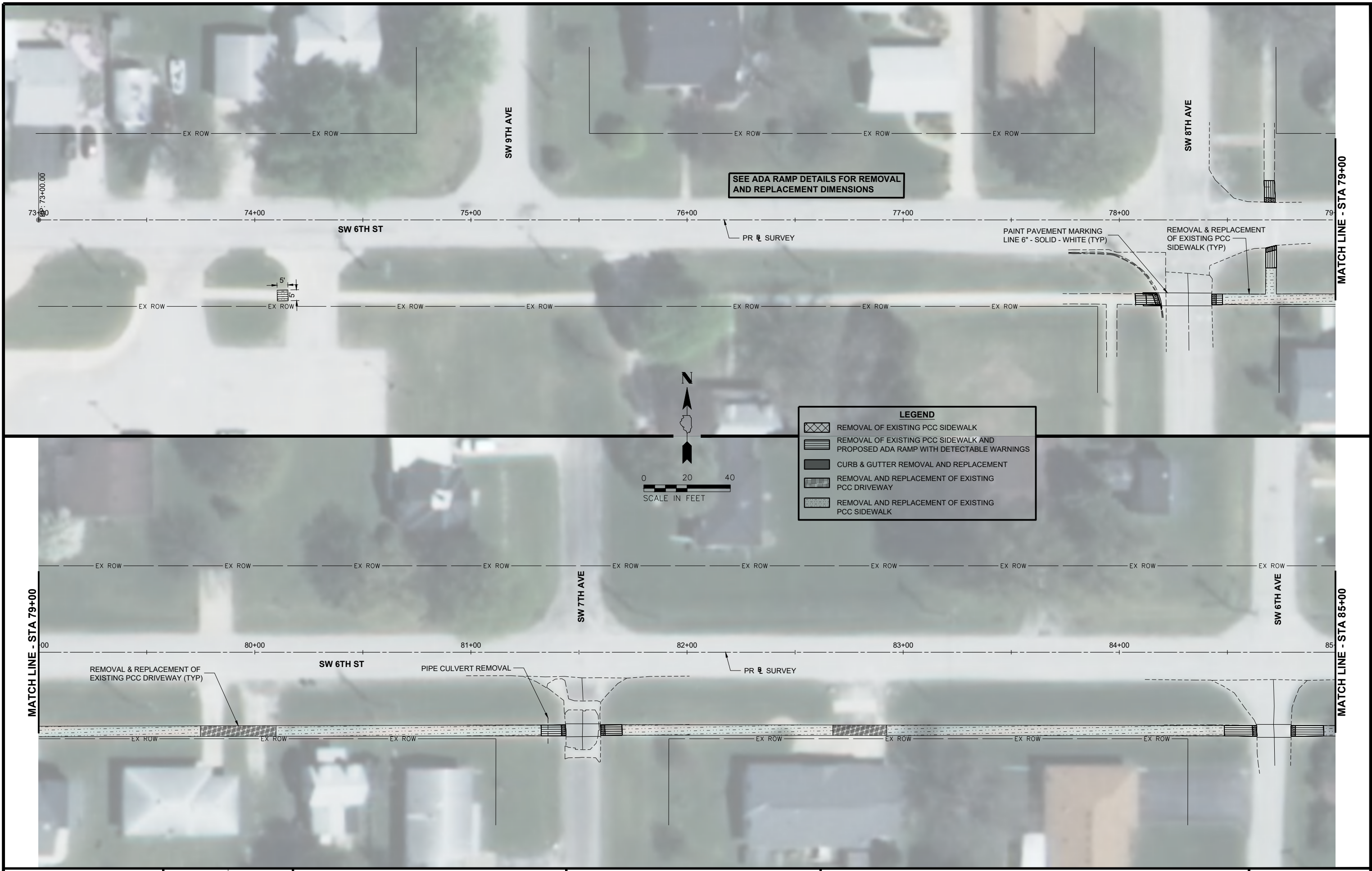

	DESIGNED ----- DATE - ##-##-25
	DRAWN -----
	CHECKED -----
	PROJECT #: 5555

SW 6TH ST SIDEWALK CONSTRUCTION

	CITY OF ALEDO
--	----------------------

PLAN (1 OF 3)

SHEET 5 OF 11

V:\5555 - Aledo - SW 6th St. Sidewalk - PH I-II\CADD\CADD Sheets\5555-sht-plnprf.dwg

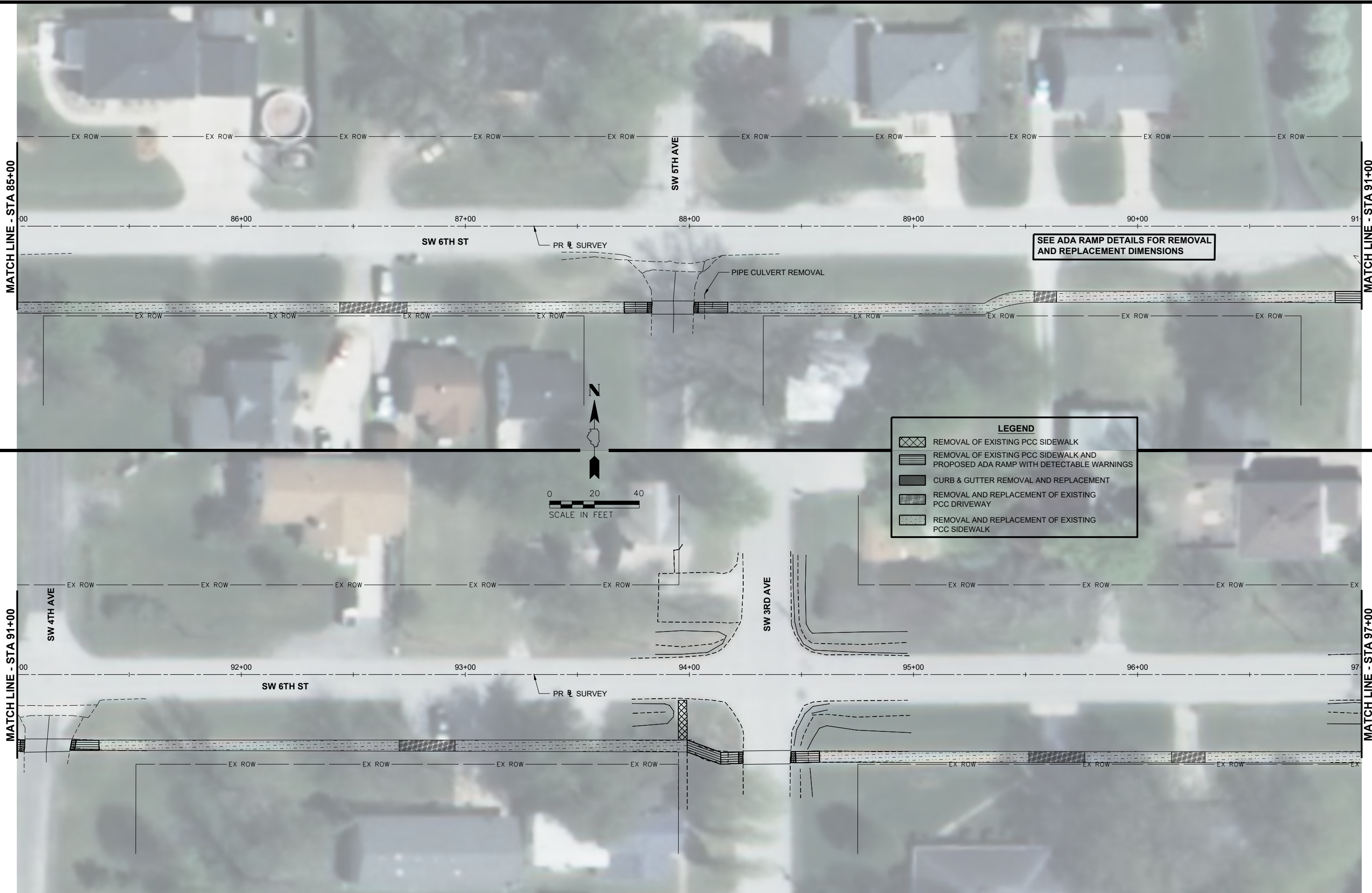

V:\5555 - Aledo - SW 6th St. Sidewalk - PH I-II\CADD\CADD Sheets\5555-sht-plnprf.dwg

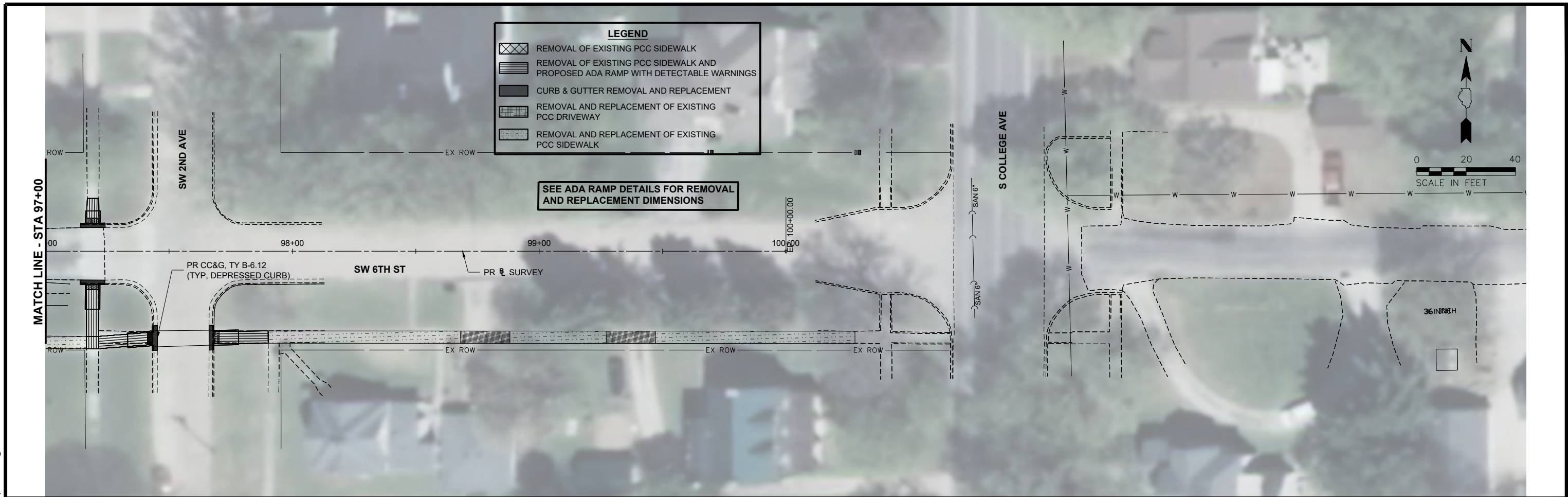

V:\5555 - Aledo - SW 6th St. Sidewalk - PH I-III\CADD\CADD Sheets\5555-sht-ADA.dwg

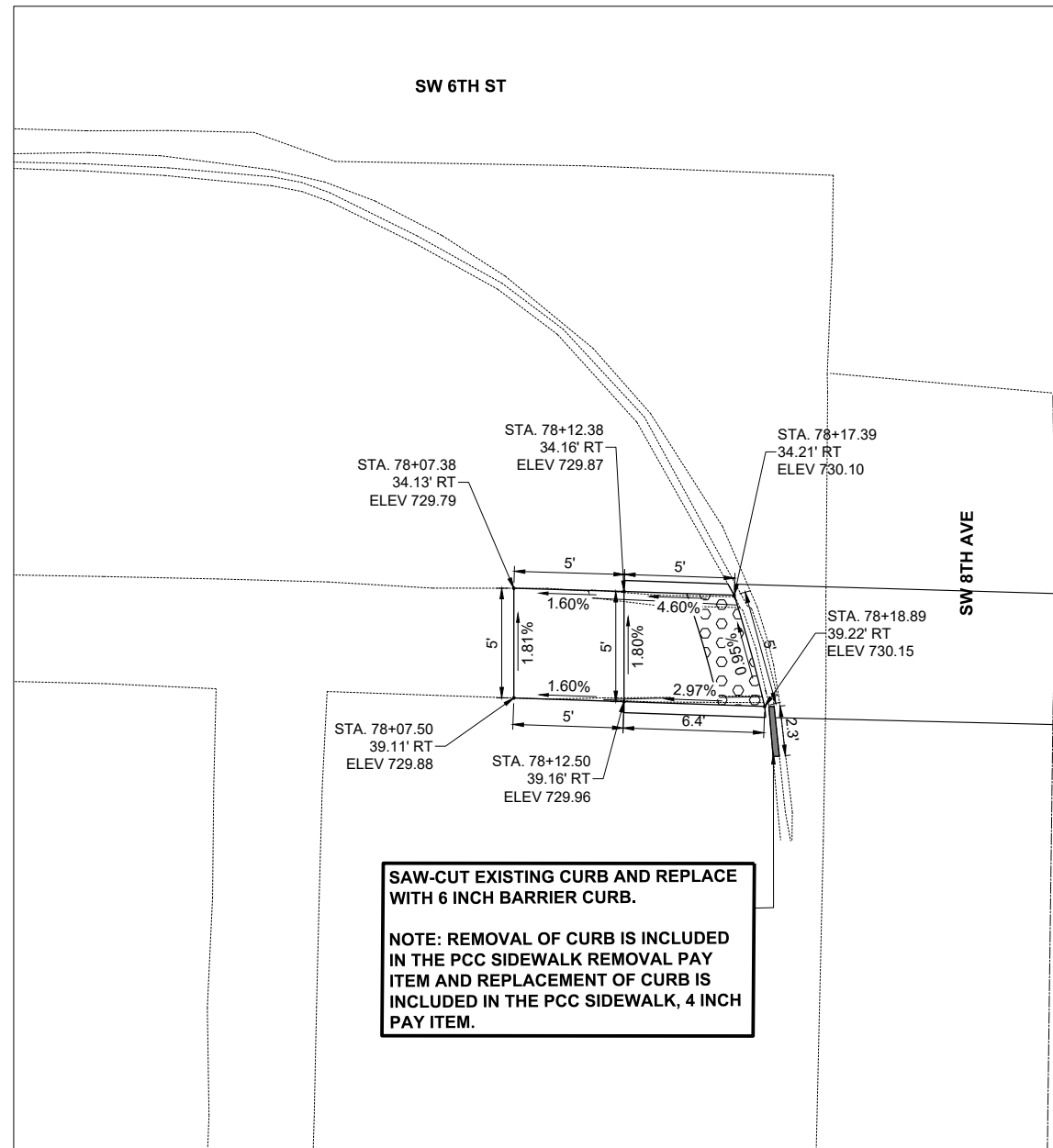

SW RAMP - SW 6TH ST & SW 8TH AVE

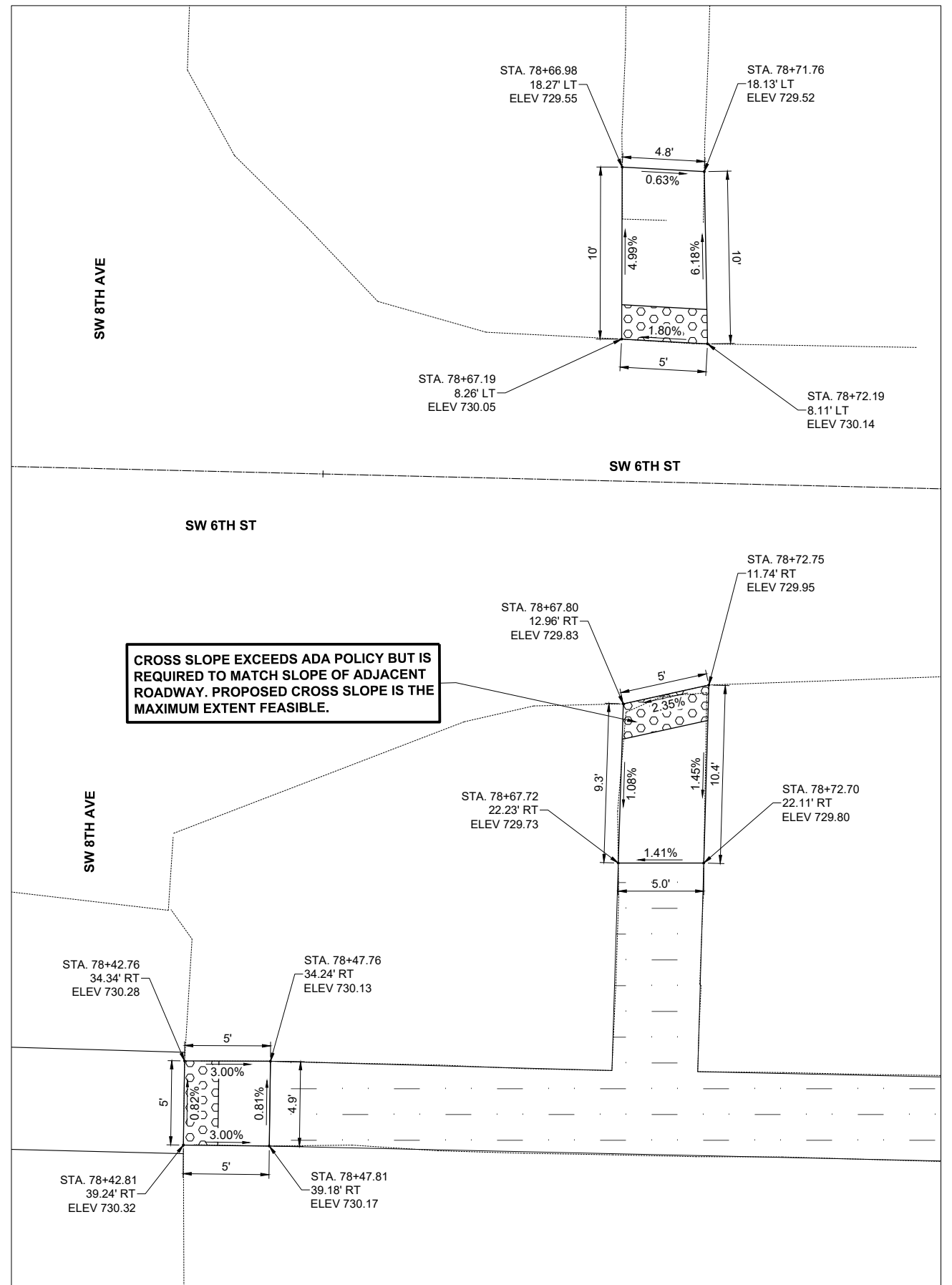
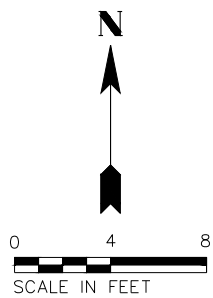

NE & SE RAMP - SW 6TH ST & SW 8TH AVE

V:\5555 - Aledo - SW 6th St. Sidewalk - PH I-III\CADD\CADD Sheets\5555-sht-ADA.dwg

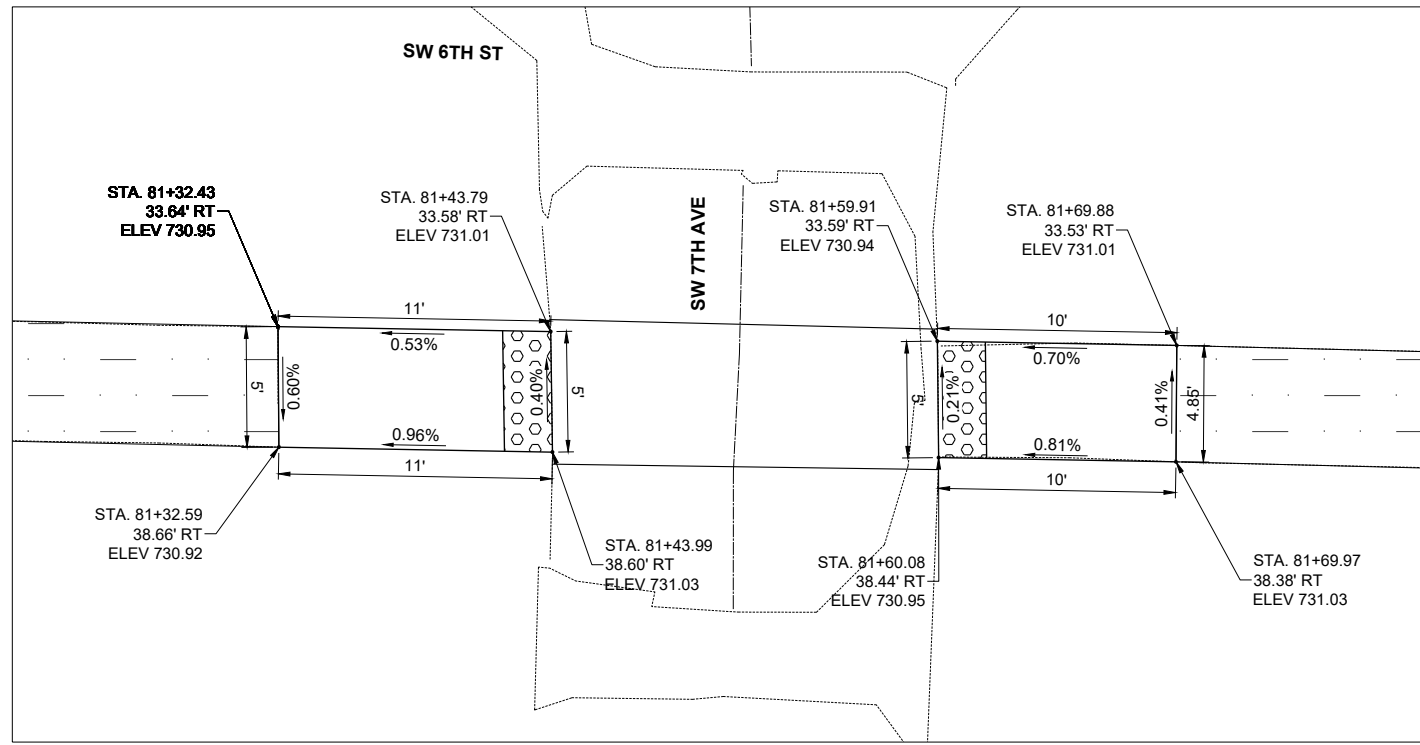

SW & SE RAMP - SW 6TH ST & SW 7TH AVE

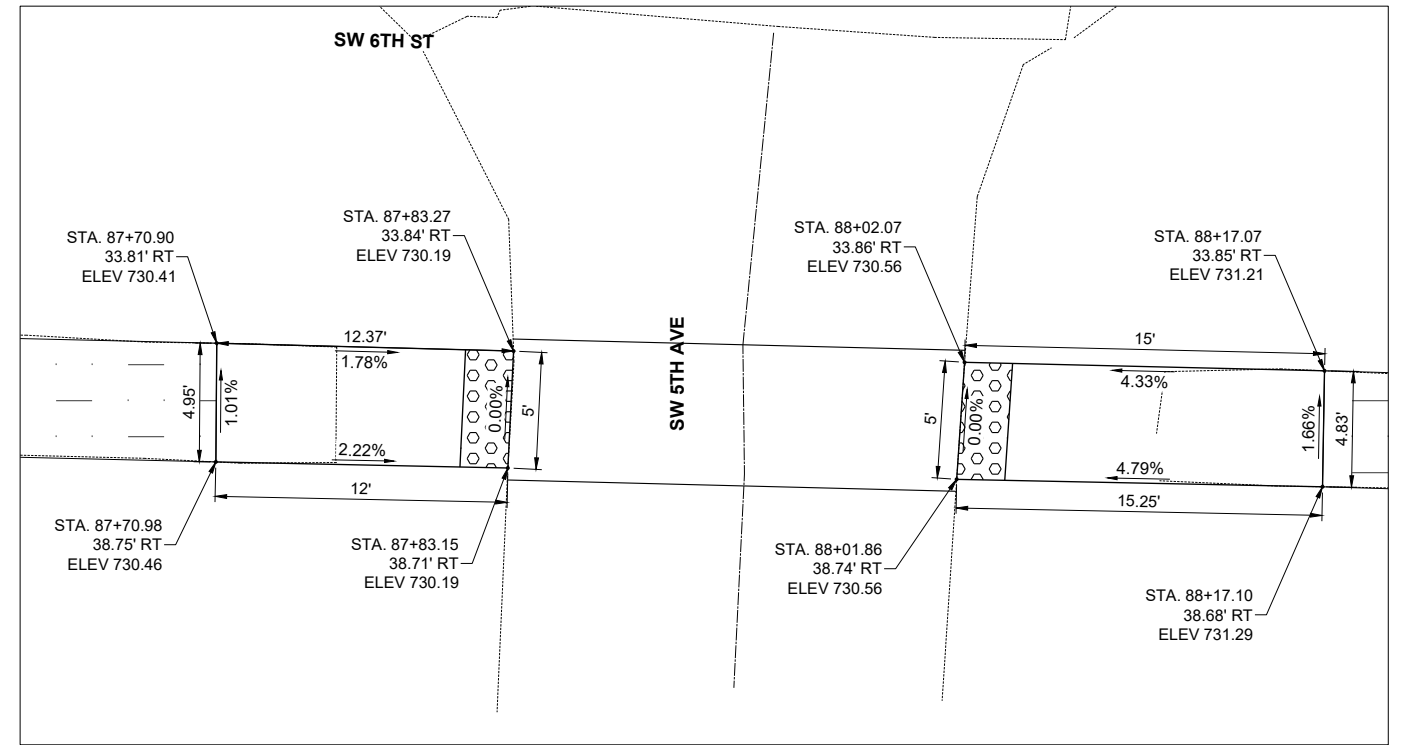

SW & SE RAMP - SW 6TH ST & SW 5TH AVE

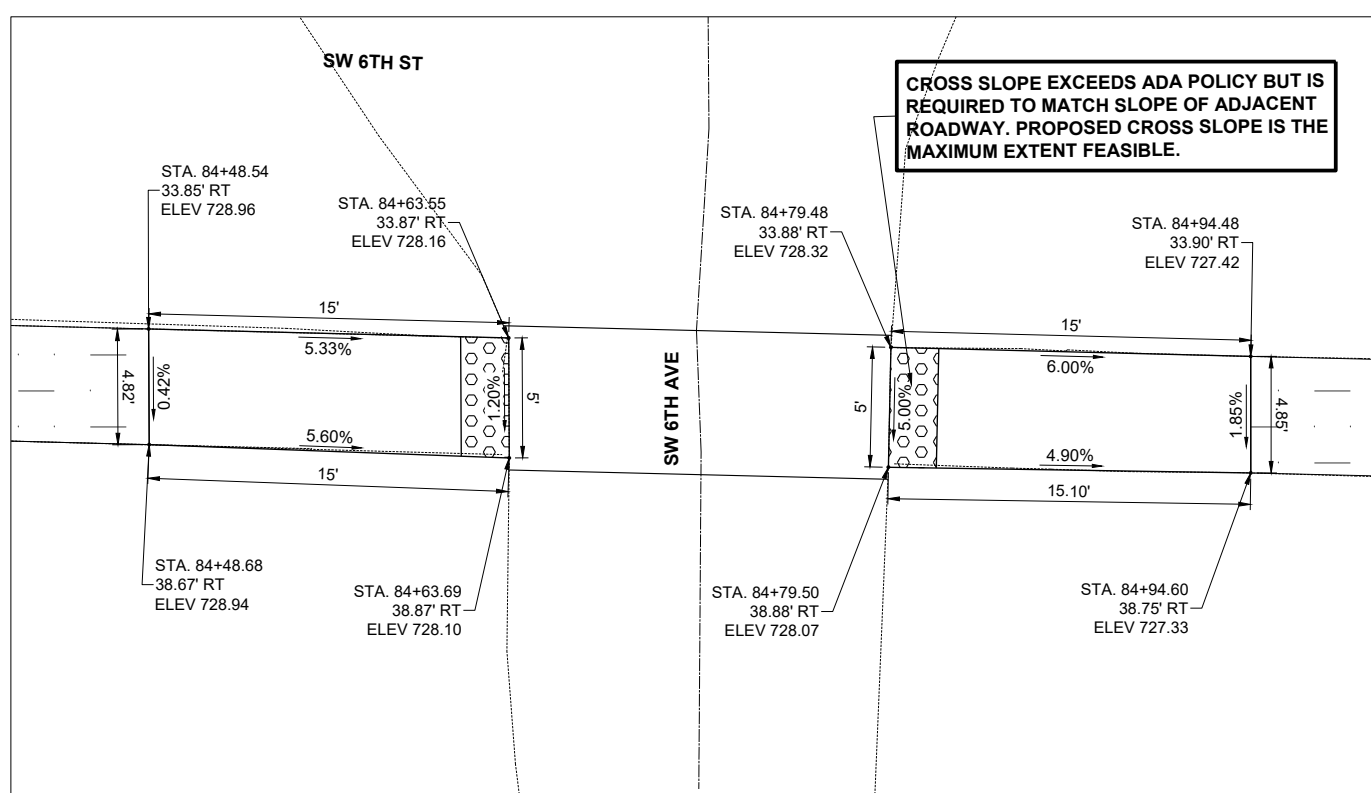
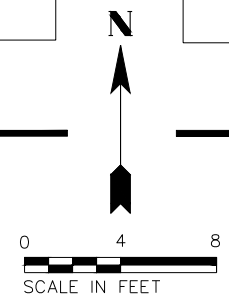

SW & SE RAMP - SW 6TH ST & SW 6TH AVE

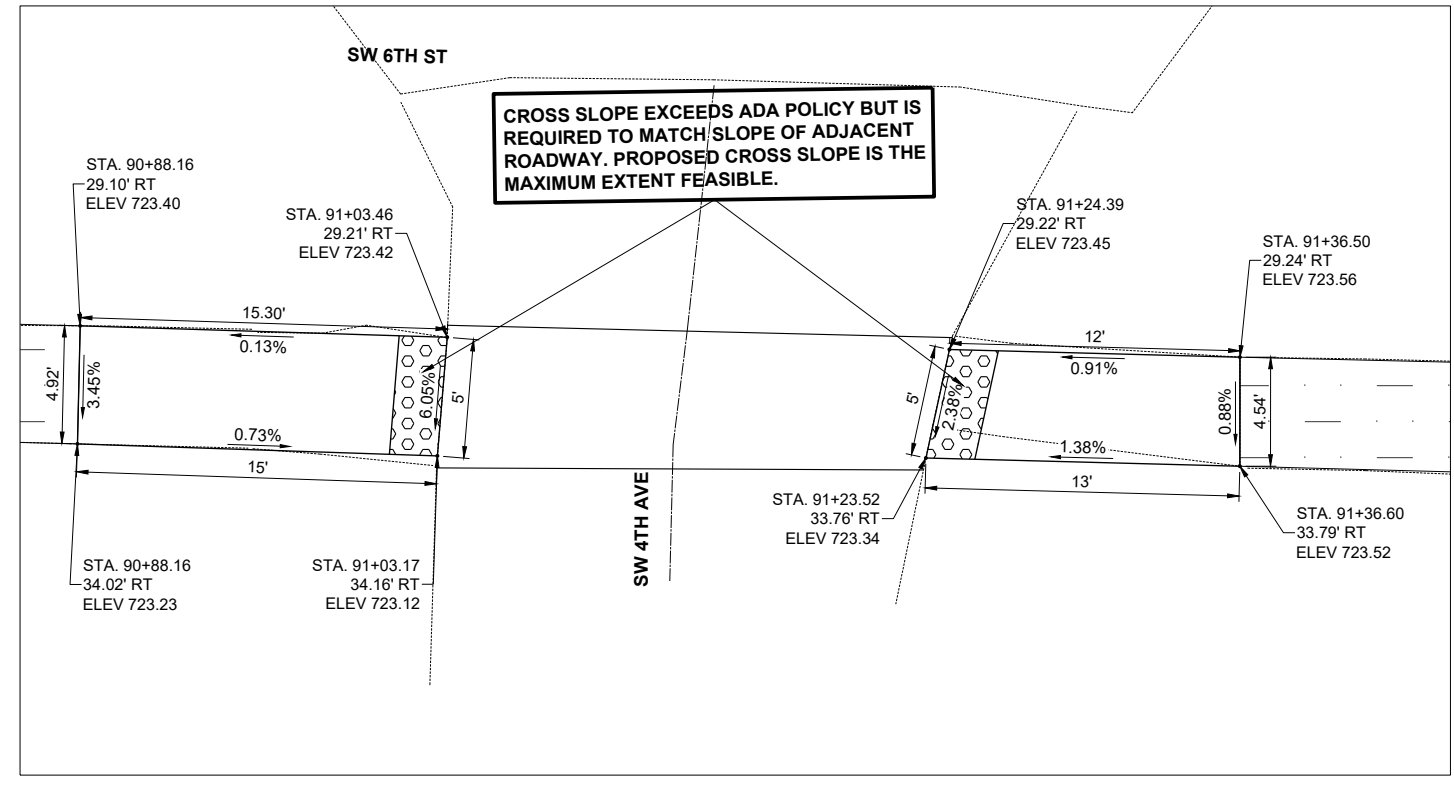

SW & SE RAMP - SW 6TH ST & SW 4TH AVE



DESIGNED --- DATE --- ##-##-25
 DRAWN MO
 CHECKED ---
 PROJECT #: 5555

SW 6TH ST SIDEWALK
 CONSTRUCTION



CITY OF ALEDO

ADA DETAILS

SHEET
 9 OF 11

V:\5555 - Aledo - SW 6th St. Sidewalk - PH I-III\CADD\CADD Sheets\5555-sht-ADA.dwg

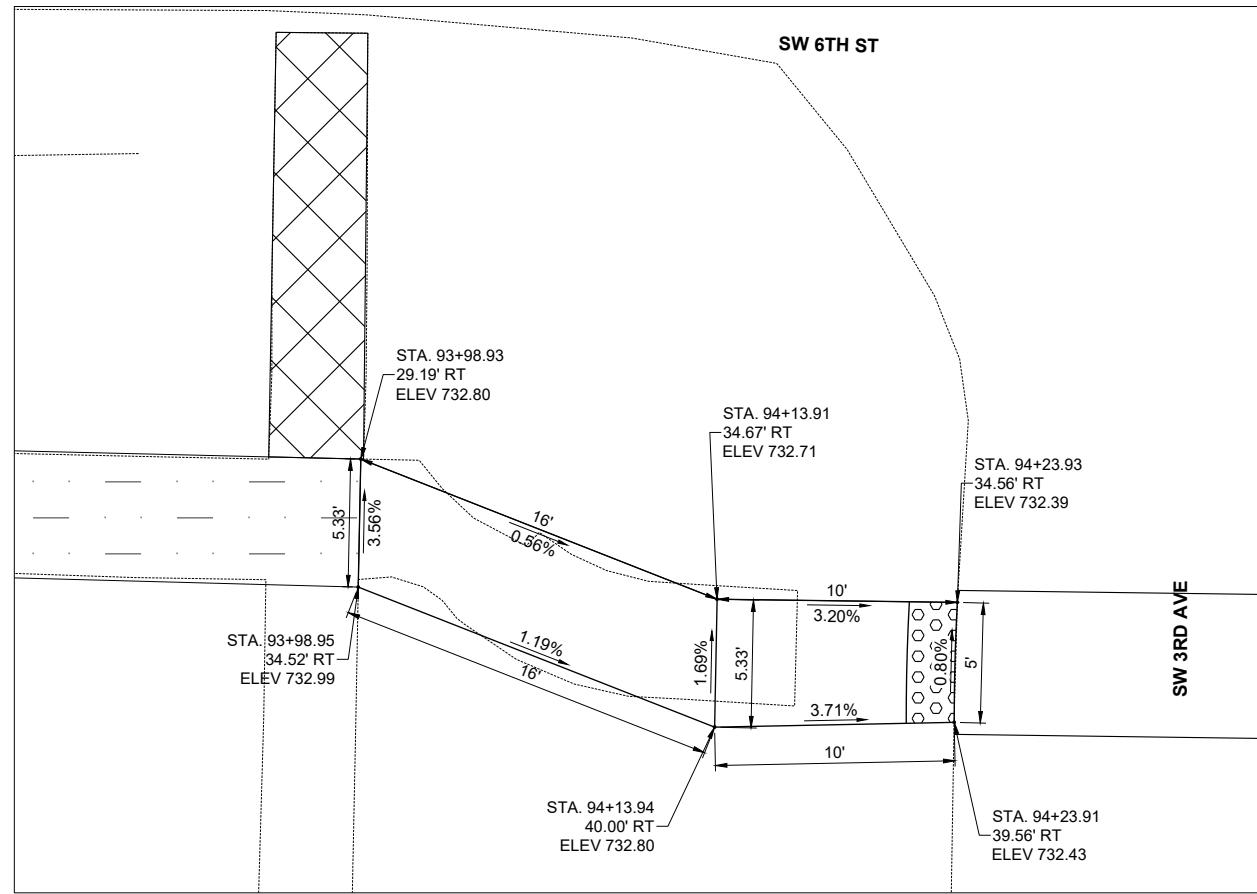

SW RAMP - SW 6TH ST & SW 3RD AVE

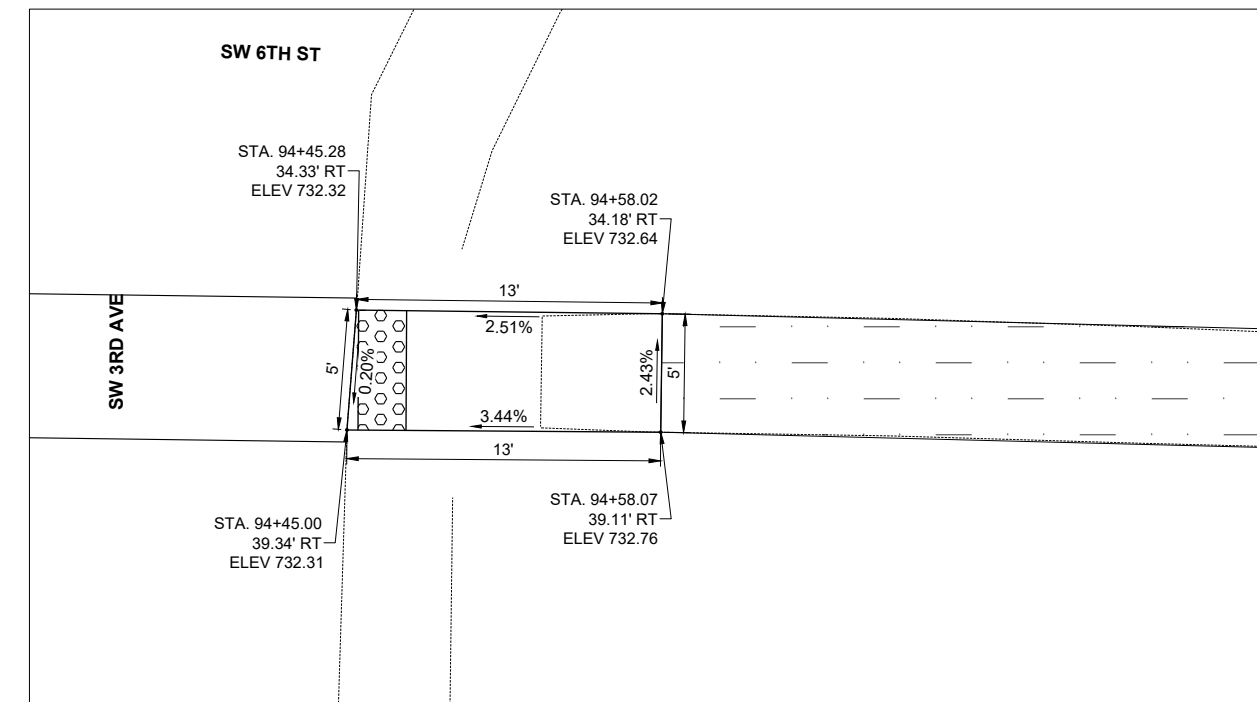

SE RAMP - SW 6TH ST & SW 3RD AVE

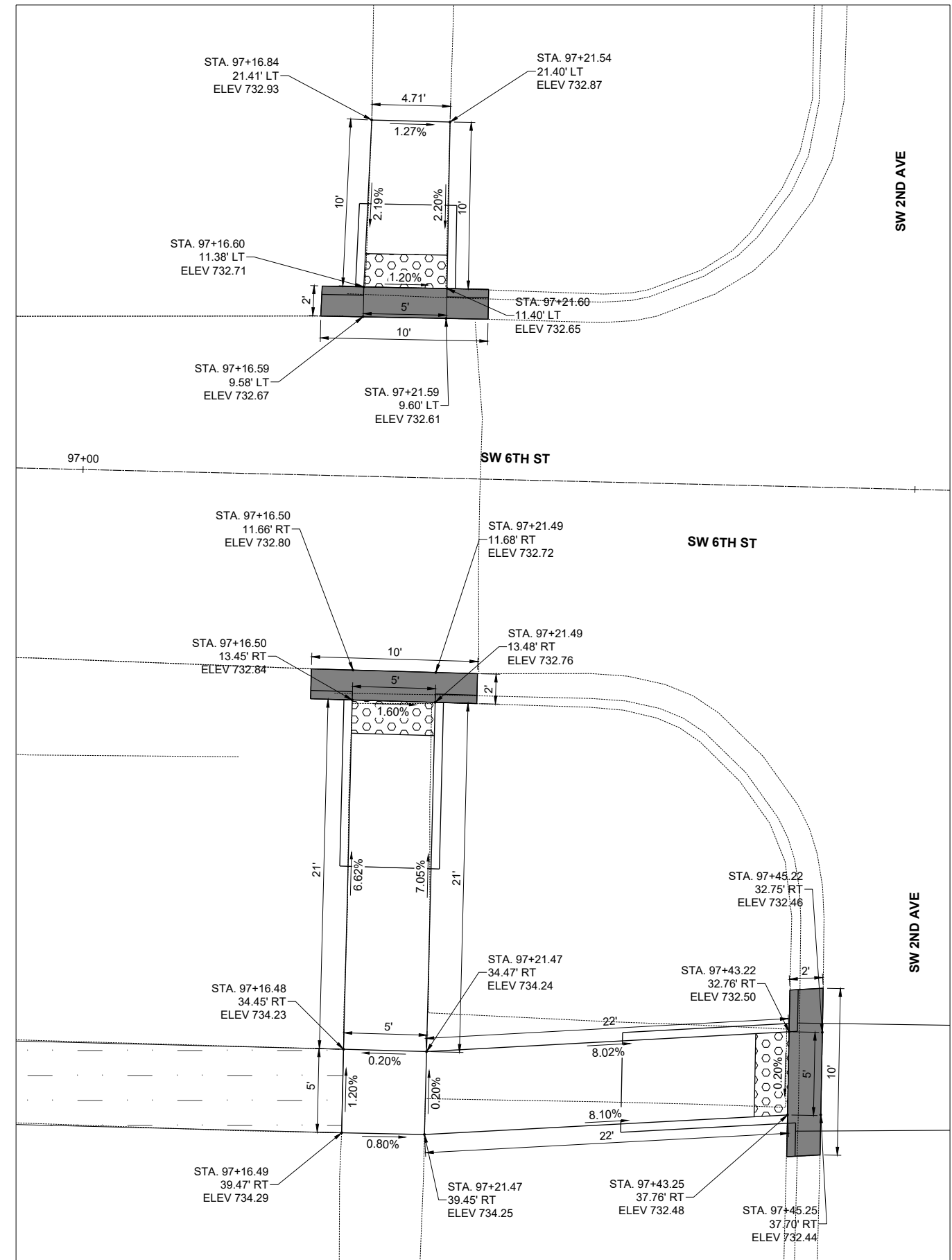

NW & SW RAMP - SW 6TH ST & SW 2ND AVE



DESIGNED	----	DATE	##-##-25
DRAWN	MO		
CHECKED	----		
PROJECT #	5555		

SW 6TH ST SIDEWALK
CONSTRUCTION



CITY OF ALEDO

ADA DETAILS

SHEET
10 OF 11

V:\5555 - Aledo - SW 6th St. Sidewalk - PH I-II\CADD\CADD Sheets\5555-sht-ADA.dwg

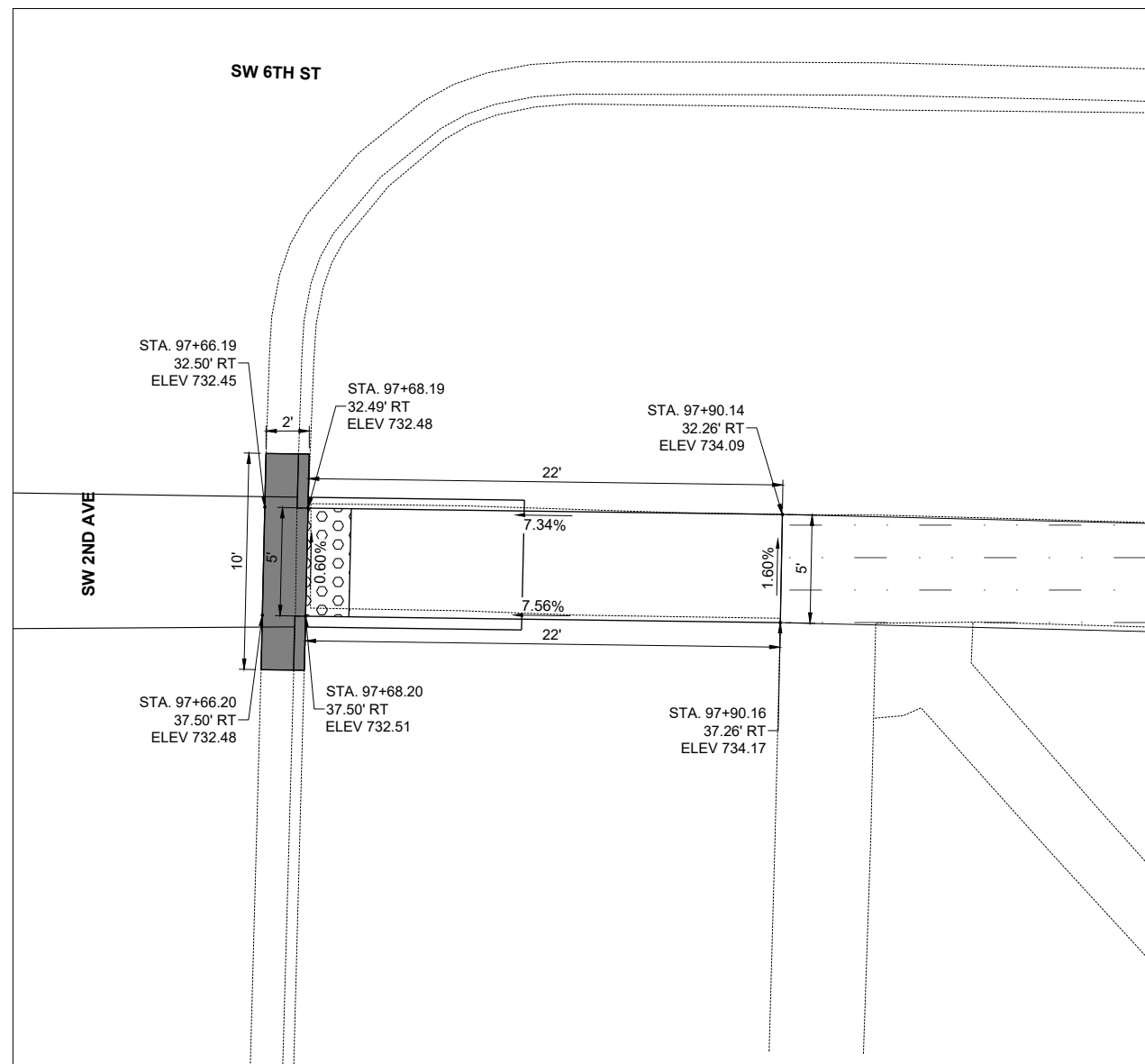

SE RAMP - SW 6TH ST & SW 2ND AVE