

STATE OF ILLINOIS
DEPARTMENT OF TRANSPORTATION

**PROPOSED
HIGHWAY PLANS**

FAP ROUTE 558 (ILL 100)
SECTION 120RS-3
PROJECT STP-8R0Y(977)
STANDARD OVERLAY
PIKE COUNTY

FOR INDEX OF SHEETS, SEE SHEET NO. 2

F.A.P. RTE.	SECTION	COUNTY	TOTAL SHEETS	SHEET NO.
558	120RS-3	PIKE	30	1
		ILLINOIS	CONTRACT NO. 72459	

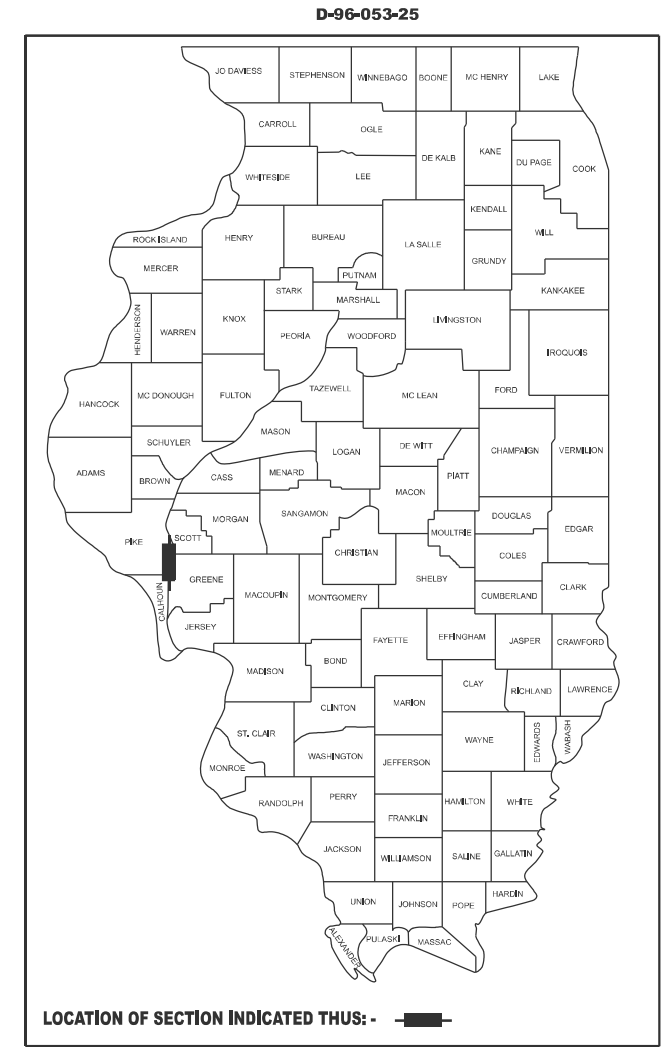

C-96-089-25

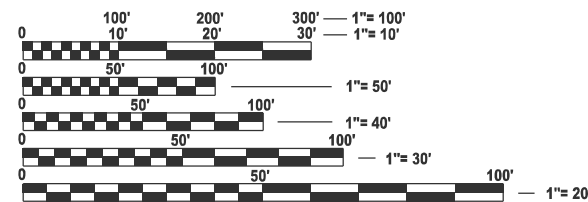
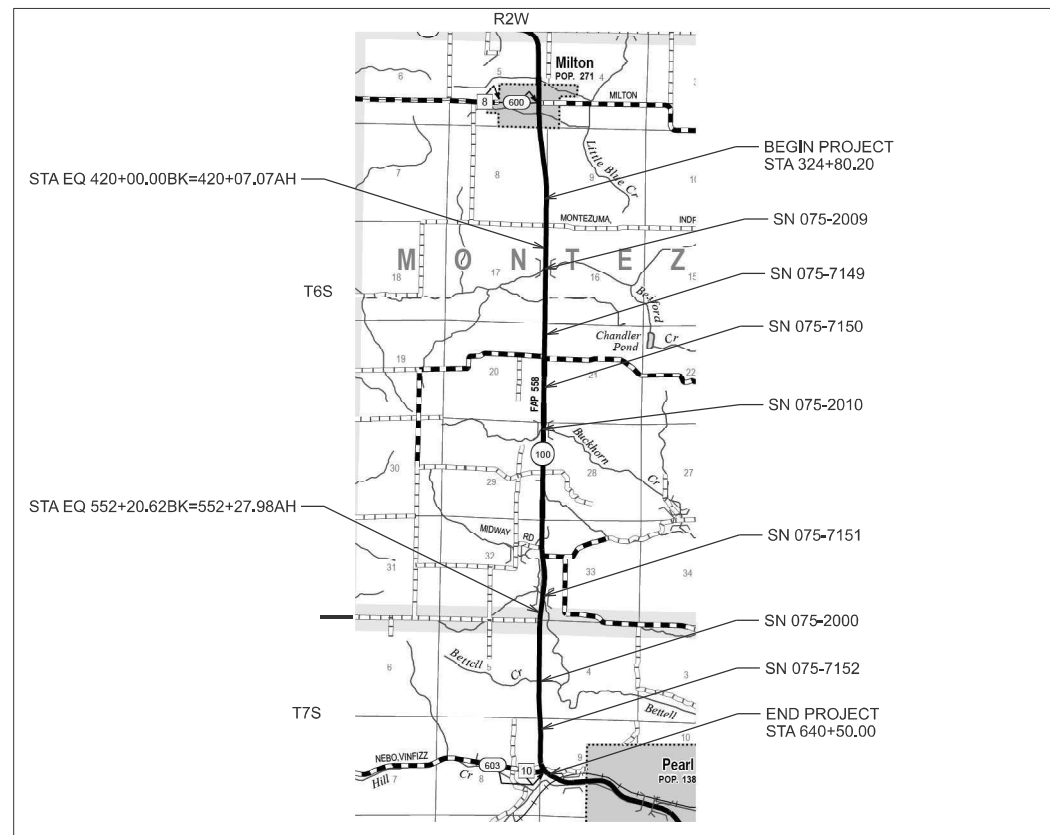

FULL SIZE PLANS HAVE BEEN PREPARED USING STANDARD ENGINEERING SCALES. REDUCED SIZED PLANS WILL NOT CONFORM TO STANDARD SCALES. IN MAKING MEASUREMENTS ON REDUCED PLANS, THE ABOVE SCALES MAY BE USED.

J.U.L.I.E.
JOINT UTILITY LOCATION INFORMATION FOR EXCAVATION
1-800-892-0123
OR 811

PROJECT ENGINEER - JON KELLEY - (217) 785-2739
PROJECT MANAGER - CHRIS SIEFERT - (217) 524-7940

GROSS LENGTH = 31530.37 FT. = 5.972 MILE
NET LENGTH = 31530.37 FT. = 5.972 MILE

CONTRACT NO. 72459

FUNCTIONAL CLASSIFICATION: MINOR ARTERIAL
ADT=725 (2025) - 185TH AVE TO 212TH AVE
MU=50, SU=70, PV=605.
ADT=500 (2025) - CH 10 TO 185TH AVE
MU=30, SU=40, PV=430.

STATE OF ILLINOIS
DEPARTMENT OF TRANSPORTATION

SUBMITTED March 17, 2026
Teresa C. Price
REGIONAL ENGINEER

May 8, 2026
Scott A. [Signature]
ENGINEER OF DESIGN AND ENVIRONMENT

May 8, 2026
[Signature]
DIRECTOR OF HIGHWAYS PROJECT IMPLEMENTATION

**PRINTED BY THE AUTHORITY
OF THE STATE OF ILLINOIS**

INDEX OF SHEETS

SHEET NO.	SHEET DESCRIPTION
1	COVER
2	GENERAL NOTES AND STANDARDS
3-4	SUMMARY OF QUANTITIES
5-9	TYPICAL SECTIONS
10-12	SCHEDULE OF QUANTITIES
13-14	ALIGNMENT TIES AND BENCHMARKS
15-25	PLAN SHEETS
26-30	DETAILS

GENERAL NOTES

1. THE CONTRACTOR SHALL NOTIFY THE DISTRICT 6 BUREAU OF OPERATIONS AT (217) 785-5306 THREE WEEKS PRIOR TO IMPLEMENTING TRAFFIC CONTROL.
2. NO PASSING ZONES SHALL BE FIELD VERIFIED AND DOCUMENTED BY THE RESIDENT ENGINEER. THE RESIDENT ENGINEER SHALL NOTIFY THE BUREAU OF OPERATIONS AT (217) 785-5306 IF THEY HAVE ANY CONCERNS WITH NO PASSING ZONES AND AT LEAST 14 DAYS PRIOR TO THE PLACEMENT OF FINAL PAVEMENT MARKINGS.
3. THE CONTRACTOR SHALL USE TYPE IV PAVEMENT MARKING TAPE AS SHORT-TERM PAVEMENT MARKING ON THE SURFACE LIFT.
4. THE MATERIAL USED FOR AGGREGATE WEDGE SHOULDERS, TYPE B SHALL BE CRUSHED STONE, CRUSHED CONCRETE, OR RAP.
5. THE MATERIAL USED FOR AGGREGATE SURFACE COURSE, TYPE B SHALL BE CRUSHED STONE OR CRUSHED CONCRETE.

MIXTURE REQUIRMENTS

LOCATION:	IL 100	IL 100	IL 100
MIXTURE USE:	HMA SURFACE COURSE	HMA SHLDS & INCIDENTAL HMA	HMA PATCHING
PG:	PG 58-28	PG 58-28	PG 64-22
DESIGN AIR VOIDS:	4.0% @ N50	4.0% @ N50	4.0% @ N50
MIXTURE COMPOSITION:	IL-9.5	IL-9.5	IL-19.0
FRICTION AGGREGATE:	MIX "C"	MIX "C"	N/A
MIXTURE WEIGHT:	112 LB/SY*IN	112 LB/SY*IN	112 LB/SY*IN
QUALITY MANAGFMENT:	QC/P	QC/QA	QC/QA
SUBLOT SIZE:	1000 TONS	N/A	N/A
MTD:	YES	NO	NO

COMMITMENTS

1. NONE

STANDARDS

NO.	DESCRIPTION
000001-09	STANDARD SYMBOLS, ABBREVIATIONS AND PATTERN
001006	DECIMAL OF AN INCH AND OF A FOOT
442201-04	CLASS C AND D PATCHES
701001-02	OFF ROAD OPERATIONS, 2L, 2W, MORE THAN 15' AWAY
701006-05	OFF ROAD OPERATIONS, 2L, 2W, 15' TO 24" FROM PAVEMENT EDGE
701011-04	OFF ROAD MOVING OPERATIONS 2L, 2W, DAY ONLY
701201-05	LANE CLOSURE, 2L 2W, DAY ONLY, FOR SPEEDS ≥ 45MPH
701301-04	LANE CLOSURE, 2L, 2W, SHORT TIME OPERATIONS
701306-04	LANE CLOSURE, 2L, 2W, SLOW MOVING OPERATIONS DAY ONLY, FOR SPEEDS ≥ 45MPH
701311-03	LANE CLOSURE, 2L, 2W, MOVING OPERATIONS DAY ONLY, FOR SPEEDS ≥ 45MPH
701901-11	TRAFFIC CONTROL DEVICES
780001-05	TYPICAL PAVEMENT MARKING
781001-04	TYPICAL APPLICATION OF RAISED REFLECTIVE PAVEMENT MARKERS

APPLICATION RATES

THE FOLLOWING RATES OF APPLICATION WERE UTILIZED TO CALCULATE QUANTITIES:
 BITUMINOUS MATERIALS (TACK COAT) 0.05 LB/SQ FT (EXISTING HMA SURFACES)
 HMA SURFACE 0.056 TONS/(SQ YD*IN)
 AGG SHOULDER 1.6 TONS/CU YD

**STATE OF ILLINOIS
DEPARTMENT OF TRANSPORTATION
DIVISION OF HIGHWAYS
DISTRICT 6**

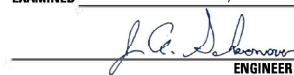
EXAMINED March 1, 20 26

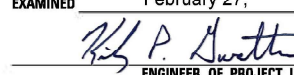
 ENGINEER OF OPERATIONS

EXAMINED February 27, 20 26

 ENGINEER OF PROJECT IMPLEMENTATION

EXAMINED March 4, 20 26

 ENGINEER OF PROGRAM DEVELOPMENT

MODEL: general details (Sheet)
FILE NAME: c:\p\work\pav\dist6\dist6\1105610172459.dgn_notes.dgn

USER NAME = Iryna.Tsymbalyuk	DESIGNED -	REVISED -
	DRAWN -	REVISED -
	CHECKED -	REVISED -
PLOT DATE = 3/4/2026	DATE -	REVISED -

**STATE OF ILLINOIS
DEPARTMENT OF TRANSPORTATION**

GENERAL NOTES

SCALE: SHEET 1 OF 1 SHEETS STA. TO STA.

F.A.P. RTE.	SECTION	COUNTY	TOTAL SHEETS	SHEET NO.
558	120RS-3	PIKE	30	2
CONTRACT NO. 72459				
ILLINOIS FED. AID PROJECT				

MODEL: Untitled (Sheet)
 FILE NAME: c:\p\work\pavdist\illinois.gov\iryna.tsymbalyuk\illinois.gov\d1103810\72459_S00.dgn

					6-60101-0000
					STP FUNDING 80% FEDERAL 20% STATE
CODE NO.	ITEM	UNIT	TOTAL QUANTITY	ROADWAY	
				0005	RURAL
20200100	EARTH EXCAVATION	CU YD	96	96	
40200800	AGGREGATE SURFACE COURSE, TYPE B	TON	4	4	
40600290	BITUMINOUS MATERIALS (TACK COAT)	POUND	39,573	39,573	
40600370	LONGITUDINAL JOINT SEALANT	FOOT	31,530	31,530	
40600405	MATERIAL TRANSFER DEVICE	TON	9,599	9,599	
40600982	HOT-MIX ASPHALT SURFACE REMOVAL - BUTT JOINT	SQ YD	260	260	
40600990	TEMPORARY RAMP	SQ YD	27	27	
40604050	HOT-MIX ASPHALT SURFACE COURSE, IL-9.5, MIX "C", N50	TON	9,599	9,599	
40800029	BITUMINOUS MATERIALS (TACK COAT)	POUND	312	312	
40800050	INCIDENTAL HOT-MIX ASPHALT SURFACING	TON	220	220	
44000155	HOT-MIX ASPHALT SURFACE REMOVAL, 1 1/2"	SQ YD	87,885	87,885	
44000200	DRIVEWAY PAVEMENT REMOVAL	SQ YD	129	129	
44200168	PAVEMENT PATCHING, TYPE II, 14 INCH	SQ YD	31	31	
44200172	PAVEMENT PATCHING, TYPE III, 14 INCH	SQ YD	129	129	

* - INDICATES PAY ITEM REQUIRES A SPECIAL PROVISION

USER NAME = Iryna.Tsymbalyuk	DESIGNED -	REVISED -
	DRAWN -	REVISED -
	CHECKED -	REVISED -
PLOT DATE = 3/10/2026	DATE -	REVISED -

**STATE OF ILLINOIS
DEPARTMENT OF TRANSPORTATION**

SUMMARY OF QUANTITIES

SCALE: SHEET 1 OF 2 SHEETS STA. TO STA.

F.A.P. RTE.	SECTION	COUNTY	TOTAL SHEETS	SHEET NO.
558	120RS-3	PIKE	30	3
			CONTRACT NO. 72459	
		ILLINOIS FED. AID PROJECT		

MODEL: Unlited-1 [Sheet]
 FILE NAME: c:\p\work\pav\illinois.gov_inna.tsymbolyuk@illinois.gov\1105810172459_S00.dgn

				6-60101-0000	
				STP FUNDING 80% FEDERAL 20% STATE	
CODE NO.	ITEM	UNIT	TOTAL QUANTITY	ROADWAY	
				0005	RURAL
44200174	PAVEMENT PATCHING, TYPE IV, 14 INCH	SQ YD	338	338	
48102100	AGGREGATE WEDGE SHOULDER, TYPE B	TON	379	379	
48203100	HOT-MIX ASPHALT SHOULDERS	TON	250	250	
67000400	ENGINEER'S FIELD OFFICE, TYPE A	CAL MO	6	6	
67100100	MOBILIZATION	L SUM	1	1	
70100450	TRAFFIC CONTROL AND PROTECTION, STANDARD 701201	L SUM	1	1	
70100460	TRAFFIC CONTROL AND PROTECTION, STANDARD 701306	L SUM	1	1	
70107025	CHANGEABLE MESSAGE SIGN	CAL DA	14	14	
70300100	SHORT TERM PAVEMENT MARKING	FOOT	5,737	5,737	
70300150	SHORT TERM PAVEMENT MARKING REMOVAL	SQ FT	1,911	1,911	
* 78001120	PAINT PAVEMENT MARKING - LINE 5"	FOOT	98,828	98,828	
* 78100100	RAISED REFLECTIVE PAVEMENT MARKER	EACH	395	395	
78300200	RAISED REFLECTIVE PAVEMENT MARKER REMOVAL	EACH	395	395	
Ø Z0076600	TRAINEES	HOUR	2000	2000	
* X4406812	PORTLAND CEMENT CONCRETE SURFACE REMOVAL 1 1/2"	SQ YD	55	55	
Ø Z0076604	TRAINEES TRAINING PROGRAM GRADUATE	HOUR	2000	2000	
* - INDICATES PAY ITEM REQUIRES A SPECIAL PROVISION					

* SPECIALTY ITEM
 Ø 0042

REV - MS

USER NAME = Iryna.Tsymbolyuk	DESIGNED -	REVISED -	STATE OF ILLINOIS DEPARTMENT OF TRANSPORTATION		SUMMARY OF QUANTITIES				F.A.P. RTE.	SECTION	COUNTY	TOTAL SHEETS	SHEET NO.
	DRAWN -	REVISED -							558	120RS-3	PIKE	30	4
	CHECKED -	REVISED -			SCALE:				CONTRACT NO. 72459				
PLOT DATE = 3/10/2026	DATE -	REVISED -			SHEET 2	OF 2	SHEETS	STA.	TO STA.	ILLINOIS FED. AID PROJECT			

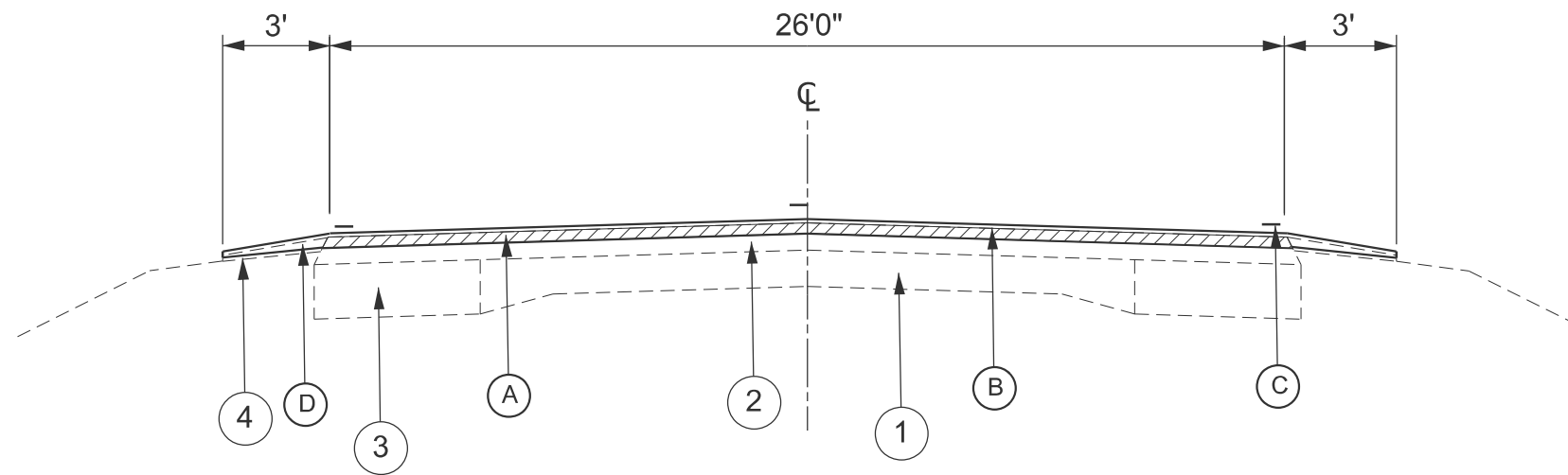

TYPICAL SECTION 1
 STA 324+80.20 TO 412+00.00
 STA 500+00.00 TO 517+50.00
 STA 533+89.00 TO 546+45.00

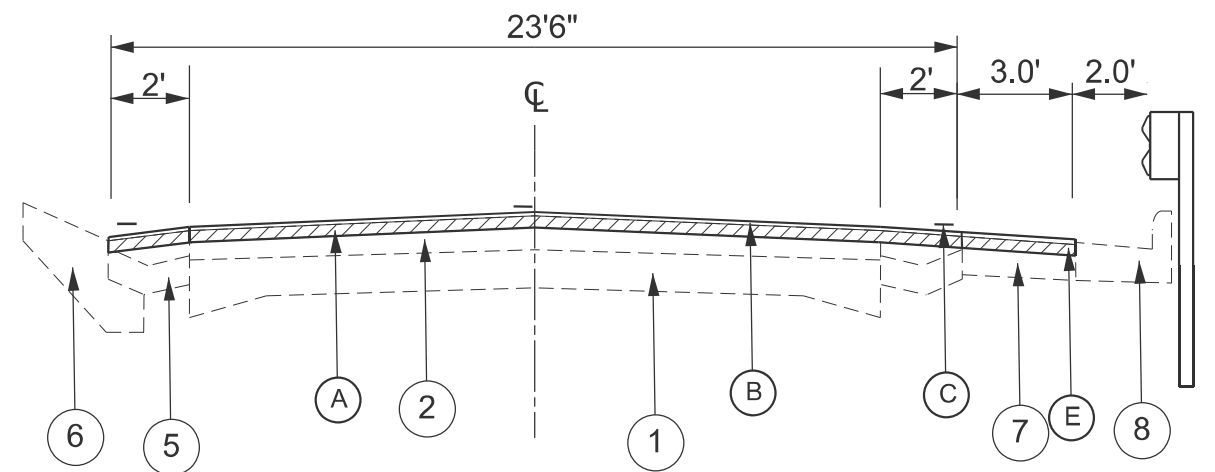

TYPICAL SECTION 3
 STA 418+75.00 TO 422+25.00
 STA 454+20.00 TO 454+70.00
 STA 459+30.00 TO 460+40.00

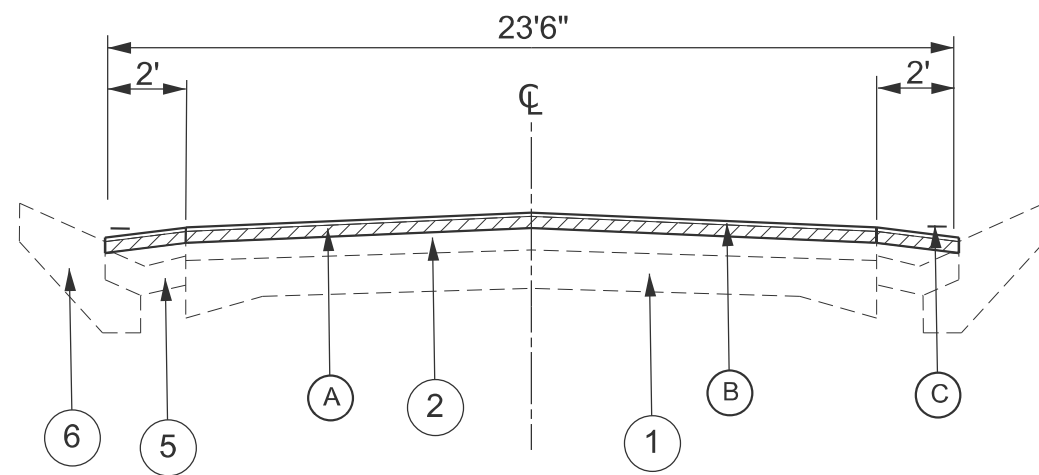

TYPICAL SECTION 2
 STA 412+00.00 TO 418+75.00
 STA 437+30.00 TO 448+40.00
 STA 454+70.00 TO 459+30.00
 STA 468+85.00 TO 478+17.00
 STA 487+11.15 TO 490+05.00
 STA 492+75.00 TO 500+00.00
 STA 517+50.00 TO 523+00.00
 STA 547+05.00 TO 552+75.00
 STA 554+70.00 TO 560+70.00
 STA 573+75.00 TO 583+75.00
 STA 593+00.00 TO 618+00.00

LEGEND

- ① EX. PCC PAVEMENT 9"-6"-9"
- ② EX. BITUMINOUS CONCRETE 4 3/4"
- ③ EX. BITUMINOUS CONCRETE WIDENING 9"
- ④ EX. AGGREGATE SHOULDER, TYPE B
- ⑤ EX. GUTTER
- ⑥ EX. PIGGYBACK GUTTER
- ⑦ EX. BITUMINOUS SHOULDER
- ⑧ EX. CONCRETE CURB & GUTTER B-6.24
- (A) PR. HMA SURFACE REMOVAL 1 1/2"
- (B) PR. HMA SURFACE COURSE 2"
- (C) PR. PAVEMENT MARKING
- (D) PR. AGGREGATE SHOULDER
- (E) PR. HMA SHOULDER 2"

MODEL: Untitled (Sheet)
 FILE NAME: c:\p\work\pav\illinois.gov\irna.tsymalyuk\illinois.gov\d1105810\72459_typicals.dgn

USER NAME = Iryna.Tsymalyuk	DESIGNED -	REVISED -
	DRAWN -	REVISED -
	CHECKED -	REVISED -
PLOT DATE = 12/23/2025	DATE -	REVISED -

**STATE OF ILLINOIS
 DEPARTMENT OF TRANSPORTATION**

TYPICAL SECTIONS

SCALE: SHEET 1 OF 5 SHEETS STA. TO STA.

F.A.P. RTE.	SECTION	COUNTY	TOTAL SHEETS	SHEET NO.
558	120RS-3	PIKE	30	5
CONTRACT NO. 72459				
ILLINOIS FED. AID PROJECT				

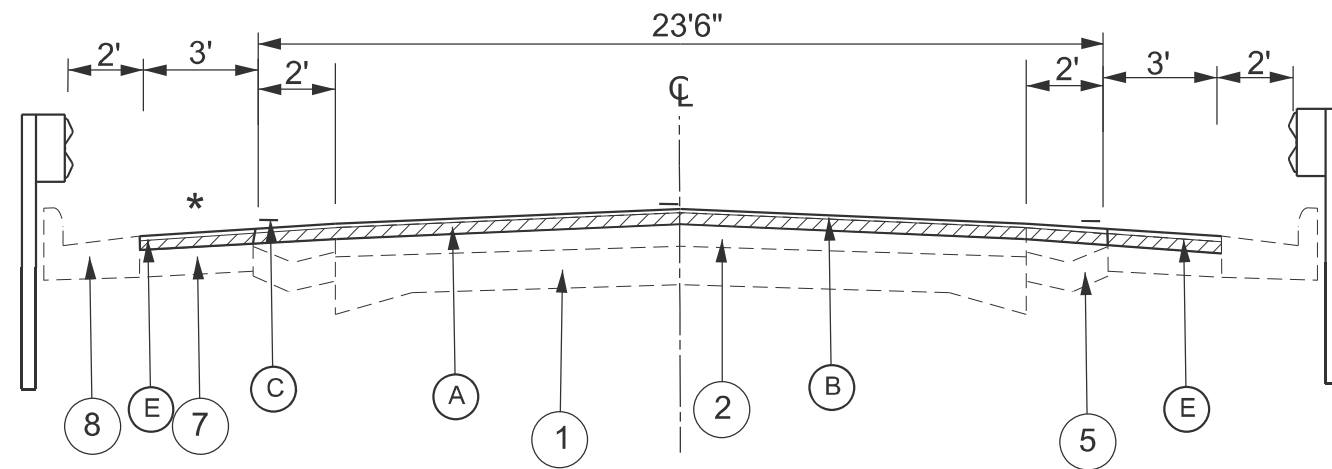

TYPICAL SECTION 4
 STA 422+25.00 TO 424+50.00
 STA 449+00.00 TO 454+20.00
 STA 460+40.00 TO 468+85.00
 STA 490+05.00 TO 492+75.00

*
 PCC REMOVAL 1 1/2" (SEE SCHEDULE)
 STA 490+05.00 TO 490+20.00
 STA 490+84.19 TO 491+66.34

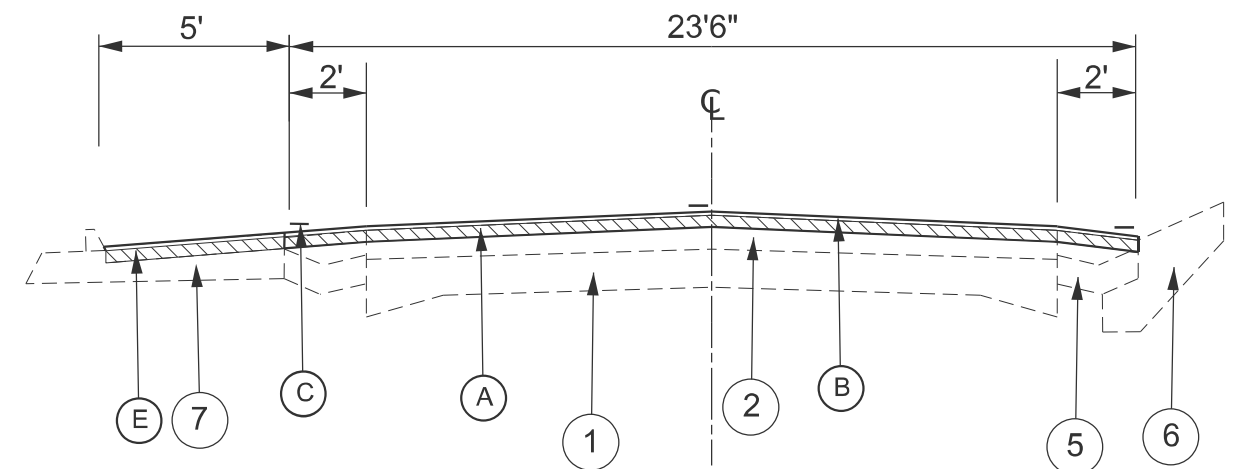

TYPICAL SECTION 6
 STA 426+24.00 TO 429+15.00

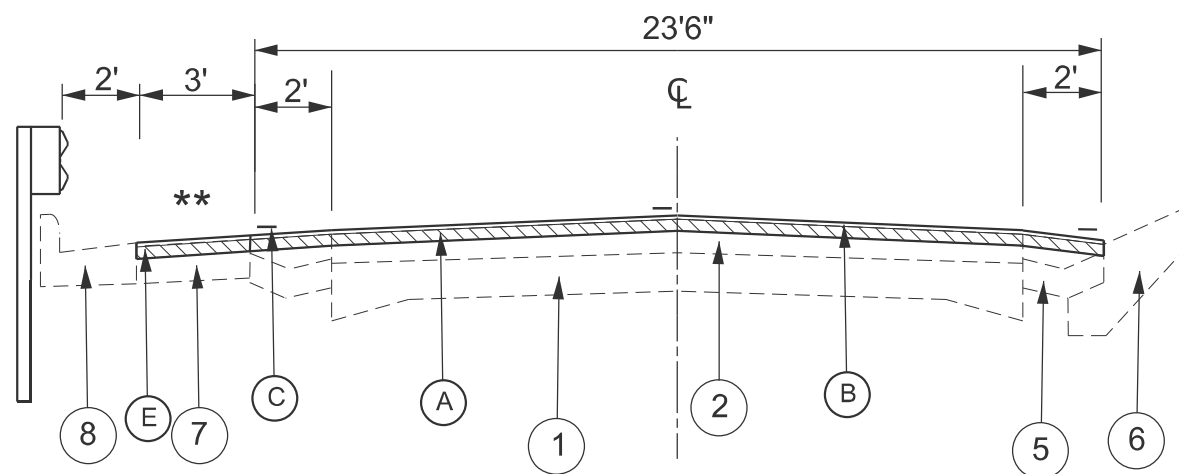

TYPICAL SECTION 5
 STA 424+50.00 TO 426+24.00
 STA 429+15.00 TO 437+30.00
 STA 448+40.00 TO 449+00.00
 STA 478+17.00 TO 487+11.15

**
 PCC REMOVAL 1 1/2" (SEE SCHEDULE)
 STA 486+56.15 TO STA 487+11.15

LEGEND

- ① EX. PCC PAVEMENT 9"-6"-9"
- ② EX. BITUMINOUS CONCRETE 4 3/4"
- ③ EX. BITUMINOUS CONCRETE WIDENING 9"
- ④ EX. AGGREGATE SHOULDER, TYPE B
- ⑤ EX. GUTTER
- ⑥ EX. PIGGYBACK GUTTER
- ⑦ EX. BITUMINOUS SHOULDER
- ⑧ EX. CONCRETE CURB & GUTTER B-6.24
- (A) PR. HMA SURFACE REMOVAL 1 1/2"
- (B) PR. HMA SURFACE COURSE 2"
- (C) PR. PAVEMENT MARKING
- (D) PR. AGGREGATE SHOULDER
- (E) PR. HMA SHOULDER 2"

MODEL: Unlited-1 [Sheet]
 FILE NAME: c:\p\work\pav\illinois.gov\irna.tsymalyuk\illinois.gov\1103810\72459_typicals.dgn

USER NAME = Iryna.Tsymalyuk	DESIGNED -	REVISED -
	DRAWN -	REVISED -
	CHECKED -	REVISED -
PLOT DATE = 12/9/2025	DATE -	REVISED -

STATE OF ILLINOIS
DEPARTMENT OF TRANSPORTATION

TYPICAL SECTIONS

SCALE: SHEET 2 OF 5 SHEETS STA. TO STA.

F.A.P. RTE.	SECTION	COUNTY	TOTAL SHEETS	SHEET NO.
558	120RS-3	PIKE	30	6
CONTRACT NO. 72459				
ILLINOIS FED. AID PROJECT				

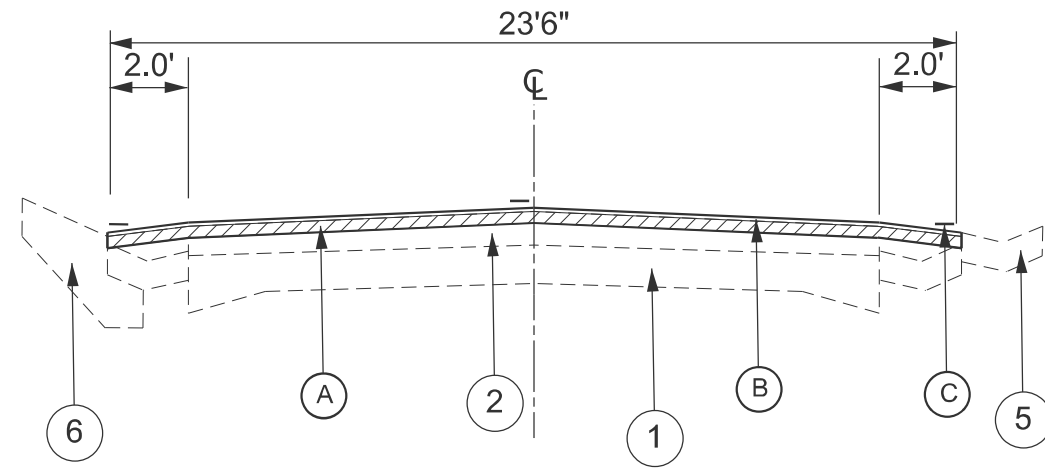

TYPICAL SECTION 7
 STA 523+00.00 TO 523+40.00
 STA 583+75.00 TO 583+80.00
 STA 618+00.00 TO 619+00.00
 STA 623+30.00 TO 632+50.00

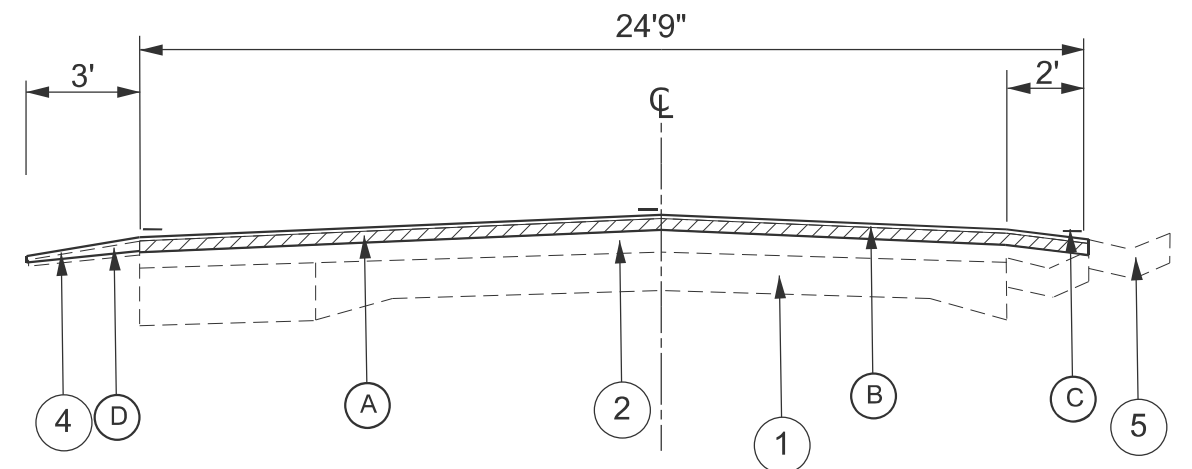

TYPICAL SECTION 9
 STA 527+30.00 TO 532+15.00

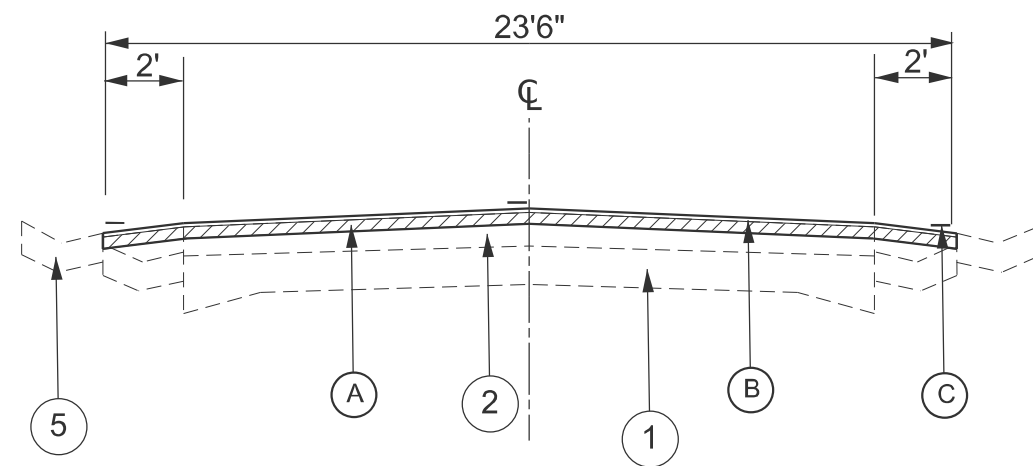

TYPICAL SECTION 8
 STA 523+40.00 TO 527+30.00
 STA 552+75.00 TO 554+70.00
 STA 567+00.00 TO 573+27.00
 STA 583+75.00 TO 593+00.00
 STA 619+00.00 TO 623+30.00

LEGEND

- ① EX. PCC PAVEMENT 9"-6"-9"
- ② EX. BITUMINOUS CONCRETE 4 3/4"
- ③ EX. BITUMINOUS CONCRETE WIDENING 9"
- ④ EX. AGGREGATE SHOULDER, TYPE B
- ⑤ EX. GUTTER
- ⑥ EX. PIGGYBACK GUTTER
- ⑦ EX. BITUMINOUS SHOULDER
- ⑧ EX. CONCRETE CURB & GUTTER B-6.24
- (A) PR. HMA SURFACE REMOVAL 1 1/2"
- (B) PR. HMA SURFACE COURSE 2"
- (C) PR. PAVEMENT MARKING
- (D) PR. AGGREGATE SHOULDER
- (E) PR. HMA SHOULDER 2"

MODEL: Unlitled-2 [Sheet]
 FILE NAME: c:\p\work\pav\illinois.gov\irna\tsymbalyuk\illinois.gov\d1105810\72459_typicals.dgn

USER NAME = Iryna.Tsymbalyuk	DESIGNED -	REVISED -
	DRAWN -	REVISED -
	CHECKED -	REVISED -
PLOT DATE = 12/9/2025	DATE -	REVISED -

STATE OF ILLINOIS
DEPARTMENT OF TRANSPORTATION

TYPICAL SECTIONS

SCALE: SHEET 3 OF 5 SHEETS STA. TO STA.

F.A.P. RTE.	SECTION	COUNTY	TOTAL SHEETS	SHEET NO.
558	120RS-3	PIKE	30	7
CONTRACT NO. 72459				
ILLINOIS FED. AID PROJECT				

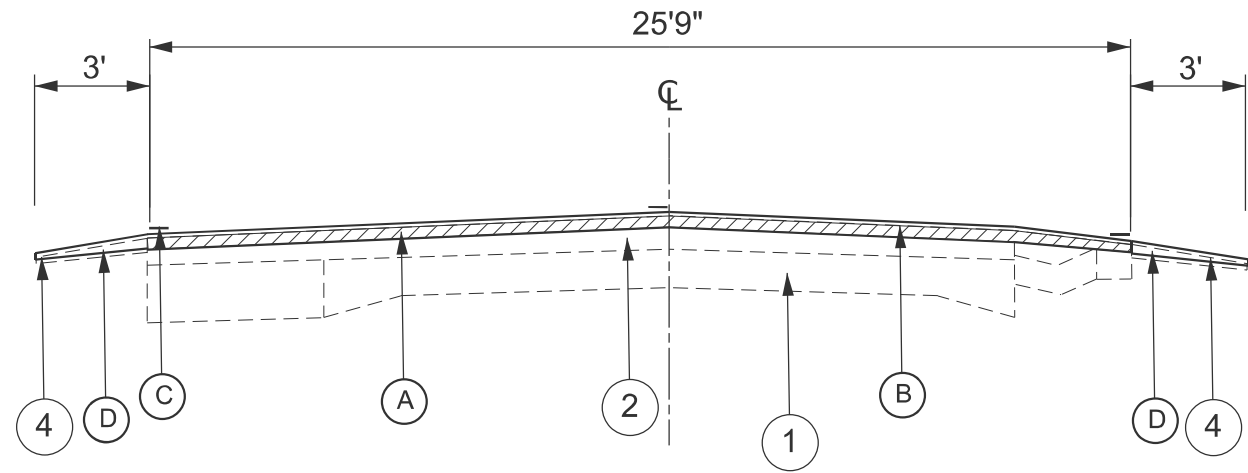

TYPICAL SECTION 10
STA 532+15.00 to 533+89.00

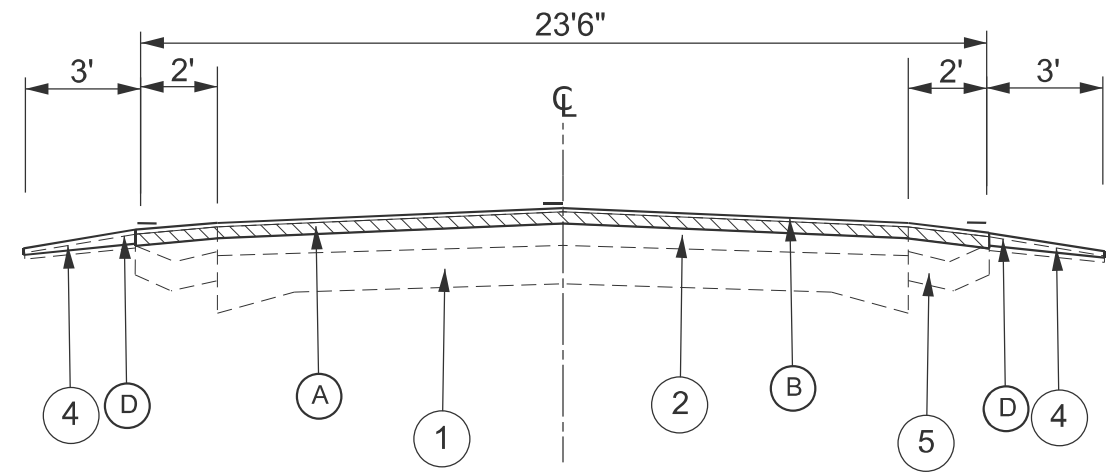

TYPICAL SECTION 12
STA 560+70.00 to 567+00.00
STA 638+20.00 to 640+50.00

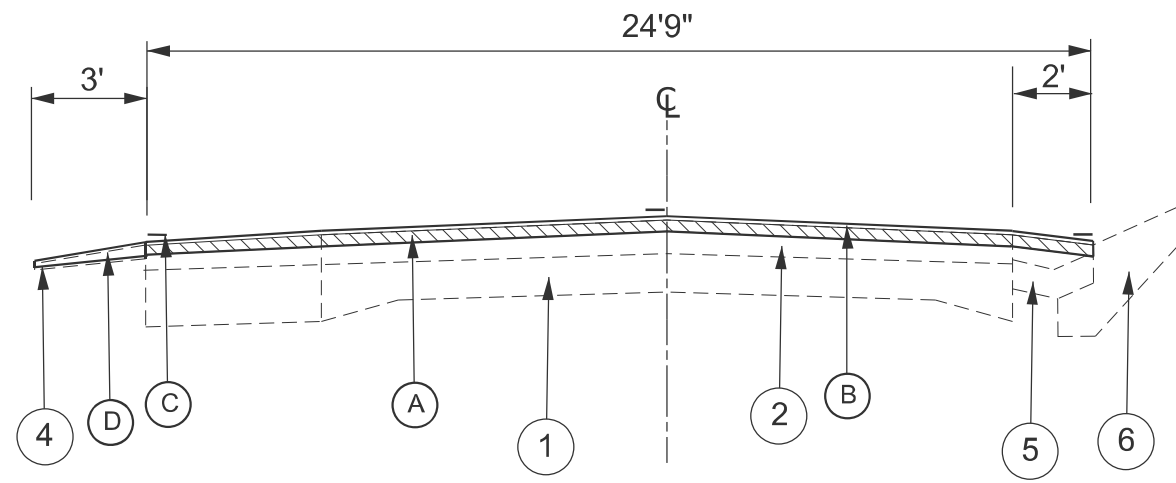

TYPICAL SECTION 11
STA 546+45.00 to 547+05.00

LEGEND

- ① EX. PCC PAVEMENT 9"-6"-9"
- ② EX. BITUMINOUS CONCRETE 4 3/4"
- ③ EX. BITUMINOUS CONCRETE WIDENING 9"
- ④ EX. AGGREGATE SHOULDER, TYPE B
- ⑤ EX. GUTTER
- ⑥ EX. PIGGYBACK GUTTER
- ⑦ EX. BITUMINOUS SHOULDER
- ⑧ EX. CONCRETE CURB & GUTTER B-6.24
- (A) PR. HMA SURFACE REMOVAL 1 1/2"
- (B) PR. HMA SURFACE COURSE 2"
- (C) PR. PAVEMENT MARKING
- (D) PR. AGGREGATE SHOULDER
- (E) PR. HMA SHOULDER 2"

MODEL: Unlited-3 [Sheet]
FILE NAME: c:\p\work\pav\illinois.gov_inna.tsymalyuk\illinois.gov\1105810\72459_typicals.dgn

USER NAME = Iryna.Tsymalyuk	DESIGNED -	REVISED -
	DRAWN -	REVISED -
	CHECKED -	REVISED -
PLOT DATE = 12/9/2025	DATE -	REVISED -

**STATE OF ILLINOIS
DEPARTMENT OF TRANSPORTATION**

TYPICAL SECTIONS

SCALE: SHEET 4 OF 5 SHEETS STA. TO STA.

F.A.P. RTE.	SECTION	COUNTY	TOTAL SHEETS	SHEET NO.
558	120RS-3	PIKE	30	8
CONTRACT NO. 72459				
ILLINOIS FED. AID PROJECT				

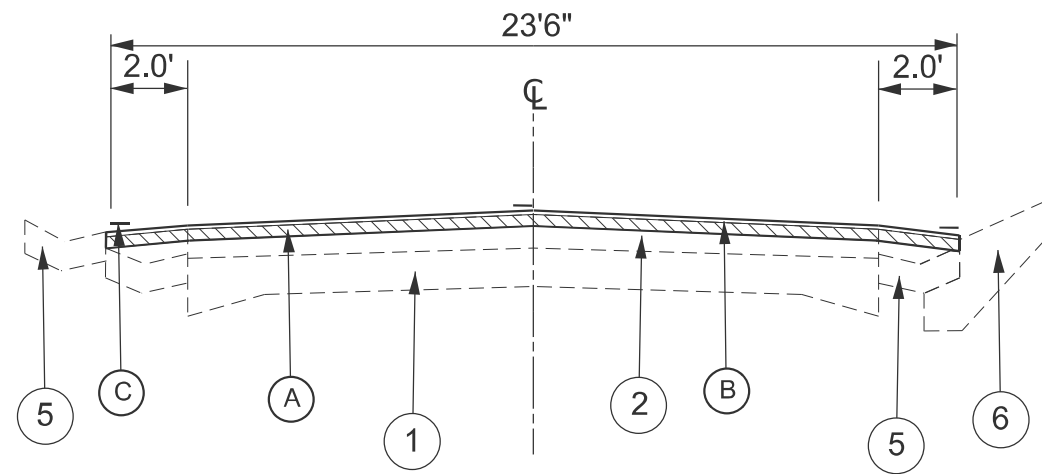

TYPICAL SECTION 13
STA 573+27.00 to 573+75.00

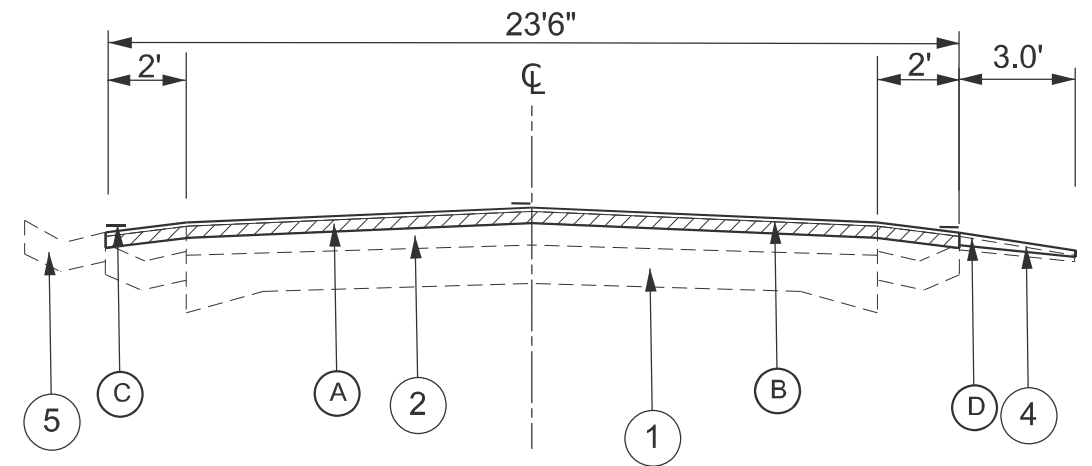

TYPICAL SECTION 15
STA 637+20.00 to 638+20.00

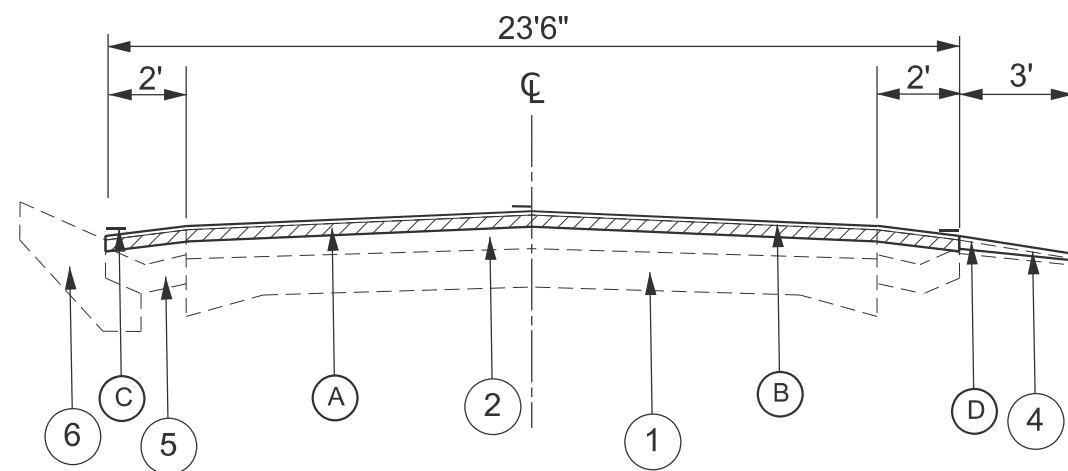

TYPICAL SECTION 14
STA 632+50.00 to 637+20.00

LEGEND

- ① EX. PCC PAVEMENT 9"-6"-9"
- ② EX. BITUMINOUS CONCRETE 4 3/4"
- ③ EX. BITUMINOUS CONCRETE WIDENING 9"
- ④ EX. AGGREGATE SHOULDER, TYPE B
- ⑤ EX. GUTTER
- ⑥ EX. PIGGYBACK GUTTER
- ⑦ EX. BITUMINOUS SHOULDER
- ⑧ EX. CONCRETE CURB & GUTTER B-6.24
- Ⓐ PR. HMA SURFACE REMOVAL 1 1/2"
- Ⓑ PR. HMA SURFACE COURSE 2"
- Ⓒ PR. PAVEMENT MARKING
- Ⓓ PR. AGGREGATE SHOULDER
- Ⓔ PR. HMA SHOULDER 2"

MODEL: Unlited.dwg (Sheet)
FILE NAME: c:\p\work\pav\illinois.gov\iryna.tsymbalyuk\illinois.gov\1103810\72459_typicals.dgn

USER NAME = Iryna.Tsymbalyuk	DESIGNED -	REVISED -
	DRAWN -	REVISED -
	CHECKED -	REVISED -
PLOT DATE = 12/9/2025	DATE -	REVISED -

STATE OF ILLINOIS
DEPARTMENT OF TRANSPORTATION

TYPICAL SECTIONS

SCALE: SHEET 5 OF 5 SHEETS STA. TO STA.

F.A.P. RTE.	SECTION	COUNTY	TOTAL SHEETS	SHEET NO.
558	120RS-3	PIKE	30	9
CONTRACT NO. 72459				
ILLINOIS FED. AID PROJECT				

MAINLINE REMOVAL SCHEDULE

STA.			STA.		WIDTH (FOOT)	LENGTH (FOOT)	4400155 HMA SURF REM, 1 1/2" (SQ YD)
324+80.20		to	412+00.00		26.00	8,720	25,191
412+00.00		to	420+00.00		23.50	800	2,089
STA EQ 420+00.00BK=420+07.07AH							
420+07.07		to	500+00.00		23.50	7993	20,870
500+00.00		to	517+50.00		26.00	1750	5,056
517+50.00		to	527+30.00		23.50	980	2,559
527+30.00		to	532+15.00		24.75	485	1,334
532+15.00		to	533+89.00		25.75	174	498
533+89.00		to	546+45.00		26.00	1256	3,628
546+45.00		to	547+05.00		24.75	60	165
547+05.00		to	552+20.62		23.50	516	1,346
STA EQ 552+20.62BK=552+27.98AH							
552+27.98		to	552+75.00		23.50	47	123
552+75.00		to	640+25.00		23.50	8,750	22,847
TOTAL						31,530	85,706

SHOULDER REMOVAL

STA.			STA.		WIDTH (FOOT)	LENGTH (FOOT)	4400155 HMA SURF REM, 1 1/2" (SQ YD)	X4406812 PCC SURF REM, 1 1/2" (SQ YD)
RIGHT								
418+75.00			420+00.00		3	125	42	
STA EQ 420+00.00BK=420+07.07AH								
420+07.07			424+50.00		3	443	148	
449+00.00			454+70.00		3	570	190	
459+30.00			468+85.00		3	955	318	
490+05.00			492+75.00		3	270	90	
LEFT								
422+25.00			426+24.00		3	399	133	
426+24.00			429+15.00		5	291	162	
429+15.00			437+30.00		3	815	272	
448+40.00			454+70.00		3	630	210	
460+40.00			468+85.00		3	845	282	
478+17.00			486+56.15		3	839	280	
486+56.15			487+11.15		3	55		18
490+05.00			490+33.23		3	28		9
490+33.23			490+84.19		3	51	17	
490+84.19			491+66.34		3	82		27
491+66.34			492+75.00		3	109	36	
TOTAL							2179	55

PAVING SCHEDULE

STA.			STA.		WIDTH (FOOT)	LENGTH (FOOT)	40600290 BIT MATLS, (TACK COAT) (POUND)	40600370 LONGITUDINAL JOINT SEALANT, (FOOT)	40604050 HMA SURF CRS 2", IL 9.5, MIX "C", N50 (TON)	40600990 TEMP RAMP, (SQYD)
324+80.20		to	412+00.00		26.00	8720	11336	8720	2821	14
412+00.00		to	420+00.00		23.50	800	940	800	234	
STA EQ 420+00.00BK=420+07.07AH										
420+07.07		to	500+00.00		23.50	7993	9392	7993	2337	
500+00.00		to	517+50.00		26.00	1750	2275	1750	566	
517+50.00		to	527+30.00		23.50	980	1152	980	287	
527+30.00		to	532+15.00		24.75	485	600	485	149	
532+15.00		to	533+89.00		25.75	174	224	174	56	
533+89.00		to	546+45.00		26.00	1256	1633	1256	406	
546+45.00		to	547+05.00		24.75	60	74	60	18	
547+05.00		to	552+20.62		23.50	516	606	516	151	
STA EQ 552+20.62BK=552+27.98AH										
552+27.98		to	552+75.00		23.50	47	55	47	14	
552+75.00		to	640+25.00		23.50	8750	10281	8750	2559	13
TOTAL						31,530	38,568	31,530	9,599	27

MODEL: Schedule (Sheet)
FILE NAME: c:\pwworking\illinois.gov\irna\tsymbalyuk\illinois.gov\d1105810\72459_schedules.dgn

USER NAME = Iryna.Tsymbalyuk	DESIGNED -	REVISED -
	DRAWN -	REVISED -
	CHECKED -	REVISED -
PLOT DATE = 12/11/2025	DATE -	REVISED -

**STATE OF ILLINOIS
DEPARTMENT OF TRANSPORTATION**

SCHEDULE OF QUANTITIES

SCALE: SHEET 1 OF 3 SHEETS STA. TO STA.

F.A.P. RTE.	SECTION	COUNTY	TOTAL SHEETS	SHEET NO.
558	120RS-3	PIKE	30	10
CONTRACT NO. 72459				
ILLINOIS FED. AID PROJECT				

SHOULDER PAVING

STA.		STA.	WIDTH (FOOT)	LENGTH (FOOT)	AREA (SQ YD)	40600290 BIT MATRLS (TACK COAT) (POUND)	48203100 HMA SHOULDER, 2" (TON)
RIGHT							
418+75.00		420+00.00	3	125	42	19	5
STA EQ 420+00.00BK=420+07.07AH							
420+07.07		424+50.00	3	443	148	66	17
449+00.00		454+70.00	3	570	190	86	21
459+30.00		468+85.00	3	955	318	143	36
490+05.00		492+75.00	3	270	90	41	10
LEFT							
422+25.00		426+24.00	3	399	133	60	15
426+24.00		429+15.00	5	291	162	73	18
429+15.00		437+30.00	3	815	272	122	30
448+40.00		454+70.00	3	630	210	95	24
460+40.00		468+85.00	3	845	282	127	32
478+17.00		487+11.15	3	894	298	134	33
490+05.00		491+66.34	3	161	54	24	6
491+66.34		492+75.00	3	109	36	16	4
TOTAL						1005	250

AGGREGATE SHOULDER

STA		STA	LENGTH (FOOT)	48102100 AGG WEDGE SHLDR, TYPE B (TON)
LEFT				
324+80.20	to	412+00.00	8720	124
500+00.00	to	517+50.00	1750	25
527+30.00	to	547+05.00	1975	28
560+70.00	to	567+00.00	630	9
638+20.00	to	640+50.00	230	3
RIGHT				
324+80.20	to	412+00.00	8720	124
500+00.00	to	517+50.00	1750	25
532+15.00	to	546+45.00	1430	20
560+70.00	to	567+00.00	630	9
632+50.00	to	640+50.00	800	11
TOTAL				379

SIDE ROADS AND ENTRANCES

STA		TYPE	EX MATERIAL	AVG DEPTH (INCH)	AREA (SQ FT)	20200100 EARTH EXCAVATION (CU YD)	44000200 DRWY PAV REM (SQYD)	40600982 HMA SURF REM, BT JNT (SQ YD)	40800029 BIT MAT (TACK COAT) (POUND)	40800050 INCIDENTAL HMA SURF (TON)	A40200800 AGG SURF CSE, TY B (TON)
339+50.00	RT	SR	AGG	8	436	11			22	22	
339+50.00	LT	SR	AGG	8	470	12			24	23	
340+69.00	RT	PE	HMA/AGG	8	160	4	7		8	8	1
393+25.00	LT	PE	AGG	8	256	6			13	13	2
411+37.61	RT	SR	HMA/AGG	8	545	13			27	27	
412+37.02	LT	SR	O&C	1.75	420			47	21	5	
454+41.07	LT	PE	HMA/AGG	1.75	125			14	6	1	
474+82.48	LT	SR	AGG	8	227	6			11	11	
474+85.01	RT	SR	AGG	8	249	6			12	12	
516+53.86	RT	SR	HMA/AGG	8	419	10	35		21	21	
518+05.00	RT	MB	HMA	1.75	290			32	15	3	
518+60.00	RT	PE	HMA/AGG	8	180	4	7		9	9	1
521+04.42	LT	SR	HMA	1.75	523			58	26	6	
556+96.73	RT	SR	HMA/AGG	8	496	12	41		25	25	
639+43.79	RT	SR	HMA	1.75	985			109	49	11	
639+43.79	LT	SR	HMA/AGG	8	467	12	39		23	23	
TOTAL						96	129	260	312	220	4

PAVEMENT PATCHING

STA	LANE	DEPTH	44200168 PAV PATCH TYPE II, 14 IN (SQ YD)	44200172 PAV PATCH TYPE III, 14 IN (SQ YD)	44200174 PAV PATCH TYPE IV, 14 IN (SQ YD)
362+87.00	RT	14			28.7
546+11.00	RT	14			41
563+62.00	RT	14			47.3
568+06.00	RT	14			28.7
578+45.00	RT	14	15.9		
587+47.00	RT	14			42
588+30.00	RT	14		23.3	
605+42.00	RT	14		26	
605+92.00	RT	14			31.3
595+30.00	LT	14		20.7	
586+35.00	LT	14		18	
580+63.00	LT	14	15.3		
570+67.00	LT	14		22	
541+51.00	LT	14			30.9
473+96.00	LT	14			28
432+65.00	LT	14			59.8
345+19.00	LT	14		19.3	
TOTAL			31	129	338
GRAND TOTAL			498		

MODEL: Schedule-1 (Sheet)
FILE NAME: c:\p\work\pav\illinois.gov\irna\tsymbalyuk\illinois.gov\1105810\72459_schedules.dgn

USER NAME = Iryna.Tsymbalyuk	DESIGNED -	REVISED -
	DRAWN -	REVISED -
	CHECKED -	REVISED -
PLOT DATE = 3/4/2026	DATE -	REVISED -

**STATE OF ILLINOIS
DEPARTMENT OF TRANSPORTATION**

SCHEDULE OF QUANTITIES

SCALE: SHEET 2 OF 3 SHEETS STA. TO STA.

F.A.P. RTE.	SECTION	COUNTY	TOTAL SHEETS	SHEET NO.
558	120RS-3	PIKE	30	11
CONTRACT NO. 72459				
ILLINOIS FED. AID PROJECT				

PAVEMENT MARKING SCHEDULE

STA.			STA.		LENGTH (FOOT)	78001120 PAINT					70300100 SHORT TERM PVT MRK (FOOT)	70300150 SHORT TERM PVT MRK REM (SQFT)	78100100 RAISED REF PVT MARKER (EACH)	78300200 RAISED REF PVT MARK REM (EACH)
						PVT MRK - LINE 5" (FOOT)								
						LT EDGE LINE WHITE	CENTERLINE (YELLOW)			RT EDGE LINE WHITE				
							NPZ-SB	SKIP-DASH	NPZ-NB					
324+80.20			333+20.00		840	840		210	840	840	153	51	10	10
333+20.00			338+77.00		557	557		139		557	101	34	7	7
338+77.00			347+22.00		845	845	845	211		845	154	51	11	11
347+22.00			349+50.00		228	228		57		228	41	14	3	3
349+50.00			357+95.00		845	845		211	845	845	154	51	11	11
357+95.00			402+34.00		4439	4439		1110		4439	807	269	55	55
402+34.00			413+23.00		1089	1089	1089	272		1089	198	66	14	14
413+23.00			414+49.00		126	126	126		126	126	23	8	2	2
414+49.00			420+00.00	BK	551	551		138	551	551	100	33	7	7
420+07.00	AH		425+88.00		581	581		145	581	581	106	35	7	7
425+88.00			428+68.00		280	280		70		280	51	17	4	4
428+68.00			441+36.00		1268	1268	1268	317		1268	231	77	16	16
441+36.00			442+93.00		157	157	157		157	157	29	10	2	2
442+93.00			454+01.00		1108	1108		277	1108	1108	201	67	14	14
454+01.00			460+23.00		622	622		156		622	113	38	8	8
460+23.00			473+08.00		1285	1285	1285	321		1285	234	78	16	16
473+08.00			476+08.00		300	300	300		300	300	55	18	4	4
476+08.00			485+78.00		970	970		243	970	970	176	59	12	12
485+78.00			499+82.00		1404	1404		351		1404	255	85	18	18
499+82.00			509+13.00		931	931		233	931	931	169	56	12	12
509+13.00			510+92.00		179	179	179		179	179	33	11	2	2
510+92.00			520+26.00		934	934	934	234		934	170	57	12	12
520+26.00			533+93.00		1367	1367	1367		1367	1367	249	83	17	17
533+93.00			543+51.00		958	958		240	958	958	174	58	12	12
543+51.00			549+58.00		607	607		152		607	110	37	8	8
549+58.00			552+21.00	BK	263	263	263	66		263	48	16	3	3
552+28.00	AH		556+05.00		377	377	377	94		377	69	23	5	5
556+05.00			578+08.00		2203	2203	2203		2203	2203	401	133	28	28
578+08.00			588+80.00		1072	1072		268	1072	1072	195	65	13	13
588+80.00			589+74.00		94	94		24		94	17	6	1	1
589+74.00			599+62.00		988	988	988	247		988	180	60	12	12
599+62.00			617+02.00		1740	1740	1740		1740	1740	316	105	22	22
617+02.00			617+74.00		72	72	72	18		72	13	4	1	1
617+74.00			623+20.00		546	546		137		546	99	33	7	7
623+20.00			633+90.00		1070	1070	1070	268		1070	195	65	13	13
633+90.00			640+50.00		660	660	660		660	660	120	40	9	9
TOTAL								98828			5737	1911	395	395

MODEL: Schedule-2 (Sheet)
 FILE NAME: c:\p\work\pavmark\illinois.gov\1105810\72459_schedules.dgn

USER NAME = Iryna.Tsymbalyuk	DESIGNED -	REVISED -
	DRAWN -	REVISED -
	CHECKED -	REVISED -
PLOT DATE = 3/12/2026	DATE -	REVISED -

**STATE OF ILLINOIS
DEPARTMENT OF TRANSPORTATION**

SCHEDULE OF QUANTITIES

SCALE: SHEET 3 OF 3 SHEETS STA. TO STA.

F.A.P. RTE.	SECTION	COUNTY	TOTAL SHEETS	SHEET NO.
558	120RS-3	PIKE	30	12
CONTRACT NO. 72459				
ILLINOIS FED. AID PROJECT				

HORIZONTAL CONTROL STATION

NAD83/1997 ADJ - STATE PLANE WEST ZONE

POINT	DESCRIPTION	NORTHING	EASTING	STATION	OFFSET	CHAIN
9905	#4 REBAR W/CAP	1050395.743	2161238.594	322+05.80	32.9 LT	E001
9904	#4 REBAR W/CAP	1047814.212	2161152.302	347+88.25	18.9 RT	E001
9921	#4 REBAR W/CAP	1044657.999	2161145.626	379+44.27	16.5 LT	E001
9920	#4 REBAR W/CAP	1041223.304	2161099.794	413+79.27	16.5 LT	E001
9919	#4 REBAR W/CAP	1038520.526	2161067.325	440+89.31	20.1 LT	E002
9918	#4 REBAR W/CAP	1035383.069	2161019.585	472+27.13	14.2 LT	E002
9902	#4 REBAR W/CAP	1031240.338	2160930.058	513+70.69	20.0 RT	E002
9917	#4 REBAR W/CAP	1030454.097	2160969.056	521+56.38	14.1 RT	E002
9916	#4 REBAR W/CAP	1029432.065	2161124.432	531+87.80	14.6 RT	E002
9913	#4 REBAR W/CAP	1025636.163	2160801.884	570+05.96	14.2 RT	E003
9909	#4 REBAR W/CAP	1022090.676	2160793.340	605+50.93	14.7 RT	E003
9901	#4 REBAR W/CAP	1018136.904	2162014.177	650+73.17	15.8 RT	E006

BENCHMARKS

NAVD-88 VERTICAL DATUM

BENCHMARK	ELEVATION	DESCRIPTION	STATION	OFFSET	CHAIN
BM TJM-35	657.611	CHSLD [] ON HEADWALL TO CULVERT WITH 24" PIPE EXTENSION, ON E SIDE OF ILL 100; 7.4 MILES NW'LY OF TR'S 396N & 3952E	316+04.43	20.8 LT	E001 (IL100)
BM TJM-33	645.506	CHSLD [] ON CENTER OF E HEADWALL TO 4' X 4' BOX CULVERT; 7.0 MILES NW'LY OF TR'S 396N & 3952E	342+63.78	23.5 LT	E001 (IL100)
BM TJM-32	631.279	CHSLD [] ON S END OF SE HEADWALL TO DOUBLE BARREL BOX CULVERT (BRIDGE #75-2009); 6.6 MILES NW'LY OF TR'S 396N & 3952E	363+19.10	20.1 LT	E001 (IL100)
BM TJM-31	630.804	CHSLD [] ON CENTER OF HEADWALL TO 3' X 6' BOX CULVERT ON SE SIDE OF ILL 100; 6.3 MILES NW'LY OF TR'S 396N & 3952E	379+88.09	20.4 LT	E001 (IL100)
BM TJM-25	562.828	CHSLD [] ON W CORNER OF DROP INLET IN CURB ON NW SIDE OF ILL 100, ACROSS FROM ROCK PE; 4.8 MILES NW'LY OF TR'S 396N & 3952E	454+54.91	18.9 RT	E002 (IL100)
BM TJM-20	649.014	CHSLD [] ON TOP CENTER OF 2.5' X 2.5' BOX CULVERT ON SE SIDE OF ILL 100, JUST SE OF TR'S 667N & 3788E	517+00.09	23.9 LT	E002 (IL100)
BM TJM-19	632.082	CHSLD [] AT SW END OF V-GUTTER ON NW SIDE OF ILL 100; 3.5 MILES N'LY FROM TR'S 396N & 3952E	532+13.76	11.6 RT	E002 (IL100)
BM TJM-18	617.562	CHSLD [] IN FL OF GUTTER, 6' S OF DROP INLET AND SE SIDE OF ILL 100; 3.3 MILES NW OF TR'S 396N & 3952E	546+99.16	14.2 LT	E002 (IL100)
BM TJM-17	658.808	60D SPIKE IN TELEPHONE POLE ON NW SIDE OF ILL 100 OPPOSITE FIELD ENTRANCE; 3.0 MILES NW OF TR'S 396N & 3952E	560+62.46	40.4 RT	E003 (IL100)
BM TJM-15	636.179	CHSLD [] ON BACK OF V-GUTTER ON E SIDE OF ILL 100 AT TOP OF HILL, ACROSS FROM ROCK PE; 2.7 MILES NW OF TR'S 396N & 3952E	577+78.56	12.2 RT	E003 (IL100)
BM TJM-14	580.324	CHSLD [] ON S END OF DROP INLET, ON E SIDE OF ILL 100 AT BOTTOM OF HILL; 2.5 MILES NW OF TR'S 396N & 3952E	589+54.98	12.8 LT	E003 (IL100)
BM TJM-13	631.217	CHSLD [] ON N SIDE OF DROP INLET ON W SIDE OF ILL 100, JUST S OF ROCK PE; 2.3 MILES NW OF TR'S 396N & 3952E	599+23.14	14.2 RT	E003 (IL100)
BM TJM-12	604.333	CHSLD [] ON S SIDE OF DROP INLET ON E SIDE OF ILL 100, NEAR LAST GUARD RAIL POST BEFORE TOP OF HILL; 2.1 MILES NW OF TR'S 396N & 3952E	611+25.31	14.2 LT	E003 (IL100)
BM TJM-11	531.636	CHSLD [] ON N SIDE OF DROP INLET ON E SIDE OF ILL 100 ACROSS FROM PRIVATE ENTRANCE; 1.9 MILES NW OF TR'S 396N & 3952E	624+05.71	14.8 LT	E003 (IL100)
NGS M 81	490.550	NGS DISK STAMPED M 81 1935 SET IN TOP OF THE E BACKWALL OF RR STR D-2524, 8 FT N OF S END, AND 10 FT S OF THE SOUTH RAIL, AT IL100	646+03.53	386.4 RT	E003 (IL100)
BM TJM-8	466.653	CHSLD [] CENTER NE HDWL 4X6 BOX CULVERT NE SIDE IL 100, & 213 FT N OF STEEL RAILROAD BRIDGE	646+08.59	25.5 LT	E003 (IL100)

MODEL: Untitled-1 [Sheet]
FILE NAME: c:\p\work\pvt\illinois.gov\irna\tsymbalyuk\illinois.gov\1105810\72459_ATB.dgn

USER NAME = Iryna.Tsymbalyuk	DESIGNED -	REVISED -
	DRAWN -	REVISED -
	CHECKED -	REVISED -
PLOT DATE = 10/21/2025	DATE -	REVISED -

**STATE OF ILLINOIS
DEPARTMENT OF TRANSPORTATION**

ALIGNMENT, TIES AND BENCHMARKS

SCALE: SHEET 2 OF 2 SHEETS STA. TO STA.

F.A.P. RTE.	SECTION	COUNTY	TOTAL SHEETS	SHEET NO.
558	120RS-3	PIKE	30	13
CONTRACT NO. 72459				
ILLINOIS FED. AID PROJECT				

HORIZONTAL ALIGNMENT CONTROL								
NAD83/1997 ADJ - STATE PLANE WEST ZONE								
POINT TYPE	STATION	NORTHING	EASTING	RADIUS	LENGTH	TANGENT	DELTA/THETA	ROTATION
ALIGNMENT NAME:		E001						
DESCRIPTION:		IL 100 MAINLINE						
POT	303+74.67	1052217.753	2161041.413					
PC	311+88.86	1051410.542	2161147.820					
PI	316+84.72	1050918.933	2161212.625	6855.70	990.00	495.86	08°16'26"	RIGHT
PT	321+78.86	1050423.115	2161206.010					
POT	349+00.00	1047702.219	2161169.710					
POT	380+00.00	1044602.495	2161128.357					
POT	414+00.00	1041202.798	2161083.001					
POT STA EQ	420+00.00 BK=	1040602.851	2161074.998					
ALIGNMENT NAME:		E002						
DESCRIPTION:		IL 100 MAINLINE						
POT STA EQ	420+07.07 AH	1040602.851	2161074.998					
POT	440+00.00	1038610.101	2161048.412					
POT	442+82.00	1038328.126	2161044.650					
POT	474+00.00	1035210.403	2161003.057					
POT	502+50.00	1032360.657	2160965.038					
PC	514+49.08	1031161.687	2160949.043					
PI	519+00.00	1030710.804	2160943.028	5742.20	900.00	450.92	08°58'49"	LEFT
PT	523+49.08	1030264.508	2161007.466					
PC	527+23.36	1029894.065	2161060.953					
PI	532+40.30	1029382.432	2161134.825	3840.27	1027.70	516.94	15°19'59"	RIGHT
PT	537+51.06	1028869.476	2161070.777					
POT STA EQ	552+20.62 BK=	1027411.240	2160888.702					
ALIGNMENT NAME:		E003						
DESCRIPTION:		IL 100 MAINLINE						
PC STA EQ	552+27.98 AH	1027411.240	2160888.702					
PI	557+31.00	1026912.099	2160826.380	8648.38	1004.90	503.02	06°39'27"	LEFT
PT	562+32.88	1026409.099	2160822.345					
POT	577+50.00	1024892.031	2160810.175					
PC	598+65.48	1022776.617	2160793.205					
PI	603+50.77	1022291.348	2160789.312	11555.97	970.00	485.28	04°48'34"	LEFT
PT	608+35.48	1021807.461	2160826.119					
PC	610+93.45	1021550.236	2160845.684					
PI	616+12.10	1021033.083	2160885.021	11570.02	1036.60	518.65	05°08'00"	RIGHT
PT	621+30.05	1020514.484	2160877.928					
PC	632+54.10	1019390.539	2160862.556					
PI	639+00.10	1018744.597	2160853.721	1041.26	1156.40	646.00	63°37'52"	LEFT
PT	644+10.50	1018449.787	2161428.532					
POT	648+70.73	1018239.756	2161838.045					

HORIZONTAL ALIGNMENT CONTROL								
NAD83/1997 ADJ - STATE PLANE WEST ZONE								
POINT TYPE	STATION	NORTHING	EASTING	RADIUS	LENGTH	TANGENT	DELTA/THETA	ROTATION
ALIGNMENT NAME:		TR_1000N						
DESCRIPTION:		SIDE RD - 200TH AVE						
POT	8+35.14	1048660.885	2161017.648					
POT	11+76.59	1048650.806	2161358.952					
ALIGNMENT NAME:		TR_867N						
DESCRIPTION:		SIDE RD - 185TH AVE						
POT	8+46.04	1041477.754	2160933.054					
POT	10+00.00	1041465.166	2161086.502					
ALIGNMENT NAME:		TR_865N						
DESCRIPTION:		SIDE RD - 185TH AVE						
POT	10+00.00	1041365.762	2161085.176					
POT	11+84.71	1041359.041	2161269.768					
ALIGNMENT NAME:		TR_749N_E						
DESCRIPTION:		SIDE RD 175TH AVE						
POT	10+00.00	1035127.931	2161001.957					
POT	12+00.00	1035142.418	2161201.431					
ALIGNMENT NAME:		TR_749N_W						
DESCRIPTION:		SIDE RD 175TH AVE						
POT	8+21.62	1035116.564	2160823.761					
POT	10+00.00	1035125.402	2161001.923					
ALIGNMENT NAME:		TR_667N						
DESCRIPTION:		SIDE RD 167TH AVE						
POT	8+00.00	1030968.392	2160750.292					
POT	10+00.00	1030956.915	2160949.963					
ALIGNMENT NAME:		TR_659N						
DESCRIPTION:		SIDE RD 166TH AVE						
POT	10+00.00	1030507.324	2160977.672					
POT	11+71.72	1030495.860	2161149.012					
ALIGNMENT NAME:		TR_600N						
DESCRIPTION:		SIDE RD 160TH AVE						
POT	8+00.00	1026941.376	2160643.284					
POT	10+00.00	1026944.753	2160843.256					
ALIGNMENT NAME:		TR_447N						
DESCRIPTION:		COUNTY HWY 10						
POT	8+55.40	1018686.396	2160942.783					
POT	10+00.00	1018747.230	2161073.962					

MODEL: Unlited-2 (Sheet)
 FILE NAME: c:\p\work\pwr\illinois.gov_inna\tsymbalyuk\illinois.gov\1105810172459_ATB.dgn

USER NAME = Iryna.Tsymbalyuk	DESIGNED -	REVISED -
	DRAWN -	REVISED -
	CHECKED -	REVISED -
PLOT DATE = 12/9/2025	DATE -	REVISED -

STATE OF ILLINOIS
DEPARTMENT OF TRANSPORTATION

ALIGNMENT, TIES AND BENCHMARKS

SCALE: SHEET 1 OF 2 SHEETS STA. TO STA.

F.A.P. RTE.	SECTION	COUNTY	TOTAL SHEETS	SHEET NO.
558	120RS-3	PIKE	30	14
CONTRACT NO. 72459				
ILLINOIS FED. AID PROJECT				

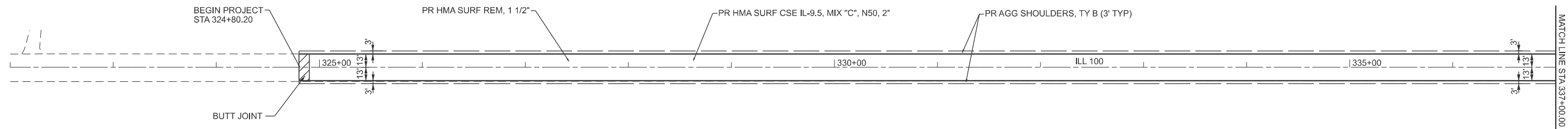

FOR PAVEMENT MARKING LOCATION SEE SCHEDULES

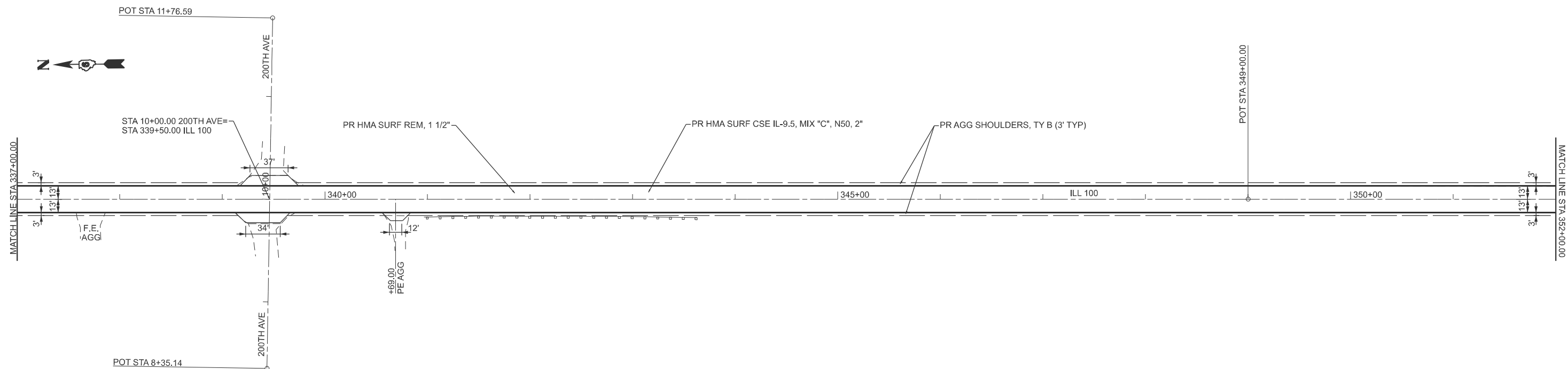

FOR PAVEMENT MARKING LOCATION SEE SCHEDULES

MODEL: EXCL - Plan 1 (Sheet)
FILE NAME: c:\p\work\pav\illinois.gov\iryna.tsymbalyuk\illinois.gov\1105810\72459_plan_sh1s.dgn

USER NAME = Iryna.Tsymbalyuk	DESIGNED -	REVISED -
	DRAWN -	REVISED -
	CHECKED -	REVISED -
PLOT DATE = 3/3/2026	DATE -	REVISED -

**STATE OF ILLINOIS
DEPARTMENT OF TRANSPORTATION**

**PLAN SHEETS
ILL 100**

SCALE: 1"=50' SHEET 1 OF 11 SHEETS STA. 322+00.00 TO STA. 352+00.00

F.A.P. RTE.	SECTION	COUNTY	TOTAL SHEETS	SHEET NO.
558	120RS-3	PIKE	30	15
CONTRACT NO. 72459				
ILLINOIS FED. AID PROJECT				

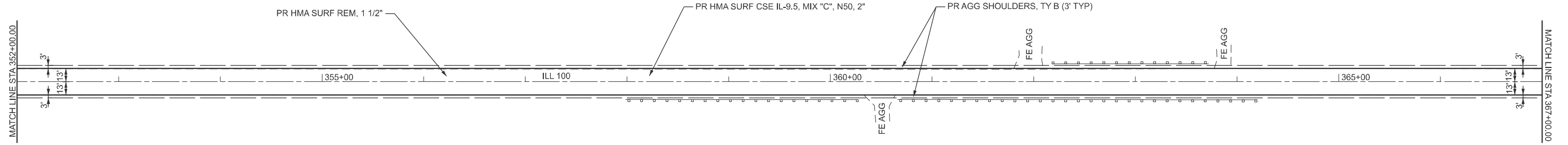

FOR PAVEMENT MARKING LOCATIONS SEE SCHEDULES

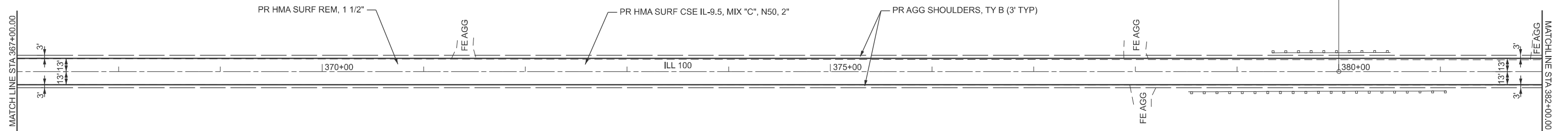

FOR PAVEMENT MARKING LOCATIONS SEE SCHEDULES

MODEL: EXCL - Plan 3 (Sheet)
 FILE NAME: c:\p\work\pav\illinois.gov\iryna.tsymbalyuk\illinois.gov\1105810\72459_plan_sh1s.dgn

USER NAME = Iryna.Tsymbalyuk	DESIGNED -	REVISED -
	DRAWN -	REVISED -
	CHECKED -	REVISED -
PLOT DATE = 12/9/2025	DATE -	REVISED -

**STATE OF ILLINOIS
 DEPARTMENT OF TRANSPORTATION**

**PLAN SHEETS
 ILL 100**

SCALE: 1"=50' SHEET 2 OF 11 SHEETS STA. 352+00.00 TO STA. 382+00.00

F.A.P. RTE.	SECTION	COUNTY	TOTAL SHEETS	SHEET NO.
558	120RS-3	PIKE	30	16
CONTRACT NO. 72459				
ILLINOIS FED. AID PROJECT				

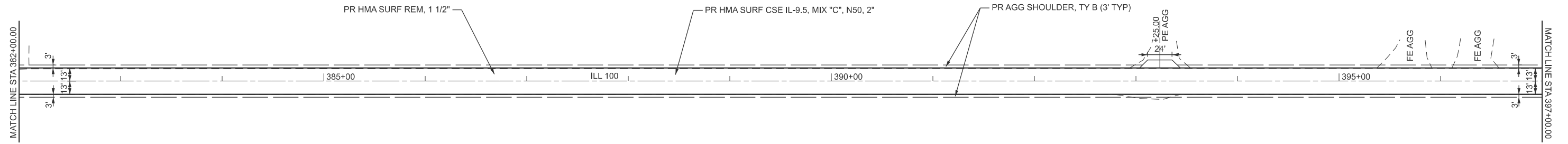

FOR PAVEMENT MARKING LOCATION SEE SCHEDULES

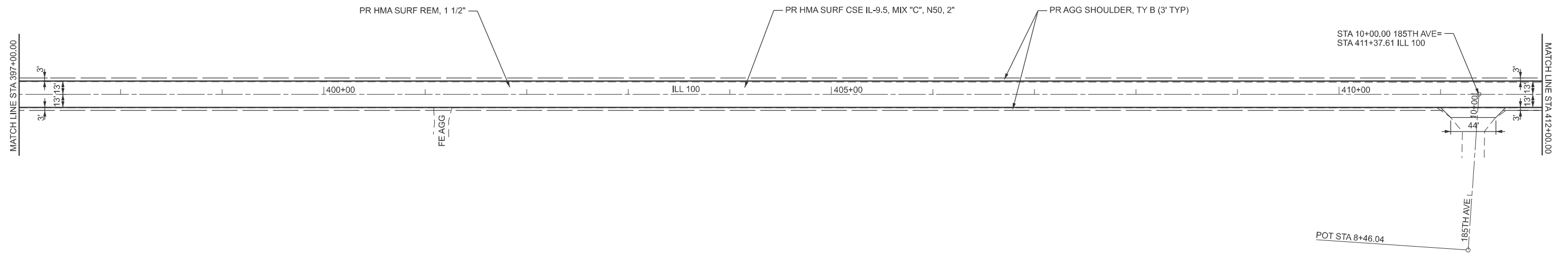

FOR PAVEMENT MARKING LOCATION SEE SCHEDULES

MODEL: EXCL - Plan 5 (Sheet)
 FILE NAME: c:\p\work\pav\illinois.gov\1105810\72459_plan_shts.dgn

USER NAME = Iryna.Tsymbalyuk	DESIGNED -	REVISED -
	DRAWN -	REVISED -
	CHECKED -	REVISED -
PLOT DATE = 12/9/2025	DATE -	REVISED -

**STATE OF ILLINOIS
 DEPARTMENT OF TRANSPORTATION**

**PLAN SHEETS
 ILL 100**

SCALE: 1"=50' SHEET 3 OF 11 SHEETS STA. 382+00.00 TO STA. 412+00.00

F.A.P. RTE.	SECTION	COUNTY	TOTAL SHEETS	SHEET NO.
558	120RS-3	PIKE	30	17
CONTRACT NO. 72459				
ILLINOIS FED. AID PROJECT				

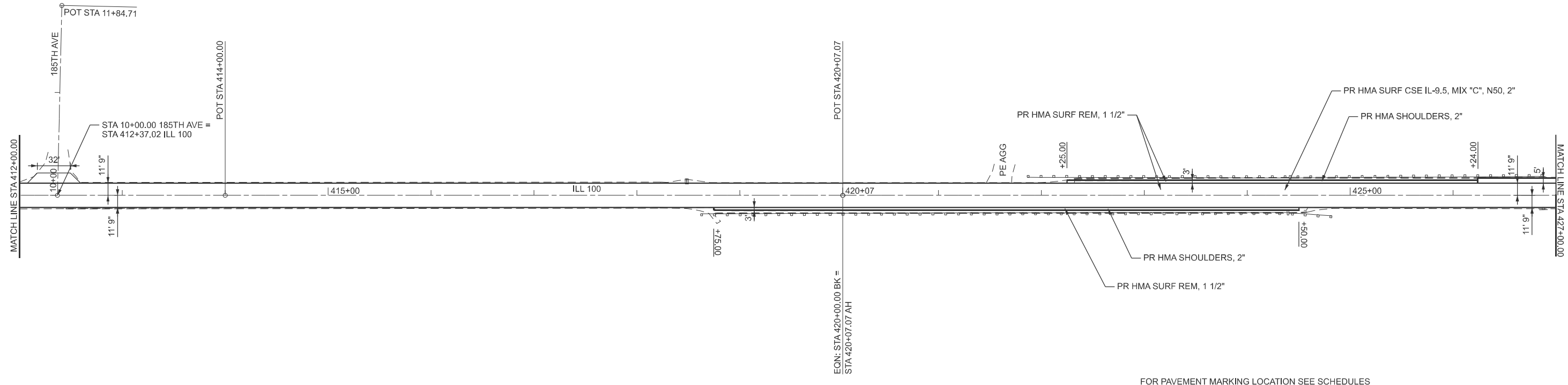

FOR PAVEMENT MARKING LOCATION SEE SCHEDULES

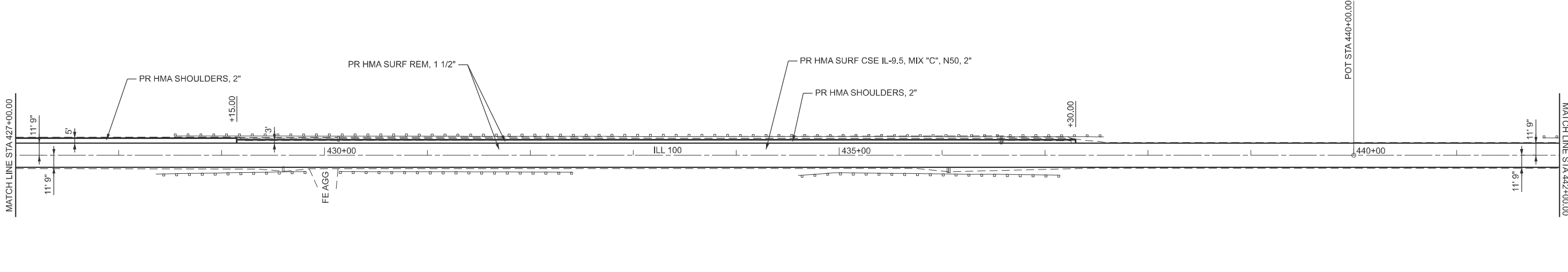

FOR PAVEMENT MARKING LOCATION SEE SCHEDULES

MODEL: EXCL - Plan 7 (Sheet)
 FILE NAME: c:\p\work\pav\illinois.gov\iryna.tsymbalyuk@illinois.gov\1105810\72459_plan_sh1s.dgn

USER NAME = Iryna.Tsymbalyuk	DESIGNED -	REVISED -
	DRAWN -	REVISED -
	CHECKED -	REVISED -
PLOT DATE = 12/9/2025	DATE -	REVISED -

**STATE OF ILLINOIS
 DEPARTMENT OF TRANSPORTATION**

PLAN SHEETS ILL 100			
SCALE: 1"=50'	SHEET 4	OF 11 SHEETS	STA. 412+00.00 TO STA. 442+00.00

F.A.P. RTE.	SECTION	COUNTY	TOTAL SHEETS	SHEET NO.
558	120RS-3	PIKE	30	18
CONTRACT NO. 72459				
ILLINOIS FED. AID PROJECT				

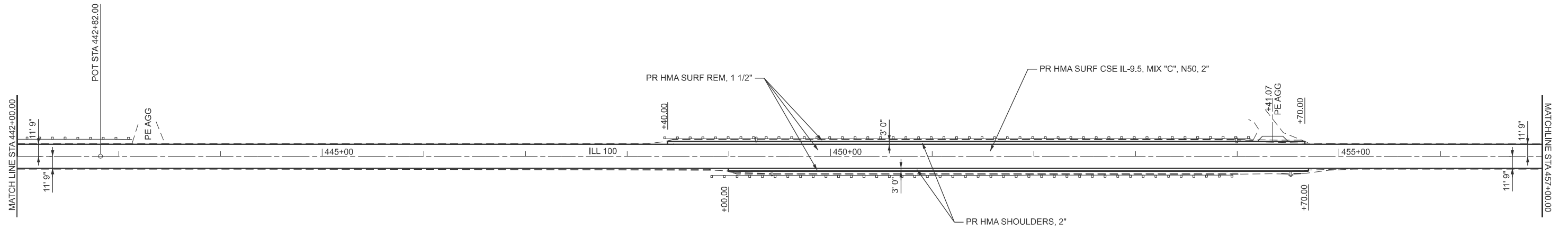

FOR PAVEMENT MARKING LOCATION SEE SCHEDULES

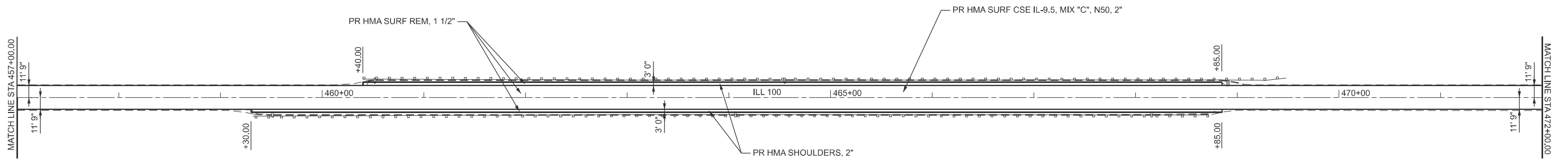

FOR PAVEMENT MARKING LOCATION SEE SCHEDULES

MODEL: EXCL - Plan 9 (Sheet)
 FILE NAME: c:\p\work\pav\illinois.gov\1105810\72459_plan_shis.dgn

USER NAME = Iryna.Tsymbalyuk	DESIGNED -	REVISED -
	DRAWN -	REVISED -
	CHECKED -	REVISED -
PLOT DATE = 12/9/2025	DATE -	REVISED -

**STATE OF ILLINOIS
 DEPARTMENT OF TRANSPORTATION**

**PLAN SHEETS
 ILL 100**

SCALE: 1"=50' SHEET 5 OF 11 SHEETS STA. 442+00.00 TO STA. 472+00.00

F.A.P. RTE.	SECTION	COUNTY	TOTAL SHEETS	SHEET NO.
558	120RS-3	PIKE	30	19
CONTRACT NO. 72459				
ILLINOIS FED. AID PROJECT				

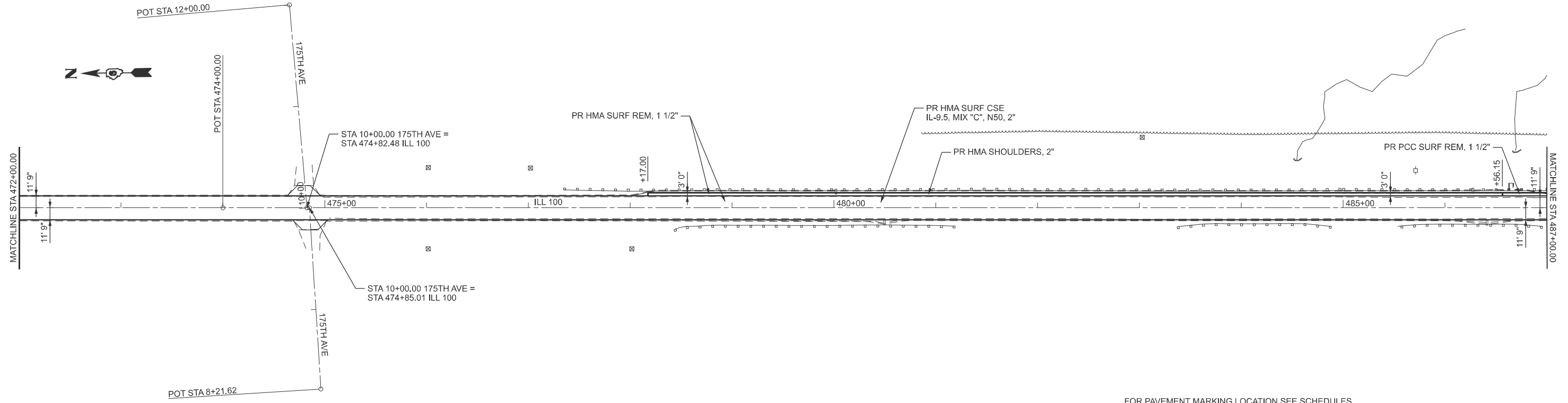

FOR PAVEMENT MARKING LOCATION SEE SCHEDULES

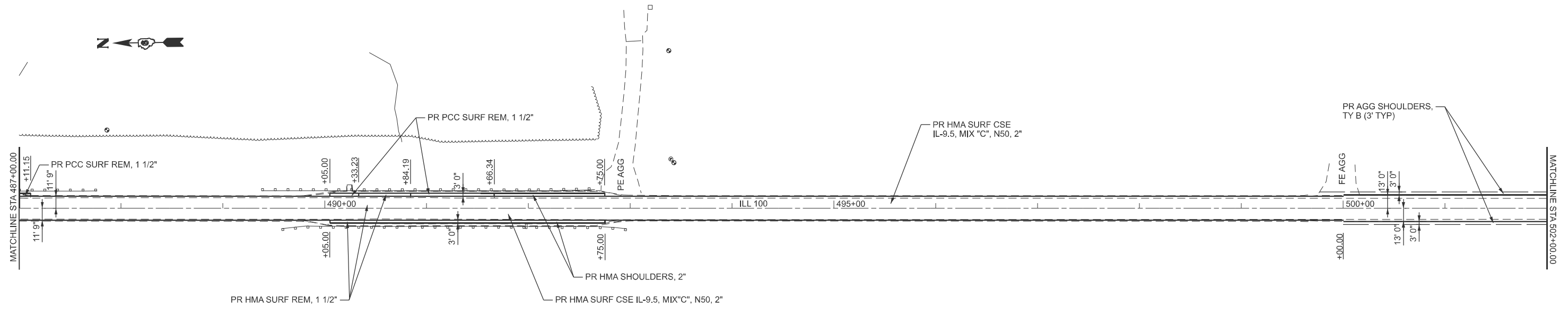

FOR PAVEMENT MARKING LOCATION SEE SCHEDULES

MODEL: EXCL - Plan 11 (Sheet)
 FILE NAME: c:\p\work\pav\illinois.gov\iryna.tsymbalyuk\illinois.gov\d1105810\72459_plan_sh1s.dgn

USER NAME = Iryna.Tsymbalyuk	DESIGNED -	REVISED -
	DRAWN -	REVISED -
	CHECKED -	REVISED -
PLOT DATE = 12/9/2025	DATE -	REVISED -

**STATE OF ILLINOIS
 DEPARTMENT OF TRANSPORTATION**

**PLAN SHEETS
 ILL 100**

SCALE: 1"=50' SHEET 6 OF 11 SHEETS STA. 472+00.00 TO STA. 502+00.00

F.A.P. RTE.	SECTION	COUNTY	TOTAL SHEETS	SHEET NO.
558	120RS-3	PIKE	30	20
CONTRACT NO. 72459				
ILLINOIS FED. AID PROJECT				

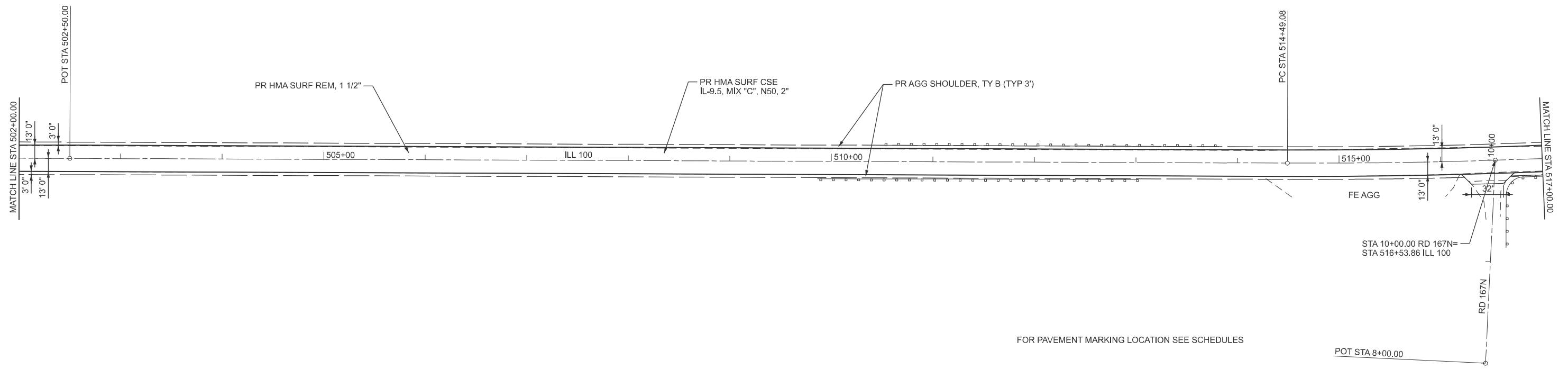

FOR PAVEMENT MARKING LOCATION SEE SCHEDULES



EX CURVE
 PI STA = 519+00.00
 $\Delta = 08^{\circ}58'49''$ (LT)
 $D = 00^{\circ}59'52''$
 $R = 5,742.20'$
 $T = 450.92'$
 $L = 900.00'$
 $E = 17.68'$
 $e =$
 PC STA = 514+49.08
 PT STA = 523+49.08

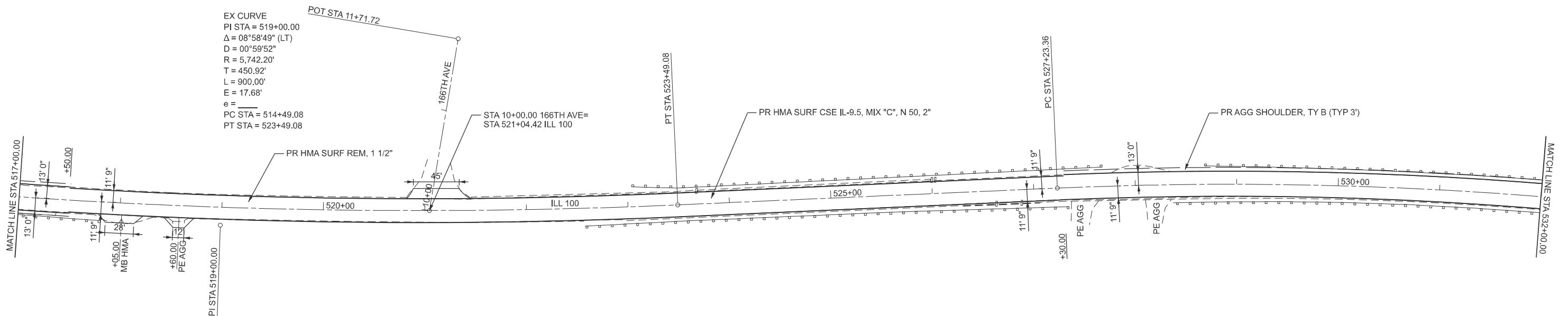

FOR PAVEMENT MARKING LOCATION SEE SCHEDULES

MODEL: EXCL - Plan 13 (Sheet)
 FILE NAME: c:\p\work\pav\illinois.gov\iryna.tsymbalyuk\illinois.gov\1105810\72459_plan_shis.dgn

USER NAME = Iryna.Tsymbalyuk	DESIGNED -	REVISED -
	DRAWN -	REVISED -
	CHECKED -	REVISED -
PLOT DATE = 3/4/2026	DATE -	REVISED -

**STATE OF ILLINOIS
 DEPARTMENT OF TRANSPORTATION**

**PLAN SHEETS
 ILL 100**

SCALE: 1"=50' SHEET 7 OF 11 SHEETS STA. 502+00.00 TO STA. 532+00.00

F.A.P. RTE.	SECTION	COUNTY	TOTAL SHEETS	SHEET NO.
558	120RS-3	PIKE	30	21
CONTRACT NO. 72459				
ILLINOIS FED. AID PROJECT				

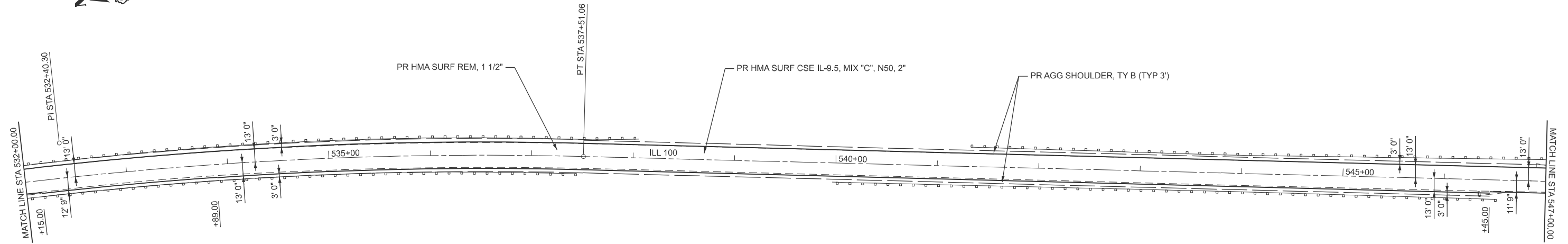

EX CURVE
 PI STA = 532+40.30
 $\Delta = 15^\circ 19' 59''$ (RT)
 $D = 01^\circ 29' 31''$
 $R = 3,840.27'$
 $T = 516.94'$
 $L = 1027.70'$
 $E = 34.64'$
 $e =$
 PC STA = 527+23.36
 PT STA = 537+51.06

FOR PAVEMENT MARKING LOCATION SEE SCHEDULES

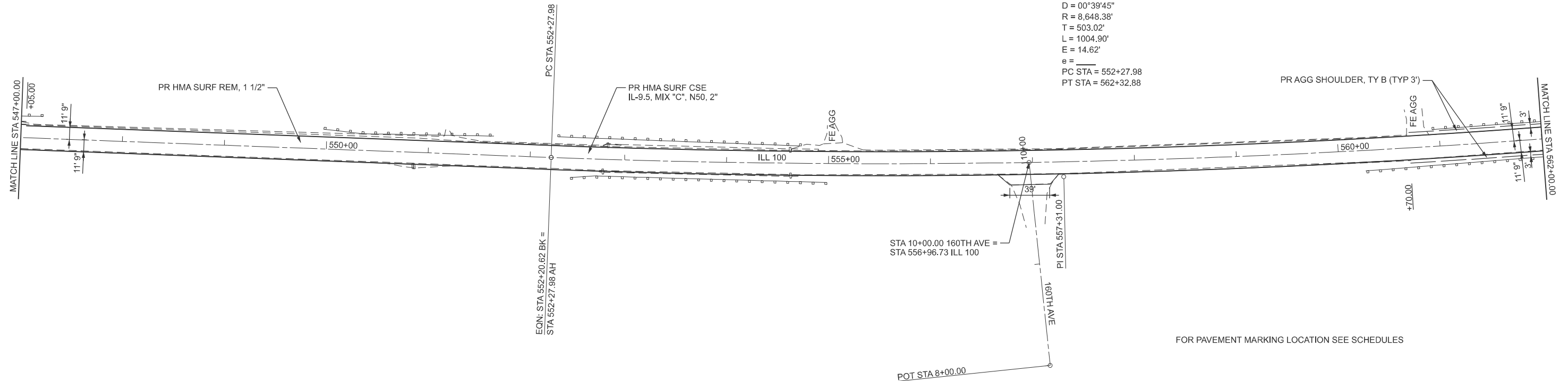

EX CURVE
 PI STA = 557+31.00
 $\Delta = 06^\circ 39' 27''$ (LT)
 $D = 00^\circ 39' 45''$
 $R = 8,648.38'$
 $T = 503.02'$
 $L = 1004.90'$
 $E = 14.62'$
 $e =$
 PC STA = 552+27.98
 PT STA = 562+32.88

FOR PAVEMENT MARKING LOCATION SEE SCHEDULES

MODEL: EXCL - Plan 15 (Sheet)
 FILE NAME: c:\p\work\pav\illinois.gov\irna\tsymbalyuk\illinois.gov\1105810\72459_plan_shts.dgn

USER NAME = Iryna.Tsymbalyuk	DESIGNED -	REVISED -
	DRAWN -	REVISED -
	CHECKED -	REVISED -
PLOT DATE = 3/4/2026	DATE -	REVISED -

STATE OF ILLINOIS
 DEPARTMENT OF TRANSPORTATION

PLAN SHEETS
 ILL 100

SCALE: 1"=50' SHEET 8 OF 11 SHEETS STA. 532+00.00 TO STA. 562+00.00

F.A.P. RTE.	SECTION	COUNTY	TOTAL SHEETS	SHEET NO.
558	120RS-3	PIKE	30	22
CONTRACT NO. 72459				
ILLINOIS FED. AID PROJECT				

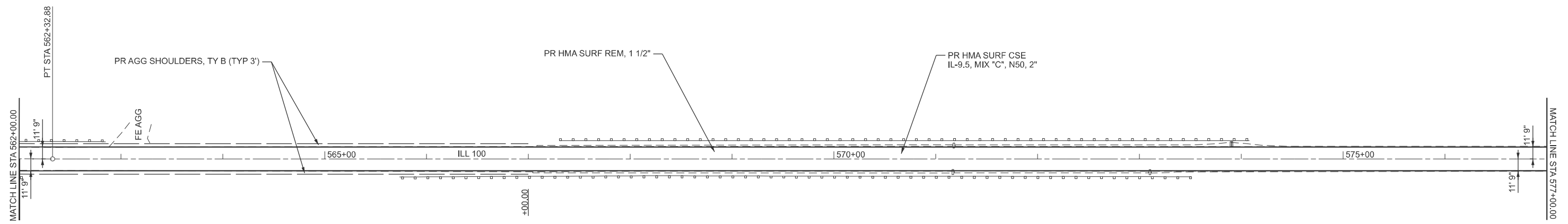

FOR PAVEMENT MARKING LOCATION SEE SCHEDULES

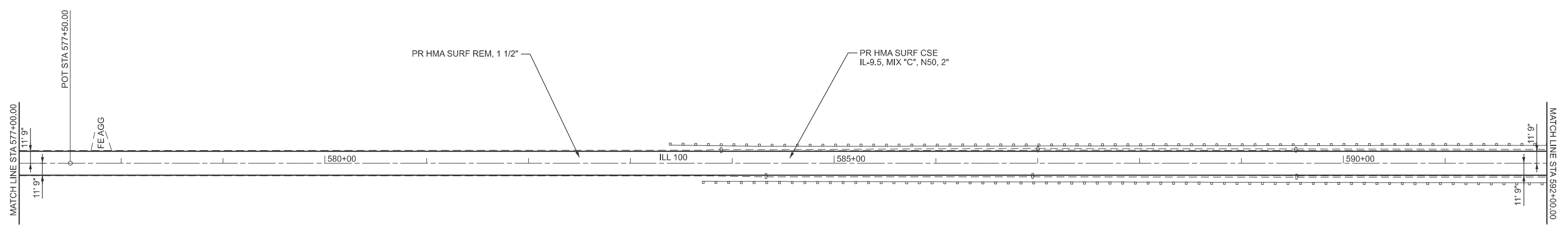

FOR PAVEMENT MARKING LOCATION SEE SCHEDULES

MODEL: EXCL - Plan 17 (Sheet)
 FILE NAME: c:\p\work\pav\illinois.gov\iryna.tsymbalyuk\illinois.gov\1103810\72459_plan_shts.dgn

USER NAME = Iryna.Tsymbalyuk	DESIGNED -	REVISED -
	DRAWN -	REVISED -
	CHECKED -	REVISED -
PLOT DATE = 3/4/2026	DATE -	REVISED -

**STATE OF ILLINOIS
 DEPARTMENT OF TRANSPORTATION**

**PLAN SHEETS
 ILL 100**

SCALE: 1"=50' SHEET 9 OF 11 SHEETS STA. 562+00.00 TO STA. 592+00.00

F.A.P. RTE.	SECTION	COUNTY	TOTAL SHEETS	SHEET NO.
558	120RS-3	PIKE	30	23
CONTRACT NO. 72459				
ILLINOIS FED. AID PROJECT				



EX CURVE
 PI STA = 603+50.76
 $\Delta = 04^{\circ}48'34''$ (LT)
 $D = 00^{\circ}29'45''$
 $R = 11,555.97'$
 $T = 485.28'$
 $L = 970.00'$
 $E = 10.19'$
 $e =$
 PC STA = 598+65.48
 PT STA = 608+35.48

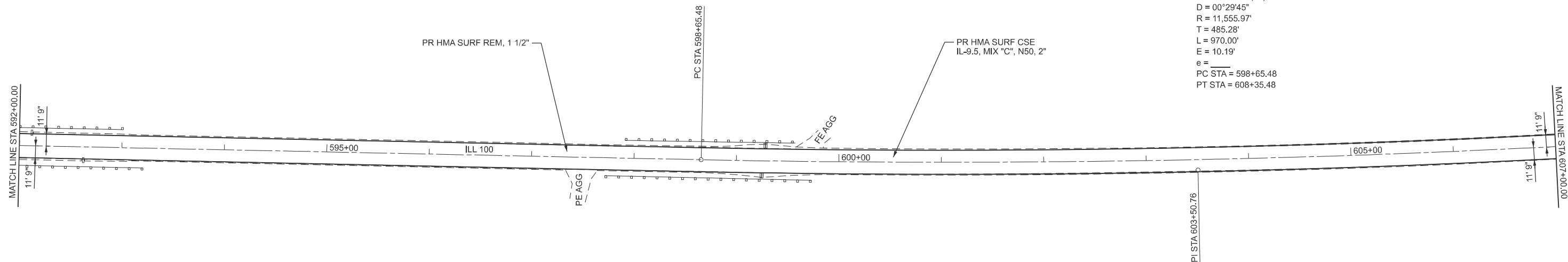

FOR PAVEMENT MARKING LOCATION SEE SCHEDULES



EX CURVE
 PI STA = 616+12.09
 $\Delta = 05^{\circ}08'00''$ (RT)
 $D = 00^{\circ}29'43''$
 $R = 11,570.02'$
 $T = 518.65'$
 $L = 1036.60'$
 $E = 11.62'$
 $e =$
 PC STA = 610+93.45
 PT STA = 621+30.05

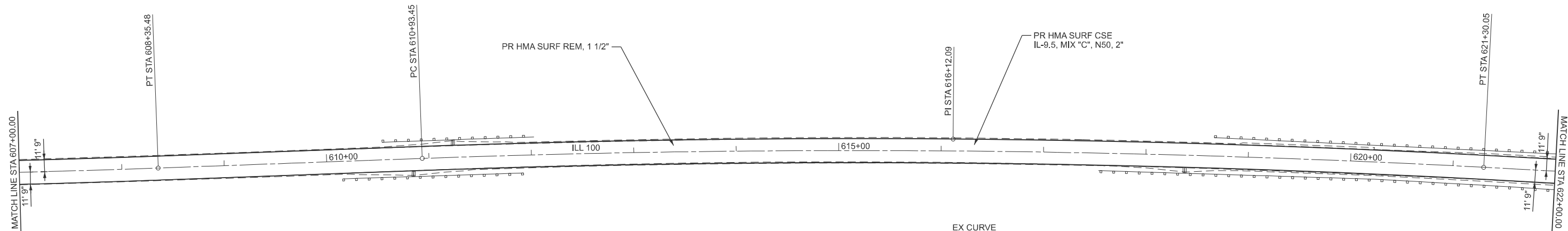

FOR PAVEMENT MARKING LOCATION SEE SCHEDULES

MODEL: EXCL - Plan 10 (Sheet)
 FILE NAME: c:\p\work\pav\illinois.gov\irna.tsymbalyuk\illinois.gov\1103810\72459_plan_shts.dgn

USER NAME = Iryna.Tsymbalyuk	DESIGNED -	REVISED -
	DRAWN -	REVISED -
	CHECKED -	REVISED -
PLOT DATE = 3/3/2026	DATE -	REVISED -

**STATE OF ILLINOIS
 DEPARTMENT OF TRANSPORTATION**

**PLAN SHEETS
 ILL 100**

SCALE: 1"=50' SHEET 10 OF 11 SHEETS STA. 592+00.00 TO STA. 622+00.00

F.A.P. RTE.	SECTION	COUNTY	TOTAL SHEETS	SHEET NO.
558	120RS-3	PIKE	30	24
CONTRACT NO. 72459				
ILLINOIS FED. AID PROJECT				



EX CURVE
 PI STA = 639+00.10
 $\Delta = 63^\circ 37' 52''$ (LT)
 $D = 05^\circ 30' 09''$
 $R = 1,041.26'$
 $T = 646.00'$
 $L = 1156.40'$
 $E = 184.11'$
 $e =$
 PC STA = 632+54.10
 PT STA = 644+10.50

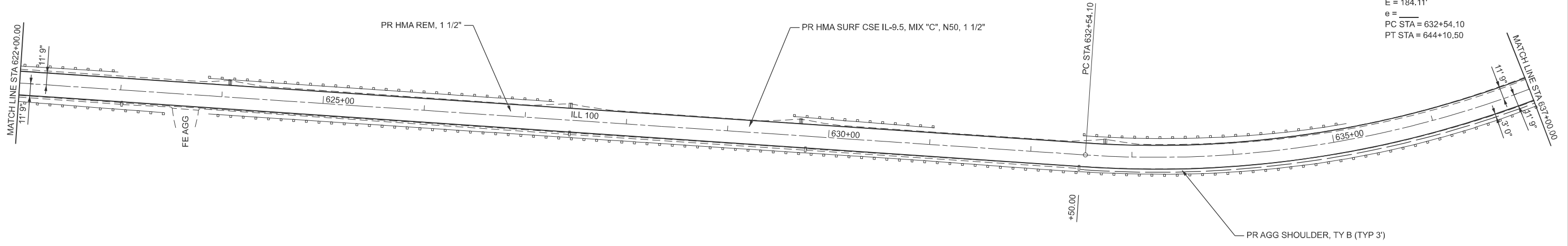

FOR PAVEMENT MARKING LOCATION SEE SCHEDULES

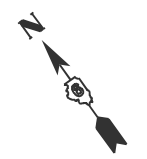

EX CURVE
 PI STA = 11+09.19
 $\Delta = 54^\circ 43' 10''$ (RT)
 $D = 44^\circ 02' 02''$
 $R = 130.12'$
 $T = 67.33'$
 $L = 124.27'$
 $E = 16.39'$
 $e =$
 PC STA = 10+41.86
 PT STA = 11+66.13

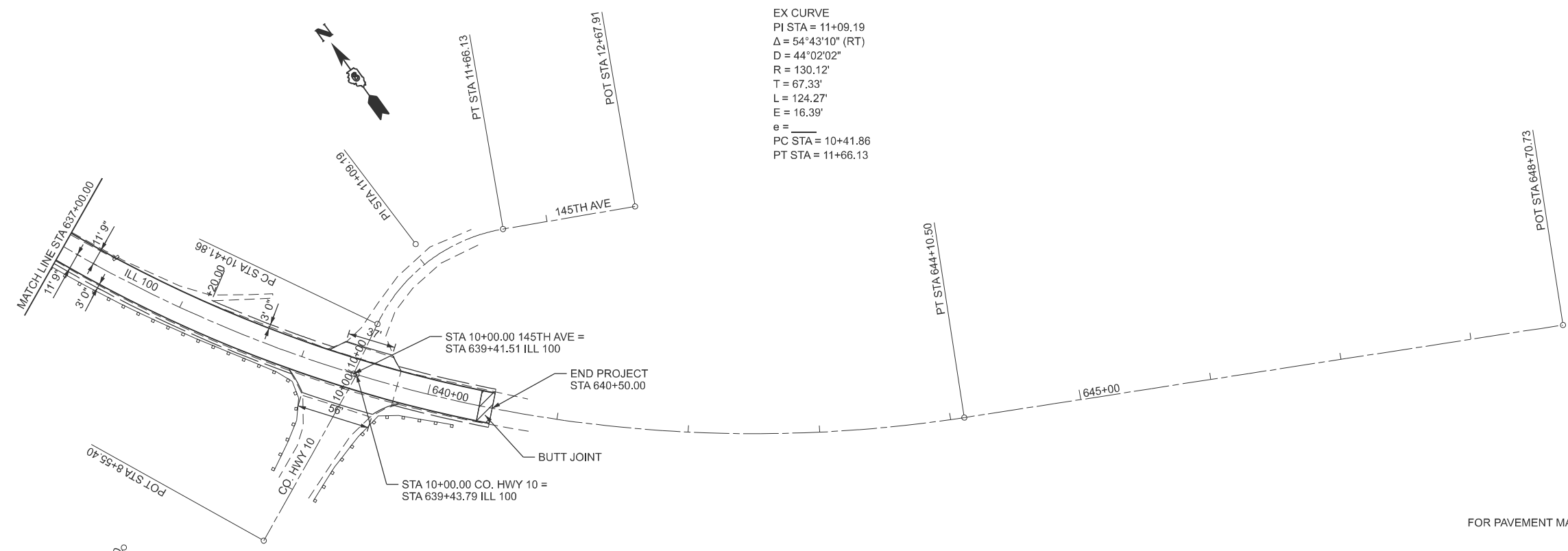

FOR PAVEMENT MARKING LOCATION SEE SCHEDULES

MODEL: EXCL - Plan 21 (Sheet)
 FILE NAME: c:\p\work\pav\illinois.gov\iryna.tsymbalyuk\illinois.gov\d1105810\72459_plan_shts.dgn

USER NAME = Iryna.Tsymbalyuk	DESIGNED -	REVISED -
	DRAWN -	REVISED -
	CHECKED -	REVISED -
PLOT DATE = 2/17/2026	DATE -	REVISED -

**STATE OF ILLINOIS
 DEPARTMENT OF TRANSPORTATION**

**PLAN SHEETS
 ILL 100**

SCALE: 1"=50' SHEET 11 OF 11 SHEETS STA. 622+00.00 TO STA. 652+00.00

F.A.P. RTE.	SECTION	COUNTY	TOTAL SHEETS	SHEET NO.
558	120RS-3	PIKE	30	25
CONTRACT NO. 72459				
ILLINOIS FED. AID PROJECT				

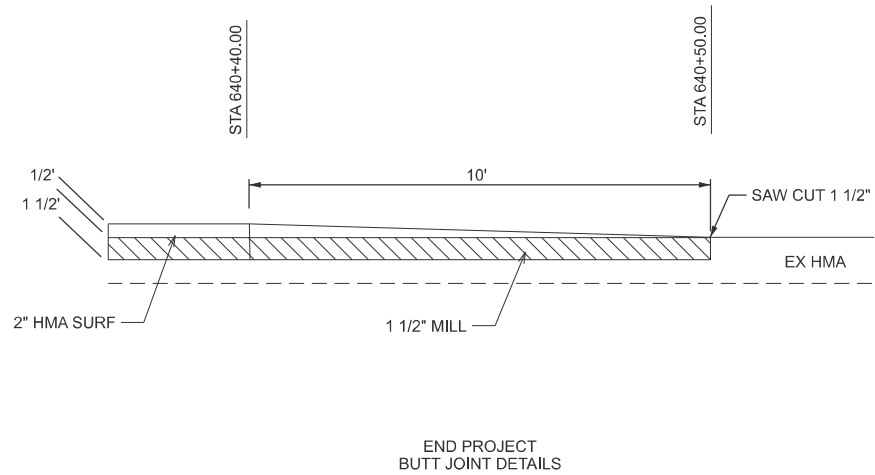
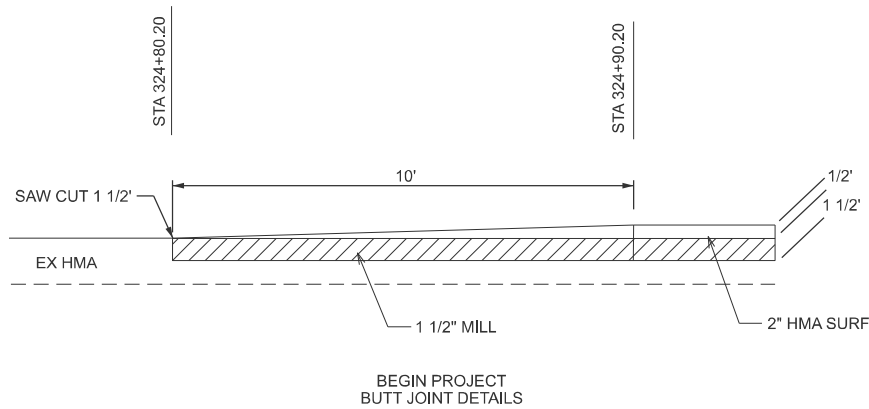

MODEL: Untitled (Sheet)
 FILE NAME: c:\p\work\pav\illinois.gov_irma.tsymboluk@illinois.gov\110381072459_Butt_joint.dgn

USER NAME = Iryna.Tsymboluk	DESIGNED -	REVISED -
	DRAWN -	REVISED -
	CHECKED -	REVISED -
PLOT DATE = 12/9/2025	DATE -	REVISED -

**STATE OF ILLINOIS
DEPARTMENT OF TRANSPORTATION**

BUTT JOINT DETAILS

SCALE: NTS SHEET 1 OF 1 SHEETS STA. TO STA.

F.A.P. RTE.	SECTION	COUNTY	TOTAL SHEETS	SHEET NO.
558	120RS-3	PIKE	30	26
CONTRACT NO. 72459				
ILLINOIS FED. AID PROJECT				

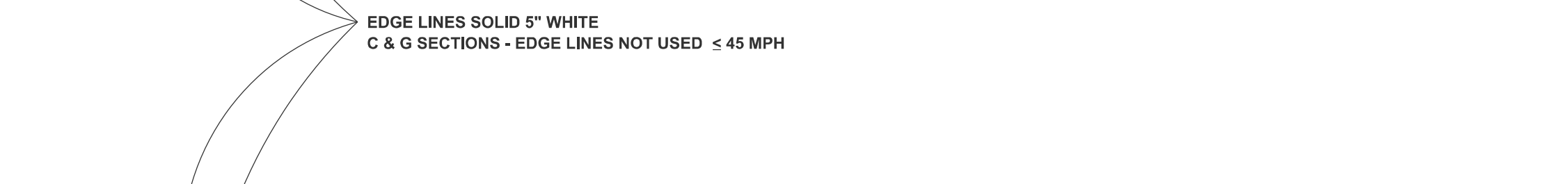
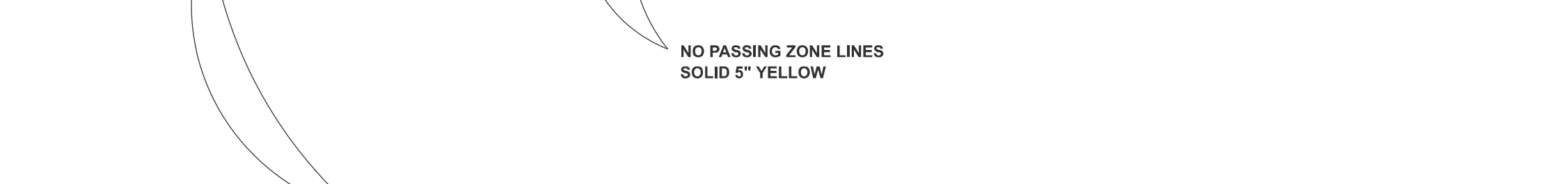
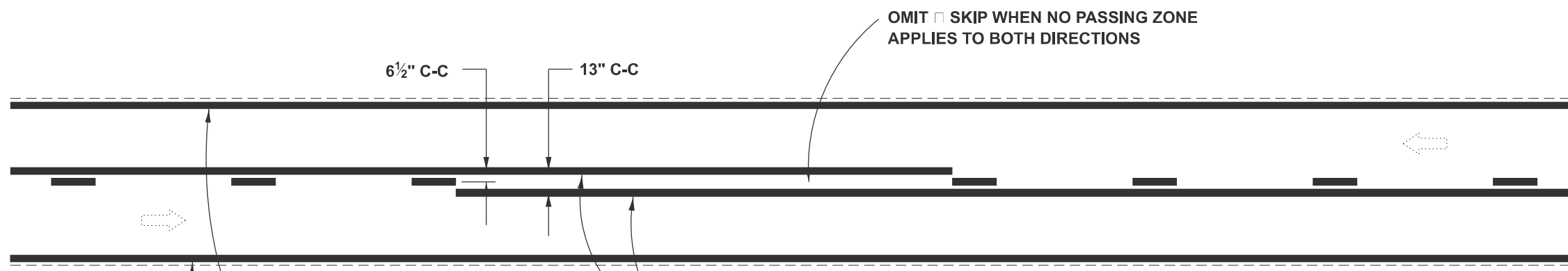

IF VERTICAL PROFILE OF ROADWAY IS CHANGED DURING CONSTRUCTION, "NO PASSING ZONES" ARE TO BE FIELD VERIFIED BY THE RESIDENT ENGINEER THE RESIDENT ENGINEER SHALL NOTIFY THE BUREAU OF OPERATIONS WITH ANY CONCERNS 14 DAYS PRIOR TO PERMANENT PAVEMENT MARKINGS.

2 LANE PAVEMENT

**ILLINOIS DEPARTMENT OF TRANSPORTATION
DISTRICT 6 PAVEMENT MARKING STANDARDS**

MODEL: Untitled (Sheet)
FILE NAME: c:\p\work\pavement\illinois.gov\1105810\72459_details.dgn

USER NAME = Iryna.Tsymbalyuk	DESIGNED -	REVISED -
	DRAWN -	REVISED -
	CHECKED -	REVISED -
PLOT DATE = 3/3/2026	DATE -	REVISED -

**STATE OF ILLINOIS
DEPARTMENT OF TRANSPORTATION**

D6 STANDARDS

SCALE: SHEET 1 OF 4 SHEETS STA. TO STA.

F.A.P. RTE.	SECTION	COUNTY	TOTAL SHEETS	SHEET NO.
558	120RS-3	PIKE	30	27
CONTRACT NO. 72459				
ILLINOIS FED. AID PROJECT				

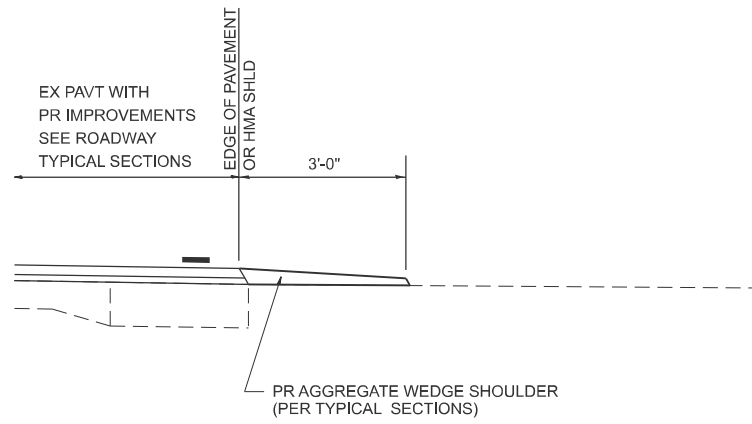

SECTION A-A FOR EX EARTH/ AGGREGATE FE

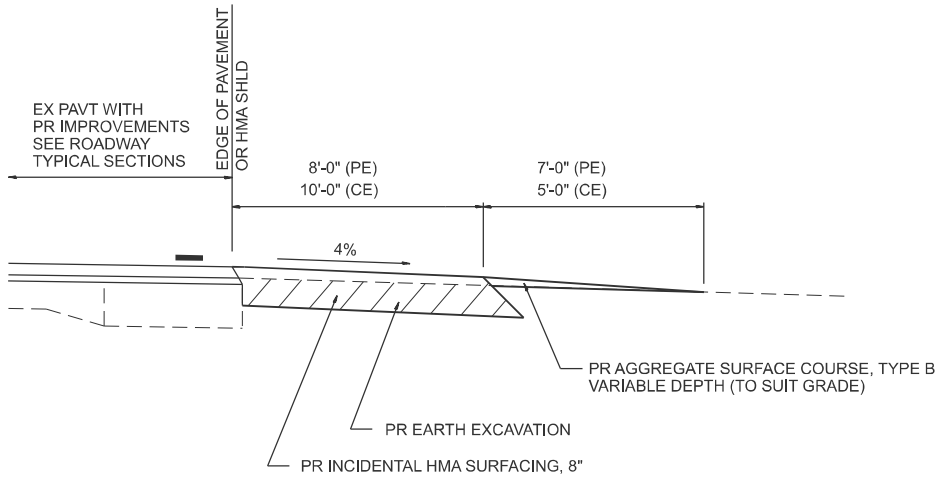

SECTION A-A FOR EX EARTH/AGGREGATE PE & CE

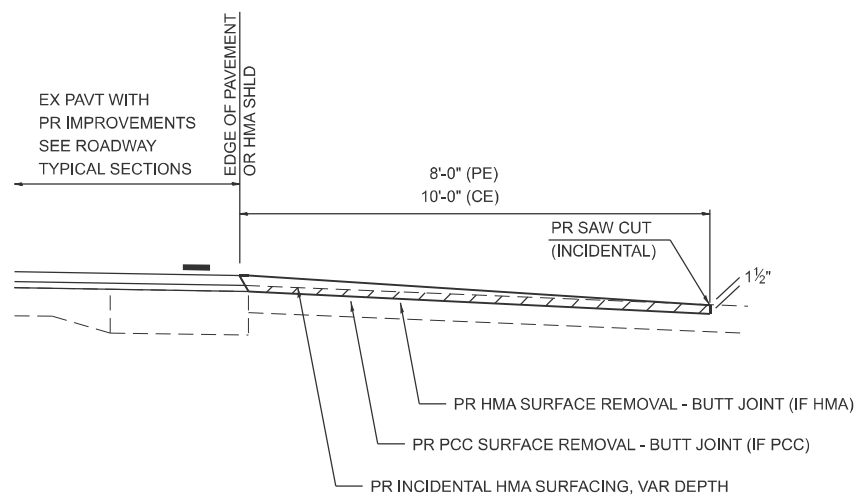

SECTION A-A FOR EX BITUMINOUS/ PC CONCRETE PE & CE

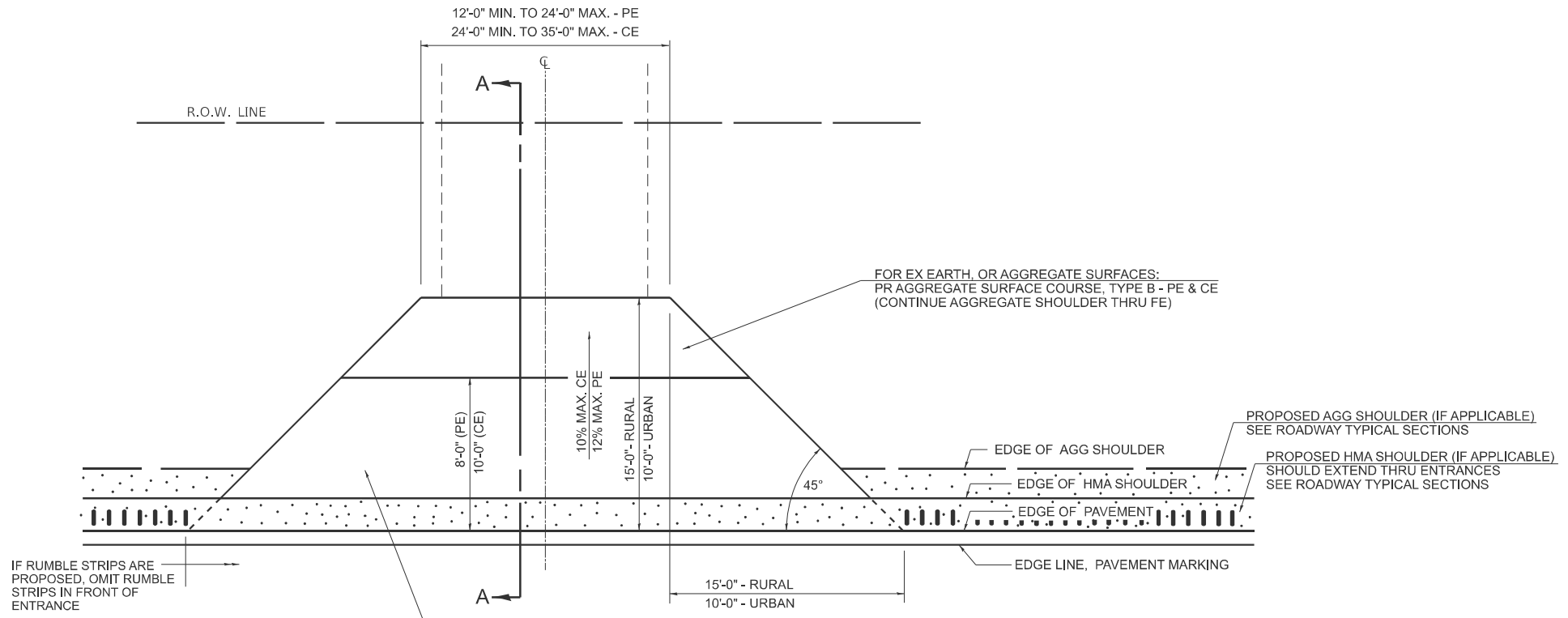

PLAN - ENTRANCE

GENERAL NOTES:

THE RESIDENT ENGINEER WILL DETERMINE THE EXACT TYPE OF IMPROVEMENT TO BE COMPLETED FOR ALL ENTRANCES, SIDEROADS, AND MAILBOX TURNOUTS ON THIS PROJECT.

THE PLAN DETAILS AND SCHEDULES SHOULD BE USED AS A GUIDE FOR THE ENGINEER TO IMPLEMENT THE FINAL DESIGN. THE ENGINEER MAY DECIDE TO SALVAGE PORTIONS OF THE EXISTING ENTRANCE PAVEMENT STRUCTURE, THEREBY REDUCING PAY ITEM QUANTITIES. NO ADDITIONAL PAYMENT WILL BE ALLOWED FOR THIS REDUCTION IN QUANTITIES.

ANY WORK THE ENGINEER REQUIRES WHICH IS NOT COVERED BY A PAY ITEM CONTAINED IN THE PLANS WILL BE PAID FOR ACCORDING TO ARTICLE 109.04 OF THE STANDARD SPECIFICATIONS.

INCIDENTAL HMA SURFACING REQUIRED TO CONSTRUCT THE ENTRANCES SHALL BE PLACED ACCORDING TO THE APPLICABLE PORTIONS OF SECTION 406 AND 408 OF THE STANDARD SPECIFICATIONS AND AS DIRECTED BY THE ENGINEER.

WHEN THE INCIDENTAL HMA SURFACING PROPOSED FOR THE IMPROVEMENT IS THICKER THAN 3 INCHES, THE CONTRACTOR WILL BE REQUIRED TO PLACE MORE THAN ONE LIFT. THE BOTTOM LIFT(S) SHALL MEET THE REQUIREMENTS OF HMA BASE COURSE IN SECTION 406 OF THE STANDARD SPECIFICATIONS AND THE TOP LIFT OF 1 1/2" INCHES SHALL MEET THE REQUIREMENTS OF HMA INCIDENTAL SURFACING.

THIS WORK WILL BE PAID FOR ACCORDING TO SECTIONS 351, 358, 408, 423 AND 440 OF THE STANDARD SPECIFICATIONS.

FOR SMART OVERLAYS (1 1/2" MILLING AND 1 1/2" RESURFACING PROJECTS), USE THE SAME STANDARDS AS SHOWN, OMITTING THE BINDER COURSE.

MODEL: Unlited-1 [Sheet]
FILE NAME: c:\p\work\pav\illinois.gov\1105810\72459_details.dgn

DIST. 6 DETAILS FOR RURAL/URBAN ENT. & MAILBOX TURNOUT W/O CONC. GUTTER (3P-PROJ.)

SHEET 1 OF 3
UPDATED 7/30/2025

USER NAME = Iryna.Tsymbalyuk	DESIGNED -	REVISED -
	DRAWN -	REVISED -
	CHECKED -	REVISED -
PLOT DATE = 3/3/2026	DATE -	REVISED -

**STATE OF ILLINOIS
DEPARTMENT OF TRANSPORTATION**

D6 STANDARDS			
SCALE:	SHEET 2	OF 4 SHEETS	STA. TO STA.

F.A.P. RTE.	SECTION	COUNTY	TOTAL SHEETS	SHEET NO.
558	120RS-3	PIKE	30	28
CONTRACT NO. 72459				
ILLINOIS FED. AID PROJECT				

DETAILS OF MAILBOX TURNOUTS

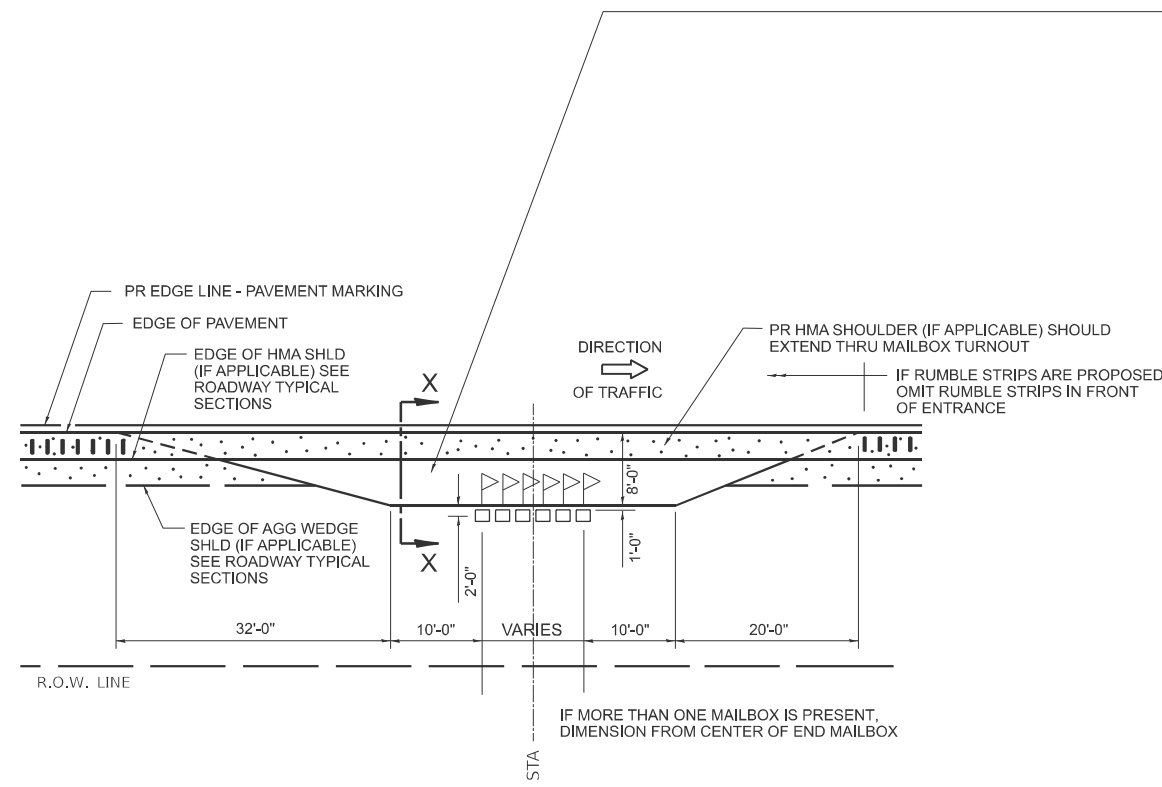

PLAN - MAILBOX TURNOUTS

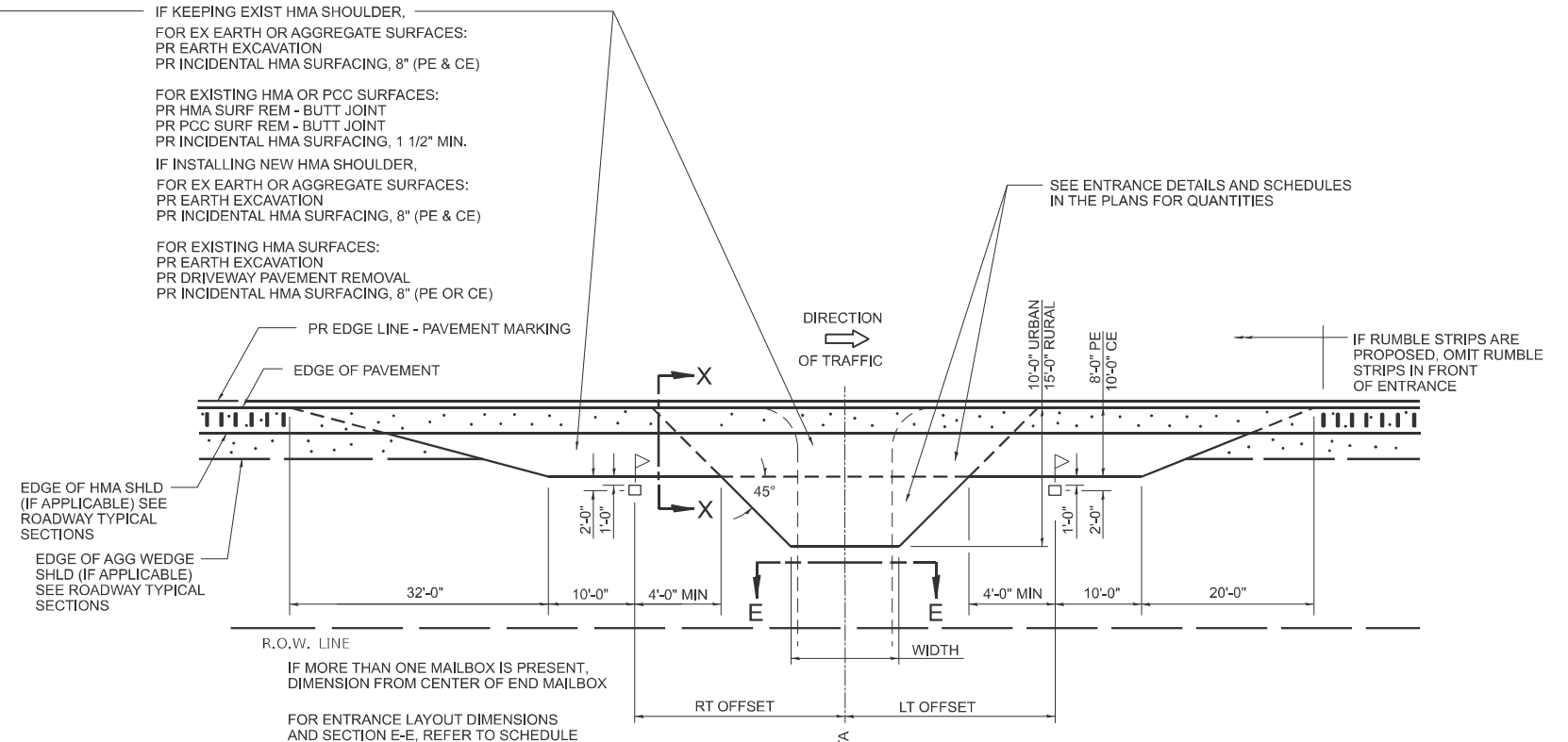

**PLAN - MAILBOX TURNOUTS
PLAN - COMBINED MAILBOX TURNOUT WITH TRAILING OR LEADING ENTRANCE**

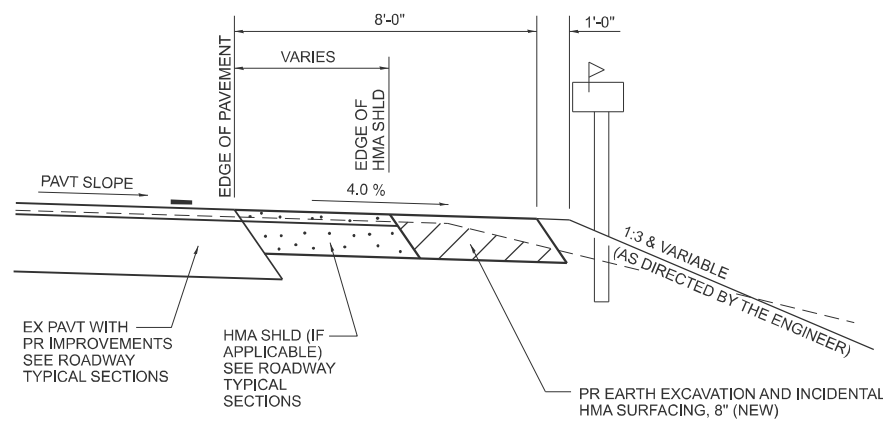

**SECTION X-X THRU MAILBOX TURNOUT
APPLIES TO MAILBOX TURNOUTS COMBINED WITH
EX EARTH OR AGGREGATE PE & FE**

(DETAIL APPLIES WHEN MAILBOX TURNOUT DOES NOT EXIST.
IF EXISTING, TREAT SAME AS ENTRANCE)

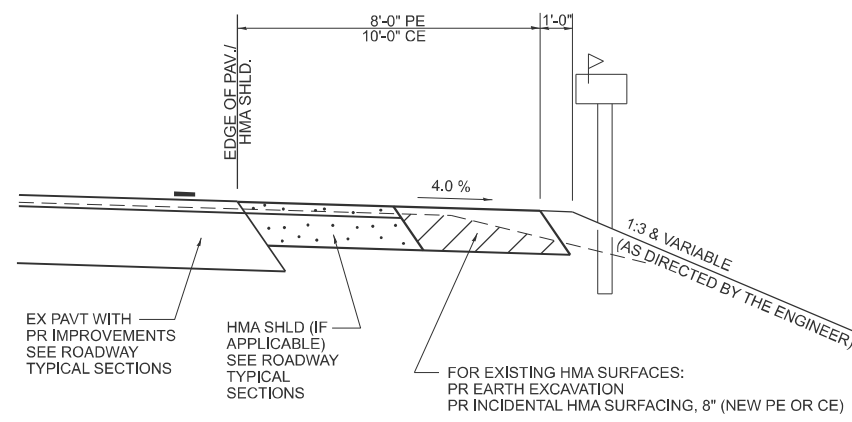

**SECTION X-X THRU MAILBOX TURNOUT
APPLIES TO MAILBOX TURNOUTS COMBINED WITH
EX HMA PE & CE WITH NEW HMA SHLD**

(DETAIL APPLIES WHEN MAILBOX TURNOUT DOES NOT EXIST.
IF EXISTING, TREAT SAME AS ENTRANCE)

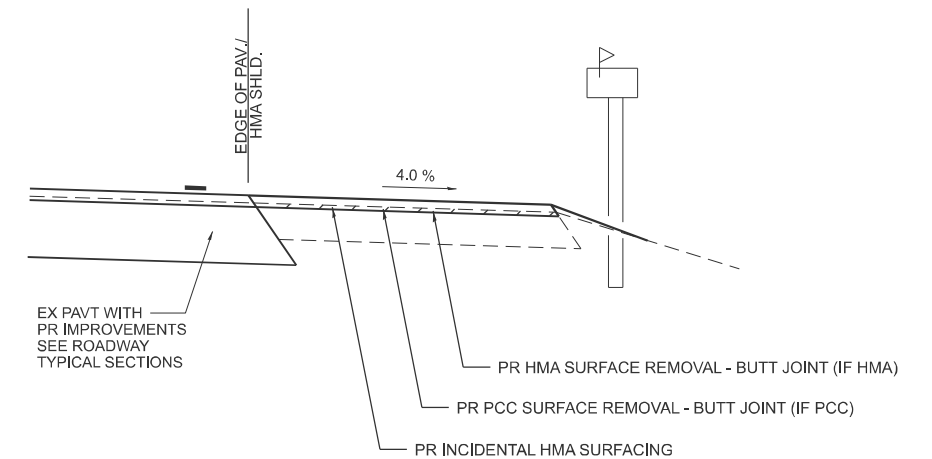

**SECTION X-X THRU MAILBOX TURNOUT
APPLIES TO MAILBOX TURNOUTS COMBINED WITH
EX HMA & PCC PE & CE W/O NEW HMA SHLD**

NOTE: IF THERE IS A NEW HMA SHOULDER PROPOSED, THEN THE ENTIRE EXISTING MB TURNOUT WILL BE REPLACED. IF THERE IS NO PROPOSED NEW HMA SHOULDER, THE EXISTING MB TURNOUT WILL BE MILLED AND RESURFACED.

**DIST. 6 DETAILS FOR RURAL/URBAN ENT., MAILBOX
TURNOUT & SIDEROADS W/O CONC. GUTTER (3P-PROJ.)**

SHEET 2 OF 3
UPDATED 7/30/2025

MODEL: Unlited-2 (Sheet)
FILE NAME: c:\p\work\pav\illinois.gov\1105810\72459_details.dgn

USER NAME = Iryna.Tsymbalyuk	DESIGNED -	REVISED -
	DRAWN -	REVISED -
	CHECKED -	REVISED -
PLOT DATE = 3/3/2026	DATE -	REVISED -

**STATE OF ILLINOIS
DEPARTMENT OF TRANSPORTATION**

D6 STANDARDS

SCALE: SHEET 3 OF 4 SHEETS STA. TO STA.

F.A.P. RTE.	SECTION	COUNTY	TOTAL SHEETS	SHEET NO.
558	120RS-3	PIKE	30	29
CONTRACT NO. 72459				
ILLINOIS FED. AID PROJECT				

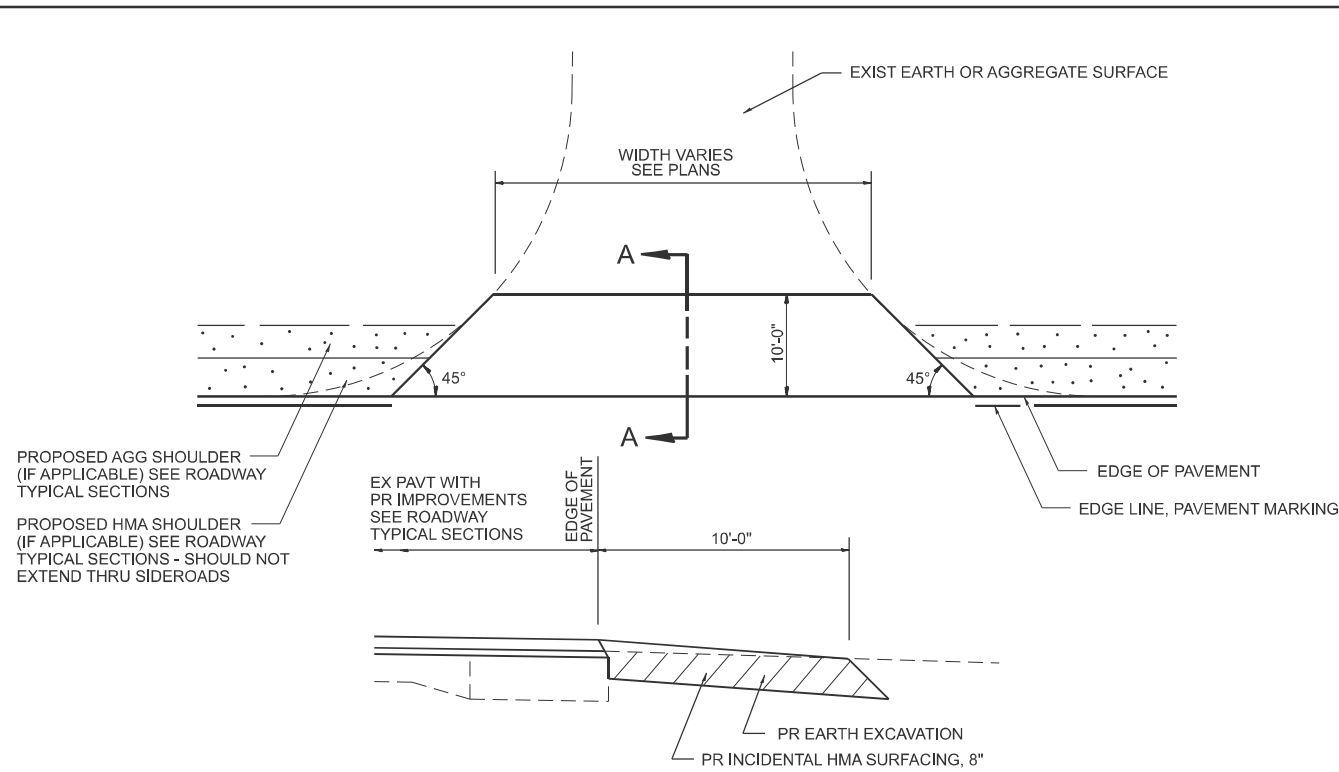

SECTION A-A
EXIST AGGREGATE SIDEROAD DETAIL
(NEW HMA APRON)

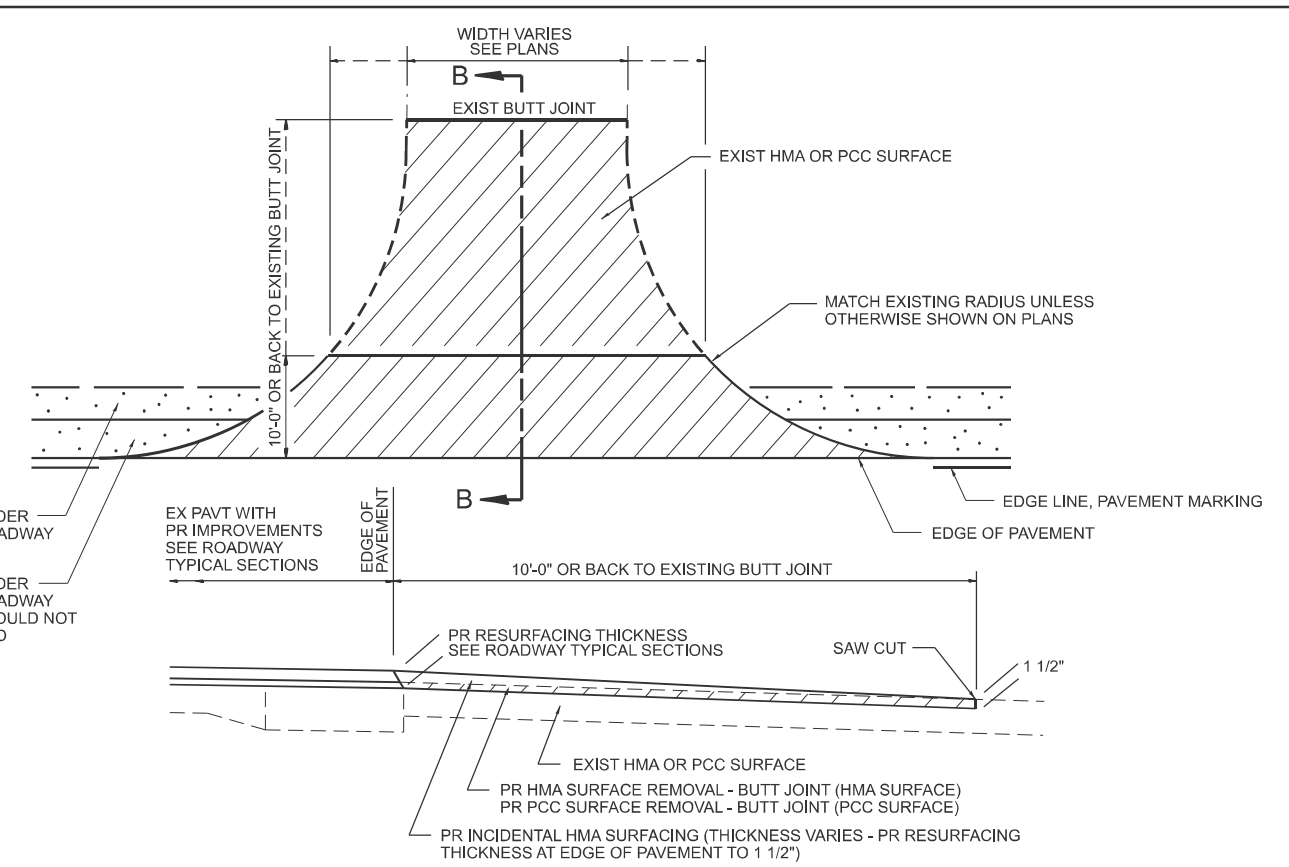

SECTION B-B
EXIST HMA OR PCC SIDEROAD DETAIL W/O CC&G (TO BE RESURFACED)

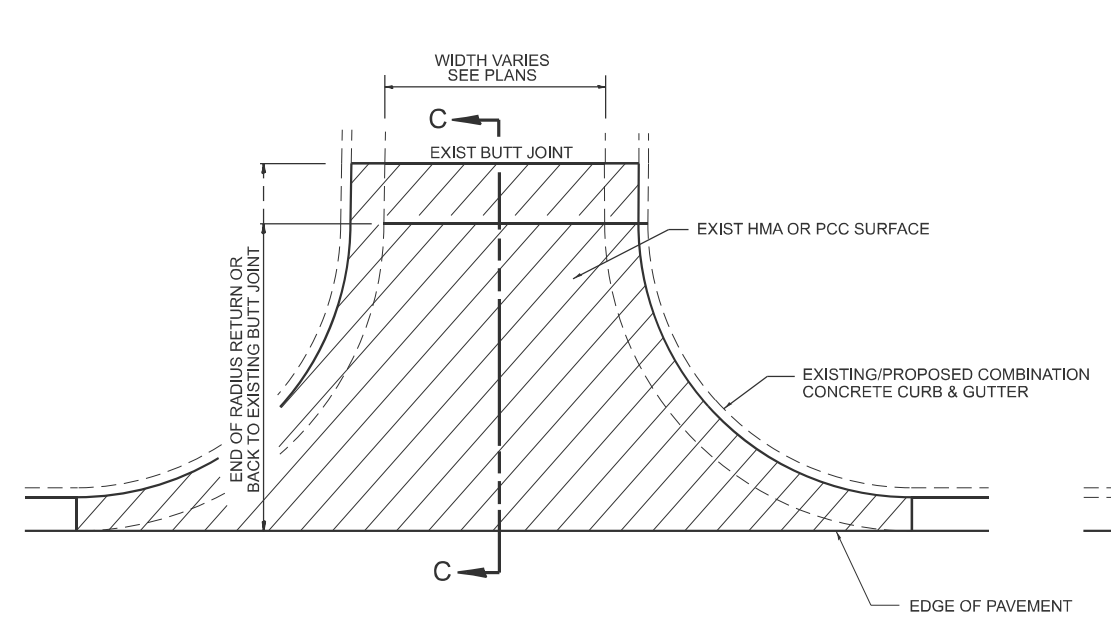

SECTION C-C
EXIST HMA SIDEROAD DETAIL W/CC&G
(TO BE RESURFACED)

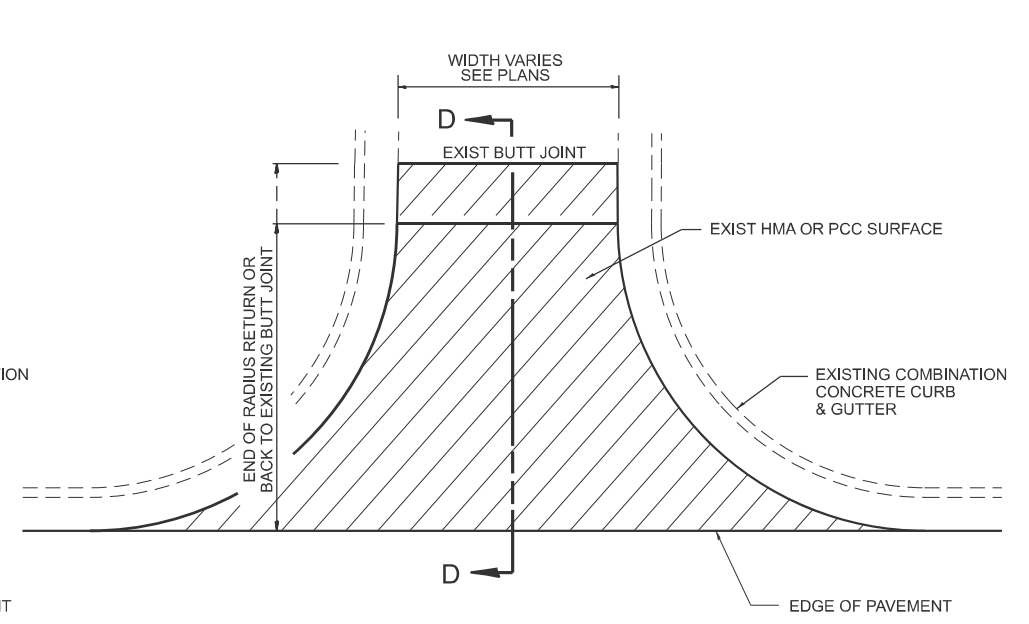

SECTION D-D
EXIST HMA OR PCC SIDEROAD DETAIL W/CC&G
(TO BE RESURFACED - MILL AND FILL ONLY)

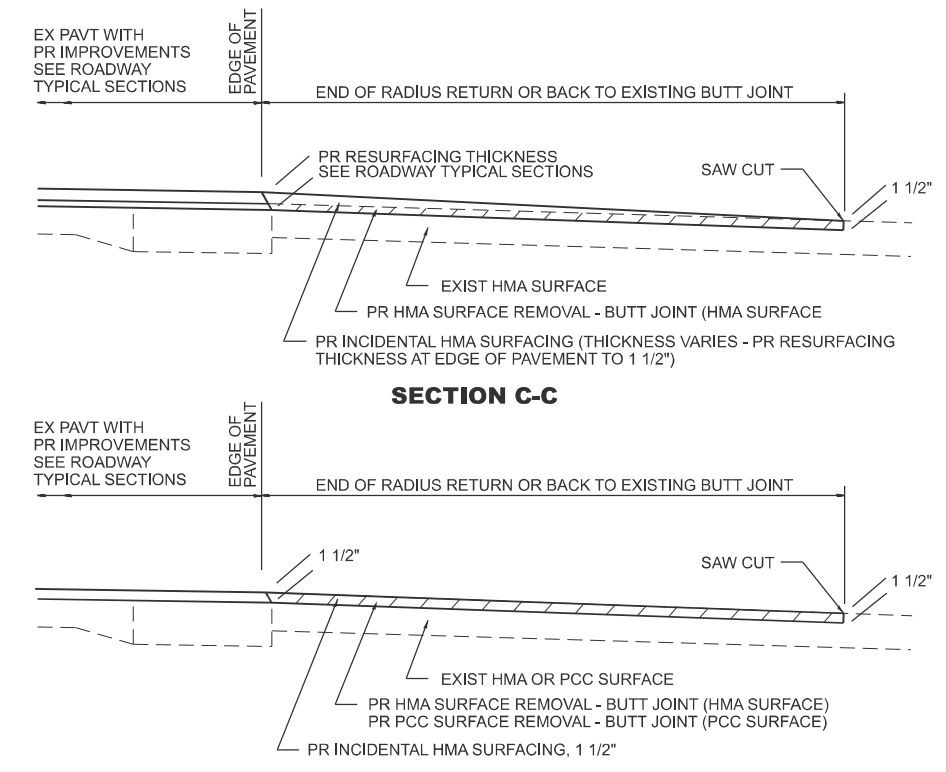

SECTION C-C

SECTION D-D

- NOTES:**
1. IF HMA SHOULDERS ARE PROPOSED, THEY SHOULD NOT EXTEND THROUGH SIDEROADS.
 2. THE COST OF SAW CUTS SHALL BE INCLUDED IN THE COST OF THE HMA SURFACE REMOVAL - BUTT JOINT OR PCC SURFACE REMOVAL - BUTT JOINT PAY ITEMS

DIST. 6 DETAILS FOR SIDEROADS (3P-PROJ.)

MODEL: Unlited-3 (Sheet)
FILE NAME: c:\p\work\pav\illinois.gov\ina.tsymbalyuk\illinois.gov\1105810\72459_details.dgn

USER NAME = Iryna.Tsymbalyuk	DESIGNED -	REVISED -
	DRAWN -	REVISED -
	CHECKED -	REVISED -
PLOT DATE = 3/3/2026	DATE -	REVISED -

STATE OF ILLINOIS
DEPARTMENT OF TRANSPORTATION

D6 STANDARDS

SCALE: SHEET 4 OF 4 SHEETS STA. TO STA.

F.A.P. RTE.	SECTION	COUNTY	TOTAL SHEETS	SHEET NO.
558	120RS-3	PIKE	30	30
CONTRACT NO. 72459				
ILLINOIS FED. AID PROJECT				