

STATE OF ILLINOIS  
DEPARTMENT OF TRANSPORTATION

F.A.P. RTE.	SECTION	COUNTY	TOTAL SHEETS	SHEET NO.
331	(5-3,1-4,1-3,1-2)LS-1	Williamson	13	1
		ILLINOIS	CONTRACT NO. D978C18	

FOR INDEX OF SHEETS, SEE SHEET NO. 3

PROPOSED  
HIGHWAY PLANS

FAP ROUTE 331 (IL 13)  
SECTION (5-3,1-4,1-3,1-2)LS-1

TREE PLANTING  
JACKSON AND WILLIAMSON COUNTIES

C-99-067-26

D99-035-26

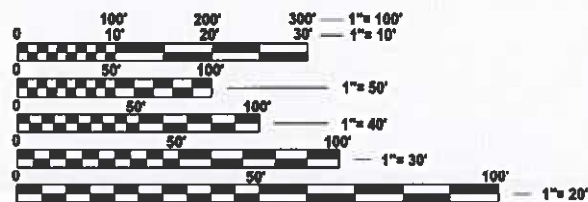

FULL SIZE PLANS HAVE BEEN PREPARED USING STANDARD ENGINEERING SCALES. REDUCED SIZED PLANS WILL NOT CONFORM TO STANDARD SCALES. IN MAKING MEASUREMENTS ON REDUCED PLANS, THE ABOVE SCALES MAY BE USED.

J.U.L.I.E.  
JOINT UTILITY LOCATION INFORMATION FOR EXCAVATION  
1-800-892-0123  
OR 811

PROJECT ENGINEER SEAN GREENLEE  
PROJECT MANAGER SEAN GREENLEE

CONTRACT NO. 78C18

STATE OF ILLINOIS  
DEPARTMENT OF TRANSPORTATION

SUBMITTED 3/26 2026  
Carrie Nelson <sup>SP</sup>  
REGIONAL ENGINEER

May 8 2026  
Sean Greenlee  
ENGINEER OF DESIGN AND ENVIRONMENT

May 8 2026  
Sean Greenlee <sup>5</sup>  
DIRECTOR OF HIGHWAYS PROJECT IMPLEMENTATION

PRINTED BY THE AUTHORITY  
OF THE STATE OF ILLINOIS

MODEL: SIGNATURE [Sheet]  
FILE NAME: c:\pwworkspace\greenlee\mtd\202791\0978C18\_SIG-INDEX-STND.dgn

Prepared By: *Susan Poe*  
DISTRICT STUDIES & PLANS ENGINEER

Examined By: *Nancy Lee*  
DISTRICT LAND ACQUISITION ENGINEER

Examined By: \_\_\_\_\_  
DISTRICT PROGRAM DEVELOPMENT ENGINEER

Examined By: *R. C. ...*  
DISTRICT OPERATIONS ENGINEER

Examined By: \_\_\_\_\_  
DISTRICT PROJECT IMPLEMENTATION ENGINEER

Examined By: *B. Smith*  
DISTRICT CONSTRUCTION ENGINEER

Examined By: *A. ...*  
DISTRICT MATERIALS ENGINEER

USER NAME = sean.greenlee	DESIGNED -	REVISED -
	DRAWN -	REVISED -
	CHECKED -	REVISED -
PLOT DATE = 3/19/2026	DATE -	REVISED -

**STATE OF ILLINOIS  
DEPARTMENT OF TRANSPORTATION**

**SIGNATURE SHEET**

SCALE: SHEET 1 OF 2 SHEETS STA. TO STA.

F.A.P. RTE.	SECTION	COUNTY	TOTAL SHEETS	SHEET NO.
331	(5-3.1-4.1-3.1-2)S-1	Williamson	13	2
CONTRACT NO. D978C18				
ILLINOIS FED. AID PROJECT				

# INDEX OF SHEETS

SHEET NO	DESCRIPTION
1	COVER SHEET
2	SIGNATURE SHEET
3	INDEX OF SHEETS, HIGHWAY STANDARDS, AND GENERAL NOTES
4	SUMMARY OF QUANTITIES
5	SCHEDULE
6-12	PLAN SHEETS
13	DETAIL: TREE PLANTING ON SLOPE

# HIGHWAY STANDARDS

- 000001-09 STANDARD SYMBOLS, ABBREVIATIONS, AND PATTERNS
- 001006 DECIMAL OF AN INCH AND OF A FOOT
- 701001-02 OFF-ROAD OPERATIONS, 2L, 2W, MORE THAN 15 FT (4.5M) AWAY
- 701006-05 OFF-ROAD OPERATIONS, 2L, 2W, 15 FT (4.5M) TO 24 (600MM) FROM PAVE
- 701101-05 OFF-ROAD OPERATIONS, MULTILANE, 15 FT (4.5M) TO 24 (600MM) FROM P
- 701106-02 OFF-ROAD OPERATIONS, MULTILANE, MORE THAN 15 FT (4.5M) AWAY
- 701801-06 SIDEWALK, CORNER OR CROSSWALK CLOSURE
- 701901-11 TRAFFIC CONTROL DEVICES
- 701306-04 LANE CLOSURE 2L, 2W SLOW MOVING OPERATIONS DAY ONLY, FOR SPEEDS >= 45 MPH

# COMMITMENTS

NONE

# GENERAL NOTES

NONE

MODEL: INDEX\_GENNOTES\_HGWYSTD (Sheet)  
 FILE NAME: c:\pwr\work\paw\sig\green\beam\1120279\1D978C18\_SIG-INDEX-STND.dgn

REV - MS

USER NAME = sean.greenlee	DESIGNED -	REVISED -	<b>STATE OF ILLINOIS</b> <b>DEPARTMENT OF TRANSPORTATION</b>	<b>INDEX OF SHEETS, HIGHWAY STANDARDS,</b> <b>COMMITMENTS, GENERAL NOTES</b>	F.A.P. RTE.	SECTION	COUNTY	TOTAL SHEETS	SHEET NO.	
	DRAWN -	REVISED -			331	(5-3.1-4.1-3.1-2)LS-1	Williamson	13	3	
	CHECKED -	REVISED -			CONTRACT NO. D978C18					
PLOT DATE = 3/24/2026	DATE -	REVISED -			SCALE:	SHEET 2	OF 2	SHEETS	STA.	TO STA.

# SUMMARY OF QUANTITIES

COUNTY:	JACKSON CO.	WILLIAMSON CO.
ROUTE:	IL 13 (FAP 331)	IL 13 (FAP 331)
FUNDING:	100 % STATE	100 % STATE
LOCATION:	URBAN	URBAN
	ROADWAY	ROADWAY
	0031	0031

CODE NUMBER	ITEM DESCRIPTION	UNIT	TOTAL QUANTITY	JACKSON CO.	WILLIAMSON CO.
67100100	MOBILIZATION	L SUM	1.0	0.5	0.5
70102640	TRAFFIC CONTROL AND PROTECTION, STANDARD 701801	L SUM	1.0	0.5	0.5
B2001167	TREE, CERCIS CANADENSIS (EASTERN REDBUD), 8' HEIGHT, BALLED AND BURLAPPED	EACH	60	17	43
B2002410	TREE, MAGNOLIA LOEBNERI MERRIL (MERRIL LOEBNER MAGNOLIA), 8' HEIGHT, CLUMP FORM, BALLED AND BURLAPPED	EACH	60	17	43
B2002566	TREE, MAGNOLIA STELLATA (STAR MAGNOLIA), 6' HEIGHT, SHRUB FORM, BALLED AND BURLAPPED	EACH	60	17	43
B2002670	TREE, MALUS ADAMS (ADAMS CRABAPPLE), 8' HEIGHT, CLUMP FORM, BALLED AND BURLAPPED	EACH	60	17	43
B2010168	TREE, CORNUS KOUSA (KOUSA DOGWOOD), 8' HEIGHT, BALLED AND BURLAPPED	EACH	60	17	43

MODEL: SOQ (Sheet)  
 FILE NAME: c:\pwworking\dwg\mtd120278\1D978C18\_SQ.dgn

USER NAME	• sean.greenlee	DESIGNED	-	REVISED	-
		DRAWN	-	REVISED	-
		CHECKED	-	REVISED	-
PLOT DATE	• 3/24/2026	DATE	-	REVISED	-

**STATE OF ILLINOIS  
DEPARTMENT OF TRANSPORTATION**

**SUMMARY OF QUANTITIES**

SCALE: SHEET 1 OF 1 SHEETS STA. TO STA.

F.A.P. RTE.	SECTION	COUNTY	TOTAL SHEETS	SHEET NO.
331	(5-3,1-4,1-3,1-2)LS-1	Williamson	13	4
CONTRACT NO. D978C18			ILLINOIS FED AID PROJECT	

## TREE SCHEDULE

LOCATION	TREE NAME					COMMENTS
	EASTERN REDBUD	MERRIL LOEBNER MAGNOLIA	STAR MAGNOLIA	ADAMS CRABAPPLE	KOUSA DOGWOOD	
	EACH	EACH	EACH	EACH	EACH	
MULTI-USE PATH - IL 13 EB STA. 223+40 TO 242+40	16	15	15	15	15	REED STATION RD. TO SPILLWAY RD. - 10' O/S FROM NORTH EDGE OF MULTI-USE PATH
MULTI-USE PATH - IL 13 EB STA. 266+20 TO 272+50	5	6	5	5	5	EAST OF SPILLWAY RD. - 20' O/S FROM NORTH EDGE OF MULTI-USE PATH
MULTI-USE PATH - COMMERCE DR. STA. 16+30 TO 26+30	5	5	6	6	5	MATCH EXISTING TREE LINE OFFSET
MULTI-USE PATH - COMMERCE DR. STA. 29+90 TO 30+70	1	1			1	40' SPACING - MATCH EXISTING TREE LINE OFFSET
MULTI-USE PATH - COMMERCE DR. STA. 34+60 TO 51+50	13	13	14	14	14	10' O/S FROM NORTH EDGE OF MULTI-USE PATH
WOLF CREEK NW GORE AREA - IL 13 WB STA. 512+65 TO 518+65	5	5	5	5	5	50' SPACING - 50' O/S FROM IL 13 EOP, 35' O/S FROM RAMP EOP
WOLF CREEK SW GORE AREA - IL 13 EB STA. 512+65 TO 518+65	5	5	5	5	5	50' SPACING - 50' O/S FROM IL 13 EOP, 35' O/S FROM RAMP EOP
WOLF CREEK NE GORE AREA - IL 13 EB STA. 519+90 TO 528+00	5	5	5	5	5	50' SPACING - 50' O/S FROM IL 13 EOP, 35' O/S FROM RAMP EOP
WOLF CREEK SE GORE AREA - IL 13 EB STA. 519+90 TO 525+00	5	5	5	5	5	50' SPACING - 50' O/S FROM IL 13 EOP, 35' O/S FROM RAMP EOP
<b>TOTAL</b>	<b>60</b>	<b>60</b>	<b>60</b>	<b>60</b>	<b>60</b>	

NOTE: TREE SPECIES TO BE PLANTED IN ALTERNATING ORDER

MODEL: Tree Schedule [Sheet]  
 FILE NAME: c:\pwworking\tds\greenlee\m1202791\0978C18\_S00.dgn

USER NAME * sean.greenlee	DESIGNED -	REVISED -
	DRAWN -	REVISED -
	CHECKED -	REVISED -
PLOT DATE * 3/30/2026	DATE -	REVISED -

**STATE OF ILLINOIS  
DEPARTMENT OF TRANSPORTATION**

**SCHEDULE**

SCALE: SHEET 1 OF 1 SHEETS STA. TO STA.

F.A.P. RTE.	SECTION	COUNTY	TOTAL SHEETS	SHEET NO.
331	(5-3,1-4,1-3,1-2)LS-1	Williamson	13	5
CONTRACT NO. D978C18				
ILLINOIS FED. AID PROJECT				

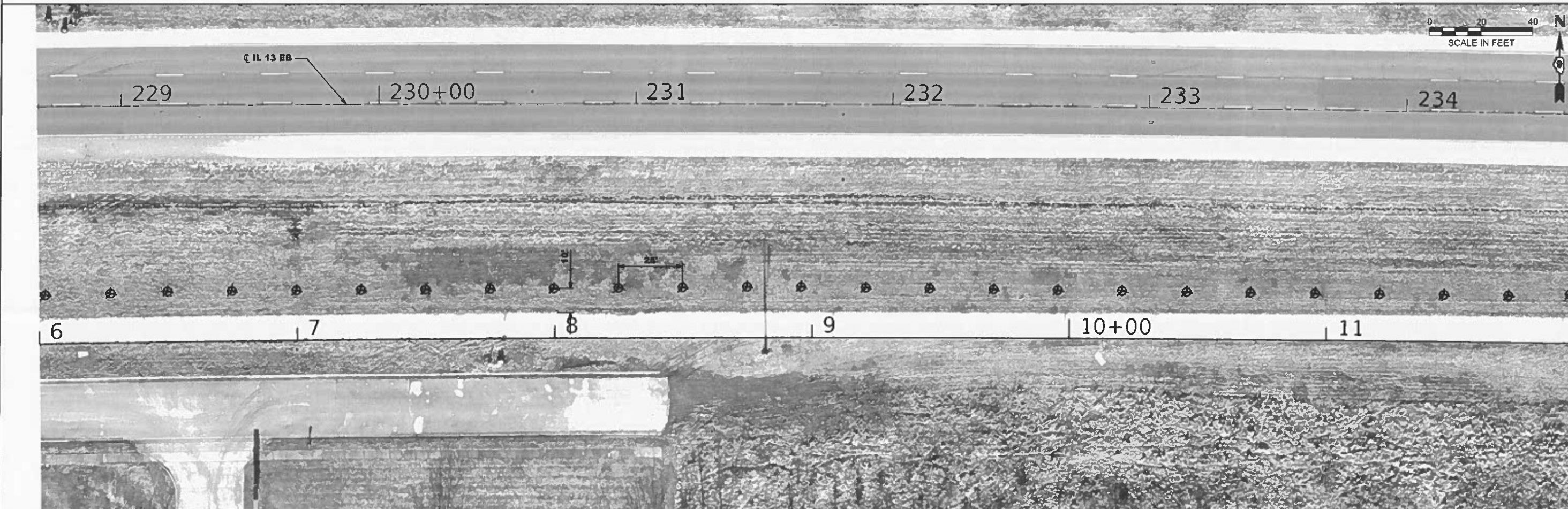
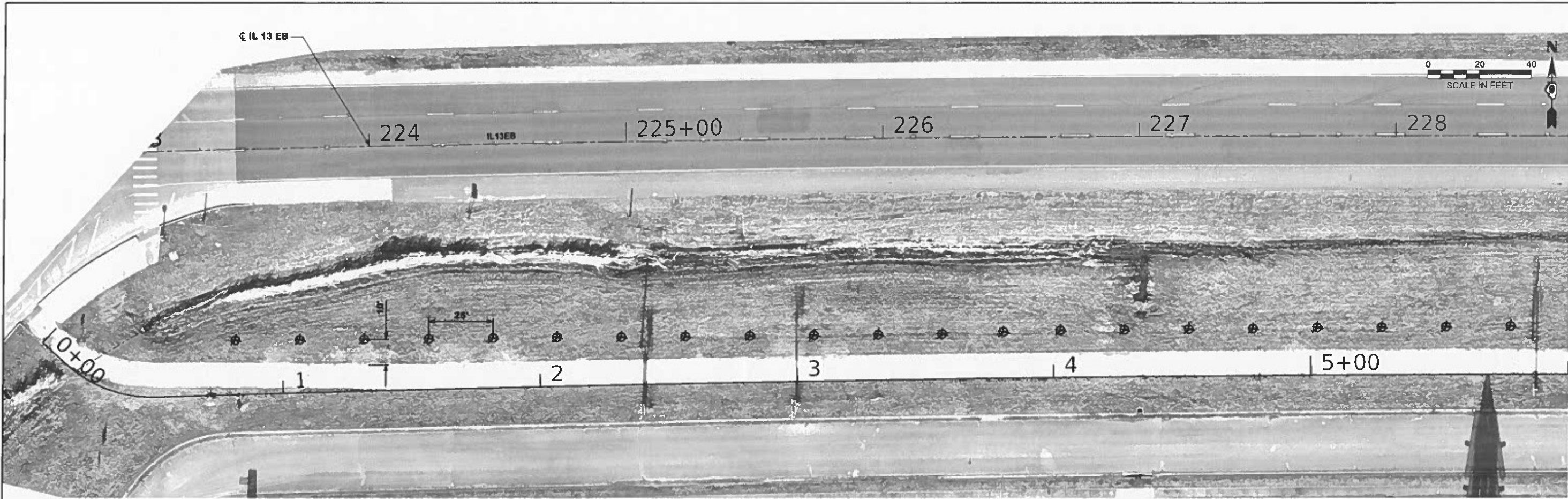

MODEL: East\_Reed - East\_Reed [Sheet]  
 FILE NAME: c:\pwworkspace\greenlee\122278\122278-18\_Plan-Sheets.dgn

USER NAME	• sean.greenlee	DESIGNED	-	REVISED	-
		DRAWN	-	REVISED	-
		CHECKED	-	REVISED	-
PLOT DATE	• 3/24/2026	DATE	-	REVISED	-

**STATE OF ILLINOIS**  
**DEPARTMENT OF TRANSPORTATION**

**PLAN VIEW - EAST OF REED STATION RD.**  
**1 OF 2**

SCALE: 1"=20'    SHEET 1 OF 7 SHEETS    STA. 0+00.0000 TO STA. 12+00.0001

F.A.P. RTE.	SECTION	COUNTY	TOTAL SHEETS	SHEET NO.
331	(6-3,1-4,1-3,1-2)LS-1	Williamson	13	6
CONTRACT NO. D978C18			ILLINOIS F.R.D. PROJECT	

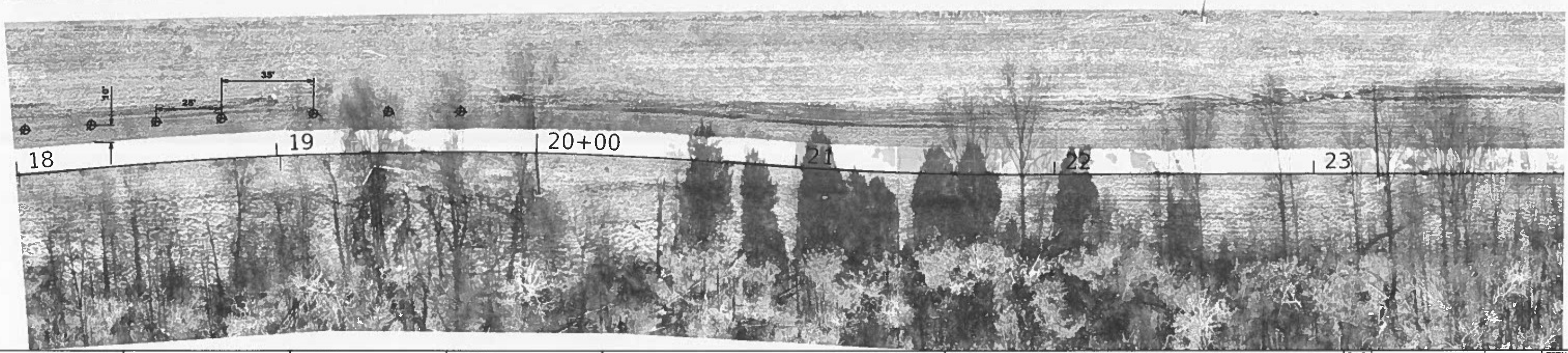
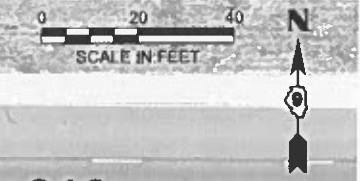
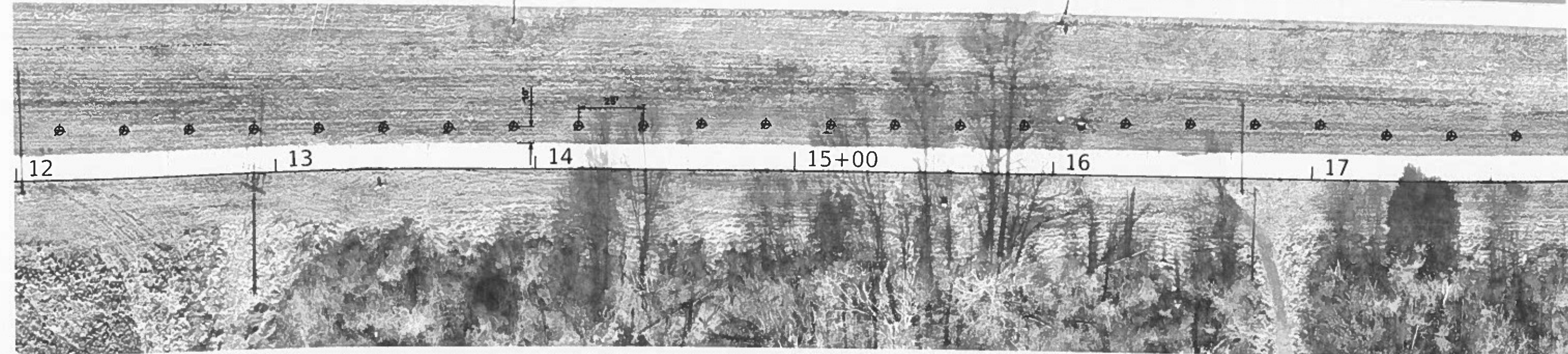
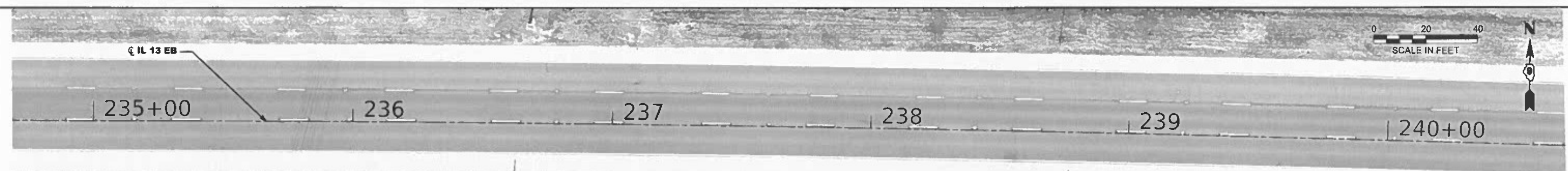
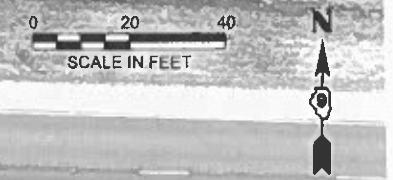

MODEL: East\_Read - East\_Read-2 (Sheet)  
 FILE NAME: C:\pwworking\illinois\1202791\0978C18\_Plan-Sheets.dwg

USER NAME = sean.greenlee	DESIGNED -	REVISED -
	DRAWN -	REVISED -
	CHECKED -	REVISED -
PLOT DATE = 3/24/2026	DATE -	REVISED -

**STATE OF ILLINOIS**  
**DEPARTMENT OF TRANSPORTATION**

**PLAN VIEW - EAST OF REED STATION RD.**  
**2 OF 2**

SCALE: 1"=20'    SHEET 2 OF 7 SHEETS    STA. 12+00.0001    TO STA. 24+00.0002

F.A.P. RTE.	SECTION	COUNTY	TOTAL SHEETS	SHEET NO.
331	(5-3,1-4,1-3,1-2)LS-1	Williamson	13	7
CONTRACT NO. D978C18				



MODEL: Unnamed Plan - East\_Spill [Sheet]  
 FILE NAME: c:\pw\work\pwrtd\greenlee\m\1202701\UD978C18\_Plan-Sheets.dgn

USER NAME = sean.greenlee	DESIGNED -	REVISED -
	DRAWN -	REVISED -
	CHECKED -	REVISED -
PLOT DATE = 3/24/2026	DATE -	REVISED -

**STATE OF ILLINOIS**  
**DEPARTMENT OF TRANSPORTATION**

**PLAN VIEW - EAST OF SPILLWAY RD.**

SCALE: 1"=30'    SHEET 3 OF 7 SHEETS    STA. 0+00.0000    TO STA. 9+00.0001

F.A.P. RTE.	SECTION	COUNTY	TOTAL SHEETS	SHEET NO.
331	(5-3.1-4.1-3.1-2)LS-1	Williamson	13	8
CONTRACT NO. D978C18				

ILLINOIS FED. AID PROJECT



MODEL: Commerce - Commerce [Sheet]  
 FILE NAME: c:\pwworking\sgreenlee\12027910978C18\_Plan-Sheets.dgn

USER NAME	= sean.greenlee	DESIGNED	-	REVISED	-
DRAWN	-	REVISIONS	-	REVISIONS	-
CHECKED	-	REVISIONS	-	REVISIONS	-
DATE	-	REVISIONS	-	REVISIONS	-
PLOT DATE	= 3/24/2026				

**STATE OF ILLINOIS**  
**DEPARTMENT OF TRANSPORTATION**

**PLAN VIEW - COMMERCE DR.**  
**WEST OF MAIN ST.**

SCALE: 1"=30'    SHEET 4    OF 7    SHEETS    STA. 1+36.17    TO STA. 19+36.17

F.A.P. RTE.	SECTION	COUNTY	TOTAL SHEETS	SHEET NO.
331	(5-3.1-4.1-3.1-2)LS-1	Williamson	13	9
CONTRACT NO. D978C18				



MODEL: Commerce - Commerce-2 (Sheet)  
 FILE NAME: c:\pwworking\sean.groenke\120279\1D978C18\_Plan-Sheets.dgn

USER NAME	sean.groenke	DESIGNED	-	REVISED	-
		DRAWN	-	REVISED	-
		CHECKED	-	REVISED	-
PLOT DATE	3/24/2026	DATE	-	REVISED	-

**STATE OF ILLINOIS**  
**DEPARTMENT OF TRANSPORTATION**

**PLAN VIEW - COMMERCE DR.**  
**EAST OF MAIN ST.**

SCALE: 1"=30'    SHEET 5 OF 7 SHEETS    STA. 19+36.17 TO STA. 37+36.17

F.A.P. RTE.	SECTION	COUNTY	TOTAL SHEETS	SHEET NO.
331	(5-3.1-4.1-3.1-2)LS-1	Williamson	13	10
CONTRACT NO. D978C18				



MODEL: Unnamed Plan-2 - Wolf Creek 1 [Sheet]  
 FILE NAME: \\pwwork\pwwork\beam\1202791\0978C18\_Plan-Sheets.dgn

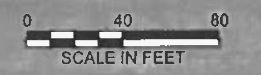

USER NAME	* sean.greerlee	DESIGNED	-	REVISED	-
		DRAWN	-	REVISED	-
		CHECKED	-	REVISED	-
PLOT DATE	* 3/24/2026	DATE	-	REVISED	-

**STATE OF ILLINOIS  
 DEPARTMENT OF TRANSPORTATION**

**PLAN VIEW - WOLF CREEK INTERCHANGE  
 NE AND SE**

SCALE: 1"=40'    SHEET 7 OF 7 SHEETS    STA. 15+55.1624 TO STA. 27+55.1625

F.A.P. RTE.	SECTION	COUNTY	TOTAL SHEETS	SHEET NO.
331	(5-3.1-4,1-3.1-2)LS-1	Williamson	13	12
CONTRACT NO. D978C18				

MODEL: Tree Planting on Slope (Sheet)  
 FILE NAME: c:\pwwork\pwwork\greenlee\sm\1202791\0978C18\_DETAILS.dgn

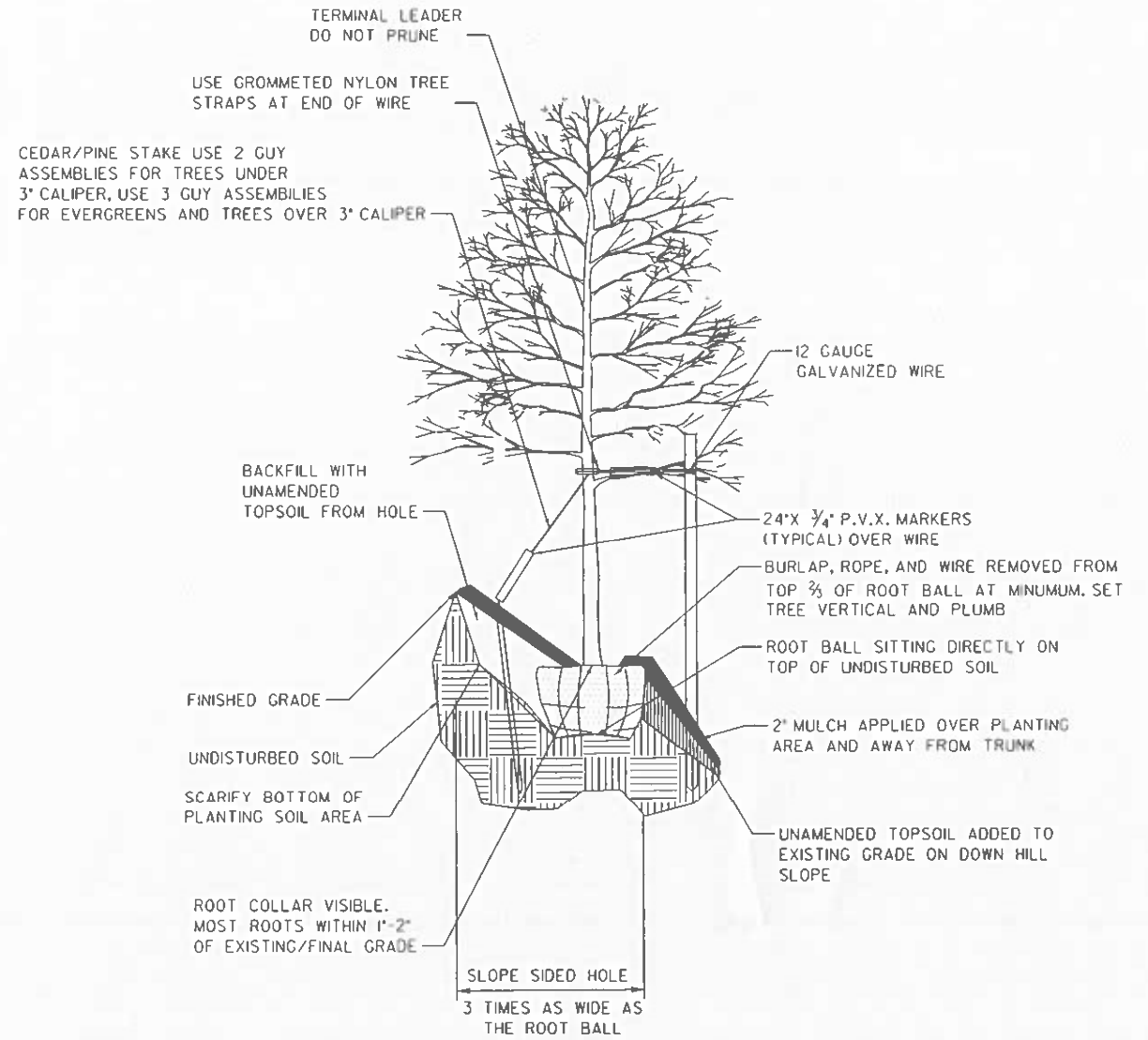

**TREE PLANTING DETAIL ON SLOPE**

**NOTES:**

1. ALL PLANTS SHALL BE MULCHED WITH 3 IN. MIN. OF HARDWOOD MULCH.
2. ALL TREES AND SHRUBS SHALL HAVE 2 FOOT RADIUS MIN. MULCH RING.
3. CONTRACTOR SHALL REMOVE ALL GROW STAKES, TAGS, RIBBONS, OR LABELS FROM ALL PLANTS.
4. BROKEN OR CRUMBLING ROOT BALLS WILL BE REJECTED.

USER NAME	sean.greenlee	DESIGNED	-	REVISED	-
		DRAWN	-	REVISED	-
		CHECKED	-	REVISED	-
PLOT DATE	3/19/2026	DATE	-	REVISED	-

**STATE OF ILLINOIS  
 DEPARTMENT OF TRANSPORTATION**

**DETAIL: TREE PLANTING ON SLOPE**

SCALE: SHEET 1 OF 1 SHEETS STA. TO STA.

F.A.P RTE	SECTION	COUNTY	TOTAL SHEETS	SHEET NO.
331	(5-3.1-4.1-3.1-2)LS-1	Williamson	13	13
CONTRACT NO. D978C18				
ILLINOIS FED AID PROJECT				