

A & B DIMENSIONS

Bar	A	B
p ₁ (E)	29'-2"	1'-7"
v ₂ (E)	11'-6"	1'-7"
v ₄ (E)	8'-9"	1'-7"
v ₆ (E)	10'-10"	1'-7"

BARS p₁(E), v₂(E), v₄(E) & v₆(E)

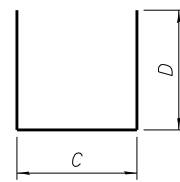

C & D DIMENSIONS

Bar	C	D
p ₃ (E)	20'-8"	1'-7"
p ₅ (E)	14'-5"	1'-7"
u ₁ (E)	2'-3"	1'-11"
u ₃ (E)	2'-3"	2'-3"

BARS p₃(E), p₅(E), u₁(E) & u₃(E)

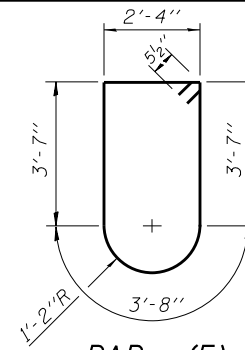

BAR s₂(E)

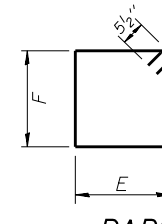

BARS s₁(E), s₄(E) & s₆(E)

E & F DIMENSIONS

Bar	E	F
s ₁ (E)	1'-6"	3'-8"
s ₄ (E)	3'-3"	2'-4"
s ₆ (E)	2'-3"	2'-4"

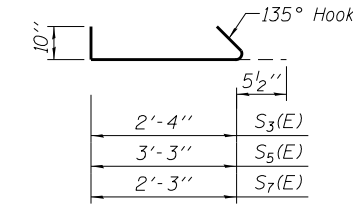

BARS s₃(E), s₅(E) & s₇(E)

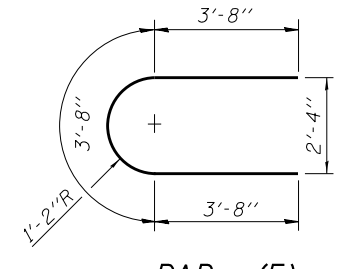

BAR u₂(E)

**PIER 1
BILL OF MATERIAL**

Bar	No.	Size	Length	Shape
d ₁ (E)	120	#6	3'-1"	—
h ₁ (E)	19	#5	47'-4"	—
h ₂ (E)	19	#5	20'-8"	—
h ₃ (E)	19	#5	14'-5"	—
h ₄ (E)	3	#5	5'-2"	—
h ₅ (E)	3	#5	17'-3"	—
p ₁ (E)	12	#9	30'-9"	┌┐
p ₂ (E)	7	#9	47'-3"	┌┐
p ₃ (E)	6	#9	23'-10"	┌┐
p ₄ (E)	7	#9	20'-8"	┌┐
p ₅ (E)	6	#9	17'-7"	┌┐
p ₆ (E)	7	#9	14'-5"	┌┐
s ₁ (E)	324	#5	11'-3"	□
s ₂ (E)	16	#5	14'-1"	○
s ₃ (E)	104	#5	3'-8"	┌┐
s ₄ (E)	24	#5	12'-1"	□
s ₅ (E)	24	#5	4'-7"	┌┐
s ₆ (E)	16	#5	10'-1"	□
s ₇ (E)	16	#5	3'-7"	┌┐
u ₁ (E)	24	#5	6'-1"	┌┐
u ₂ (E)	16	#5	11'-0"	┌┐
u ₃ (E)	60	#5	6'-9"	┌┐
v ₁ (E)	52	#7	6'-3"	—
v ₂ (E)	98	#9	13'-1"	┌┐
Concrete Structures			Cu. Yd.	71.8
Reinforcement Bars, Epoxy Coated			Pound	17,180
Concrete Sealer			Sq. Ft.	2,166

**PIER 2
BILL OF MATERIAL**

Bar	No.	Size	Length	Shape
h ₁ (E)	10	#5	47'-4"	—
h ₂ (E)	10	#5	20'-8"	—
h ₃ (E)	10	#5	14'-5"	—
h ₄ (E)	3	#5	5'-2"	—
h ₅ (E)	3	#5	17'-3"	—
p ₁ (E)	12	#9	30'-9"	┌┐
p ₂ (E)	7	#9	47'-3"	┌┐
p ₃ (E)	6	#9	23'-10"	┌┐
p ₄ (E)	7	#9	20'-8"	┌┐
p ₅ (E)	6	#9	17'-7"	┌┐
p ₆ (E)	7	#9	14'-5"	┌┐
s ₁ (E)	324	#5	11'-3"	□
s ₂ (E)	12	#5	14'-1"	○
s ₃ (E)	78	#5	3'-8"	┌┐
s ₄ (E)	18	#5	12'-1"	□
s ₅ (E)	18	#5	4'-7"	┌┐
s ₆ (E)	12	#5	10'-1"	□
s ₇ (E)	12	#5	3'-7"	┌┐
u ₁ (E)	24	#5	6'-1"	┌┐
u ₂ (E)	10	#5	11'-0"	┌┐
v ₁ (E)	52	#7	6'-3"	—
v ₄ (E)	98	#9	10'-4"	┌┐
Concrete Structures			Cu. Yd.	45.9
Reinforcement Bars, Epoxy Coated			Pound	14,120
Concrete Sealer			Sq. Ft.	1,371

**PIER 3
BILL OF MATERIAL**

Bar	No.	Size	Length	Shape
h ₁ (E)	10	#5	47'-4"	—
h ₂ (E)	10	#5	20'-8"	—
h ₃ (E)	10	#5	14'-5"	—
h ₄ (E)	3	#5	5'-2"	—
h ₅ (E)	3	#5	17'-3"	—
p ₁ (E)	12	#9	30'-9"	┌┐
p ₂ (E)	7	#9	47'-3"	┌┐
p ₃ (E)	6	#9	23'-10"	┌┐
p ₄ (E)	7	#9	20'-8"	┌┐
p ₅ (E)	6	#9	17'-7"	┌┐
p ₆ (E)	7	#9	14'-5"	┌┐
s ₁ (E)	324	#5	11'-3"	□
s ₂ (E)	12	#5	14'-1"	○
s ₃ (E)	78	#5	3'-8"	┌┐
s ₄ (E)	18	#5	12'-1"	□
s ₅ (E)	18	#5	4'-7"	┌┐
s ₆ (E)	12	#5	10'-1"	□
s ₇ (E)	12	#5	3'-7"	┌┐
u ₁ (E)	24	#5	6'-1"	┌┐
u ₂ (E)	10	#5	11'-0"	┌┐
v ₁ (E)	52	#7	6'-3"	—
v ₄ (E)	98	#9	10'-4"	┌┐
Concrete Structures			Cu. Yd.	45.3
Reinforcement Bars, Epoxy Coated			Pound	14,120
Concrete Sealer			Sq. Ft.	1,348

**PIER 4
BILL OF MATERIAL**

Bar	No.	Size	Length	Shape
d ₁ (E)	120	#6	3'-1"	—
h ₁ (E)	19	#5	47'-4"	—
h ₂ (E)	19	#5	20'-8"	—
h ₃ (E)	19	#5	14'-5"	—
h ₄ (E)	3	#5	5'-2"	—
h ₅ (E)	3	#5	17'-3"	—
p ₁ (E)	12	#9	30'-9"	┌┐
p ₂ (E)	7	#9	47'-3"	┌┐
p ₃ (E)	6	#9	23'-10"	┌┐
p ₄ (E)	7	#9	20'-8"	┌┐
p ₅ (E)	6	#9	17'-7"	┌┐
p ₆ (E)	7	#9	14'-5"	┌┐
s ₁ (E)	324	#5	11'-3"	□
s ₂ (E)	16	#5	14'-1"	○
s ₃ (E)	104	#5	3'-8"	┌┐
s ₄ (E)	24	#5	12'-1"	□
s ₅ (E)	24	#5	4'-7"	┌┐
s ₆ (E)	16	#5	10'-1"	□
s ₇ (E)	16	#5	3'-7"	┌┐
u ₁ (E)	24	#5	6'-1"	┌┐
u ₂ (E)	16	#5	11'-0"	┌┐
u ₃ (E)	60	#5	6'-9"	┌┐
v ₁ (E)	52	#7	6'-3"	—
v ₆ (E)	98	#9	12'-5"	┌┐
Concrete Structures			Cu. Yd.	70.2
Reinforcement Bars, Epoxy Coated			Pound	16,960
Concrete Sealer			Sq. Ft.	2,112

H:\projects\2011\0223\CAD\Structure\pier-bom.dgn
 3/27/2014 4:57:07 PM