

ROADWORK LEGEND

- (A) PROP. SIDEWALK REMOVAL
- PROP. PCC SIDEWALK RAMP (SEE HWY STDS ON SHEET 2)
- PROP. DETECTABLE WARNINGS
- SEE GENERAL NOTES

PROP. HOT-MIX ASPHALT SURFACE REMOVAL 2 1/4"
 PROPOSED H.M.A. SURFACE COURSE, MIX "D", N70, 1 1/2"
 PROP. POLY. LEVELING BINDER (MACHINE METHOD), IL-4.75, N50, 3/4"

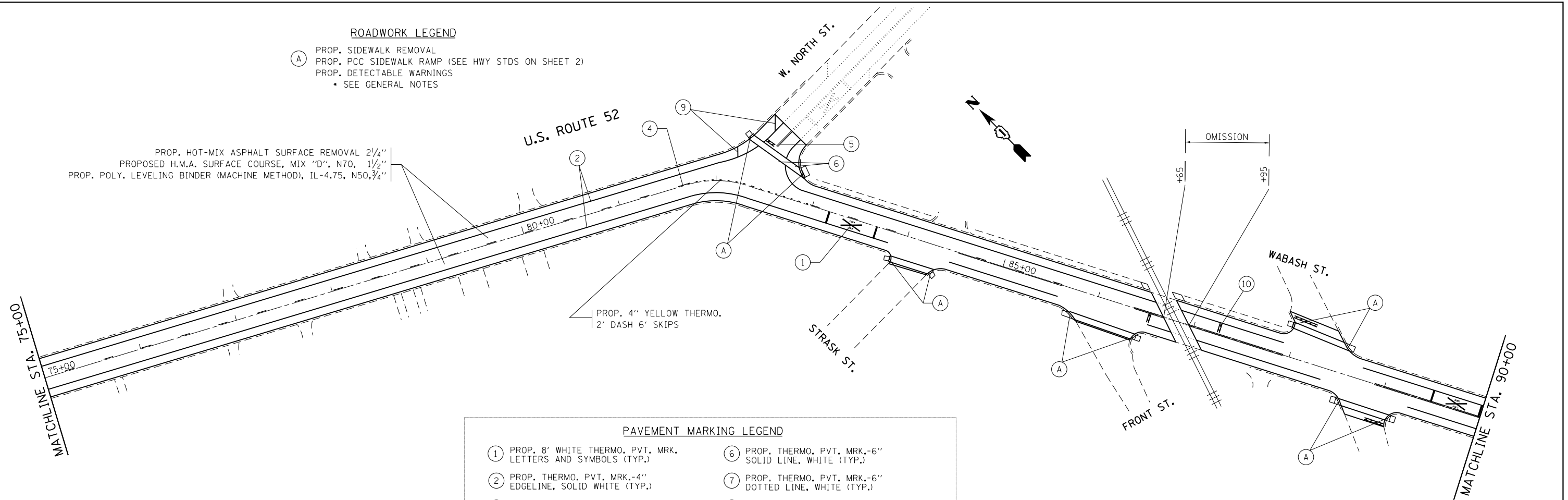

PAVEMENT MARKING LEGEND

- | | |
|---|--|
| (1) PROP. 8' WHITE THERMO. PVT. MRK. LETTERS AND SYMBOLS (TYP.) | (6) PROP. THERMO. PVT. MRK.-6" SOLID LINE, WHITE (TYP.) |
| (2) PROP. THERMO. PVT. MRK.-4" EDGELINE, SOLID WHITE (TYP.) | (7) PROP. THERMO. PVT. MRK.-6" DOTTED LINE, WHITE (TYP.) |
| (3) PROP. THERMO. PVT. MRK.-4" YELLOW NO PASSING ZONE LINE (TYP.) | (8) PROP. THERMO. PVT. MRK.-12" DIAGONAL, YELLOW (TYP.) |
| (4) PROP. THERMO. PVT. MRK.-4" SKIP-DASH, SINGLE YELLOW (TYP.) | (9) PROP. THERMO. PVT. MRK.-12" DIAGONAL, WHITE (TYP.) |
| (5) PROP. THERMO. PVT. MRK.-4" CENTERLINE, DOUBLE YELLOW (TYP.) | (10) PROP. THERMO. PVT. MRK.-24" STOP LINE, WHITE (TYP.) |

NOTE:
 ALL FINAL PAVEMENT MARKINGS SHALL BE PLACED IN ACCORDANCE WITH DISTRICT ONE TYPICAL PAVEMENT MARKINGS (TC-13) DETAIL.

PROP. HOT-MIX ASPHALT SURFACE REMOVAL 2 1/4"
 PROPOSED H.M.A. SURFACE COURSE, MIX "D", N70, 1 1/2"
 PROP. POLY. LEVELING BINDER (MACHINE METHOD), IL-4.75, N50, 3/4"

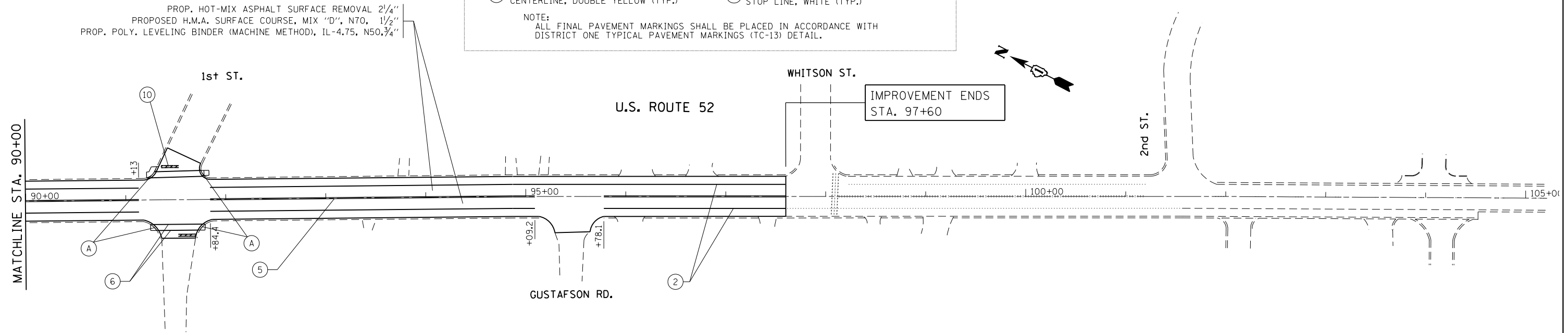

NOTE:
 WHERE GUARDRAILS ARE PRESENT ON HMA SHOULDER THE MILLING AND RESURFACING LIMIT SHALL BE A MINIMUM OF ONE FOOT AWAY FROM THE GUARDRAIL FACE.

FILE NAME =	USER NAME = paraynoal	DESIGNED -	REVISED -
ei:\pwork\pwork\paraynoal\00383138\012411-sh-t-plan.dgn		DRAWN -	REVISED -
Default	PLOT SCALE = 100.0000' / in.	CHECKED -	REVISED -
	PLOT DATE = 5/2/2014	DATE -	REVISED -

**STATE OF ILLINOIS
 DEPARTMENT OF TRANSPORTATION**

**ROADWAY AND PAVEMENT MARKING PLAN
 U.S. ROUTE 52 (COUGAR ROAD - 0.1 MI W/O 2nd STREET)**

SCALE: 1"=50' SHEET OF SHEETS STA. TO STA.

F.A.P. RTE.	SECTION	COUNTY	TOTAL SHEETS	SHEET NO.
852	18-RS-7	WILL	22	9
CONTRACT NO. 60N07				
ILLINOIS FED. AID PROJECT				