

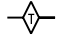



EROSION CONTROL LEGEND

-  INLET AND PIPE PROTECTION
-  TEMPORARY DITCH CHECK
-  PERIMETER EROSION BARRIER
-  TEMPORARY EROSION CONTROL SEEDING WITH MULCH METHOD 4
-  INLET FILTER
-  SEDIMENT BASIN
-  DITCH FLOW
-  DRAINAGE SUMMIT

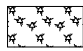
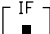

DRAINAGE AREA = 1.95 ACRES
 STORAGE SIZE = 263 CY
 LENGTH = 142 FT
 WIDTH = 10 FT
 DEPTH = 5 FT

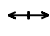
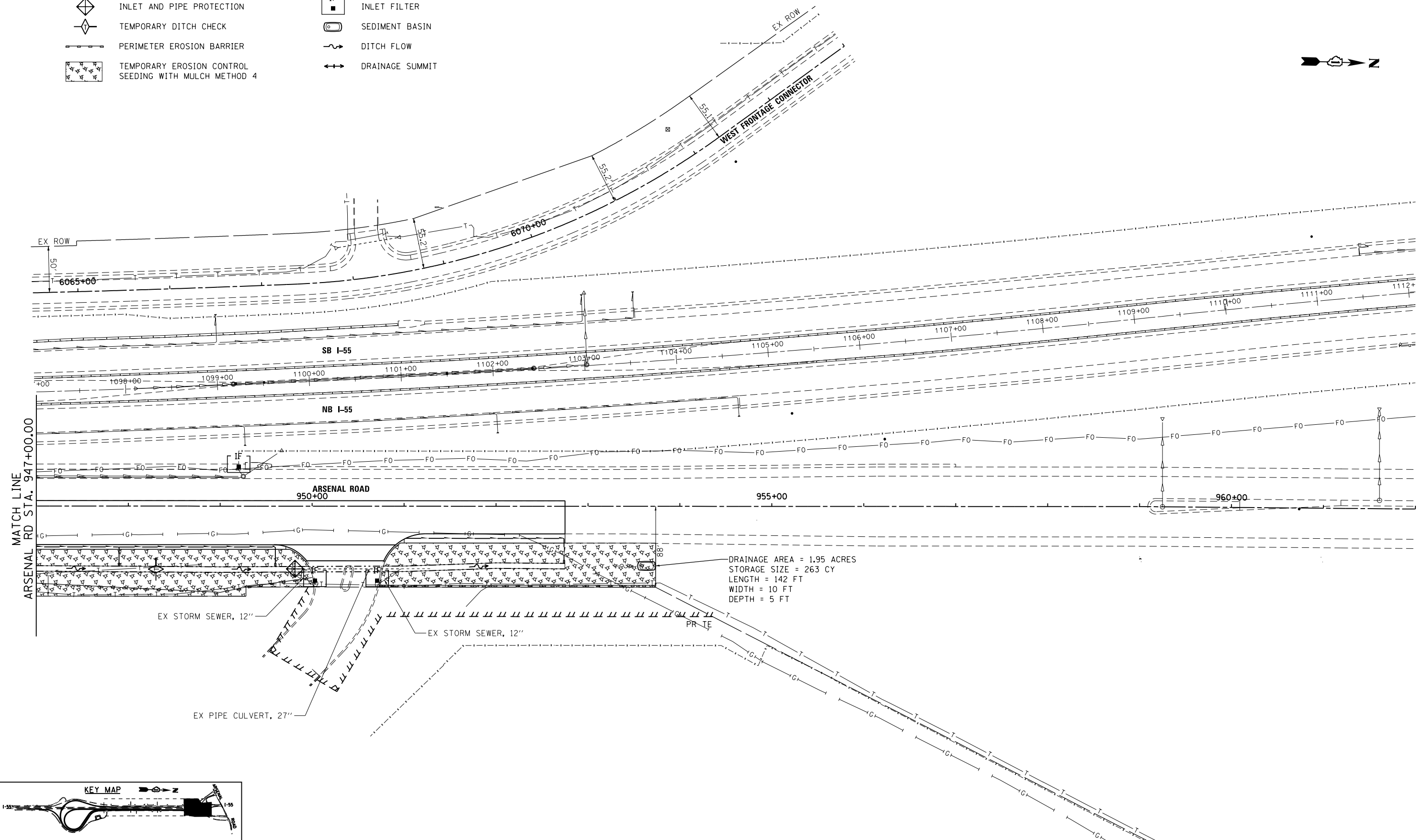
MATCH LINE
 ARSENAL RD STA. 947+00.00

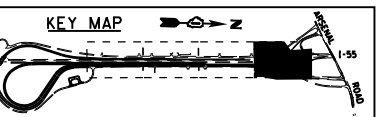

FILE NAME = S:\JOLI\63300-63999\6346-045\Micros\CADD Sheets\0168P51-SHT-EROSION.dgn

	1170 SOUTH HOUBOLT ROAD JOLIET, ILLINOIS 60431 (815) 744-4200	USER NAME = dennisw MODEL NAME = Default PLOT SCALE = 100.0000' / in. PLOT DATE = 2/18/2014	DESIGNED - MAG DRAWN - JKP/DJW CHECKED - BMA DATE - 12-5-12	REVISED - REVISED - REVISED - REVISED -	STATE OF ILLINOIS DEPARTMENT OF TRANSPORTATION	TEMPORARY SEDIMENT & EROSION CONTROL	SCALE: 1"=50'	SHEET 3 OF 3 SHEETS	STA. 947+00.00 TO STA. 962+00.00	F.A.I. RTE. 55	SECTION 99-IAC-2	COUNTY WILL	TOTAL SHEETS 102	SHEET NO. 40	CONTRACT NO. 60P51 ILLINOIS FED. AID PROJECT