

DATE	
BY	
FINAL SURVEY	SURVEYED
NOTE BOOK	PLOTTED
NO.	TEMPLATE
	AREAS CHECKED

DATE	
BY	
ORIGINAL SURVEY	SURVEYED
NOTE BOOK	PLOTTED
NO.	TEMPLATE
	AREAS CHECKED

FILE NAME = S:\JUL 063800 - 6399\6346\048\3\WIP\04\00_Sheets\063800_511-XSSH1.dgn

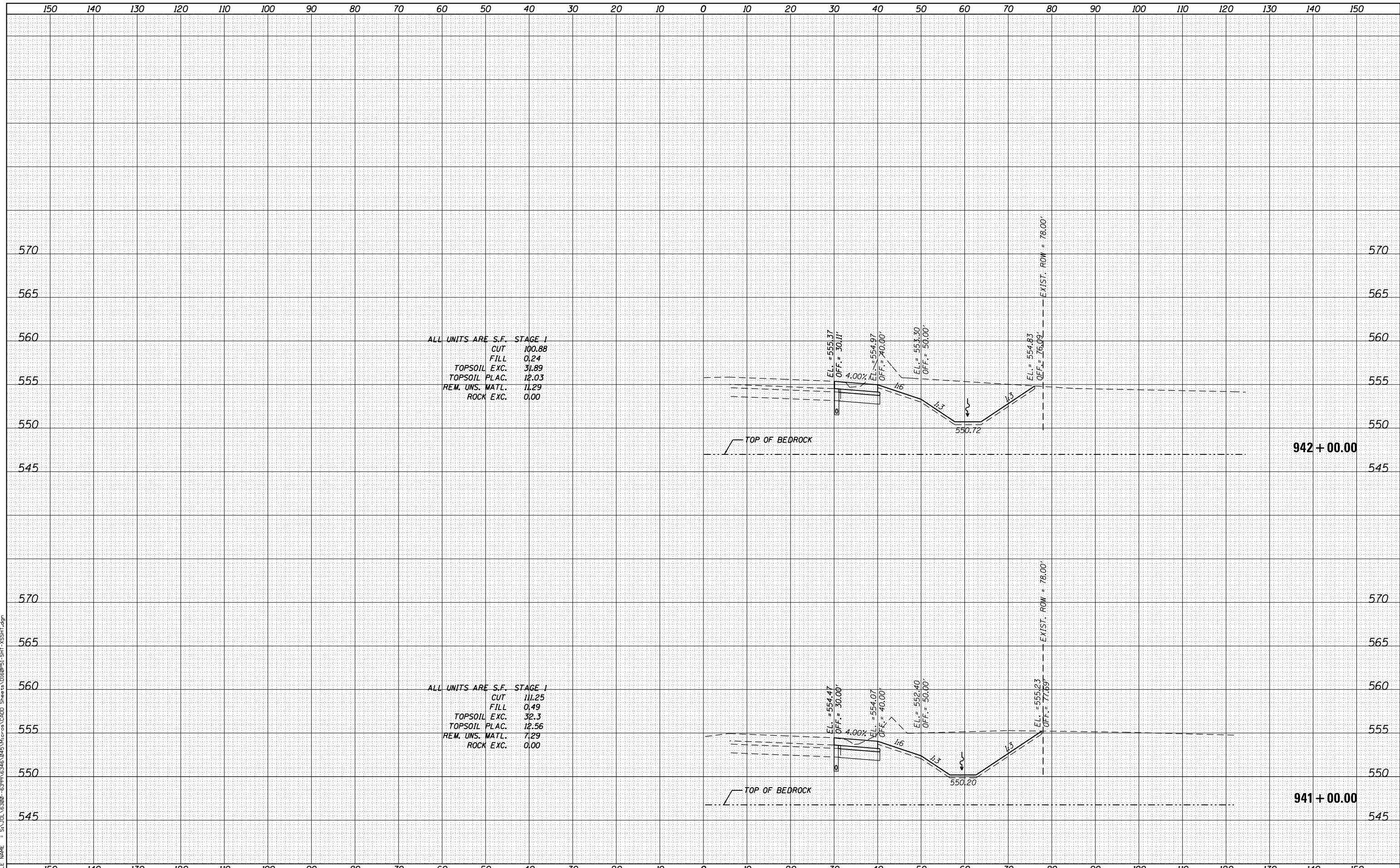

ALL UNITS ARE S.F. STAGE 1

CUT	100.88
FILL	0.24
TOPSOIL EXC.	31.89
TOPSOIL PLAC.	12.03
REM. UNS. MATL.	11.29
ROCK EXC.	0.00

ALL UNITS ARE S.F. STAGE 1

CUT	111.25
FILL	0.49
TOPSOIL EXC.	32.3
TOPSOIL PLAC.	12.56
REM. UNS. MATL.	7.29
ROCK EXC.	0.00

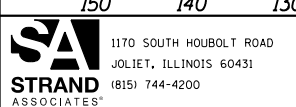

USER NAME = dennisw	DESIGNED - MAG	REVISED -
MODEL NAME = Default	DRAWN - JKP/DJW	REVISED -
PLOT SCALE = 20.0000' / in.	CHECKED - BMA	REVISED -
PLOT DATE = 2/18/2014	DATE - 12-5-12	REVISED -

STATE OF ILLINOIS
DEPARTMENT OF TRANSPORTATION

ARSENAL ROAD CROSS SECTIONS
SCALE: 1" = 10'H 1" = 5'V SHEET 13 OF 20 SHEETS STA. 941+00.00 TO STA. 942+00.00

F.A.I. RTE.	SECTION	COUNTY	TOTAL SHEETS	SHEET NO.
55	99-IAC-2	WILL	102	95
CONTRACT NO. 60P51				

ILLINOIS FED. AID PROJECT