

- NOTES:
1. SEE SCHEDULE FOR EXACT LIMITS OF COMBINATION GUTTER REMOVAL AND GUARDRAIL REMOVAL.
 2. GUARDRAIL REMOVAL LIMITS WILL BE ADJUSTED BASED UPON FIELD CONDITIONS.
 3. SAWCUTTING INCLUDED IN COST OF PAVEMENT REMOVAL.
 4. SLOPE WALL REMOVAL AND WING WALL REMOVAL WILL BE INCLUDED IN THE COST OF REMOVAL OF EXISTING STRUCTURES
 5. ALL NECESSARY MEASURES TO PROTECT PUBLIC SAFETY DURING THE REMOVAL OF THE BLODGETT ROAD STRUCTURE OVER FAI 55 NOT OTHERWISE SPECIFIED WILL BE INCLUDED IN THE COST OF REMOVAL OF EXISTING STRUCTURES.
 6. CONTRACTOR SHALL INSPECT EXISTING PROTECTIVE SHIELD ON THE BLODGETT ROAD STRUCTURE OVER FAI 55 FOR STRUCTURAL ADEQUACY. INADEQUATE PROTECTIVE SHIELD OR UNPROTECTED AREAS SHALL BE PROTECTED BY PROTECTIVE SHIELD, TO BE PAID FOR AS PROTECTIVE SHIELD.
 6. CONTRACTOR SHALL REMOVE PIER AND PIER FOOTINGS FROM BLODGETT ROAD OVER FAI 55 AT PROPOSED LOCATIONS OF GUARDRAIL POSTS (TO BE DETERMINED BY CONTRACTOR) TO SUFFICIENT DEPTH AND WIDTH TO ACCOMMODATE NEW GUARDRAIL. THE COST OF THIS REMOVAL WILL BE INCLUDED IN THE COST OF THE REMOVAL OF EXISTING STRUCTURES.
 7. CULVERTS UNDER SLOPE WALLS TO REMAIN.

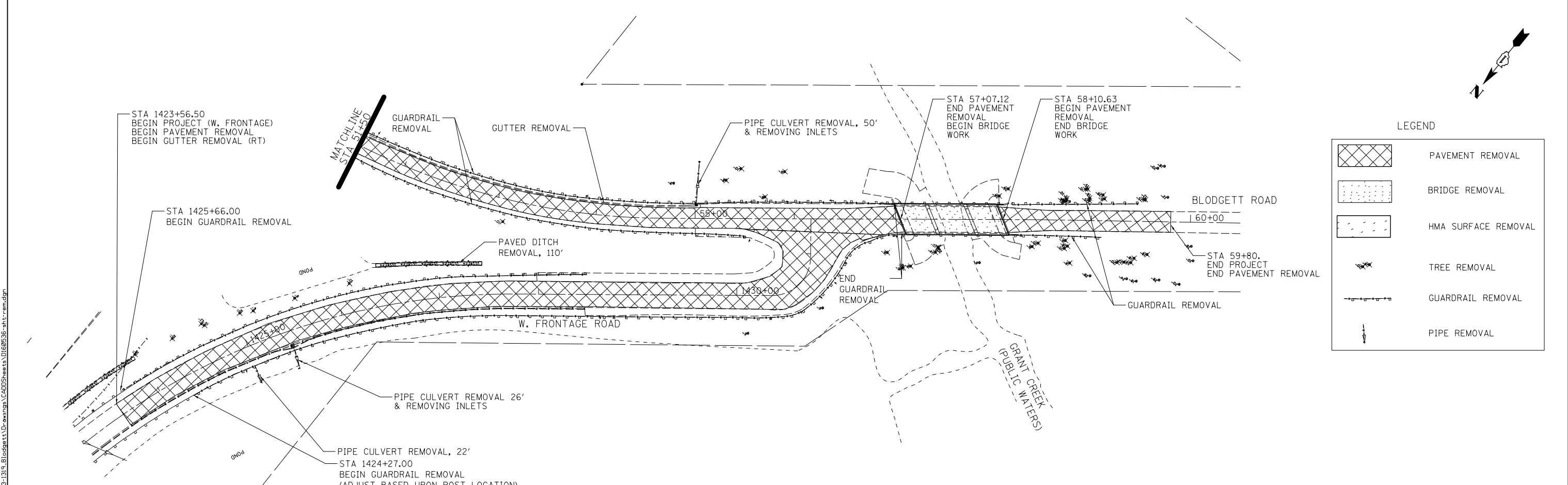

LEGEND

	PAVEMENT REMOVAL
	BRIDGE REMOVAL
	HMA SURFACE REMOVAL
	TREE REMOVAL
	GUARDRAIL REMOVAL
	PIPE REMOVAL

BLOOM COMPANIES, LLC
 Infrastructure Development and Design
 600 W. Fulton Street, Suite 701 • Chicago, IL 60661
 Phone: (312) 676-8500 Fax: (312) 876-8600

USER NAME = tborges	DESIGNED - MMO	REVISED -
	DRAWN - BL	REVISED -
PLOT SCALE = 100.0000' / 1" =	CHECKED - LSA	REVISED -
PLOT DATE = 3/31/2014	DATE - 12/4/2013	REVISED -

**STATE OF ILLINOIS
 DEPARTMENT OF TRANSPORTATION**

REMOVAL PLANS

SCALE: 1" = 50' SHEET OF SHEETS STA. TO STA.

F.A.I. RTE.	SECTION	COUNTY	TOTAL SHEETS	SHEET NO.
55	91-2HB-31-3	WILL	87	25
CONTRACT NO. 60X60				
ILLINOIS FED. AID PROJECT				