

LEGEND:

EXISTING SIGNS & DISPOSITION		PROPOSED SIGNS	
(A) REMOVE	STOP	①	W1-3R 36" x 36"
(B) REMOVE	WEIGHT LIMIT 10 TONS AXLE 40 TONS GROSS	②	W1-3P 24" x 24"
(C) REMOVE	SPEED LIMIT 45	③	DEAD END W14-1 36" x 36"
(D) REMOVE	←	④	ROAD CLOSED R11-2 48" x 30"
(E) REMOVE	↔	⑤	← W1-6L 48" x 24"
(F) RETAIN	NO OUTLET	⑥	W1-BL 24" x 30"
(G) REMOVE	STOP	⑦	W1-BR 24" x 30"

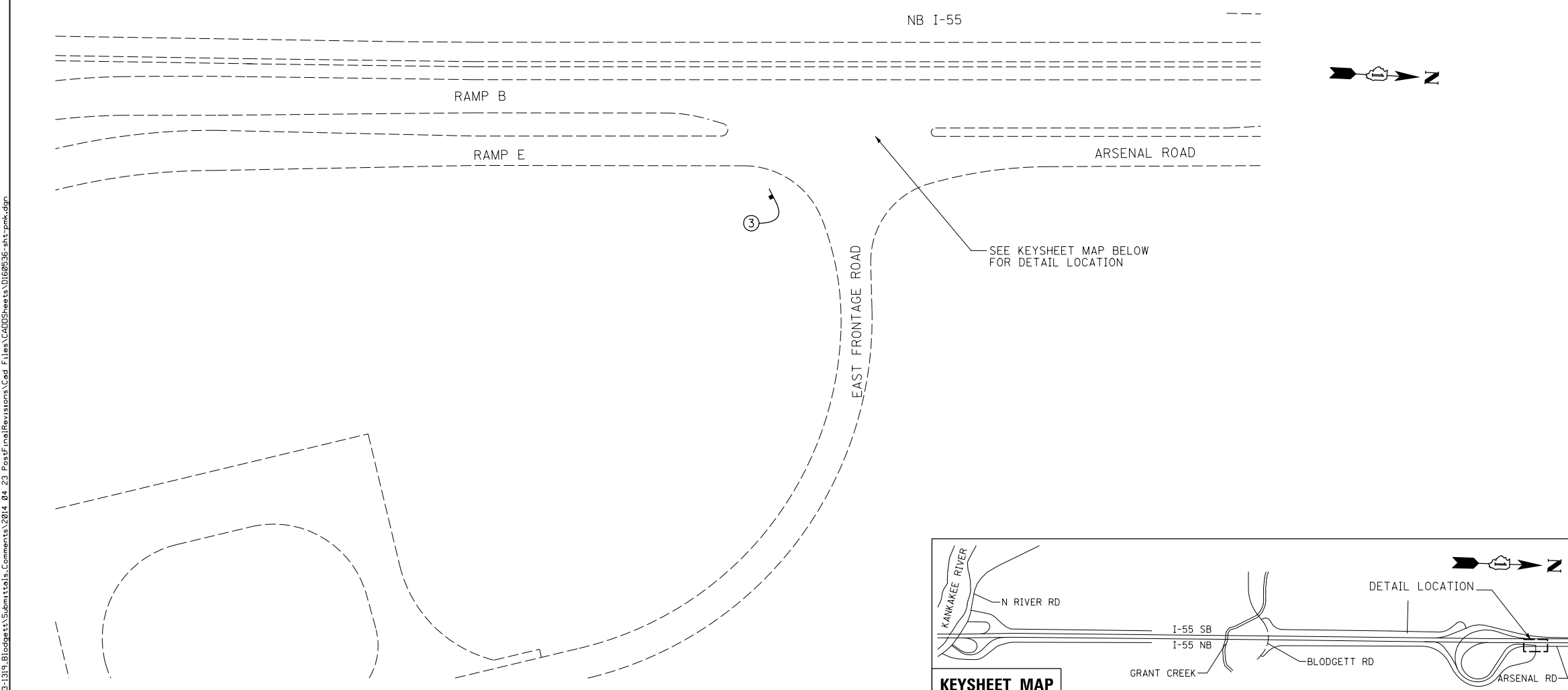

FILE NAME = F:\3-1319-Blodgett\Submittals\Comments\2014_04_23_Plan\10\Revisions\Cad_Files\CAD05Sheet\0160536-sht-1.pmk.dgn

BLOOM COMPANIES, LLC
 Infrastructure Development and Integrity
 600 W. Fulton Street, Suite 701 • Chicago, IL 60661
 Phone: (312) 676-8500 Fax: (312) 876-8600

USER NAME = makrent	DESIGNED - BCA	REVISED -
PLOT SCALE = 100.0000' / 1"	DRAWN - BL	REVISED -
PLOT DATE = 4/22/2014	CHECKED - MMO	REVISED -
	DATE - 9/25/2013	REVISED -

**STATE OF ILLINOIS
 DEPARTMENT OF TRANSPORTATION**

**PAVEMENT MARKING
 AND SIGNING**

SCALE: 1" = 50' SHEET 1 OF 2 SHEETS STA. TO STA.

F.A.I. RTE.	SECTION	COUNTY	TOTAL SHEETS	SHEET NO.
55	99-2HB-31-3	WILL	87	37
CONTRACT NO. 60X60				
ILLINOIS FED. AID PROJECT				