

GENERAL NOTES

SPECIFICATIONS, STANDARDS AND SPECIAL PROVISIONS

ALL CONSTRUCTION SHALL BE DONE IN ACCORDANCE WITH THE "STANDARD SPECIFICATIONS FOR ROAD AND BRIDGE CONSTRUCTION", ADOPTED JANUARY 1, 2012; THE "SUPPLEMENTAL SPECIFICATIONS AND RECURRING SPECIAL PROVISIONS", ADOPTED JANUARY 1, 2014; THE LATEST EDITION OF THE "ILLINOIS MANUAL ON UNIFORM TRAFFIC CONTROL DEVICES FOR STREETS AND HIGHWAYS", (IMUTCD); "THE STANDARD SPECIFICATIONS FOR WATER AND SEWER MAIN CONSTRUCTION IN ILLINOIS" JULY 2009 SIXTH EDITION, THE "DETAILS" IN THE PLANS AND THE "SPECIAL PROVISIONS" INCLUDED IN THE CONTRACT DOCUMENTS.

ALL WORK SHALL BE PERFORMED IN ACCORDANCE WITH APPLICABLE LAWS AND GOVERNMENT AGENCY REGULATIONS AND RULES; AUTHORITIES HAVING JURISDICTION; OSHA REGULATIONS AND RULES; AND ANY APPLICABLE RULES AND REGULATIONS OF THE STATE OF ILLINOIS OR COOK COUNTY AGENCIES. FURTHERMORE, AND AS RELATED TO THE WORK, THE CONTRACTOR SHALL GIVE NOTICES AND COMPLY WITH APPLICABLE LAWS, ORDINANCES, RULES, REGULATIONS, AND LAWFUL ORDERS OF ALL PUBLIC AUTHORITIES BEARING ON THE SAFETY OF PERSONS OR PROPERTY OR THEIR PROTECTION FROM DAMAGE, INJURY OR LOSS.

ALL TRAFFIC CONTROL AND OTHER ADVISORY SIGNS NEEDED FOR CONSTRUCTION ARE TO BE FURNISHED BY THE CONTRACTOR IN ACCORDANCE WITH SECTION 700 OF THE STANDARD SPECIFICATIONS.

UTILITIES

THE CONTRACTOR SHALL BE RESPONSIBLE FOR CONTACTING THE OWNERS OF ALL EXISTING FACILITIES SO THAT THE UTILITIES AND THEIR APPURTENANCES MAY BE LOCATED AND ADJUSTED OR MOVED, IF NECESSARY, PRIOR TO THE START OF CONSTRUCTION OPERATIONS. THE CONTRACTOR SHALL COOPERATE WITH ALL UTILITY OWNERS AS PROVIDED FOR IN THE STANDARD SPECIFICATIONS.

THE LOCATIONS OF EXISTING DRAINAGE STRUCTURES, STORM AND SANITARY SEWERS, WATER SERVICE LINES AND OTHER UTILITY LINES ARE APPROXIMATE, AND THE ENGINEER DOES NOT GUARANTEE THEIR ACCURACY. THEIR EXACT HORIZONTAL AND VERTICAL LOCATIONS ARE TO BE DETERMINED IN THE FIELD BY THE CONTRACTOR AT HIS OWN EXPENSE.

THE CONTRACTOR SHALL BE RESPONSIBLE FOR THE PROTECTION OF ALL UNDERGROUND OR SURFACE UTILITIES EVEN THOUGH THEY MAY NOT BE SHOWN ON THE PLANS. ANY UTILITY THAT IS DAMAGED DURING CONSTRUCTION SHALL BE REPAIRED OR REPLACED TO THE SATISFACTION OF THE ENGINEER. THIS WORK SHALL BE AT THE CONTRACTOR'S EXPENSE.

COORDINATION OF ALL UTILITY WORK INVOLVED IN THE CONSTRUCTION AREA WILL BE DISCUSSED AT THE PRECONSTRUCTION CONFERENCE.

BEFORE STARTING ANY EXCAVATION, THE CONTRACTOR SHALL CALL "JULIE" AT 800-892-0123 FOR FIELD LOCATIONS OF BURIED ELECTRIC, TELEPHONE, GAS AND CABLE TELEVISION FACILITIES. (48 HOURS NOTIFICATION IS REQUIRED.)

STAKING

THE CONTRACTOR SHALL PROTECT AND CAREFULLY PRESERVE ALL SECTION OR SUBSECTION MONUMENTS OR PROPERTY OR REFERENCE MARKERS UNTIL THE ENGINEER, HIS AGENT OR AN AUTHORIZED SURVEYOR HAS WITNESSED OR OTHERWISE REFERENCED THEIR LOCATIONS.

ALL RADII FOR PROPOSED CURB AND GUTTER ARE TO THE EDGE OF PAVEMENT UNLESS OTHERWISE NOTED, AND SHALL BE AS INDICATED ON THE PLANS. ELEVATIONS SHOWN AT POINT OF CURVE, ETC. IS EDGE OF PAVEMENT UNLESS OTHERWISE NOTED.

WATER, STORM SEWER AND SANITARY SEWER

WHENEVER DURING CONSTRUCTION OPERATIONS ANY LOOSE MATERIAL IS DEPOSITED IN THE FLOW LINE OF DRAINAGE STRUCTURES SUCH THAT THE NATURAL FLOW OF WATER IS OBSTRUCTED, IT SHALL BE REMOVED AT THE CLOSE OF EACH WORKING DAY. AT THE CONCLUSION OF CONSTRUCTION OPERATIONS, ALL UTILITY STRUCTURES SHALL BE FREE FROM DIRT AND DEBRIS. THE WORK SPECIFIED ABOVE WILL NOT BE PAID FOR SEPARATELY BUT SHALL BE COMPLETED PER ARTICLE 107.15 OF THE STANDARD SPECIFICATIONS.

ANY EXISTING OR PROPOSED STORM SEWER DAMAGED BY THE CONTRACTOR DURING CONSTRUCTION SHALL BE REPLACED BY THE CONTRACTOR AT THEIR EXPENSE.

THE CONTRACTOR SHALL NOT OPEN OR SHUT ANY WATER VALVES OR FIRE HYDRANTS WITHOUT PRIOR AUTHORIZATION FROM THE CITY WATER DEPARTMENT. UNAUTHORIZED USE SHALL SUBJECT THE OFFENDER TO ARREST AND PROSECUTION.

COST TO CONNECT EXISTING OR PROPOSED STORM SEWER TO EXISTING OR PROPOSED DRAINAGE STRUCTURE SHALL BE INCLUDED IN THE COST FOR STORM SEWER.

CONTRACTOR SHALL PROVIDE STRUCTURE LAYOUT INFORMATION TO THE ENGINEER PRIOR TO ORDERING ALL PROPOSED DRAINAGE STRUCTURES. THIS INFORMATION WILL BE DETERMINED IN THE FIELD WITH THE ENGINEER. COST TO DO THIS INVESTIGATIVE WORK SHALL BE INCLUDED IN THE COST FOR THE DRAINAGE STRUCTURE.

GENERAL NOTES

- THE CITY OF NORTHLAKE AND ENGINEER SHALL BE NOTIFIED BY THE CONTRACTOR IN WRITING AT LEAST (3) FULL WORKING DAYS PRIOR TO COMMENCEMENT OF CONSTRUCTION.
- THE CONTRACTOR SHALL PROVIDE ALL NECESSARY PROTECTION FOR EXISTING UTILITIES IN CONFORMANCE WITH THE AFFECTED UTILITY COMPANIES' REQUIREMENTS AS MAY BE REQUIRED TO PERFORM THE WORK OF THIS CONTRACT.
- BEFORE BEGINNING CONSTRUCTION, THE CONTRACTOR SHALL VERIFY THE LINE AND GRADES SHOWN ON THE CONTRACT DRAWINGS. IF THERE ARE ANY DISCREPANCIES FROM WHAT IS SHOWN ON THE CONTRACT DRAWINGS, THE CONTRACTOR SHALL IMMEDIATELY REPORT SAME TO THE ENGINEER PRIOR TO PERFORMING WORK. CONTRACTOR SHALL BE RESPONSIBLE FOR COORDINATION OF WORK AS REQUIRED.
- THE CONTRACT DOCUMENTS ARE NOT INTENDED TO SHOW EVERY AND ALL DETAILS OF WORK TO BE PERFORMED OR EQUIPMENT TO BE SUPPLIED. THE INTENT OF THE CONTRACT DOCUMENTS IS TO ILLUSTRATE THE CONCEPTUAL DESIGN AND LAYOUT. THE CONTRACTOR SHALL BE KNOWLEDGEABLE AND REGULARLY ENGAGED IN THE TYPE OF WORK DESCRIBED BY THESE CONTRACT DOCUMENTS, AND SHALL BE RESPONSIBLE FOR UNDERSTANDING THEIR INTENT. ADDITIONAL WORK TO BE PERFORMED OR ITEM OF EQUIPMENT TO BE SUPPLIED WHICH IS NOT SPECIFICALLY CALLED FOR BY THESE CONTRACT DOCUMENTS BUT WHICH IS NECESSARY TO PROVIDE A COMPLETE AND SUCCESSFUL WORKING SYSTEM SHALL BE INCLUDED IN ACCORDANCE WITH ARTICLE 109.04.
- IT IS THE CONTRACTOR'S RESPONSIBILITY TO DETERMINE ALL MATERIAL QUANTITIES AND APPRAISE HIMSELF/HERSELF OF ALL CONDITIONS. NO CLAIMS FOR ADDITIONAL COMPENSATION FOR INDIVIDUAL PAY ITEMS WILL BE RECOGNIZED DUE TO THE CONTRACTOR'S FAILURE TO UNDERSTAND THE SCOPE OF WORK.
- THE WORK PERFORMED UNDER THIS CONTRACT SHALL IN NO WAY INTERFERE WITH THE NORMAL OPERATION OF ANY EXISTING UTILITY SERVICE. THE CONTRACTOR SHALL FURNISH ALL NECESSARY ITEMS OF EQUIPMENT REQUIRED TO MAINTAIN SUCH NORMAL OPERATION AT NO ADDITIONAL COST TO THE OWNER. THE COST ASSOCIATED FOR THIS WORK SHALL BE CONSIDERED INCLUDED IN THE COST OF THE CONTRACT.
- CERTAIN INFORMATION SHOWN ON THESE DRAWINGS HAS BEEN OBTAINED FROM DRAWINGS OF RECORD. CONTRACTOR SHALL VERIFY SUCH INFORMATION PRIOR TO ACTUAL START OF WORK. WHERE DISCREPANCIES ARE DISCOVERED THE CONTRACTOR SHALL IMMEDIATELY NOTIFY THE ENGINEER. FAILURE BY THE CONTRACTOR TO IMMEDIATELY NOTIFY THE ENGINEER OF SUCH DISCREPANCIES SHALL RESULT IN THE CONTRACTOR BEARING THE FULL BURDEN OF ALL RISKS/COSTS ATTRIBUTED TO THE DISCOVERED DISCREPANCY.
- SOIL EROSION PROTECTION SHALL BE IN ACCORDANCE WITH IEPA STANDARDS AND SPECIFICATIONS FOR SOIL EROSION AND SEDIMENT CONTROL. ALL DISTURBED AREAS (NOT IMPERVIOUS IN NATURE) SHALL BE FINE GRADED, TOPSOIL RESTORED (MIN 4 INCHES) AND SEED/MULCH APPLIED UNLESS OTHERWISE SPECIFIED ON THE PLANS.
- ALL REMOVAL OR EXCAVATION ITEMS BEING DISPOSED OF AT AN UNCONTAMINATED SOIL FILL OPERATION OR CLEAN CONSTRUCTION AND DEMOLITION DEBRIS (CCDD) FILL SITE SHALL MEET THE REQUIREMENTS OF PUBLIC ACT 96-1416. ALL COSTS ASSOCIATED WITH MEETING THESE REQUIREMENTS SHALL BE INCLUDED IN THE UNIT PRICE COST FOR THE ASSOCIATED REMOVAL OR EXCAVATION ITEMS IN THE CONTRACT. THESE COSTS SHALL INCLUDE, BUT ARE NOT LIMITED TO, COMPLETING THE ILLINOIS ENVIRONMENTAL PROTECTION AGENCY FORM LPC 663, ALL REQUIRED TESTING, LAB ANALYSIS, CERTIFICATION BY A LICENSED PROFESSIONAL ENGINEER, AND STATE OR LOCAL TIPPING FEES.

MISCELLANEOUS

ACCESS: THE CONTRACTOR SHALL PROVIDE ACCESS TO ABUTTING PROPERTY AT ALL TIMES DURING THE CONSTRUCTION OF THIS PROJECT, EXCEPT FOR PERIODS OF SHORT DURATION. THE COST TO PROVIDE ACCESS SHALL BE PAID FOR AND INCLUDED IN THE PAY ITEM AGGREGATE FOR TEMPORARY ACCESS.

DIMENSIONS: IT SHALL BE THE CONTRACTOR'S RESPONSIBILITY TO VERIFY ALL DIMENSIONS AND CONDITIONS EXISTING IN THE FIELD PRIOR TO ORDERING MATERIALS AND BEGINNING CONSTRUCTION.

ALL SAWCUTTING SHALL BE INCLUDED TO REMOVAL ITEMS AND SHALL BE PERFORMED PRIOR TO BEGINNING REMOVAL. ANY ITEMS OF WORK REMOVED PRIOR TO SAWCUTTING WILL NOT BE MEASURED FOR PAYMENT.

DETECTABLE WARNINGS FOR THE DISABLED SHALL BE INSTALLED AT ALL INTERSECTING STREETS, COMMERCIAL DRIVEWAYS, AND ALLEYS AS SHOWN ON THE PLANS (SEE IDOT STD. 424201).

RELOCATING EXISTING SIGNS: EXISTING SIGNS WHICH ARE IN CONFLICT WITH PROPOSED IMPROVEMENTS SHALL BE REMOVED AND REINSTALLED UPON COMPLETION OF CONFLICTING IMPROVEMENTS IN ACCORDANCE WITH THE ILLINOIS DEPARTMENT OF TRANSPORTATION "MANUAL OF UNIFORM TRAFFIC CONTROL DEVICES" AND THE "STANDARD SPECIFICATIONS FOR ROAD AND BRIDGE CONSTRUCTION". STOP SIGNS, SPEED LIMIT SIGNS, AND STREET NAME SIGNS SHALL BE UP AND VISIBLE AT ALL TIMES. THIS WORK SHALL BE PERFORMED PER ARTICLE 107.25 OF THE STANDARD SPECIFICATIONS.

PER ARTICLE 107.20, MAILBOXES WHICH ARE IN CONFLICT WITH PROPOSED IMPROVEMENTS SHALL BE REMOVED, TEMPORARILY RELOCATED, AND REPLACED UPON COMPLETION OF THE PROPOSED IMPROVEMENTS AS DIRECTED BY THE ENGINEER.

PROPOSED CONCRETE CURB AND GUTTER SHALL BE TRANSITIONED TO EXISTING CURB AND GUTTER OVER A LENGTH OF 5 FEET. THIS WORK SHALL BE PAID FOR AT THE CONTRACT UNIT PRICE PER FOOT FOR COMBINATION CONCRETE CURB AND GUTTER.

THE HMA SURFACE COURSE USED TO REPLACE DRIVEWAYS WILL BE PAID FOR PER TON.

PROTECTIVE COAT FOR ALL CONCRETE SURFACES SHALL BE CONSIDERED INCLUDED IN THE COST OF THE RESPECTIVE PAY ITEM.

ANY DEFACED WORK SHALL BE CORRECTED OR REPLACED BY THE CONTRACTOR AT HIS SOLE EXPENSE PRIOR TO FINAL PAYMENT. THE CITY WILL COOPERATE WITH THE CONTRACTOR TO MINIMIZE VANDALISM, BUT THE CONTRACTOR SHALL BE ULTIMATELY RESPONSIBLE TO CORRECT ANY DAMAGE PER CONDITIONS OF ARTICLE 107.30 OF THE STANDARD SPECIFICATIONS.

THE CONTRACTOR SHALL BE SOLELY RESPONSIBLE FOR JOB SITE SAFETY AS WELL AS SUPERVISION / DIRECTION AND MEANS / METHODS OF CONSTRUCTION.

THE CONTRACTOR SHALL CONTACT THE IDOT TRAFFIC CONTROL SUPERVISOR AT (847) 705-4470 A MINIMUM OF 72 HOURS IN ADVANCE OF BEGINNING WORK.

THE LANE CLOSURES ON IL 64 (NORTH AVENUE) WILL ONLY BE ALLOWED WHEN NECESSARY BETWEEN THE HOURS OF 9:00 A.M. AND 3:00 P.M.

THE GENERAL CONTRACTOR IS REQUIRED TO HIRE AN ENVIRONMENTAL FIRM TO CONTINUOUSLY MONITOR FOR WORKER SAFETY AND SOIL CONTAMINATION AT SEVERAL LOCATIONS. SEE SPECIAL PROVISION AND SUPPLEMENTAL SPECIFICATIONS FOR DETAILS.

DISTRICT ONE STANDARDS

- BD-22 PAVEMENT PATCHING FOR HMA SURFACED PAVEMENT
- TC-10 TRAFFIC CONTROL AND PROTECTION FOR SIDE ROADS, INTERSECTIONS, AND DRIVEWAYS
- TC-13 DISTRICT ONE TYPICAL PAVEMENT MARKINGS
- TC-22 ARTERIAL ROAD INFORMATION SIGN
- TS-05 STANDARD TRAFFIC SIGNAL DESIGN DETAILS
- TS-07 DETECTOR LOOP INSTALLATION DETAILS FOR ROADWAY RESURFACING
- BD-32 BUTT JOINT AND HMA TAPER DETAILS

HIGHWAY STANDARDS

- 000001-06 STANDARD SYMBOLS, ABBREVIATIONS, AND PATTERNS
- 424001-07 PERPENDICULAR CURB RAMPS FOR SIDEWALK
- 442201-03 CLASS C AND D PATCHES
- 602001-02 CATCH BASIN TYPE A
- 602011-02 CATCH BASIN TYPE C
- 604001-03 FRAME AND LIDS TYPE 1
- 606001-05 CONCRETE CURB TYPE B AND COMBINATION CONCRETE CURB AND GUTTER
- 701006-05 OFF-RD OPERATIONS, 2L, 2W, 15' (4.5M) TO 24" (600MM) FROM PAVEMENT EDGE
- 701101-04 OFF-RD OPERATIONS, MULTILANE, 15' (4.5M) TO 24" (600MM) FROM PAVEMENT EDGE
- 701301-04 LANE CLOSURE, 2L, 2W, SHORT TIME OPERATIONS
- 701311-03 LANE CLOSURE, 2L, 2W, MOVING OPERATIONS- DAY ONLY
- 701427-02 LANE CLOSURE, MULTILANE, INTERMITTENT OR MOVING OPER., FOR SPEEDS < 40 MPH
- 701501-06 URBAN LANE CLOSURE, 2L, 2W UNDIVIDED
- 701601-09 URBAN LANE CLOSURE, MULTILANE, 1W OR 2W, WITH NONTRAVERSABLE MEDIAN
- 701701-09 URBAN LANE CLOSURE, MULTILANE INTERSECTION
- 701801-05 SIDEWALK, CORNER OR CROSSWALK CLOSURE
- 701901-03 TRAFFIC CONTROL DEVICES
- 780001-04 TYPICAL PAVEMENT MARKINGS
- 886001-01 DETECTOR LOOP INSTALLATIONS
- 886006-01 TYPICAL LAYOUTS FOR DETECTION LOOPS

DATE: _____ BY: _____
 SURVEYED: _____ PLOTTED: _____
 PLANNED: _____ CHECKED: _____
 NOTE BOOK NO. _____
 STRUCTURE NOTATIONS: _____

CHRISTOPHER B. BURKE
 ENGINEERING LTD.
 9575 West Higgins Road, Suite 600
 Rosemont, Illinois 60018
 (847) 623-0500

SUMMARY OF QUANTITIES

SUMMARY OF QUANTITIES			STP
CODE NO.	ITEM	UNIT	TOTAL QUANTITY
			CONSTRUCTION TYPE CODE
			0004
20201200	REMOVAL AND DISPOSAL OF UNSUITABLE MATERIAL	CU YD	690
20800150	TRENCH BACKFILL	CU YD	55
21001000	GEO TECHNICAL FABRIC FOR GROUND STABILIZATION	SQ YD	1555
25000110	SEEDING, CLASS 1A	ACRE	0.2
25000400	NITROGEN FERTILIZER NUTRIENT	POUND	18
25000500	PHOSPHORUS FERTILIZER NUTRIENT	POUND	18
25000600	POTASSIUM FERTILIZER NUTRIENT	POUND	18
25100630	EROSION CONTROL BLANKET	SQ YD	700
28000510	INLET FILTERS	EACH	19
30300001	AGGREGATE SUBGRADE IMPROVEMENT	CU YD	560
31101100	SUBBASE GRANULAR MATERIAL, TYPE B	CU YD	185
35102000	AGGREGATE BASE COURSE, TYPE B 8"	SQ YD	3562
40201000	AGGREGATE FOR TEMPORARY ACCESS	TON	300
40600400	MIXTURE FOR CRACKS, JOINTS, AND FLANGEWAYS	TON	100
40600625	LEVELING BINDER (MACHINE METHOD), N50	TON	111
40600982	HOT-MIX ASPHALT SURFACE REMOVAL - BUTT JOINT	SQ YD	38
40603080	HOT-MIX ASPHALT BINDER COURSE, IL-19.0, N50	TON	945
40603335	HOT-MIX ASPHALT SURFACE COURSE, MIX "D", N50	TON	505
42400200	PORTLAND CEMENT CONCRETE SIDEWALK 5 INCH	SQ FT	4440
42400400	PORTLAND CEMENT CONCRETE SIDEWALK 7 INCH	SQ FT	60
42400800	DETECTABLE WARNINGS	SQ FT	75
44000100	PAVEMENT REMOVAL	SQ YD	4060
44000158	HOT-MIX ASPHALT SURFACE REMOVAL, 2 1/4"	SQ YD	2050
44000500	COMBINATION CURB AND GUTTER REMOVAL	FOOT	1890
44000600	SIDEWALK REMOVAL	SQ FT	5160
44201297	DOWEL BARS 1"	EACH	1250
44201761	CLASS D PATCHES, TYPE I, 10 INCH	SQ YD	140
44300100	AREA REFLECTIVE CRACK CONTROL TREATMENT	SQ YD	5470
550A0040	STORM SEWERS, CLASS A, TYPE 1 10"	FOOT	39
550A0430	STORM SEWERS, CLASS A, TYPE 2 30"	FOOT	20
55100300	STORM SEWER REMOVAL 8"	FOOT	22
55100400	STORM SEWER REMOVAL 10"	FOOT	12
55100500	STORM SEWER REMOVAL 12"	FOOT	8
55101400	STORM SEWER REMOVAL 30"	FOOT	20
* 56103000	DUCTILE IRON WATER MAIN 6"	FOOT	28
* 56400500	FIRE HYDRANTS TO BE REMOVED	EACH	1
* 56400820	FIRE HYDRANT WITH AUXILIARY VALVE AND VALVE BOX	EACH	1
56500600	DOMESTIC WATER SERVICE BOXES TO BE ADJUSTED	EACH	5
60200105	CATCH BASINS, TYPE A, 4'-DIAMETER, TYPE 1 FRAME, OPEN LID	EACH	6
60206905	CATCH BASINS, TYPE C, TYPE 1 FRAME, OPEN LID	EACH	9
60221100	MANHOLES, TYPE A, 5'-DIAMETER, TYPE 1 FRAME, CLOSED LID	EACH	2

SUMMARY OF QUANTITIES			STP
CODE NO.	ITEM	UNIT	TOTAL QUANTITY
			CONSTRUCTION TYPE CODE
			0004
60250400	CATCH BASINS TO BE ADJUSTED WITH NEW TYPE 1 FRAME, OPEN LID	EACH	1
60250500	CATCH BASINS TO BE ADJUSTED WITH NEW TYPE 1 FRAME, CLOSED LID	EACH	2
60252800	CATCH BASINS TO BE RECONSTRUCTED	EACH	2
60406000	FRAMES AND LIDS, TYPE 1, OPEN LID	EACH	1
60406100	FRAMES AND LIDS, TYPE 1, CLOSED LID	EACH	1
60603800	COMBINATION CONCRETE CURB AND GUTTER, TYPE B-6.12	FOOT	2450
60605000	COMBINATION CONCRETE CURB AND GUTTER, TYPE B-6.24	FOOT	150
* 66900200	NON-SPECIAL WASTE DISPOSAL	CU YD	1850
67100100	MOBILIZATION	L SUM	1
* 66900450	SPECIAL WASTE PLANS AND REPORTS	L SUM	1
70102620	TRAFFIC CONTROL AND PROTECTION, STANDARD 701501	L SUM	1
* 66900550	SOIL DISPOSAL ANALYSIS	EACH	6
70102630	TRAFFIC CONTROL AND PROTECTION, STANDARD 701601	L SUM	1
70102635	TRAFFIC CONTROL AND PROTECTION, STANDARD 701701	L SUM	1
70102640	TRAFFIC CONTROL AND PROTECTION, STANDARD 701801	L SUM	1
70103815	TRAFFIC CONTROL SURVEILLANCE	CAL DA	19
72000100	SIGN PANEL - TYPE 1	SQ FT	75
72900100	METAL POST - TYPE A	FOOT	105
* 78000200	THERMOPLASTIC PAVEMENT MARKING - LINE 4"	FOOT	1580
* 78000400	THERMOPLASTIC PAVEMENT MARKING - LINE 6"	FOOT	445
* 78000650	THERMOPLASTIC PAVEMENT MARKING - LINE 24"	FOOT	125
* 80400100	ELECTRIC SERVICE INSTALLATION	EACH	1
* 81028160	UNDERGROUND CONDUIT, GALVANIZED STEEL, 3/4" DIA.	FOOT	130
* 81702450	ELECTRIC CABLE IN CONDUIT, 600V (XLP - TYPE USE) 3-1/C NO. 10	FOOT	160
* 85000200	MAINTENANCE OF EXISTING TRAFFIC SIGNAL INSTALLATION	EACH	1
* 87900200	DRILL EXISTING HANDHOLE	EACH	2
* 88600600	DETECTOR LOOP REPLACEMENT	FOOT	70
* 89502300	REMOVE EXISTING CABLE FROM CONDUIT	FOOT	240
* 89502376	REBUILD EXISTING HANDHOLE	EACH	4
* X0323710	REMOVE CONDUIT ATTACHED TO STRUCTURE	FOOT	12
* X0696100	PARKING BLOCKS	EACH	11
* X2110100	TOPSOIL FURNISH AND PLACE, SPECIAL	CU YD	400
X4060120	NON-TRACKING BITUMINOUS MATERIALS (PRIME COAT)	POUND	13525
* X4240430	PORTLAND CEMENT CONCRETE SIDEWALK 5 INCH, SPECIAL	SQ FT	2575
* X5610706	WATER MAIN REMOVAL, 6"	FOOT	35
* X6026057	SANITARY MAN-HOLES TO BE RECONSTRUCTED WITH NEW TYPE 1 FRAME, CLOSED LID	EACH	2
* X0001290	CONCRETE BOLLARDS	EACH	8
Z0004002	BOLLARDS	EACH	2
Z0013798	CONSTRUCTION LAYOUT	L SUM	1
Z0018400	DRAINAGE STRUCTURES TO BE ADJUSTED	EACH	13
Z0018700	DRAINAGE STRUCTURES TO BE REMOVED	EACH	11
Z0030850	TEMPORARY INFORMATION SIGNING	SQ FT	45
Z0076600	TRAINEES	HOURL	1000
Z0076604	TRAINEES TRAINING PROGRAM GRADUATE	HOURL	1000

DATE: _____ BY: _____
 SURVEYED _____ PLOTTED _____
 CHECKED _____
 DATE: _____ BY: _____
 SURVEYED _____ PLOTTED _____
 CHECKED _____

ENGINEERING LTD.
 9575 West Higgins Road, Suite 600
 Rosemont, Illinois 60018
 (847) 823-0500

PROFILE SURVEYED _____
 CHECKED _____
 DATE: _____

FILE NAME = N:\NORTHLAKE\940032HR - Municipal Review

USER NAME = apufundt
 DESIGNED -
 CHECKED -
 DATE -

REVISED - 6/2/14
 REVISED -
 REVISED -
 REVISED -

**STATE OF ILLINOIS
 DEPARTMENT OF TRANSPORTATION**

SUMMARY OF QUANTITIES

SCALE: N.T.S. SHEET 3 OF 34 SHEETS STA. TO STA.

F.A.P. RTE.	SECTION	COUNTY	TOTAL SHEETS	SHEET NO.
307	13-00085-00-CH	COOK	34	3
CONTRACT NO. 61A43				
ILLINOIS FED. AID PROJECT				

DATE	BY	REVISIONS
		ALIGNED, CHECKED, PLOTTED, PRINTED, FILED
DATE	BY	REVISIONS
		STRUCTURE NOT AT THIS POINT
DATE	BY	REVISIONS
		STRUCTURE NOT AT THIS POINT
DATE	BY	REVISIONS
		STRUCTURE NOT AT THIS POINT
DATE	BY	REVISIONS
		STRUCTURE NOT AT THIS POINT

CHRISTOPHER B. BURKE
ENGINEERING LTD.
8575 North Higgins Rd.
Rosemont, Illinois 60018
(847) 823-0000

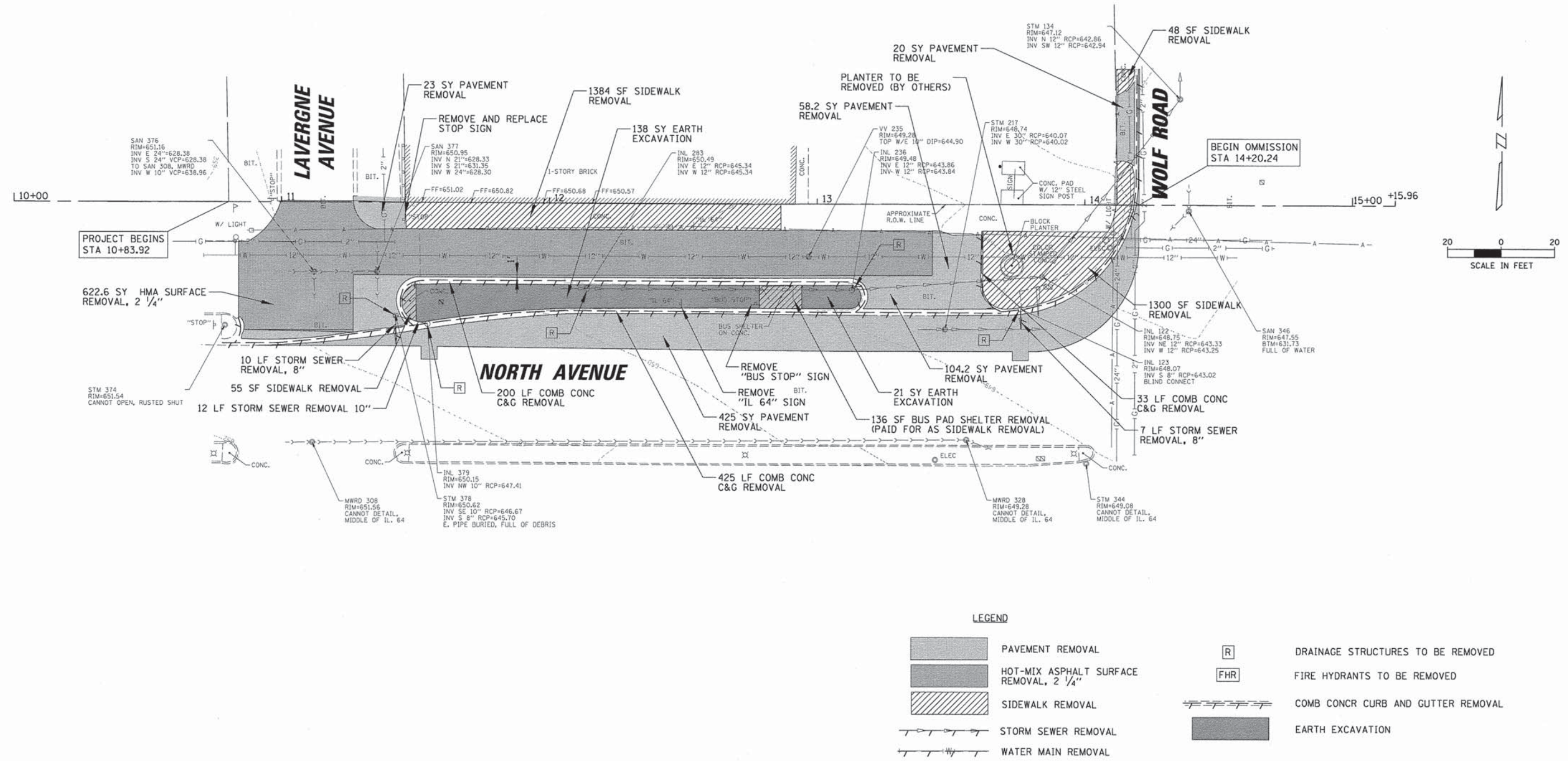

NOTE:
THE ENVIRONMENTAL FIRM IS REQUIRED TO CONTINUOUSLY MONITOR FOR WORKER PROTECTION AND SOIL CONTAMINATION AT SEVERAL LOCATIONS. SEE SPECIAL PROVISION AND SUPPLEMENTAL SPECIFICATIONS FOR DETAILS.

FILE NAME =	USER NAME = epufundt	DESIGNED -	REVISED - 6/2/14	STATE OF ILLINOIS DEPARTMENT OF TRANSPORTATION	REMOVAL PLAN LAVERGNE AVENUE TO WOLF AVENUE		F.A.P. RTE.	SECTION	COUNTY	TOTAL SHEETS	SHEET NO.
N:\NORTHLAKE\9400320C134\Civil\REM_9400	20C134.SHT	DRAWN -	REVISED -		307	13-00085-00-CH	COOK	34	7		
Default	PLOT SCALE = 20'	CHECKED -	REVISED -		SCALE: \$SCALE\$	SHEET 7	OF 34 SHEETS	STA.	TO STA.	CONTRACT NO. 61A43	
	PLOT DATE = 6/2/2014	DATE -	REVISED -							ILLINOIS FED. AID PROJECT	

DATE	
BY	
SURVEYED	
PLOTTED	
CHECKED	
FILE NAME	
NO.	
PLAN	
NOTE BOOK	
NO.	

CHRISTOPHER B. BURKE
 ENGINEERING LTD.
 8575 West Higgins Road, Suite 600
 Rosemont, Illinois 60018
 (847) 823-0900

DATE	
BY	
SURVEYED	
PLOTTED	
CHECKED	
FILE NAME	
NO.	
PROFILE	
NOTE BOOK	
NO.	

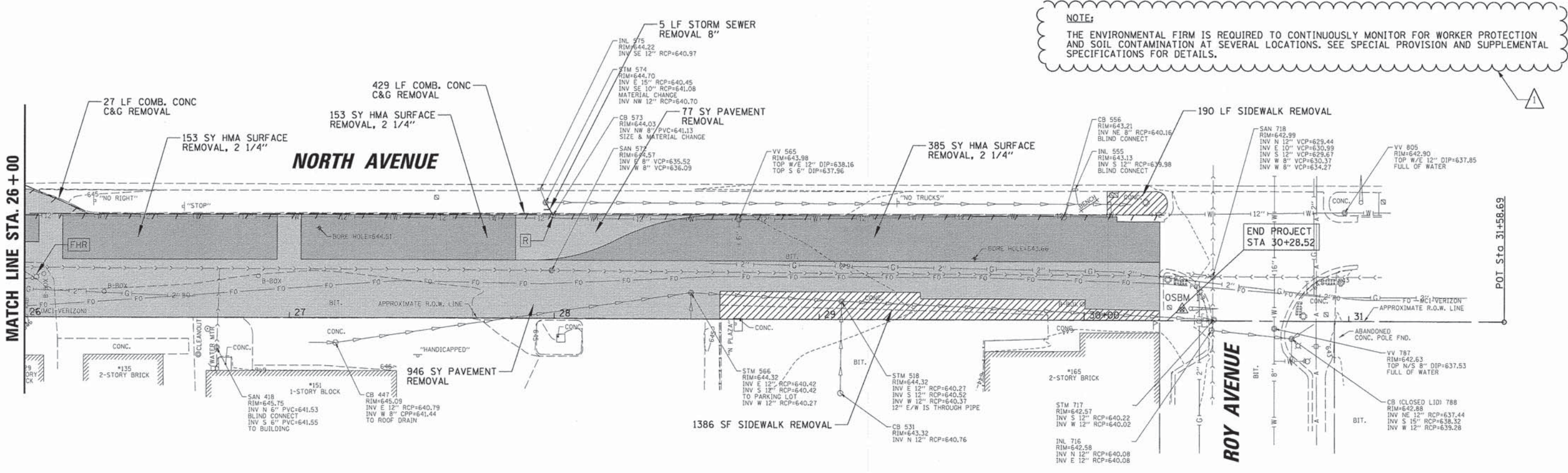
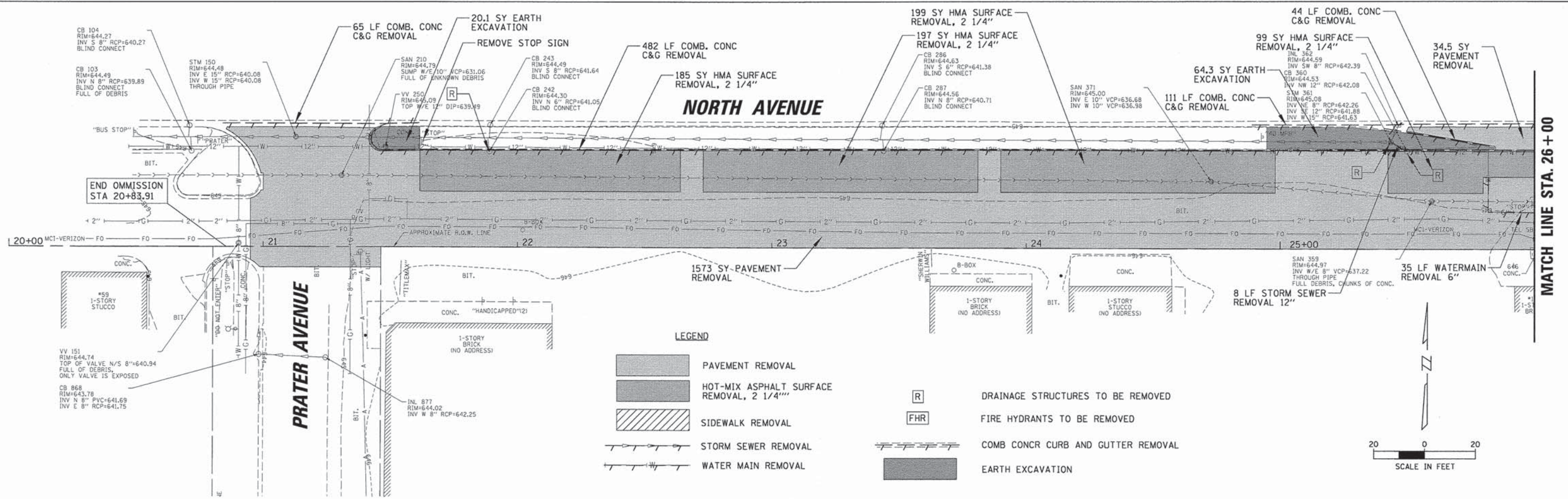

FILE NAME =	USER NAME = epufundt	DESIGNED -	REVISED - 6/2/14	STATE OF ILLINOIS DEPARTMENT OF TRANSPORTATION	REMOVAL PLAN PRATER AVENUE TO ROY AVENUE	F.A.P. R.T.E.	SECTION	COUNTY	TOTAL SHEETS	SHEET NO.
N:\NDRTHLAKE\940032HR - Municipal Review	Projects\940032 HR 200's\940032HR219\Civil1	DRAWN 032HR219.shs	REVISED -			307	13-00085-00-CH		34	8
PLOT SCALE = 20'	CHECKED -	REVISED -	CONTRACT NO. 61A43							
Default	PLOT DATE = 6/2/2014	DATE -	REVISED -	SCALE: *SCALE*	SHEET 8 OF 34 SHEETS	STA.	TO STA.	[ILLINOIS] FED. AID PROJECT		

SURVEYED ALIGNED CHECKED
 PLAN NO. DATE
 ENGINEERING LTD.
CHRISTOPHER B. BURKE
 8075 West Higgins Road, Suite 600
 Chicago, IL 60631
 (847) 924-0800
 CB
 PROFILE
 DATE
 BY
 CHECKED
 GRADING CHECKED
 BEAM NOTED
 STRUCTURE NOTATIONS CHECKED
 NOTE BOOK NO.
 SURVEYED ALIGNED CHECKED
 PLAN NO. DATE
 ENGINEERING LTD.
CHRISTOPHER B. BURKE
 8075 West Higgins Road, Suite 600
 Chicago, IL 60631
 (847) 924-0800
 CB
 PROFILE
 DATE
 BY
 CHECKED
 GRADING CHECKED
 BEAM NOTED
 STRUCTURE NOTATIONS CHECKED
 NOTE BOOK NO.

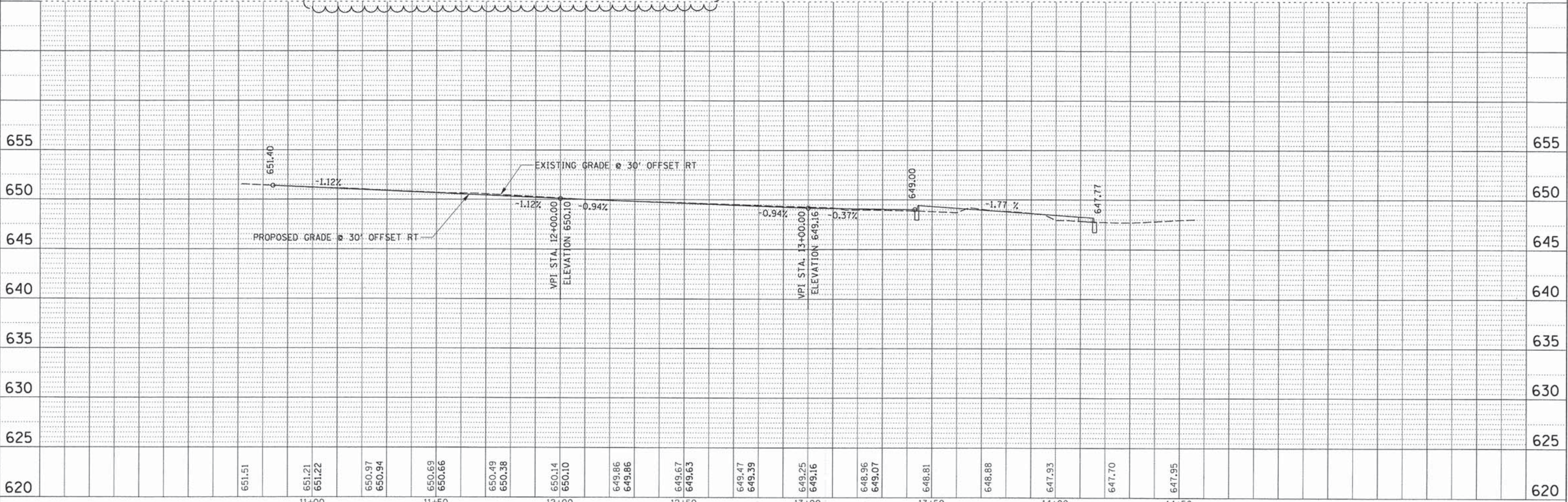
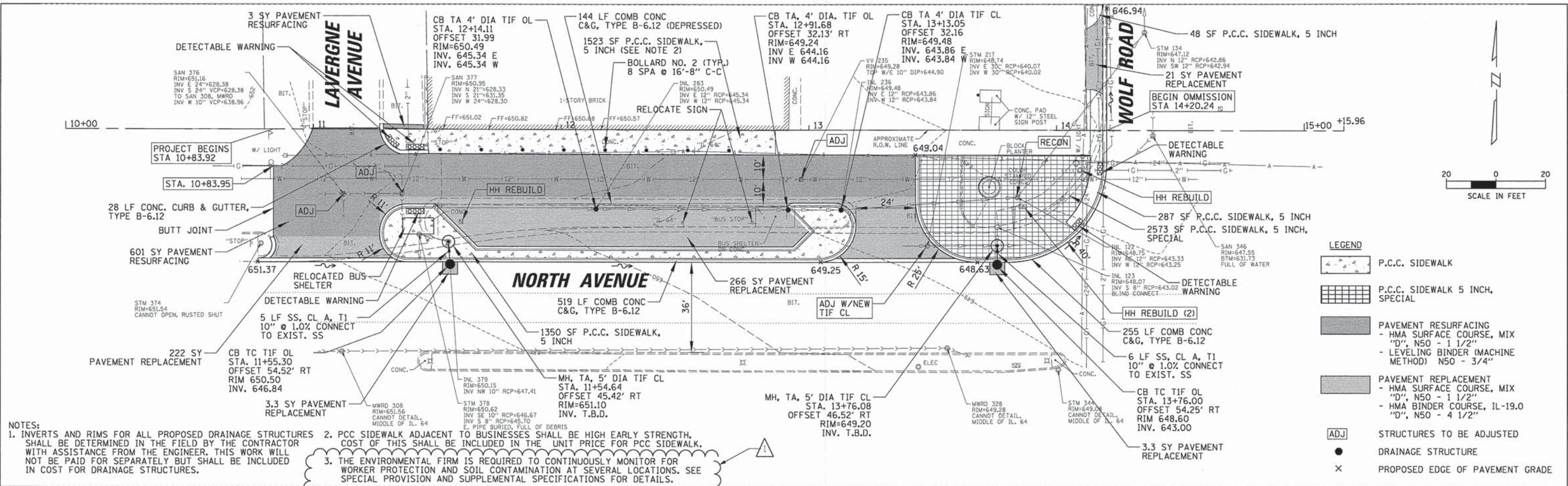

FILE NAME =	USER NAME = apufundt	DESIGNED - AMP	REVISED - 6/2/14
N:\NORTH LAKE\9400320C134\Civil\APP_9400320C134_01.SHT		DRAWN - FPB	REVISED -
PLOT SCALE = 20'		CHECKED - MEW	REVISED -
PLOT DATE = 6/2/2014		DATE -	REVISED -

STATE OF ILLINOIS
DEPARTMENT OF TRANSPORTATION

PLAN AND PROFILE
LAVERGNE AVENUE TO WOLF ROAD

SCALE: SHEET NO. OF SHEETS STA. TO STA.

F.A.P. RTE. 307	SECTION xxx	COUNTY COOK	TOTAL SHEETS 34	SHEET NO. 10
FED. ROAD DIST. NO.		ILLINOIS FED. AID PROJECT		

BY: DATE: SURVEYED: [] CHECKED: [] DATE: []
 PLAN: [] CHECKED: [] DATE: []
 NOTE BOOK NO. []
 PROJECT: []
 NOTE: []
 STRUCTURE: []
 NOTATIONS: []

CHRISTOPHER B. BURKE
 ENGINEERING LTD.
 9575 West Higgins Road, Suite 600
 Rosemont, Illinois 60018
 (847) 823-0500

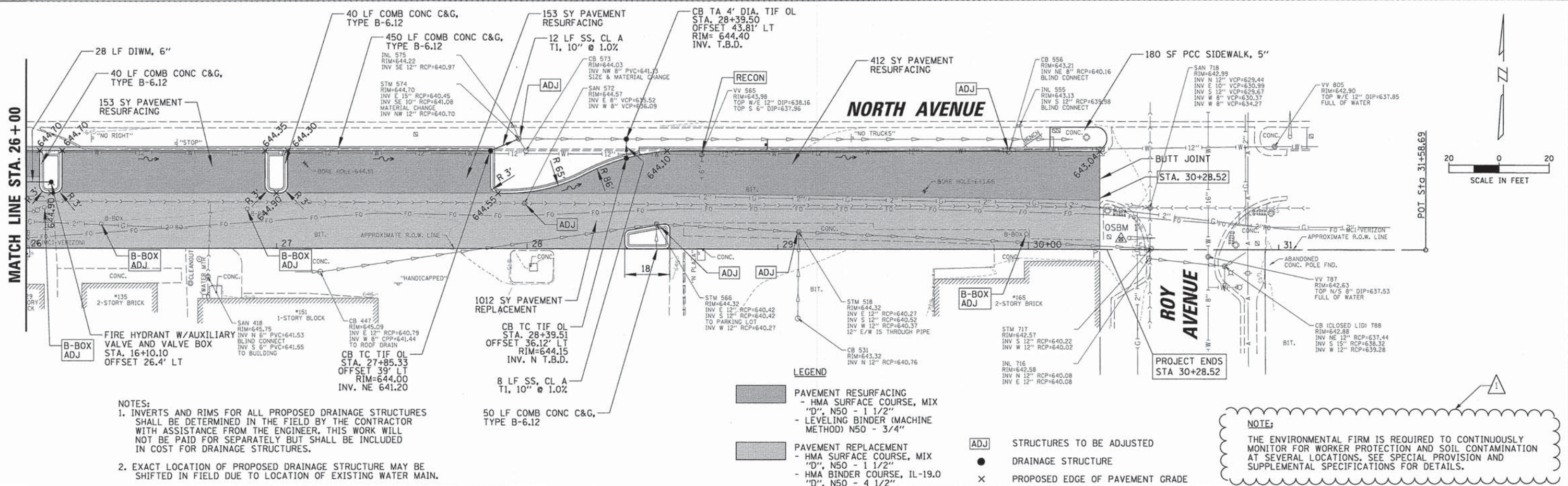

NOTES:
 1. INVERTS AND RIMS FOR ALL PROPOSED DRAINAGE STRUCTURES SHALL BE DETERMINED IN THE FIELD BY THE CONTRACTOR WITH ASSISTANCE FROM THE ENGINEER. THIS WORK WILL NOT BE PAID FOR SEPARATELY BUT SHALL BE INCLUDED IN COST FOR DRAINAGE STRUCTURES.
 2. EXACT LOCATION OF PROPOSED DRAINAGE STRUCTURE MAY BE SHIFTED IN FIELD DUE TO LOCATION OF EXISTING WATER MAIN.

LEGEND
 [] PAVEMENT RESURFACING
 - HMA SURFACE COURSE, MIX "D", N50 - 1 1/2"
 - LEVELING BINDER (MACHINE METHOD) N50 - 3/4"
 [] PAVEMENT REPLACEMENT
 - HMA SURFACE COURSE, MIX "D", N50 - 1 1/2"
 - HMA BINDER COURSE, IL-19.0 "D", N50 - 4 1/2"
 [] STRUCTURES TO BE ADJUSTED
 ● DRAINAGE STRUCTURE
 x PROPOSED EDGE OF PAVEMENT GRADE

NOTE:
 THE ENVIRONMENTAL FIRM IS REQUIRED TO CONTINUOUSLY MONITOR FOR WORKER PROTECTION AND SOIL CONTAMINATION AT SEVERAL LOCATIONS. SEE SPECIAL PROVISION AND SUPPLEMENTAL SPECIFICATIONS FOR DETAILS.

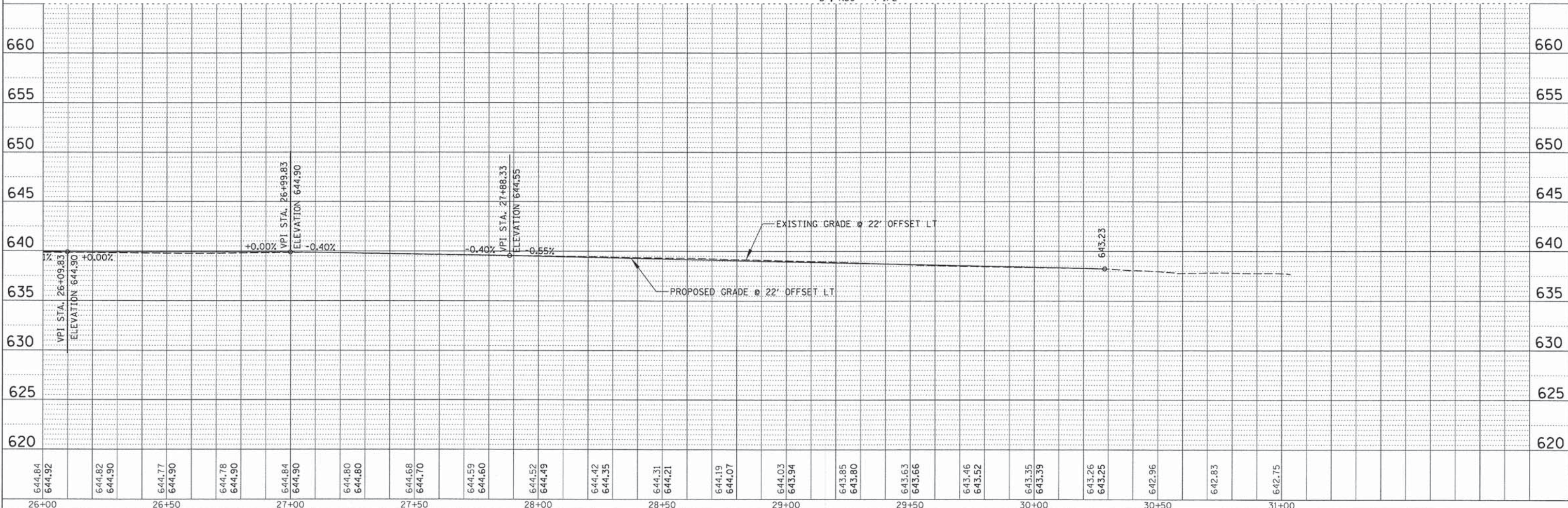

644.84	644.92	644.82	644.90	644.77	644.90	644.78	644.90	644.84	644.90	644.80	644.80	644.68	644.70	644.59	644.60	644.52	644.49	644.42	644.35	644.31	644.21	644.19	644.07	644.03	643.94	643.85	643.80	643.63	643.66	643.46	643.52	643.35	643.39	643.26	643.25	642.96	642.83	642.75																																																														
26+00	26+05	26+10	26+15	26+20	26+25	26+30	26+35	26+40	26+45	26+50	26+55	26+60	26+65	26+70	26+75	26+80	26+85	26+90	26+95	27+00	27+05	27+10	27+15	27+20	27+25	27+30	27+35	27+40	27+45	27+50	27+55	27+60	27+65	27+70	27+75	27+80	27+85	27+90	27+95	28+00	28+05	28+10	28+15	28+20	28+25	28+30	28+35	28+40	28+45	28+50	28+55	28+60	28+65	28+70	28+75	28+80	28+85	28+90	28+95	29+00	29+05	29+10	29+15	29+20	29+25	29+30	29+35	29+40	29+45	29+50	29+55	29+60	29+65	29+70	29+75	29+80	29+85	29+90	29+95	30+00	30+05	30+10	30+15	30+20	30+25	30+30	30+35	30+40	30+45	30+50	30+55	30+60	30+65	30+70	30+75	30+80	30+85	30+90	30+95	31+00

STATE OF ILLINOIS
 DEPARTMENT OF TRANSPORTATION

PLAN AND PROFILE
 PRATER AVENUE TO ROY AVENUE

F.A.P. RTE. 307	SECTION 13-00085-00-CH	COUNTY COOK	TOTAL SHEETS 34	SHEET NO. 12
CONTRACT NO. 61A43				
FED. ROAD DIST. NO. [] ILLINOIS FED. AID PROJECT				

SCALE: SHEET NO. OF SHEETS STA. TO STA.

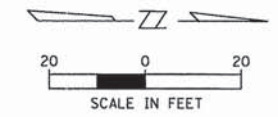

NOTES:
 1. INVERTS AND RIMS FOR ALL PROPOSED DRAINAGE STRUCTURES SHALL BE DETERMINED IN THE FIELD BY THE CONTRACTOR WITH ASSISTANCE FROM THE ENGINEER. THIS WORK WILL NOT BE PAID FOR SEPARATELY BUT SHALL BE INCLUDED IN COST FOR DRAINAGE STRUCTURES.

- LEGEND**
- PAVEMENT RESURFACING
 - HMA SURFACE COURSE, MIX "D", N50 - 1 1/2"
 - LEVELING BINDER (MACHINE METHOD) N50 - 3/4"
 - PAVEMENT REPLACEMENT
 - HMA SURFACE COURSE, MIX "D", N50 - 1 1/2"
 - HMA BINDER COURSE, IL-19.0 "D", N50 - 4 1/2"
 - ADJ STRUCTURES TO BE ADJUSTED
 - DRAINAGE STRUCTURE
 - × PROPOSED EDGE OF PAVEMENT GRADE

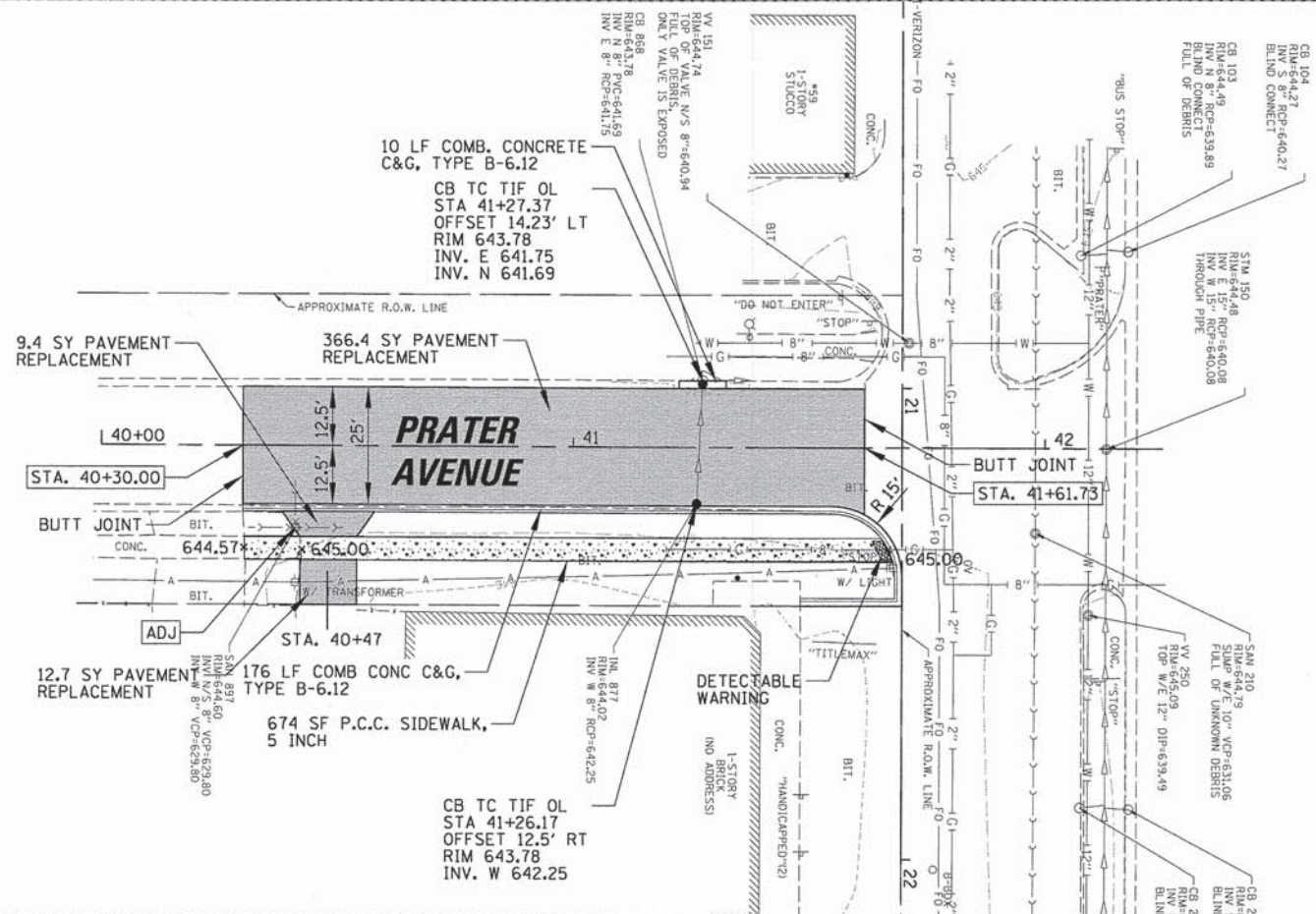

NOTE:
 THE ENVIRONMENTAL FIRM IS REQUIRED TO CONTINUOUSLY MONITOR FOR WORKER PROTECTION AND SOIL CONTAMINATION AT SEVERAL LOCATIONS. SEE SPECIAL PROVISION AND SUPPLEMENTAL SPECIFICATIONS FOR DETAILS.

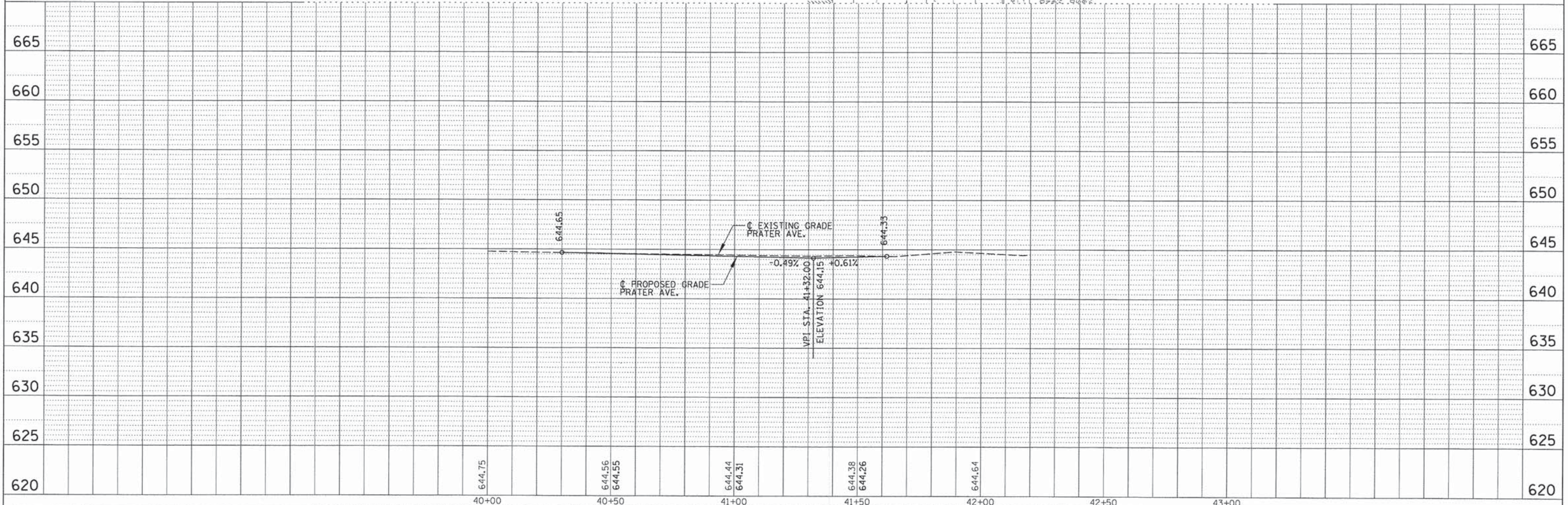

PLAN SURVEYED _____ PLOTTED _____ ALIGNED _____ CHECKED _____ DATE _____ CADD FILE NAME _____	PROFILE SURVEYED _____ PLOTTED _____ BAL. NOTED _____ STRUCTURE NOTATIONS CHVD _____ DATE _____
--	---

CHRISTOPHER B. BURKE
 ENGINEERING LTD.
 8575 West Higgins Road, Suite 600
 Rosemont, Illinois 60018
 (847) 823-0500

FILE NAME =	USER NAME = adufundt	DESIGNED - AMP	REVISED - 6/2/14	STATE OF ILLINOIS	PLAN AND PROFILE	F.A.P. RTE. 307	SECTION 13-00085-00-CH	COUNTY COOK	TOTAL SHEETS 34	SHEET NO. 13
N:\NORTHLAKE\940032HR - Municipal Review Projects\940032 HR 200's\940032HR219\Civil\PH\DRAWN2HR219.0\FB\ter.sht DRAWN 2HR219.0FB ter.sht PLOT SCALE = 20' PLOT DATE = 6/2/2014				DEPARTMENT OF TRANSPORTATION	PRATER AVENUE	CONTRACT NO. 61A43		FED. ROAD DIST. NO. [ILLINOIS] FED. AID PROJECT		
CHECKED - MEW DATE -				SCALE: SHEET NO. OF SHEETS STA. TO STA.						

WORK SHALL MEET THE REQUIREMENTS OF THE SPECIAL PROVISIONS, "TRAFFIC SIGNAL SPECIFICATIONS FOR DETECTOR LOOP REPLACEMENT AND/OR INSTALLATION ON ROADWAY GRINDING, RESURFACING AND PATCHING OPERATIONS". SPECIAL ATTENTION MUST BE MADE TO THE SECTIONS "INSPECTION OF CONSTRUCTION" AND "DETECTOR LOOP REPLACEMENT" FOR INSTALLATION AND INSPECTION REQUIREMENTS. LOOP REPLACEMENT WORK THAT DOES NOT MEET THE CONTRACT REQUIREMENTS SHALL NOT BE PAID. WORK NECESSARY TO COMPLETE THE LOOP REPLACEMENT WORK MAY BE ASSIGNED BY THE ENGINEER TO IDOT'S ELECTRICAL MAINTENANCE CONTRACTOR (EMC); ALL RELATED COSTS WILL BE THE RESPONSIBILITY OF THE CONTRACTOR.

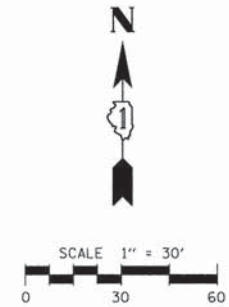

DATE	BY	SURVEYED	PLANNED
		PLOTTED	NOTED
		FILED	STRUCTURE
		REVISIONS	NOTATIONS
		REVISIONS	NOTATIONS
		REVISIONS	NOTATIONS
		REVISIONS	NOTATIONS
		REVISIONS	NOTATIONS
		REVISIONS	NOTATIONS
		REVISIONS	NOTATIONS

CHRISTOPHER B. BURKE
ENGINEERING LTD.
9575 West Higgins Road, Suite 600
Rosemont, Illinois 60018
(847) 823-0500

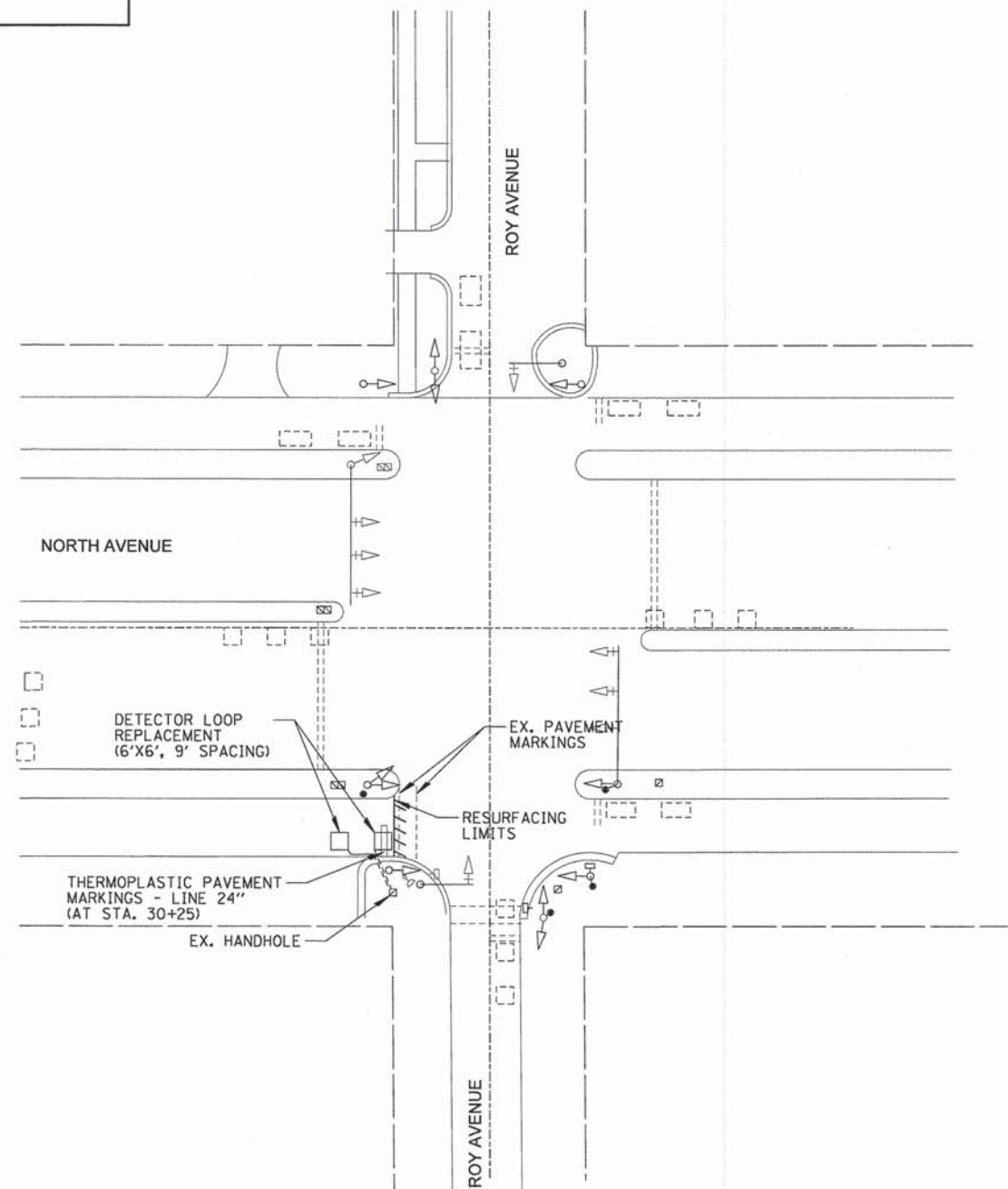

TRAFFIC SIGNAL LEGEND

ITEM	PROPOSED	EXISTING
SIGNAL HEAD WITH BACKPLATE		▲
SIGNAL HEAD		▲
DETECTOR LOOP	□	□

NOTE:
THE ENVIRONMENTAL FIRM IS REQUIRED TO CONTINUOUSLY MONITOR FOR WORKER PROTECTION AND SOIL CONTAMINATION AT SEVERAL LOCATIONS. SEE SPECIAL PROVISION AND SUPPLEMENTAL SPECIFICATIONS FOR DETAILS.

**THIS PLAN IS FOR THE SOLE PURPOSE OF
DETECTOR LOOP REPLACEMENT**

REPLACE ALL DETECTOR LOOPS AS SHOWN
(WITHIN THE RESURFACING LIMITS)

CODE	QUANTITY	UNIT	ITEM
88600600	70	FOOT	DETECTOR LOOP REPLACEMENT