



POLYUREA PAVEMENT MARKING TYPE II - LINE 4" (WHITE SKIP-DASH, 30' SKIP 10' DASH)
 GROOVING FOR RECESSED PAVEMENT MARKING 5"
 RAISED REFLECTIVE PAVEMENT MARKER (SINGLE, 1-WAY CRYSTAL 40' O.C.)

POLYUREA PAVEMENT MARKING TYPE II - LETTERS AND SYMBOLS (TYP.)
 (SEE DIST. STD. 41.1 FOR SYMBOL DETAILS)

POLYUREA PAVEMENT MARKING TYPE II - LINE 8" (WHITE SOLID)
 GROOVING FOR RECESSED PAVEMENT MARKING 9"
 RAISED REFLECTIVE PAVEMENT MARKER (SINGLE, 1-WAY CRYSTAL AT 3" OFFSET & 20' O.C.)

POLYUREA PAVEMENT MARKING TYPE II - LINE 24" (SOLID WHITE)
 GROOVING FOR RECESSED PAVEMENT MARKING 25"

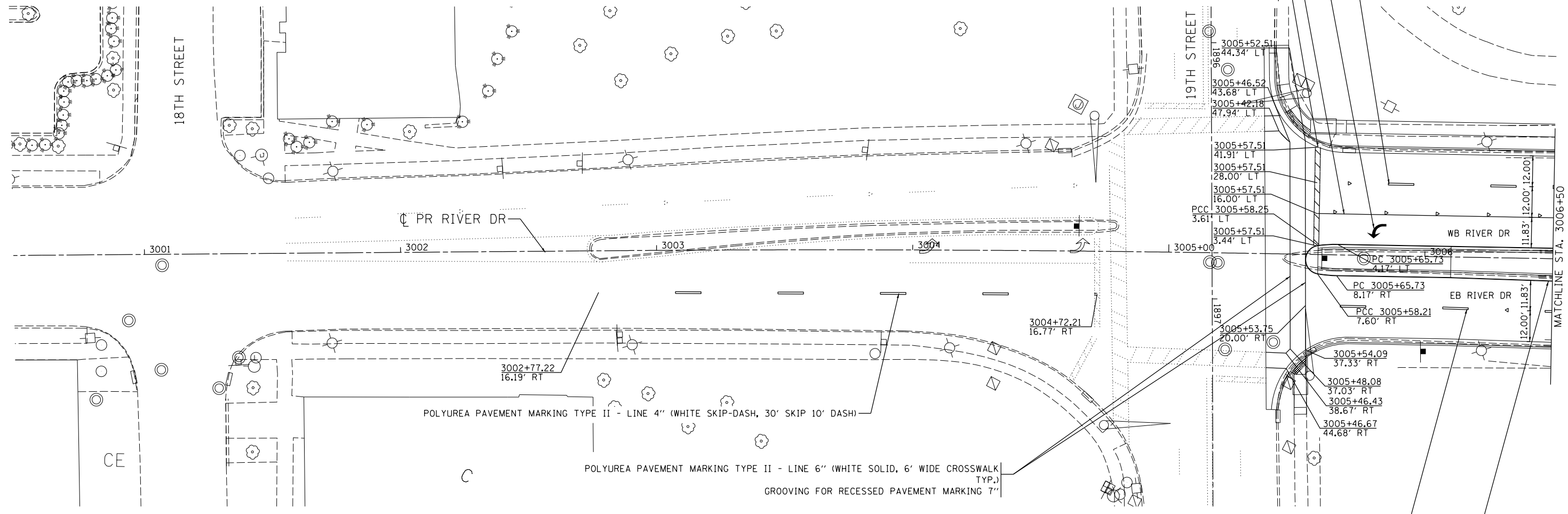

POLYUREA PAVEMENT MARKING TYPE II - LINE 4" (WHITE SKIP-DASH, 30' SKIP 10' DASH)

POLYUREA PAVEMENT MARKING TYPE II - LINE 6" (WHITE SOLID, 6' WIDE CROSSWALK TYP.)
 GROOVING FOR RECESSED PAVEMENT MARKING 7"

POLYUREA PAVEMENT MARKING TYPE II - LINE 4" (WHITE SKIP-DASH, 30' SKIP 10' DASH)
 GROOVING FOR RECESSED PAVEMENT MARKING 5"
 RAISED REFLECTIVE PAVEMENT MARKER (SINGLE, 1-WAY CRYSTAL 40' O.C.)

POLYUREA PAVEMENT MARKING TYPE II - LINE 4" (YELLOW SOLID)
 GROOVING FOR RECESSED PAVEMENT MARKING 5"

NOTES:

- FOR SIGNING INFORMATION, REFER TO SIGNING SHEETS
- DIMENSIONS ARE MEASURED TO CENTER OF PAVEMENT MARKING LINE
- STRIPE OUT FUTURE TURN LANE



LAYOUT	MPV	4/4/2011
DRAWN	MPV	2/5/2013
REVIEWED	MTH	2/12/2013

FILE NAME =	USER NAME = v11a01439	DESIGNED - MPV	REVISED -
D2PACKE-HP5-sht-pmk007.dgn		DRAWN - MPV	REVISED -
	PLOT SCALE =	CHECKED - MTH	REVISED -
	PLOT DATE = 03/26/2014	DATE - 3/7/2014	REVISED -

STATE OF ILLINOIS
 DEPARTMENT OF TRANSPORTATION

PAVEMENT MARKINGS
 RIVER DRIVE

SCALE:	SHEET NO.	OF	SHEETS	STA.	TO	STA.
--------	-----------	----	--------	------	----	------

F.A.U. RTE.	SECTION	COUNTY	TOTAL SHEETS	SHEET NO.
5756	(81-1)M	ROCK ISLAND	217	95
ILLINOIS FED. AID PROJECT			CONTRACT NO. 64J68	

PMK-01