

TYPICAL FRONT ELEVATION
With lights and handrail omitted for clarity.

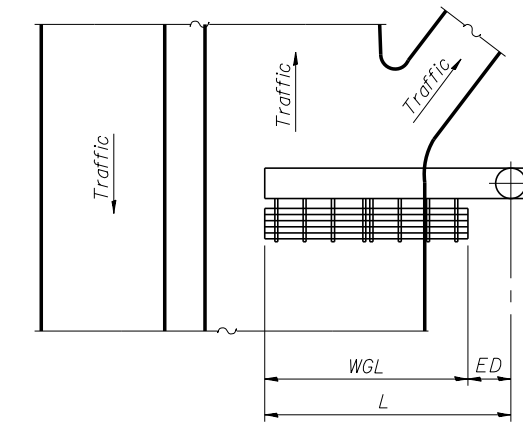

PLAN WALKWAY AND HANDRAIL SKETCH
(Road plan beneath truss varies)

Walkway and truss grating dimensions are nominal and may vary (width ± 1/2", depth ± 1/2") based on available standard widths.

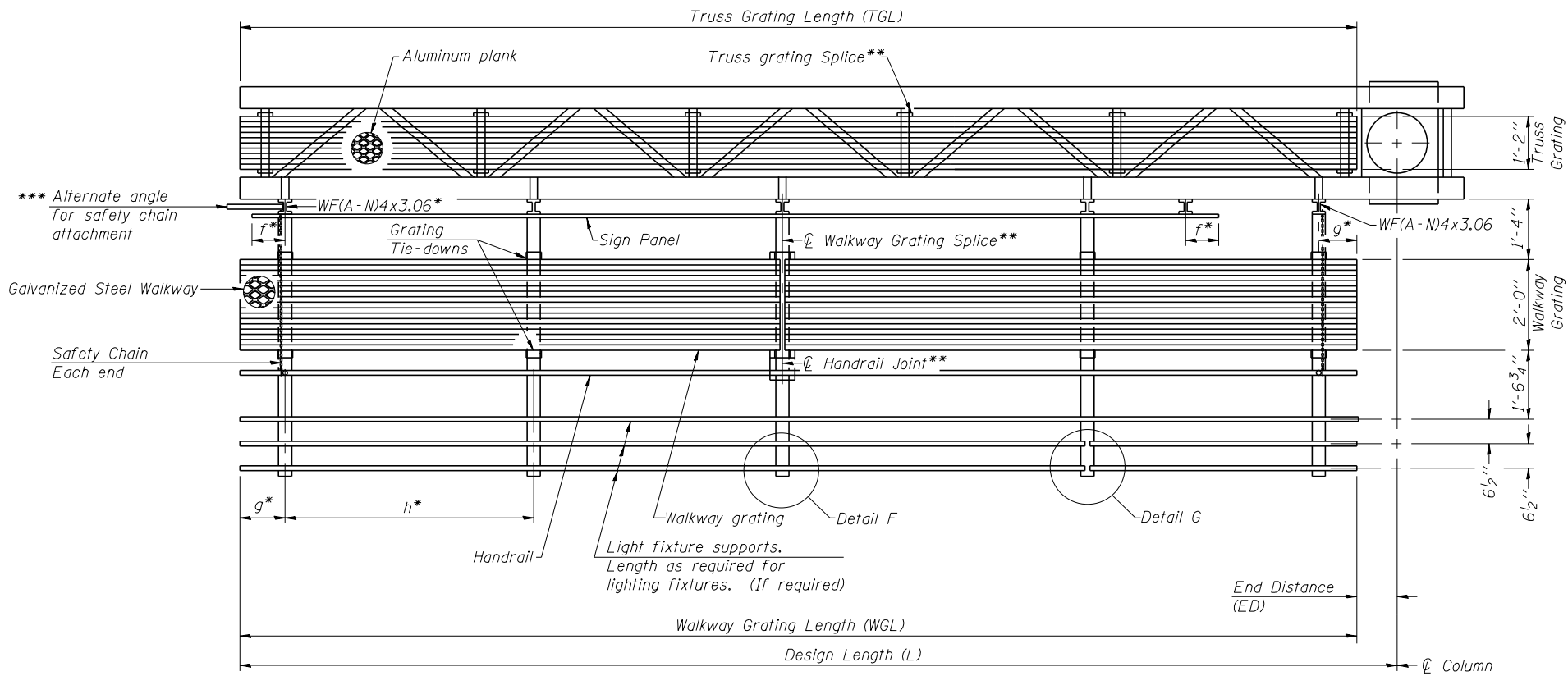

SECTION A-A

Truss grating to facilitate inspection shall run full length of cantilevers. Cost of truss grating is included in Overhead Sign Structure Cantilever.

Handrail and walkway grating shall span a minimum of three brackets between splices.
** Use and location of handrail joints or grating splices are optional, based on lengths needed and material availability.

$$TGL = L - \left(\frac{\text{Post O.D.}}{2} + 6' \right)$$

| Structure Number | Station | WGL | ED | TGL |
|------------------|------------|-----|----|--------|
| 2C081LRIVR000.7 | 3010+20.00 | - | - | 12'-6" |
| 2C081LRIVL000.6 | 3019+40.00 | - | - | 12'-6" |
| | | | | |
| | | | | |
| | | | | |
| | | | | |
| | | | | |
| | | | | |
| | | | | |

Notes:
 * Space walkway brackets WF(A-N)4x3.06 and sign brackets WF(A-N)4x1.79 for efficiency and within limits shown:
 f = 12" maximum, 4" minimum (End of sign to center of nearest bracket)
 g = 12" maximum, 4" minimum (End of walkway to center of nearest bracket)
 h = 6'-0" maximum (center to center sign and/or walkway support brackets, WF(A-N)4x1.79 or WF(A-N)4x3.06)
 *** If walkway bracket at safety chain location is behind sign, add angle to bracket. See alternate safety chain attachment on base sheet OSC-A-8.
 For details of sign placement, sign/walkway brackets, truss and walkway gratings, grating splices and Section B-B, see Base Sheet OSC-A-7S.
 For details of handrail, handrail joint, safety chain and Details F and G, see Base Sheet OSC-A-8.

BRACKET TABLE

| Sign Width | | Number Brackets Required |
|--------------|-----------------------|--------------------------|
| Greater Than | Less Than or Equal To | |
| | 8'-0" | 2 |
| 8'-0" | 14'-0" | 3 |
| 14'-0" | 20'-0" | 4 |
| 20'-0" | 26'-0" | 5 |
| 26'-0" | 32'-0" | 6 |

SIGN PANEL (DMS), SIGN PANEL SUPPORTS, WALKWAY GRATING, WALKWAY SUPPORTS, HANDRAIL AND LIGHTING ARE NOT INCLUDED IN THIS CONTRACT. INFORMATION SHOWN ON THIS SHEET SHALL BE USED FOR TRUSS GRATING ONLY.

| | | | |
|--|-------------------|--------------------|-----------|
| FILE NAME = ArtCantDMS-TBD-100-ArtCantDMSupp01.dgn | USER NAME = knous | DESIGNED - MFB/MFH | REVISED - |
| MODEL = E 07 05-A-6S Cantilever Sign Structures | PLOT SCALE = | CHECKED - KJN | REVISED - |
| PLOT DATE = 3/6/2014 | | DRAWN - MFB | REVISED - |
| | | CHECKED - KJN | REVISED - |