

DATE	
BY	
SURVEYED	
PLOTTED	
TEMPLATE	
AREAS	
CHECKED	
FINAL SURVEY	
NOTE BOOK	
NO.	



© Copyright Hanson Professional Services Inc.

DATE	
BY	
SURVEYED	
PLOTTED	
TEMPLATE	
AREAS	
CHECKED	
ORIGINAL SURVEY	
NOTE BOOK	
NO.	

DATE	9/14/2011
BY	RLT
SURVEYED	
PLOTTED	
TEMPLATE	
AREAS	
CHECKED	
ORIGINAL SURVEY	
NOTE BOOK	
NO.	
DATE	2/22/2013
BY	RLT
SURVEYED	
PLOTTED	
TEMPLATE	
AREAS	
CHECKED	
ORIGINAL SURVEY	
NOTE BOOK	
NO.	
DATE	3/5/2014
BY	MTH
SURVEYED	
PLOTTED	
TEMPLATE	
AREAS	
CHECKED	
ORIGINAL SURVEY	
NOTE BOOK	
NO.	

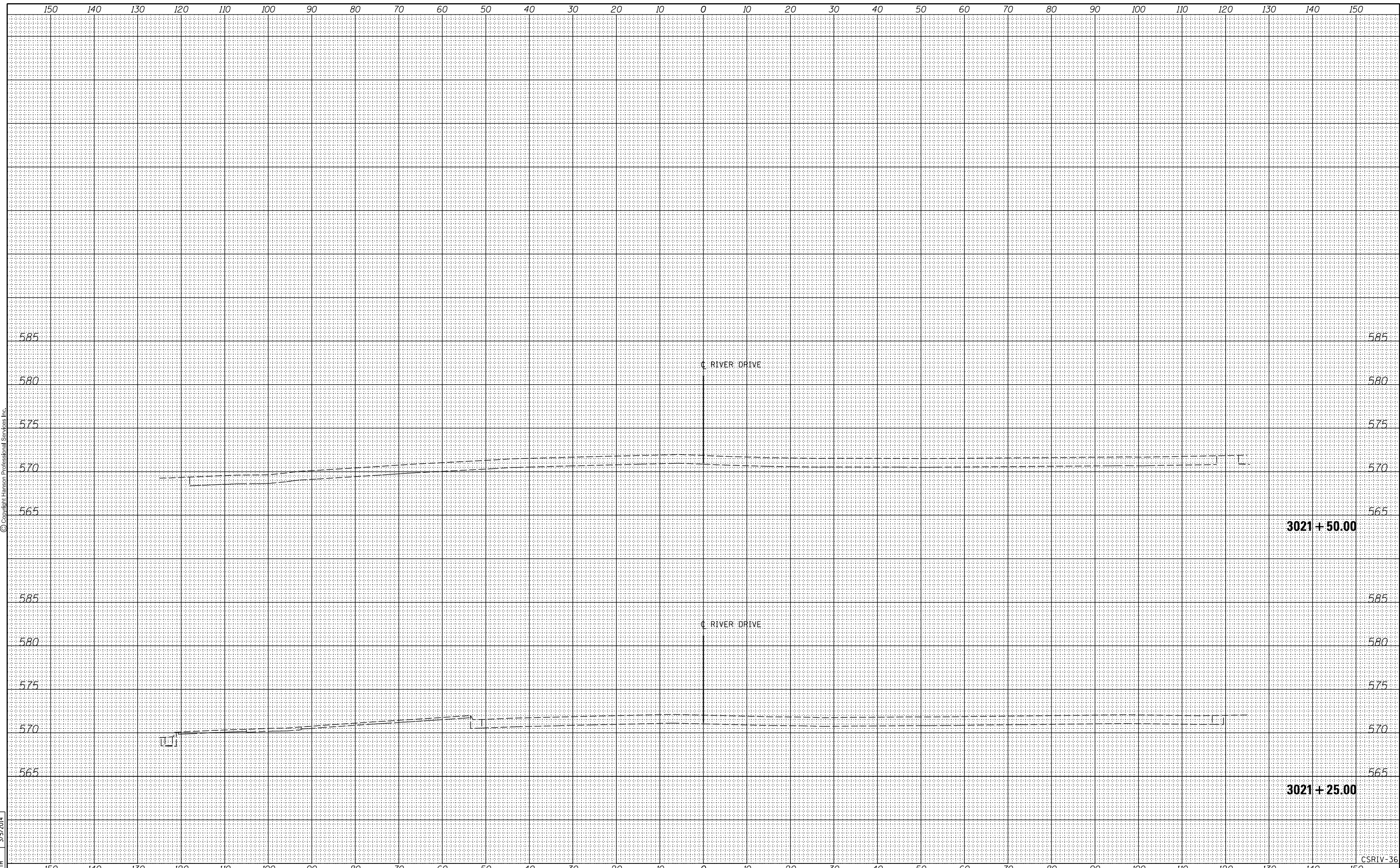

FILE NAME =	D2PACKE-HPS-sht-xssht001L.dgn	USER NAME =	plsa001256	DESIGNED -	RLT	REVISIED -		CROSS SECTIONS RIVER DRIVE				F.A.U	SECTION	COUNTY	TOTAL SHEETS	SHEET NO.					
LAYOUT	REVIEWED	DRAWN	REVIEWED	DRAWN	REVIEWED	CHECKED	DATE					5756	(81-1)M	ROCK ISLAND	217	197					
PLOT SCALE =		PLOT DATE =	03/06/2014	CHECKED	AAP/MTH	REVISIED						SCALE:				SHEET NO.	OF	SHEETS	STA. 3021+25.00 TO STA. 3021+50.00	CONTRACT NO.	64J68
				DATE	3/7/2014	REVISIED										ILLINOIS FED. AID PROJECT					

CSRIV-36