

**PAVEMENT REINFORCEMENT DETAIL**

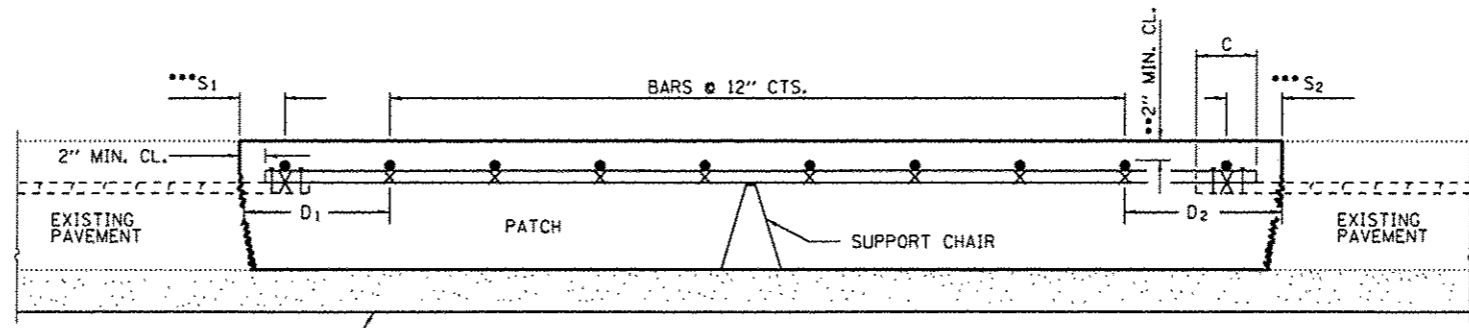

**PATCHING DETAIL  
WITHOUT HMA SURFACE**

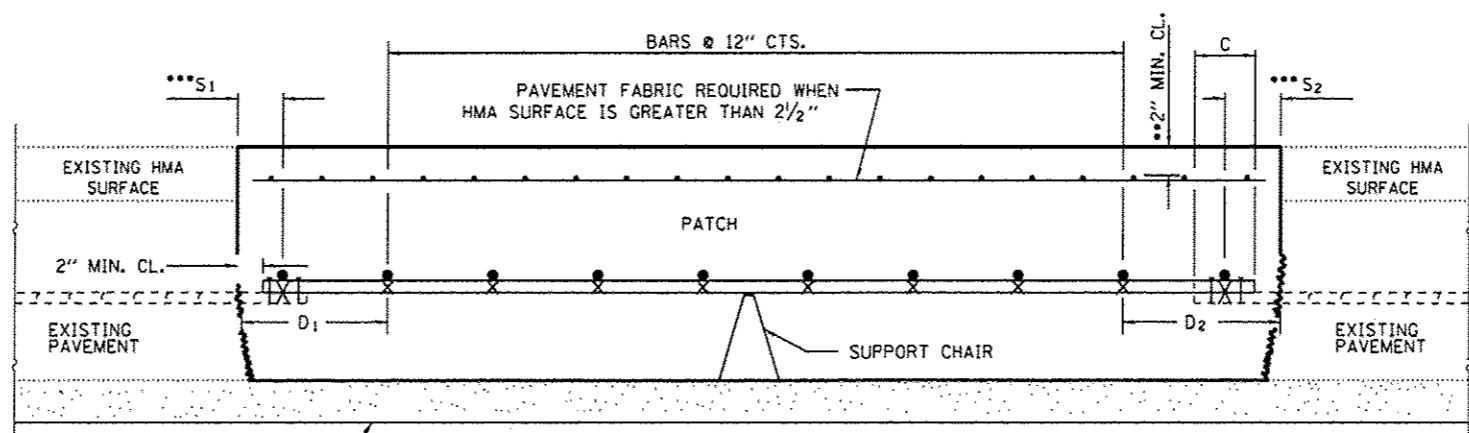

**PATCHING DETAIL  
WITH HMA SURFACE**

- EVERY 3<sup>rd</sup> INTERSECTION MUST BE TIED.
- WHEN THE MINIMUM CLEARANCE CANNOT BE OBTAINED WITH THE TRANSVERSE REBAR ON TOP, THEN THE TRANSVERSE REBAR SHALL BE TIED TO THE BOTTOM OF THE LONGITUDINAL REBAR.
- VARIABLES: WHERE S<sub>1</sub> AND S<sub>2</sub> ARE 2 1/2" MIN. AND 12" MAX. D<sub>1</sub> = 2(S<sub>1</sub>) AND D<sub>2</sub> = 2(S<sub>2</sub>).

FILE NAME *	USER NAME * santacruzja	DESIGNED -	REVISED -
c:\pwork\pedit\santacruzja\0308031\0366078-sht-details.dgn		DRAWN -	REVISED -
#MODELNAME#	PLOT SCALE * 500000.0018 / in.	CHECKED -	REVISED -
	PLOT DATE * 3/31/2014	DATE -	REVISED -

**STATE OF ILLINOIS  
DEPARTMENT OF TRANSPORTATION**

**CLASS A PATCHES**

SCALE: \_\_\_\_\_ SHEET 2 OF 2 SHEETS STA. \_\_\_\_\_ TO STA. \_\_\_\_\_

F.A.I. RTE.	SECTION	COUNTY	TOTAL SHEETS	SHEET NO.
55	D3 PATCHING 2015-2	LIVINGSTON	15	14
CONTRACT NO. 66D78				
[ILLINOIS] FED. AID PROJECT				