

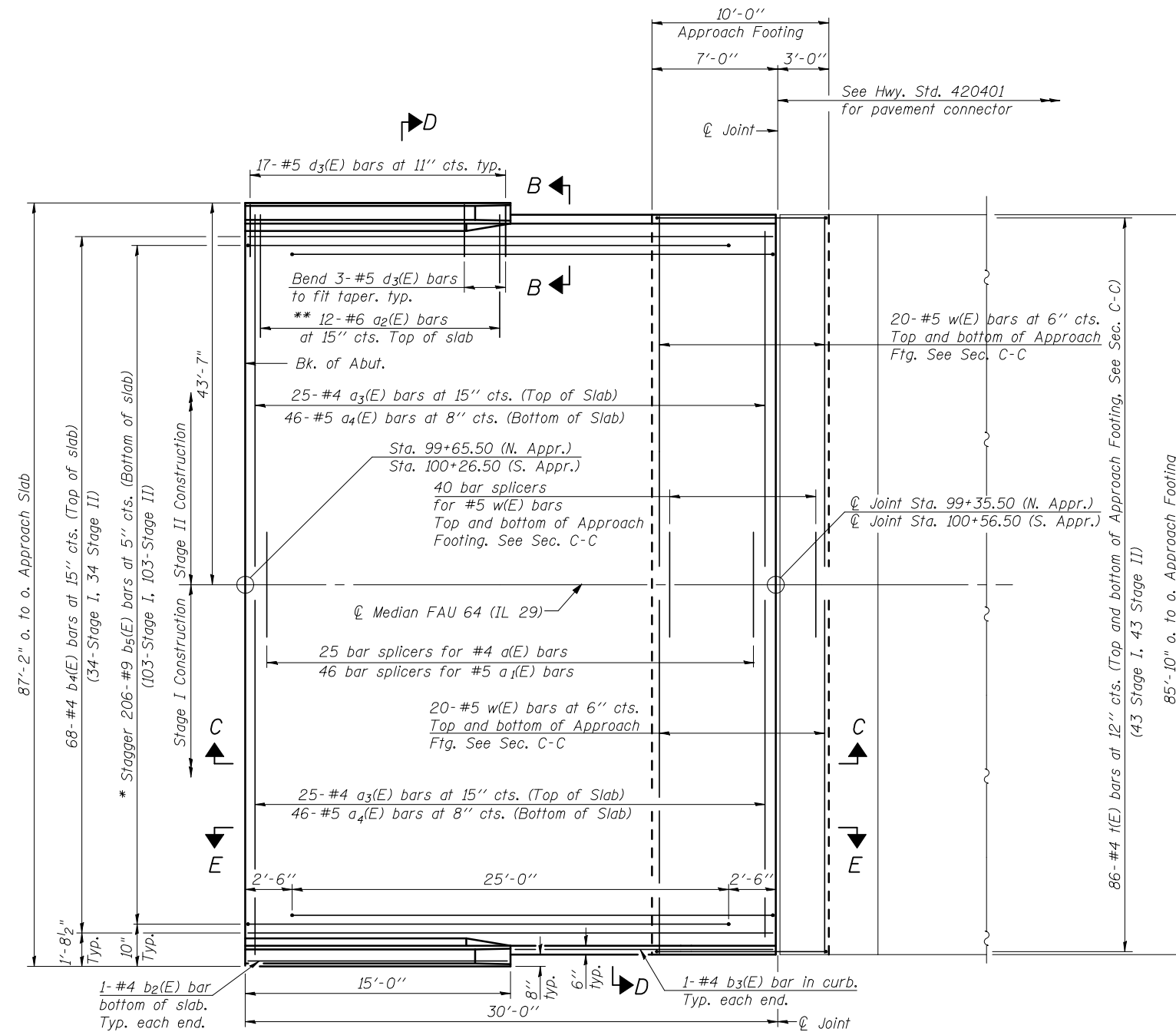

Notes:
See sheet 13 of 27 for Sections C-C & D-D and View E-E.
a(E), a₁(E), and w(E) bar spacings measured along \varnothing Rdwy.



PLAN

(S. Appr shown, N. Appr similar)

- * Tilt #9 b₁(E) bars as required to maintain clearance.
- ** Space between a(E) bars, typ. ea. parapet.

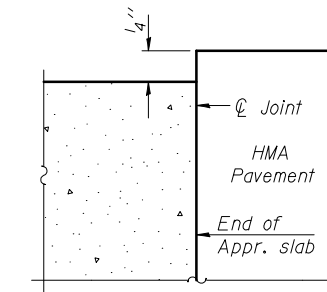

FLEXIBLE PAVEMENT

DETAIL A

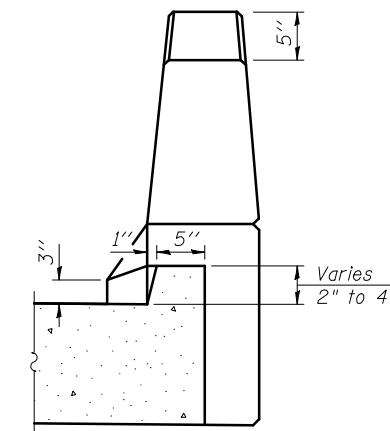

VIEW B-B

(Sheet 1 of 2)

| | | | | | | | | | | |
|---|----------------------------------|---------------|-----------|---|--|--------------------|---------------------------|-----------------|-------------------|----------------|
| FILE NAME = ...\\0720226-68481-012-ApprSlab01s.dgn | USER NAME = _USER_ | DESIGNED - AB | REVISED - | STATE OF ILLINOIS DEPARTMENT OF TRANSPORTATION | BRIDGE APPROACH SLAB DETAILS STRUCTURE NO. 072-0226 | F.A.U. RTE. = 64 | SECTION = (10B) BR | COUNTY = PEORIA | TOTAL SHEETS = 77 | SHEET NO. = 40 |
| | PLOT SCALE = #SCALE# | DRAWN - RMH | REVISED - | | | CONTRACT NO. 68481 | | | | |
| THE UPCHURCH GROUP, INC. | PLOT DATE = 3/1/2013 11:27:01 AM | CHECKED - LP | REVISED - | SHEET NO. 12 OF 27 SHEETS | | | ILLINOIS FED. AID PROJECT | | | |