

NORTH EDGE OF SHOULDER

Location	Station	Offset	Theoretical Grade Elevations
W. End W. Appr. Pav't.	798+81.39	-16.00	513.52
A1	798+91.39	-16.00	513.62
A2	799+01.39	-16.00	513.72
E. End W. Appr. Pav't.	799+11.39	-16.00	513.82

NORTH EDGE OF PAVEMENT

Location	Station	Offset	Theoretical Grade Elevations
W. End W. Appr. Pav't.	798+81.39	-12.00	513.60
A1	798+91.39	-12.00	513.70
A2	799+01.39	-12.00	513.80
E. End W. Appr. Pav't.	799+11.39	-12.00	513.90

☉ ROADWAY, PG & STAGE CONSTRUCTION JOINT

Location	Station	Offset	Theoretical Grade Elevations
W. End W. Appr. Pav't.	798+81.39	0.00	513.79
A1	798+91.39	0.00	513.89
A2	799+01.39	0.00	513.99
E. End W. Appr. Pav't.	799+11.39	0.00	514.09

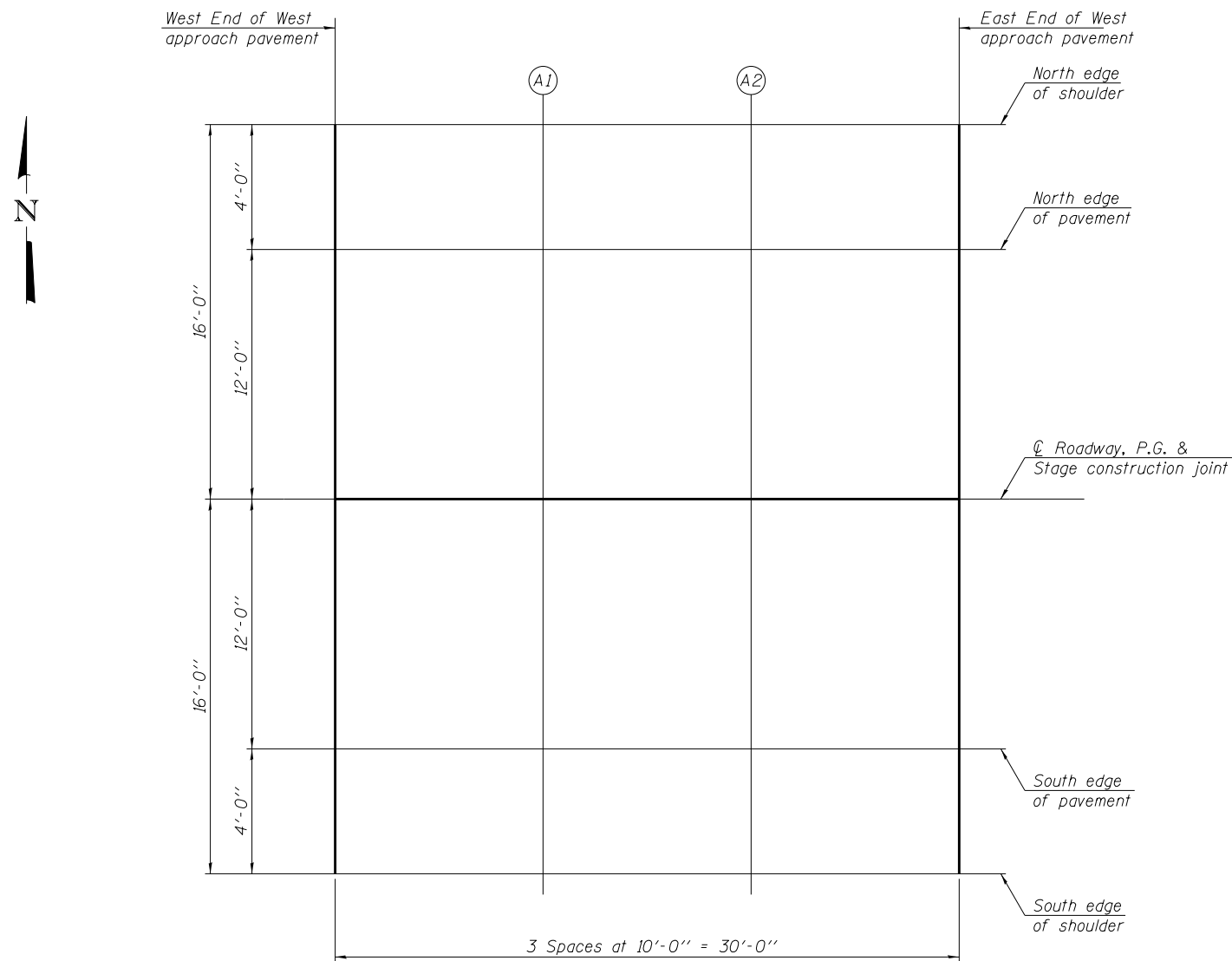

PLAN

SOUTH EDGE OF PAVEMENT

Location	Station	Offset	Theoretical Grade Elevations
W. End W. Appr. Pav't.	798+81.39	12.00	513.60
A1	798+91.39	12.00	513.70
A2	799+01.39	12.00	513.80
E. End W. Appr. Pav't.	799+11.39	12.00	513.90

SOUTH EDGE OF SHOULDER

Location	Station	Offset	Theoretical Grade Elevations
W. End W. Appr. Pav't.	798+81.39	16.00	513.52
A1	798+91.39	16.00	513.62
A2	799+01.39	16.00	513.72
E. End W. Appr. Pav't.	799+11.39	16.00	513.82