

CONSTRUCT PERPENDICULAR CURB RAMP IN ACCORDANCE WITH STANDARD 424001

+14' ± CROSS ST

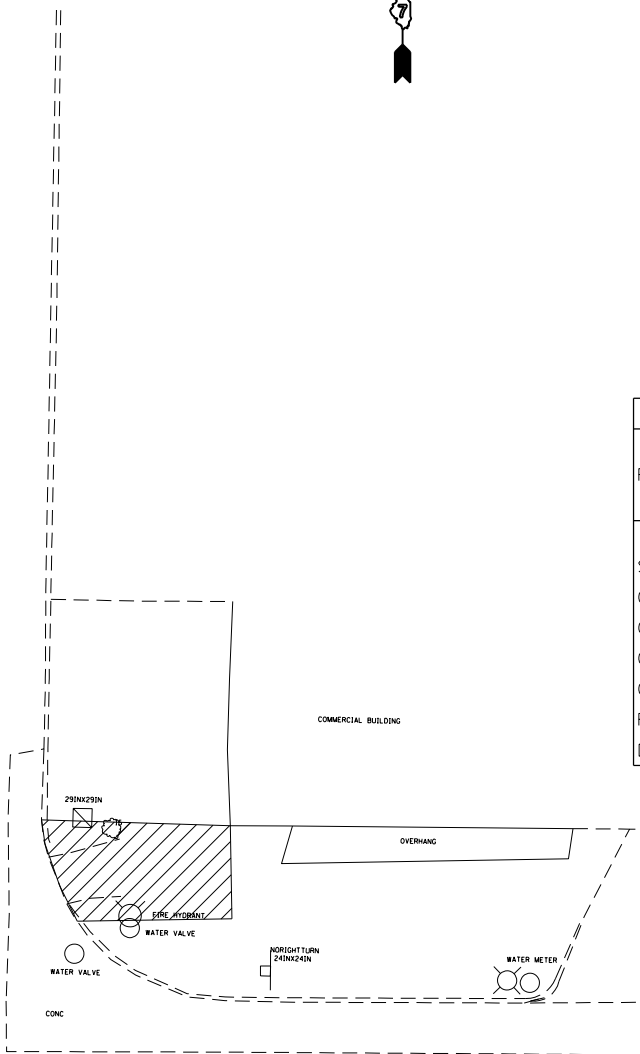

CONSTRUCT PERPENDICULAR CURB RAMP IN ACCORDANCE WITH STANDARD 424001

PAY ITEM (UNIT)	CROSS & MAIN							
	QUADRANT							
	NW		NE		SW		SE	
	state	city	state	city	state	city	state	city
SIDEWALK REMOVAL (SQ FT)		53		118				
CURB REMOVAL (FOOT)								
COMB. CURB & GUTTER REMOVAL (FOOT)								
COMB. CONC. CURB & GUTTER, TYPE B-6.12 (FOOT)								
COMB. CONC. CURB & GUTTER, TYPE B-6.24 (FOOT)								
PCC SIDEWALK 4" (SQ FT)		53		118				
DETECTABLE WARNINGS (SQ FT)		8		8				



FILE NAME =	USER NAME = steffenmk	DESIGNED -	REVISED -
ci:\pw\work\p\dot\steffenmk\d0282300\074554-sht-sidewalk-details.dgn		DRAWN -	REVISED -
Default	PLOT SCALE = 16.0000' / in.	CHECKED -	REVISED -
	PLOT DATE = 4/5/2013	DATE -	REVISED -

**STATE OF ILLINOIS
DEPARTMENT OF TRANSPORTATION**

**SIDEWALK DETAILS
CROSS STREET**

SCALE: SHEET 11 OF 15 SHEETS STA. TO STA.

F.A.P. RTE.	SECTION	COUNTY	TOTAL SHEETS	SHEET NO.
781	(1Z,17Z)RS-1	CRAWFORD	60	41
ILLINOIS FED. AID PROJECT			CONTRACT NO. 74554	