

CONSTRUCT PERPENDICULAR CURB RAMPS IN ACCORDANCE WITH STANDARD 424001

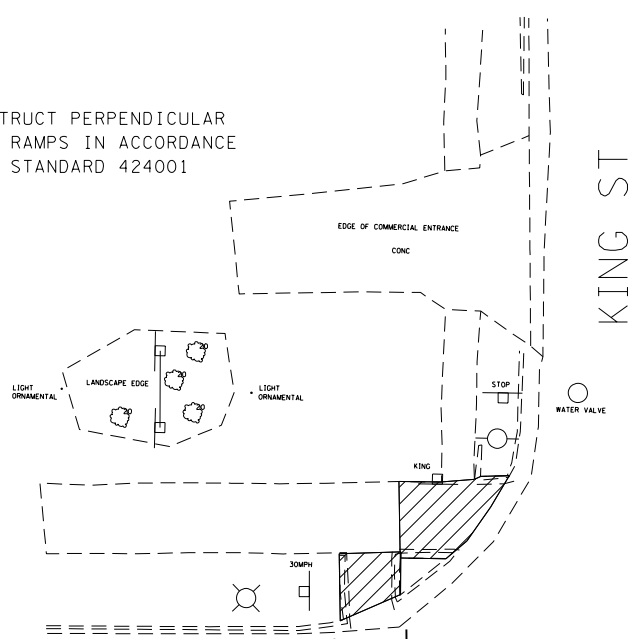

KING ST

CONSTRUCT PERPENDICULAR CURB RAMPS IN ACCORDANCE WITH STANDARD 424001

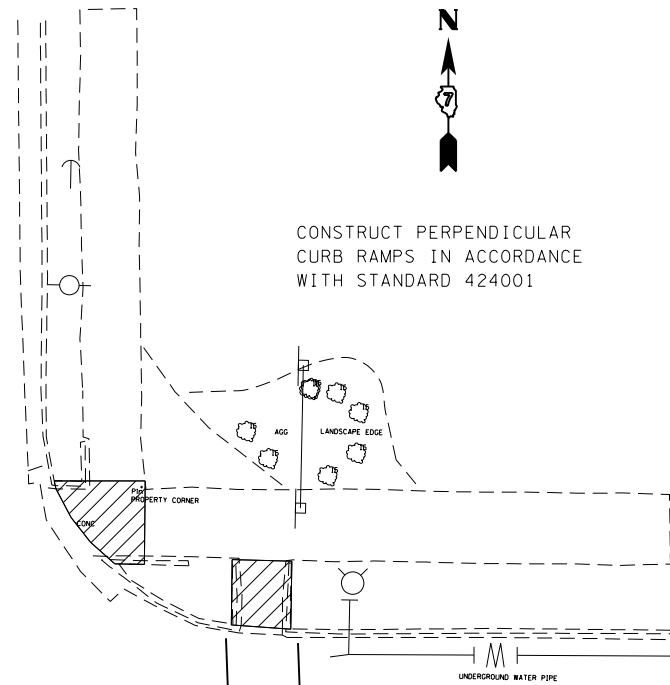

ADD CROSSWALKS

EDGE OF COMMERCIAL ENTRANCE

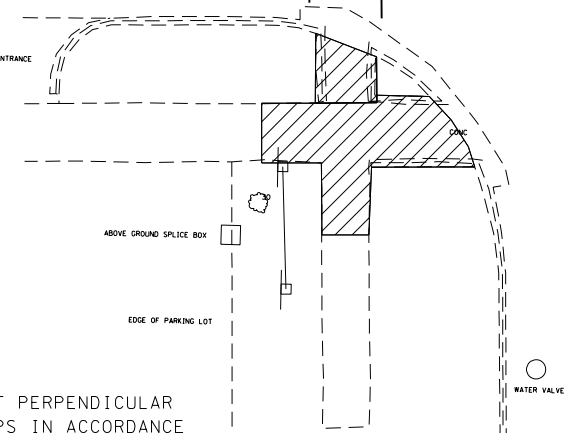

CONSTRUCT PERPENDICULAR CURB RAMPS IN ACCORDANCE WITH STANDARD 424001

KING ST

CONSTRUCT PERPENDICULAR CURB RAMPS IN ACCORDANCE WITH STANDARD 424001



PAY ITEM (UNIT)	KING & MAIN							
	QUADRANT							
	NW		NE		SW		SE	
	state	city	state	city	state	city	state	city
SIDEWALK REMOVAL (SQ FT)	23	44	28	38	137		26	48
CURB REMOVAL (FOOT)			0.1		0.3		0.2	
COMB. CURB & GUTTER REMOVAL (FOOT)								
COMB. CONC. CURB & GUTTER, TYPE B-6.12 (FOOT)								
COMB. CONC. CURB & GUTTER, TYPE B-6.24 (FOOT)								
PCC SIDEWALK 4" (SQ FT)	23	44	28	38	25		27	48
DETECTABLE WARNINGS (SQ FT)	8	8	8	8	16		8	8

FILE NAME =	USER NAME = steffenmk	DESIGNED -	REVISED -
ci:\pw\work\p\idot\steffenmk\d0282300\0774554-sht-sidewalk-details.dgn		DRAWN -	REVISED -
Default	PLOT SCALE = 16.0000' / in.	CHECKED -	REVISED -
	PLOT DATE = 4/5/2013	DATE -	REVISED -

STATE OF ILLINOIS
DEPARTMENT OF TRANSPORTATION

SIDEWALK DETAILS
KING STREET

SCALE: SHEET 15 OF 15 SHEETS STA. TO STA.

F.A.P. RTE.	SECTION	COUNTY	TOTAL SHEETS	SHEET NO.
781	(1Z,17Z)RS-1	CRAWFORD	60	45
CONTRACT NO. 74554			ILLINOIS FED. AID PROJECT	