

**OUTSIDE PLATE AT PANEL POINT U4N AND U4S**  
 (U4'N AND U4'S SIMILAR)  
 (Span 9 and 11)

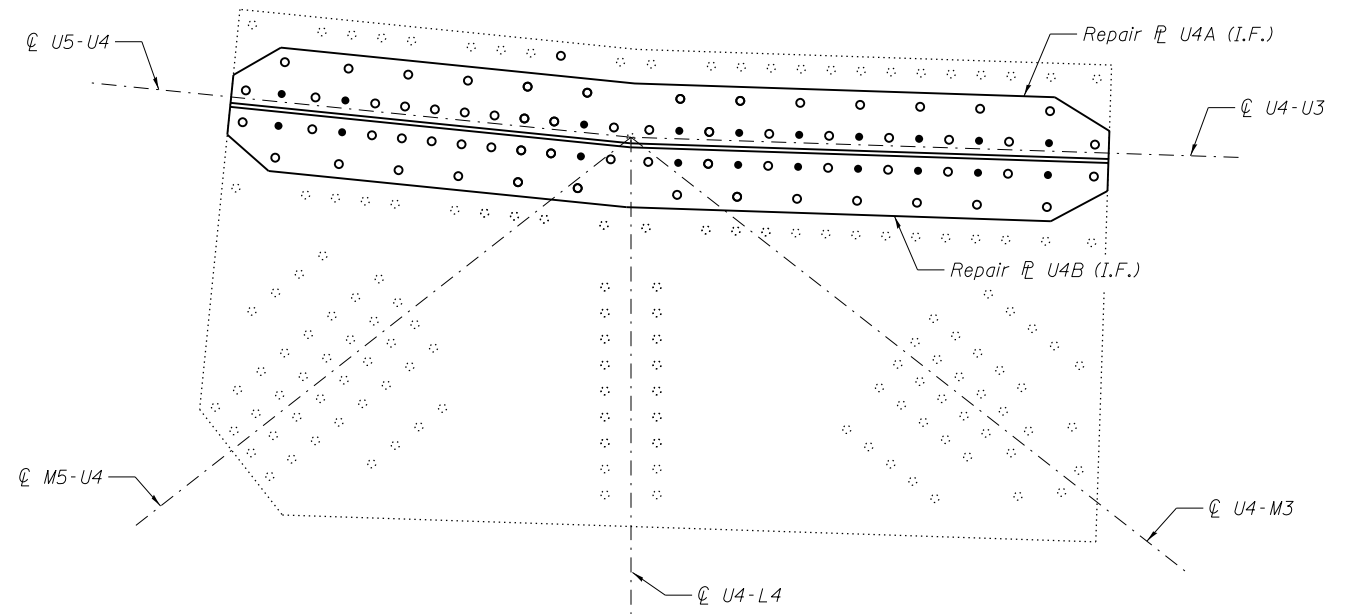

**INSIDE PLATE AT PANEL POINT U4N AND U4S**  
 (U4'N AND U4'S SIMILAR)  
 (Span 9 and 11)

**GUSSET PLATE STRENGTHENING**

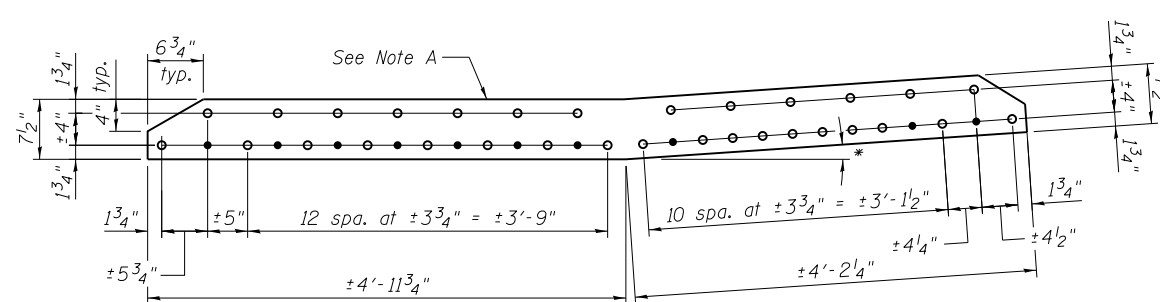

**REPAIR PL U4A**  
 PL 5/8" x 7/2" x ±9'-2"

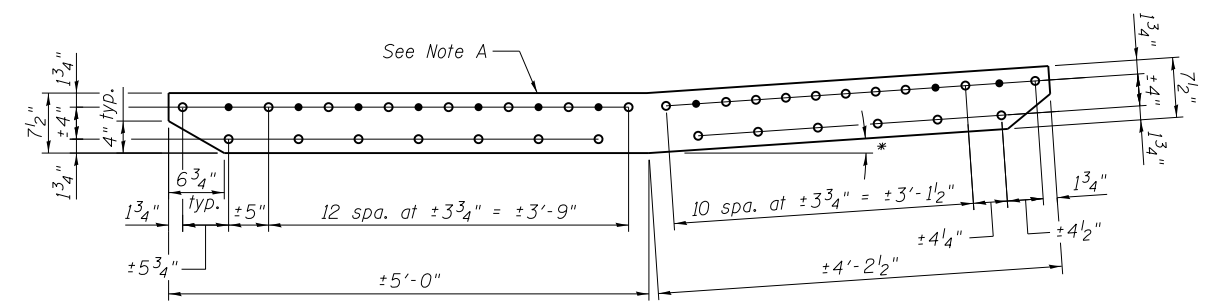

**REPAIR PL U4B**  
 PL 5/8" x 7/2" x ±9'-2 1/2"

\* To be determined in field

Note A:  
 Field drill holes (○) using existing holes as template.  
 Remainder of holes (●) may be shop or field drilled.

**Procedure:**  
 On the Outside face of the Outside Gusset Plate:  
 Install Repair Plate U4A with 1" Dia. A325 H.S. Bolts.  
 After Repair Plate U4A is installed, install Repair Plate U4B with 1" Dia. A325 H.S. Bolts.  
 Repeat for the Inside Gusset Plate.

**BILL OF MATERIAL**

Item	Unit	Total
Structural Steel Repair	Pound	3,080

Note:  
 All bolted connections shown on this sheet shall be made with 1" dia. H.S. bolts unless otherwise noted.  
 For front and inside faces of gusset plates, see truss cross section on sheet S8.



USER NAME =	DESIGNED - MEL	REVISED
	CHECKED - CDB	REVISED
PLOT SCALE =	DRAWN - PRC	REVISED
PLOT DATE = 05/02/2014	CHECKED - MEL	REVISED

**STATE OF ILLINOIS**  
**DEPARTMENT OF TRANSPORTATION**

**MAIN SPANS GUSSET PLATE STRENGTHENING - 11**  
**S.N. 082-6001 MLK BRIDGE OVER MISSISSIPPI RIVER**

SHEET NO. S56 OF S138 SHEETS

F.A.P. RTE.	SECTION	COUNTY	TOTAL SHEETS	SHEET NO.
799	IBR, DRS-2	ST. CLAIR	156	74
CONTRACT NO. 76B03				
ILLINOIS FED. AID PROJECT				