

**OUTSIDE PLATE AT PANEL POINT U10N AND U10S**  
 (U10'N AND U10'S SIMILAR)  
 (Span 9 and 11)

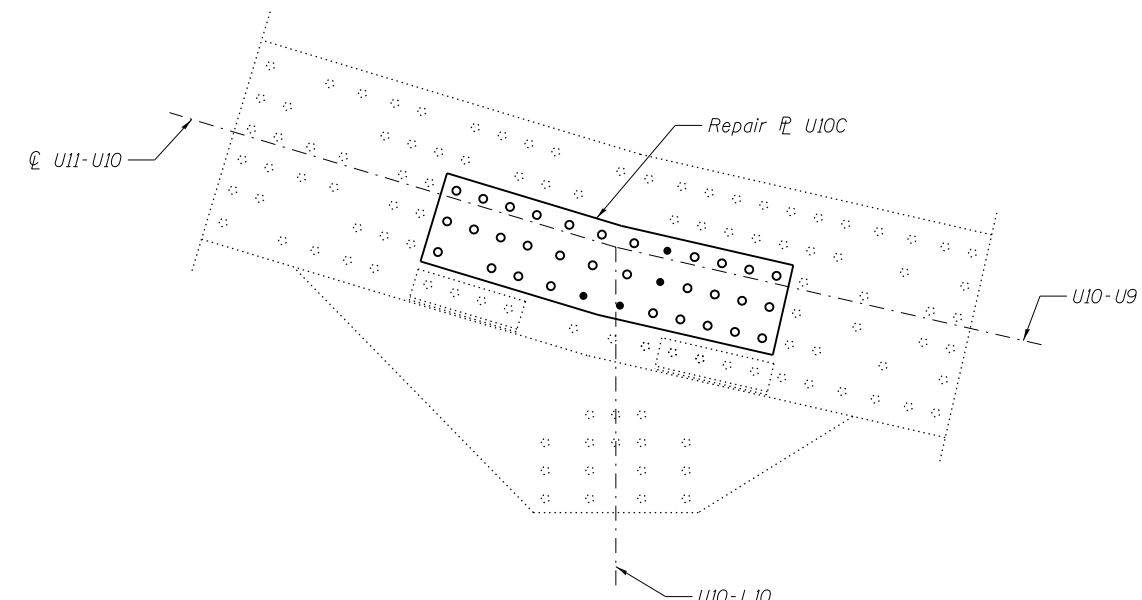

**INSIDE PLATE AT PANEL POINT U10N AND U10S**  
 (U10'N AND U10'S SIMILAR)  
 (Span 9 and 11)

**GUSSET PLATE STRENGTHENING**

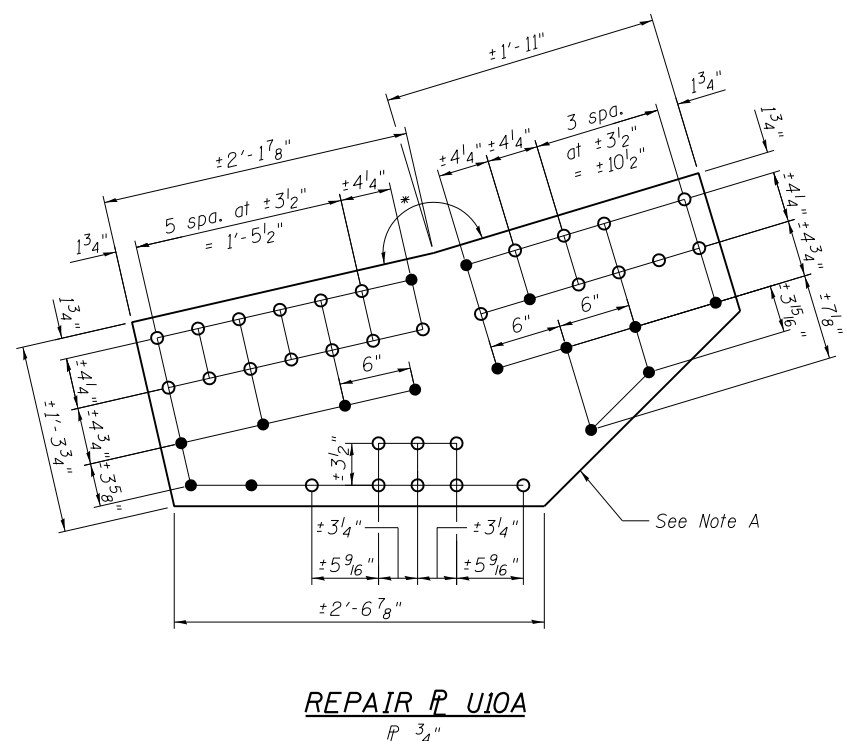

**REPAIR P U10A**  
 P 3/4"

\* To be determined in field

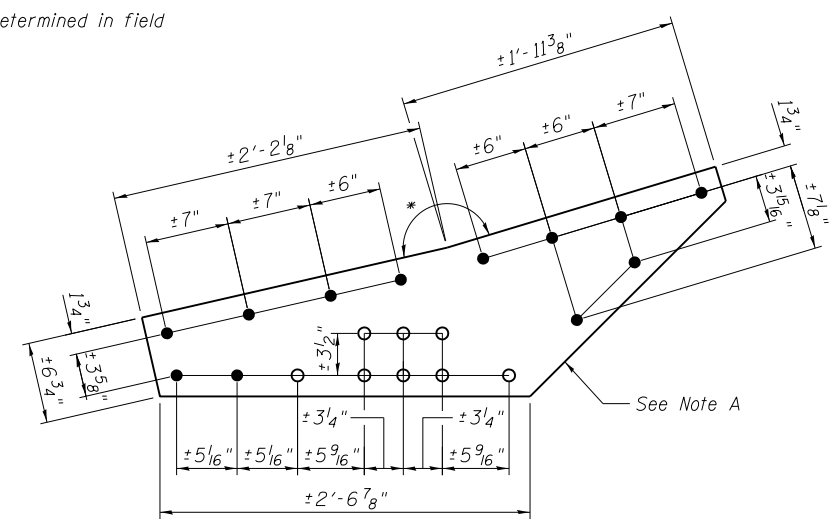

**FILL P U10B**  
 P 3/4"

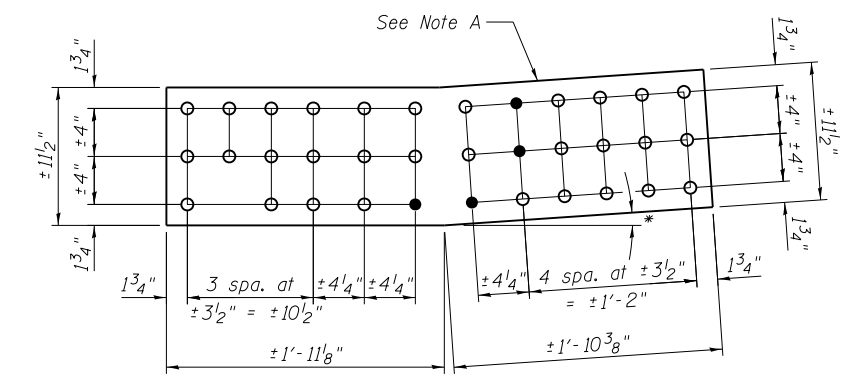

**REPAIR P U10C**  
 P 3/4" x ±11 1/2" x ±3'-9 1/2"

**Procedure:**  
 Install repair plates one at a time.

**BILL OF MATERIAL**

Item	Unit	Total
Structural Steel Repair	Pound	2,030

Note A:  
 Field drill holes (○) using existing holes as template.  
 Remainder of holes (●) may be shop or field drilled.

Note:  
 All bolted connections shown on this sheet shall be made with 1" dia. H.S. bolts unless otherwise noted.



USER NAME =	DESIGNED - MEL	REVISED
PLOT SCALE =	CHECKED - CDB	REVISED
PLOT DATE = 05/02/2014	DRAWN - PRC	REVISED
	CHECKED - MEL	REVISED

**STATE OF ILLINOIS**  
**DEPARTMENT OF TRANSPORTATION**

**MAIN SPANS GUSSET PLATE STRENGTHENING - 13**  
**S.N. 082-6001 MLK BRIDGE OVER MISSISSIPPI RIVER**

SHEET NO. S58 OF S138 SHEETS

F.A.P. RTE. 799	SECTION 1BR, DRS-2	COUNTY ST. CLAIR	TOTAL SHEETS 156	SHEET NO. 76
ILLINOIS FED. AID PROJECT				CONTRACT NO. 76B03