

CONSTRUCTION NOTES:

1. CONTRACTOR SHALL VERIFY EXISTING CONDITIONS PRIOR TO CONSTRUCTION OF ANY RAMP OR SIDEWALK ELEMENTS.
2. PROPOSED ELEVATIONS SHOWN SHALL BE REFINED AS NEEDED TO MEET EXISTING CONDITIONS.
3. SLOPES ON LANDING SHALL BE PREFERABLY NO MORE THAN 1.5% (2% ABSOLUTE MAX.) IN ALL DIRECTIONS.
4. RUNNING SLOPES ON RAMPS SHALL BE 8.3% MAX., CROSS SLOPES ON RAMPS SHALL BE PREFERABLY NO MORE THAN 1.5% (2% ABSOLUTE MAX.).
5. ELEVATIONS SHOWN ARE TOP OF SIDEWALK ELEVATION UNLESS OTHERWISE NOTED. SEE SPECIAL PROVISION ADA ADA RAMP COORDINATED AND ELEVATIONS FOR POINT REFERENCE DATA

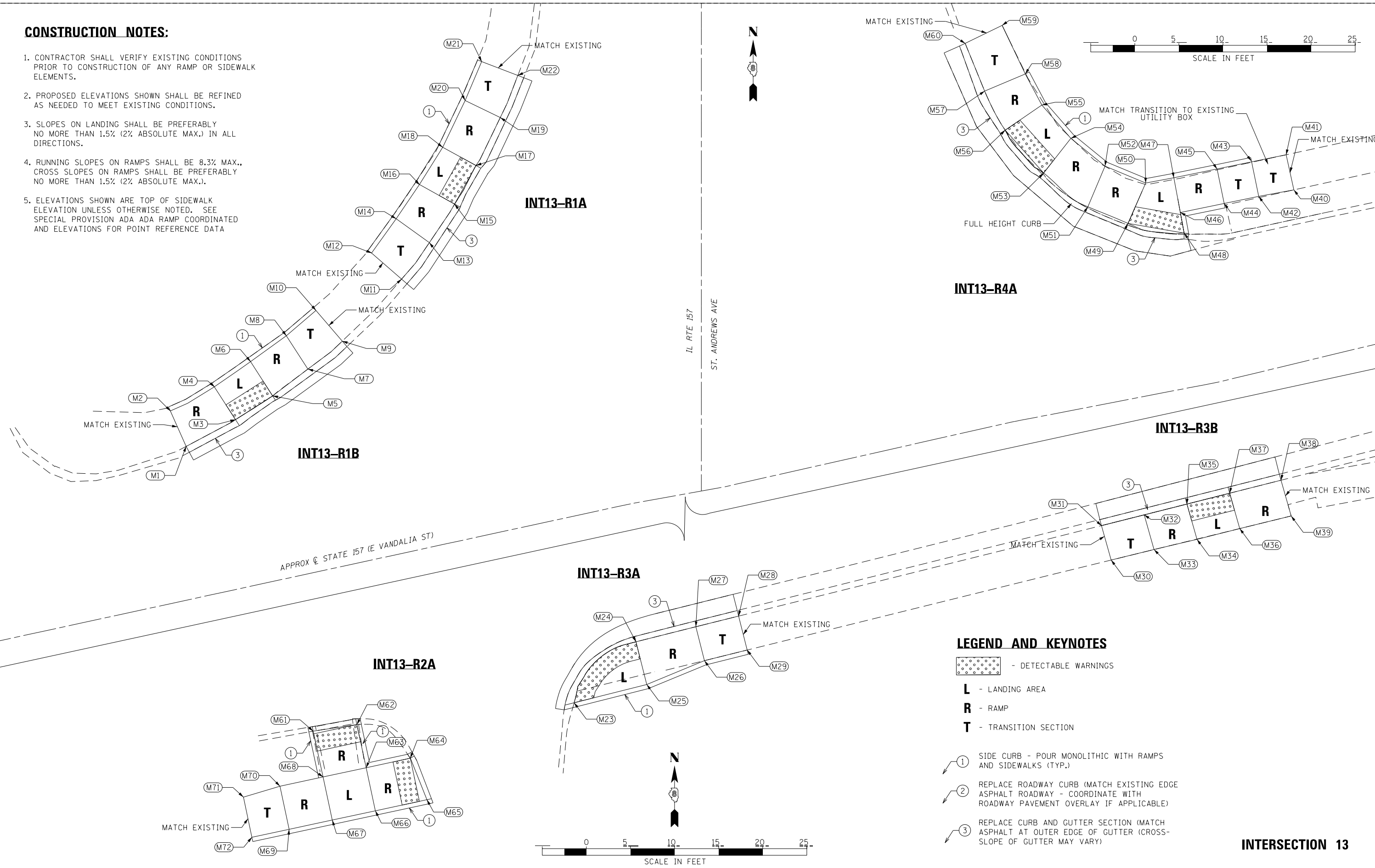

LEGEND AND KEYNOTES

- DETECTABLE WARNINGS
- L** - LANDING AREA
- R** - RAMP
- T** - TRANSITION SECTION
- ① SIDE CURB - POUR MONOLITHIC WITH RAMPS AND SIDEWALKS (TYP.)
- ② REPLACE ROADWAY CURB (MATCH EXISTING EDGE ASPHALT ROADWAY - COORDINATE WITH ROADWAY PAVEMENT OVERLAY IF APPLICABLE)
- ③ REPLACE CURB AND GUTTER SECTION (MATCH ASPHALT AT OUTER EDGE OF GUTTER (CROSS-SLOPE OF GUTTER MAY VARY))

INTERSECTION 13

| | | | |
|---------------|----------------------|------------|-----------|
| FILE NAME = | USER NAME = \$USER\$ | DESIGNED - | REVISED - |
| \$FILEL\$ | | DRAWN - | REVISED - |
| \$MODELNAME\$ | | CHECKED - | REVISED - |
| | | DATE - | REVISED - |

STATE OF ILLINOIS
DEPARTMENT OF TRANSPORTATION

RAMP DETAILS

SCALE: _____ SHEET ____ OF ____ SHEETS STA. _____ TO STA. _____

| | | | | |
|---------------------------|------------------------|---------|--------------------|-----------|
| F.A. RTE. | SECTION | COUNTY | TOTAL SHEETS | SHEET NO. |
| 789/592 | (27, 56RS-1, 65-2RS-4) | MADISON | 74 | 45 |
| EDWARDSVILLE ADA RAMPS | | | CONTRACT NO. 76G71 | |
| ILLINOIS FED. AID PROJECT | | | | |