

EXIST. CURVE C22  
 PI STA. = 99+26.67  
 $\Delta = 0^\circ 06' 56''$  (RT)  
 $D = 0^\circ 05' 12''$   
 $R = 66,193.50'$   
 $T = 66.70'$   
 $L = 133.40'$   
 $E = 0.03'$   
 $e = \text{-----}$   
 $T.R. = \text{-----}$   
 $S.E. \text{ RUN} = \text{-----}$   
 P.C. STA. = 98+59.97  
 P.T. STA. = 99+93.37

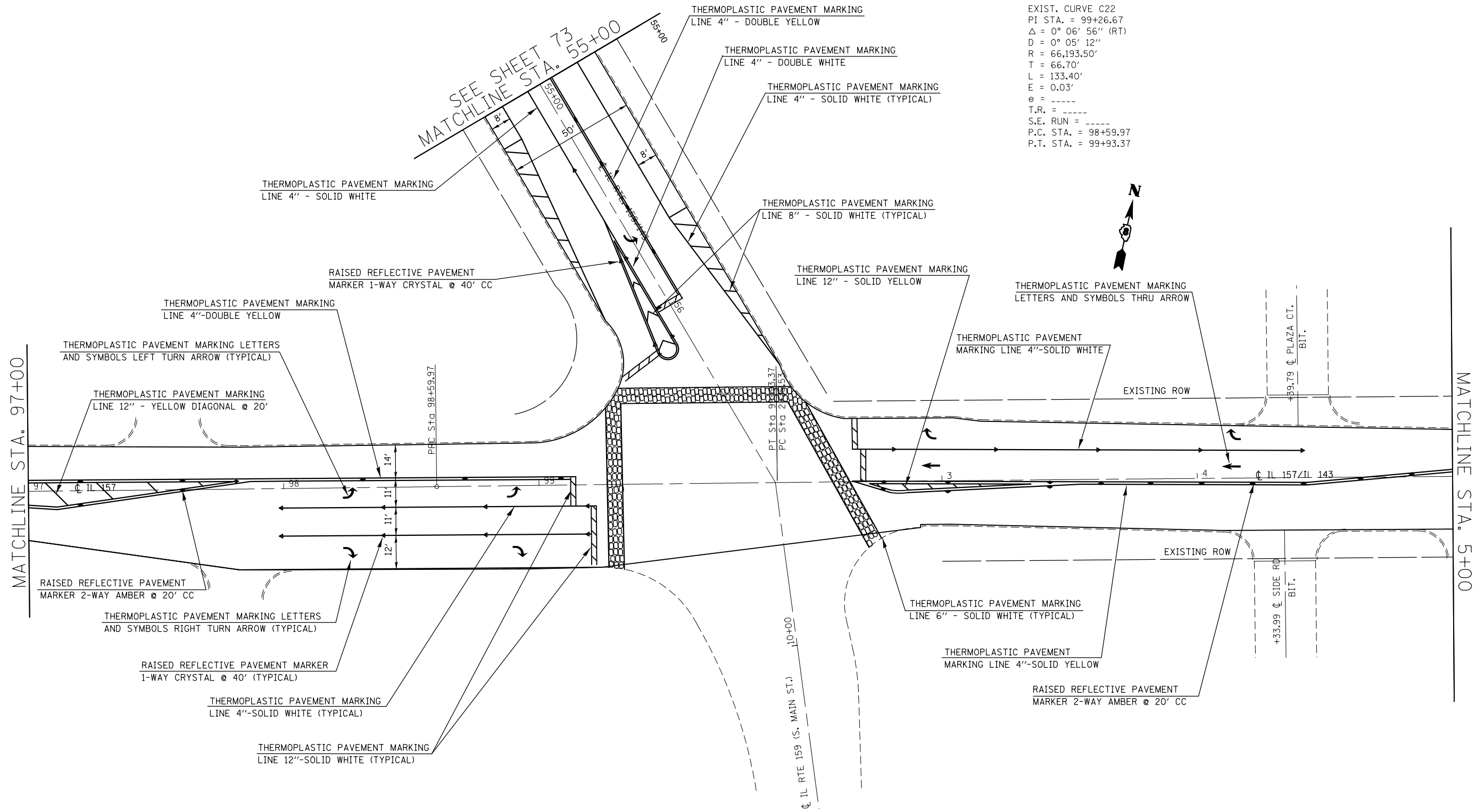

STATION	THERMOPLASTIC PAVEMENT MARKING, LINE - 4" (FOOT)			TEMPORARY PAVEMENT MARKING LINE - 4" (FOOT)			THERMOPLASTIC PAVEMENT MARKING LINE - 6" (FOOT)	TEMPORARY PAVEMENT MARKING LINE - 6" (FOOT)	THERMOPLASTIC PAVEMENT MARKING LINE - 8" (FOOT)	TEMPORARY PAVEMENT MARKING LINE - 8" (FOOT)	THERMOPLASTIC PAVEMENT MARKING LINE - 12" (FOOT)	TEMPORARY PAVEMENT MARKING LINE - 12" (FOOT)	THERMOPLASTIC PAVEMENT MARKING LINE - 24" (FOOT)	TEMPORARY PAVEMENT MARKING LINE - 24" (FOOT)	SHORT TERM PAVEMENT MARKING (FOOT)	RAISED RELECTIVE PAVEMENT MARKERS (EACH)		RAISED RELECTIVE PAVT. MRK. REMOVAL (EACH)	WORK ZONE PAVEMENT MRK. REM. (SQ FT)	THERMOPLASTIC PAVEMENT MARKING - LETTERS & SYMBOLS (SQ FT)	TEMPORARY PAVEMENT MARKING - LETTERS & SYMBOLS (SQ FT)
	SOLID WHITE	SKIP-DASH YELLOW	SOLID YELLOW	SOLID WHITE	SKIP-DASH YELLOW	SOLID YELLOW										1-WAY CRYSTAL	2-WAY AMBER				
97+00.00 TO 99+93.37	245.0	0.0	374.5	245.0	0.0	374.5	125.2	125.2	0.0	0.0	63.0	63.0	0.0	0.0	135.0	8	9	17	439.5	62.4	62.4
02+35.53 TO 05+00.00	175.0	0.0	597.8	175.0	0.0	597.8	126.4	126.4	0.0	0.0	36.1	36.1	0.0	0.0	121.7	5	14	19	451.7	54.2	54.2
55+00.00 TO 56+81.22	548.0	0.0	201.0	548.0	0.0	201.0	135.4	135.4	91.9	91.9	27.6	27.6	0.0	0.0	*4	6	4	10	421.8	54.2	15.6
<b>TOTAL THIS PAGE</b>	1368.5			1368.5			387.0	387.0	91.9	91.9	126.7	126.7	0.0	0.0	256.6	46		46	1313.0	170.8	170.8
<b>SUB-TOTAL</b>	<b>8444.3</b>			<b>8444.3</b>			<b>387.0</b>	<b>387.0</b>	<b>91.9</b>	<b>91.9</b>	<b>275.0</b>	<b>275.0</b>	<b>270.0</b>	<b>270.0</b>	<b>1493.8</b>	<b>190</b>		<b>190</b>	<b>5213.5</b>	<b>612.0</b>	<b>612.0</b>

FILE NAME = *FILEL*	USER NAME = *USER*	DESIGNED -	REVISED -	<b>STATE OF ILLINOIS DEPARTMENT OF TRANSPORTATION</b>	<b>PAVEMENT MARKING PLAN</b>			F.A.P. RTE.	SECTION	COUNTY	TOTAL SHEETS	SHEET NO.
		DRAWN -	REVISED -					* (7Z, 56)RS-1, 65-2RS-4	MADISON	74	58	
		CHECKED -	REVISED -					CONTRACT NO. 76G71				
		DATE -	REVISED -					FED. ROAD DIST. NO.	ILLINOIS	FED. AID PROJECT		

SCALE: 1"=20' SHEET NO. 7 OF SHEETS STA. TO STA.

(7Z, 56)RS-1, 65-2RS-4