

LEGEND

 PAVEMENT PATCHING

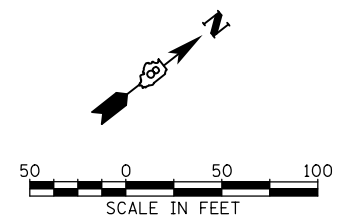
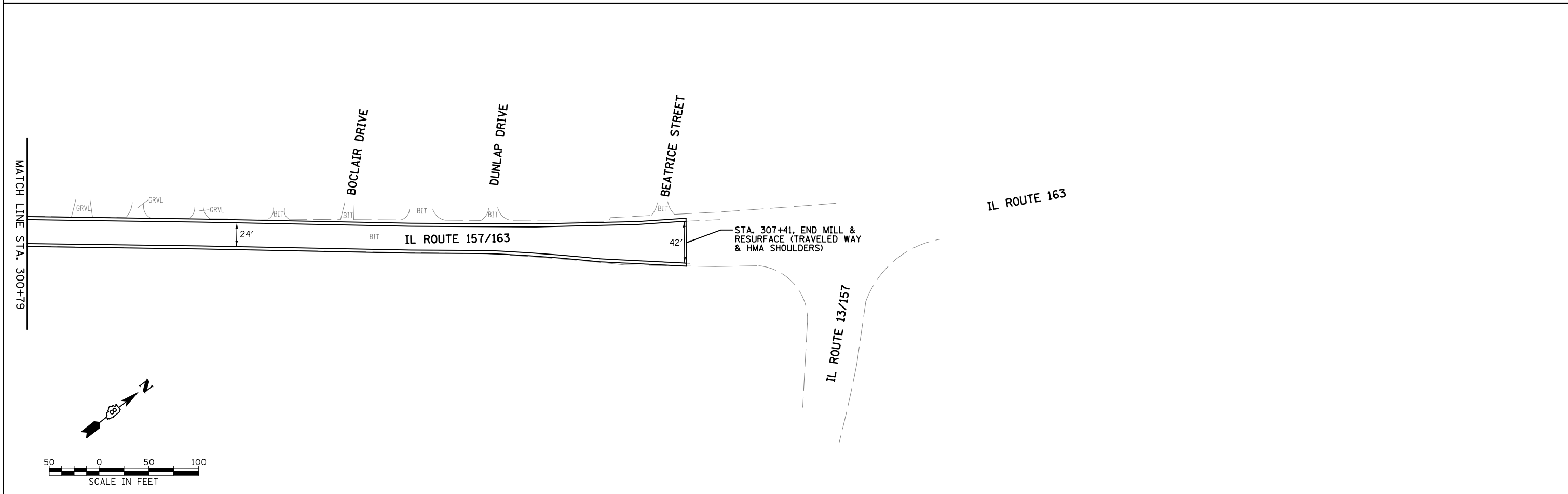
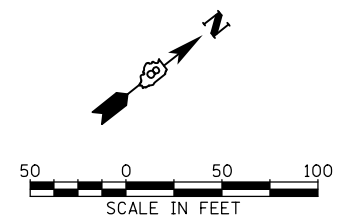

4/11/2014 9:26:59 AM
 FILE NAME = 76H23-shr-RDWAY-02.dgn

USER NAME = mmcklin	DESIGNED - TTB	REVISED -
MODEL NAME = Default	DRAWN - GDO	REVISED -
PLOT SCALE = 100.000' / in.	CHECKED - JAH	REVISED -
PLOT DATE = 4/11/2014	DATE - 4/10/14	REVISED -

**STATE OF ILLINOIS
 DEPARTMENT OF TRANSPORTATION**

**ROADWAY PLAN - CAMP JACKSON ROAD/IL ROUTE 157
 (LAURALEE TO IL ROUTE 13/157 - SHEET 2 OF 2)**

SCALE: 1"=50' SHEET NO. 2 OF 4 SHEETS STA. TO STA.

F.A.I. RTE.	SECTION	COUNTY	TOTAL SHEETS	SHEET NO.
VAR.	*	ST. CLAIR	19	13
• DIST 8 RESURFACING 2014-5		CONTRACT NO. 76H23		
FED. ROAD DIST. NO. 8 ILLINOIS FED. AID PROJECT				