

LEGEND
 PAVEMENT PATCHING

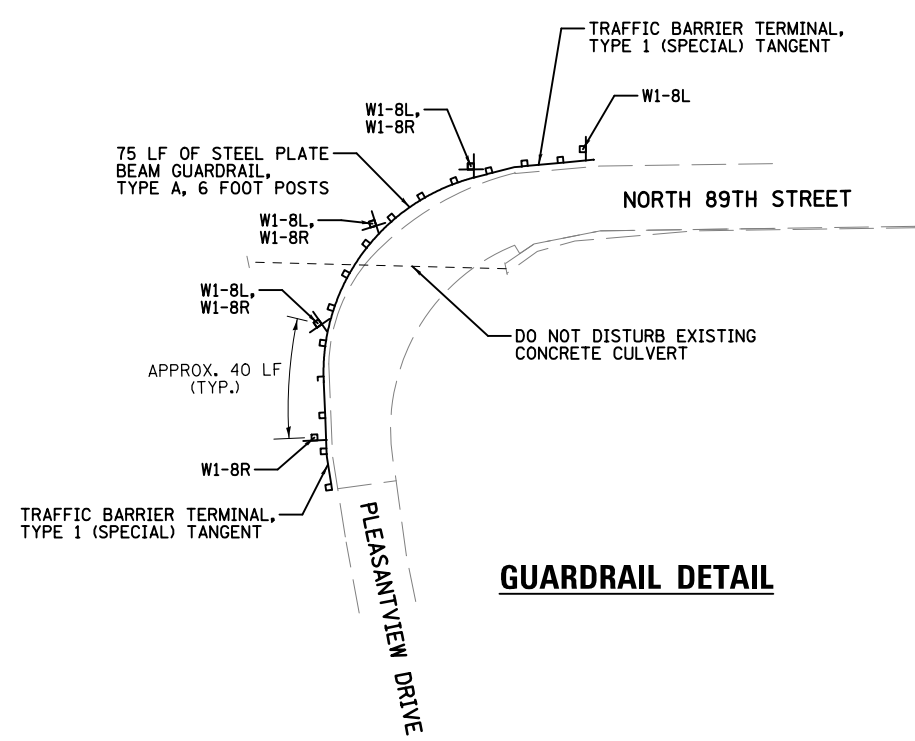

GUARDRAIL DETAIL

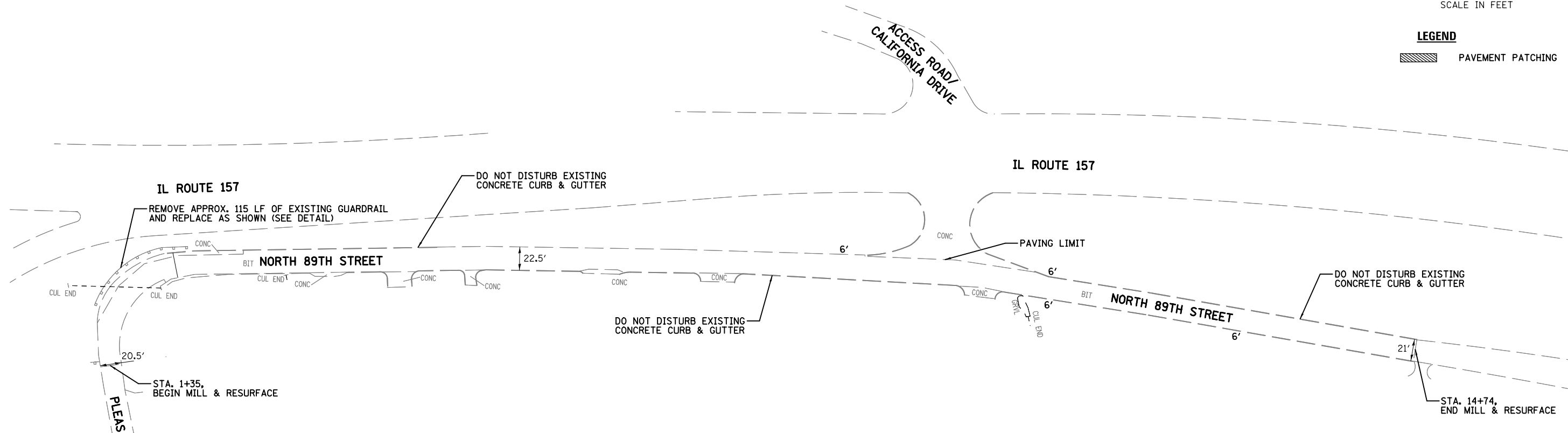
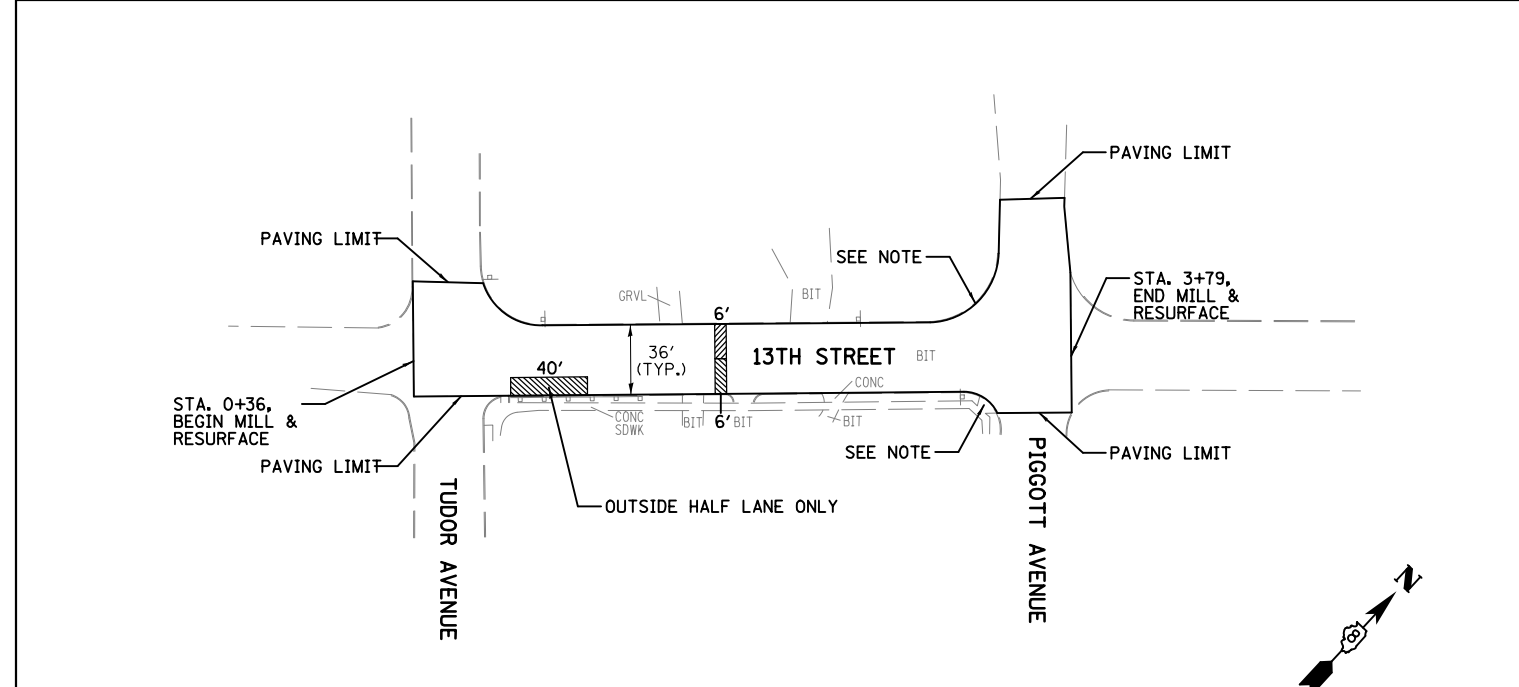

NOTE:
 REMOVE EXISTING SIDEWALK PAVEMENT NECESSARY TO CONSTRUCT NEW DIAGONAL CURB RAMP PER STANDARD 424006-01. NEW CURB RAMP SHALL CONSIST OF 6-INCH PORTLAND CEMENT CONCRETE SIDEWALK PAVEMENT.

LEGEND
 PAVEMENT PATCHING

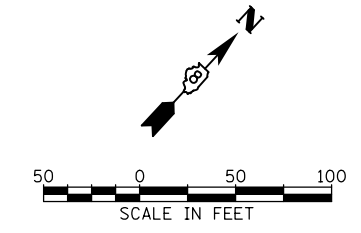

4/11/2014
 9:27:25 AM
 FILE NAME = 76h23-shr-RDWY-04.dgn
 USER NAME = mmcklin
 MODEL NAME = Default
 PLOT SCALE = 100.000' / in.
 PLOT DATE = 4/11/2014

DESIGNED -	REVISED -
DRAWN -	REVISED -
CHECKED -	REVISED -
DATE - 4/10/14	REVISED -

**STATE OF ILLINOIS
 DEPARTMENT OF TRANSPORTATION**

**ROADWAY PLAN -
 NORTH 89TH STREET (NORTH OF ST. CLAIR AVENUE)
 & 13TH STREET**
 SCALE: 1"=50' SHEET NO. 4 OF 4 SHEETS STA. TO STA.

F.A.I. RTE. VAR.	SECTION *	COUNTY ST. CLAIR	TOTAL SHEETS 19	SHEET NO. 15
* DIST 8 RESURFACING 2014-5		CONTRACT NO. 76H23		
FED. ROAD DIST. NO. 8 ILLINOIS FED. AID PROJECT				