

NORTH RADIUS DETAIL

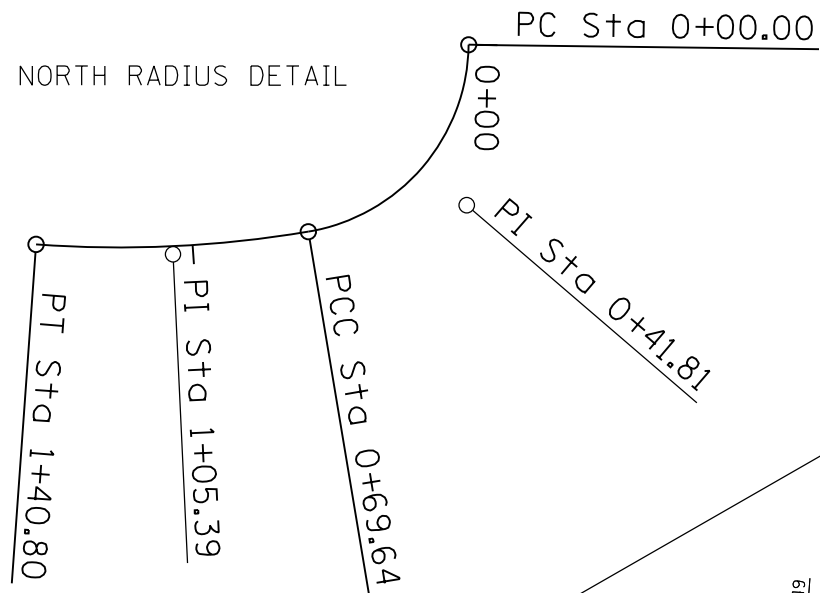

EXIST. CURVE RUSH20  
 PI STA. = 160+77.59  
 $\Delta = 48^\circ 59' 58''$  (RT)  
 $R = 64.84'$   
 $T = 29.55'$   
 $L = 55.45'$   
 $E = 6.42'$   
 $e = \text{-----}$   
 T.R. = -----  
 S.E. RUN = -----  
 P.C. STA. = 160+48.04  
 P.T. STA. = 161+03.49

PROP. CURVE N-RADIUS-1	PROP. CURVE N-RADIUS-2
PI STA. = 0+41.81	PI STA. = 1+05.39
$\Delta = 79^\circ 48' 09''$ (RT)	$\Delta = 13^\circ 35' 26''$ (RT)
$D = 114^\circ 35' 30''$	$D = 19^\circ 05' 55''$
$R = 50.00'$	$R = 300.00'$
$T = 41.81'$	$T = 35.75'$
$L = 69.64'$	$L = 71.16'$
$E = 15.18'$	$E = 2.12'$
$e = \text{-----}$	$e = \text{-----}$
T.R. = -----	T.R. = -----
S.E. RUN = -----	S.E. RUN = -----
P.C. STA. = 0+00.00	P.C. STA. = 0+69.64
P.T. STA. = 0+69.64	P.T. STA. = 1+40.80

SOUTH RADIUS DETAIL

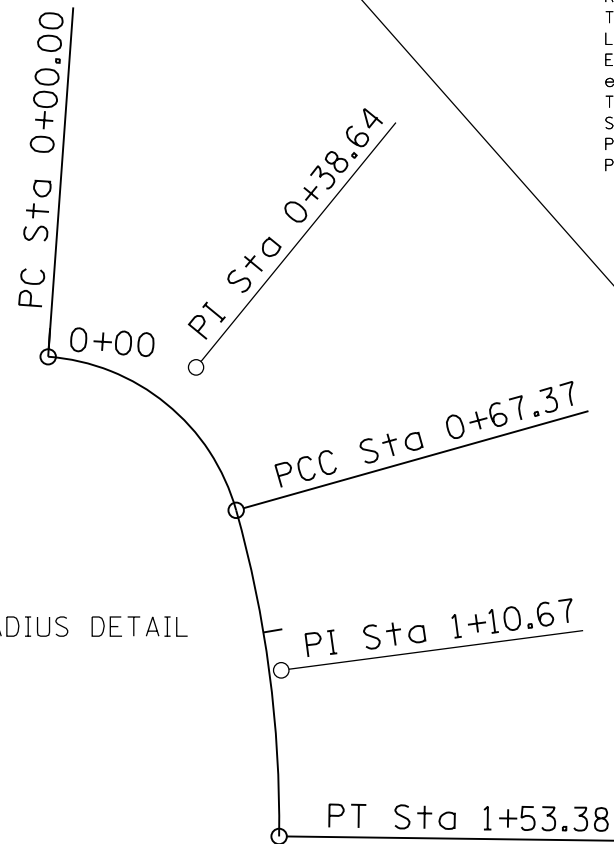

PROP. CURVE S-RADIUS-1	PROP. CURVE S-RADIUS-2
PI STA. = 0+38.64	PI STA. = 1+10.67
$\Delta = 70^\circ 10' 50''$ (RT)	$\Delta = 16^\circ 25' 35''$ (RT)
$D = 104^\circ 10' 27''$	$D = 19^\circ 05' 55''$
$R = 55.00'$	$R = 300.00'$
$T = 38.64'$	$T = 43.30'$
$L = 67.37'$	$L = 86.01'$
$E = 12.22'$	$E = 3.11'$
$e = \text{-----}$	$e = \text{-----}$
T.R. = -----	T.R. = -----
S.E. RUN = -----	S.E. RUN = -----
P.C. STA. = 0+00.00	P.C. STA. = 0+67.37
P.T. STA. = 0+67.37	P.T. STA. = 1+53.38

FILE NAME =	USER NAME = \$USER\$	DESIGNED -	REVISED -
c:\pwork\pwork\kellykd\0374570\78402-shrb-tp-sch_ties_geopakelements.dgn		DRAWN -	REVISED -
	PLOT SCALE = 100.0000' / 1".	CHECKED -	REVISED -
\$MODELNAME\$	PLOT DATE = 3/20/2014	DATE -	REVISED -

STATE OF ILLINOIS  
 DEPARTMENT OF TRANSPORTATION

GEOPAK ELEMENTS IDENTIFICATION SHEET

SCALE: SHEET OF SHEETS STA. TO STA.

F.A.P. RTE.	SECTION	COUNTY	TOTAL SHEETS	SHEET NO.
726	(1-2) N-3	WILLIAMSON	50	18
CONTRACT NO. 78402				
ILLINOIS FED. AID PROJECT				